



# VITEC MVGRC Gimbal Remote Controller User Manual

[Home](#) » [VITEC](#) » VITEC MVGRC Gimbal Remote Controller User Manual 



## Contents

- [1 Structure and accessories](#)
- [2 Material:](#)
- [3 Main body dimension](#)
- [4 Specification](#)
- [5 Extension Port](#)
- [6 Operation way working with AK2000/AK4000](#)
- [7 The feature of Hyperlink remote](#)
- [8 Documents / Resources](#)
- [9 Related Posts](#)

## Structure and accessories

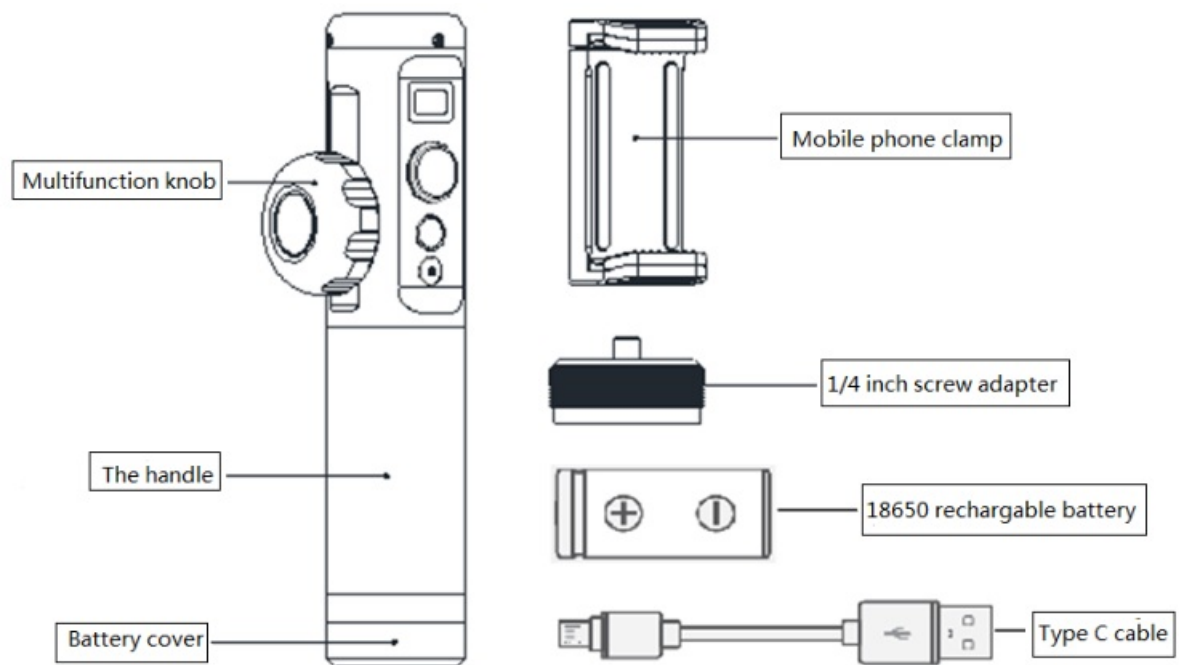

### Standard accessories list

Hyperlink Remote Control\*1  
 Mobile phone clamp\*1  
 1/4inch thread adaptor\*1  
 18650 rechargeable battery\*1  
 Type c cable\*1

### Material:

**Metal (aluminum alloy) +silica gel**

Accessory	Main material
Multifunction knob	aluminum alloy/Stainless steel
Silicon case of the handle	silica gel
Battery cover	aluminum alloy
Mobile phone clamp	aluminum alloy/silica gel/Stainless steel
1/4inch screw adaptor	aluminum alloy/Stainless steel

### Main body dimension

φ35.5\*161.1mm

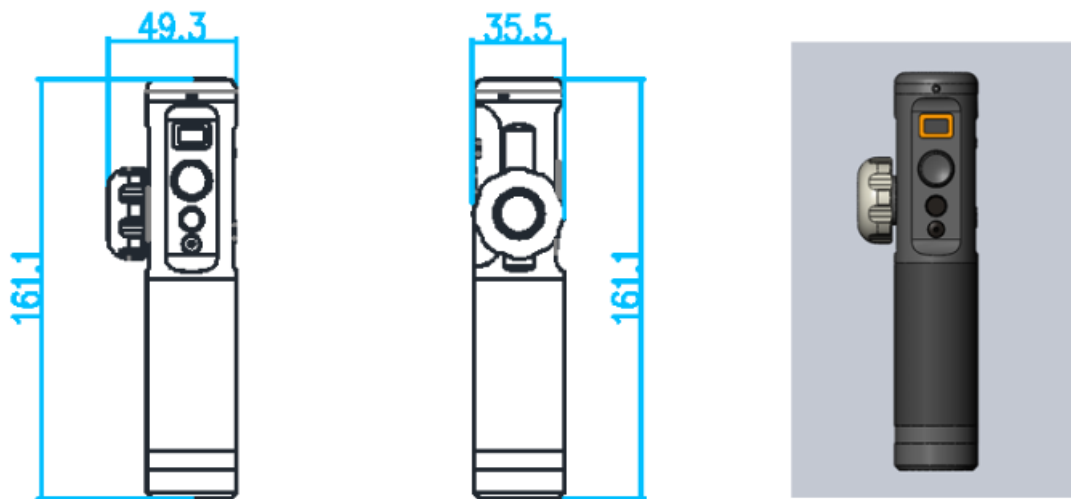

## Specification

No.	Parameter name	standard	Remark
1	Bluetooth module	BT4.1	—
2	Bluetooth control distance	1015 meters	Depend on operational environment al
3	Battery life	18 hours	Depending on the usage way
4	charging port	Type c	—
5	Charging time	2 hours	—
6	Battery capacity	2200mAh,rechargeable	18650 battery, the same as AK series
7	Voltage	3.7V	—
8	Battery power	8.14WH	—
9	The width of a compatible mobile phone	55-84mm	For Image transmission and monitoring when working with phone and camera APP
10	Pure Weight	271g(including battery)	—

## Extension Port

On the top and bottom Each 1/4 inch thread hole Please check the following picture to use the top port



## Operation way working with AK2000/AK4000

No.	Display & Button	Function
1	Display	Show gimbal connection, APP connection status, control object status, power level, Somatosensory mode, gimbal mode, follow focus progress bar when working with B rushless follows focus gear.
2	joystick	1. control camera movement 2. move to the left to cancel, move to the right to confirm
3	Function button	1. Long press function button to power on/off, 2. Single tap to enter LK mode, double-tap to enter TF mode, triple tap to enter AF mode; single tap again to back to HF mode
4	Shutter button	Single tap to shoot, long press to switch between photo and video, long press again to video (after connecting AK series to camera)

5	Setting button	Single tap to enter the setting menu, then you can check the remote control's information. Connect and disconnect Bluetooth. Knob sensitivity adjustment setting. Calibrate gyroscope.
6	Trigger button	1. Hold the trigger button to enter Somatosensory mode, release it to exit 2. Double-tap to reset the gimbal, three axes return to default status
7	Level control button	Can't be used on the AK series (Because there isn't that button on the AK series)
8	Multifunction knob	1. Press multifunction knob can switch the control between three-axis 2. Long press knob to control external follow focus while connecting. (Can't support internal electronic follow focus function when connecting the camera with WiFi)
<p><b>Note:</b> All above operations are available on AK2000/4000 with gimbal firmware V1008, Bluetooth firmware V1.0.8 and Keypad Board Firmware V1.2.4. Please update the gimbal to the latest firmware.</p>		

## The feature of Hyperlink remote

- ★ Go to Somatosensory mode anytime and follow your movements without contacting the gimbal.
- ★ Comfortable handing as the main body of the gimbal, directly controlling the gimbal and camera.
- ★ Clear working state on display to easily check them
- ★ With a multifunction knob, you can control follow focus with an external follow focus gear
- ★ Set up the remote by connecting and disconnecting Bluetooth, controlling the sensitivity and calibration,
- ★ General two 1/4inch extension port with standard accessory phone clamp for image transmission and monitor.
- ★ Super-long working hours up to 18 hours for a whole day's usage.

## FCC regulatory conformance

This device complies with Part 15 of the FCC Rules. Operation is subject to the following two conditions:

1. This device may not cause harmful interference.
2. This device must accept any interference received, including interference that may cause undesired operation.

**NOTE:** This equipment has been tested and found to comply with the limits for a Class B digital device, pursuant to part 15 of the FCC Rules. These limits are designed to provide reasonable protection against harmful interference in a residential installation.

This equipment generates uses and can radiate radio frequency energy and, if not installed and used in accordance with the instructions, may cause harmful interference to radio communications. However, there is no guarantee that interference will not occur in a particular installation. If this equipment does cause harmful interference to radio or television reception, which can be determined by turning the equipment off and on, the user is encouraged to try to correct the interference by one or more of the following measures:

- Reorient or relocate the receiving antenna.
- Increase the separation between the equipment and receiver.
- Connect the equipment into an outlet on a circuit different from that to which the receiver is connected.
- Consult the dealer or an experienced radio/TV technician for help

**NOTE:** The manufacturer is not responsible for any radio or TV interference caused by unauthorized modifications to this equipment. Such modifications could void the user’s authority to operate the equipment.

### IC regulatory conformance

This device complies with CAN ICES-3 (B)/NMB-3(B).

This device complies with Industry Canada licence-exempt RSS standard(s). Operation is subject to the following two conditions:

1. this device may not cause harmful interference, and
2. this device must accept any interference received, including interference that may cause undesired operation.

### RF Exposure

This equipment complies with FCC/IC radiation exposure limits set forth for an uncontrolled environment.

**Guilin Feiyu Technology Incorporated Company**

**+86-773-2320860**

**3rd Floor, Building B, Guilin Electric Valley, Innovation Building, Information Industry Park,  
Chaoyang Road, Qixing District, Guilin, China**

### Documents / Resources

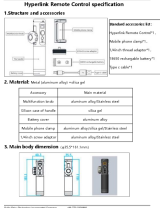
	<p><a href="#">VITEC MVGRC Gimbal Remote Controller</a> [pdf] User Manual MVGRC, 2AQK5-MVGRC, 2AQK5MVGRC, MVGRC Gimbal Remote Controller, Gimbal Remote Controller, Remote Controller, Controller</p>
---	---