



Vita SP-A12T-UP-1 Bottom Loading Water Dispenser Instruction Manual

[Home](#) » [Vita](#) » Vita SP-A12T-UP-1 Bottom Loading Water Dispenser Instruction Manual 

Contents

- 1 Vita SP-A12T-UP-1 Bottom Loading Water Dispenser
- 2 SAFETYINSTRUCTION
- 3 PART NAME
- 4 SAFETY PRECAUTIONS
- 5 GETTING STARTED
- 6 DISPENSING WATER
- 7 TROUBLE SHOOTING
- 8 TECHNICAL PARAMETERS
- 9 CIRCUIT DIAGRAM
- 10 CLEANING
- 11 MACHINE INSTALLATION
- 12 Documents / Resources



Vita SP-A12T-UP-1 Bottom Loading Water Dispenser



MODEL: SP-A12T-UP-1

KEEP THIS MANUAL IN GOOD CONDITION PLEASE READ THIS MANUAL CAREFULLY BEFORE USING THE MACHINE REV.

SAFETYINSTRUCTION

1. This appliance can be used by children aged from 8 years and above and persons with reduced physical, sensory or mental capabilities or lack of experience and knowledge if they have been given supervision or instruction concerning use of the appliance in a safe way and understand the hazards involved. Children shall not play children without with the appliance. Cleaning and user maintenance shall not be made by supervision.
2. Appliances can be used by persons with reduced physical, sensory or mental capabilities or lack of experience and knowledge if they have been given supervision or instruction concerning use of the appliance in a safe way and understand the hazards involved. Children shall not play with the appliance.
3. This appliance is intended to be used by expert or trained users in shops, in light industry and on farms, or for commercial use by lay persons.
4. If the supply cord is damaged, it must be replaced by the manufacturer, its service agent or similarly qualified persons in order to avoid a hazard.
5. The appliance must not be cleaned by a water jet.
6. The appliance is suitable for indoor use only.
7. **WARNING:** Keep ventilation openings, in the appliance enclosure or in the built-in structure, clear of obstruction.
8. **WARNING:** Do not use mechanical devices or other means to accelerate the defrosting process, other than those recommended by the manufacturer.
9. **WARNING:** Do not use electrical appliances inside the food storage compartments of the appliance, unless they are of the type recommended by the manufacturer.

PART NAME

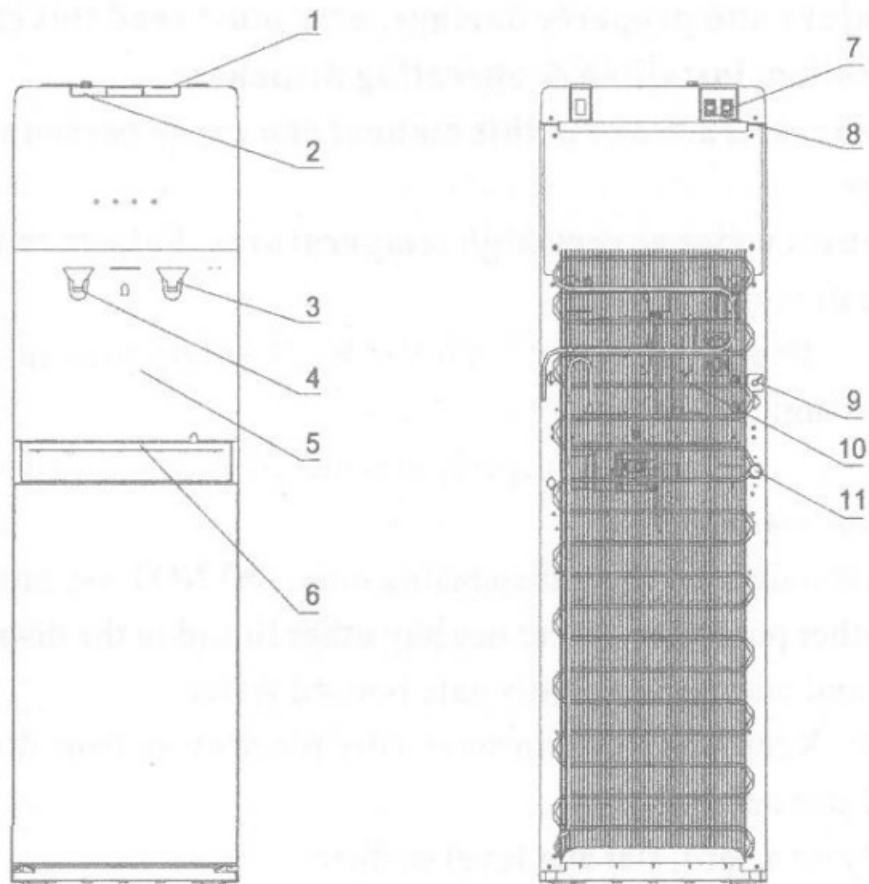

NO.	PART NAME	NO.	PART NAME
1	push button of cold water	7	heating switch
2	push button of hot water	8	cooling switch
3	cold spout	9	power cord
4	hot spout	10	condenser
5	front carapace	11	outlet of hot water
6	water collector		

NOTE:

This machine can be suitable for bottle of 5 gallons. Do not use unhealthy hard water.

SAFETY PRECAUTIONS

WARNING

To reduce risk of injury and property damage, user must read this entire guide before assembling, installing & operating dispenser.

Failure to execute the instructions in this manual can cause personal injury or property damage.

This product dispenses water at very high temperatures. Failure to use properly can cause personal injury.

When operating this dispenser, always exercise basic safety precautions, including the following:

- Prior to use, this dispenser must be properly assembled and installed in accordance with this manual.
- This dispenser is intended for water dispensing only. DO NOT use other liquids
DO NOT use for other purposes. Never use any other liquid in the dispenser other than known and

microbiologically safe bottled water.

- For indoor use only. Keep water dispenser in a dry place away from direct sunlight. DO NOT use outdoors.
- Install and use only on a hard, flat and level surface.
- DO NOT place dispenser into an enclosed space or cabinet.
- DO NOT operate dispenser in the presence of explosive fumes.
- Position back of dispenser no closer than 20cm from wall and permit free airflow between wall and dispenser. There must be at least 20cm clearance on the sides of the dispenser to permit airflow.
- Use only properly grounded outlets.
- Do not use an extension cord with your water dispenser.
- Always grasp plug and pull straight out from outlet. Never unplug by pulling on power cord.
- DO NOT use dispenser if cord becomes frayed or otherwise damaged.
- To protect against electric shock. DO NOT immerse cord, plug, or any other part of dispenser in water or other liquids.
- Ensure dispenser is unplugged prior to cleaning.
- Never allow children to dispense hot water without proper and direct supervision. Unplug unit to prevent unsupervised use by children.
- Service should be performed only by a certified technician.
- Warning: DO NOT damage the refrigerant circuit.
- The adult should supervise the children in order to make sure the children can not play with the appliance.
- The appliance is not intended for use by persons (including children) with reduced physical, sensory or mental capabilities, or lack of experience and knowledge, unless they have been given supervision or instruction concerning use of the appliance by a person responsible for their safety.
- This appliance is intended to be used in household and similar applications such as:
 - staff kitchen in hotels, motels and other residential type
 - farm houses; -by clients in hotels, motels and other residential type environments; -bed and breakfast type environments.
- If the supply cord is damaged, it must be replaced by the manufacturer, its service agent or similarly qualified person.
- Never turn the machine upside down or lean it more than 45°.
- Thermostat has been adjusted. No need to adjust it by yourself. When the machine is under the ice point and blocked by ice, the cooling switch must be closed for 4 hours before turning it on again to continue its operation.
- This machine should not be turned on until 3 minutes later after turning off the power switch.
- Do not store explosive substances such as aerosol cans with a flammable propellant in this appliance.

GETTING STARTED

Locate Dispenser

1. Place dispenser upright.
2. Locate dispenser on a hard and level surface in a cool shaded location near a grounded wall outlet.
Notice: DO NOT plug in power cord yet.
3. Position dispenser so the back is at least 20cm from wall and there are at least 20cm of clearance on both sides.

Assemble

1. Remove drip tray from door and place the grid on top.
2. Snap drip tray and grid assembly into door.

Install Water Bottle

1. Open dispenser door.
2. Place probe assembly on probe hanger.
3. Place fresh bottle outside of cabinet.
4. Remove entire plastic cap from top of bottle.
5. Clean outside of new bottle with a cloth.
6. Place probe into bottle.
7. Slide collar down until it clicks in place.
8. Push head down until tubes hit bottom of bottle.
9. Slide bottle into cabinet and close door.

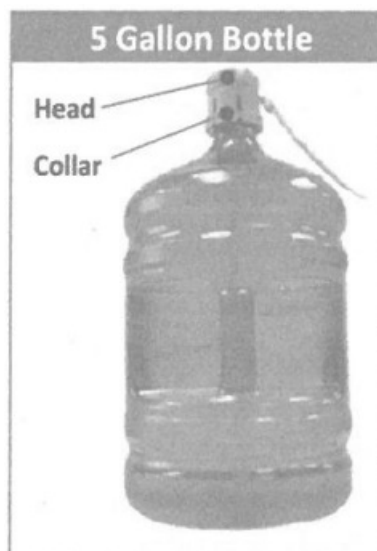

Provide Electricity

Plug cord into a properly grounded wall outlet.

At this time the pump will begin to move water from the bottle to the hot and cold tanks. It will take up to 5 minutes to fill the tanks for the first time. During this period the pump will run continuously. This is normal.

DISPENSING WATER

This unit has been tested and sanitized prior to packing and shipping. During transit dust and odors can accumulate in the tank and lines. Dispense and dispose at least one quart of water prior to drinking any water.

Dispensing Cold Water

After setup, it will take up to 1 hour to get water to maximum cold temperature. During this time the compressor could run continuously. This is normal.

1. Position bottle, glass, pitcher or cooking pot below spout.

2. Depress nonnal water control downward to start cold water flow.
3. Release control once desired fill level is achieved.

Dispensing Hot Water After setup, hot water will be available in 15-20 minutes.

1. Position bottle, glass, pitcher or cooking pot below spout.
2. Slide red button away from you and depress hot water control downward to start hot water flow.
3. Release control once desired fill level is achieved.

Changing Bottles

A flashing red light on your function lights alerts you when your bottle is empty. Replace the bottle as soon as possible.

Notice: Do not dispense hot, cool or cold water if the light is flashing as you could empty the tanks and cause the dispenser to overheat.

1. Open dispenser door.
2. Slide empty bottle out of cabinet.
3. Remove probe assembly from empty bottle. Place probe assembly on probe hanger.
4. Set empty bottle aside.
5. Place fresh bottle outside of cabinet. Remove entire plastic cap from top of bottle. Clean outside of new bottle with a cloth.
6. Place probe into bottle. Slide collar down until it clicks in place. Push head down until tubes hit bottom of bottle.
7. Slide bottle into cabinet and close door.

TROUBLE SHOOTING

• Water is leaking

- Unplug dispenser, remove bottle and replace it.
- No water is coming from the spout.
- Make sure the bottle is not empty. If empty, replace it.
- Make sure to completely depress the pushbutton controls.

• Cold water is not cold

- It takes up to one hour after setup to dispense cold water.
- Make sure the power cord is properly connected to a working outlet.
- Make sure the back of the dispenser is at least 20cm from a wall and there is free airflow on all 20cm sides of the dispenser.
- Make sure green power switch on back of dispenser is ON.
- If water still isn't cold, please ask for the service agent for assistance.

• Hot water is not hot.

- It takes 15-20 minutes after setup to dispense hot water.
- Make sure the power cord is properly connected to a working outlet.
- Make sure red power switch on back of dispenser is ON.

• Dispenser Is Noisy

Make sure the dispenser is positioned on a level surface.

TECHNICAL PARAMETERS

MODEL:	SP-A12T-UP-1	
DIMENSION:	316*360*1040mm	
RATED VOLTAGE:220-240V~		RATED FREQUENCY:50Hz
RATED POWER:520W		HEATING POWER:420W
HOT WATER:≥85℃ 4L/h		COLE WATER:≤10℃ 2L/h
REFRIGERANT:R134a(32g)		COOLING CURRENT:1.0A
COLD TANK CAPACITY:2L		HOT TANK CAPACITY:1L

CIRCUIT DIAGRAM

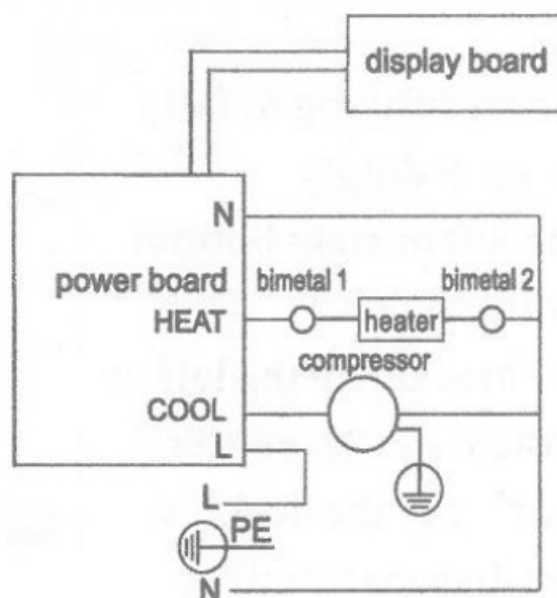

CLEANING

To avoid accident, cut off the power supply before operation according to the foil owing instruction.

1. The machine had been disinfected before departed from factory. Cleaning the dispenser prior to installing a full bottle of water for the first time.

2. Rinsing instruction:

1. Put the pumping pipe into the bottle.
2. Stop the bottle.
3. Push the bottle into the water drinking machine and close the door.
4. Turn on the power; let the machine pumped water then press the outlet button.
5. Turn off the power and remove the water bottle.
6. Open the drain plug in back of the machine.
7. Screw up the drain plug after water drained and you can use the machine.

3. Draining instruction:

1. Open the hot water tap.
2. Open the outlet in back of the machine and drain the water.
3. After draining, cover the outlet and you can use the machine. (Attention: The drained water may be very hot, please operate it carefully.)

4. Sanitizing:

Generally sanitizing should be done every 3 months (Exact time depends on the machine working environment). About the sanitizing and cleaning media use method please refer to the cleaning media use direction. You'd better consult your service providers for the help.

MACHINE INSTALLATION

To prevent the machine from swaying to fall, please install the bracket accordingly.

1. Loosen the screw of the left or right bottom angle just as the picture shown.
2. Use the screw to fix the bracket on the left or right bottom angle of the water dispenser.
3. Make a hole on the floor's or the desk's surface where the water dispenser will be installed.
4. Fix the bracket on the floor by screw tightly.
5. Tighten the screw.

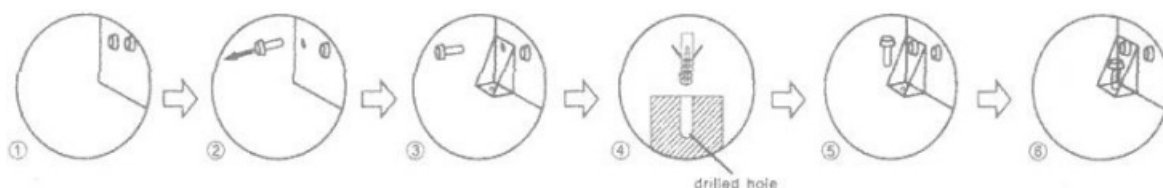

NOTE:

Manufacture shall have the right to make changes without prior notice. The packaging material used is recyclable; we recommend that you separate plastic, paper and cardboard and give them to recycling companies. To help preserve the environment, the refrigerant used in this product is R134a (Hydrofluorocarbon -HFC), which does not affect the ozone layer and has little impact on the greenhouse effect. According to WEEE (Waste of Electrical and Electronic Equipment) guidelines, waste from electrical and electronic devices should be collected separately. If you need to dispose of this appliance in the future, do NOT throw it away with the rest of your domestic garbage. Instead, please take the appliance to the nearest WEEE collection point, where available.

Documents / Resources

	<p>Vita SP-A12T-UP-1 Bottom Loading Water Dispenser [pdf] Instruction Manual SP-A12T-UP-1 Bottom Loading Water Dispenser, SP-A12T-UP-1, Bottom Loading Water Dispenser, Loading Water Dispenser, Water Dispenser, Dispenser</p>
---	--