



VISUAL LED 500X1000MM Modular LED Display Instruction Manual

[Home](#) » [VISUAL LED](#) » VISUAL LED 500X1000MM Modular LED Display Instruction Manual 

Contents

- [1 VISUAL LED 500X1000MM Modular LED Display](#)
- [2 Product Information](#)
- [3 INSTALLATION STEPS](#)
- [4 STEP 1: UNPACKING AND POSITIONING](#)
- [5 STEP 2: DISPLAY ASSEMBLY](#)
- [6 STEP 3: WIRING OF THE LED DISPLAY](#)
- [7 CHANGING AN LED MODULE](#)
- [8 CONNECTING WIRES](#)
- [9 Documents / Resources](#)



VISUAL LED 500X1000MM Modular LED Display



Product Information

This manual provides installation and assembly instructions for the Modular LED Display. The display is available in two sizes: 500 x 1000mm and 500 x 500mm. It is important to read and follow the handling guidelines mentioned in this manual during the assembly process.

Installation Steps:

Step 1: Unpacking and Positioning

- A minimum of 2 people is required for handling and assembly.
- Use a soft protective surface (e.g., foam, cardboard, carpet, blanket, etc.) to place the frames out of the box.
- Avoid any damage to the LEDs during unpacking and handling of the cabinets, as these damages are not covered by warranty.
- Always place the back of each frame first, protecting the LEDs.
- Avoid impact damages on the display area.
- LED panels are extremely sensitive elements. Extreme care must be taken to avoid damaging the LEDs during display assembly.
- Choose a perfectly level surface or structure to assemble the screen on.
- Be sure to orientate the cabinets correctly. In the vertical position, pins should always be facing up. In the horizontal position, pins should always be facing left.

Step 2: Display Assembly

- Set one cabinet over another.
- Press levers from the upper cabinet and insert mechanisms from the lower frame.
- Release upper levers with mechanisms inserted.
- If a frame locking mechanism does not apply tightening force between the cabinets when it's engaged, use the mechanism's adjustment screw.

Step 3: Display Wiring

- The cabinets must be interconnected in series with network cables. Each frame has 2 network ports. Standard network cable can be used to make the connections.
- Interconnect the cabinets of your display with the supplied power cables. Do not draw more than 3000W from the same connection. Each frame has 2 power ports.
- Make sure to follow the correct mains connection for powering the display.

Note: The maximum network cable length between the player and display is 15 meters. Depending on the size of your screen, more than one power mains connection may be needed to power all the frames.

INSTALLATION STEPS

READ THIS MANUAL AND FOLLOW THE HANDLING GUIDELINES DURING THE ASSEMBLY PROCESS.

1. UNPACKING AND POSITIONING OF THE DISPLAY CABINETS
2. DISPLAY ASSEMBLY
3. POWER & DATA WIRING

STEP 1: UNPACKING AND POSITIONING

- A MINIMUM OF 2 PEOPLE FOR HANDLING AND ASSEMBL

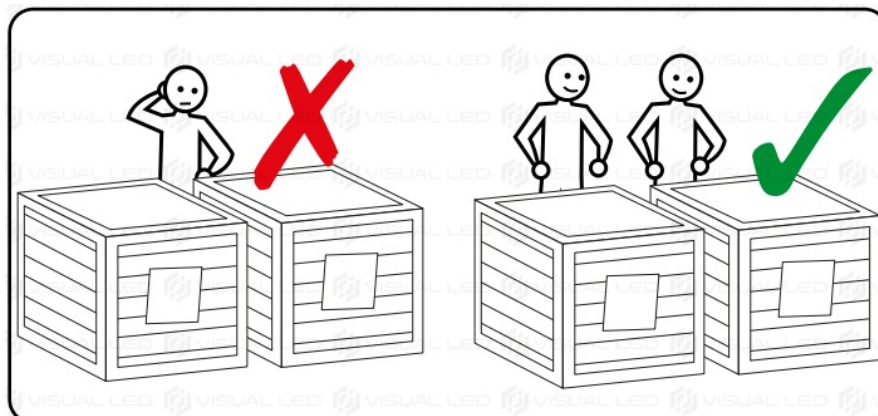

- USE A SOFT PROTECTIVE SURFACE (E.G. FOAM, CARDBOARD, CARPET, BLANKET, ETC.) TO PLACE THE FRAMES OUT OF THE BOX.

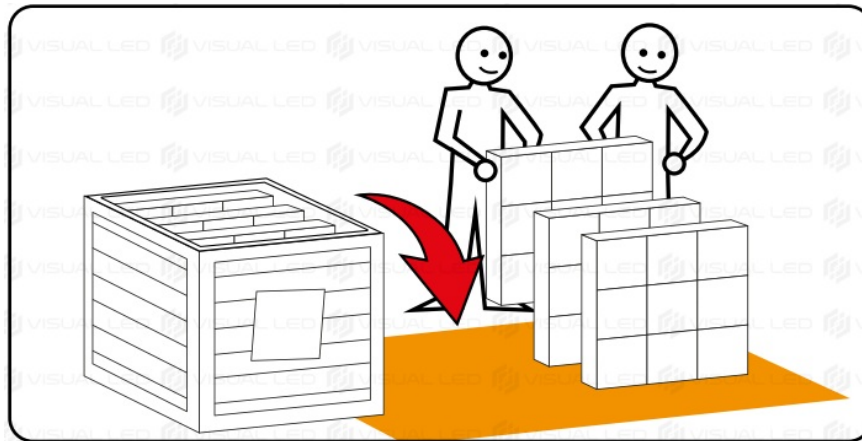

- **WARNING:** AVOID ANY DAMAGE TO THE LEDS DURING UNPACKING AND HANDLING OF THE CABINETS. THESE DAMAGES ARE NOT COVERED BY WARRANTY
- **NOTE:** ALWAYS PLACE THE BACK OF EACH FRAME FIRST, PROTECTING THE LEDS.

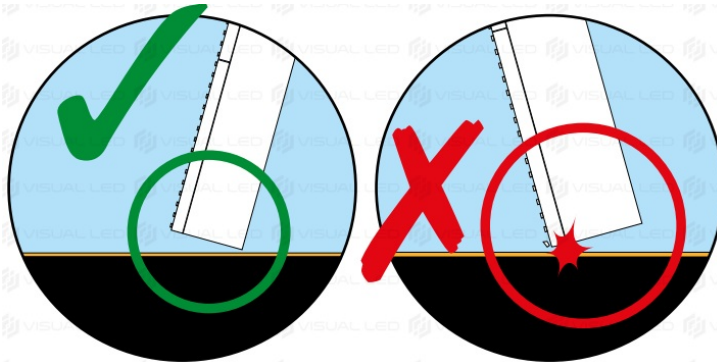

- AVOID IMPACT DAMAGES ON THE DISPLAY AREA.

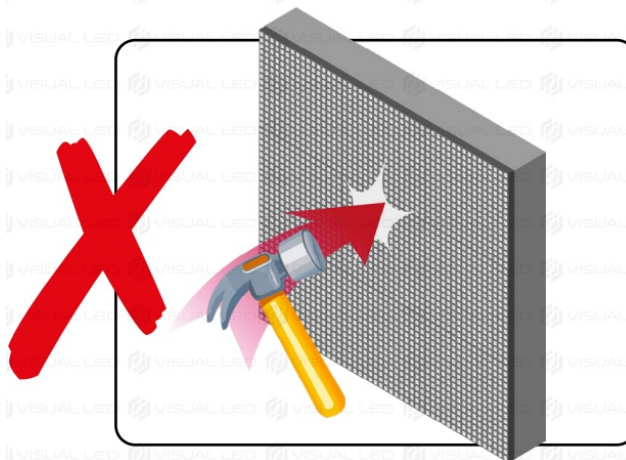

- LED PANELS ARE EXTREMELY SENSITIVE ELEMENTS. DURING DISPLAY ASSEMBLY, EXTREME CARE MUST BE TAKEN TO AVOID DAMAGING THE LEDS.

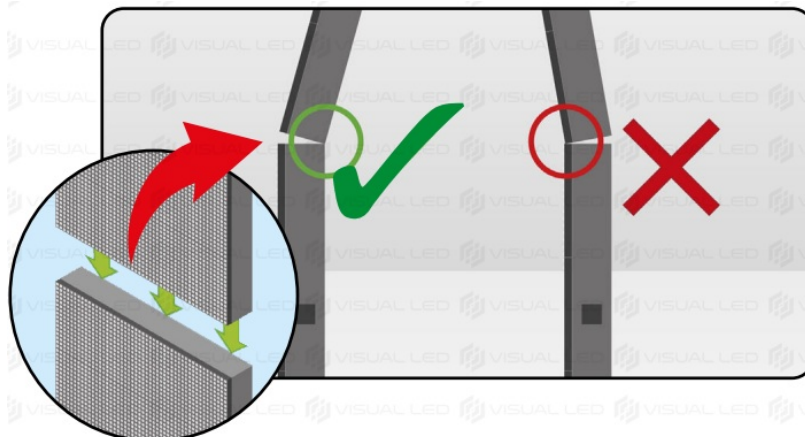

- **CAUTION:** CHOOSE A PERFECTLY LEVEL SURFACE OR STRUCTURE TO ASSEMBLE THE SCREEN ON

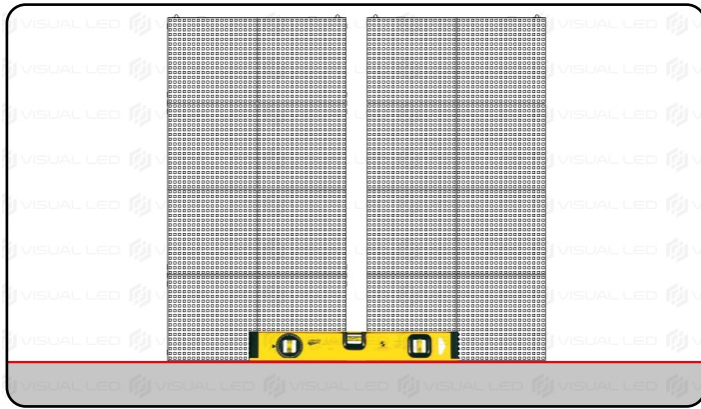

- **IMPORTANT: BE SURE TO ORIENTATE THE CABINETS CORRECTLY.**

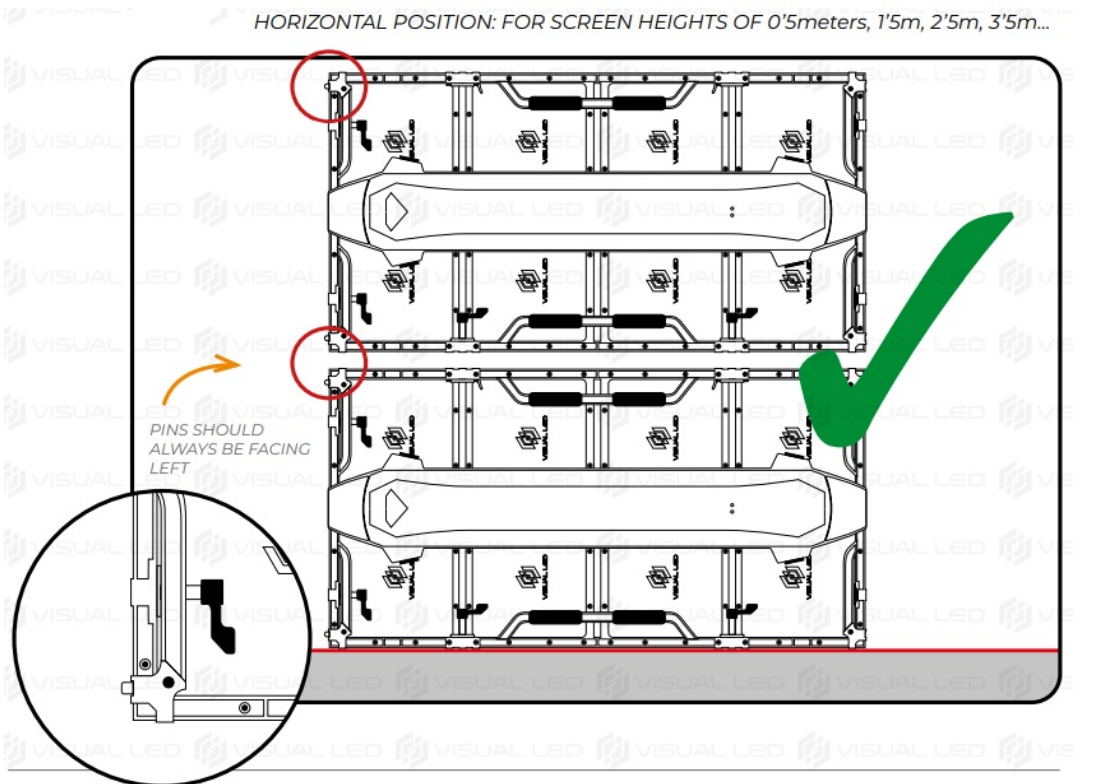
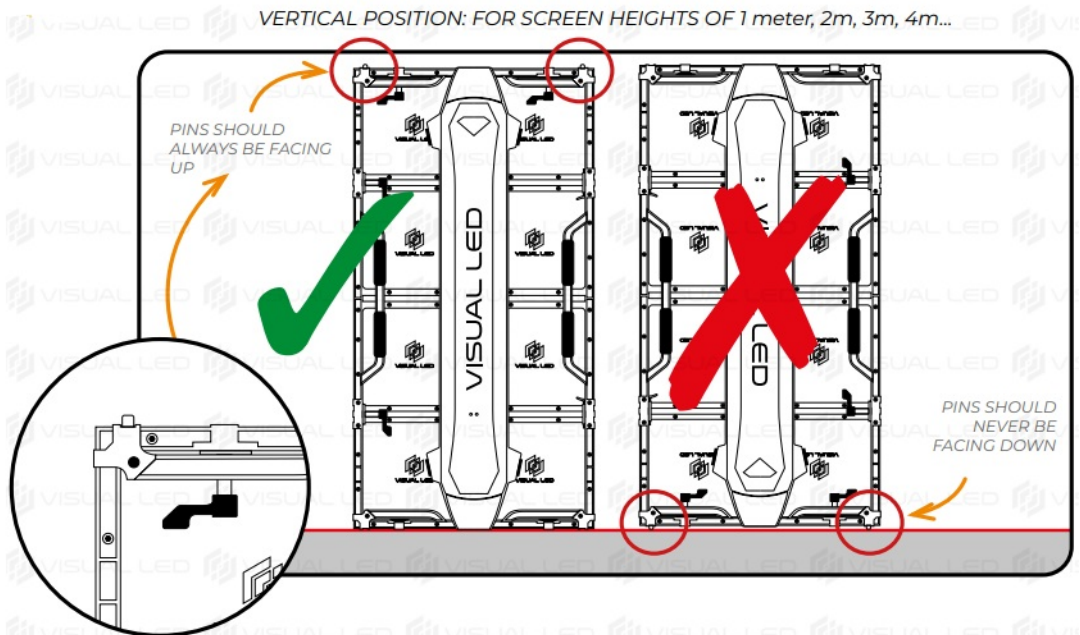

STEP 2: DISPLAY ASSEMBLY

CABINET LOCKING MECHANISMS:

1. SET ONE CABINET OVER ANOTHER.

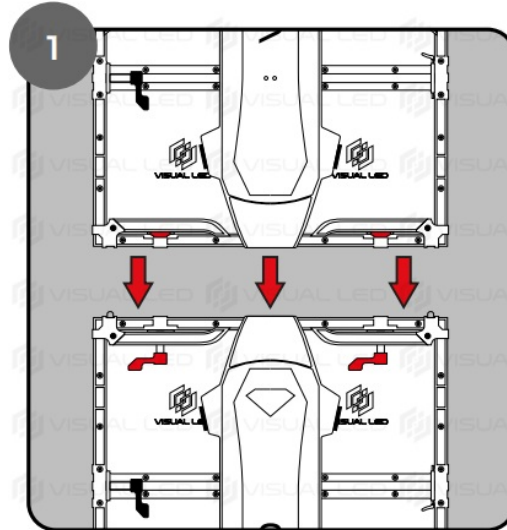

2. PRESS LEVERS FROM THE UPPER CABINET AND INSERT MECHANISMS FROM THE LOWER FRAME.

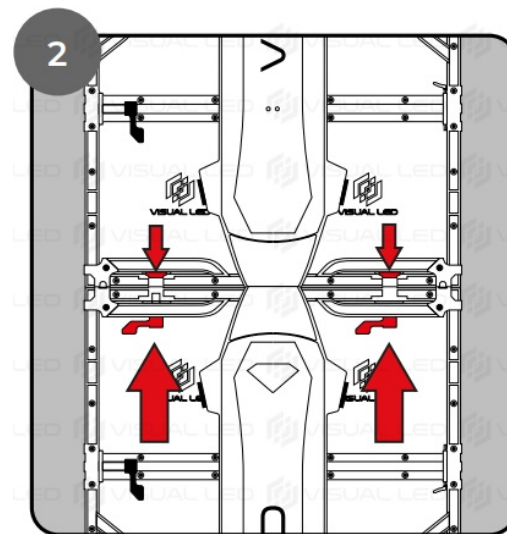

3. RELEASE UPPER LEVERS WITH MECHANISMS INSERTED

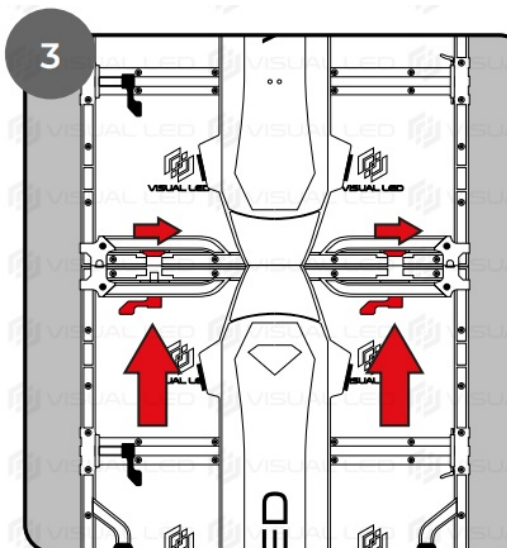

4. LOCK MECHANISMS FROM THE LOWER FRAME. REPEAT THIS PROCEDURE FOR THE SIDE ANCHORAGES IF NECESSARY.

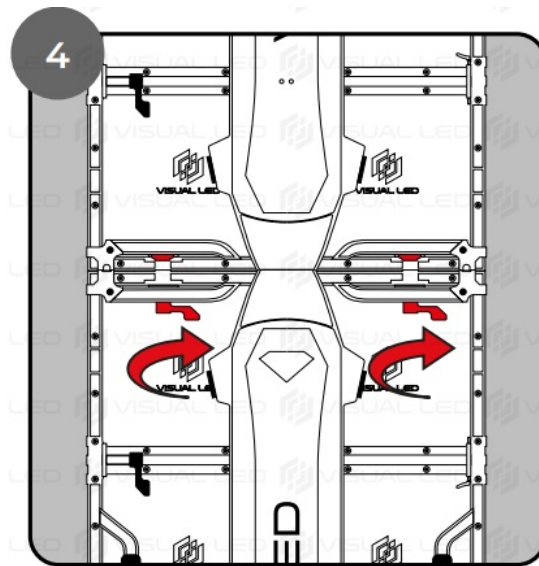

NOTE: IF A FRAME LOCKING MECHANISM DOES NOT APPLY TIGHTENING FORCE BETWEEN THE CABINETS WHEN IT'S ENGAGED, USE THE MECHANISM'S ADJUSTMENT SCREW.

ADJUSTMENT SCREW

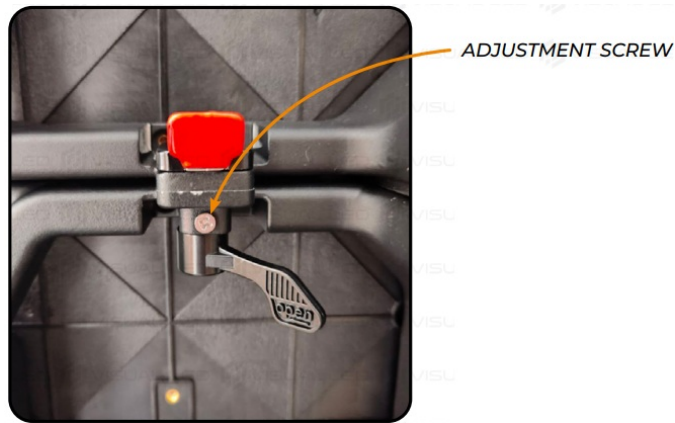

1. WITH THE MECHANISM OPEN LOOSEN THE ADJUSTMENT SCREW WITHOUT REMOVING IT COMPLETELY.
2. MOVE THE LEVER TO ITS OPEN POSITION AS FAR AS POSSIBLE AND TIGHTEN THE SCREW.
3. NOW INSERT THE MECHANISM AND CLOSE IT. CHECK THAT WHEN CLOSING THE LOCK MECHANISM IT IS APPLYING FORCE AND TIGHTENING THE 2 FRAMES.

STEP 3: WIRING OF THE LED DISPLAY

1. DATA WIRING

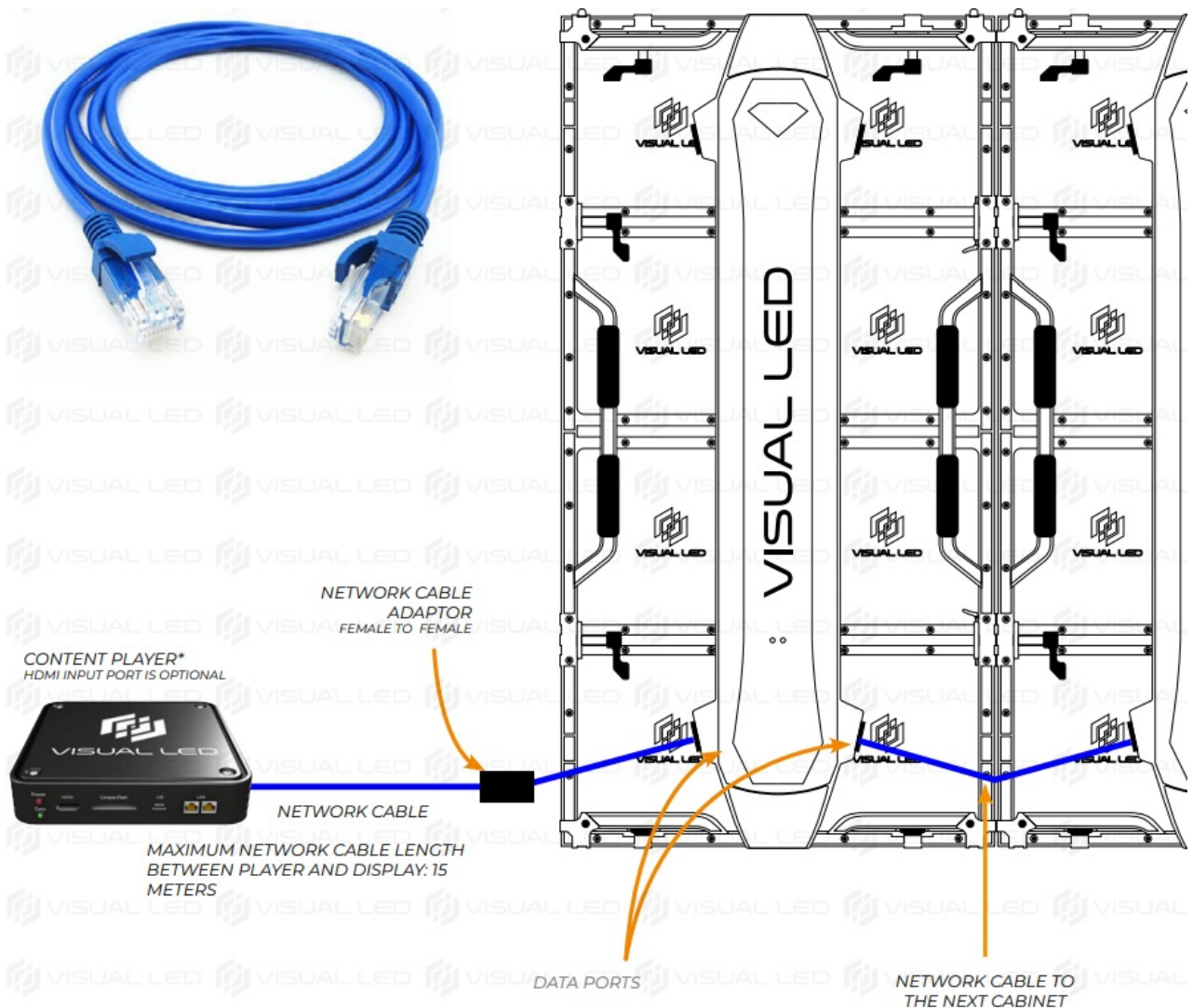

THE CABINETS MUST BE INTERCONNECTED IN SERIES WITH THE NETWORK CABLES. EACH FRAME HAS 2 NETWORK PORTS.

STANDARD NETWORK CABLE CAN BE USED TO MAKE THE CONNECTIONS.

2. POWER WIRING

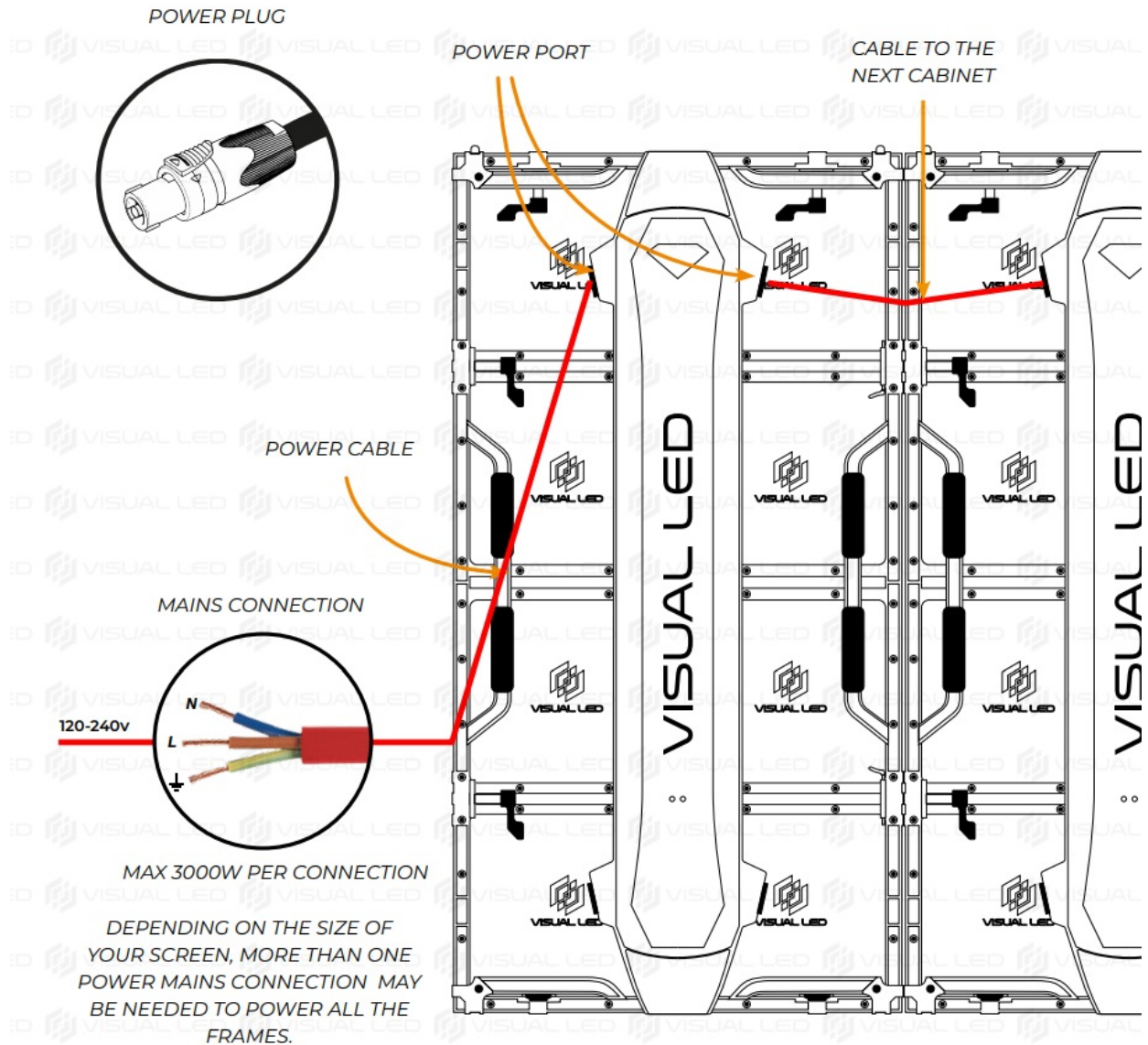

CAUTION: INTERCONNECT THE CABINETS OF YOUR DISPLAY WITH THE SUPPLIED POWER CABLES. DO NOT DRAW MORE THAN 3000W FROM THE SAME CONNECTION.

EACH FRAME HAS 2 POWER PORTS

3. MAINS CONNECTION

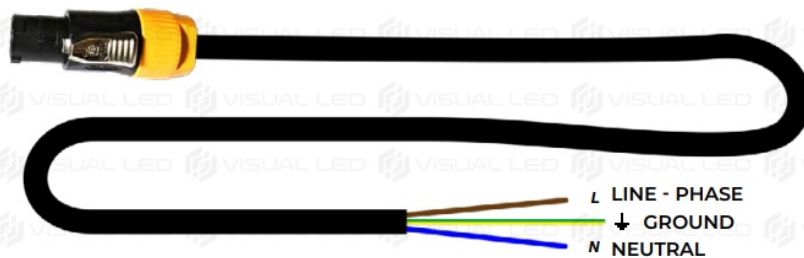

4. LEDS INDICATORS

IMPORTANT: ALL CABINETS HAVE 2 INDICATOR LEDS ON THE REAR SIDE PROVIDING INFORMATION CODES ABOUT THE SCREEN STATUS

COLOR	FUNCTION	STATUS	DESCRIPTION
RED	Power LED	Always ON	Power supply is normal
		Other	ready for configuration
Green	DATA LED	2 flashes every second	Cabinet with correct data connection ready to function normally
		1 flash every 3 seconds	Ethernet cable connection is abnormal
		3 Flashes every second	cable connection is normal, but no video source input is available
		5 flashes every second	cabinet failed to load program. Using backup program
		Other	ready for configuration

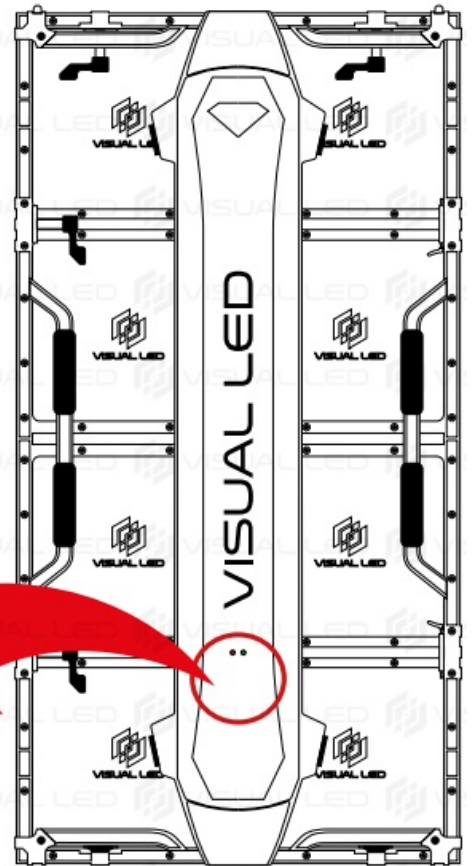
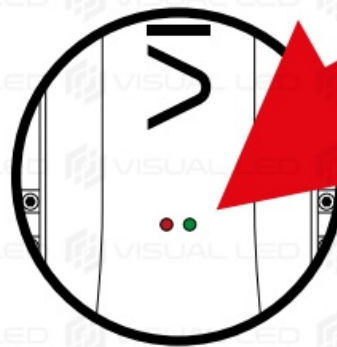

- **END OF ASSEMBLY PROCESS:**

ONCE YOU HACE COMPLETED THE WIRING YOU CAN PROCEED WITH THE DISPLAY STARTUP & SETUP PROCEDURE

CHANGING AN LED MODULE

LED SCREENS ARE MADE UP OF “CABINETS” OR FRAMES. EACH CABINET CONTAINS SEVERAL LED MODULES

1. STEP 1: UNSCREW LED MODULE

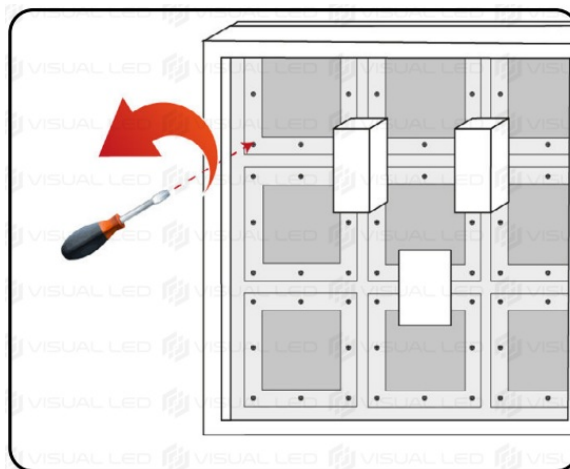

2. STEP 2: LED MODULE EXTRACTION

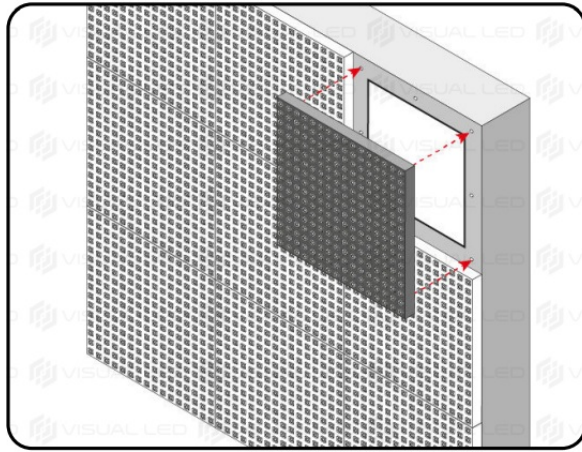

NOTE: TO REMOVE THE AFFECTED MODULE FROM THE DISPLAY ARM FOLLOW THE STEPS OUTLINED AT THE END OF THIS MANUAL

CONNECTING WIRES

1. UNSCREW THE LED MODULE FROM THE CABINET.



2. DISCONNECT THE LED MODULE CABLES TO SEPARATE IT FROM THE CABINET

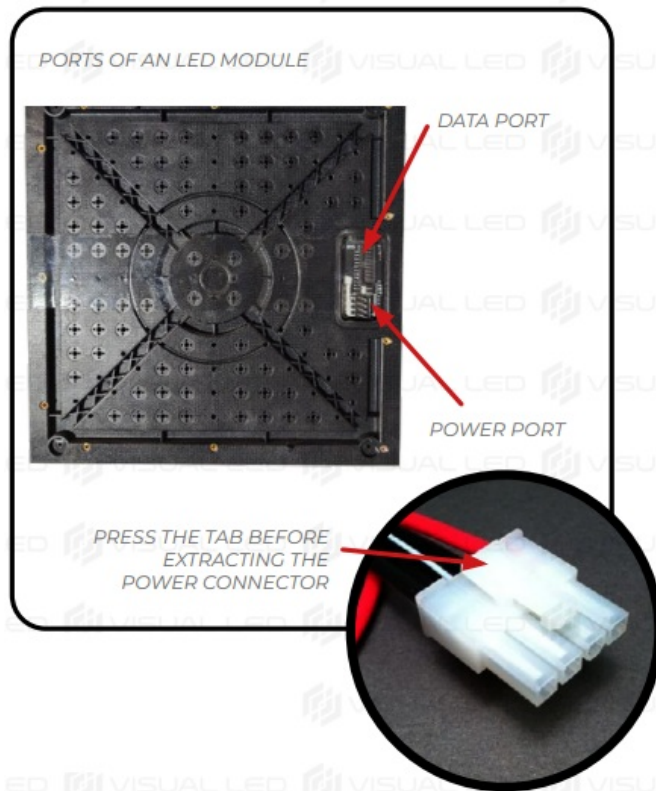

WARNING: LED MODULES ARE DIFFERENT FOR EACH SIDE (LEFT-HAND SIDE OR RIGHT-HAND SIDE)

3. IDENTIFY THE HAND OF A LED MODULE

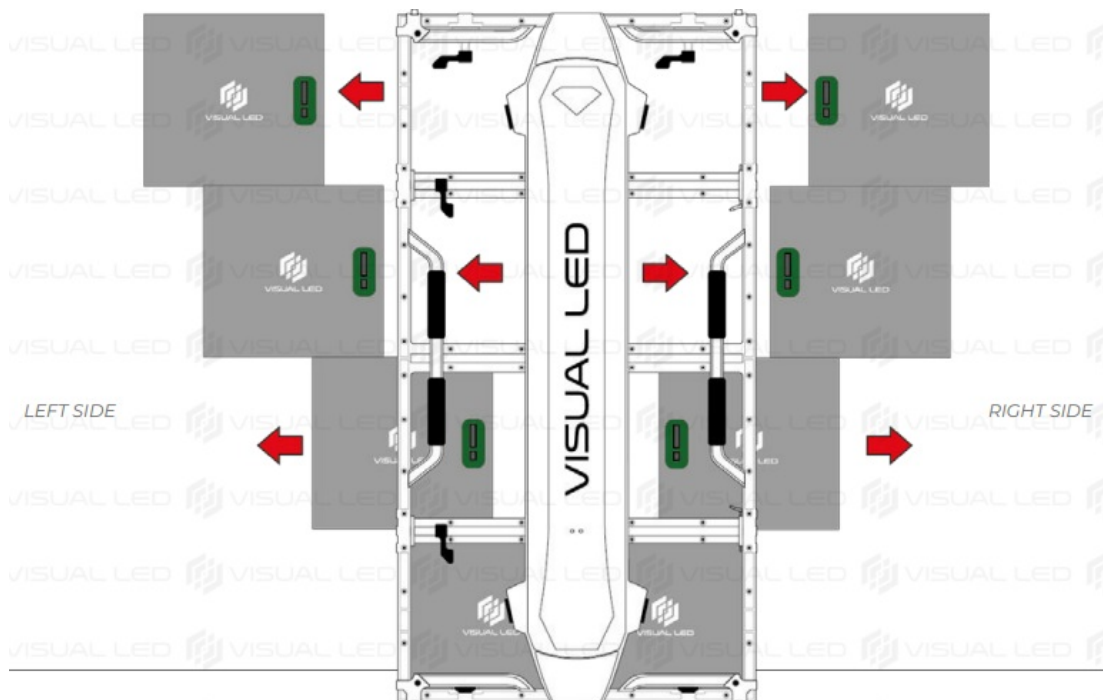

Documents / Resources

	<p>VISUAL LED 500X1000MM Modular LED Display [pdf] Instruction Manual 500 X 1000MM, 500 X 500MM, 500X1000MM Modular LED Display, Modular LED Display, LE D Display, Display</p>
--	---