



VISUAL COMFORT ESSWC-10 Wall Transmitter Installation Guide

[Home](#) » [VISUAL COMFORT](#) » VISUAL COMFORT ESSWC-10 Wall Transmitter Installation Guide 

Contents

- 1 VISUAL COMFORT ESSWC-10 Wall Transmitter Installation Guide
- 2 Wall Transmitter Installation and Wiring
- 3 Wall Transmitter Setting and operation
- 4 The fan will start to run and begin the control setting process. The fan will run in both directions for a total of approximately 3 minutes, then the fan will stop. The control and speed setting process is complete and the fan is ready for use.
- 5 REMOTE CONTROL SETTING and OPERATION
- 6 User Tips
- 7 Read More About This Manual & Download PDF:
- 8 Documents / Resources
 - 8.1 References

VISUAL COMFORT ESSWC-10 Wall Transmitter Installation Guide



SAFETY INFORMATION AND GENERAL GUIDE

READ AND SAVE THESE INSTRUCTIONS

- Please read and understand this entire manual before attempting to assemble, install or operate the product.
- Make sure that all electrical connections comply with local codes, ordinances, the National Electrical Code and ANSI/NFPA Hire a qualified electrician or consult a do-it-yourself wiring handbook if you are unfamiliar with installing electrical wiring.

Warning: Before proceeding, be sure to shut off electricity at main switch or circuit breaker in order to avoid electrical shock.

Note: Fan installation must be complete including assembly of blades before testing wall control unit.

Note: Refer to your Ceiling fan instruction manual for Safety and installation instruction. This wall controller is to be used for the control of ceiling fan and fan light only.

Warning: Do not exceed maximum rating of the wall transmitter. Install the wall transmitter away from excess heat or humidity

Wall Transmitter Installation and Wiring

Warning: Before proceeding, be sure to shut off electricity at main switch or circuit breaker in order to avoid electrical shock.

Note: Before installing the wall transmitter, place it in OFF position by pushing ON/OFF switch to the OFF.

Make series-wound connection for the wall transmitter with HOT wire from house. Connect a black wire from wall transmitter to the HOT wire and then connect the other wire of wall transmitter to the LOAD wire in outlet box (Follow the instruction shown on the labels on the lead wires from wall transmitter). Connect white wire from fan to white (neutral) wire from house.

Connect green grounded wire to grounded wire from outlet box.

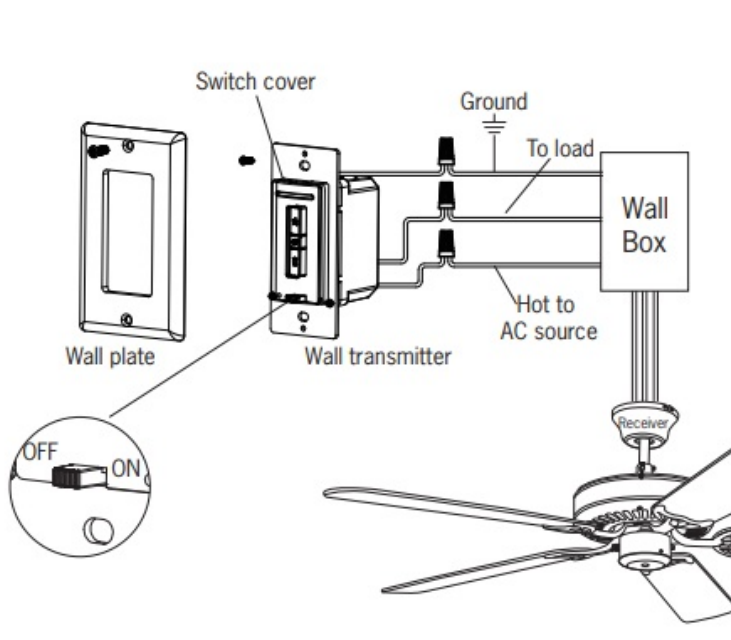

Install the wall transmitter to outlet box using machine screws provided.

Attach wall plate to wall control unit with screws provided.

Note: Place the wall transmitter in ON mode when fan installation is completed for operation.

The switch cover and wall plate can be replaced with almond covers provided. Remove the switch cover by a finger and snap the new one in place.

Wall Transmitter Setting and operation

Restore power to your fan to make learn function setting to pair the Transmitter and receiver, press and hold the "OFF" button for at least 5 seconds. You must press the 'OFF' button within 60 seconds of restoring power to the fan.

Important: Only turn the power on for the fan which you would pair with the transmitter and make sure to turn the power off for all other fans which use the same remote controller.

Note: If the fan is installed with light (down light), light will twinkle twice then off.

The fan will start to run and begin the control setting process. The fan will run in both directions for a total of approximately 3 minutes, then the fan will stop. The control and speed setting process is complete and the fan is ready for use.

Note: If the power is on already, you must turn the power off for at least 5 seconds, and then turn the power back for remote control setting.

Note: If you want to control the fan with another hand-held transmitter, make the same setting. A fan can be controlled by 2 transmitters maximum.

The fan will again start to run control setting process when you make learn function setting for the second transmitter. You may keep this setting process or you may finish the setting process by turning the power off and turning power back.

Note: If use 2 wall-mounted transmitters, they have to be wire with series wound. Recommend handling by an electrician.

Note: If you press wrong buttons, you must again turn power off and turn the power back then reset learn function.

REMOTE CONTROL SETTING and OPERATION

The buttons on the remote control transmitter control the fan speed and light as follows.

Press the button to get desired fan speed, Low to High and then High to Low cyclically.

Press the OFF button to turn fan off. Fan speed will maintain last setting if turned off.

Press this forward/reverse button to get desired airflow direction. Fan must be running to reverse. It will take about 25 seconds for fan to slow down and change rotation direction.

Light control button. Press this button quickly to turn light on or off. To dim light, hold down the button, the light will

cycle from bright to dim to bright until button is released (when the controller is set in dimming mode). Light will maintain last setting if turned off. **Refer to page 4 for dimming, non-dimming setting.**

Note: Dimming function is not available if the controller is set at non-dimming mode.

User Tips

1. If your fan is operating automatically after installation, it is still using the factory Follow the settings for Learn Mode above to reset.
2. If the fan or light isn't working, reset power (turn the power off then turn the power back on) and follow the Universal Mode or Learn Mode remote control settings.
3. If two or more fans in the same remote signal range are on the same power supply, they cannot be operated separately by remote Use a separate power supply for each fan, such as an individual wall switch, and restrict the power supply to only the fan which you are pairing with its transmitter in order to use the remote controller.
4. When the fan is turned on to oscillate in either forward or reverse direction, it may shudder briefly until fully engaged. This is a normal operation for this fan; the shuddering will quickly cease as movement is
5. There might be other remote transmitters got the same code combination as the transmitter that you are using, you may remove the code setting of the other transmitters by turn the power off and turn it back and then push and hold the "OFF" button of the transmitter which you are using for at least 10 You must press the 'OFF" button within 60 seconds of restoring power to the fan.

REMOTE CONTROL SETTING (Dimming/Non Dimming)

Dimming, Non-Dimming Setting

The remote controller is set with dimming function at factory.

If you would make the light with on/off feature (non-dimmable). Set the fan at third speed (medium low speed), press "OFF" and "Light" buttons at the same time for more than 3 seconds. It has to be handled with fan/receiver power on. Operate the same process may switch it back to dimming function and vice versa.

In the dimming mold, it is light dimmable selection and it is to be used with dimmable luminaries. Press and hold the button to dim the light. The light will cycle from bright to dim to bright until button is released. Light will maintain the last setting if turned off. Press and release the button quickly may turn light on/off.

In on/off (non-dimming mold), it is for light ON/OFF only (non-dimming function). **OFF ON**

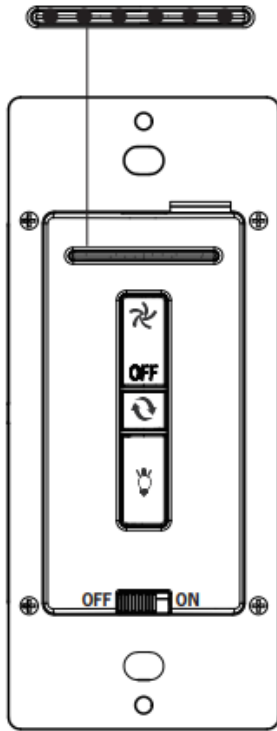

THIS DEVICE COMPLIES WITH PART 15 OF THE FCC RULES OPERATION IS SUBJECT TO THE FOLLOWING TWO CONDITIONS. (1)THIS DEVICE MAY NOT CAUSE HARMFUL INTERFERENCE AND (2) THIS DEVICE MUST ACCEPT ANY INTERFERENCE RECEIVED, INCLUDING INTERFERENCE THAT MAY CAUSE UNDESIED OPERATION.

Read More About This Manual & Download PDF:

Documents / Resources

	<p>VISUAL COMFORT ESSWC-10 Wall Transmitter [pdf] Installation Guide ESSWC-10-CUL-ENG, ESSWC-10 Wall Transmitter, ESSWC-10, Wall Transmitter, Transmitter</p>
---	---

References

- [vc Signature Designer Light Fixtures | Experience Visual Comfort & Co.](#)
- [User Manual](#)

[Manuals+](#), [Privacy Policy](#)

This website is an independent publication and is neither affiliated with nor endorsed by any of the trademark owners. The "Bluetooth®" word mark and logos are registered trademarks owned by Bluetooth SIG, Inc. The "Wi-Fi®" word mark and logos are registered trademarks owned by the Wi-Fi Alliance. Any use of these marks on this website does not imply any affiliation with or endorsement.