

VisionTek®
VS627
Smart
Projector



VisionTek VS627 Smart Projector User Manual

[Home](#) » [VisionTek](#) » VisionTek VS627 Smart Projector User Manual 

Contents

- 1 [VisionTek VS627 Smart Projector](#)
- 2 [PACKING LIST](#)
- 3 [FUNCTION OVERVIEW](#)
- 4 [REMOTE CONTROL](#)
- 5 [Quick Start](#)
- 6 [Specifications](#)
- 7 [SETTINGS](#)
- 8 [TROUBLESHOOTING GUIDE](#)
- 9 [FCC STATEMENT](#)
- 10 [Documents / Resources](#)
 - 10.1 [References](#)
- 11 [Related Posts](#)

VisionTek®

VisionTek VS627 Smart Projector



This User Manual is important to you. Please read it before using your projector.

PACKING LIST

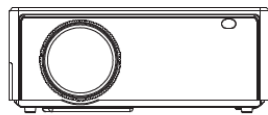

PROJECTOR



Remote



User Manual



AV Cable



HDMI Cable



Power Cable

CAUTION: TO REDUCE THE RISK OF ELECTRIC SHOCK, DO NOT REMOVE COVER (OR BACK) NO USER-SERVICEABLE PARTS INSIDE REFER SERVICING TO QUALIFIED SERVICE PERSONNEL.

WARNING:  DO NOT LOOK DIRECTLY THE LENS WHEN THE PROJECTOR IS IN THE POWER ON MODE.

NOTICE:

Recommended

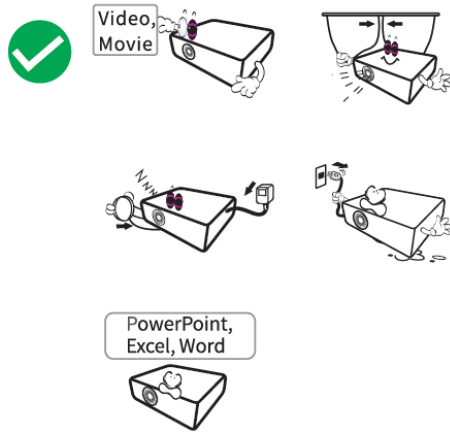

NOT Recommended

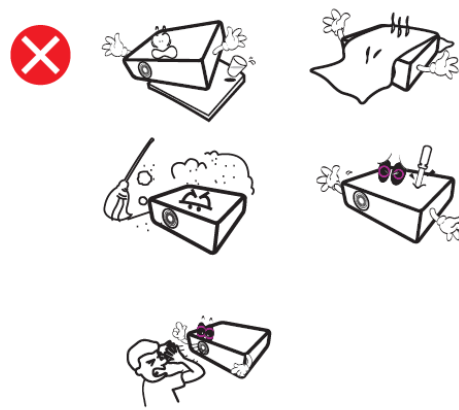

FUNCTION OVERVIEW

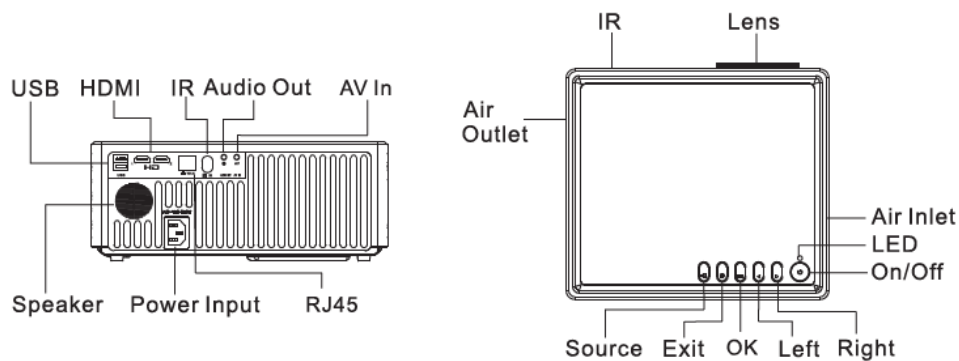

REMOTE CONTROL

- **Power:** Power on/off the projector Source: Select input signal
- **OK:** Confirm the setting or enter sub-menu 4 7 4 / Select desired menu times and make adjustments
- **Homepage:** Jump to the homepage directly
- **Exit:** Exit and save menu setting
- **Menu:** Enter menu or go back to previous item
- **VOL:** Adjust the volume
- **Focus +/-:** Adjust the focus when the image is
- **blurrySettings:** Go to the system settings.

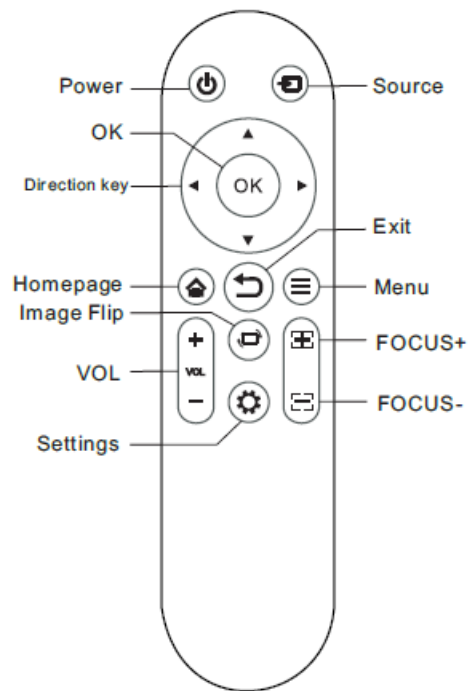

Quick Start

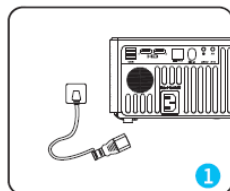

1 Plug the power cord into an outlet.

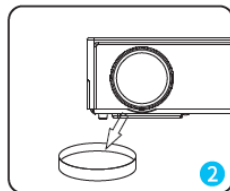

2 Take off the lens cover.

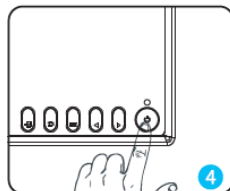

4 Press power button to turn on the projector.

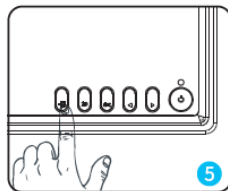

5 Select the correct input source to project your device.

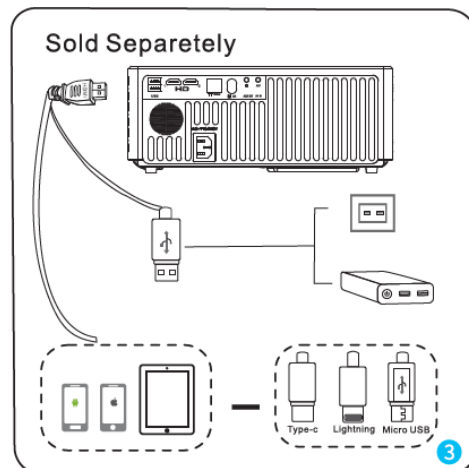

3 Connect your device to the projector correctly.

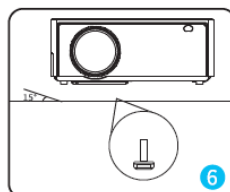

6 Adjust the kickstand accordingly.



7 Press Focus +/- to adjust the clarity of the pictures on the Remote control

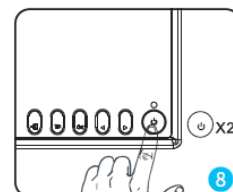

8 Press the power button twice to turn off the projector.

PROJECTOR CONNECTION

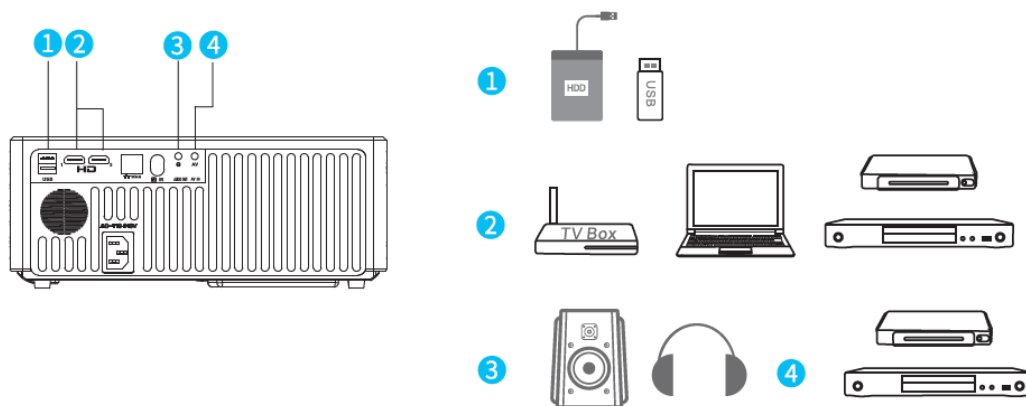

INPUT SOURCE

Press  on the projector or **S** on the remote to enter the interface of Input Source. Select signal input by using Direction key. Press OK to confirm. Insert USB disk or corresponding signal input cable.

A. Multimedia Connection

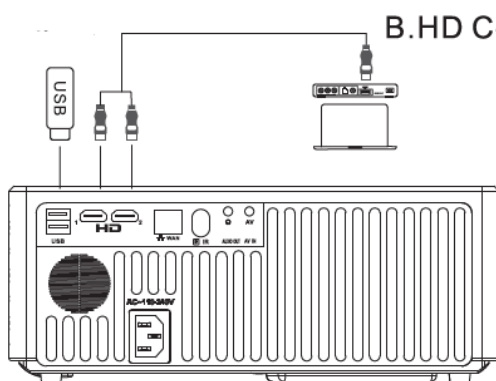

B.HD Connection



Specifications

Feature	Details
Display Technology	LCD
Light Source	LED
Installation Type	Front table, Front ceiling, Rear table, Rear ceiling
Vertical Correction	-50 to 50
Horizontal Correction	-50 to 50
Focus	Manual
Keystone Correction	Electronic
Speaker	5W / 4 ohm
Power Supply	AC 110-240V, 50/60Hz
Dimensions (L x W x H)	290 x 255 x 110 mm (11.4 x 10 x 4.3 in)
Net Weight	2.8 kg (6.17 lb)
Supported Photo Formats	BMP, JPG, PNG, JPEG
Supported Audio Formats	AAC, MAV, OGG, MP2, M4A, FLAC, AMR, MPGA
Supported Video Formats	AVI, MP4, MKV, MOV, MPG, VOB, MPEG2, H.264, MPEG1, TS, TP, DIVX5
Ports	HDMI in x2, USB 2.0 x2, AV in x1, Audio out x1

SETTINGS

Press  key on remote or move cursor to settings and press OK to enter.

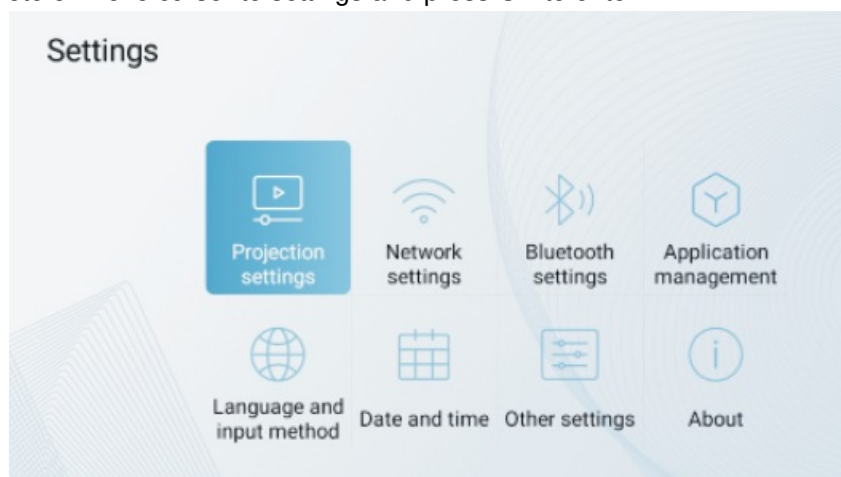

Projection settings: Change the projection mode according projector installation way. Zoom in/out the images in the range of 50% to 100%.

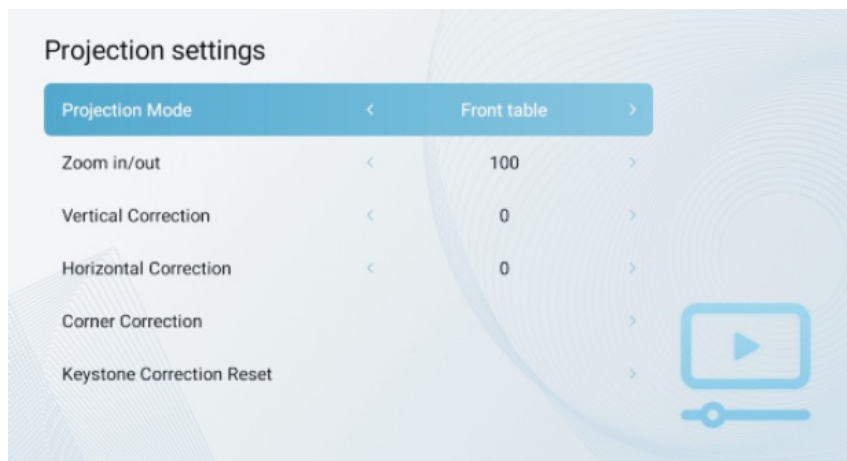

Correct the images in horizontal/vertical direction or from four corners.

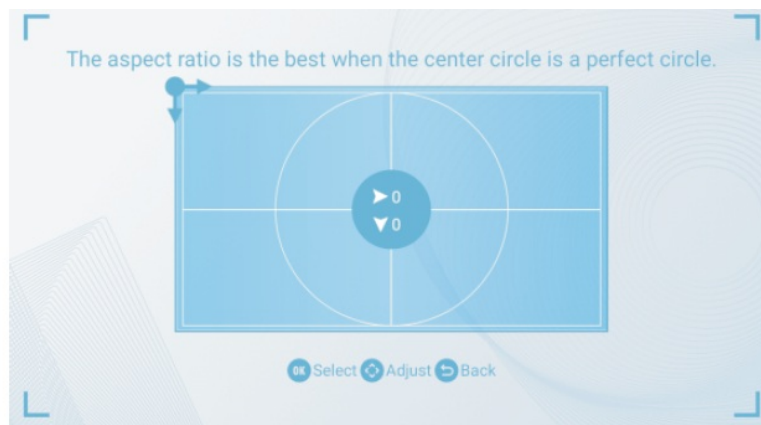

Network settings: Projector searches connectable network automatically when Wifi is turned on. Select desired Wifi. Input correct password to connect. The same Wifi will be connected spontaneously when power on the projector next time if keep Wifi switch on as projector shutdown.



Bluetooth settings: Projector searches connectable Bluetooth automatically when BT switch turned on. Select desired device to connect by pressing OK button. pressing OK. The same BT device will be connected spontaneously when power on the projector next time if keep BT switch on as projector shutdown.

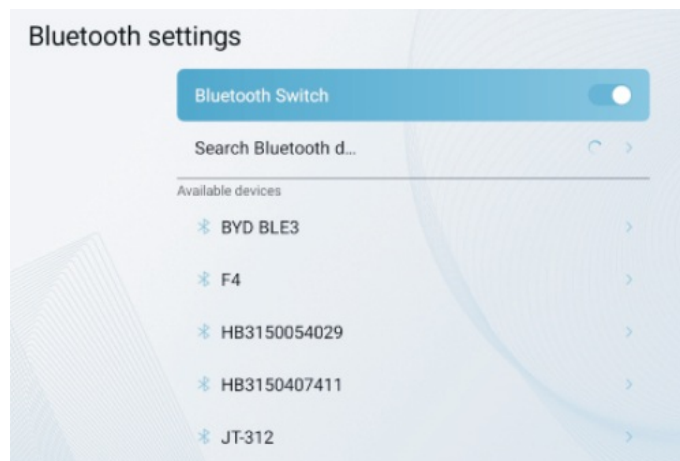

PROJECTION DISTANCE & SIZE

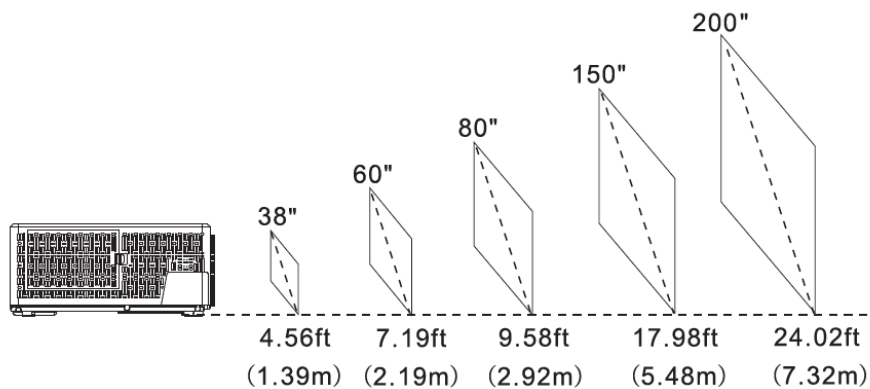

The recommended projection screen is around 80 inches with a projection distance of around 9.58ft. Ambient darkness will improve the clarity of the projected images.

TROUBLESHOOTING GUIDE

1. Blurry Image

Adjust focus ring/keystone.

Project and screen/wall must be in effective distance.

2. Remote Unresponsive

Make sure remote points at IR receiver directly.

Do not cover IR receiver.

Try a new pair of AAA batteries.

3. Mobile Connection

iOS: Genuine lightning to HDMI cable.

Android: Micro USB to HDMI adapter/Type C to HDMI cable.

4. Up Side Down Images

Enter "Image flip" on remote to flip the projector image.

FCC STATEMENT

FCC Caution.

This device complies with part 15 of the FCC Rules. Operation is subject to the following two conditions:

1. This device may not cause harmful interference, and
2. this device must accept any interference received, including interference that may cause undesired operation.

Any Changes or modifications not expressly approved by the party responsible for compliance could void the user's authority to operate the equipment.

Note: This equipment has been tested and found to comply with the limits for a Class B digital device, pursuant to part 15 of the FCC Rules. These limits are designed to provide reasonable protection against harmful interference in a residential installation. This equipment generates uses and can radiate radio frequency energy and, if not installed and used in accordance with the instructions, may cause harmful interference to radio communications. However, there is no guarantee that interference will not occur in a particular installation. If this equipment does cause harmful interference to radio or television reception, which can be determined by turning the equipment off and on, the user is encouraged to try to correct the interference by one or more of the following measures:

- Reorient or relocate the receiving antenna.
- Increase the separation between the equipment and receiver.
- Connect the equipment into an outlet on a circuit different from that to which the receiver is connected.
- Consult the dealer or an experienced radio/TV technician for help.

RF warning

This equipment complies with FCC radiation exposure limits set forth for an uncontrolled environment. This equipment should be installed and operated with minimum distance 20cm between the radiator & your body.

Documents / Resources

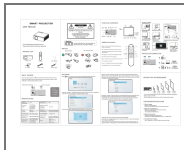

[VisionTek VS627 Smart Projector](#) [pdf] User Manual
VS627, VS627 Smart Projector, Smart Projector, Projector

References

- [User Manual](#)

[Manuals+](#), [Privacy Policy](#)

This website is an independent publication and is neither affiliated with nor endorsed by any of the trademark owners. The "Bluetooth®" word mark and logos are registered trademarks owned by Bluetooth SIG, Inc. The "Wi-Fi®" word mark and logos are registered trademarks owned by the Wi-Fi Alliance. Any use of these marks on this website does not imply any affiliation with or endorsement.