



VirtualFly Flight Simulation Composs User Manual

[Home](#) » [VirtualFly](#) » VirtualFly Flight Simulation Composs User Manual 



Flight Simulation Composs User Manual

Contents

- [1 IN THE BOX](#)
- [2 HARDWARE SETUP](#)
- [3 SOFTWARE SETUP](#)
- [4 Documents / Resources](#)
 - [4.1 References](#)
- [5 Related Posts](#)

IN THE BOX

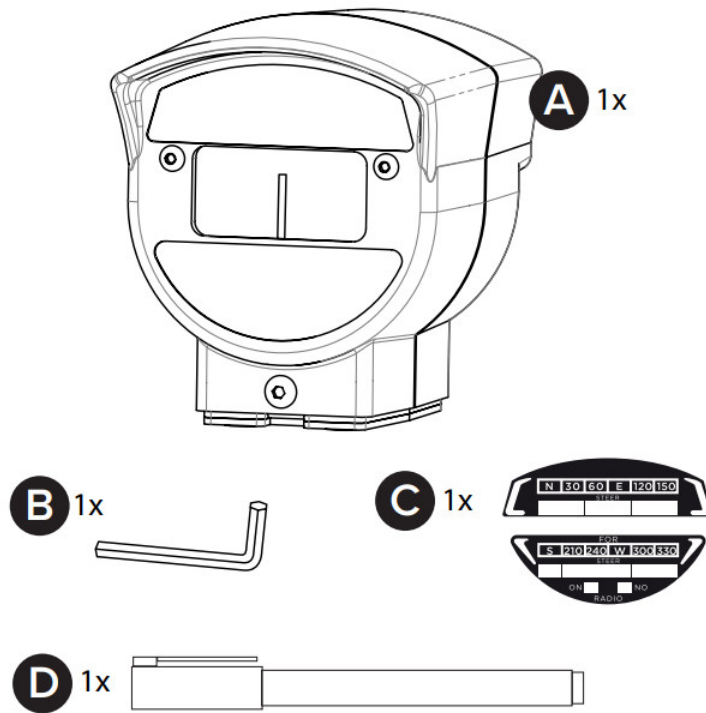

- A) COMPOSS
- B) Allen Key
- C) Replacement tags
- D) Fine tip marker

For support, contact us at support@virtual-fly.com

HARDWARE SETUP

2.1 ATTACHING TO DESKTOP/HOME COCKPIT SETUP

OPTION A: Mounting on Iron Surface

The COMPOSS has 4 magnets that make it very easy to attach to magnetic metal surfaces. Simply place the COMPOSS in its desired location.

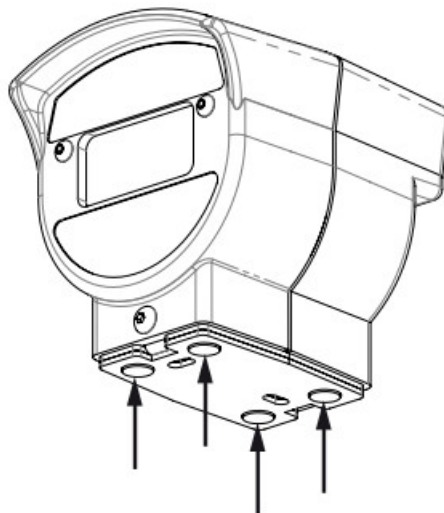

OPTION B: Mounting on non-magnetic surface

Two screws (not provided) or double sided tape (not provided) are needed to secure to mount the COMPOSS in a non-magnetic surface.

Unscrew both screws (a) indicated in the diagram below using the provided Allen key (B). Remove the bottom

plate of the COMPOSS and secure it to your non-magnetic surface using two additional screws. Reassemble the compass and its base plate with the two screws (a) previously removed.

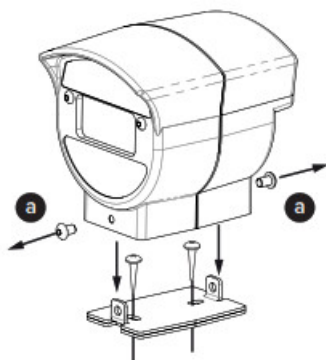

Alternatively, attach double-sided tape/velcro to the COMPOSS base to secure it to the non-magnetic surface.

2.2 CONNECTING TO PC

Connect the integrated USB cable from the COMPOSS to the computer where the flight simulation software is running.

2.3 ADJUSTEMENTS

FRONT LABELS

Aircraft may have an effect on the magnetic values of the COMPOSS. To account for these small errors, use the fine tip marker (D) to annotate the variations on the white region of the front labels.

For instance, data labels with error variations annotated might look like the example below. In this particular case, when the COMPOSS indicates 358, the aircraft is actually facing directly North (a heading of 360).

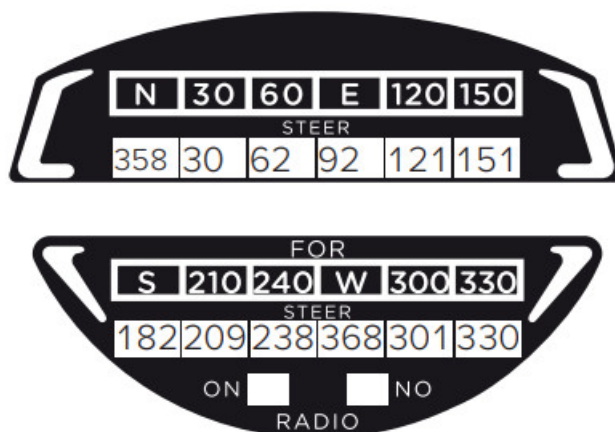

You also have a replacement set of labels (C) in case you decide to change the simulated aircraft.

BACKLIGHT



You can turn on/off the backlight of the COMPOSS as per convenience by pressing the button (a) behind it, indicated in the diagram below.

If you want to customize the backlight options of the COMPOSS works, select the device's options button () in VFHub's Dashboard. For detailed instructions on all the tuning and customization possibilities, check the USER's MANUAL button in the VFHub software.

Documents / Resources

	VirtualFly Flight Simulation Composs [pdf] User Manual Flight Simulation Composs, Simulation Composs, Flight Composs, Composs
---	--

References

-  [Cheap Flights: Flights Tickets, Airline Tickets, Search Flights | Fly.com us](#)
-  [Virtual Fly | Professional Flight Simulators and Controls](#)
-  [Flight Simulation Setup & Support | Virtual Fly](#)