



Virtual Technologies GC310006 LCD Touch AIO User Manual

[Home](#) » [Virtual Technologies](#) » Virtual Technologies GC310006 LCD Touch AIO User Manual 

Virtual Technologies GC310006 LCD Touch AIO User Manual

Contents

- [1 Use of Android System](#)
- [2 Introduction to Remote Controller](#)
- [3 Documents / Resources](#)
- [4 Related Posts](#)



Use of Android System

Switch from Computer System to Android System

1. Click “Homepage” key on remote control to switch to homepage between Android home page and OPS channel, as shown in figure below:



Homepage of Android System

2. Or press “” button on keyboard to switch to homepage between Android home page and OPS channel.
3. Floating menu is as shown in figure below. Touch the “” key in floating menu to open the homepage between Android home page and OPS channel.

Switch from Homepage between Android home page and OPS channel

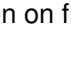
1. Click “Homepage” button of remote control at homepage between Android home page and OPS channel, or touch “OPS” on homepage using pen or hands to realize the switch.
2. Click “” button on front panel at homepage between Android home page and OPS channel.

Android System Setting

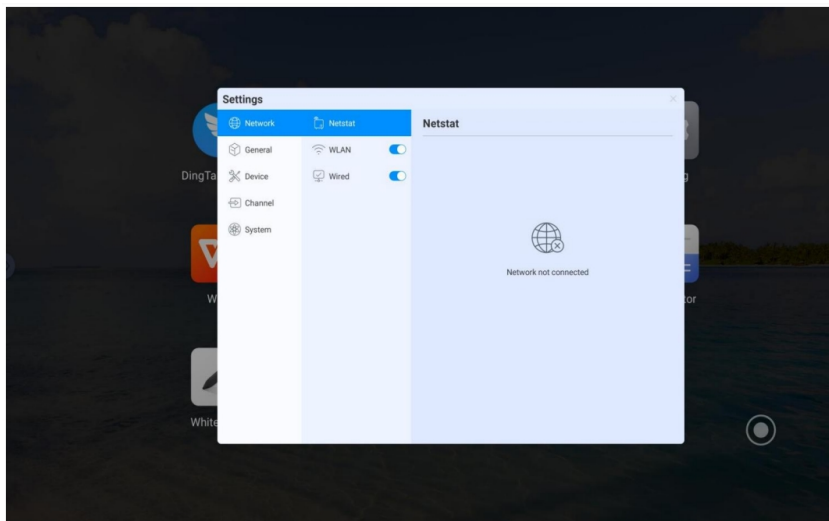

Introduction to Remote Controller

(Product images are for illustrative purposes only and may differ from the actual product)

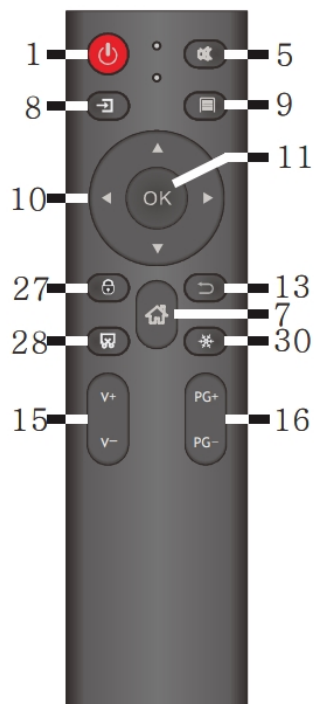
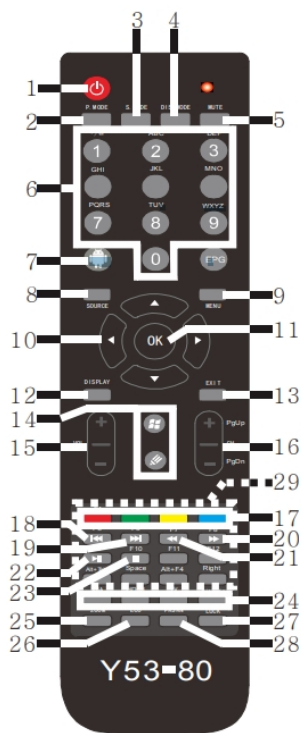

1. **Power (standby key):** press this key to enter the mode of startup or standby.
2. **Picture mode:** press picture mode key to have circular switch between picture modes of “ Standard, soft, user and bright”.
3. **Sound mode:** press this key to circular switch of sounds between standard, music, movie, sport and user.
4. **Display mode:** press this key to have circular switch of picture scale between: auto, 4:3 , 16:9 , zoom 1, zoom 2, full screen, nonlinear and pointto-point.
5. **Mute:** press mute key to enter mute mode.The mute mark is shown at upper left corner of screen. Press this key again to release mute state and the mark on screen will disappear.
6. **Figure:** it is valid under TV signal source only and used for receiving TV channel, or inputting figure in corresponding menus.
7. **Homepage:** press this key to switch from WINDOWS to homepage of Android.

8. **Signal source:** press this key to pop up list of signal source; press UP and Down arrow to switch the input signal sources, including TV, analogue TV, component, computer, HDMI 1, HDMI 2, built-in computer, Android and video.
9. **Menu:** press this key in all modes to display the overall setting options.
10. **Direction key:** press UDLR (Up, Down, Left, Right) key to adjust or select menu options.
11. **OK key:** press this key to confirm certain option.
12. **Display:** press this key to display the resolution of present signal source.
13. **Exit:** press this key to exit present menu.
14. Windows/Whiteboard function key.
15. **Volume:** Press Volume(+)/(-) to adjust volume.
Press this key under mute mode to release mute state.
16. Press this key to switch channel, or page up/down.
17. **Color key:** to have prompt function in menu of digital TV.
18. Press this key to enter the previous directory or play the previous song.
19. Press this key to enter the next directory or play the next song.
20. Press this key to fast forward.
21. Press this key to rewind.
22. Press this key to play or pause program.
23. Press this key to stop play.
24. Channel shortcut key: to switch to corresponding channel by one key.
25. **Picture zoom:** press this key to zoom in or zoom out picture.
26. **ECO:** press this key to turn off screen brightness.
27. **LOCK:** press this key to lock screen, remote controller and functions of key.
28. **PRSRN:** Press this button to capture the screen and save.
29. F11/F22/Alt+Tab/Space/Alt+f4/Right, Press these keys to have corresponding functions under the signal source of OPS.
30. **Freeze:** Press this button to freeze the picture of current playing screen and continue to play audio.

Documents / Resources

	<p>Virtual Technologies GC310006 LCD Touch AIO [pdf] User Manual GC310006, 2A8H3-GC310006, 2A8H3GC310006, GC310006 LCD Touch AIO, LCD Touch AIO</p>
---	---