



Virtual Jeff PRO VJPML1 Audio Effects Processor User Guide

[Home](#) » [Virtual Jeff PRO](#) » Virtual Jeff PRO VJPML1 Audio Effects Processor User Guide 

Virtual Jeff^{PRO}

QUICK START GUIDE

v1.3 FOMOfx

Thank you for joining the whammy revolution with us. Virtual Jeff PRO™ is precision made and built like a tank. If you don't drown it in beer or crush it under a bus, it'll work with that precision for decades. Please get in touch with any problem (stuff happens!). We'll get you going asap with no corporate run-around. Please visit our website for a more detailed manual as well as helpful user videos on each topic.

Contents

- [1 INSTALL THE WHAMMY](#)
- [2 SET UP CONTROLLER](#)
- [3 MODES A & B](#)
- [4 V-CAPO](#)
- [5 PACKAGE CONTENTS](#)
- [6 VJP MOUNT ASSEMBLY](#)
- [7 CONTROLLER OVERVIEW](#)
- [8 SET UP CONTROLLER](#)
- [9 SET UP MINI-LINK](#)
- [10 CHARGING](#)
- [11 PLACEMENT](#)
- [12 INTERFERENCE](#)
- [13 MINI-UNK LED INDICATOR](#)
- [14 CONTROLLER PAIRING LED INDICATOR](#)
- [15 MINI-LINK OVERVIEW](#)
- [16 BELT MOUNT ASSEMBLY](#)
- [17 FCC STATEMENT](#)
- [18 IC STATEMENT](#)
- [19 DECLARATION OF CONFORMITY](#)
- [20 Documents / Resources](#)
- [21 Related Posts](#)

INSTALL THE WHAMMY

1. Follow the arrows to slide Virtual Jeff onto the Mount rails until it clicks
2. Find your preferred location by test fitting behind the bridge/tailpiece
3. Clean the guitar surface to remove oil, grime and polish 4. Remove the adhesive backing on the Mount and press down firmly into place for 10 seconds

SET UP CONTROLLER

1. Connect your guitar cable to INPUT and connect OUTPUT to your pedals or amp
2. Plug the 13ft (4m) data cable into Virtual Jeff and the 'Whammy IN' on the CONTROLLER
3. Connect the supplied power adapter to the CONTROLLER IMPORTANT: Don't move the whammy bar during power up – it's being tested to guarantee all is well.

MODES A & B

We use MODE A for regular bends and MODE B for wild and crazy stuff. 1. Use UP & DOWN buttons to change pitch settings for MODES A & B 2. Orange LEDs indicate the current settings in each Mode 3. Your settings are remembered after powering off

V-CAPO

When active, it's like a regular capo in both directions – capo higher AND lower. The whammy works as normal at all V-CAPO settings.

1. One orange LED will indicate the current setting from -24 to +12 half-steps

2. Use any UP & DOWN button to change the V-CAPO setting
3. Your V-CAPO setting is remembered after power off

More information on operational modes, as well as details on HOLD and BLEND functions, are in the detailed manual on our website.

PACKAGE CONTENTS

- Virtual Jeff PROT™
- FOM0fx CONTROLLER with w032
- 13ft (4m) data cable with 3.5mm RTS plugs
- 18' (0.5m) data cable with 3.5mm RTS plugs
- Can case
- User QuickStart Guide
- MINI-UNK transmitter
- Mount assembly (with an adhesive)
- Spare Mount
- Mount adapter
- 2 x spare adhesive strips
- Belt clip

VJP MOUNT ASSEMBLY

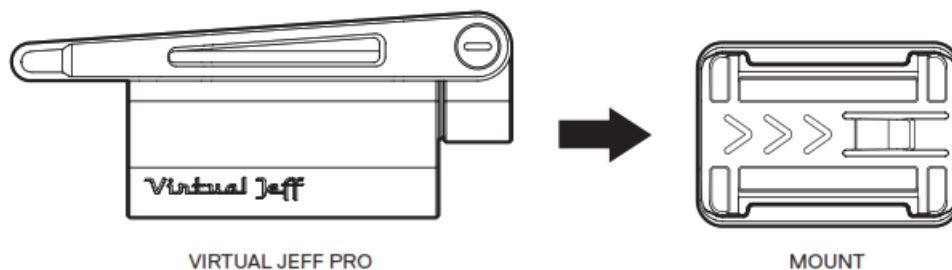

CONTROLLER OVERVIEW

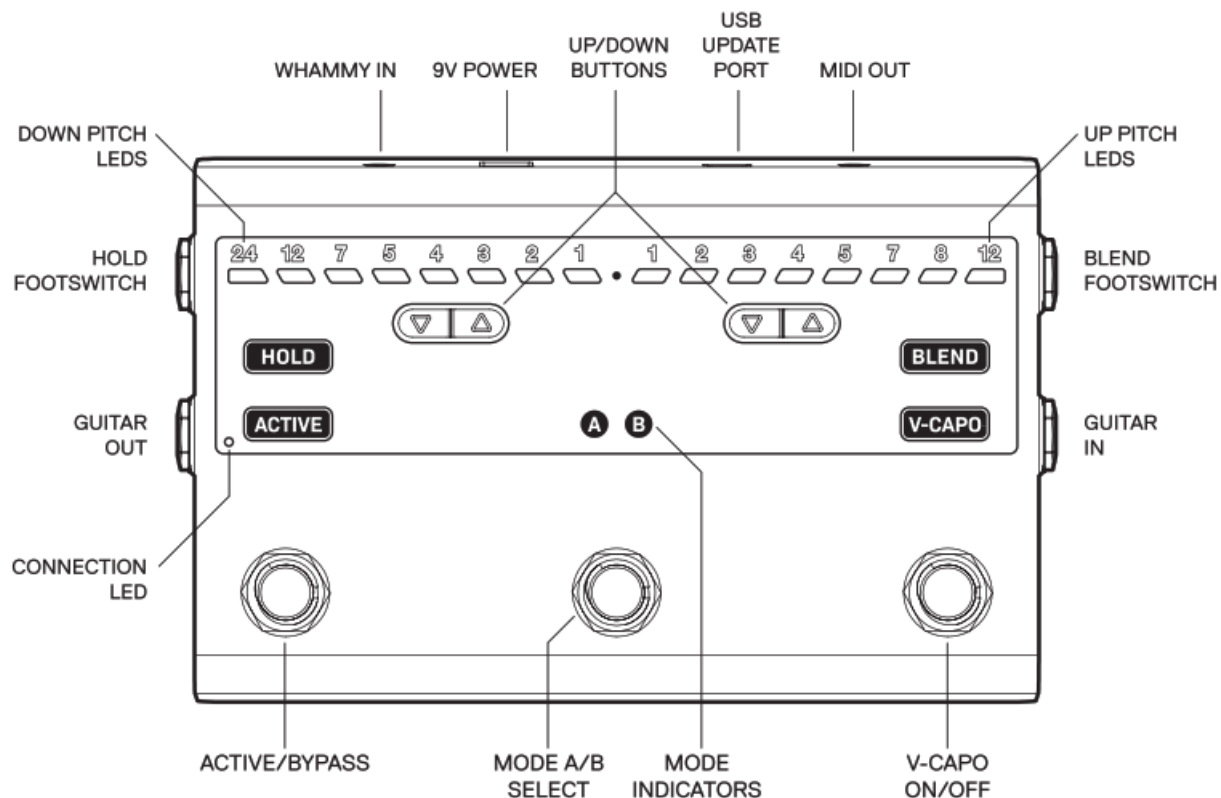

CAUTION

There are no user-serviceable parts inside the units. Do not open the units. Do not attempt to service the units yourself. Refer all servicing to qualified personnel. Opening the chassis of either unit for any reason will void the manufacturer's warranty. Do not allow the units to get wet. If the liquid is spilled on either unit, remove the power supply immediately and take both of them to a dealer for service. Do not use the equipment during electrical storms – remove the power supply for proper protection.

DISPOSAL

Do not expose this unit with household waste. There is a separate collection system for used electronic equipment in accordance with local legislation that requires proper treatment, recovery and recycling.

Within the EU and many other countries, used electronic equipment may be recycled free of charge to designated collection centers, or, retailers when a replacement product is purchased. Please 'do the right thing' to prevent further damage to the environment.

WARRANTY

Virtual Jeff PRO™ is a precision mechanism using patented technology. Please register online at www.fomox.com within 14 days of purchase. This will ensure all warranty provisions can be supported without delay. This warranty is valid only in the original country of purchase.

WARRANTY CONDITIONS

FOMOX wants Virtual Jeff to be free of defects in material and workmanship when purchased from an authorized dealer in your local country. This warranty applies only to the original purchaser.

FOMOX will repair or replace any defective materials provided the product is returned under a RETURN MERCHANDISE AUTHORIZATION issued by FOMOX or its authorized dealer in the country of purchase.

The warranty period is 24 months from the date of purchase. Reasonable Proof of Purchase must be provided to invoke this warranty.

Any unauthorized tampering, modification or opening of the units will invalidate this warranty. Similarly, any use outside the normal purpose or with a non-approved power supply will invalidate this warranty. Power supply approval is based on (1) the correct polarity of cabling/plug and (2) local regulatory approval of the power supply unit. Warranty service will be provided when the units are returned with the power supply used in operation. Postal, freight or shipping charges will be paid by the user to get the units to and from the service center.

FOMOX reserves the right to make changes or improvements to this product without any obligation to apply them to products manufactured or sold prior to those changes or improvements.

All of the foregoing is in lieu of any other warranties, expressed or implied, except where declared or implied by local consumer law.

Run wireless using MINI-LINK, our micro 2.4GHz transmitter. PRO-LINK will be available in the near future but we've included MINI-UNK so you can enjoy the fun of wireless now. It has extended battery life and an easy set-

up. MINI-LINK is great for practice or small gigs but not recommended for critical use or stadium gigs. That's PRO-LINK territory.

71P: If you're using a wireless link for your guitar (e.g. Line6 610 etc). we recommend getting it running first. and MINI-UNK will automatically avoid its channel(s).

SET UP CONTROLLER

Power up the CONTROLLER without a data cable. It defaults to Wireless Mode when there no data cable plugged in. The Connection red LED blinks while scanning for MINI-UNK and turns solid when connected. When playing, it blinks frequently if there's bad interference. Plug in a data cable at any time to change back to Wired Mode.

IMPORTANT: Don't move the whammy bar during changeover – it's checked when you change modes to make sure all is well

SET UP MINI-LINK

Connect MINI-UNK to the whammy with the 18- (0.5m) data cable BEFORE pressing the power button. To power ON. press & hold its power button for 2 seconds. It automatically connects with the nearest CONTROLLER in a few seconds. The blue LED flashes slowly at a low level during use.

CHARGING

MINI-UNK has extended battery life with 25-30 hours per charge. The blue LED will double flash when 10% charge remains. Standard chargers will fully charge MINI-LINK in 1 hour with normal 'micro-U58' cads The red LED will turn on while charging and turn off once completed.

PLACEMENT

MINI-LINK works best with line-of-sight to the CONTROLLER. Our favorite position is to put MINI-LINK in our front jeans pocket. It works well in that location and is very convenient when guitar swapping.

You can also use the spare Mount to attach it to the front of your guitar. Or use the spare Mount with the adapter plate and belt clip to fit it to your strap. It slides off the mount for charging.

CONTACT

www.fomofx.com

Email: support@fcmolx.COM

INTERFERENCE

WiFi/2.4GHz interference can be unpredictable. You can force a re-scan for clear channels: 1. Turn off MINI-LINK (Press and Hold the power button for 2 seconds) 2. Press & Hold the LEFT & RIGHT 'UP' buttons on the CONTROLLER until 4 orange LEDs on the right side light up. then 4 LEDs on the left side. This has forced a channel re-scan (the guitar signal isn't interrupted) 3. Turn MINI-UNK back on to re-connect

MINI-UNK LED INDICATOR

BLUE SLOW FLASH: Connected BLUE DOUBLE FLASH: Low battery SCUD RED: Charging

CONTROLLER PAIRING LED INDICATOR

RED FLASHING: Scanning for MINI-UNK SOLID RED: MINI-UNK is connected RANDOM FLASHING: Interference

This device emits <20mW of radiated RF power

MINI-LINK OVERVIEW

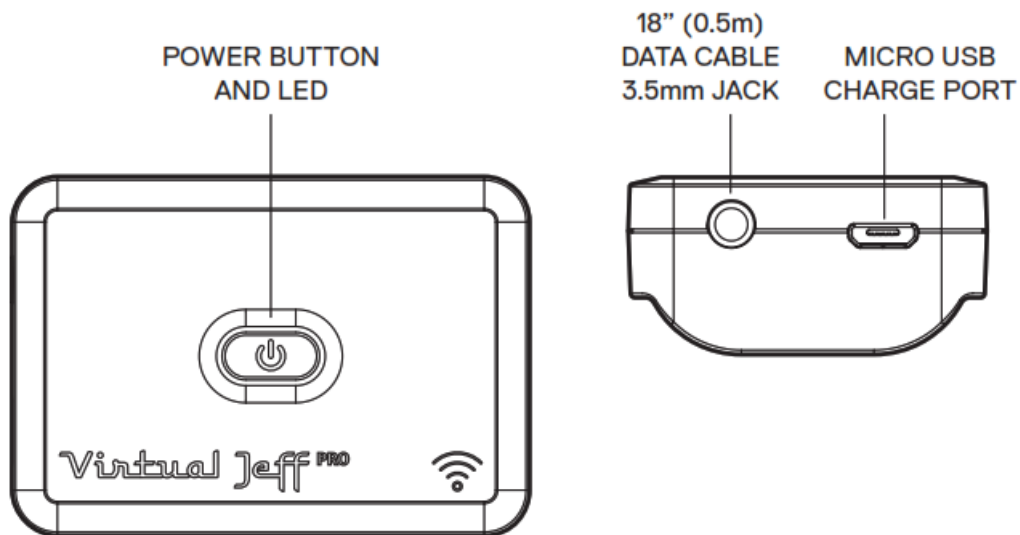

BELT MOUNT ASSEMBLY

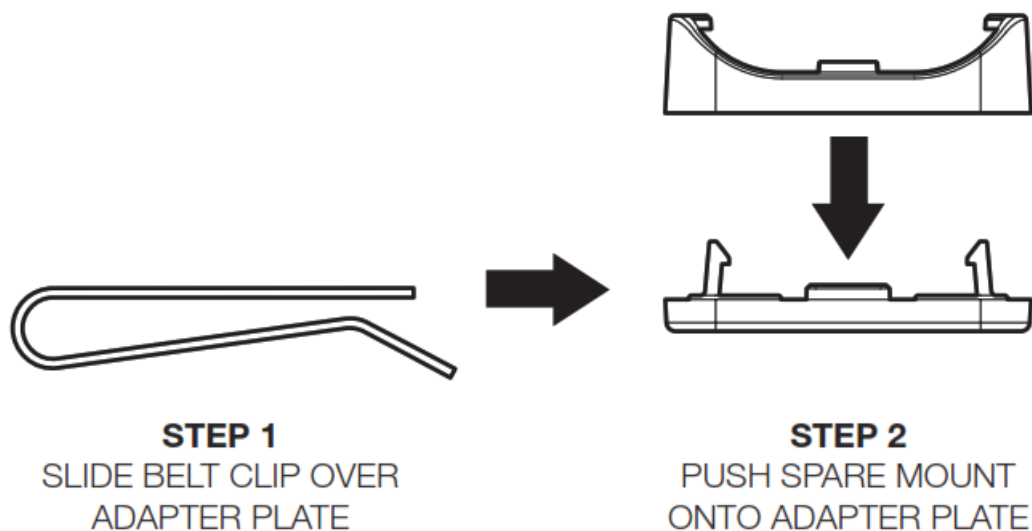

FCC STATEMENT

Note: This equipment has been tested and found to comply with the limits for a Class B digital device, pursuant to part 15 of the FCC Rules. These limits are designed to provide reasonable protection against harmful interference in a residential installation. This equipment generates, uses and can radiate radio frequency energy and if not installed and used in accordance with the instructions, may cause harmful interference to radio communications. However, there is no guarantee that interference will not occur in a particular installation. If this equipment does cause harmful interference to radio or television reception, it can be determined by turning the equipment off and on. The user is encouraged to try to correct the interference by one or more of the following measures:

- Reorient or relocate the receiving antenna.

- Increase the separation between the equipment and receiver.
- Connect the equipment into an outlet on a circuit different from that to which the receiver is connected.
- Consult the dealer or an experienced radio/ TV technician for help.

Shielded cables must be used with this unit to ensure compliance with the Class B FCC limits.

IC STATEMENT

This device contains license-exempt transmitter(s)/receiver(s) that comply with Innovation, Science, and Economic Development Canada's license-exempt RSS(s).

Operation is subject to the following two conditions: 1. This device may not cause interference. 2. This device must accept any interference, including interference that may cause undesired operation of the device.

Model: VJP_OI FCC ID: 2AYFZVJPM1 IC: 26801 -VJPM1 CAN ICES-3 (SyNNe-agin



DECLARATION OF CONFORMITY

We: FOMOfx Pty Ltd of 13 Station St Kogarah, NSW Australia 2217 in accordance with the following Directive(s) EMC Directive 2014/30/EU FCC CFR 47 Part 16, Subpart B hereby declare that the Product: VIRTUAL JEFF PRO Model: VJP_01, Serial Numbers: 01000- onwards is in conformity with the applicable standards: a) EN 61000-6-3 (emissions) b) EN 61000-6-1 (Immunity) c) CFR 47 Part 15. Sub-part Bd) IEC 62368 (safety) and complies with: d) Directive 2011/65/EU (ROHS 2) e) Directive 2012/19/EU (VVEEE) I hereby declare that the equipment named above has been designed to comply with the relevant sections of the above referenced specifications. The equipment is compliant with all applicable Essential Requirements of the Directives.

Authorized Signature: Name: Peter J. Walker Position: CEO, FOMOfx Pty Ltd Signed at: Sydney, Australia Date: 28/08/2020

Warning: Changes or modifications to this unit not expressly approved by the party responsible for compliance could void the user's authority to operate the equipment.

This device complies with Part 15 of the FCC Rules. Condition: Operating it is subject to the following two conditions: (1) this device may not cause harmful interference (2) this device must accept any interference received, including interference that may cause undesired operation.

Shielded cables must be used with this unit to ensure compliance with Class B FCC limits.

FCC ID: 2AYFZVJPM1 IC: 26801-VJPM1 CAN ICES-3 (B) INMB-3(B)

CONTACT

www.fomofx.com

Email: support@fcmolx.COM



Documents / Resources

| | |
|---|---|
|  | Virtual Jeff PRO VJPM1 Audio Effects Processor [pdf] User Guide VJPM1, 2AYFZVJPM1, VJPM1 Audio Effects Processor, VJPM1, Audio Effects Processor |
|---|---|