



VIQUA D4+ Sensor Replacement Instructions

[Home](#) » [VIQUA](#) » VIQUA D4+ Sensor Replacement Instructions 

Contents

- [1 VIQUA D4+ Sensor Replacement](#)
- [2 Product Information](#)
- [3 Product Usage Instructions](#)
- [4 Safety Information](#)
 - [4.1 Safety Precautions](#)
- [5 Maintenance](#)
- [6 Installing Sensor to the Controller](#)
- [7 Contact information](#)
- [8 Documents / Resources](#)
 - [8.1 References](#)
- [9 Related Posts](#)



VIQUA D4+ Sensor Replacement



Product Information

This instruction sheet is for the Sensor Replacement of Models D4+, E4+, and F4+. It contains safety information, safety precautions, maintenance instructions, and installing sensors to the controller procedures.

The equipment should only be used or installed in the manner specified in the instruction sheet. The product emits UV light which can be hazardous to human health. The product also contains Phthalates, which can cause cancer and birth defects or other reproductive harm. It is recommended to wear cotton gloves while handling the product and clean quartz sleeves. The product should be used with caution to avoid thermal hazards, personal injury hazards, and contamination hazards. The temperature management valve can be installed to eliminate the hot water condition.

Product Usage Instructions

Before operating the equipment, thoroughly read the entire instruction sheet and pay attention to all danger, warning, and caution statements. Follow the safety precautions to avoid serious personal injury or damage to the equipment. Perform the disinfection procedure before turning on the system. Refer to Owner's Manual for guidance. Ensure that there is no other power source connected before installing the sensor to the controller.

To install the sensor to the controller:

1. Remove the old sensor from the controller
2. Connect the new sensor to the controller
3. Install solenoid and cool touch valve, if applicable
4. Turn on the power supply and wait for 10 minutes
5. Press and hold the reset button for 45 seconds
6. Release the reset button, and wait for 15 seconds
7. Press and hold the reset button again for 30 seconds
8. Release the reset button, and wait for 2 minutes
9. Press and hold the reset button for 15 seconds
10. Release the reset button, and wait for 10 minutes







After installing the sensor, follow the maintenance instructions to keep the equipment in good condition. Wear cotton gloves to handle new UV lamps and clean quartz sleeves to protect against contaminants. If there are any problems or concerns with the equipment, refer to the Owner’s Manual or contact the manufacturer for assistance.

Safety Information

Please read this entire instruction sheet before operating this equipment. Pay attention to all danger, warning, and caution statements in this instruction sheet. Failure to do so could result in serious personal injury or damage to the equipment. Make sure that the protection provided by this equipment is not impaired. Do not use or install this equipment in any manner other than that specified in the instruction sheet.

Safety Precautions

DANGER

| DANGER | |
|---|---|
| <div>      </div> | <p>Failure to follow these instructions will result in serious injury or death.</p> <p>Shock Hazard – Stored Energy</p> <ul style="list-style-type: none">• Disconnect power to system before performing any maintenance or repair.• There may be more than one source of power. Only connect to a GFCI.• Protective ground• DO NOT touch with wet hands. <p>Pressurized Device – Impalement Hazard</p> <ul style="list-style-type: none">• NEVER perform any physical inspection, repair or maintenance on UV chamber unless UV chamber has been isolated and depressurized.• NEVER service UV lamps, quartz sleeves or associated hardware until depressurization of UV chamber has been confirmed.• DO NOT store any combustible or flammable material close to the system. |

WARNING

WARNING

Failure to follow these instructions could result in serious injury or death.



UV Light Hazard

- ALWAYS use UV protective gear, including gloves and UV safety glasses.
- NEVER look directly at illuminated UV lamps, even when using protective gear.
- NEVER illuminate UV lamp outside of the UV chamber.
- If accidental exposure occurs, immediately cool the affected area and consult a physician.



Contamination Hazard

- If UV lamp breaks, avoid inhalation, ingestion, or exposure to eyes and skin. Wear appropriate clothing and personal protective equipment.
- NEVER use a vacuum cleaner to clean up broken UV lamps as this will scatter the mercury. Obey local regulations and guidelines for the removal and disposal of mercury waste.



WARNING: This product can expose you to chemicals including Phthalates, which are known to the State of California to cause cancer and birth defects or other reproductive harm. For more information go to www.P65Warnings.ca.gov.

CAUTION

CAUTION

Failure to follow these instructions could result in minor or moderate injury.

Thermal Hazard

- Allow UV lamps, UV chamber to cool for a minimum of 10 (ten) minutes before handling.
- When there is no water flow, the water in the chamber will become hot. To prevent scalding, allow the system to cool for 10 minutes before draining the system.



Personal Injury Hazard

- UV lamps and quartz sleeves are fragile. Do not strike, bend or apply pressure, or they will break.
- DO NOT handle UV lamps or quartz sleeves with bare hands. Wear rubber or latex gloves to handle previously installed UV lamps and soiled quartz sleeves to protect against contaminants. Wear cotton gloves to handle new UV lamps and clean quartz sleeves.





NOTICE

| NOTICE | |
|---|---|
|  | <p>Avoid Injury</p> <ul style="list-style-type: none">Read and understand this Instruction Sheet before operating and performing any maintenance on this equipment. <p>System Protection</p> <ul style="list-style-type: none">To protect the Controller, a UL 1449 certified (or equivalent) transient voltage surge suppressor is strongly recommended. |

Maintenance

WARNING

| WARNING | |
|---|---|
|   | <ul style="list-style-type: none">Always disconnect power before performing any work on the disinfection system.Always shut-off water flow and release water pressure before servicing.Replace the UV lamp annually (or biennially if seasonal home use) to ensure maximum disinfection.Always drain the chamber when closing a seasonal home or leaving the unit in an area subject to freezing temperatures.During extended periods of no water flow, the water in your chamber can become very hot (Approx. 60 °C) and potentially lead to scalding. It is recommended to run your water until this hot water has been purged from your chamber. Do not allow water to contact your skin during this time. To eliminate this condition, a temperature management valve can be installed at the outlet of your UV system. |

Installing Sensor to the Controller

Note:

System figures may look slightly different than your actual system.

Procedure:

- Shut off the water supply.

Note: Solenoid and Cool Touch valve are not used in all systems.

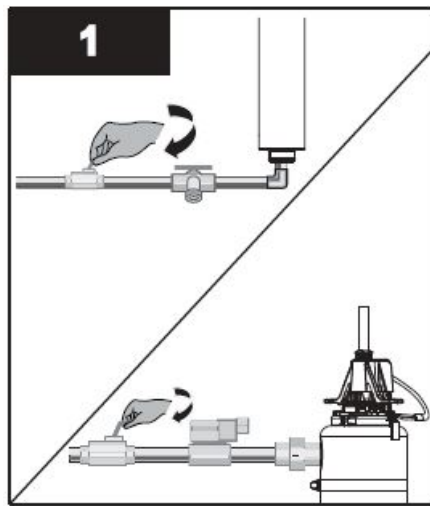

- Open a tap downstream of the UV unit to release pressure. Then, close this tap.



- Disconnect the main power source and allow the unit to cool for 10 minutes.

Note: Ensure there is no other power source connected, such as a solenoid, junction box, and remote alarms.

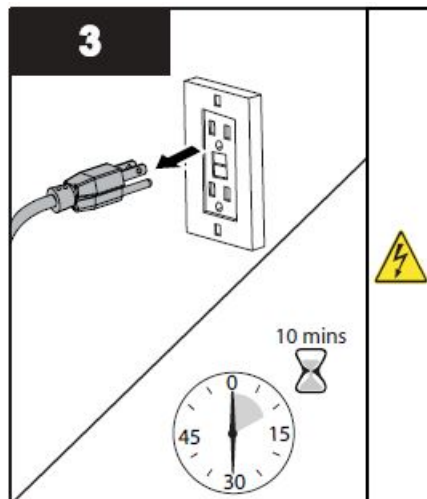

- Disconnect the sensor cable from the controller.

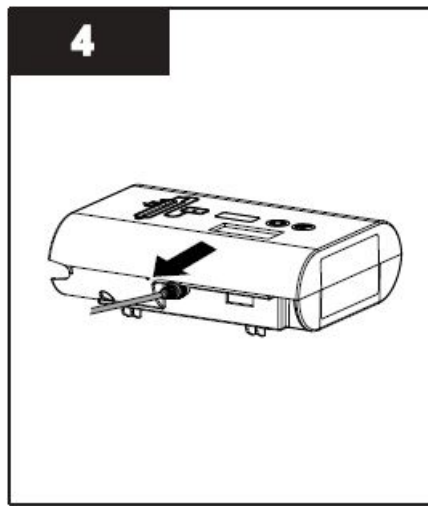

- Remove the old sensor from UV chamber.

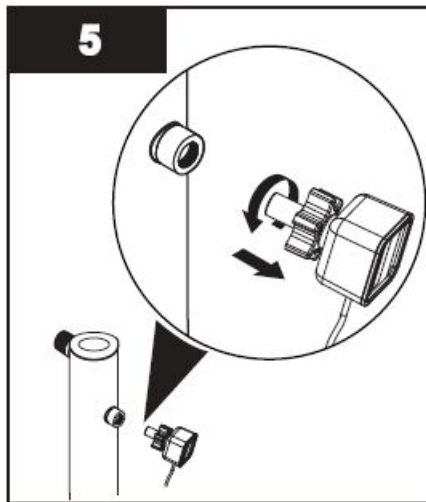

- Install the new sensor to the UV chamber.

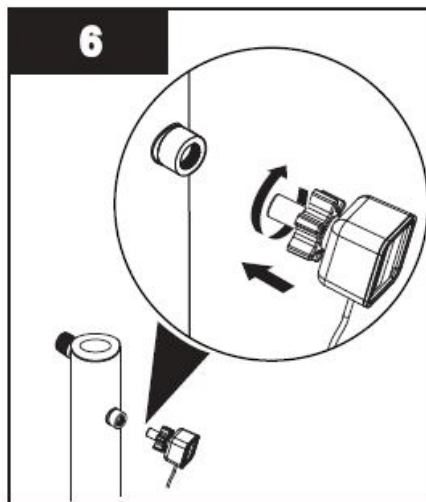

- Connect the sensor cable to the controller.

Note: Perform the disinfection procedure before turning the system on. Refer to Owner's Manual.

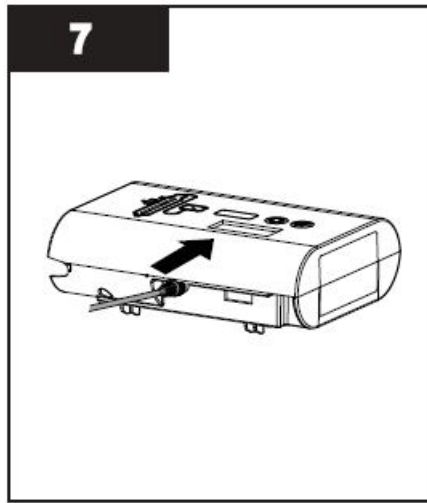

- Restore power and connect the other devices such as a solenoid, junction box, and remote alarms.

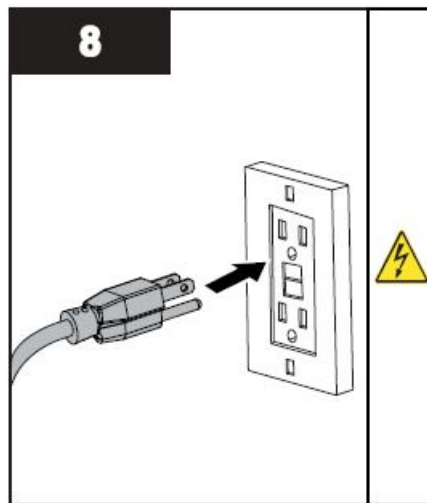

- Turn on the water supply.

Note: Solenoid and Cool Touch valves are not used in all systems.

Contact information

425 Clair Rd. W, Guelph, Ontario, Canada N1L 1R1

t. (+1) 519.763.1032

tf. (+1) 800.265.7246 (US and Canada only)

t. (+31) 73 747 0144 (Europe only)

f. (+1) 519.763.5069

e-mail: info@viqua.com.

www.viqua.com.

Documents / Resources

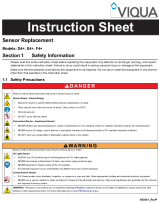
| | |
|--|--|
|  | <p>VIQUA D4+ Sensor Replacement [pdf] Instructions</p> <p>D4 Sensor Replacement, D4, Sensor Replacement, Replacement</p> |
|--|--|

References

-  [P65Warnings.ca.gov](https://www.p65warnings.ca.gov)
-  [Residential UV Water Treatment | VIQUA | Trojan Technologies](#)