



VIOFO RM100 Bluetooth Remote Control User Manual

[Home](#) » [VIOFO](#) » VIOFO RM100 Bluetooth Remote Control User Manual 

Contents

- [1 VIOFO RM100 Bluetooth Remote Control](#)
- [2 Overview](#)
- [3 Contents](#)
- [4 Specifications](#)
- [5 Installation](#)
- [6 Pairing with a dash camera](#)
- [7 Replacing the battery](#)
- [8 Customer Service](#)
- [9 Join Viofo Community](#)
- [10 Documents / Resources](#)
- [11 Related Posts](#)

VIOFO

VIOFO RM100 Bluetooth Remote Control



Overview

The RM100 Bluetooth remote control is designed to operate the VIOFO Bluetooth dash camera.

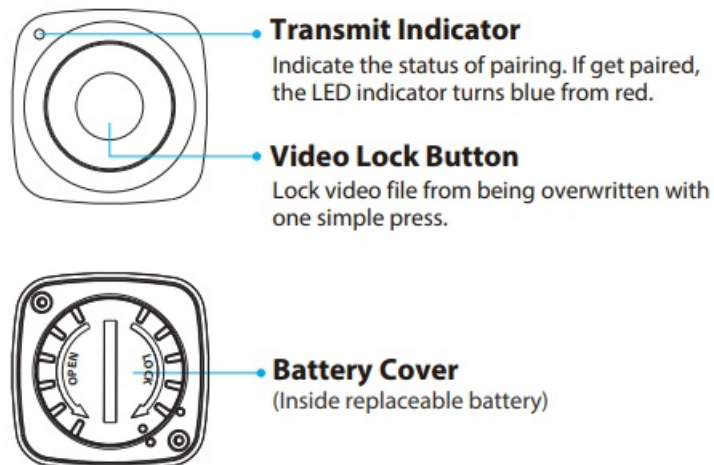

Contents

- Bluetooth Remote Control *1
- 3M Adhesive *2
- User Manual *1

Specifications

- **Size:** 33*33*10mm
- **Weight:** 10g
- **Battery:** CR2032
- **Control Distance:** 3-5 meters

Installation

- Fix the Bluetooth remote control in a convenient location on your dashboard.



- With one simple press of the remote, important videos can be saved and locked without needing to take your eyes off the road.

Pairing with a dash camera

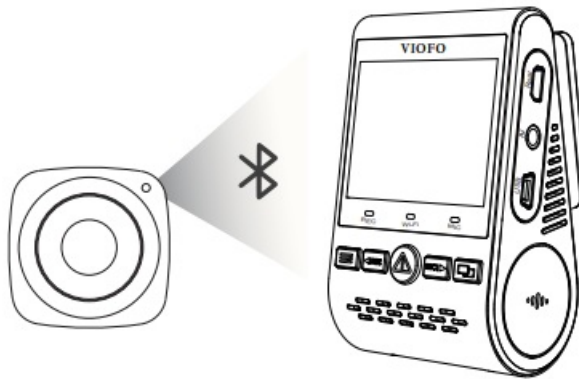

- Power on the camera.
- Press and hold the video lock button on the remote control for 3 seconds to pair with the camera.
- If gets paired successfully, the LED indicator of the remote turns blue.

Replacing the battery

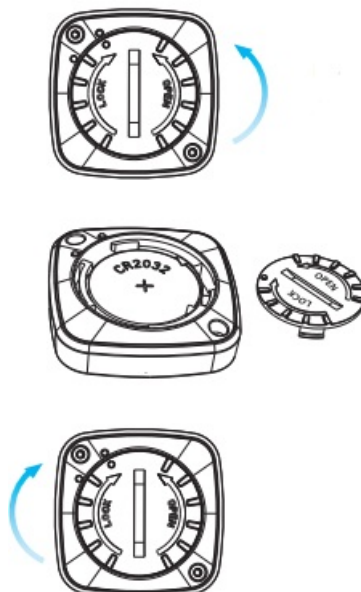

1. Open the battery cover by turning it in the direction of the arrow.

2. Place the new battery with the “+” symbol facing upward.
3. Lock the battery cover by turning it in the direction of the arrow.

Customer Service

- 12-month Limited warranty
- Lifetime technical support
- support@viofo.com
- +86 755 8526 8909 (CN) Mon-Fri 9am-6pm

Join Viofo Community

- [Facebook.com/viofo.world](https://www.facebook.com/viofo.world)
- Copyright 2022 Viofo Ltd. All Rights Reserved.

Documents / Resources

	VIOFO RM100 Bluetooth Remote Control [pdf] User Manual RM100 Bluetooth Remote Control, RM100, Bluetooth Remote Control, Remote Control, Control
--	--