



Metal magnetic contact for flush mounting installation.

## Contents [ [hide](#) ]

[1 INSTALLATION RULES](#)

[2 CHARACTERISTICS](#)

[3 VIEWS AND DIMENSIONS](#)

[4 Documents / Resources](#)

[4.1 References](#)



## INSTALLATION RULES

Installation must be carried out by qualified persons in compliance with the current regulations regarding the installation of electrical equipment in the country where the products are installed.

## CHARACTERISTICS

- Max. voltage: 60 V DC – 42.4 V ~
- Max. current: 1 A
- Max. power: 10 W
- Cable length: 25 cm

- Electrical connections: 2 cables for the contact + 2 cables for the tamper
- Max. number of cycles: > 3000000
- Operating temperature: -25 ÷ +60 °C
- Protection degree: IP65
- Material: brass
- Dimensions: 24 x Ø 15 mm

REACH (EU) Regulation no. 1907/2006 – Art.33. The product may contain traces of lead.



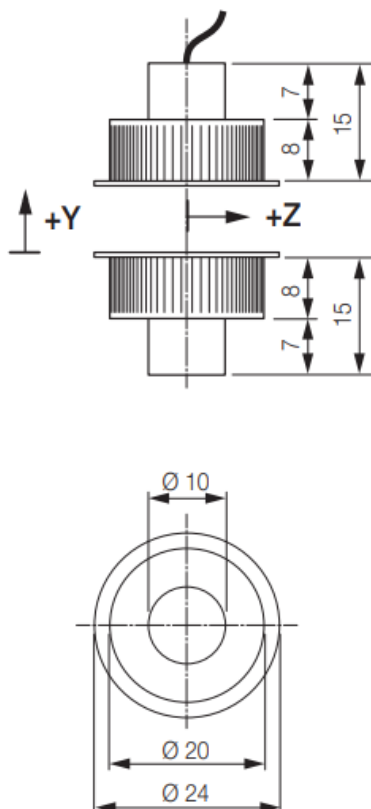

### **WEEE – User information**

The crossed out bin symbol indicates that the product must be sent to separate collection facilities for recovery and recycling, in compliance with the national laws of EU Countries that implement the WEEE Directive. The objective is to prevent any harmful effects on the environment and on human health by ensuring that products are disposed of correctly, avoiding illegal disposal sanctioned by law. To dispose of the product correctly, please check local dispositions in your country.

## **VIEWS AND DIMENSIONS**



- 1% diagram tolerance

Magnet operating distances (mm)			
Axis		Material	
		Iron	PVC
Y	Distancing 	16 mm	19 mm
	Approaching 	14 mm	18 mm
Z	Distancing 	16 mm	12 mm
	Approaching 	14 mm	12 mm

- 20% distance tolerance.

CE 01821 01 2504



**VIMAR**

Viale Vicenza, 14

36063 Marostica VI – Italy

[www.vimar.com](http://www.vimar.com)

## Documents / Resources

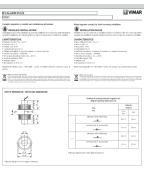
	<p><a href="#">VIMAR 01821 By Alarm Plus [pdf]</a> Installation Guide</p> <p>01821, 01821 01 2504, 01821 By Alarm Plus, 01821, By Alarm Plus, Alarm Plus, Plus</p>
---	--

## References

- [User Manual](#)

## Leave a comment

Your email address will not be published. Required fields are marked \*

Comment \*

Name

Email

Website

☐ Save my name, email, and website in this browser for the next time I comment.

**Post Comment**

**Search:**

**Search**

[Manuals+](#) | [Upload](#) | [Deep Search](#) | [Privacy Policy](#) | [@manuals.plus](#) | [YouTube](#)

This website is an independent publication and is neither affiliated with nor endorsed by any of the trademark owners. The "Bluetooth®" word mark and logos are registered trademarks owned by Bluetooth SIG, Inc. The "Wi-Fi®" word mark and logos are registered trademarks owned by the Wi-Fi Alliance. Any use of these marks on this website does not imply any affiliation with or endorsement.