

VIKEYUNVK
B0D8785MLP Projector
with Wi-Fi and Bluetooth



VIKEYUNVK B0D8785MLP Projector with Wi-Fi and Bluetooth User Manual

[Home](#) » [VIKEYUNVK](#) » VIKEYUNVK B0D8785MLP Projector with Wi-Fi and Bluetooth User Manual 

Contents

- [1 VIKEYUNVK B0D8785MLP Projector with Wi-Fi and Bluetooth](#)
- [2 Important safety precautions](#)
- [3 Use of remote control](#)
- [4 Suitable for smartphones](#)
- [5 Android on the same screen](#)
- [6 Projection Settings](#)
- [7 Common Problem](#)
- [8 How to install and debug projector quickly](#)
- [9 Documents / Resources](#)
 - [9.1 References](#)
- [10 Related Posts](#)

VIKEYUNVK

VIKEYUNVK B0D8785MLP Projector with Wi-Fi and Bluetooth



Important safety precautions

Announcements

- Thank you for purchasing this digital projector series.
- Please read through this manual for proper use of this product.
- After reading, please put this manual together with the warranty card in a safe place for reference.
- Please read this instruction manual if you need to know something or have any problems.

NOTICE

- To prevent electric shock, do not open the chassis. There are no parts in the machine that the customer can repair. Please entrust qualified professional maintenance personnel to carry out maintenance.
- This sign reminds the user that great care must be taken in operation and repair, therefore, it must be read carefully to prevent any failures.
- This sign warns the user that uninsulated voltages in the unit may cause electric shock from the surface magnetic field, and therefore it is dangerous to contact any part of the unit.

WARNING

- To prevent fire or electric shock, do not expose the unit to rain or moisture. Do not open
- **Warning:** Do not look directly at or stare at the light beam from the lens. Strong light may cause eye discomfort or damage. Parents should supervise and educate children to use it properly.
- Suitable for altitude less than 2000 m and non-hot climate

Use of remote control

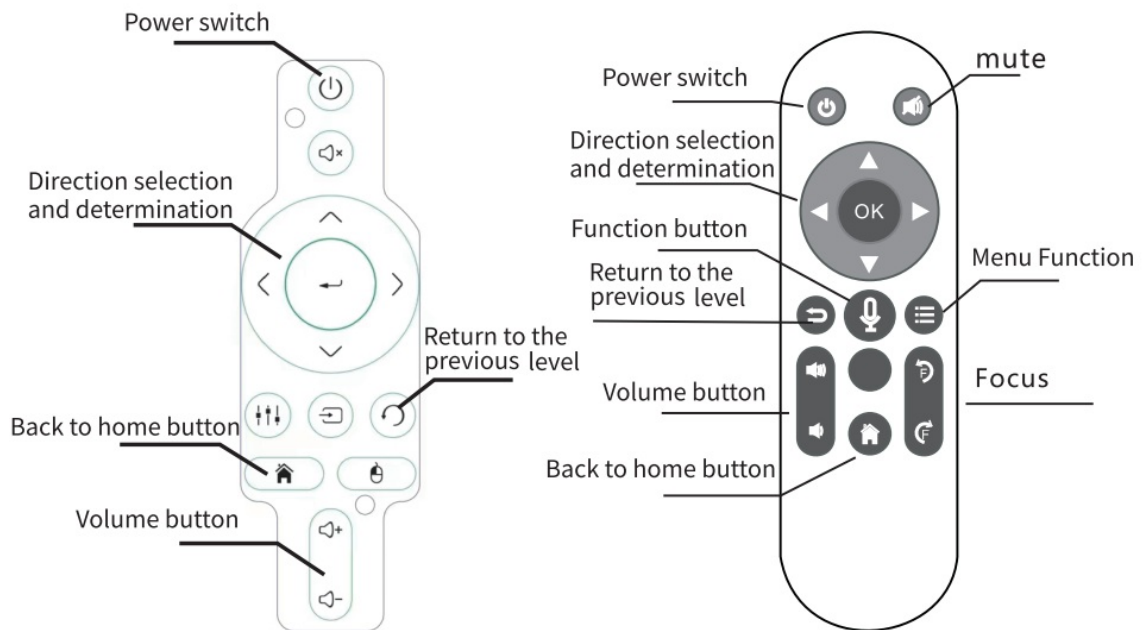

Suitable for smartphones

Apple on the same screen

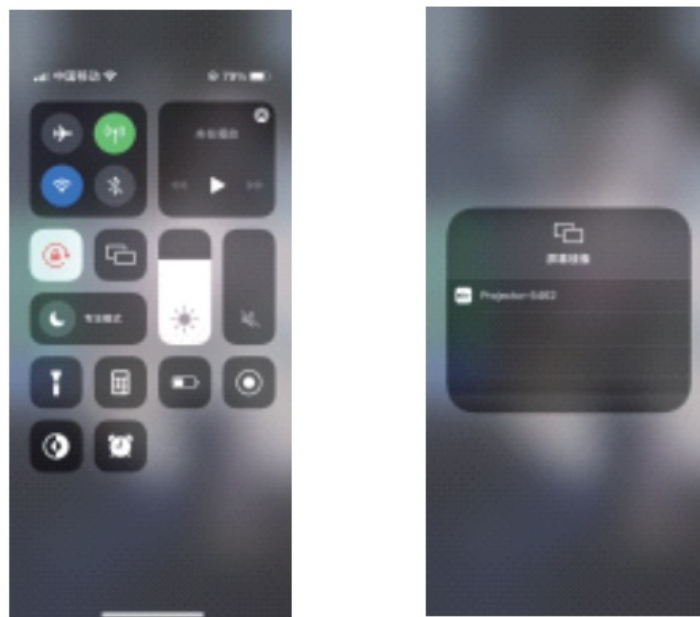

1. The projector and Apple mobile phone are connected to the same network, open the projector, select the projector end "my apps→" . The system will open Eshare on the same screen software.
2. Apple mobile phone drop -down status bar, find "screen mirror" and open, wait for the search projector equipment, select the projector equipment and click on, wait for the connection, complete the same screen.

Android on the same screen

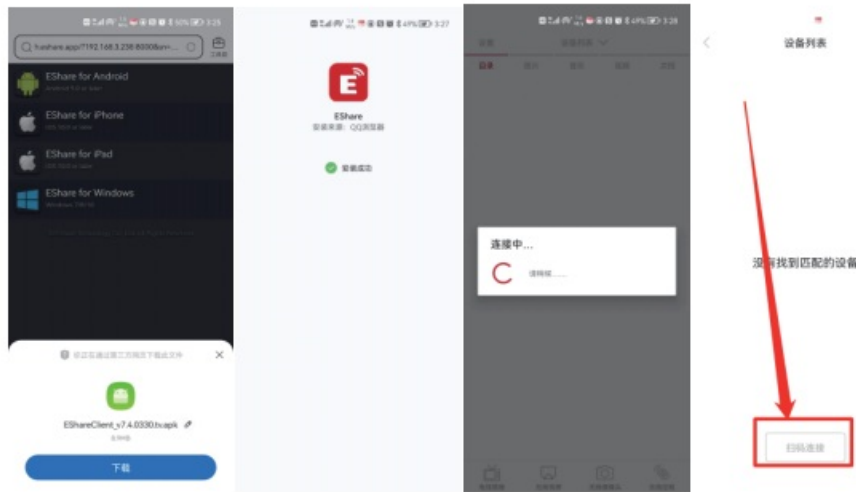

1. The projector and mobile phone are connected to the same network. Open the projector and select the “my apps→” . The system will open the EShare on screen software.
2. Download the software by scanning the QR code in the bottom left corner of the mobile phone interface
3. Open the downloaded software, select “Scan Code Link”, wait for the connection, and complete the same screen.

Projection Settings

- Find the top left corner of the main interface “” Here you can find some commonly used settings, including connecting to WiFi, Bluetooth, and projection settings.
- In projection settings, screen scale: can be switched between “16:9 and 4:3”
- Installation mode: including “desktop forward projection, desktop backward projection, lifting forward projection, and lifting backward projection”
- **Trapezoidal correction:** When the projector is side projection, it can be adjusted through the remote control to achieve a square image
- **Global zoom:** Press the “left and right” buttons on the remote control to zoom the screen, supporting 30% – 100% screen adjustment

Common Problem

1. The screen is blurry

Please maintain a distance of at least 1.0 meters for focusing until the image is clear

2. How to adjust the size of the screen

Find “Settings” in the upper left corner of the main interface and open it. Find “Projection” and “Global Zoom”. Press the “Left and Right” keys on the remote control to zoom the screen, supporting 30% – 100% screen adjustment

3. Unable to connect to the internet

1. Please check the router settings connected and ensure that the projector device’s WiFi is turned on. Enter the correct password and connect to the network.
2. Open the mobile hotspot test. If the mobile hotspot can be connected to the internet, it is a problem with the router’s settings. Please contact the router manufacturer for debugging

How to install and debug projector quickly

Set projection screen trapezoidal scale and projection mode

1. Select "Trapezoidal Correction" on the home page.
2. Select function keys based on the projection scenario.

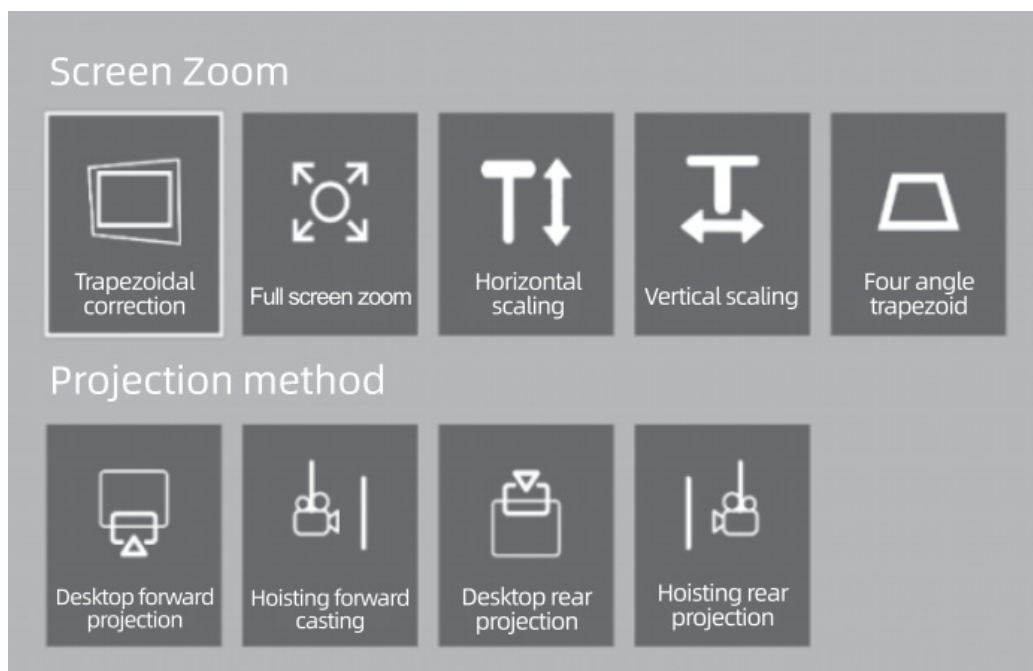

Setting up wifi Connection

1. Open the Settings menu on the remote control or the Settings on the home page.
2. On the WLAN network connection page, enable Wireless and Network as shown in the figure.
3. Select the home wifi signal network, enter the wifi password, and connect.



By pressing the home menu, you can now go online and enjoy your home theater.

Documents / Resources



[VIKEYUNVK B0D8785MLP Projector with Wi-Fi and Bluetooth](#) [pdf] User Manual
B0D8785MLP Projector with Wi-Fi and Bluetooth, B0D8785MLP, Projector with Wi-Fi and Bluetooth, Wi-Fi and Bluetooth, Bluetooth, Projector

References

- [User Manual](#)

[Manuals+](#), [Privacy Policy](#)

This website is an independent publication and is neither affiliated with nor endorsed by any of the trademark owners. The "Bluetooth®" word mark and logos are registered trademarks owned by Bluetooth SIG, Inc. The "Wi-Fi®" word mark and logos are registered trademarks owned by the Wi-Fi Alliance. Any use of these marks on this website does not imply any affiliation with or endorsement.