



VIGILATE VIGMS Wireless Motion Sensor User Manual

[Home](#) » [VIGILATE](#) » **VIGILATE VIGMS Wireless Motion Sensor User Manual** 

Contents

- [1 VIGILATE VIGMS Wireless Motion Sensor User Manual](#)
- [2 Operating Instructions](#)
- [3 Installation & Notice](#)
- [4 Features](#)
- [5 Parameters](#)
- [6 Appearance](#)
- [7 Battery Replacement Instructions](#)
- [8 LED Indication](#)
- [9 FCC Statement](#)
- [10 Read More About This Manual & Download PDF:](#)
- [11 Documents / Resources](#)
- [12 Related Posts](#)

VIGILATE VIGMS Wireless Motion Sensor User Manual

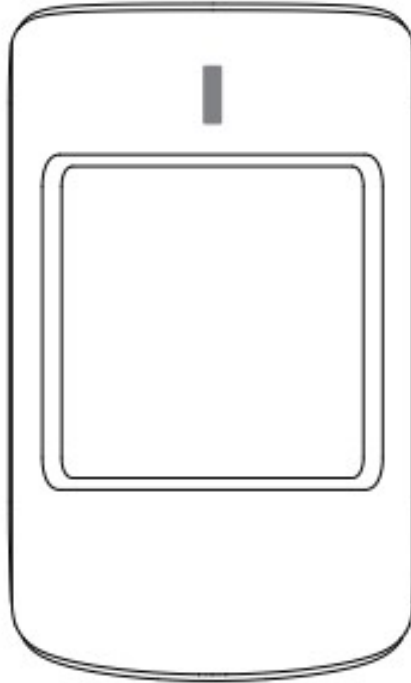

Operating Instructions

1. Working principle

With digital dual-core fuzzy logic operative programming and intelligent analysis, it accurately detects human body movement with the infrared sensor and sends a signal to the main panel.

2. Pairing with main panel by App

- ① Scan the QR code on the sensor.
- ② The pairing result can be confirmed in App.

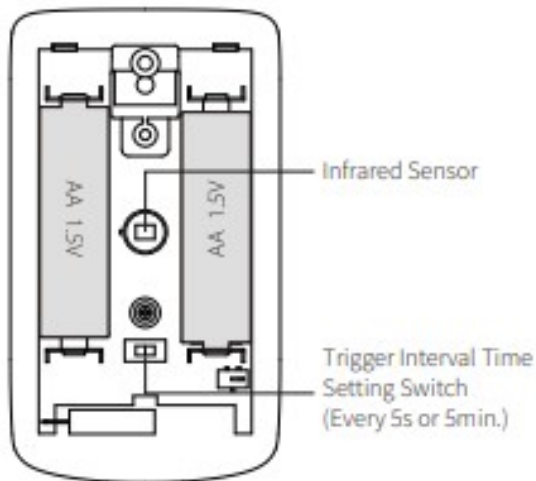

3. Product testing

- ① Power on, LED indicator would flash for 1s. It takes about 30s to do a self-check.
- ② To verify this product is installed properly, please walk in the sensing area to test.

Installation & Notice

- Pull out and remove the battery insulative plastic strip.

- Pair with the main panel using the App before installing.
- Fix the bracket to the wall using the screws included, connect the sensor to bracket, adjust to the proper angle.
- Recommended to install at a height of 1.8-2.2m from ground, with gradient $10^{\circ}\sim 20^{\circ}$.
- Make sure there is no temptation for pets to pass by, like stairs, etc.
- Indoor use only. Avoid installing the sensors in an area with strong light, rapid temperature changes, direct sunshine, heat source or the air stream flows frequently, like close to windows, air-conditioners, and under rotating objects.
- Because the sensor is more sensitive to cross movement than vertical movement, it works best when the detecting direction is vertical to the people's walking direction.
- To ensure the device is working, please perform a walk test periodically, once a week recommended.

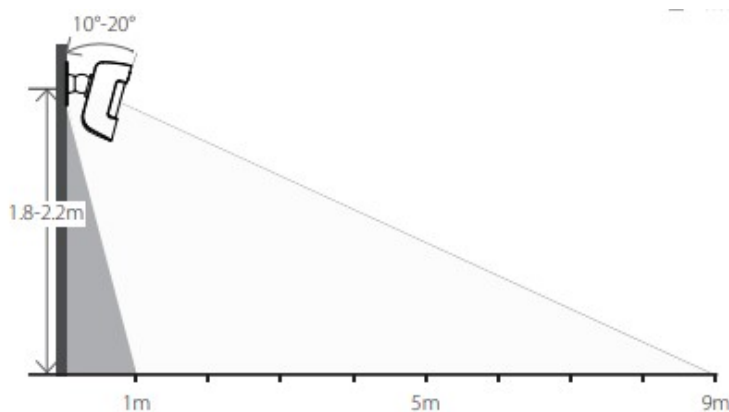
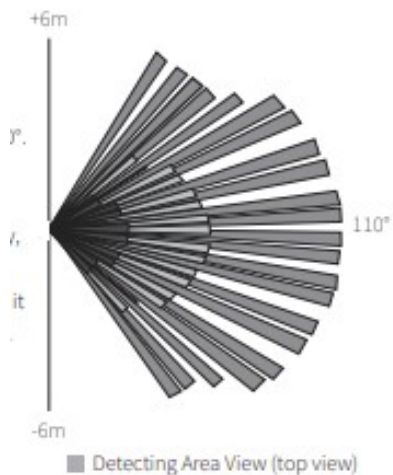

Detecting Area View (side view)

Features

The wireless motion sensor is an accessory of the VIGILATE Smart Alarm System. It accurately detects human body movement. Featured with automatic temperature compensation technology, it ensures high intelligence, sensitivity, and stability. It has a modern and elegant appearance. With technology like RF supervision, anti-tamper protection, energy saving and low battery warning, it's easy to set up and use.

Parameters

• Working Voltage	DC 3V
•	
• Battery	2 × AA battery(1.5V)
• Working Current	≤100mA
• Standby Current	≤15μA
• Detection Range	100°
• Detection Distance	9m
• Transmission Distance	Up to 1000m line of sight
• Transmission Frequency	433.92MHz °C °C
• Working Temperature	-10 ~50

• Humidity	≤90%rh (non-condensing)
• Weight	147g (battery not included) 194g (battery included) 65g (Bracket)
• Dimension	100x60x48mm Φ55x32mm(Bracket) LxWxH(±0.1mm)

Appearance

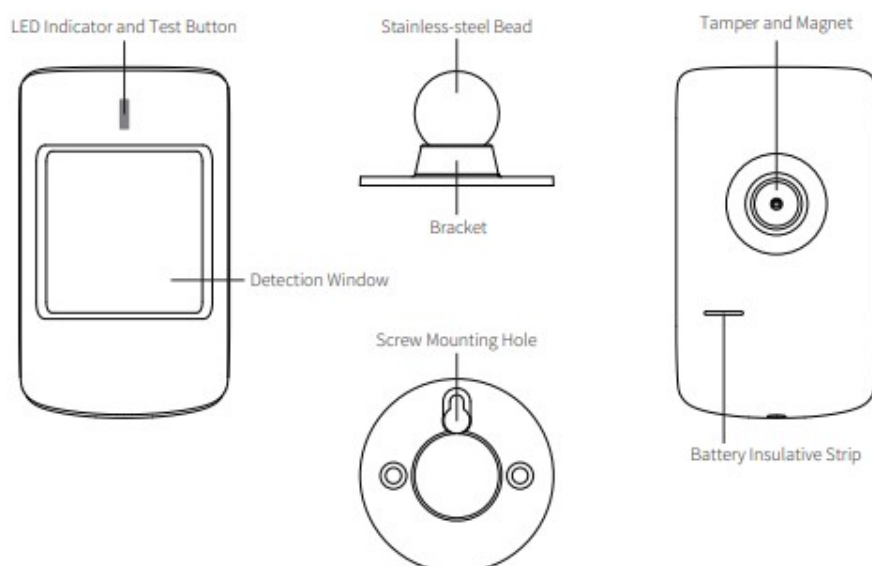

Battery Replacement Instructions

1. Unscrew to open the back cover.



2. Replace with 2x AA battery

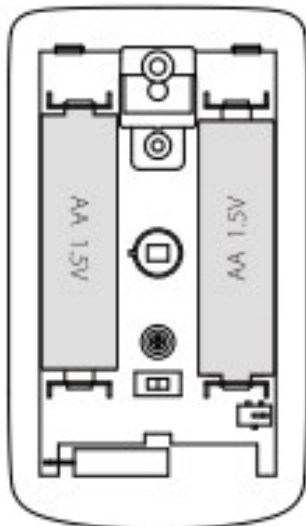

LED Indication

LED flashes once: Motion is detected and transmitter sends signal to the main panel.

The LED indicator will light up once every 15 seconds in case of low battery. Please replace the battery in time. Push notification will be sent to your APP.

FCC Statement

This equipment has been tested and found to comply with the limits for a Class B digital device, pursuant to Part 15 of the FCC

Rules. These limits are designed to provide reasonable protection against harmful interference in a residential installation.

This equipment generates uses and can radiate radio frequency energy and, if not installed and used in accordance with the instructions, may cause harmful interference to radio communications. However, there is no guarantee that interference will not occur in a particular installation. If this equipment does cause harmful interference to radio or television reception, which can be determined by turning the equipment o and on, the user is encouraged to try to correct the interference by one or more of the following measures:

- Reorient or relocate the receiving antenna.
- Increase the separation between the equipment and receiver.
- Connect the equipment into an outlet on a circuit dierent from that to which the receiver is connected.
- Consult the dealer or an experienced radio/TV technician for help.

This device complies with part 15 of the FCC Rules. Operation is subject to the following two conditions:

- ① This device may not cause harmful interference.
 - ② This device must accept any interference received, including interference that may cause undesired operation.
- Changes or modifications not expressly approved by the party responsible for compliance could void the user's authority to operate the equipment.

Read More About This Manual & Download PDF:

Documents / Resources



[VIGILATE VIGMS Wireless Motion Sensor](#) [pdf] User Manual
VIGMS, Wireless Motion Sensor, VIGMS Wireless Motion Sensor