

Videosec IDI-701W IP Video Intercom Indoor Station User Manual

Videosec[®]

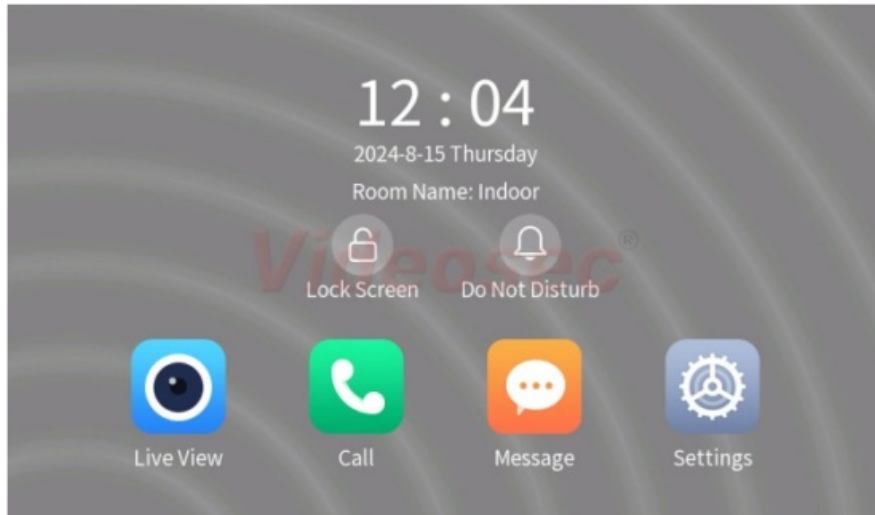

Contents

1 IDI-701W

1.1 IP Video Intercom Indoor Station User Manual

1.2 1 Description

1.3 2 Connections

1.3.1 2.1 Cable description

1.3.2 2.2 Connection diagram

1.4 3 Installation

1.4.1 3.1 Default settings

1.4.2 3.2 Installation wizard

1.4.2.1 3.2.1 Settings that can be made on the outdoor unit, before adding

1.4.3 3.3 Basic handling operations

1.4.3.1 3.3.1 Main Screen

1.4.3.2 3.3.2 Live view

1.4.3.3 3.3.3 Call (Dialer / Call log)

1.4.3.4 3.3.4 Message

1.4.4 3.4 System settings

1.4.4.1 3.4.1 Sounds

1.4.4.2 3.4.2 General settings

1.4.4.3 3.4.3 Wi-Fi

1.4.4.4 3.4.4 Device info

1.4.5 3.5 System settings

1.4.5.1 3.5.1 Indoor station

1.4.5.2 3.5.2 Devices

1.4.6 3.5.3 Administrator password

1.4.7 3.5.4 Administration configuration

1.5 4 Mobile application

1.5.1 4.1 Basic operations with mobile application

1.5.1.1 4.1.1 Enable/disable video call notifications

1.5.1.2 4.1.2 Receiving a call, opening the door lock

1.5.1.3 4.1.3 Door lock operation without a call

1.5.1.4 4.1.4 Activate microphone and speaker without a call

1.5.2 4.2 Access via browser, setting options

1.5.2.1 4.2.1 Login to the web interface

1.5.2.2 4.2.2 Setting the language of the user interface displayed on the display

1.5.2.3 4.2.3 Setting Wi-Fi network

2 Documents / Resources

2.1 References

3 Related Posts

IDI-701W

IP Video Intercom Indoor Station User Manual

v1.12

1 Description

The IDI-701W IP video indoor unit, complemented by the ODI-201W-R (S) outdoor units, is capable of controlling electric locks connected to the outdoor units, has an audio and visual viewing function through the outdoor units, and Videosec SMART IP cameras as an external video source can also be connected to it. It provides users with a wide range of safe and convenient uses.

2 Connections

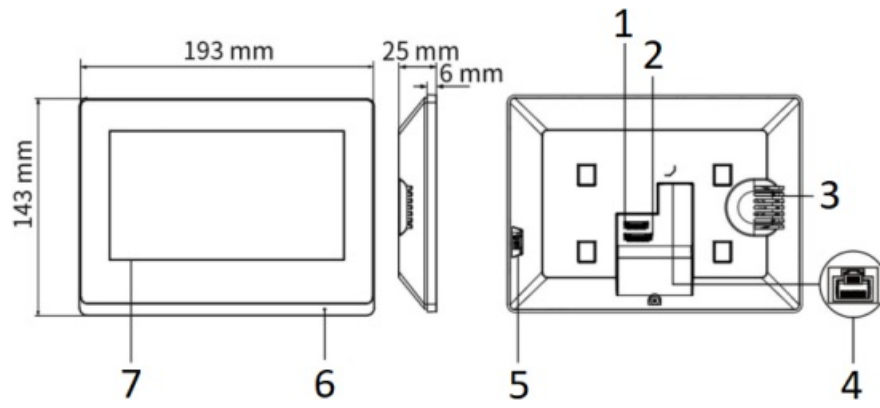

1. RS-485, Alarm outputs
2. 12 VDC, Alarm inputs
3. Speakers
4. LAN connector (POE supply)
5. SD card slot
6. Microphone
7. Display

Power supply: PoE (802.3af, recommended) or 12VDC, max. 10W

2.1 Cable description

Cable	Remarks	Color	Description
12-pin cable	VDD12V	Red	12VDC power interface
	GND	Black	
	IN1	Purple	Zone detector interface (not used)
	IN2	White	
	IN3	Blue	
	IN4	Brown	
	IN5	Yellow	
	IN6	Green	
	IN7	Orange	
	IN8	Gray	
10-pin cable	GND	Black	GND
	RS485_A	Yellow	RS485 interface (not used)
	RS485_B	Green	
	OUT1_NC	Orange	Alarm output interface (not used, under development)
	OUT1_COM	Gray	
	OUT1_NO	Purple	
	OUT2_NC	White	
	OUT2_COM	Blue	
	OUT2_NO	Brown	

2.2 Connection diagram

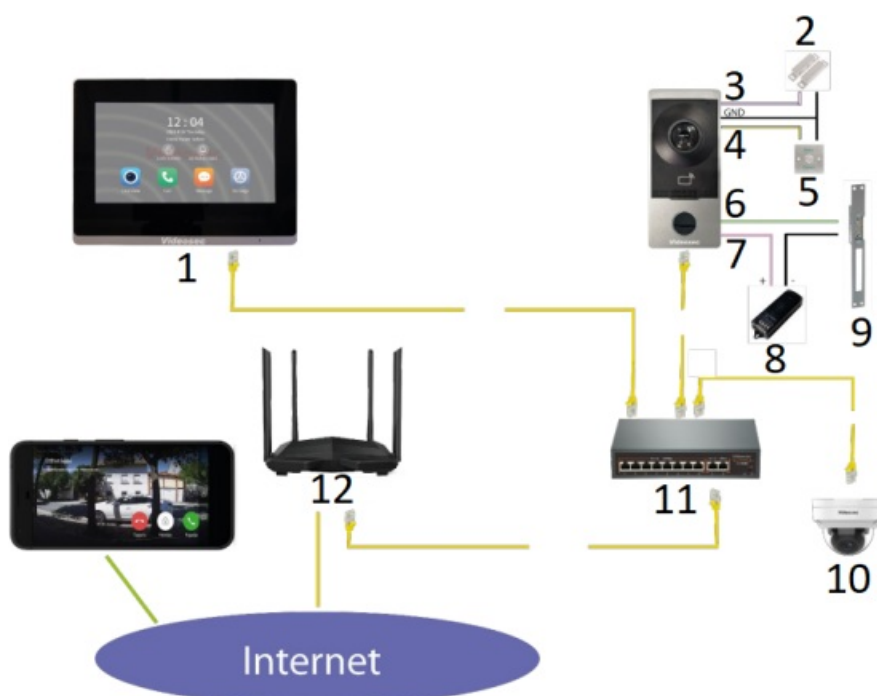

Example: Wired LAN connection with PoE supply

1. Indoor Station
2. Door sensor 1
3. Alarm input2
4. Alarm input4
5. Door button1
6. Lock1 NC
7. Lock1 COM
8. Power supply (for door lock)
9. Door lock1
10. Camera
11. PoE switch
12. Router

3 Installation

3.1 Default settings

The default parameters of the indoor station and door station are consistent:

IP address: 192.168.1.13 (wired LAN, DHCP enable)

Username: admin

Password: 123456

Note:

– Wi-Fi access mode is disabled by default. Activation can be enabled on the unit's local interface in the system settings/Wi-Fi menu item or in a web browser in the Settings/Network menu item.

3.2 Installation wizard

After connecting the power supply, the indoor unit in factory condition starts with a setup wizard that guides you through the basic and necessary settings.

1. Setting the user interface language on the indoor unit



2. To log in, the default password (123456) must be changed to "Strong".
Setting up a recommended e-mail address, which can be used to easily restore a forgotten password

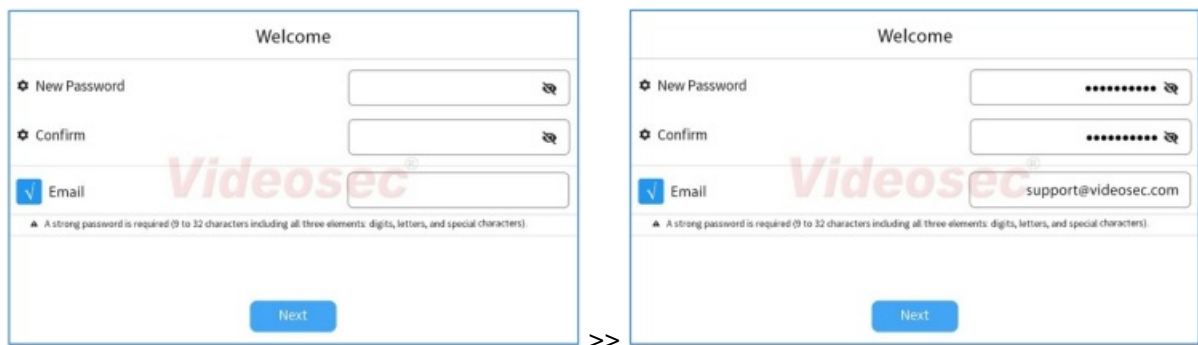

3. LAN connection settings



4. Enable Wi-Fi connection

After authorization, select the ID of the appropriate network, and then set the necessary data for connection.

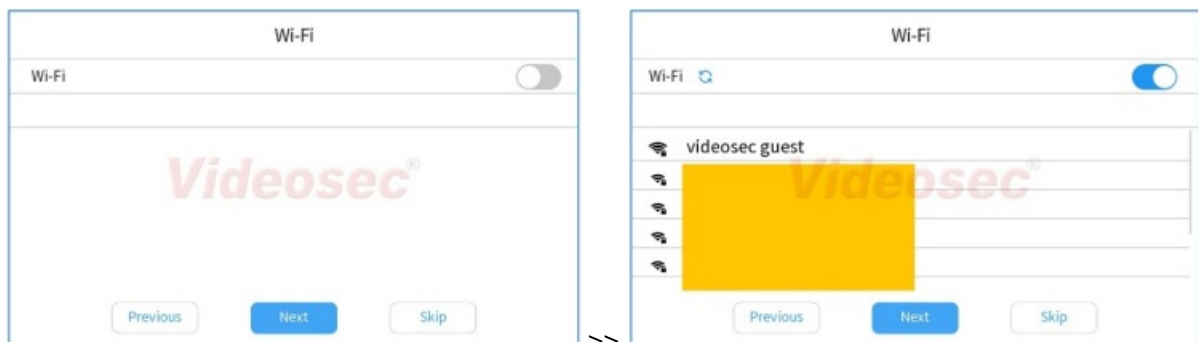

5. Date and time settings



6. Setting the operating mode and location of the indoor unit

In every system, only one Main, but even several Auxiliary indoor units are possible.

Set the name of the Community set on the Main indoor unit also on the additional units to be added.

Device Location

Indoor Station Type

Main Indoor Station

Device Location

Main Indoor Station
Extension

▲ Do not set duplicate extension numbers

Previous
Next
Skip

>>

Device Location

Community

Home

Phase

1

Building

1

Unit

1

Room No.

1

Extension No.

0

7. Search for additional units connected to the network and basic settings

Only suitable for detecting outdoor units, not for indoor units and cameras.

You can find a more detailed description of the available settings of the outdoor devices found by the search in chapter 3.2.1.

Device Discovery

Product Type
SN Code
IP Address
Settings
Status

Searching...

Previous
Finish
Skip

8. Adding outdoor units

Follow these steps to add:

- select device (1)
- click on the add icon (2)
- enter the device admin user password (3)
- click the Confirm button (4)
- after successful addition, a ✓ sign will be displayed in the Status column of the device (5)

>>

Device Discovery

Product Type	SN Code	IP Address	Settings	Status
DS-201W-R	21E...	192.168.1.137	⚙️	

Previous
Finish
Skip

>>

Please enter the administrator password.

Name

admin

Password

Confirm
Cancel

Previous
Finish
Skip

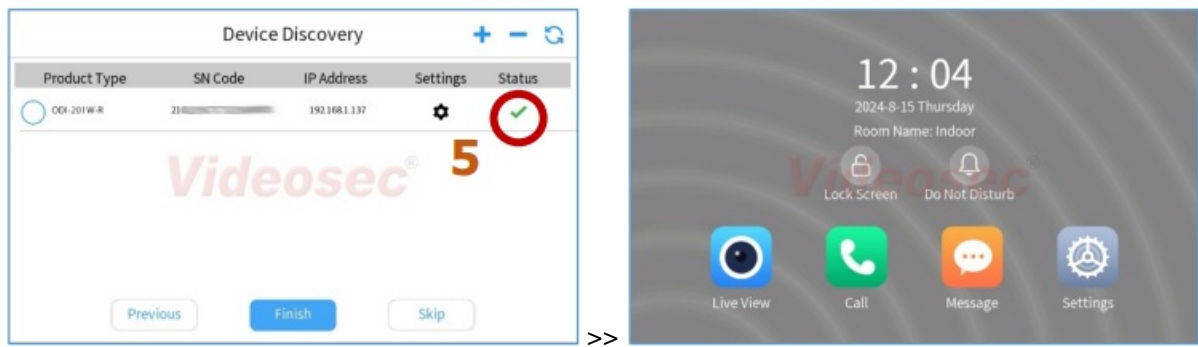

Click Finish to complete the setup wizard.

3.2.1 Settings that can be made on the outdoor unit, before adding

In the list of devices found during the search, click the Setup (⚙️) icon

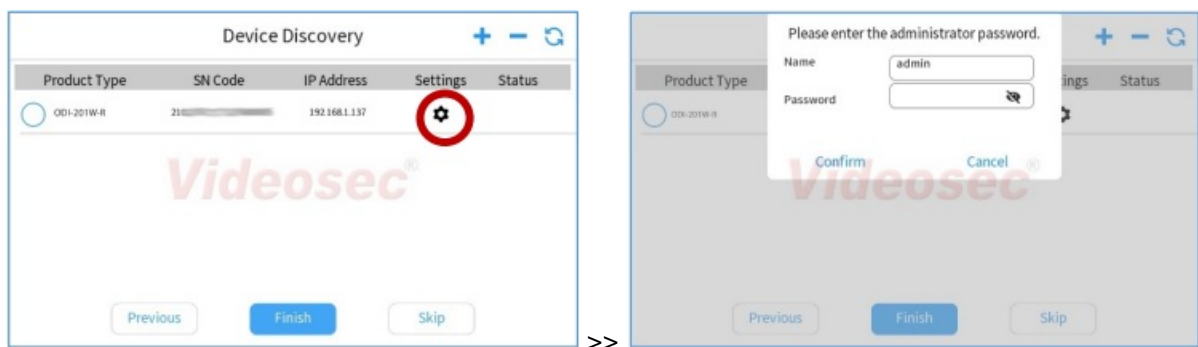

Note:

- Before adding additional devices, the factory default password (123456) must be entered.
- Password synchronization is enabled by default on the indoor unit. Therefore, after adding, the password of the indoor unit must be entered.

❖ Registration password



By setting it up, a higher level of security can be achieved, when using it, extra care must be taken to ensure that the same registration password is set on all elements of the system.

To set up the devices, you must still use the password set for the admin user!

❖ Set device location

Device Location

CommunityHome

Phase1

Building1

Unit1

Room No.1

Extension No.1

Device Location

Community

Phase1

Building1

Unit1

Room No.1

Extension No.1

Important:

- Set the “Community name” field to the same as your indoor unit
- Before adding several units at the same time, the number of Extensions on each device must be set to a different one in order to synchronize the password during the addition!

❖ Enabling/disabling electric locks

Door Control

Door 1

Door 2

Apply

>>

Door Control

Door 1

Door 2

Apply

- By default, lock control output 1 is enabled on outdoor units.
- To use the second lock control output, enable the output.
- If both outputs are disabled, the given outdoor unit works as a doorbell.

3.3 Basic handling operations

3.3.1 Main Screen

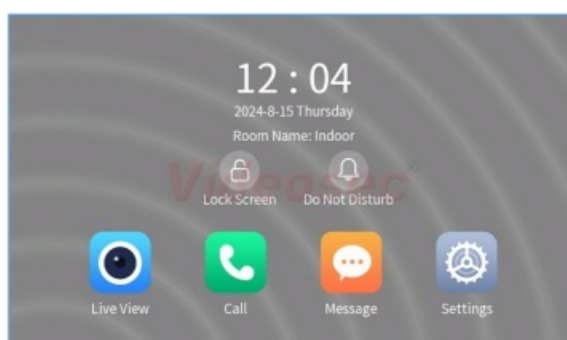

Icon	Description
	Live view: without an incoming call, it provides the possibility to display the image of the connected outdoor units and cameras, to open two-way audio, and to control the electric lock of the outdoor units.
	Open dialer and call log. In the case of several indoor units, it provides the possibility to call between the units.
	Open list: Voicemail/Snapshots/Videos The number of unanswered messages is displayed in the upper right corner of the icon
	Open System settings
	Lock screen
	Mute ringtone

By default, 60 seconds after the last operation, the system automatically returns to the main screen from any menu item.

3.3.2 Live view

By touching the Live View () icon, a list of connected outdoor units and cameras is displayed.



Selecting the outdoor icon displays the live image of the given device.

3.3.2.1 Outdoor unit

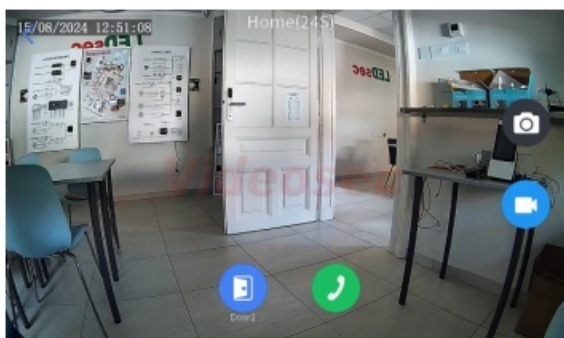

The following options are available on this interface:



Operation of lock control outputs



/ Start/stop two-way audio communication



Start/stop video recording



Taking a snapshot

3.3.2.2 IP camera



Start/stop video recording



Taking a snapshot

3.3.3 Call (Dialer / Call log)



By touching the Call () icon, the dialer appears, from which you can directly call another indoor unit connected to the system, as well as the call log.





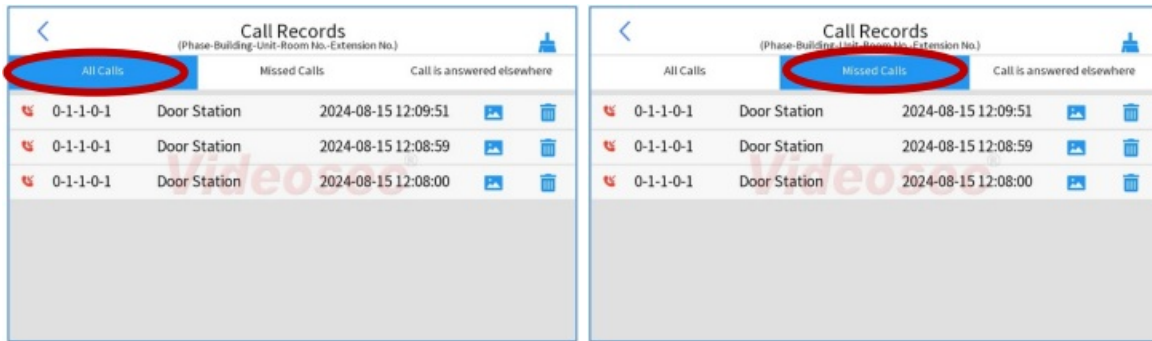

To make a call, you must dial a number derived from the indoor Location settings.

Pl.: Extension: 1 >> 1

To view the call log, tap the  icon:



-  /  : The call was accepted/rejected.
-  /  : The call was answered/ended.

 : View the snapshot taken at the moment of the call

3.3.4 Message



Touching the List icon () displays the Snapshots/Videos taken by the given indoor unit, as well as the messages recorded by the Message recorder.

The number of unanswered messages is displayed in the upper right corner of the icon: 

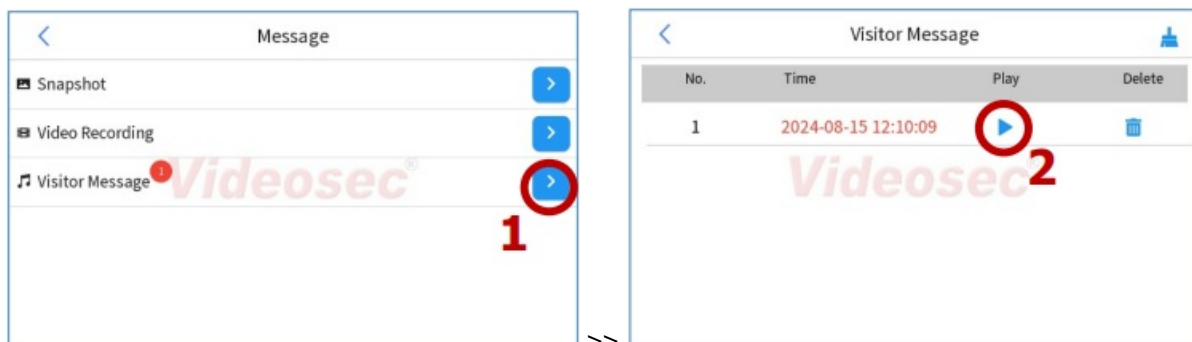

3.4 System settings



Click the Setup () icon to open system settings.



3.4.1 Sounds

3.4.1.1 Call settings

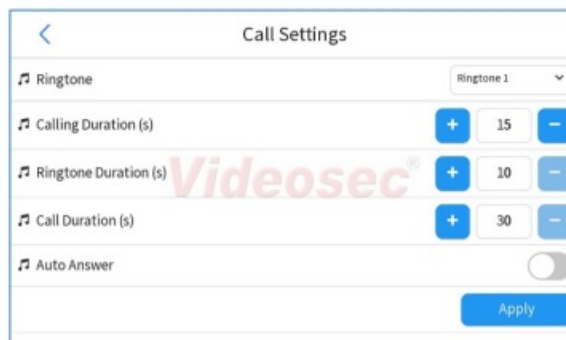

- Ringtone: select the ringtone of the indoor unit
- Call Duration: in case of a call initiated from an outdoor unit, the indoor unit remains in Live view for the set time
- Ring duration: in case of a call initiated from an outdoor unit, the ringing time of the indoor unit
- Talk time: maximum talk time on the indoor unit
- Automatic rejection: When switched on, the indoor unit and the application do not indicate the incoming call. If Voicemail is enabled, the incoming call is automatically routed to Voicemail, and the image of the outside is displayed indoors.

3.4.1.2 Volume settings



3.4.2 General settings



3.4.2.1 Display settings

Enable and schedule display screen saver mode



3.4.2.2 Time settings

Setting the system date and time

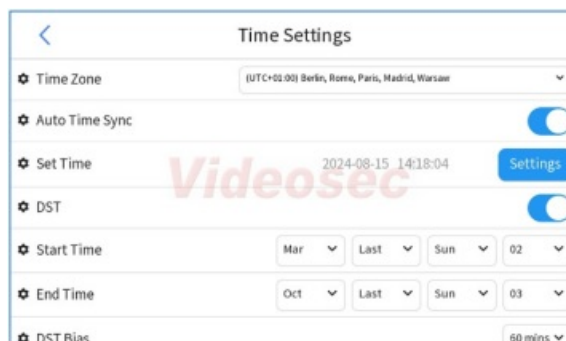

3.4.2.3 Password settings

Currently the Door Opening Password function cannot be used.

3.4.2.4 I/O settings

Currently the I/O interfaces cannot be used.

3.4.2.5 Visitor message settings

If the voice recorder is enabled, it starts automatically after the time set in the Call settings/Call duration option, if no one answers the call.



The image is displayed on the indoor unit during message recording, it is also possible to manage the call and control the lock control outputs. At the end of the process, the indoor will return to the main screen and the indication will also be visible on the List icon.



>>

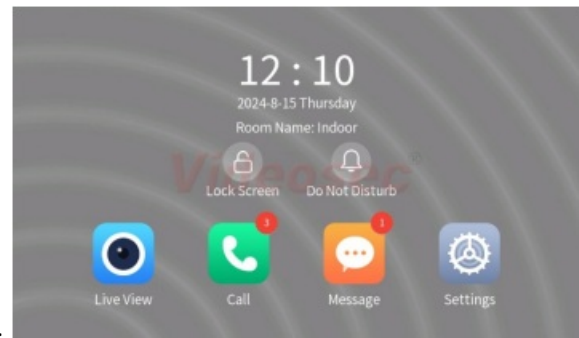

3.4.3 Wi-Fi

By default, Wi-Fi network connection is not enabled on the indoor unit. After activating the function, the device searches for available 2.4 GHz networks. Choose which one you want to connect to, then enter the data required for connection in the window that appears.



>>

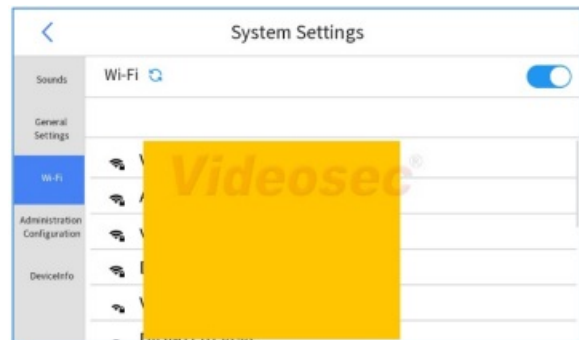

3.4.4 Device info

Through the user interface, you can access the data of the given device, as well as the time elapsed since the last switch on.



3.5 System settings

Select Setup/Administrative Settings to open system settings. Enter the password for the admin user to log in.

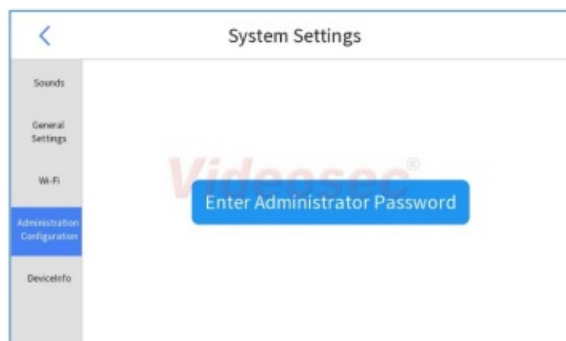

3.5.1 Indoor station

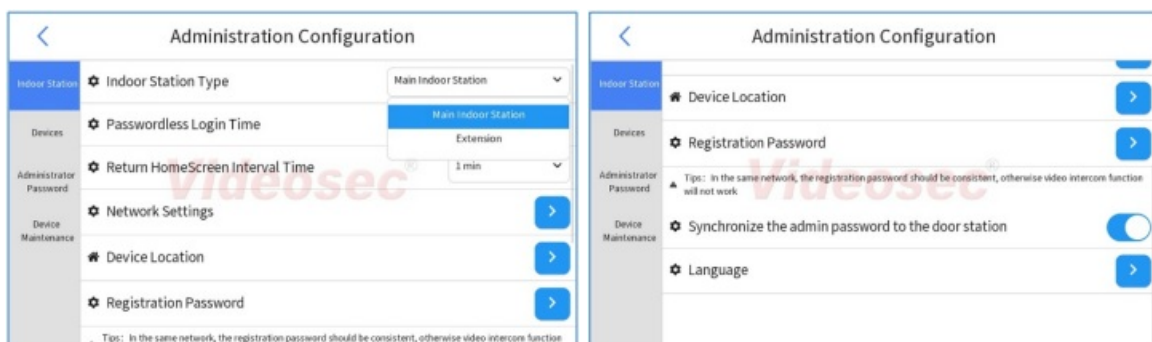

- Indoor unit mode: Main/Extension indoor unit
- Login time without a password: set how long after the last password login, the device asks for a password again when entering the administration settings (0: in all cases, a maximum of 30 minutes can be set)
- Home page return: Starting from the last operation, it will automatically return to the Main screen after the set time
- Network settings: Setting the parameters of a wired network connection
- Device location: Setting the logical location of the indoor unit
- Registration password: By setting it, a higher level of security can be achieved. By default, synchronization is not set, but with additional units added after setting, the Master unit will synchronize it.
- To set up the devices, you must still use the password set for the admin user!

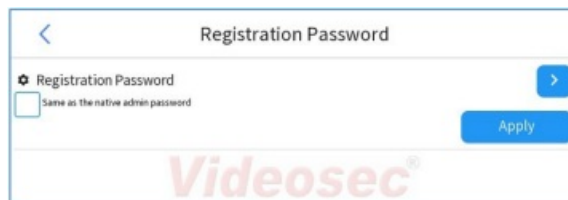

- Synchronization of the administrator password with the door station: the function is enabled by default. It is recommended to keep it switched on.
- Language: setting the language of the user interface displayed on the display

3.5.2 Devices



3.5.2.1 Related devices (outdoor units and IP cameras)

In the menu, you can manage already added outdoor units and IP cameras or you can add new ones



- Central server: currently unavailable device
- Outdoor intercom: by clicking on the  icon, you can edit the device's own settings (see chapter 3.2)
- Edit: edit the contact data of the selected device

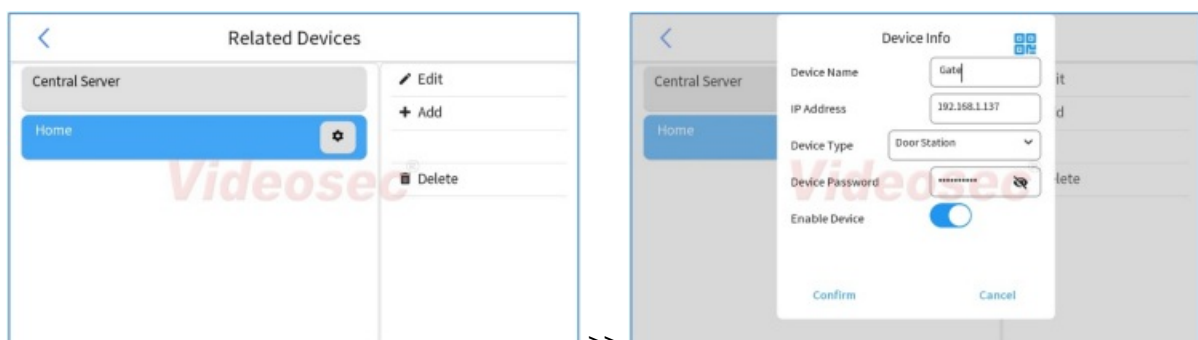

- Add: by clicking the Add button, you can add additional devices:

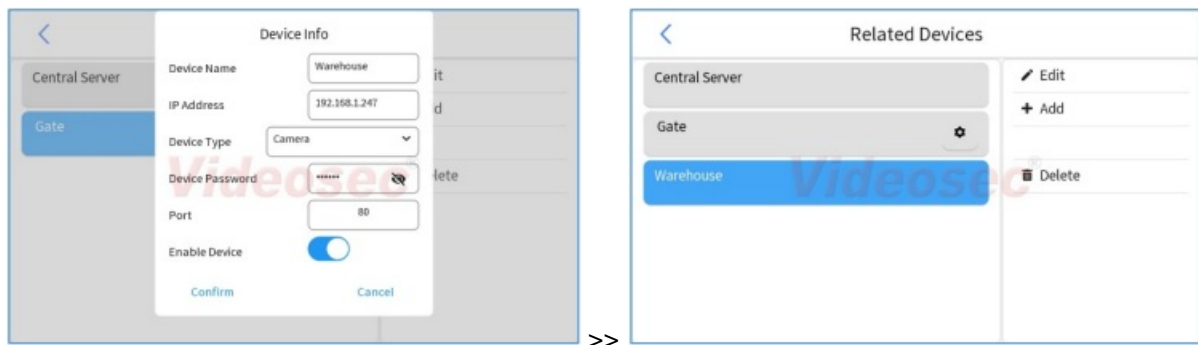

Note:

- A total of 20 units can be used in one system: 1 main indoor unit, max. 19 outdoor units and IP cameras in any distribution
- From IP cameras, it is possible to add Videosec Smart IP cameras with Private protocol, secondary stream, from the same local network.

3.5.2.2 Indoor stations

In the case of additional indoor units, they appear here and can be set as Extension units.

Indoor Stations		
Room Name	IP Address	Extension No.
Videosec®		

3.5.2.3 Device discovery

Automatic search for outdoor units.

Device Discovery					
Product Type	SN Code	IP Address	Settings	Status	
ODI-201W-R	215	192.168.1.137	⚙️	✅	
Videosec®					

3.5.3 Administrator password

Changing the password for the admin user:

Administration Configuration	
Indoor Station	Old Password <input type="password"/>
Devices	A strong password is required (9 to 32 characters including all three elements: digits, letters, and special characters).
Administrator Password	New Password <input type="password"/>
Device Maintenance	Confirm <input type="password"/>
Apply	

3.5.4 Administration configuration



- Reboot the indoor intercom: the device will reboot when you touch the Reboot button
- Reset settings: drag the slider to the right to reset user and network data, otherwise they will not be deleted during the reset
- Data storage: information about the current status of the inserted Micro SD card
- Formatting: formatting the inserted Micro SD card
- P2P Cloud setting



- P2P: enable cloud-based access
- Add without signup: Add to the Guard Live application without registration on the star4live.com cloud server
- Address: cloud server address
- Register code: the device's unique registration code for adding and connecting to the cloud server
- Device status: shows the status of the P2P connection.
- P2P: by clicking the Scan button, a QR code will appear, which can be added to the cloud server by scanning it through the Guard Live application.

4 Mobile application

Receiving and managing calls from outdoor units and using the lookout function can be accessed through the Guard Live application.



Before use, install the Guard Live () application from the application store (Google Play/App Store) corresponding to the operating system of the mobile phone you want to use, and then create a user account.

1. After starting the application, log in to the user account
2. Tap Add Device. button on the home screen, then scan it on the screen that appears
 - a. you can find a QR code on the “Quick User Guide” form in the box of the indoor unit
 - b. via the display, open the QR code under P2P Cloud in the Maintenance menu item (Chapter 3.5.4)

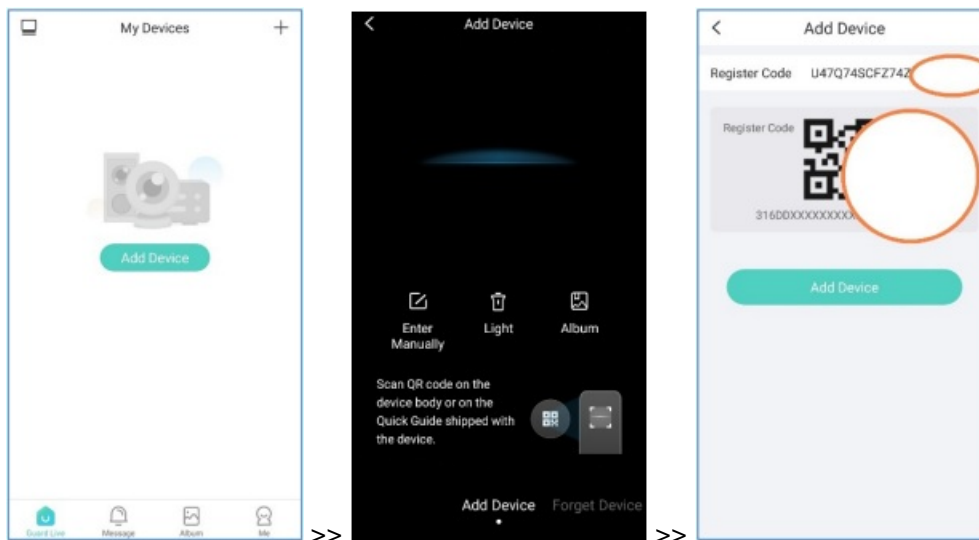

3. After successful addition, set a name for the device for easy identification, then tap OK:

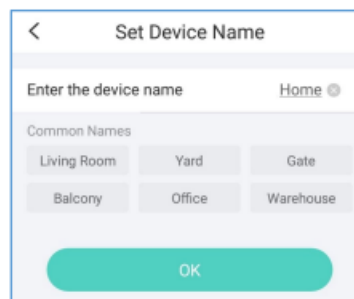

4. After adding, the application will return to the main window, where the device will be displayed offline, but after a few seconds it will go online.

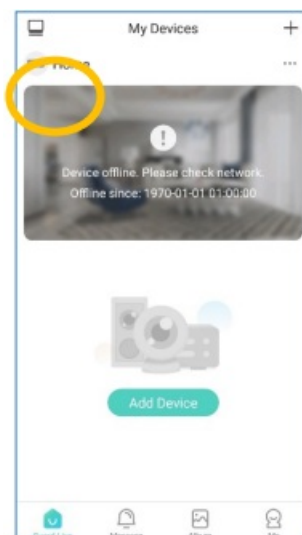

5. Touch the device image to open the live image:

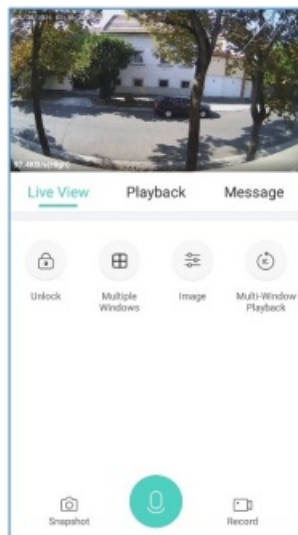

4.1 Basic operations with mobile application

4.1.1 Enable/disable video call notifications

1. To enable call alerts from each device, click the “...” sign in the upper right corner of the device thumbnail on the Home page.
2. Touch the Setup menu item
3. In the window that appears, enable/disable Video Call notifications

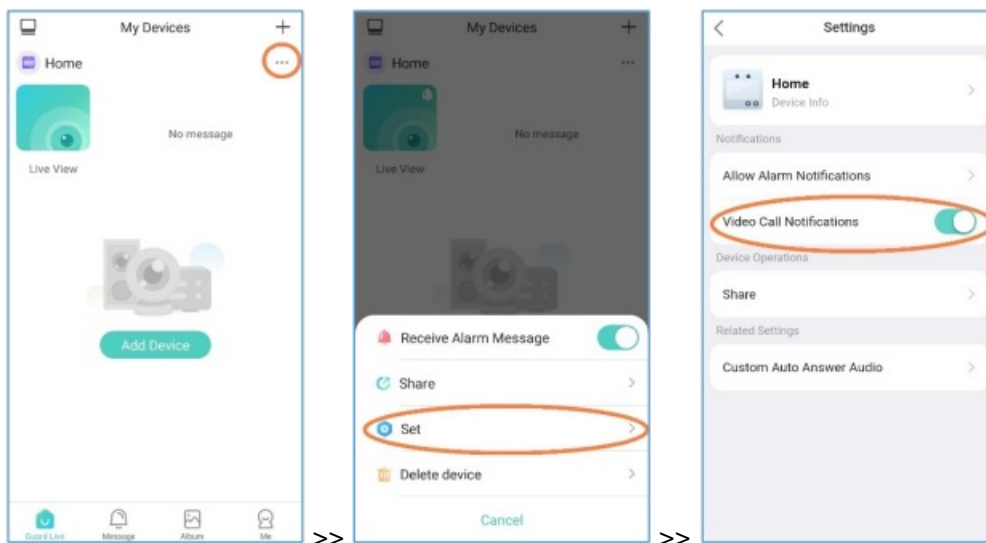

4.1.2 Receiving a call, opening the door lock

In case of an incoming call, the phone switches to full screen mode:

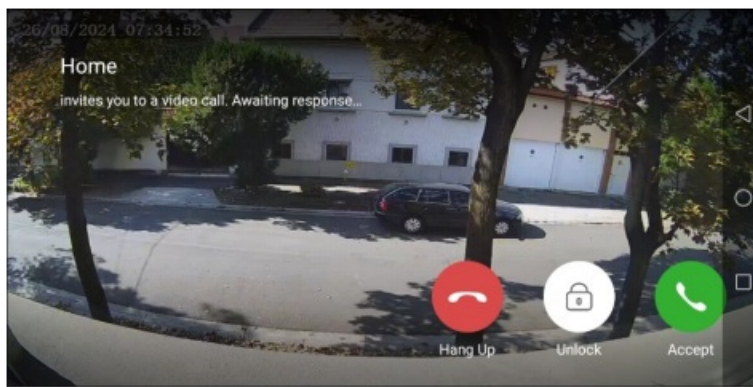

1 2 3

1. Reject a call
2. Open the lock
3. Accept a call



Reject a call



Operation of door lock output(s).



Accept a call

4.1.3 Door lock operation without a call

To operate the electric lock connected to the outdoor unit without a call, tap the Unlock icon in the live view of the device:

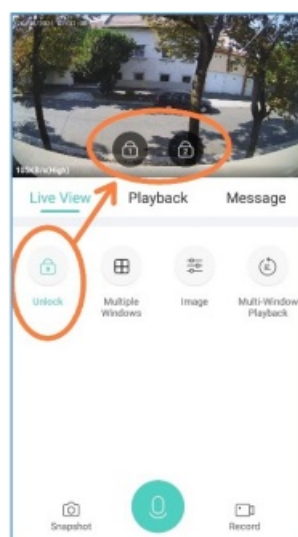

4.1.4 Activate microphone and speaker without a call

With the help of the microphone in the outdoor unit, it is possible to listen to the surrounding sounds without receiving a call, and/or even to speak on the phone. To activate it, tap the two-way audio icon in the device's live view:

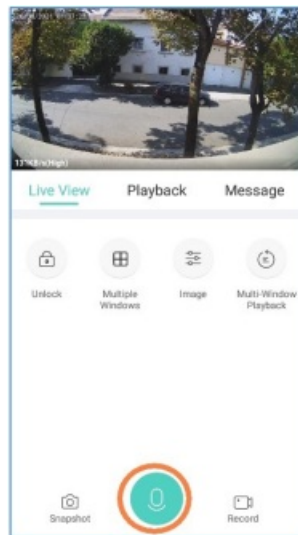

4.2 Access via browser, setting options

4.2.1 Login to the web interface

To access the web interface of the indoor unit, we recommend installing the GuardTools search program from our website. The software can be found under the menu item Support/Software/NVR, IP camera, DVR software (Smart IP platform) or can be downloaded from the following link:

[https://videosec.com/download/software1/GuardTools-R1122.2.6.1\(IN\).exe](https://videosec.com/download/software1/GuardTools-R1122.2.6.1(IN).exe)

The GuardTools program is capable of detecting Videosec intercoms, cameras and recorders connected to the local network.

Default settings:

IP address: 192.168.1.13 (wired LAN, DHCP enabled)

User: admin

Password: 123456

After logging in, the following web interface is visible:

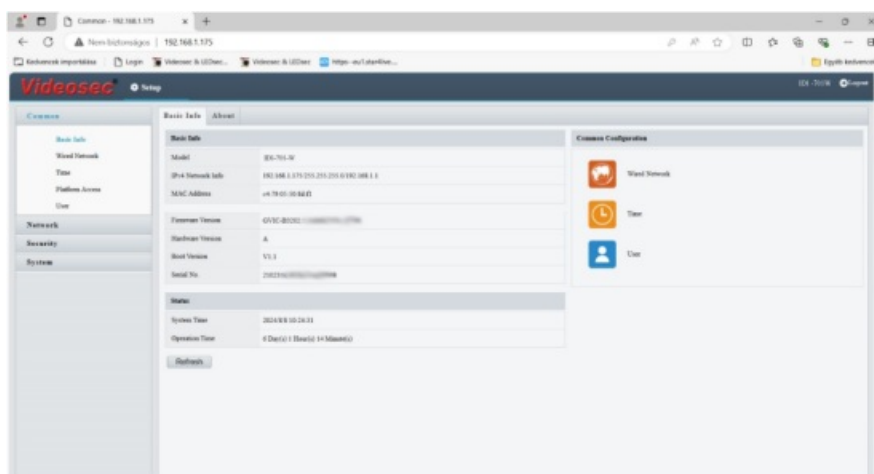

4.2.2 Setting the language of the user interface displayed on the display

The language of the user interface displayed on the display of the indoor unit can be changed in the menu item Setup/System/Maintenance (default language: English)

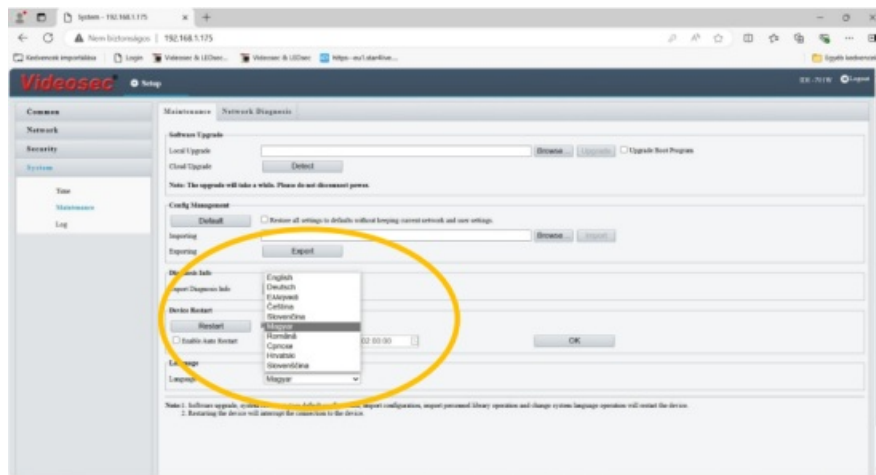

After changing the language, the device will restart automatically.

4.2.3 Setting Wi-Fi network

1. By default, Wi-Fi connection is not enabled, to change the setting, go to Setup/Network/Basic Config, and then open the Wi-Fi tab.



2. After turning on the Wi-Fi, choose from the available 2.4 GHz networks which one you want to connect to or enter the necessary data manually.

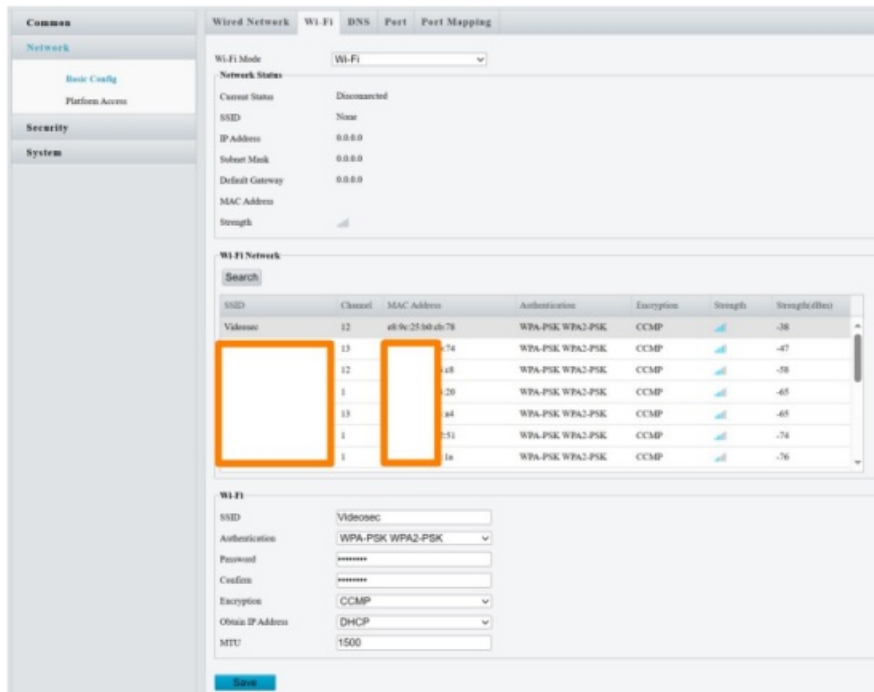

After making the necessary settings, we wish you long-term, problem-free use!

Documents / Resources

	<p>Videosec IDI-701W IP Video Intercom Indoor Station [pdf] User Manual</p> <p>IDI-701W, IDI-701W IP Video Intercom Indoor Station, IDI-701W, IP Video Intercom Indoor Station, Intercom Indoor Station, Indoor Station, Station</p>
---	--

References

- [User Manual](#)

[Manuals+](#), [Privacy Policy](#)

This website is an independent publication and is neither affiliated with nor endorsed by any of the trademark owners. The "Bluetooth®" word mark and logos are registered trademarks owned by Bluetooth SIG, Inc. The "Wi-Fi®" word mark and logos are registered trademarks owned by the Wi-Fi Alliance. Any use of these marks on this website does not imply any affiliation with or endorsement.