



[Home](#) » [vidaxl](#) » **vidaXL 41230 2 Socket Power Strip Stone With Timer User Guide** 

Contents [[hide](#)]

- 1 [vidaXL 41230 2 Socket Power Strip Stone With Timer](#)
- 2 [Introduction](#)
- 3 [Warnings and personal safety](#)
- 4 [Parts list](#)
- 5 [Operation Guide](#)
- 6 [Technical specifications](#)
- 7 [Documents / Resources](#)
 - 7.1 [References](#)



vidaXL 41230 2 Socket Power Strip Stone With Timer



Introduction

This timer is ideal for home security and energy-saving applications. It shows it is working by the movement of the second needle. 15-minute interval settings and 48 on/off cycles per day.

Warnings and personal safety

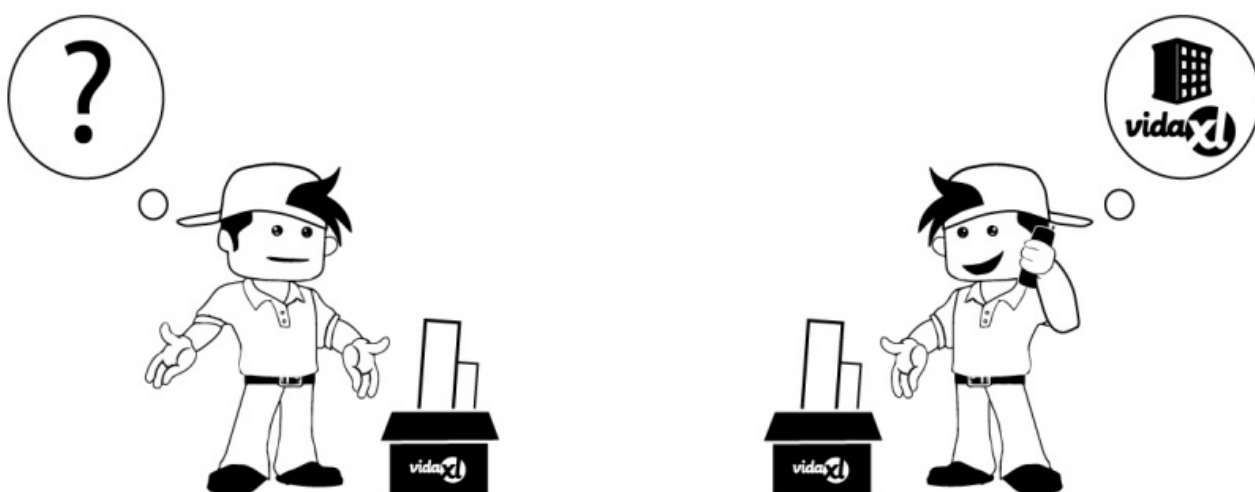

 [vidaXL.help](https://www.vidaXL.help)

- For outdoor and indoor.

- Do not connect this product to any power supply or adapter other than one described in the manual, the name plate, or specifically recommended by VidaXL.
- Electricity is dangerous.
- Damage and improper use or alteration, such as replacement of individual components, can lead to the product and the mains wiring, resulting in electric shock and serious injuries to the user.
- Do not operate this product in the presence of explosives such as flammable liquids, gases, and dust or in extreme temperatures.
- Do not place the product near any form of liquid to avoid damage to the internal parts and an electric shock.
- Do not switch on and operate this product if it has a damaged cord or plug, or if it has been damaged or dropped into the water.
- Contact the customer care or an experienced technician for any repair or replacement.
- Disconnect the plug from the mains power supply before making any adjustments or installation.

Parts list

(See image 1)

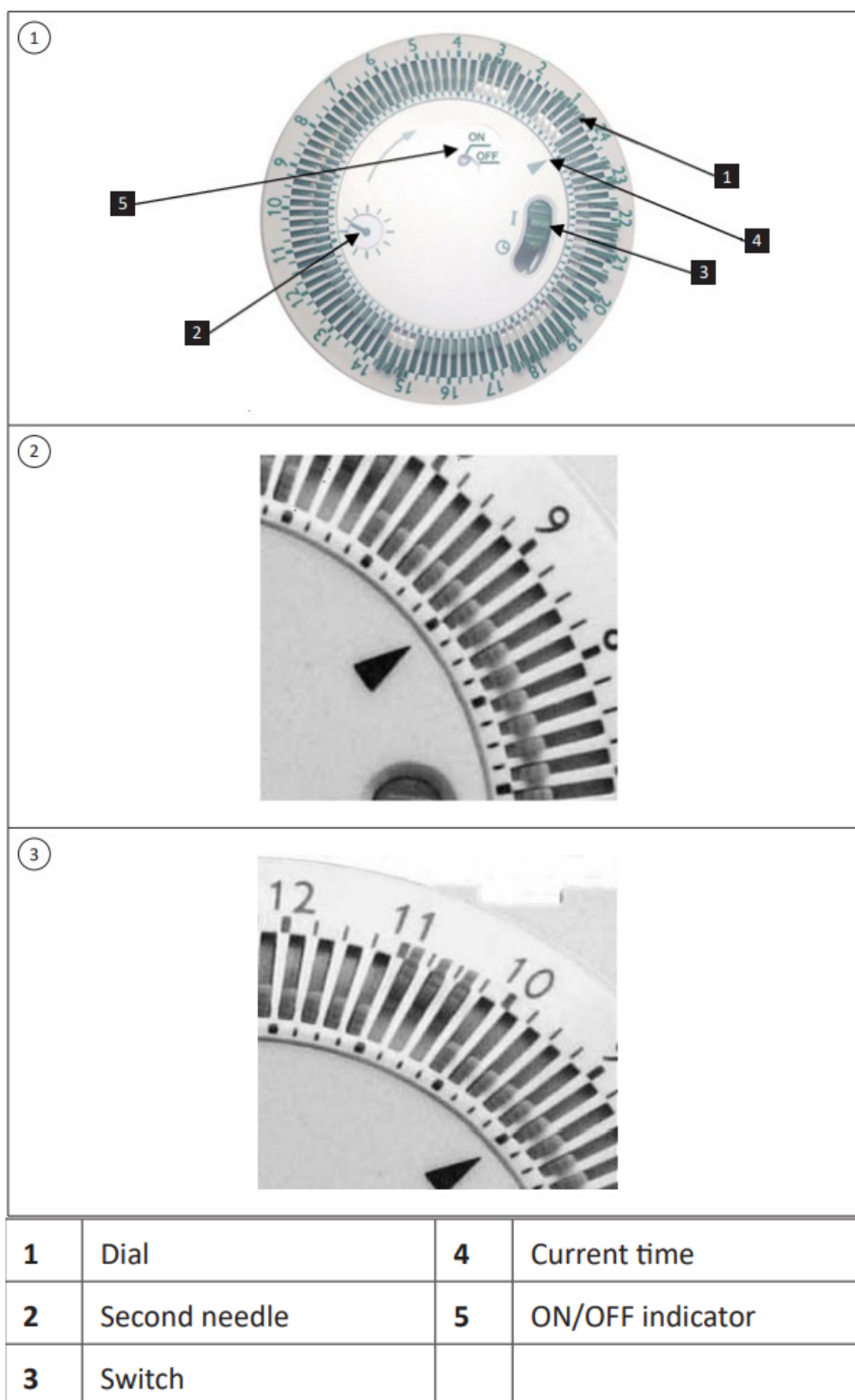

Operation Guide

- Turn the dial clockwise with the arrow pointed to the correct time. (See image 2)

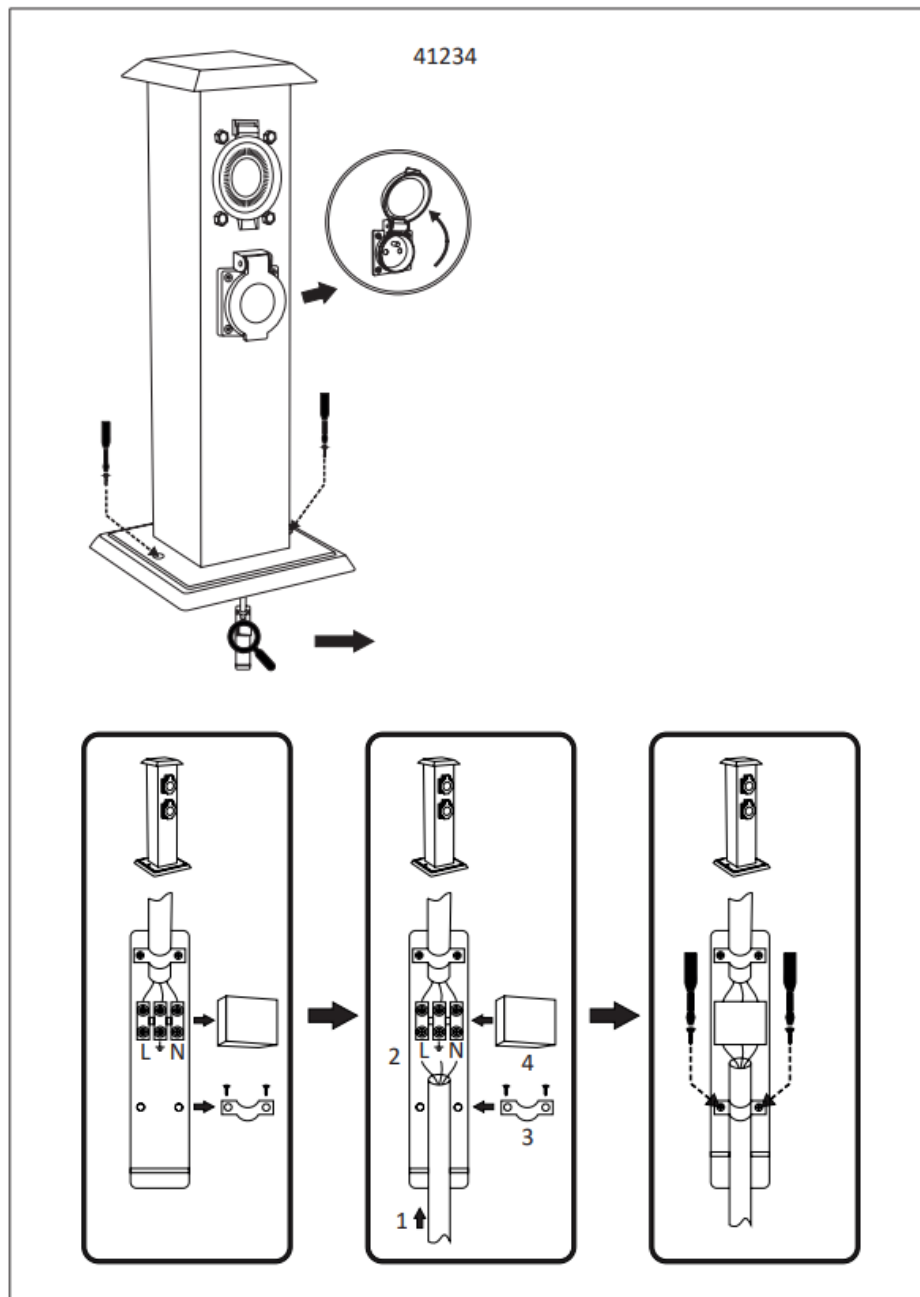

- Push the segments outwards to the ON position. Each segment represents 15 minutes.
- For example, you want to let the electric apparatus work from 10:15 – 11:00.
- Push three segments outwards between 10:15 and 11:00. (See image 3
- Push the switch down to the image of clock 2 and the timer will start.
- If you want to cancel the timer, push the switch up to “I” to permanently keep the timer on. (See image 1)

Technical specifications

Max. 3680W, AC250V, 50Hz, Class I, IP44

vidaXL

Haba Trading B.V.
Mary Kingsleystraat 1, 5928SK Venlo, The Netherlands

HB Commerce PTY LTD
Level 16, 201 Elizabeth Street, Sydney NSW 2000, Australia
vidaXL LLC
2250 Palmetto Ave, Redlands, CA 92374, USA

HBI COMMERCE LIMITED
C/O Tmf Group 8th Floor, 20 Farringdon Street, London, United Kingdom EC4A 4AB
Yaroslavskaya str. 39G, Kyiv, 04071, Ukraine

www.vidaXL.com
SKU : 41230+41234+41237+48542
Batch Nr: 2300336003

Documents / Resources

	vidaXL 41230 2 Socket Power Strip Stone With Timer [pdf] User Guide 41230, 41234, 41237, 48542, 41230 2 Socket Power Strip Stone With Timer, 41230, 2 Socket Power Strip Stone With Timer, Power Strip Stone With Timer, Stone With Timer, Timer
---	---

References

- [User Manual](#)

vidaxl
2 Socket Power Strip Stone With Timer, 41230, 41230 2 Socket Power Strip Stone With Timer, 41234, 41237, 48542, Power Strip Stone With Timer, Stone With Timer, Timer, vidaxl

Leave a comment

Your email address will not be published. Required fields are marked *

Comment *

Name

Email

Website

☐ Save my name, email, and website in this browser for the next time I comment.

Post Comment

Search:

e.g. whirlpool wrf535swhz

Search

[Manuals+](#) | [Upload](#) | [Deep Search](#) | [Privacy Policy](#) | [@manuals.plus](#) | [YouTube](#)

This website is an independent publication and is neither affiliated with nor endorsed by any of the trademark owners. The "Bluetooth®" word mark and logos are registered trademarks owned by Bluetooth SIG, Inc. The "Wi-Fi®" word mark and logos are registered trademarks owned by the Wi-Fi Alliance. Any use of these marks on this website does not imply any affiliation with or endorsement.