



VICON Capture.U Wireless Sensor User Guide

[Home](#) » [VICON](#) » VICON Capture.U Wireless Sensor User Guide 

Contents

- [1 VICON- Capture.U- Wireless - Sensor](#)
- [2 QUICK START GUIDE](#)
- [3 Documents / Resources](#)
- [4 Related Posts](#)



VICON- Capture.U- Wireless -Sensor



QUICK START GUIDE

- What's in the box?
- Blue Trident sensor(s)
- Sensor strap(s)
- IMU adapter(s)
- Micro USB cable(s)

1. Get to know the sensor

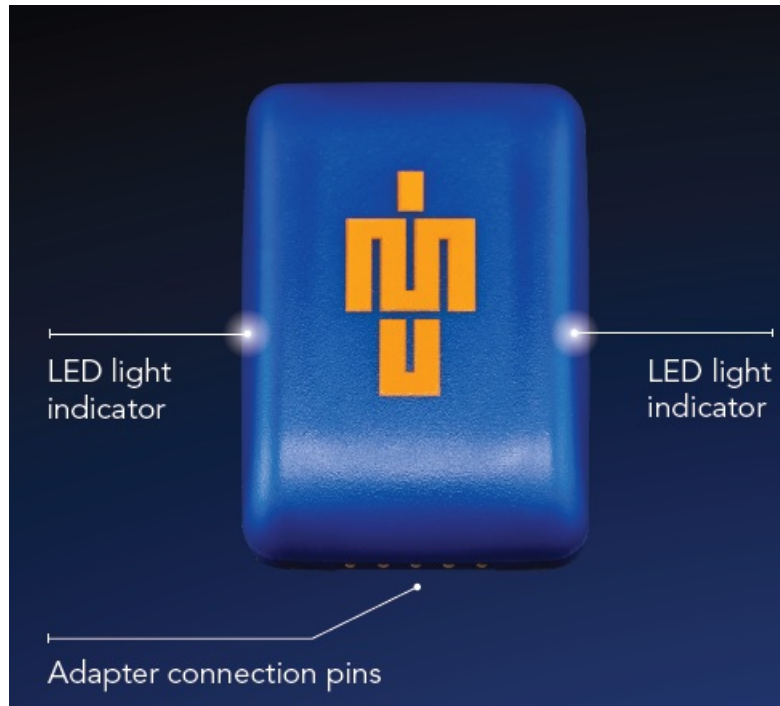

2. Download the Vicon Capture.U app from the App Store to your iOS Device

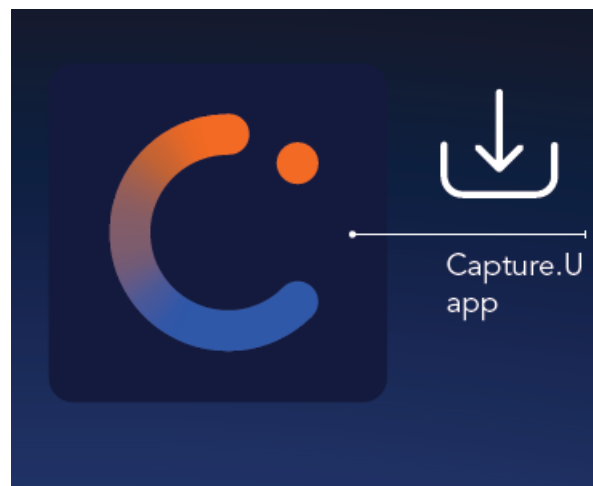

3. Select a mode:

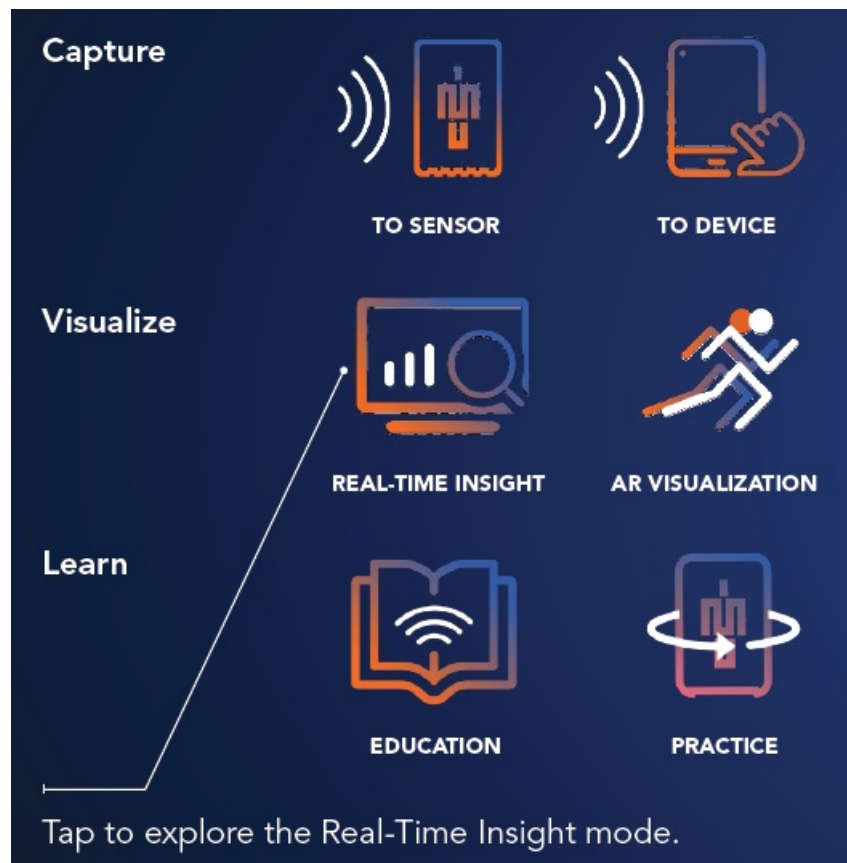

4. Tap Select Sensors (bottom left)

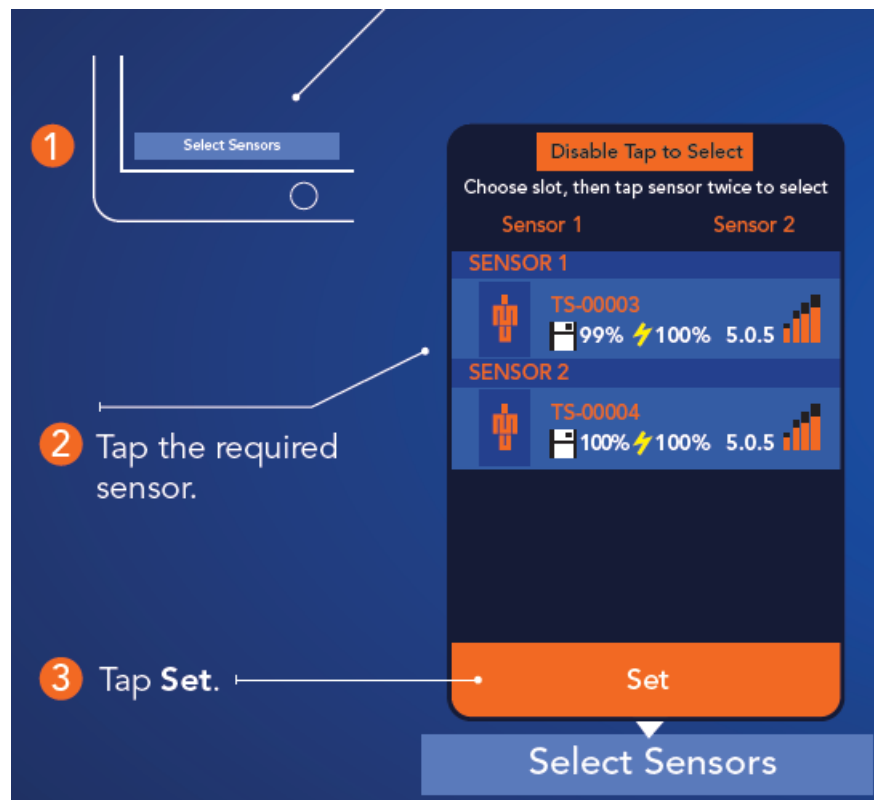

5. Select the data to stream and change the axis graph

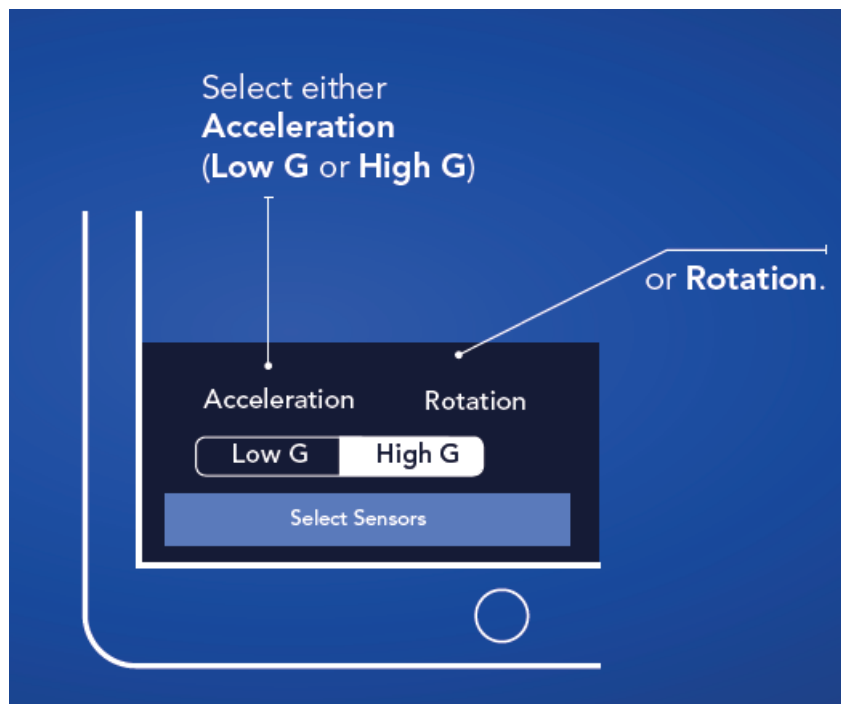

6. Tap the Video icon (top right)

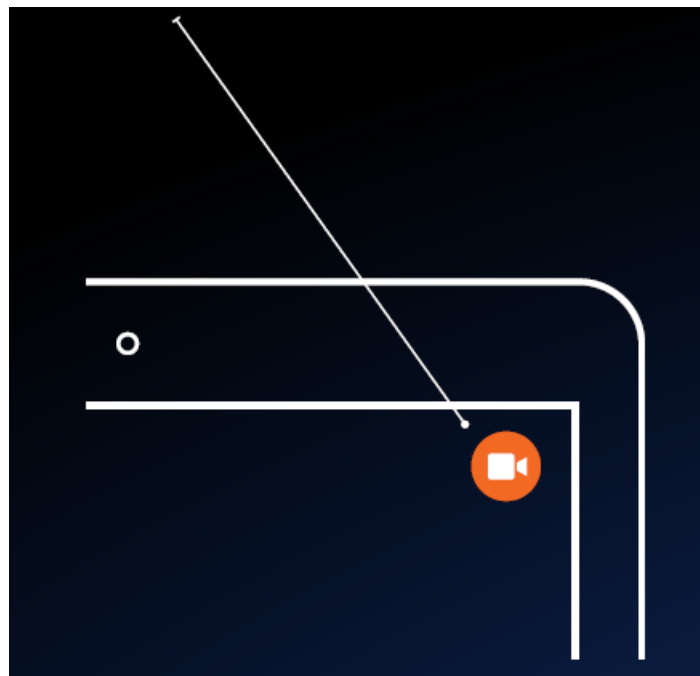

7. Set the benchmarks (bottom right)

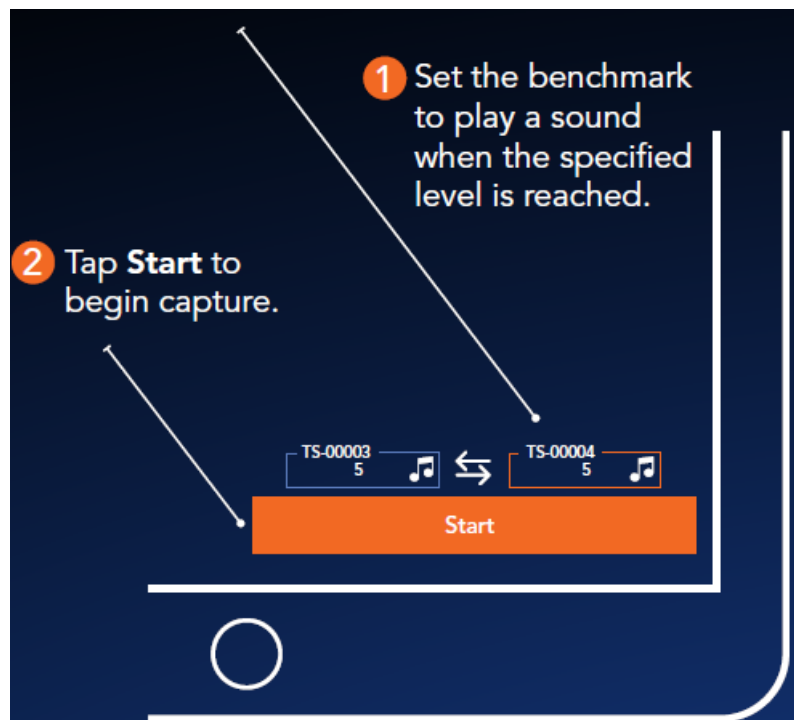

8. Tap the Statistics icon (bottom right)

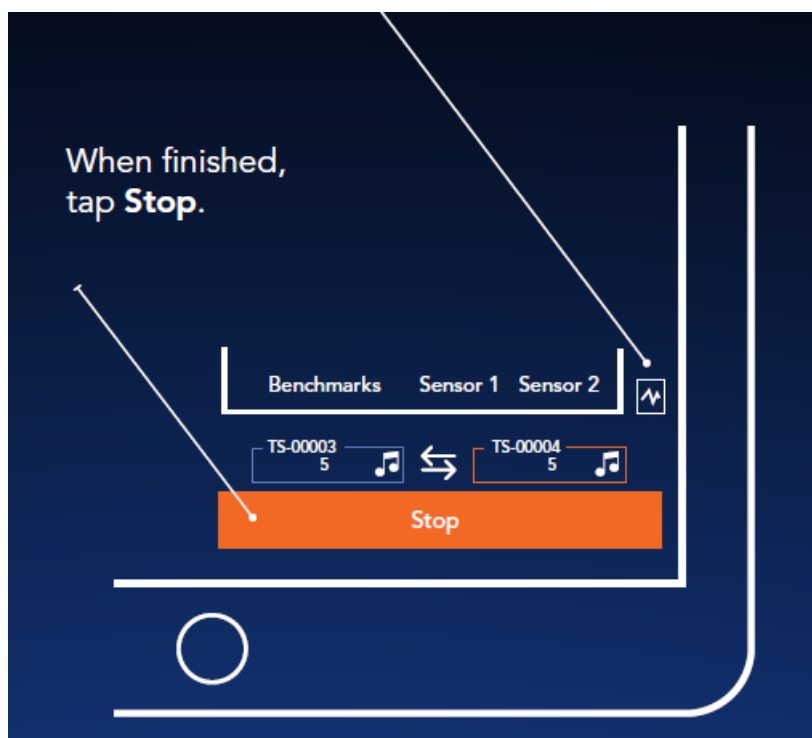

9. Select an export option:

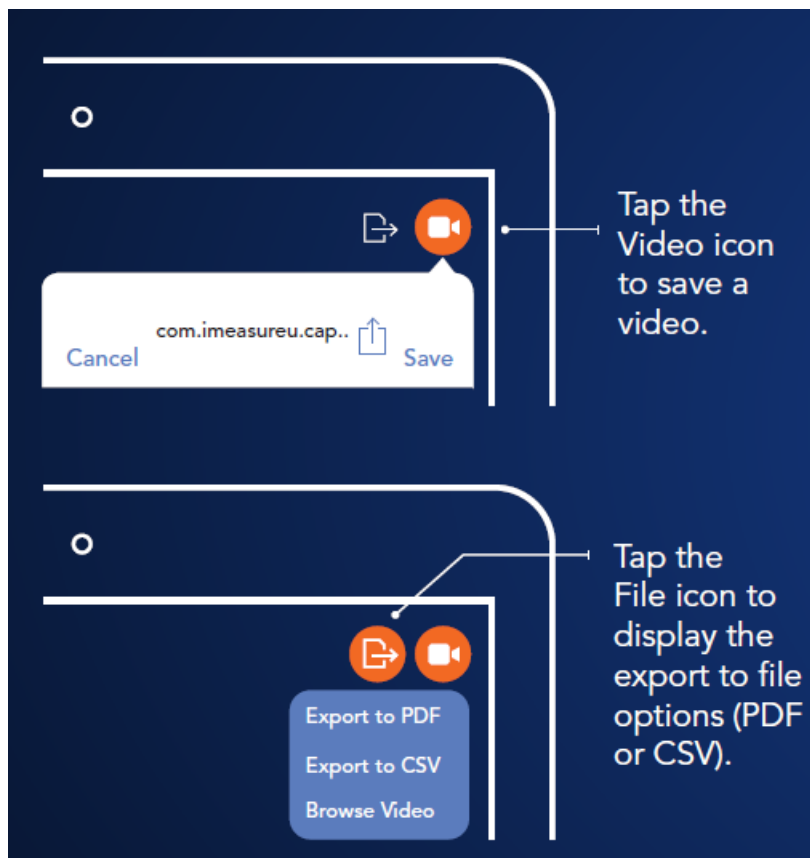

10. Tap Export to PDF to display a PDF Preview



11. Download Capture.U Desktop

www.vicon.com/downloads/software Analyze your data and access walk-throughs and documentation.

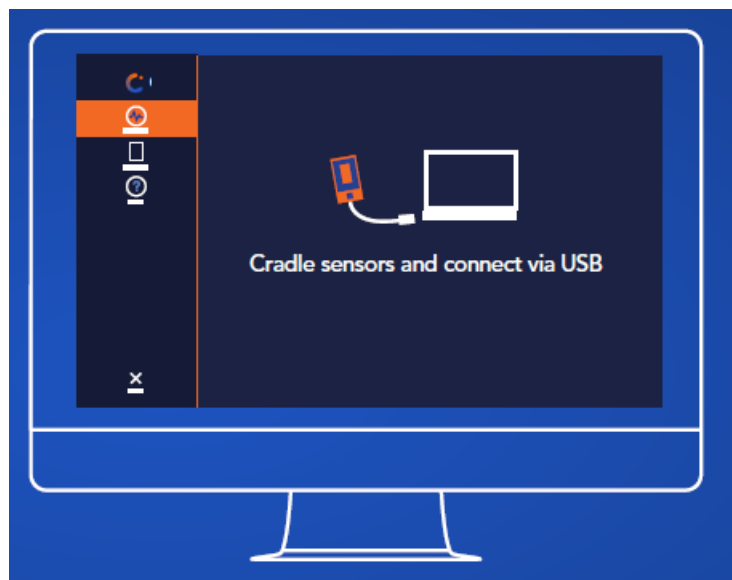

For regulatory information and links to other language versions of this guide, go to docs.vicon.com/display/IMU/. Copyright © 2019 –2022 Vicon Motion Systems Ltd. All rights reserved. Vicon® is a registered trademark of Oxford Metrics plc. IMeasureU is a trademark of IMeasureU Ltd in New Zealand. Other product and company names herein may be the trademarks of their respective owners. Vicon Motion Systems is an Oxford Metrics plc company. IMeasureU is a wholly owned subsidiary of Vicon Motion Systems Ltd.

Documents / Resources



[VICON Capture.U Wireless Sensor](#) [pdf] User Guide
Capture.U Wireless Sensor