



# ViABECS CAN008-X Harness with Simple Soft Canbus Box Instruction Manual

[Home](#) » [ViaBecs](#) » ViABECS CAN008-X Harness with Simple Soft Canbus Box Instruction Manual 



## Contents

- [1 ViABECS CAN008-X Harness with Simple Soft Canbus Box](#)
- [2 Model A](#)
- [3 Model B](#)
- [4 Model C](#)
- [5 Documents / Resources](#)
  - [5.1 References](#)

**ViABECS CAN008-X Harness with Simple Soft Canbus Box**



### Harness with Simple Soft Canbus Box

1. Check if your vehicle's factory radio matches the provided picture below.
2. Connect the cable plug that matches your car's head unit.

**Note:** Not all plugs need to be connected. Please note that some factory features may be lost if the factory radio is removed, such as a CD player.

### Model A

Support factory SWC, Bose AMP, Backup Camera or 360 Camera, USB, A/C info

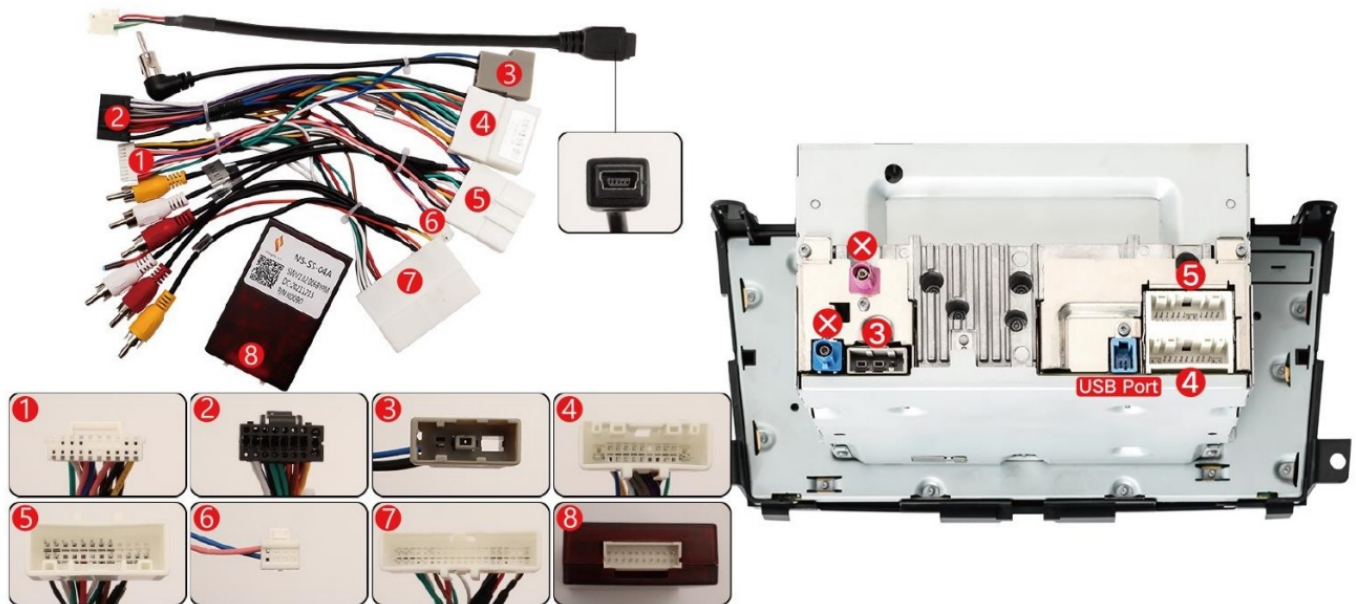

## Model B

Support factory SWC, Bose AMP, Backup Camera or 360 Camera, USB, A/C info

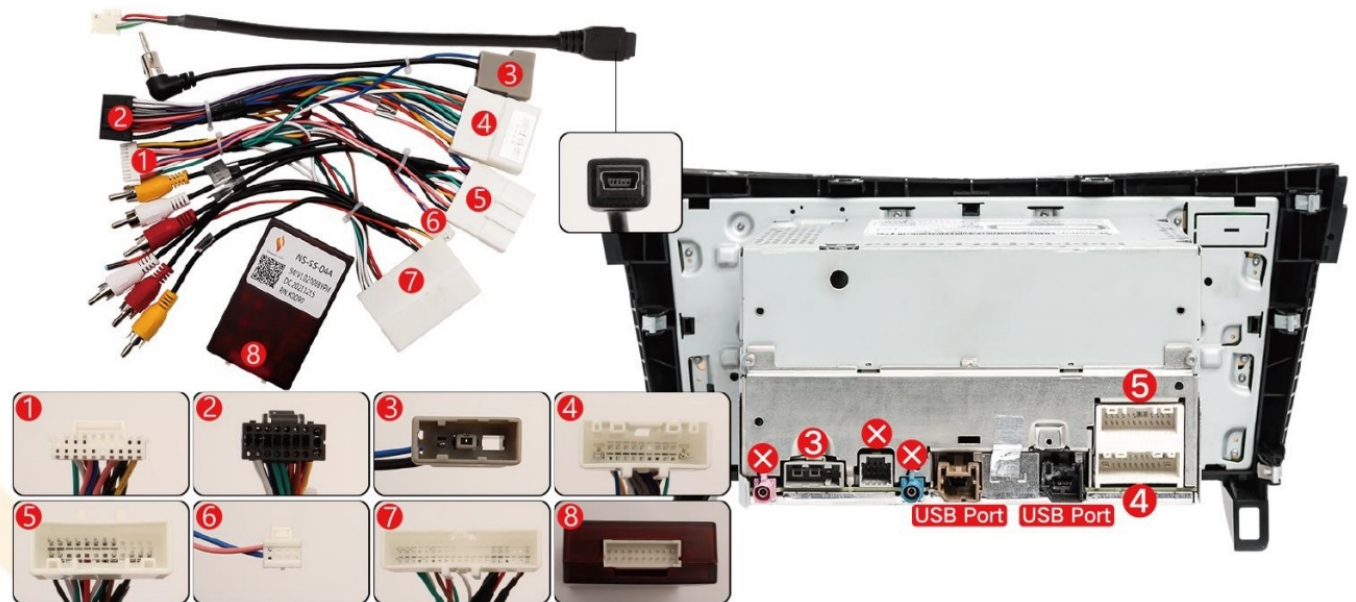

## Model C

Support factory SWC, Bose AMP, Backup Camera or 360 Camera, USB, A/C info

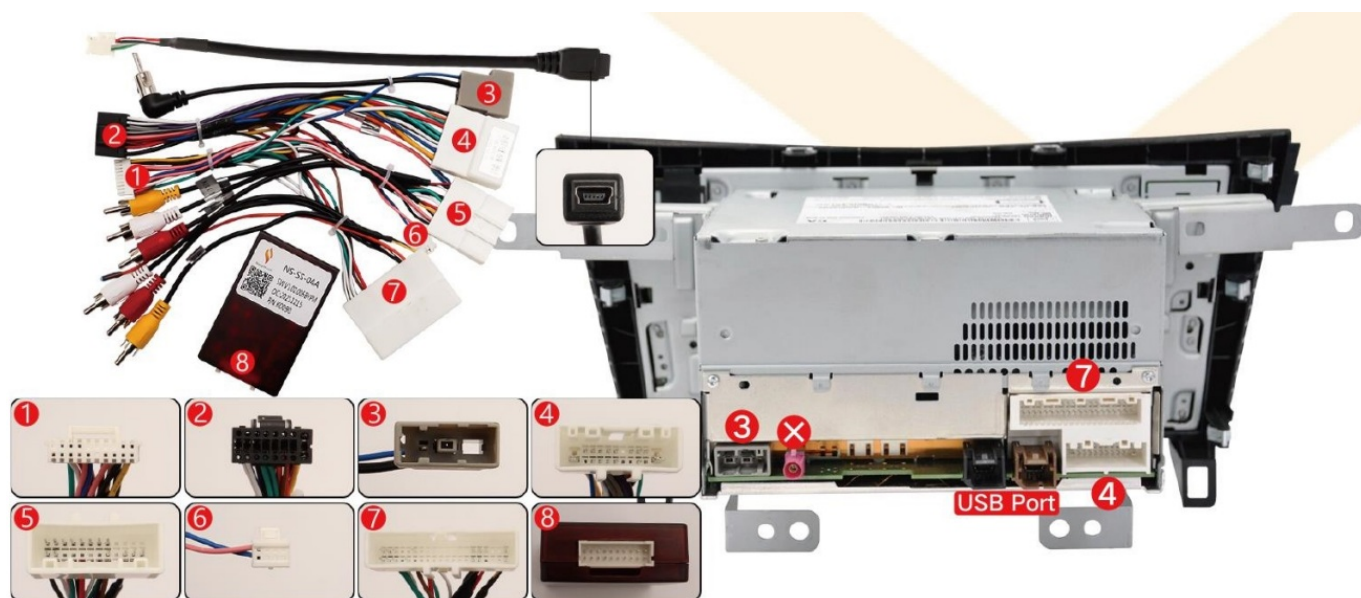

Temperature A/C Control Amplifier



Keep the factory temperature A/C Control Amplifier and install it back. Then connect it to the original harness. Afterward, the factory A/C will display on our head unit. CAN008-X Harness comes with a Simple Soft Canbus box,

**Note:** Please set up the canbus option after you finish the canbus harness. You can contact your radio seller to get the correct canbus option.

- Correct Canbus Option: 03: Simple Soft – 71: Nissan – 01: 2013 Altima – Public



- Video: How to Set Up Canbus Option <https://www.youtube.com/watch?v=oRcBn3C6uns>



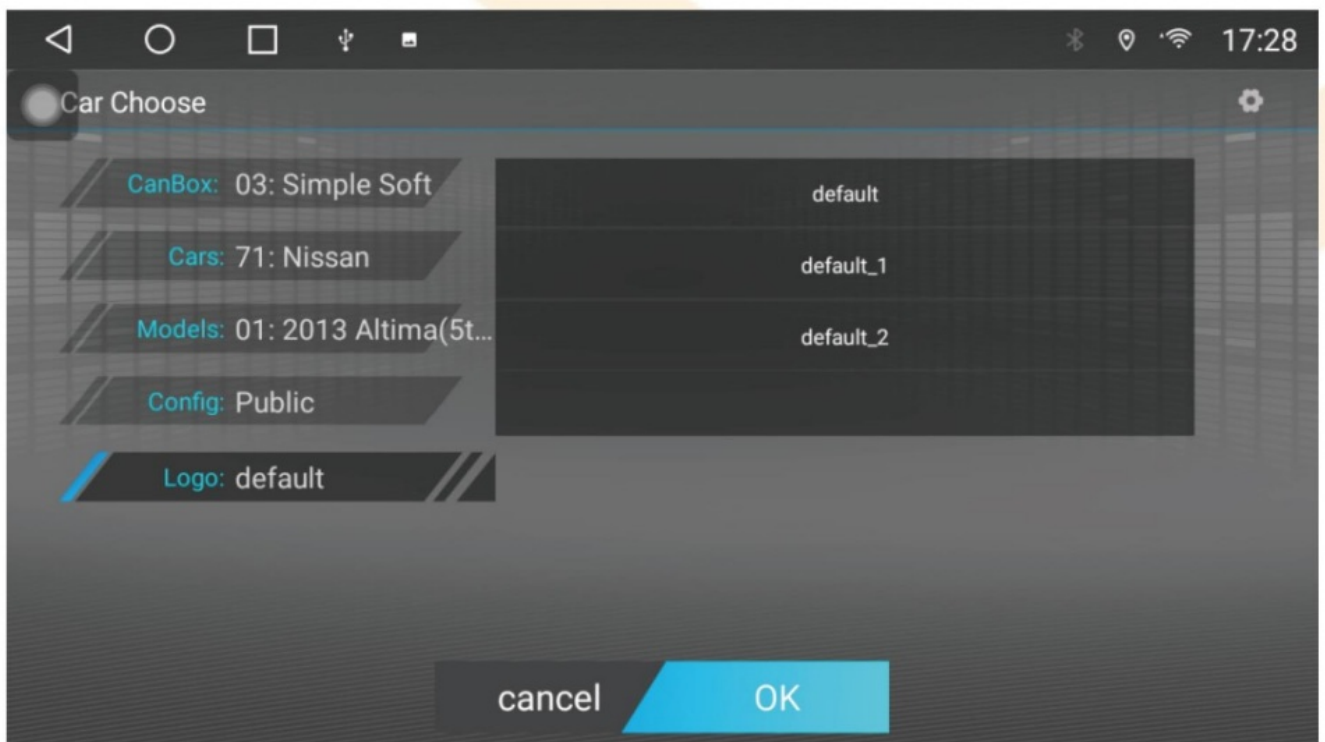

Wiring harness connection diagram

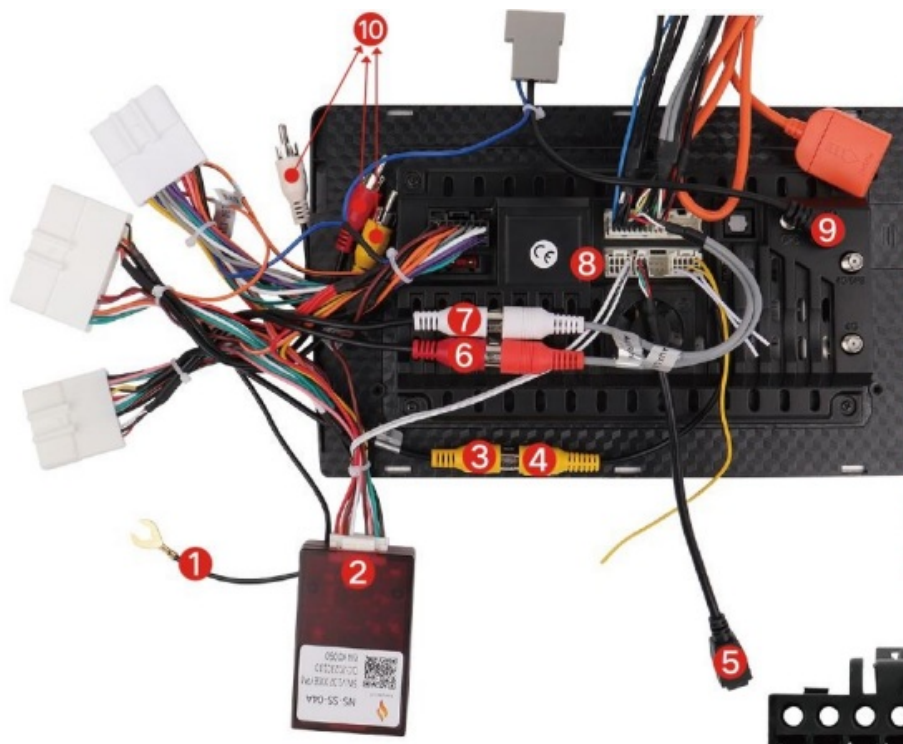

1. GND line to cthe iron part to reduce Noise
2. Canbus box
3. Male rear camera
4. 1 OPIN female CAM VIN & Wifi Line
5. 4PIN USB adapter
6. Red: Male AUX R OUT to Female AUX R IN
7. White: Male AUX L OUT to Female AUX L IN
8. 8PIN Canbus Port

9. O FM/AM radio antenna adapter
10. O, you need to connect them if you connect the 40PIN connector.



If you need assistance or have inquiries, please contact ViaBecs Tech for help. Click our Store Name and then find"Ask a Question". Then you can contact us.

## Documents / Resources

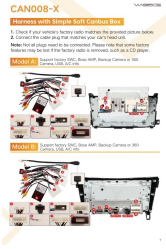
	<a href="#">ViABECS CAN008-X Harness with Simple Soft Canbus Box</a> [pdf] Instruction Manual Model A, CAN008-X Harness with Simple Soft Canbus Box, CAN008-X, Harness with Simple S oft Canbus Box, Simple Soft Canbus Box, Soft Canbus Box, Canbus Box, Box, Harness
---	--

## References

- [User Manual](#)

[Manuals+](#), [Privacy Policy](#)

This website is an independent publication and is neither affiliated with nor endorsed by any of the trademark owners. The "Bluetooth®" word mark and logos are registered trademarks owned by Bluetooth SIG, Inc. The "Wi-Fi®" word mark and logos are registered trademarks owned by the Wi-Fi Alliance. Any use of these marks on this website does not imply any affiliation with or endorsement.