



VEX ROBOTICS 280-7729 EXP Controller Instruction Manual

[Home](#) » [VEX ROBOTICS](#) » VEX ROBOTICS 280-7729 EXP Controller Instruction Manual 

Contents

- [1 VEX ROBOTICS 280-7729 EXP Controller](#)
- [2 FEATURES](#)
- [3 To Charge Controller:](#)
- [4 Charge LED Status:/Etat de la LED Charge/
Etat:](#)
- [5 FCC NOTES](#)
- [6 Documents / Resources](#)
- [7 Related Posts](#)



VEX ROBOTICS 280-7729 EXP Controller



FEATURES

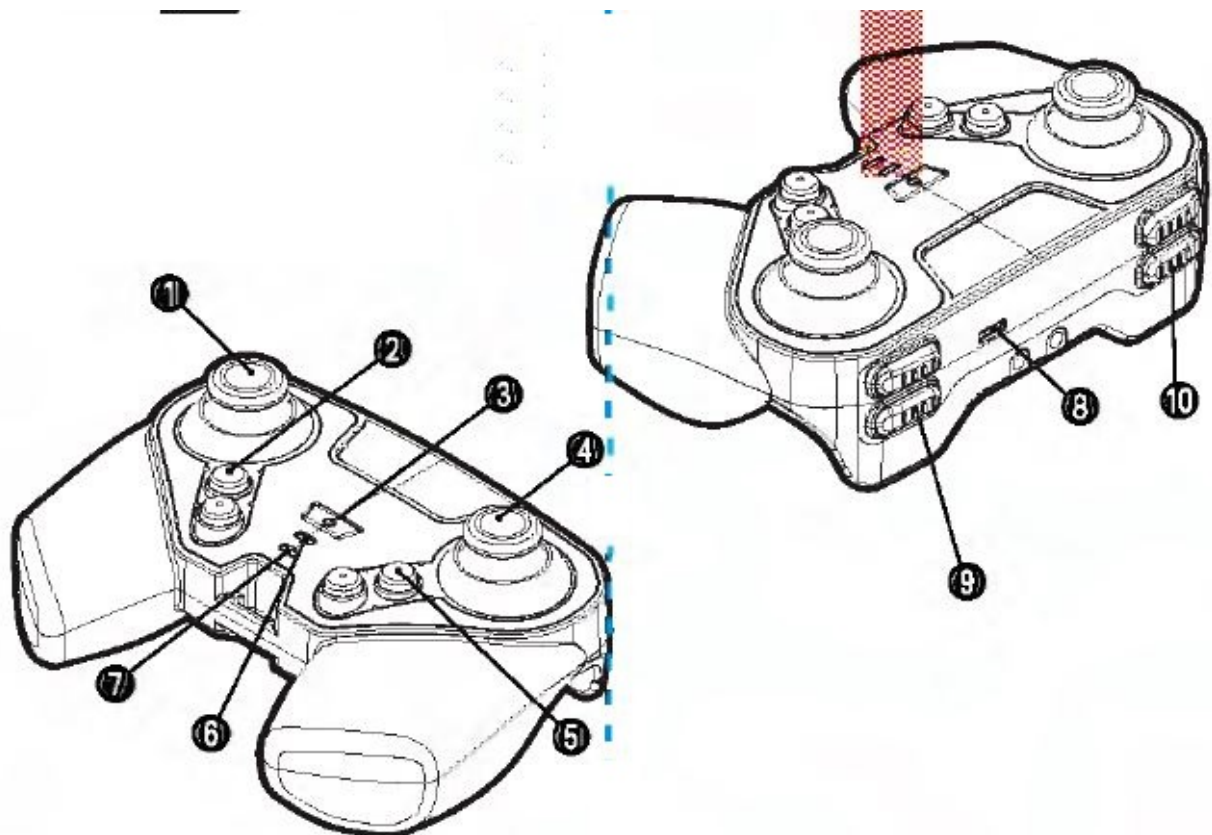

1. L3 Joystick
2. E Buttons E
3. Power Button
4. R3 Joystick/Joystick R3

5. F Buttons F
6. Power/Link LED
7. Charge LEDA..
8. USS Charge Port/PortChargeur USB
9. R Buttons/Boutons R
10. L Buttons/Boutons L

To Charge Controller:

Pour charger la telllcommande:

1. Tum off Controller
2. Connect USBCableA-C(269-6961) to Controller and attach charging adapter
3. Plug into a power outlet
4. Charging will start automatically

Adapter Not Included

Charging Input USBPort (recommended2.4Aor greater,minimum0.5A)

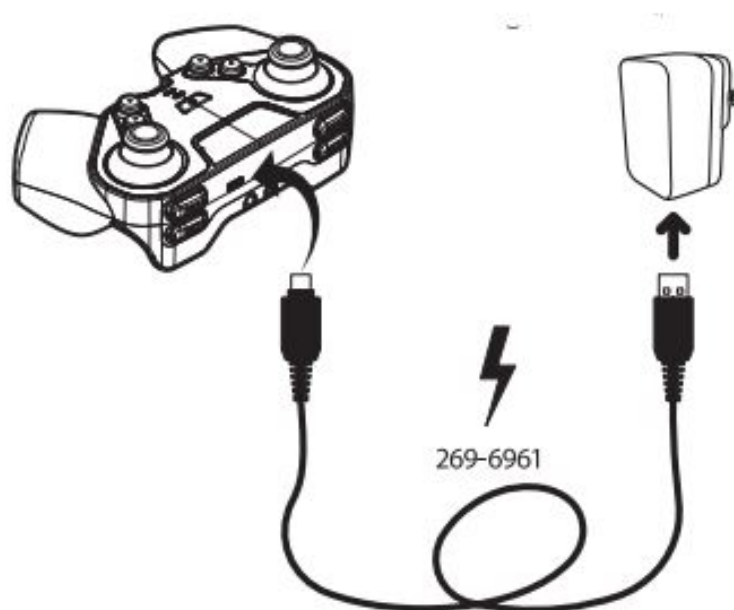

Charge LED Status:/Etat de la LED Charge/ Etat:



Green-Fully Charged
Vert - Totalement chargé



Red-Charging in Progress
Rouge - Chargement en cours



Blinking Red-Battery Fault
Rouge clignotant - Batterie faible

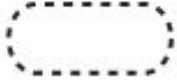

Off-Not Charging
Eteind - Ne charge pas

To tumon/off  press the

power Pour controller

FCC NOTES

This equipment has been tested and found to comply with the limits for a class B digital device This equipment generates, uses and interference will not occur in a particular installati~ If this equipment does cause harm~ul interference to radio or television reception, which can be determined by turning the equipment off and on, the user is encouraged to try to correct the interference by f ne or more of the following measures

- Reorient or relocate the receiving antenna.
- Increase the separation between the equipment and receiver.
- Connect the equipment into an outlet on a circuit, different from that to which the receiver is connected.
- shielded cables must be used ith this unit to ensure compliance with the class BFCC limits

Warning: Changes or modifications to this unit not Jxpressly approved by the party responsible for compliance could void the user's authority to aper.he the equipment.

Documents / Resources

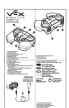

[VEX ROBOTICS 280-7729 EXP Controller](#) [pdf] Instruction Manual
RAD20, UKU-RAD20, UKURAD20, 280-7729 EXP Controller, 280-7729, EXP Controller