

```
[ hide ]
```

- # 6CC 6 in 1 Multi-Functional Trimming Tools
- ## TOOL INSTALLATION
- ### START A COLD KOMBI TOOLS
- #### ts / Resources
- #### ences



1. Attach the handle by placing both pieces of the handle around the trimmer shaft. Fasten both pieces together by tightening the bolts clockwise.
2. Install the grass shield facing trimmer head by placing (4)bolts through the plate grass shield assembly and fasten the bolts to the grass shield clockwise using the larger-sized (4mm) Allen wrench provided.

3. Remove rubber cutting blade cover from grass shield.
4. **FITTING THE BLADE** Insert the 4 mm Allen key through the winding guard and the mounting disc into the opening on the angle gear (blocks the angle gear).



5. Unscrew the locknut (3) from the shaft by turning it clockwise with the spark plug wrench and screwdriver.
6. Remove the floating disc (2) and washer (4). Place the mounting disc (1) on the shaft.
7. Insert the 4 mm Allen key through the winding guard and the mounting disc (1) into the opening on the angle gear (blocks the angle gear).
8. Position the blade 40 teeth. Blades must be installed like fig 8 (teeth toward direction of rotation)



**5** Unscrew the locknut (3) from the shaft by turning it clockwise with the spark plug wrench and screwdriver.

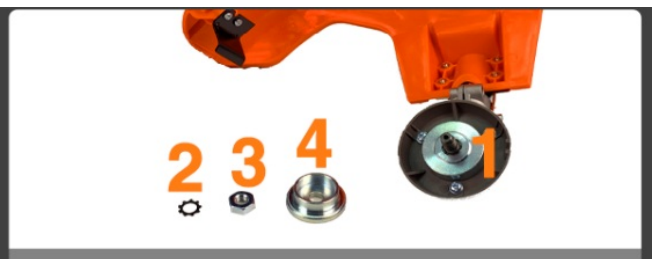

**6** Remove the floating disc (2) and washer (4). Place the mounting disc (1) on the shaft.

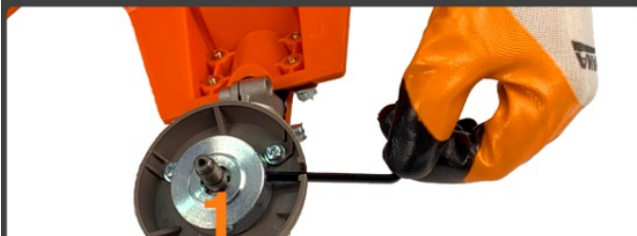

**7** Insert the 4 mm Allen key through the winding guard and the mounting disc (1) into the opening on the angle gear (blocks the angle gear).



**8** Position the blade 40 teeth. Blades must be installed like fig 8 (teeth toward direction of rotation)

9. Set the floating disc(2) onto the blade or circular saw
10. Set screw washer and safety nut
11. Screw down the locknut and tighten it by turning the allen key counterclockwise.  
Remove the Allen key and check for freedom of motion of the blade.
12. Insert Cotter Pin (F) in hole in shaft, and bend pin legs around shaft counterclockwise to retain 10 mm nut.

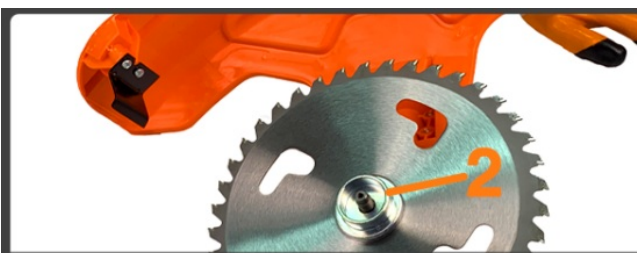

**9** Set the floating disc(2) onto the blade or circular saw

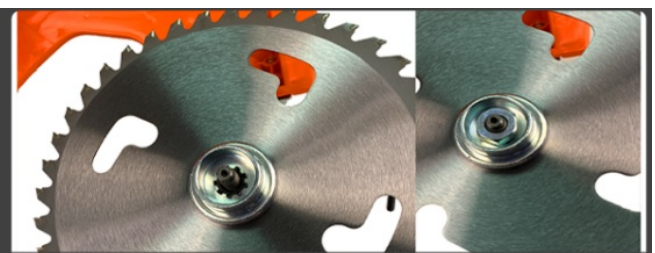

**10** Set screw washer and safety nut



**11** Screw down the locknut and tighten it by turning the allen key counter clockwise. Remove Allen key and check for freedom of motion of the blade.

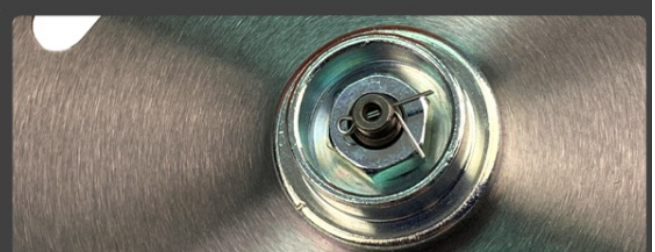

**12** Insert Cotter Pin (F) in hole in shaft, and bend pin legs around shaft counter clockwise to retain 10 mm nut.



13. Insert the 4 mm Allen key through the winding guard and the mounting disc (1) into the opening on the angle gear (blocks the angle gear). Necessary turn the mounting disc (1) slightly.
14. Screw the line spool (A) onto the shaft by turning it counter-clockwise. Now tighten the trimmer head by hand.
15. Loosen screws (A) and remove locator screw (B) on hedge trimmer cutting attachment.
16. Slide the cutting attachment onto the shaft housing until the hole in the neck of the cutting attachment is aligned with the hole (C) in the housing

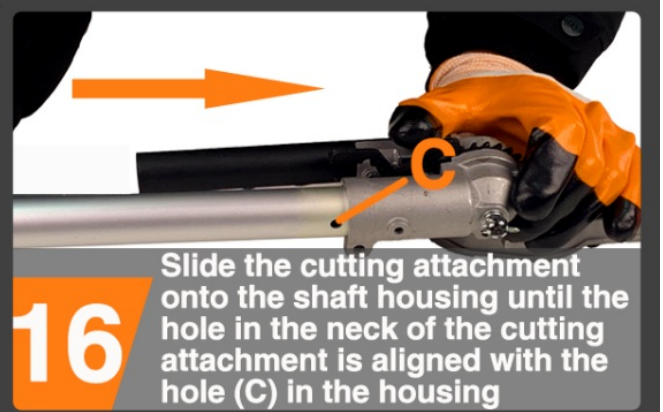
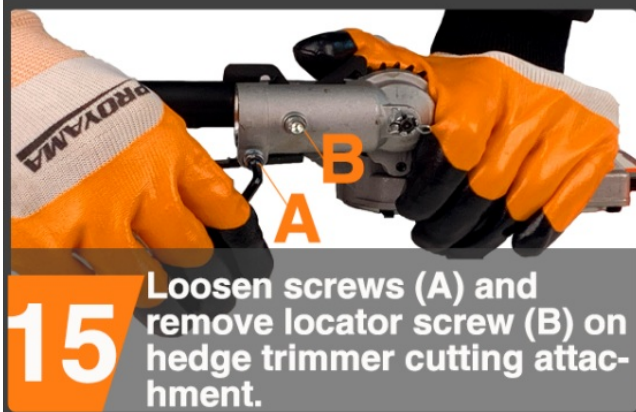
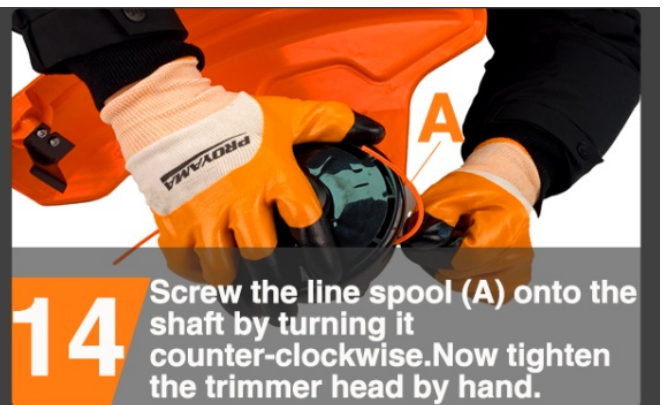

17. Insert locator screw (B) into hole (C) and tighten to snug.
18. FITTING THE POLE SAW Loosen screws (A) and remove locator screw (B) on cutting attachment.
19. Slide the cutting attachment onto the shaft housing until the hole in the neck of the cutting attachment is aligned with the hole (C) in the housing.
20. Insert locator screw (B) into hole (C) and tighten to snug.

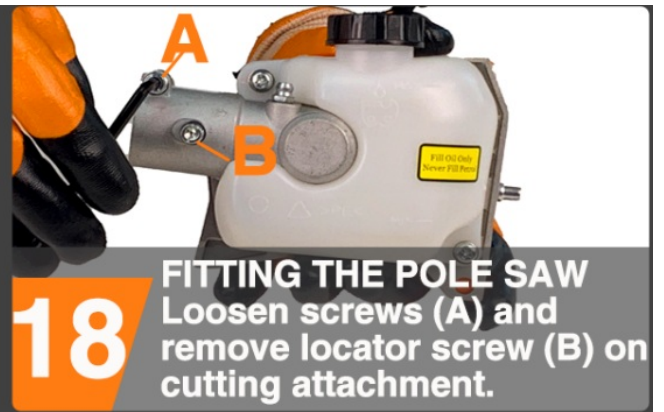

21. Pull out the locking pin, Insert the pole saw attachment shaft, lining up the locking hole with the locking pin.
22. Tighten the clamp by turning the handle (7).
23. Fit the saw chain into the guide bar groove. Make sure the cutters point in the correct direction of rotation. Keep a loop of saw chain at the back end of the guide bar .
24. Loop the saw chain around the drive sprocket and install all the guide bar onto the bar-retaining studs.



**21** Pull out the locking pin, Insert the pole saw attachment shaft, lining up the locking hole with the locking pin.



**22** Tighten the clamp by turning the handle (7).



**23** Fit the saw chain into the guide bar groove . Make sure the cutters point in the correct direction of rotation. Keep a loop of saw chain at the back end of the guide bar .



**24** Loop the saw chain around the drive sprocket and install the guide bar onto the bar-retaining studs.

25. Ensure chain tension adjuster pin fits into the guide bar adjuster hole. If it doesn't fit you may need adjust the position of pin by rotating the tension screw.
26. Install the bar cover. Tighten sprocket guard nuts finger tight.
27. Hold the guide bar tip up
  - Turn the chain-tensioning screw (D) clockwise to tighten the saw chain.
  - Turn the chain-tensioning screw (J) counterclockwise to loosen the saw chain.
28. Hold the bar nose up, and turn the adjuster screw clockwise until chain contacts underside of bar



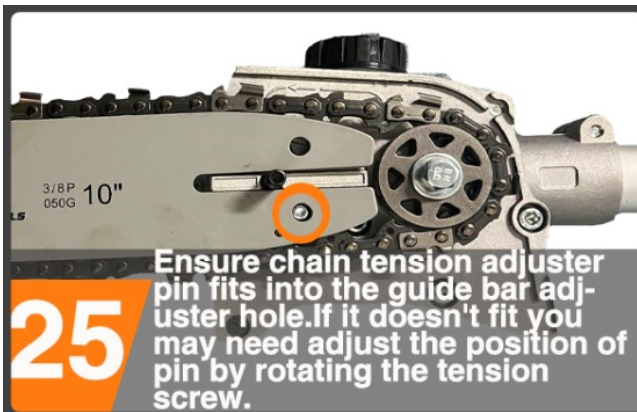

29. Tighten the bar nuts with the combination wrench.

30. Move the saw chain back and forth on the guide bar. If the saw chain does not move freely, loosen the chain tension.

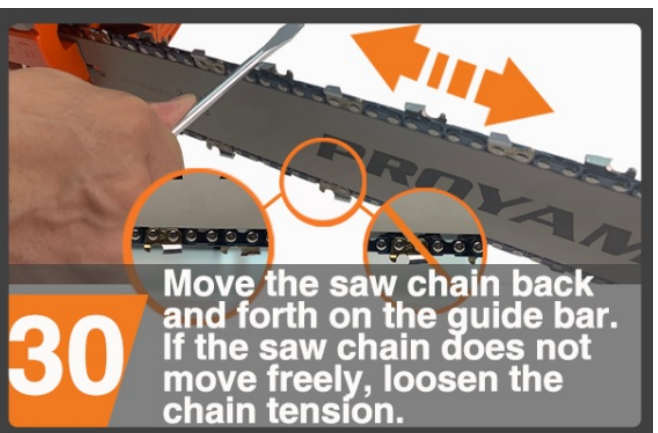

NOTE1: The chain is tensioned correctly the weight of the chain does not cause it to sag below the guide bar (with the chain saw sitting in an upright position), but the chain still moves freely around the guide bar (FIG 12).

NOTE 2: Always loosen sprocket guard nuts before turning the chain tension adjuster; otherwise, the sprocket guard and tensioner will be damaged.

31. Loosen screws (A) and remove locator screw (B) on hedge trimmer cutting attachment.



32. Slide the cutting attachment onto the shaft housing until the hole in the neck of the cutting attachment is aligned with the hole (C) in the housing.
33. Insert locator screw (B) into hole (C) and tighten to snug.

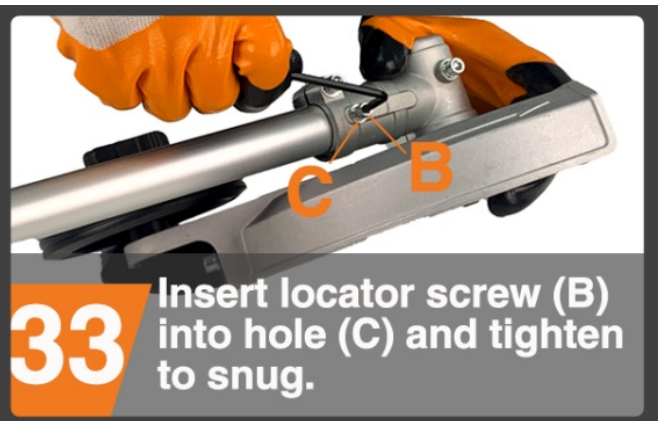
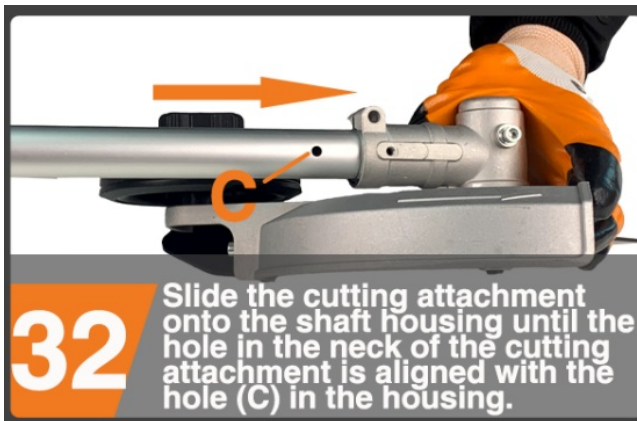

## HOW TO START A COLD KOMBI TOOLS

1. Place the start key in position "I" /Start
2. Push the throttle control lever B and the throttle safety lever at the same time C and keep them in this position whilst pressing the throttle shutter button



3. Release the levers so that the button remains pressed
4. Press the purge bulb 10 times or until bulb is full of fuel



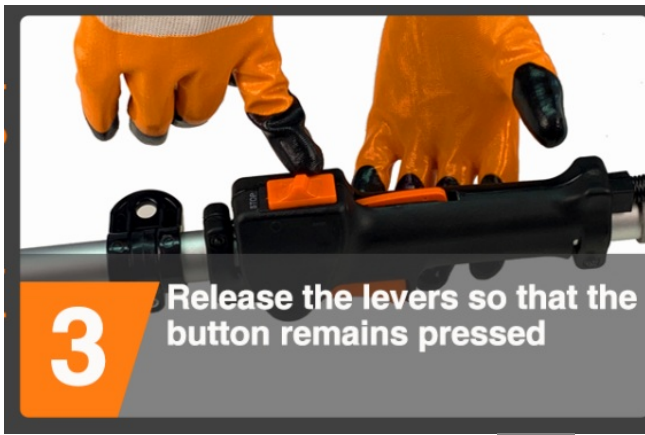

5. :Turn the choke lever upwards.” 

6. Pull starter handle firmly and rapidly several times until first starting sound (pops).

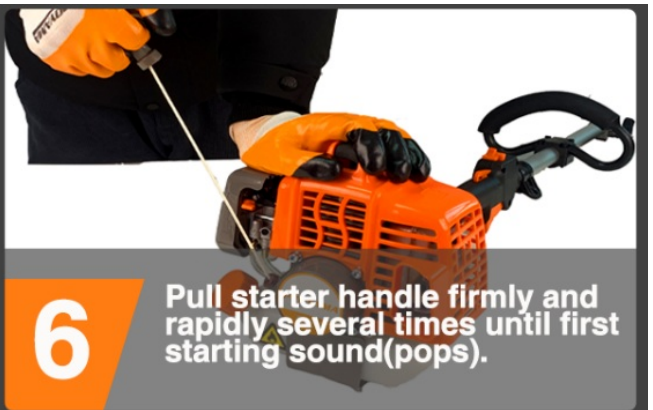

7. push the choke level down 

8. Pull the starter rope rapidly 1-4 times to start the engine.if the engine does not start, repeat steps 4-8.



9. lightly press the accelerator to deactivate the pre-acceleration

10. Allow the engine to warm up for 30 seconds

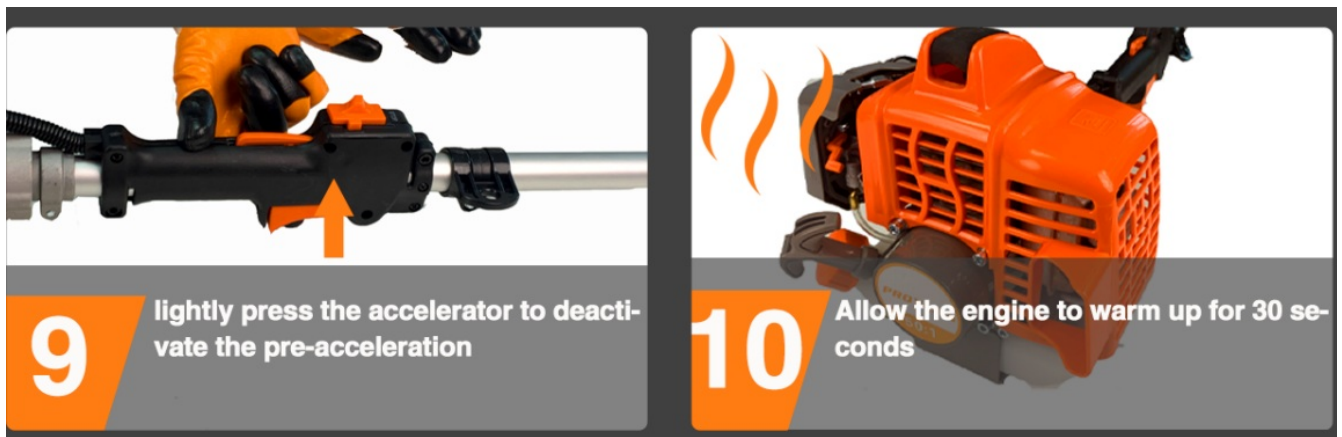

## How to start warm engine



NOTE1:Do not use E15 or E85 fuel (fuel containing ethanol greater than 10% in this product. The use of E15 will damage your engine and void your warranty. FUEL MIXTURE for this product is powered by a 2-cycle engine and requires pre-mixing gasoline and 2-cycle oil in a 50:1 ratio. Pre-mix unleaded gasoline and 2-cycle engine oil in a clean container approved for gasoline.

NOTE2:DO NOT mix quantities larger than usable in a 30-day period.

Any problem contact:[customerservice@proyamatools.com](mailto:customerservice@proyamatools.com)

## Documents / Resources

	<p><a href="#">VEVOR 26CC 6 in 1 Multi Functional Trimming Tools [pdf]</a> Installation Guide</p> <p>PMT26, 26CC, 26CC 6 in 1 Multi Functional Trimming Tools, 6 in 1 Multi Functional Trimming Tools, Multi Functional Trimming Tools, Functional Trimming Tools, Trimming Tools</p>
--	---

## References

- [User Manual](#)

## Leave a comment

Your email address will not be published. Required fields are marked \*

Comment \*

Name

Email

Website

☐ Save my name, email, and website in this browser for the next time I comment.

**Post Comment**

**Search:**

**Search**

[Manuals+](#) | [Upload](#) | [Deep Search](#) | [Privacy Policy](#) | [@manuals.plus](#) | [YouTube](#)

This website is an independent publication and is neither affiliated with nor endorsed by any of the trademark owners. The "Bluetooth®" word mark and logos are registered trademarks owned by Bluetooth SIG, Inc. The "Wi-Fi®" word mark and logos are registered trademarks owned by the Wi-Fi Alliance. Any use of these marks on this website does not imply any affiliation with or endorsement.