

velleman WSL125 Light Sensitive Switch Kit Instruction Manual

[Home](#) » [Velleman](#) » velleman WSL125 Light Sensitive Switch Kit Instruction Manual 

Contents

- [1 Velleman WSL125 Light Sensitive Switch Kit](#)
- [2 OVERVIEW](#)
- [3 TO ALL RESIDENTS OF THE EUROPEAN UNION](#)
- [4 Documents / Resources](#)
- [5 Related Posts](#)



Velleman WSL125 Light Sensitive Switch Kit

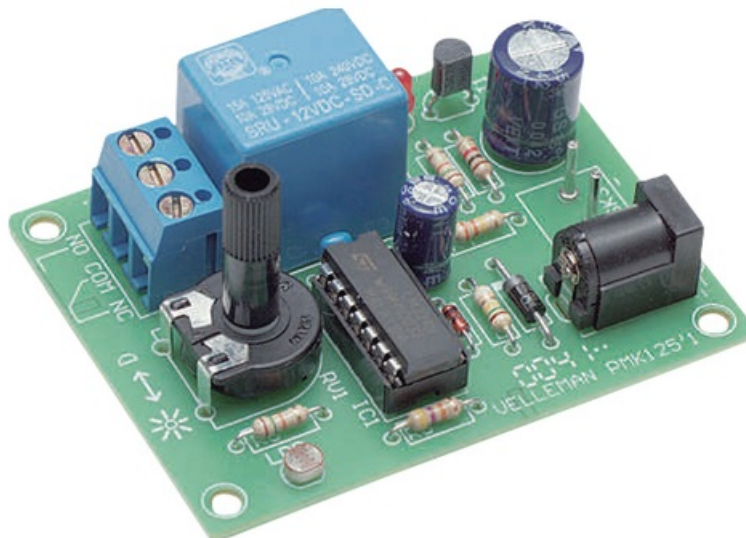

OVERVIEW

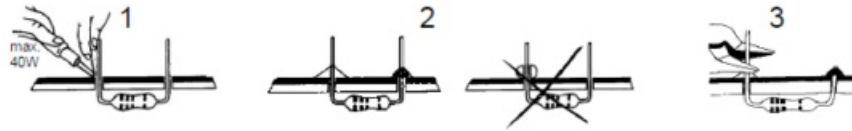

Resistor

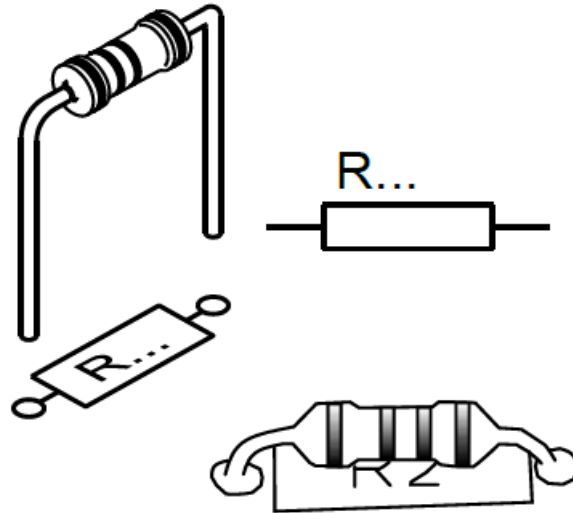

- R1:150K
(Brown, Green, Yellow)
- R2:15K
(Brown, Green, Orange)
- R3:1K
(Brown, Black, Red)
- R4:330K
(Orange, Orange, Yellow)
- R5:15K
(Brown, Green, Orange)
- R6:47K
(Yellow, Purple, Orange)

DIODE Watch the polarity !

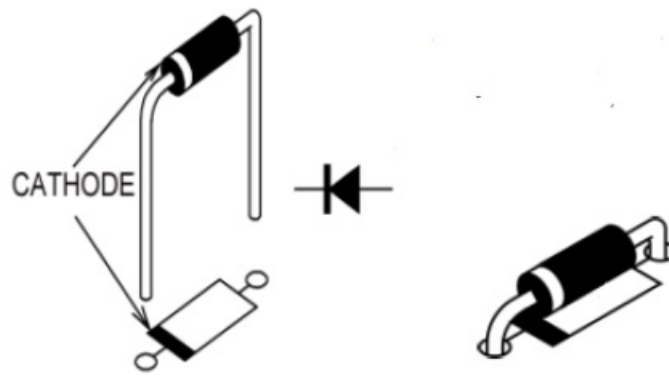

◇ D1 : 1N4007

◇ D2, D3 : 1N4148

• CAPACITOR

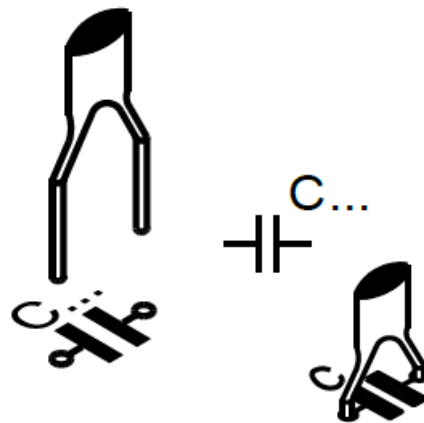

◇ C2 : 100nF

• IC SOCKET

WATCH THE POSITION
OF THE NOTCH !
ATTENTION A LA POSITION DE
L'ENCOCHE !

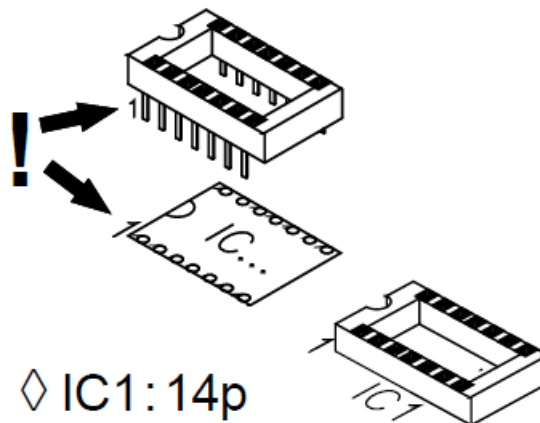

◇ IC1: 14p

• TRANSISTOR

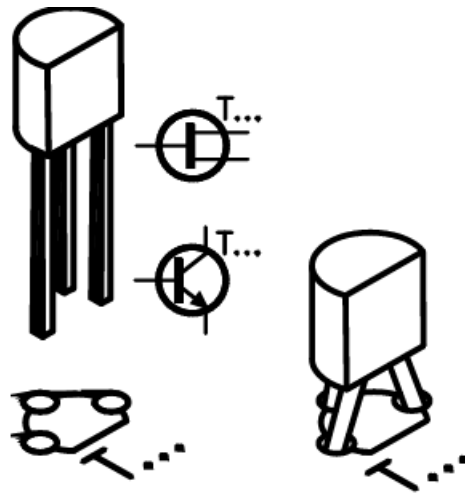

◇ T1 : BC547

• TRIMMER

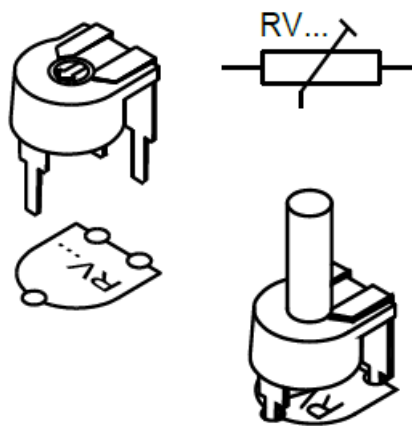

◇ RV1 : 100k

• LED

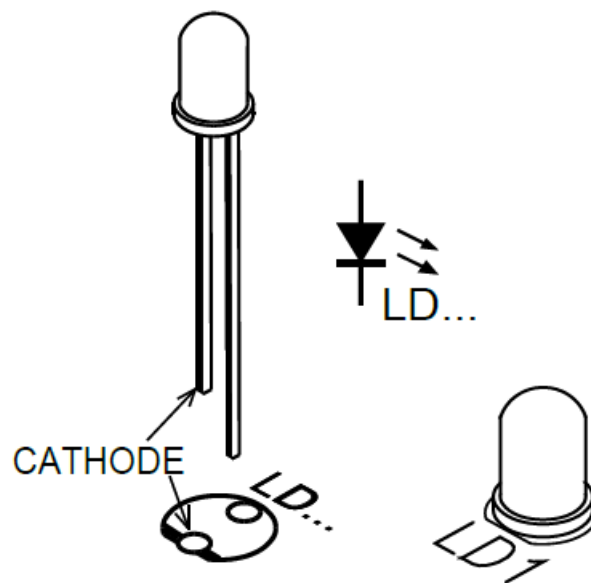

• PCB PINS

◇ SK3

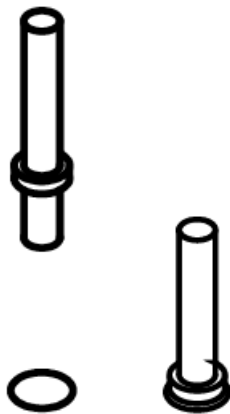

- DC JACK

◇ SK2

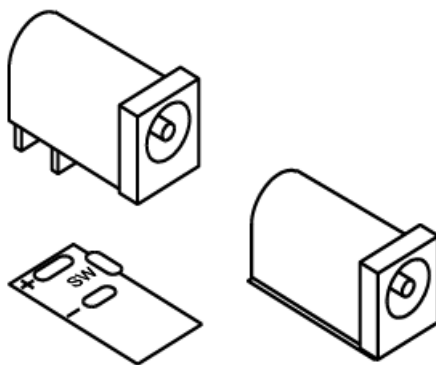

- TERMINAL BLOCK

◇ SK1

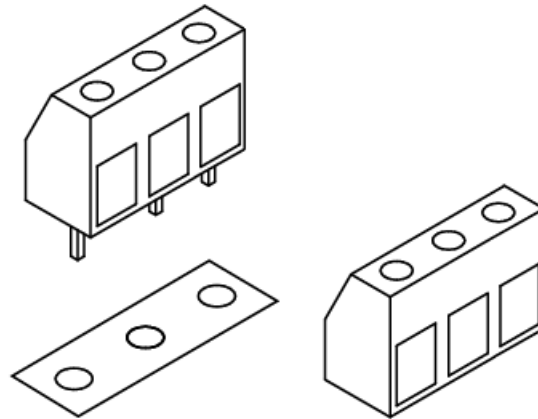

• LDR

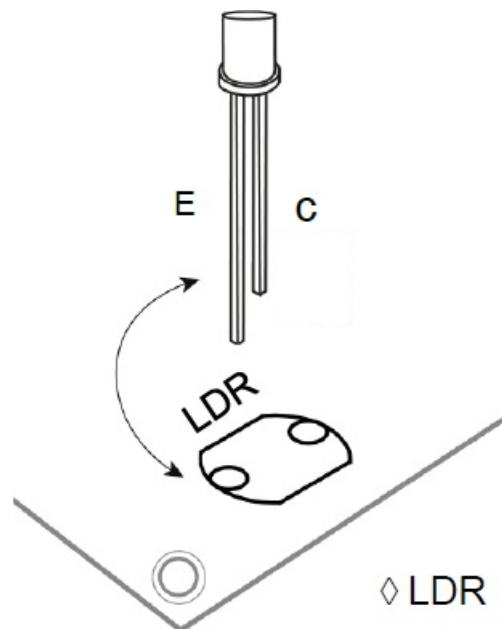

• ELECTROLYTIC CAPACITOR

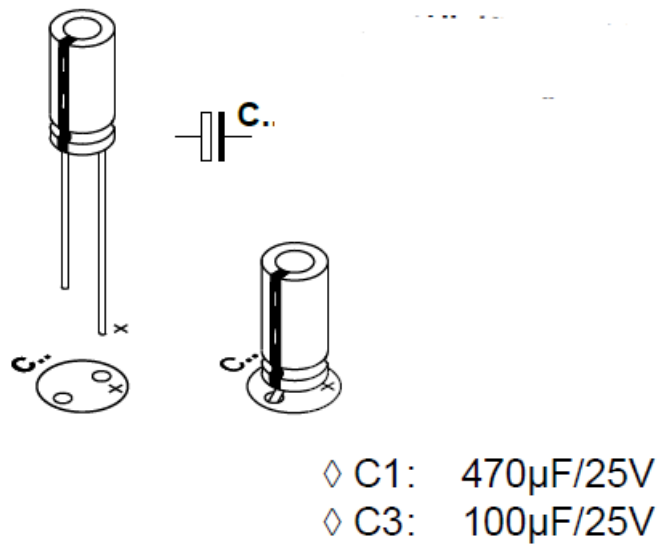

• RELAY

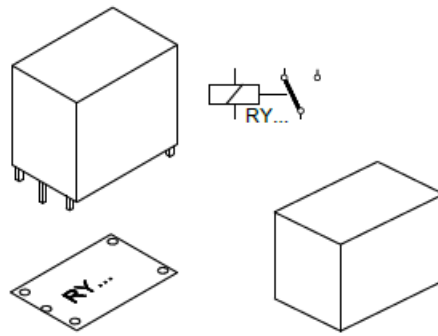

◇ RY1

• IC

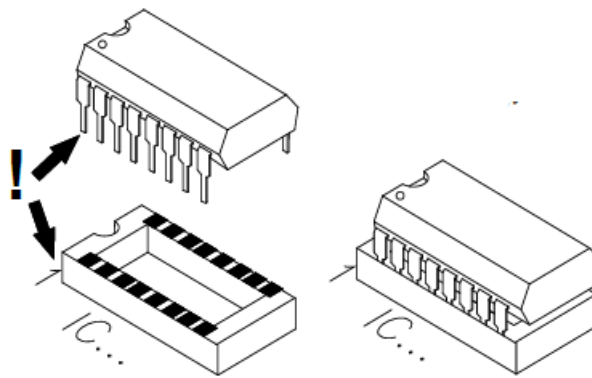

◇ IC1: LM324 (LM224)

• APPLICATION

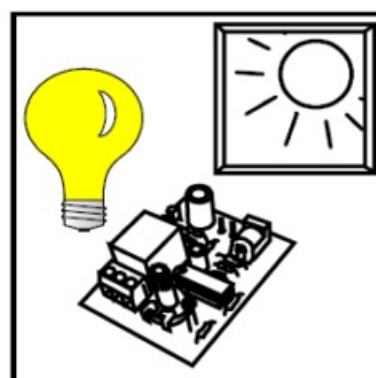

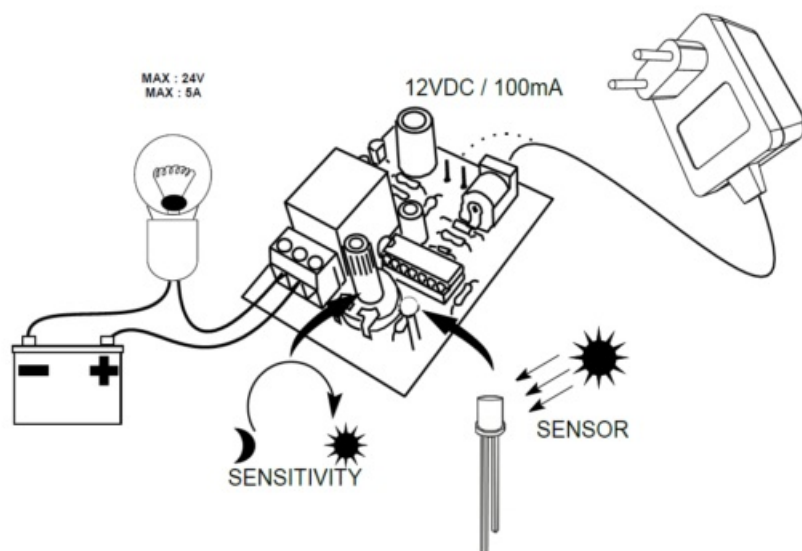

TO ALL RESIDENTS OF THE EUROPEAN UNION

Important environmental information about this product This symbol on this unit or the package, indicates that disposal of this unit after its lifecycle could harm the environment. Do not dispose the unit as unsorted municipal waste; it should be disposed by a specialized company for recycling. This unit should be returned to your distributor or to a local recycling service. Respect the local environmental rules. If any doubt contact your local authorities about waste disposal rules.

Documents / Resources

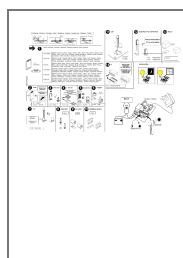

[velleman WSL125 Light Sensitive Switch Kit](#) [pdf] Instruction Manual
WSL125, Light Sensitive Switch Kit, WSL125 Light Sensitive Switch Kit