



Vekkia THOR 1000 Jump Starter and Portable Power Source User Manual

[Home](#) » [Vekkia](#) » Vekkia THOR 1000 Jump Starter and Portable Power Source User Manual



User Manual
Jump Starter& Portable Power Source

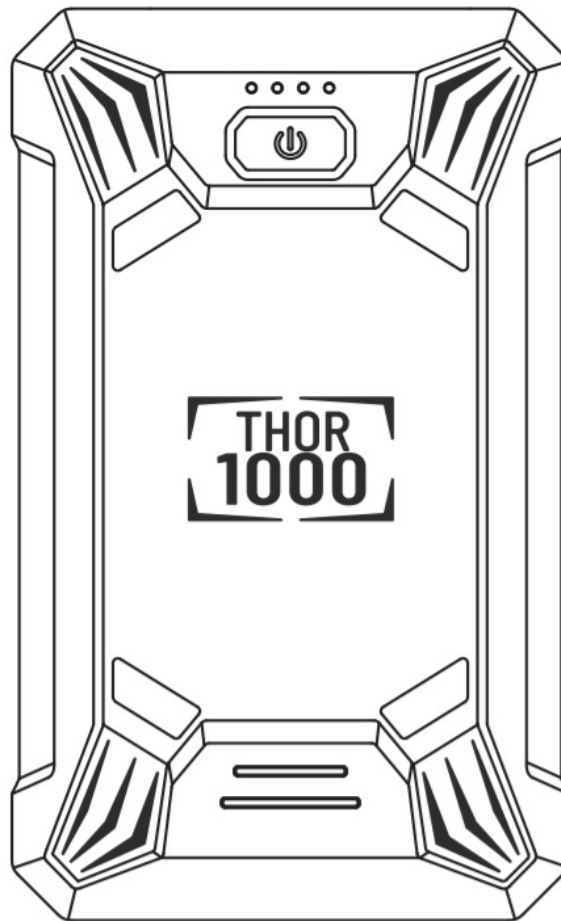

Model: **THOR 1000**

Contents [[hide](#)

- [1 Getting Started](#)
- [2 Jumpstart your car](#)
- [3 Documents / Resources](#)
- [4 Related Posts](#)

Getting Started

Charging the jump starter

1. To charge the product, connect the jump starter and the power source via the Micro USB cable provided in the package.
2. While charging the jump starter, the battery level indicator light will flash.
Once it is fully charged, all 4 battery level indicator lights will be on.
3. Unplug the cable when charging is not required.

Note:

- When using the product for the first time, please make sure that the jump starter is fully charged.
- Please use the provided Micro USB cable to charge the product.
- Wall charger is not included in the package.

Power bank

1. Connect the product with your electronic device (e.g. iPhone series, other smartphones, or pads).
2. Press the ON/OFF button to turn on the power output of the product.
3. Unplug the cable when your electronic device is fully charged.

LED flashlight

Long press the ON/OFF button for 3 seconds to turn on the light. Press the ON/OFF button shortly to switch modes among Solid, SOS, Flash, and Off.

Jumpstart your car

Note:

- This product is for 12V cars only.
- Check to make sure that 3 to 4 indicator lights are on (battery level is above 50%) before you use it to jumpstart your car.

Step 1: Insert the plug of the smart battery clamp completely into the jump starter. If the green and red light indicators on the battery clamp are flashing alternately, you can safely proceed to the next step.

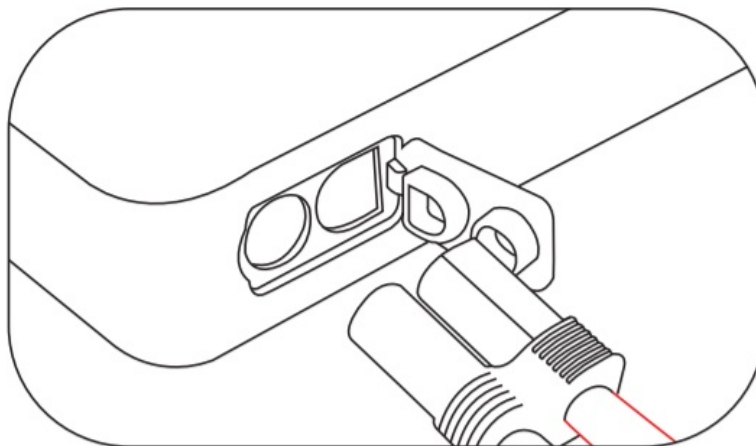

Step 2: Connect the red clamp to the positive terminal (+) of the car battery and connect the black clamp to the negative terminal (-) of the car battery.

If the green and red light indicators on the battery clamp are flashing alternately, you can safely proceed to the next step.

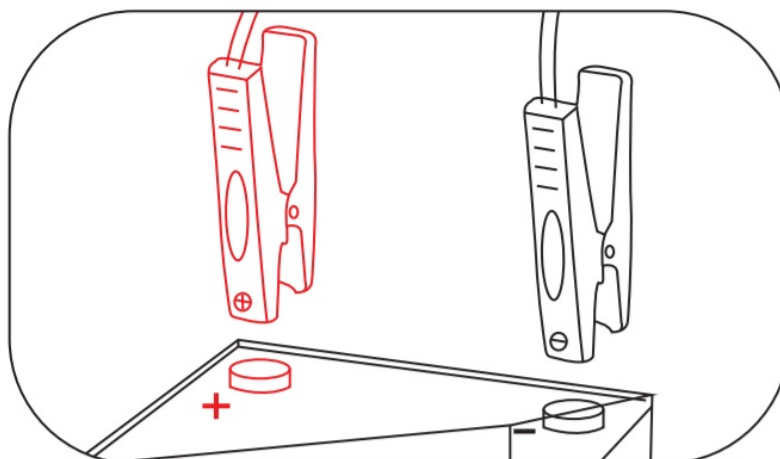

Trouble Shooting

If the red indicator light is on:

1. The battery clamp may be connected in reverse. If so, you need to disconnect the battery clamp from the vehicle and the jump starter.
2. Adjust the clamps for maximum contact with the battery terminals.
3. The voltage of your car battery is higher than 17.5V.
4. It has been connected over the 30s, you should disconnect the battery clamp and jump starter asap, and then follow Step 1-2.

Step 3-a: Start your car.

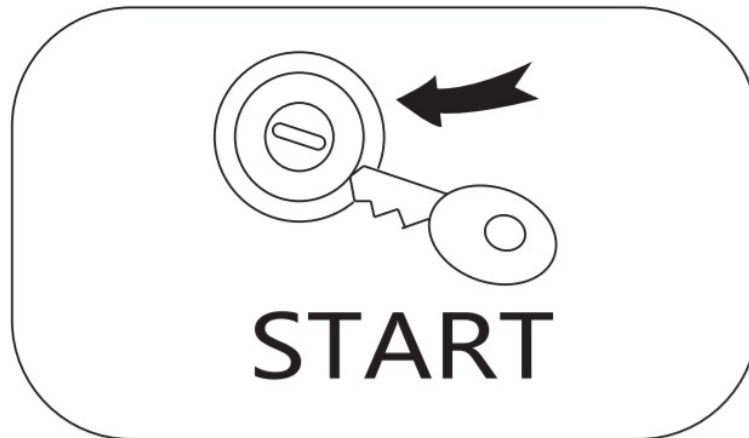

- You need to start your car within 30 seconds after **Step 2**.
- If you failed to start your car, you need to disconnect the battery clamp from the vehicle and the jump starter. Wait for at least 30 seconds, then try again.
- If you failed to start your car after 2 attempts, you can use the force start function. See **Step 3-b**.

Step 3-b (optional): Force start function. First please make sure that the clamps are connected to the correct polarity battery terminal. Then, press and hold the force start button for 3 seconds. When the indicator light of the smart clamp is solid green, you need to start the vehicle within the 30s.

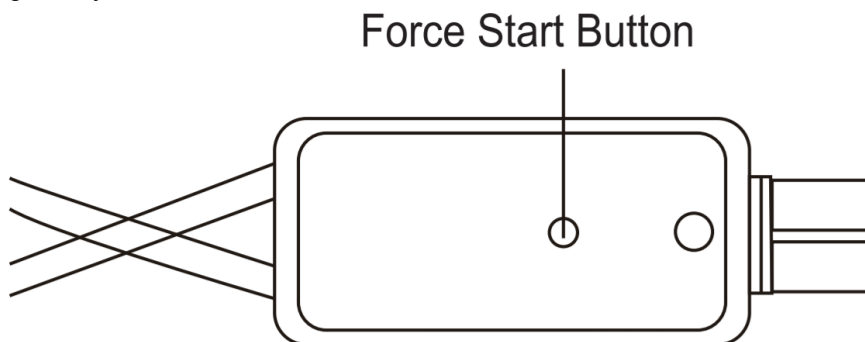

Step 4: Once your car is started, remove the battery clamp from the car battery and the jump starter as soon as possible.

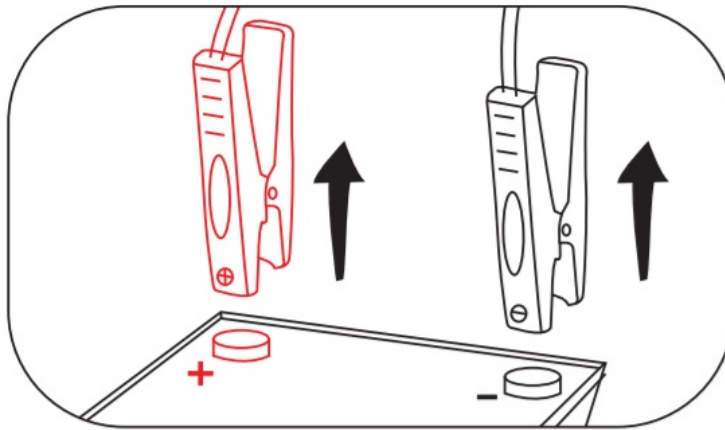

NOTE: When you finish starting the first car and then start the next car, please disconnect the battery clamp and the jump starter, and then follow **Steps 1-4** to start again.

How to read the indicator light of the battery clamp?

Indicator Light & Buzzer	Meaning
The red and green indicator lights flash alternately.	The battery clamps are correctly connected to the jump starter and car battery, ready to start.
The red indicator light stays on and buzzer alarm.	1) Battery clamp is reversely connected or short-circuited. 2) The voltage of your car battery is higher than 17.5V.
The green indicator light stays on after pressing the force start button.	The current is running through the battery clamp. Ready to start your car.
The red indicator light flashes quickly and the buzzer beeps.	1) The over-temperature protection is triggered because the temperature of the clamp exceeds 65 (+/-5) C. The output would be automatically shut off. The red indicator light would flash quickly (5 times per sec). 2) After the car is started, the engine enters a stable working state. Please remove the clamp from the car battery as soon as possible.
The green light flashes slowly.	The voltage of the product is too low. You need to charge the product in time.

NOTE: When the green light is on (in the start state), DO NOT take off the clamp to short circuit them or reverse the positive and negative poles of the clamp to the car battery.

	Vekkia THOR 1000 Jump Starter and Portable Power Source [pdf] User Manual THOR 1000, QZ-B07TD4NQR9, Jump Starter and Portable Power Source
---	---