



VEICHI IOT-BWS1.0-FLink FLink IOT Expansion Module Owner's Manual

[Home](#) » [VEICHI](#) » VEICHI IOT-BWS1.0-FLink FLink IOT Expansion Module Owner's Manual 

Contents

- [1 VEICHI IOT-BWS1.0-FLink FLink IOT Expansion Module](#)
- [2 VEICHI FLink IOT Expansion Module IOT-BWS1.0-FLink](#)
- [3 Product Specification](#)
- [4 Size](#)
- [5 Installation method](#)
- [6 Contact us](#)
- [7 Documents / Resources](#)
 - [7.1 References](#)
- [8 Related Posts](#)



VEICHI IOT-BWS1.0-FLink FLink IOT Expansion Module



VEICHI FLink IOT Expansion Module IOT-BWS1.0-FLink

- 350+ Industrial protocol access, support most of the industrial equipment connection
- Complete data parsing locally and push data to the cloud server
- Support VEICHI remote management tool, support remote configuration, diagnosis
- Supports local caching of historical data

Product Specification

| | | |
|---------------------------|------------------------|---|
| Hardware Parameter | Network Access | Ethernet/WiFi |
| | Network Band | IEEE 802.11b/g/n compatible WLAN IEEE 802.11e QoS Enhancement (WMM) |
| Environmental requirement | Operating Temperature | -10~60°C |
| | Storage Temperature | -20~70°C |
| | Environmental Humidity | 10~90%RH Non-condensing |
| | Seismic Resistance | 10~25Hz X Y Z Direction 2G/30 minutes |
| | Cooling Method | Natural air cooling |
| Mechanical indicator | Size | 67.9mm×74.2mm×19.5mm Antenna not included |
| | Weight | About 50g |
| | Material | ABS Engineering Plastics |
| Software Parameter | VPN Pass-through | Support (only for the 6000 series with its own network port) |
| | Data Monitoring | 300 points, support timed upload or change upload |
| | Alarm Push | 100 points, support client push, SMS push (20 free messages per day), WeChat public number push |
| | Historical Data | 30 points, support offline renewal, offline each point can store 5w bars, cloud retention 90 days |
| | Edge Computing | Support for script programming |
| | Network Protocols | Supports over a hundred industrial device protocols |
| | Management and | Support remote firmware upgrade, support configuration file import |
| | Maintenance | and export |

Size

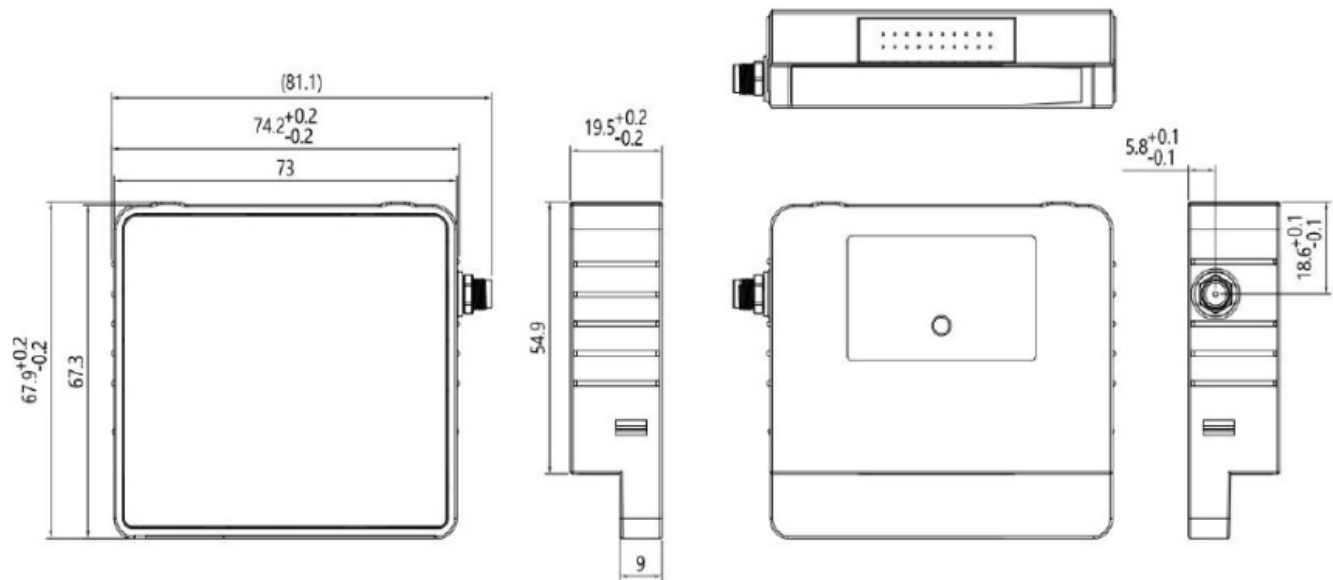

Installation method

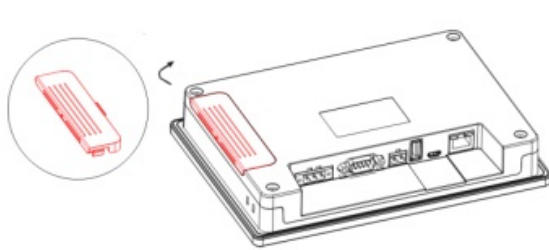

Figure 1-1

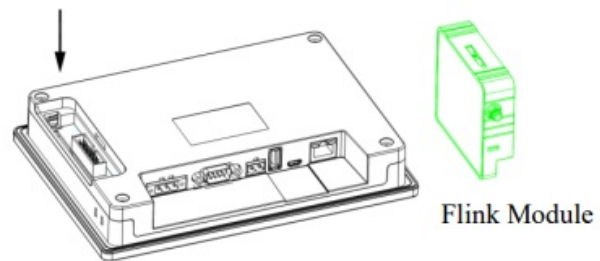

Figure 1-2

Complete the installation of Flink

Along the direction of force can be advanced, you can install a good snap

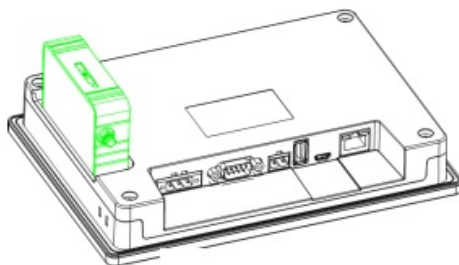

Figure 1-3

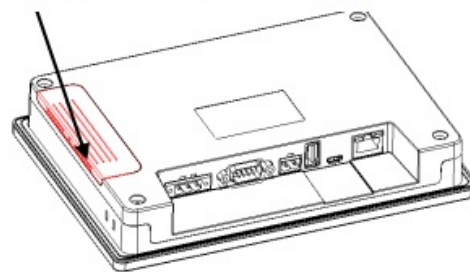
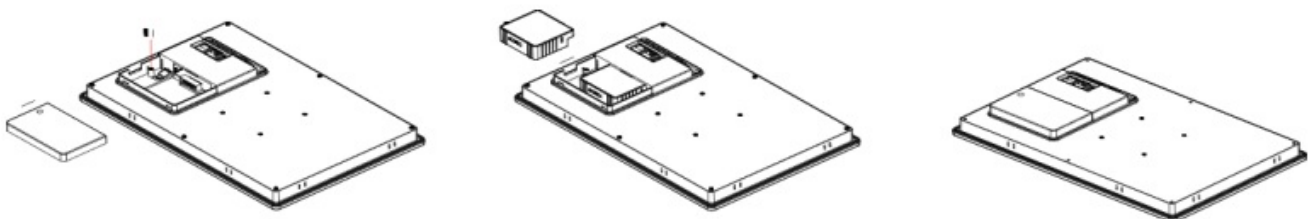

Figure 1-4

- Aluminum structure HMI back open the cover in the direction shown
- Complete the FLink installation as shown in the diagram
- Install the cover to reset and lock the screws



Contact us

Suzhou Headquarters

Address: NO.1000 Songjia Avenue,Guoxiang Street,Wuzhong District,Suzhou,China

Phone: 0512 66171988

Fax: 0512 66173610

Shenzhen Branch

Address: No.1 Factory Building (Chunsh eng Building), No.1 Road, Leading Asia Industrial Park, Tangtou Community, Shiyan Street, Baoan District, Shenzhen, China

Phone: 0755 36861688

Documents / Resources



[VEICHI IOT-BWS1.0-FLink FLink IOT Expansion Module](#) [pdf] Owner's Manual IOT-BWS1.0-FLink, FLink IOT Expansion Module, IOT-BWS1.0-FLink FLink IOT Expansion Module, IOT Expansion Module, Expansion Module, Module

References

- [VEICHI](#) - -