



VAVA VA-LTS005 Adjustable ALR Screen User Manual

[Home](#) » [Vava](#) » VAVA VA-LTS005 Adjustable ALR Screen User Manual 



ADJUSTABLE ALR SCREEN
FOR UST PROJECTOR
VA-LTS005

Dear customer,

Thank you for purchasing our product. Please read the following instructions carefully before first use and keep this user manual for future reference. Pay particular attention to the safety instructions. If you have any questions or comments about the device, please contact the customer line.

✉ www.alza.co.uk/kontakt

☎ +44 (0)203 514 4411

Importer

Alza.cz a.s., Jankovcova 1522/53, Holešovice, 170 00 Praha 7, www.alza.cz

Thank you for choosing the VAVA Projection Screen. Please read this User Guide thoroughly before use and retain it for future reference.

With the constant optimization of the projector, instructions in this User Guide may not be totally applicable to the actual product.

Contents

- [1 IMPORTANT SAFETY INSTRUCTIONS](#)
- [2 Package Contents](#)
- [3 Assemble the Screen](#)
- [4 Assemble the Outer Frames and Corner Protectors](#)
- [5 Mount the Screen onto Wall](#)
- [6 Screen Height Adjustment](#)
- [7 Specification](#)
- [8 Warranty Conditions](#)
- [9 Documents / Resources](#)
 - [9.1 References](#)
- [10 Related Posts](#)

IMPORTANT SAFETY INSTRUCTIONS

READ AND FOLLOW ALL SAFETY INFORMATION AND INSTRUCTIONS. KEEP FOR FUTURE REFERENCE.



CAUTION

For optimal projection, safe installation and long lasting use of the screen, please always follow below instructions carefully:

- Always handle the screen on a clean, level surface covered with clean cloth, film, etc.
- Gently hold and put down the unit to avoid any damage to the screen surface.
- Do not touch the screen surface by hand. Before handling the screen, put on the pairs of gloves to avoid fingerprint, dust or hand oil on the screen surface.
- Do not poke the screen surface with any sharp or hard objects to avoid scratches or tears.
- It is recommended to clean the screen once every two weeks.
- Wipe clean the screen with a soft cloth and lukewarm water. For General dust, use a soft brush (rough towels or cloth may damage the screen) to clean the screen surface.
- Do not clean with abrasive detergent, solvent or other coarse chemicals to avoid permanent damage to the screen surface.
- You may notice a slight smell for first-time use, which will dissipate over time. If the smell
- is too strong, open a window to ventilate the room.
- Child ren should be supervised to ensure that they do not play with the screen.
- Please contact your local dealer for repair or maintenance. For any questions or concerns, please email us at support@vava.com or call us at (877) 969-8282.

READ AND SAVE THESE INSTRUCTIONS

Package Contents

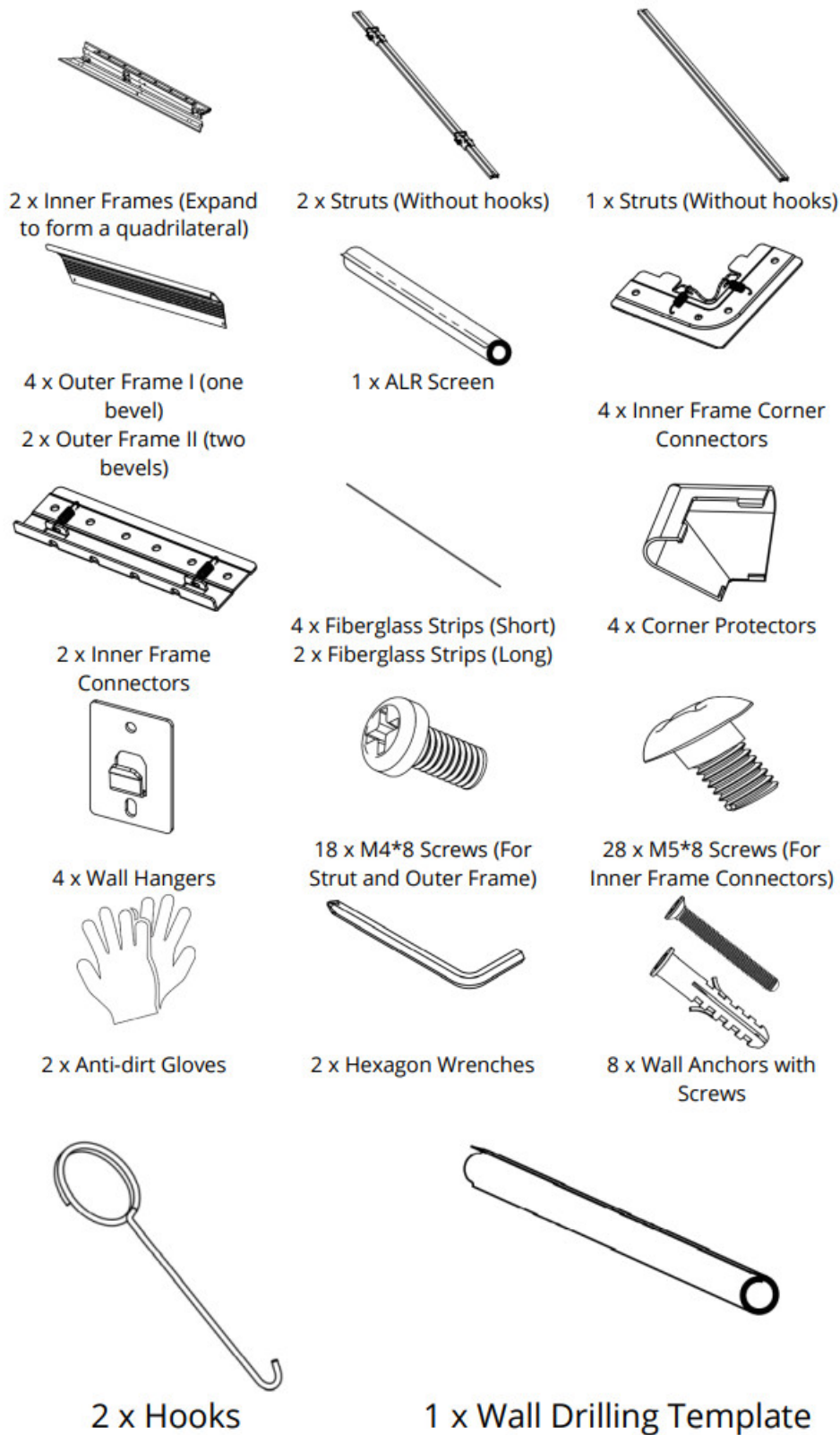

How to Setup

1. Unpack the frames and place the packaging material underneath to keep them protected.
2. Please wear the included protective gloves before handling in case of scratches from metal parts.

Assemble the Inner Frames

1. Take out the two Inner Frames.

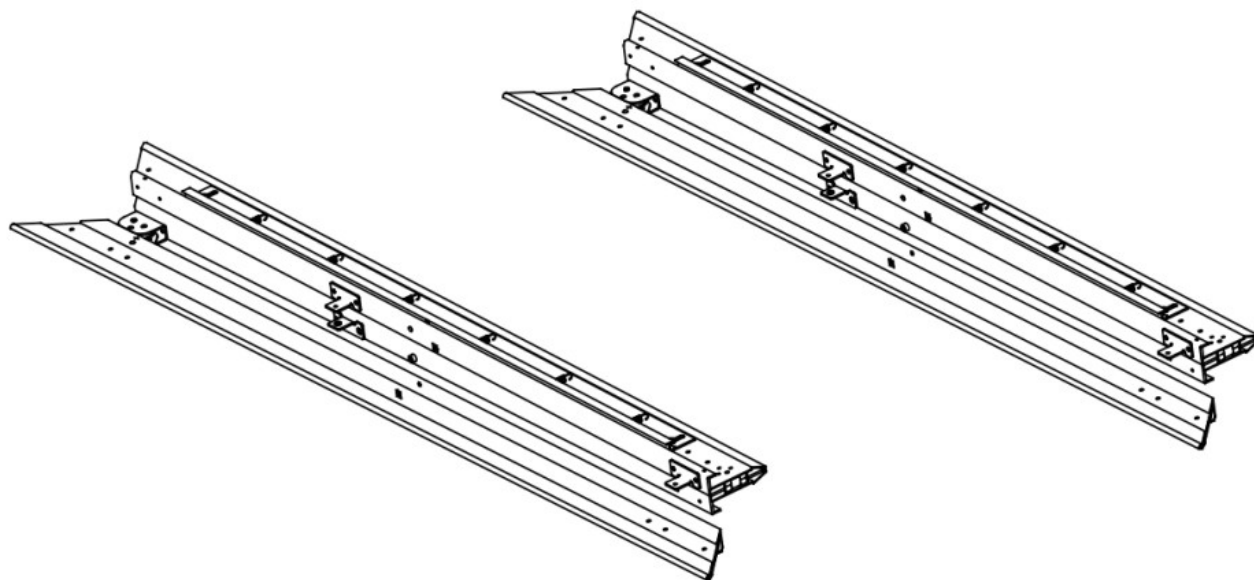

2. Expand the Inner Frames.

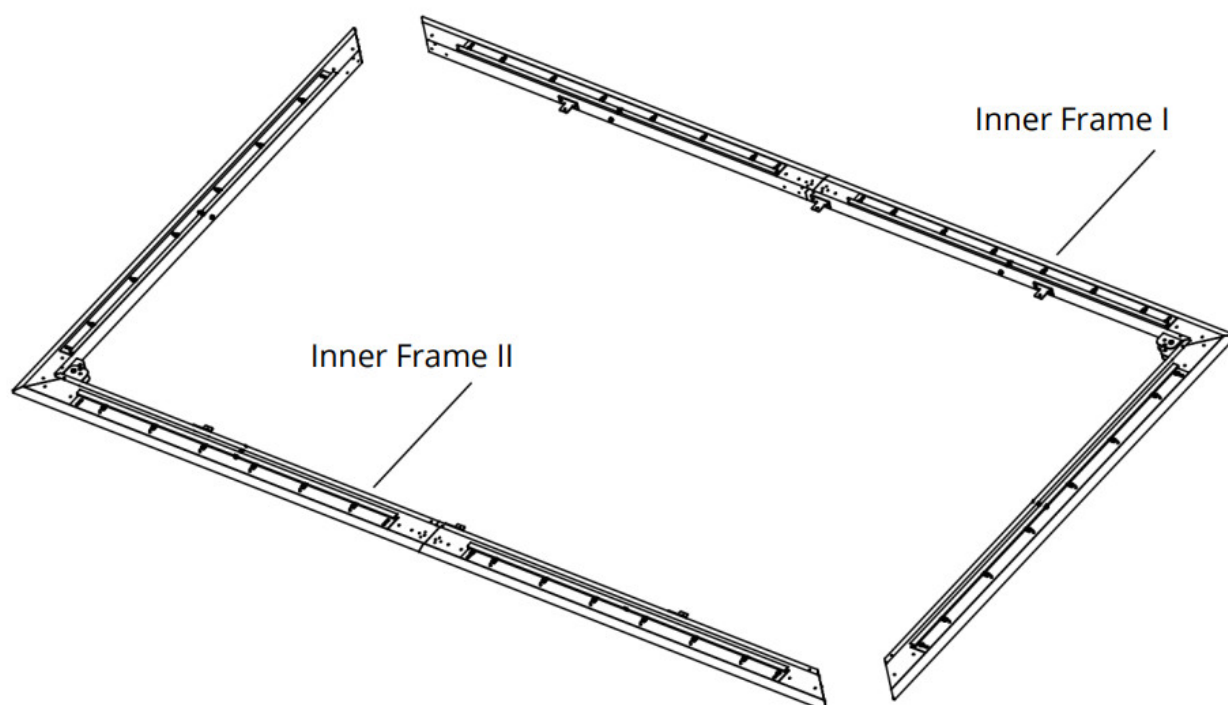

3. Fix the Inner Frame Connectors.

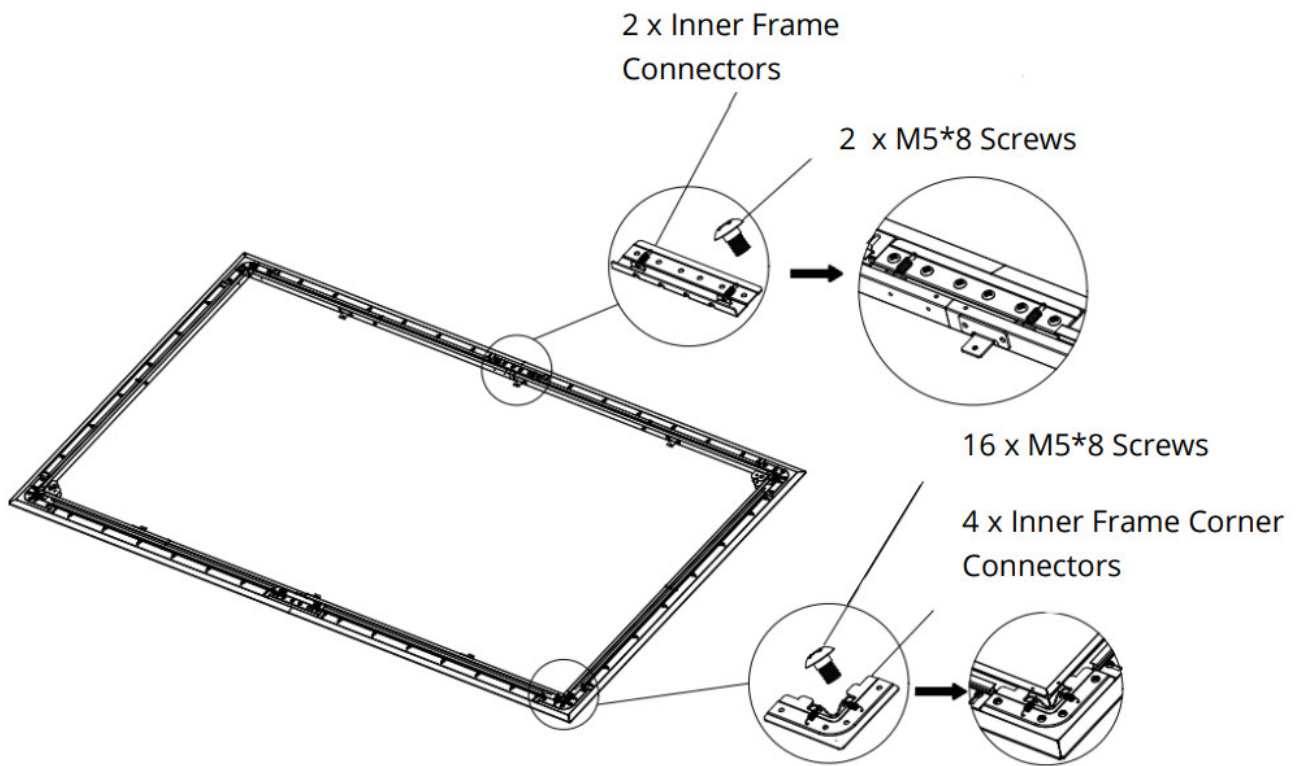

4. Assemble the Struts.

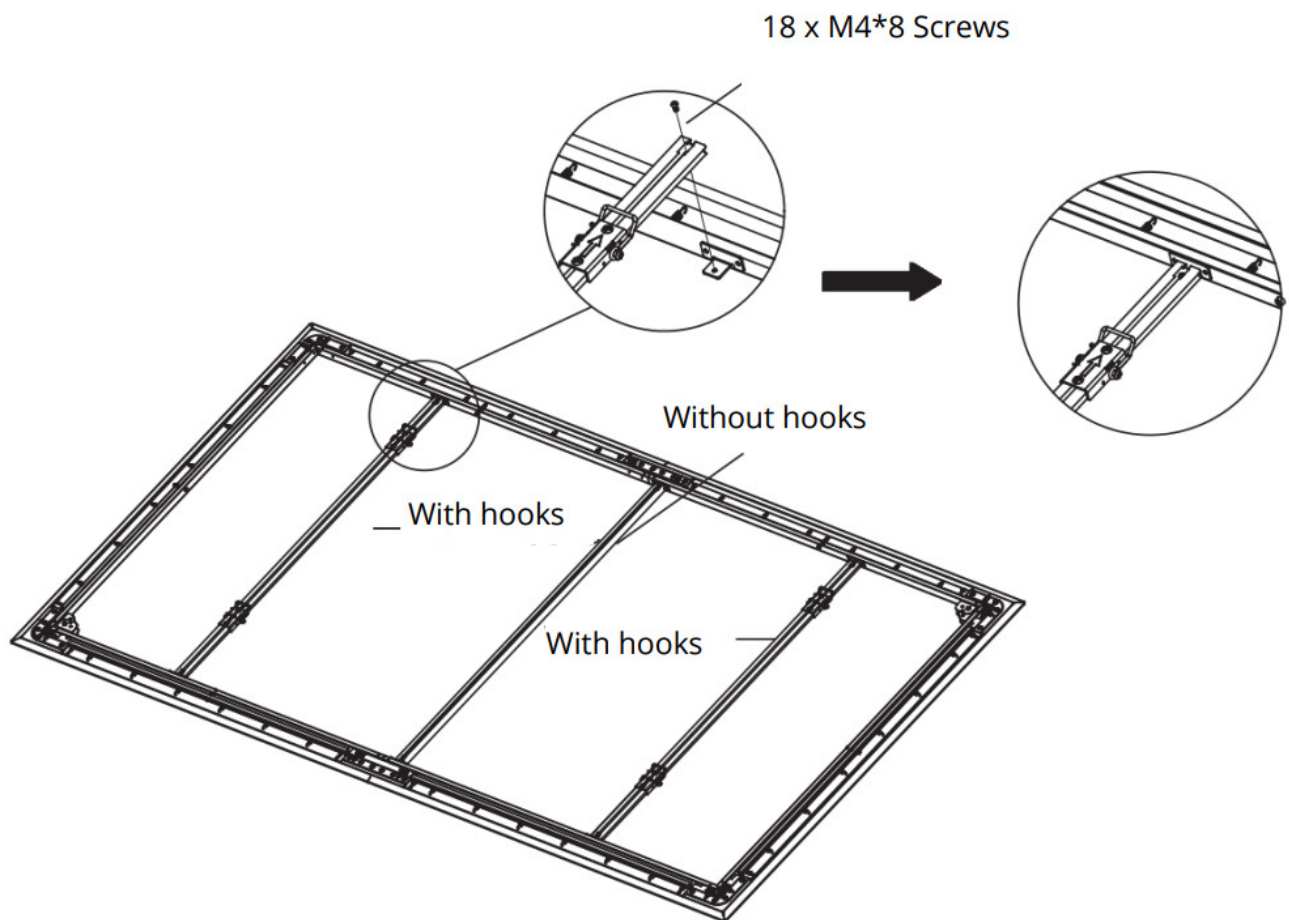

Assemble the Screen

1. Place a piece of clean and soft cloth or plastic film onto a flat surface.
2. Wear the included anti-dirt gloves before handling the screen to avoid fingerprint smudges.
3. Unpack the screen, gently unroll it onto the cloth or plastic film with its back facing upwards.

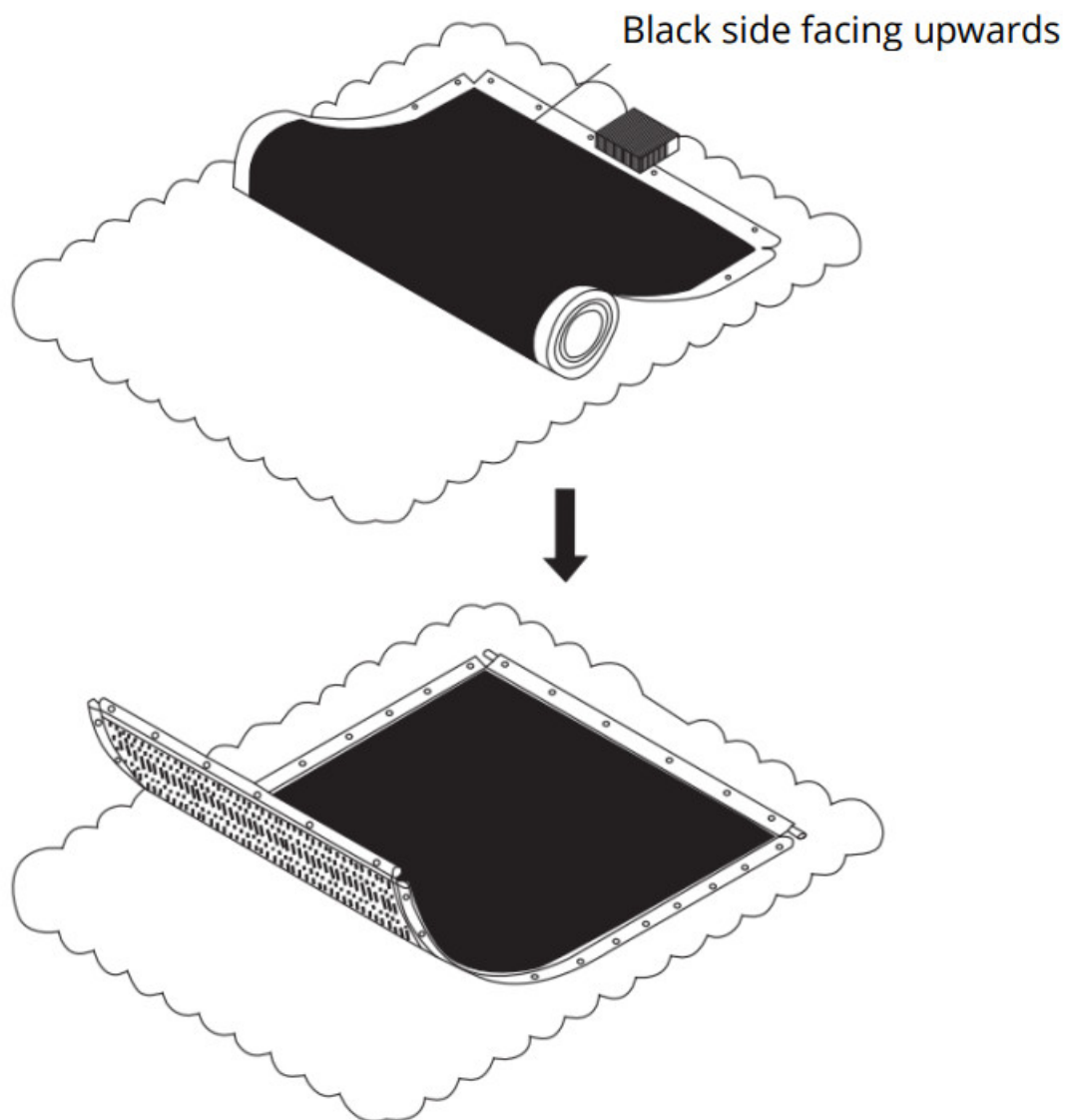

4. Insert the fiberglass strips into the screen sides: 1 longer strip into the short screen side, 2 shorter strips into the long screen side. Make sure the shorter ones in the long screen sides are well aligned with each other.

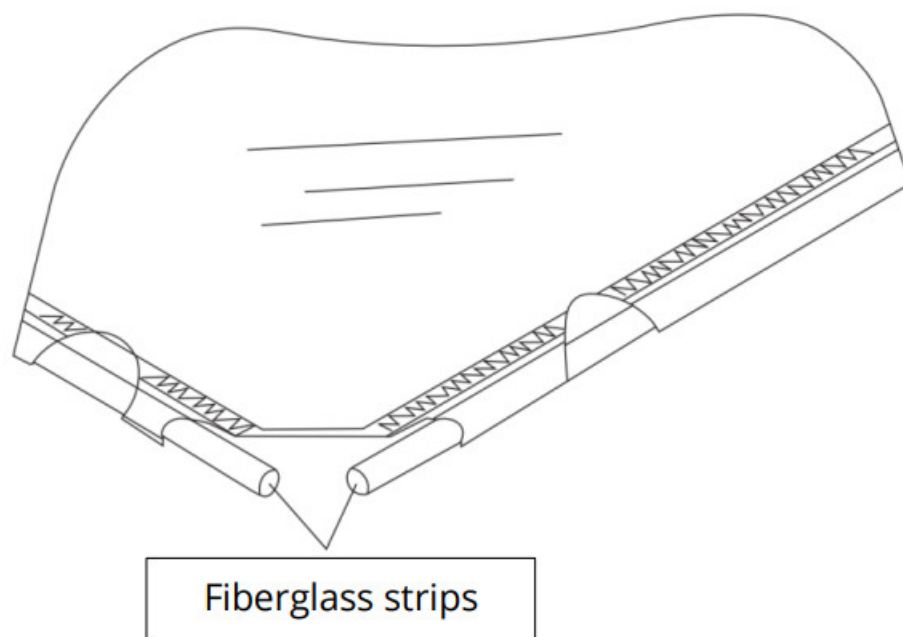

5. Put the installed inner frame onto the back side of the screen.

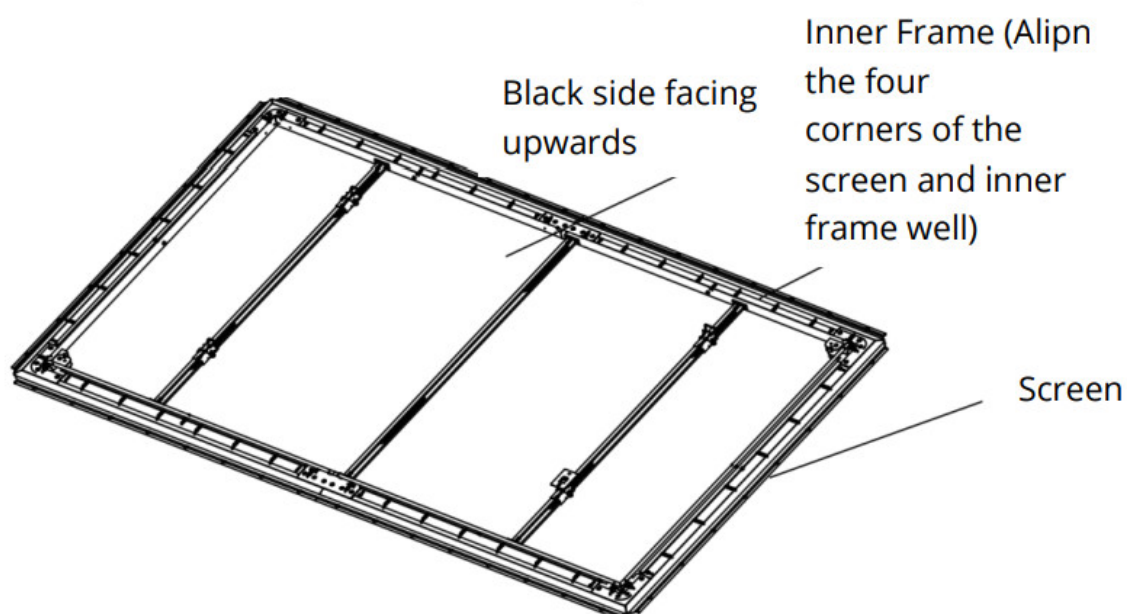
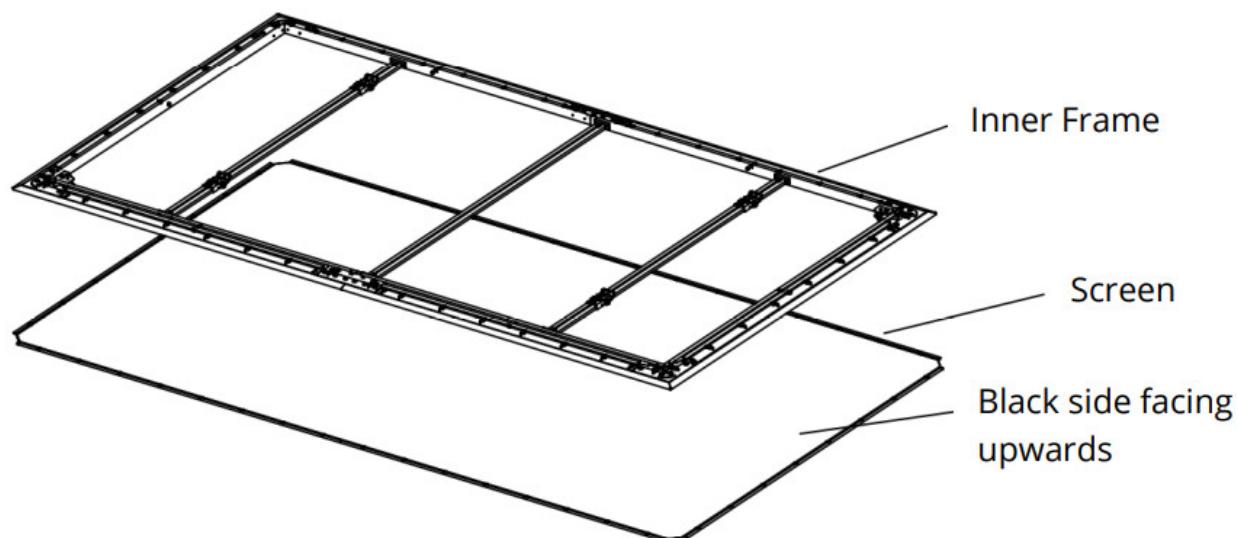

6. Attach the screen onto the inner frame using the tension springs. Install the tension springs to the four corners in the sequence 1 3 first. Then install the other tension springs to both sides from the frame center as shown below (please pull the springs with force at the same time).

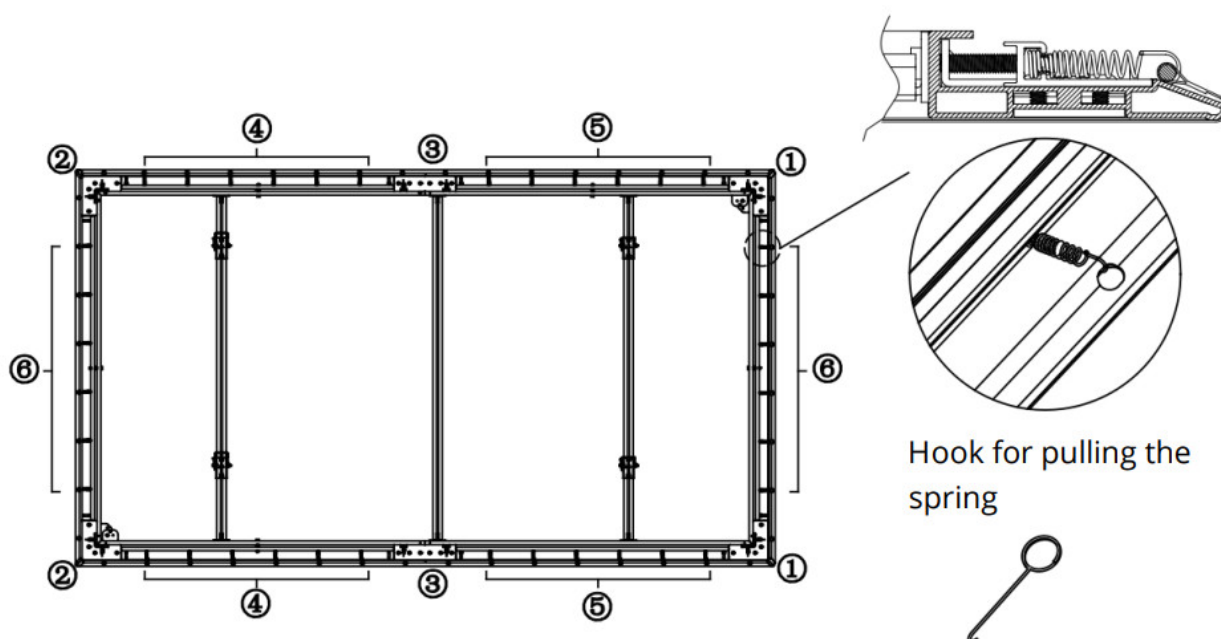

Note:

- Pull the tension springs with hooks.
 - Hang the tension spring on the fiberglass strips.
 - It is strongly recommended that two people pull the tension springs on opposite sides at the same time.
7. Place the screen upright to check its even ness. If the screen is not stretched tight, tighten throup h the six adjusting bolts (A as shown below).

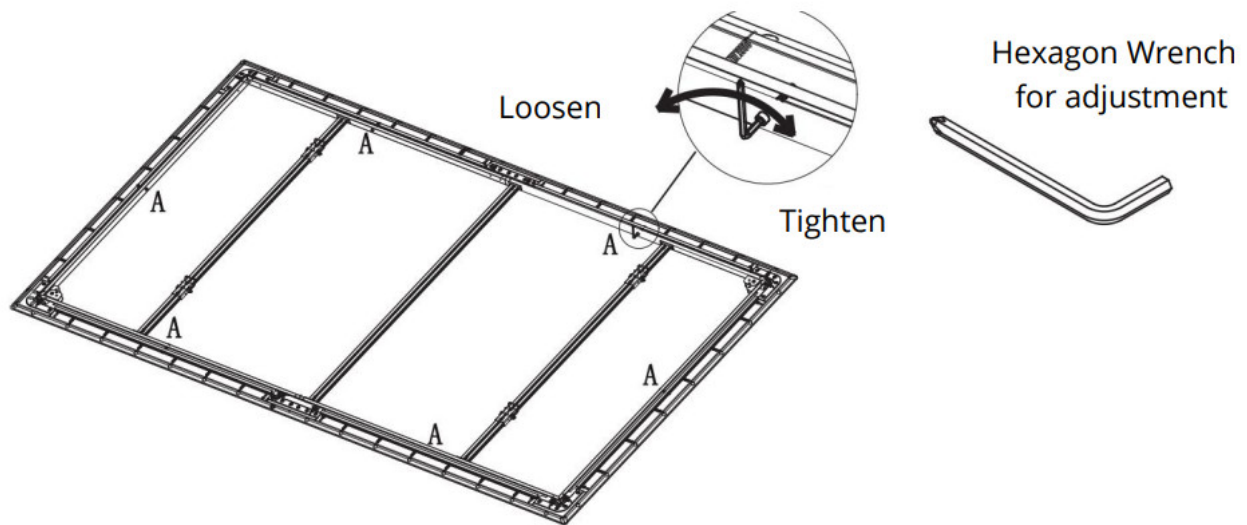

Assemble the Outer Frames and Corner Protectors

1. Place the outer frames against the border of the frame, align the four corners. Fix the inner frames with the outer ones using the included M4*8 screws.

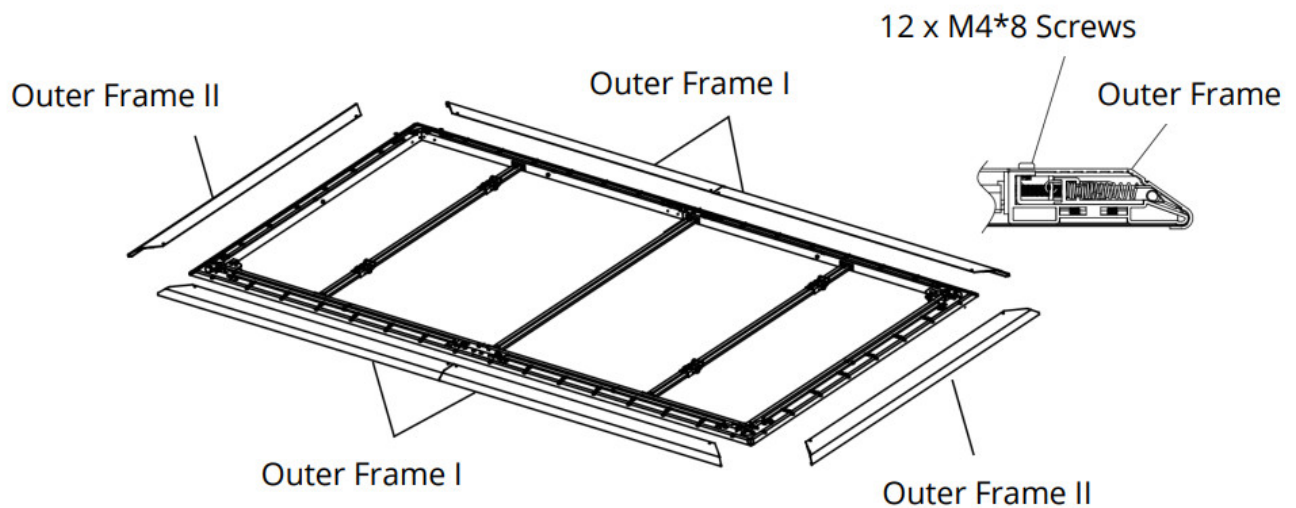

2. Fix the plastic corner protectors onto the four corners. Make sure they are well aligned with the outer frames in case of falling.

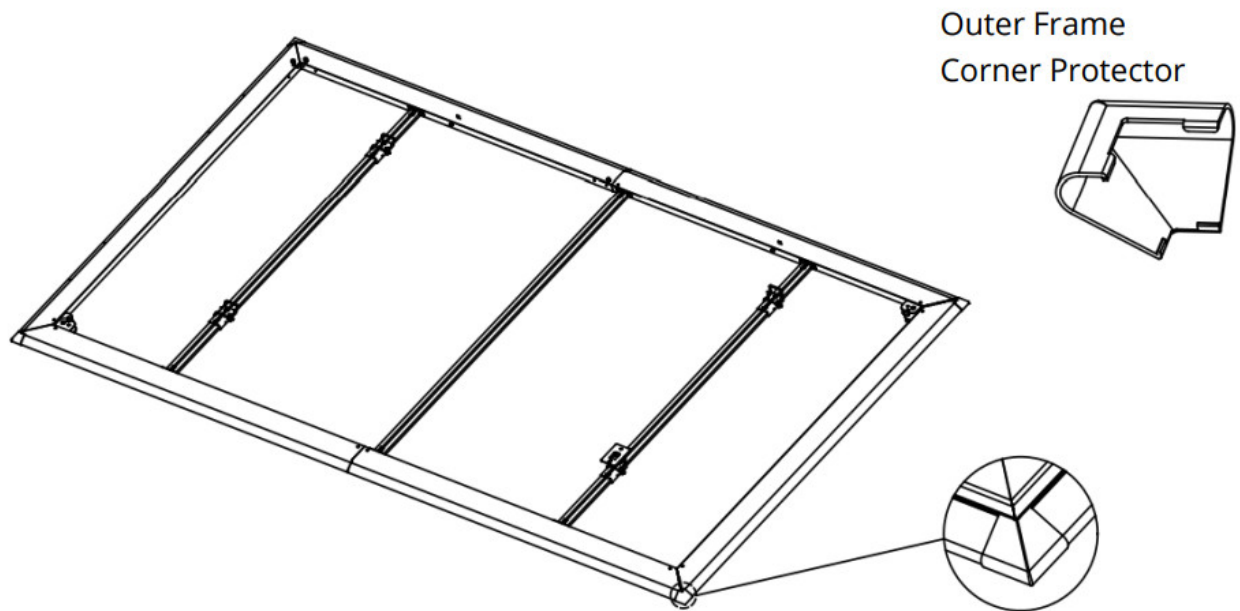

Mount the Screen onto Wall

1. Mount the wall hangers onto the wall with a horizontal distance of 130cm / 51.2in and vertical distance of 70cm / 27.6in. Please estimate the location of the screen to be mounted as per the projector used. Generally, distance between the lower edge of the frame and ground is 60-80cm / 23.6-31.5in.It

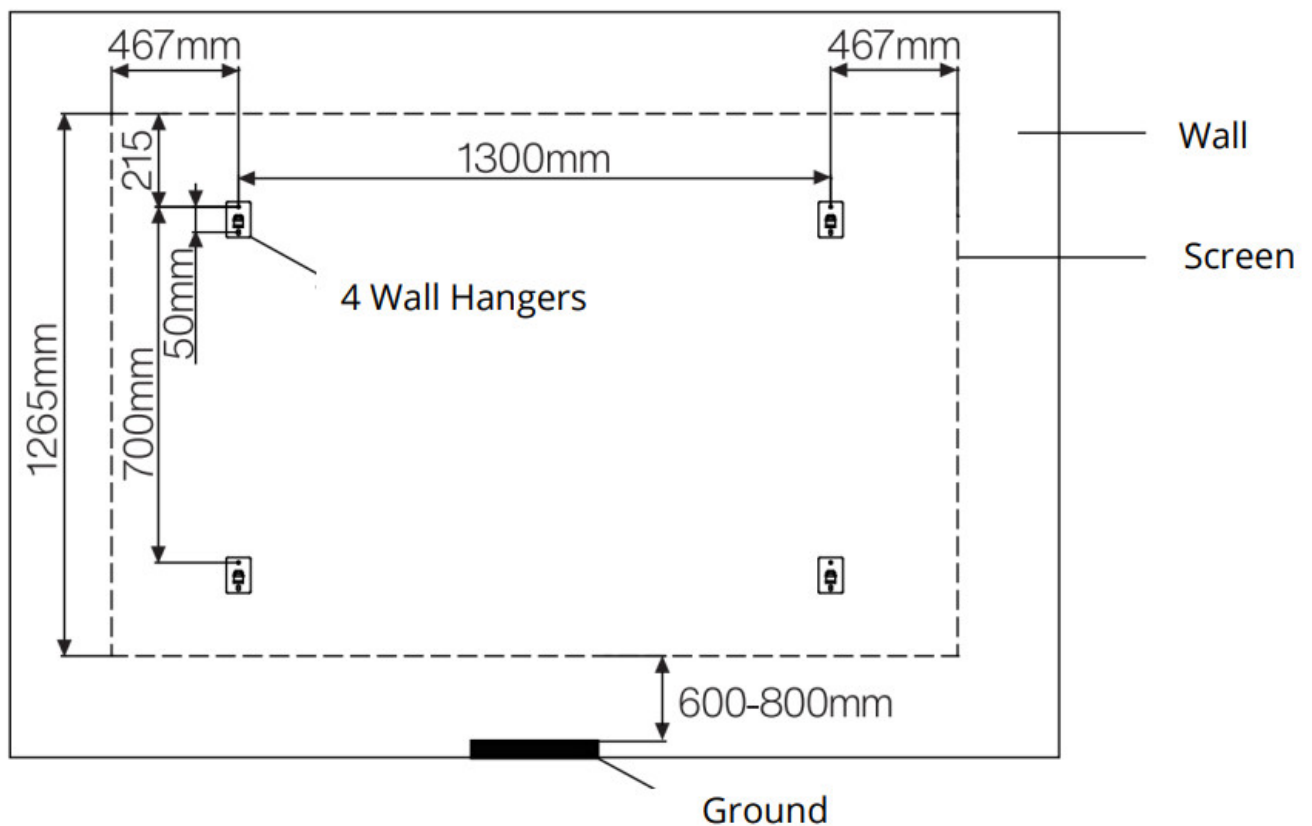

Note: Fix one hanger first, then use the wall drilling template to facilitate locating the position of the remaining hangers.

2. Mount the screen onto the wall as shown below.

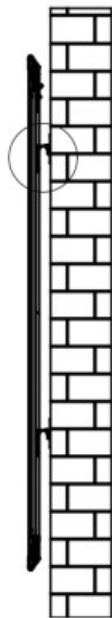

Before

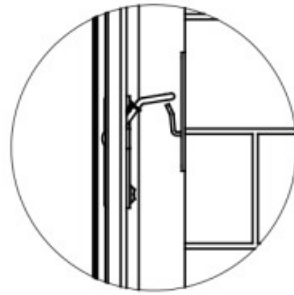

After

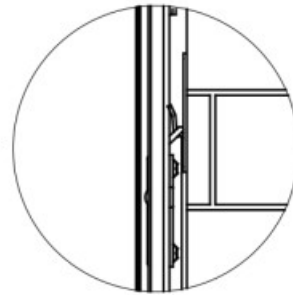

Screen Height Adjustment

1. Adjust the screen height via the height adjusters on the struts if you have already fixed the wall hangers.
2. The height adjusters on the struts are locked to "0" by default.
3. Please adjust as shown below.

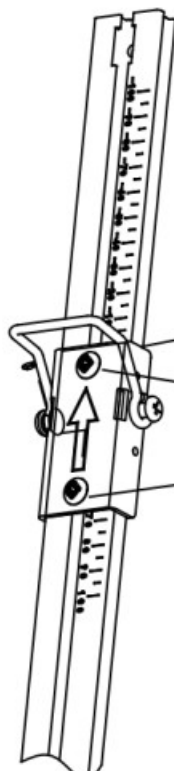

Originally set to "0".

Slightly unscrew the two screws, move the adjuster to the desired scale and tighten.

Note: Make sure the four height adjusters are set to the same scale.

Specification

Model	VA-LTS005
Projection Area	2214 x 1245 mm / 87.2 x 49.0 in
Aspect Ratio	100" 16:9
Dimensions	2234 x 1265 x 27 mm / 88.0 x 49.8 x 1.1 in
Net Weight	15.2kg

Warranty Conditions

A new product purchased in the Alza.cz sales network is guaranteed for 2 years. If you need repair or other services during the warranty period, contact the product seller directly, you must provide the original proof of purchase with the date of purchase.

The following are considered to be a conflict with the warranty conditions, for which the claimed claim may not be recognized:

- Using the product for any purpose other than that for which the product is intended or failing to follow the instructions for maintenance, operation and service of the product.
- Damage to the product by a natural disaster, the intervention of an unauthorized person or mechanically through the fault of the buyer (e.g. during transport, cleaning by inappropriate means, etc.).
- Natural wear and aging of consumables or components during use (such as batteries, etc.).
- Exposure to adverse external influences, such as sunlight and other radiation or electromagnetic fields, fluid intrusion, object intrusion, mains overvoltage, electrostatic discharge voltage (including lightning), faulty supply or input voltage and inappropriate polarity of this voltage, chemical processes such as used power supplies, etc.
- If anyone has made modifications, modifications, alterations to the design or adaptation to change or extend the functions of the product compared to the purchased design or use of non-original components.

EU Declaration of Conformity

Identification data of the manufacturer's / importer's authorized representative: Importer: Alza.cz a.s.

Registered office: Jankovcova 1522/53, Holešovice, 170 00 Prague 7

IČO: 27082440

Subject of the declaration:

Title: ADJUSTABLE ALR SCREEN FOR UST PROJECTOR

Model / Type: VA-LTS005

The above product has been tested in accordance with the standard(s) used to demonstrate compliance with the essential requirements laid down in the

Directive(s):

Directive No. (EU) 2014/35/EU

Directive No. (EU) 2014/30/EU

Directive No. (EU) 2014/53/EU

Directive No. (EU) 2011/65/EU as amended 2015/863/EU

Prague, 18.10. 2021



WEEE



Instead, it shall be returned to the place of purchase or handed over to a public collection point for the recyclable waste. By ensuring this product is disposed of correctly, you will help prevent potential consequences for the environment and human health, which could otherwise be caused by inappropriate handling of this product. Contact your local authority or the nearest collection point for further details. Disposal of this type of waste may result in fines in accordance with national regulations.