



Vari-Lite NEO X15 Launches X-Series Console Designed for Both Theatrical User Guide

[Home](#) » [Vari-Lite](#) » Vari-Lite NEO X15 Launches X-Series Console Designed for Both Theatrical User Guide 

Contents

- 1 Vari-Lite NEO X15 Launches X-Series Console Designed for Both Theatrical
- 2 OVERVIEW
- 3 INCLUDED ITEMS
- 4 INSTALLATION AND SETUP
- 5 CONNECTIONS
- 6 UNPACK CONSOLE
- 7 SITE REQUIREMENT
- 8 CONNECTING POWER
- 9 READY TO USE
- 10 CONSOLE LAYOUT
- 11 SAFETY WARNINGS AND NOTICES
- 12 COMPLIANCE NOTICE
- 13 Documents / Resources
 - 13.1 References
- 14 Related Posts

VARI*LTE

Vari-Lite NEO X15 Launches X-Series Console Designed for Both Theatrical



OVERVIEW

This document provides basic setup instructions and safety warnings for the following product(s):

INCLUDED ITEMS

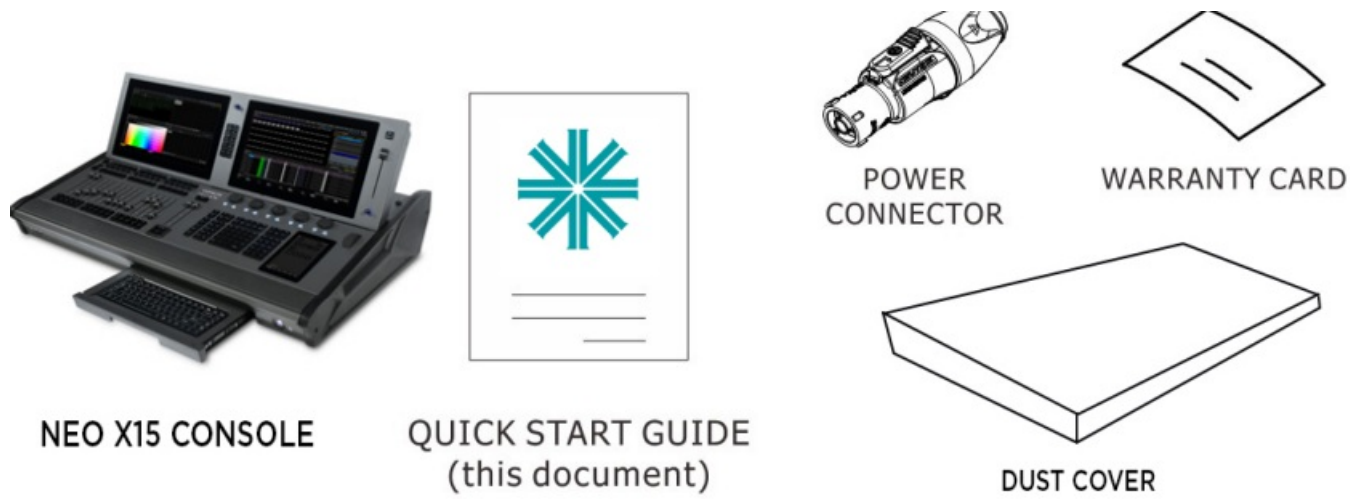

INSTALLATION AND SETUP

CONNECTING POWER

This console requires standard AC power distribution from 100-240VAC. Current required depends on the AC supply voltage and product model.

NOTE: The mating compatible connector is supplied; however, you will need to purchase or construct a cable appropriate for your application.

Depending on the application, the Console’s AC input cable may require a different connector. If required, install a new connector meeting your requirements using the following wire color code reference:

WIRE*	CONNECTION
Green/yellow	ac ground
Blue	ac neutral
Brown	ac line

* International (Harmonized) Standard

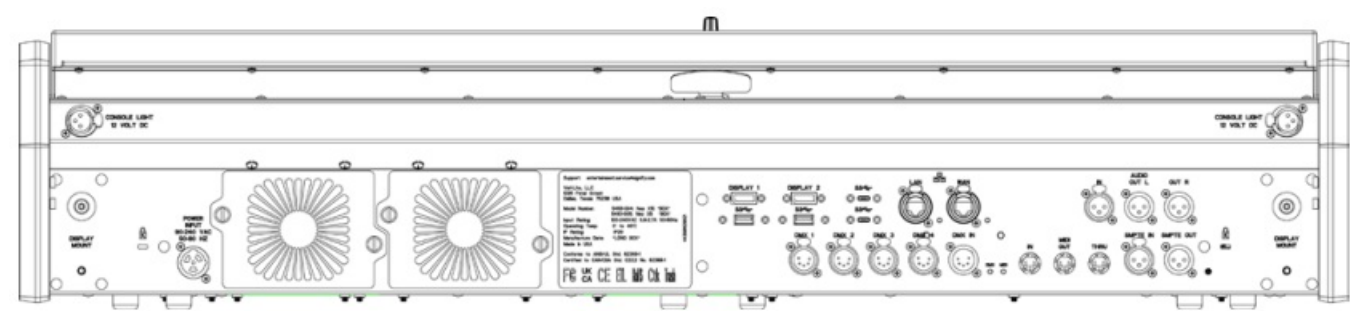

WARNING: DO NOT connect to three-phase service in countries with 240V power.

Single-phase power from 100-240V RMS

CONNECTION	PIN
ac neutral	X
ac line	Y
Ground (earth)	G

Two-phase power at 208V RMS

CONNECTION	PIN
Phase 1	X
Phase 2	Y
Ground (earth)	G

CONNECTIONS

Figure 1 shows the features and controls of the NEO X15 Lighting Control Console. Refer to the on-line manual for additional information and operation.

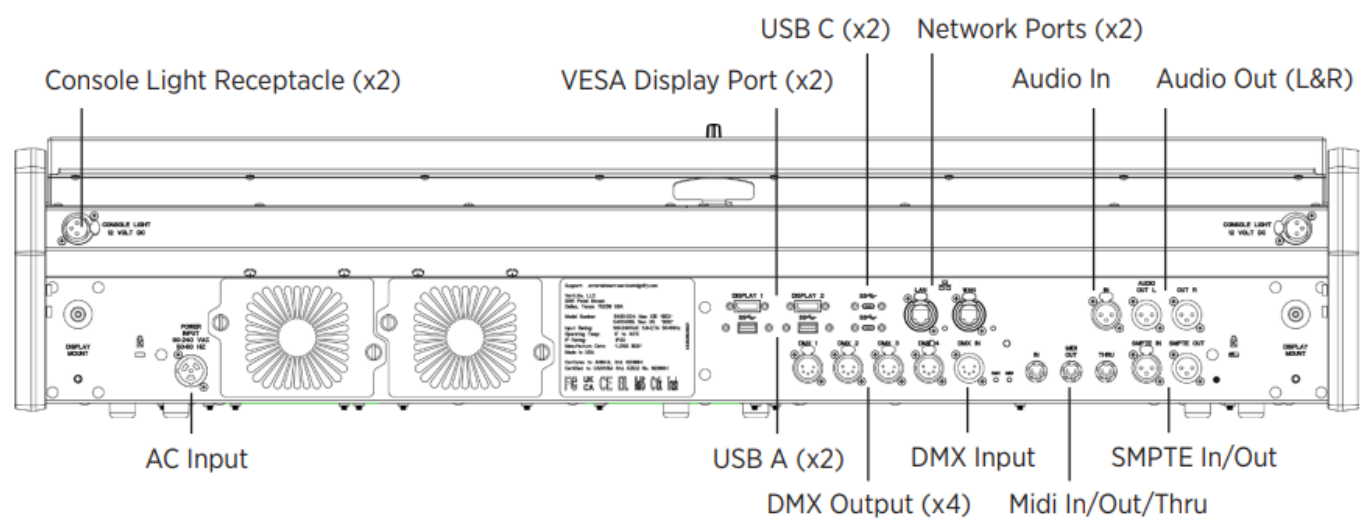

Rear of Unit

Figure 1: Neo X15 Lighting Control Connections

Use only the supplied AC input cables with unit. If the supplied AC input cable is ever damaged, you must replace it with an approved replacement. For assistance, please contact an Authorized Vari-Lite Lighting Dealer or Service Center. Authorized Dealers and Service Centers are found on the Vari-Lite web site at www.vari-lite.com.1.

UNPACK CONSOLE

Unpack your Neo X15 Lighting Control Console from its shipping box and insure you have all included items. A list of included items is found in “Included Items” on page 1 of this guide. If you are missing any components, please contact your local Authorized Vari-Lite Dealer. Authorized Dealers are found on the VariLite web site at www.vari-lite.com.

SITE REQUIREMENT

The Neo X15 Lighting Control Console requires a sturdy, flat surface for installation. The surface should be able to support the weight of the console and should provide suitable ventilation. Also, the site should be clean (i.e. absent of any construction dust or debris) and dry. Before setting up, ensure that the installation site meets these requirements. For operational and space requirements, refer to “Neo X15 Lighting Control Console Connections” on page 2 and “Console Dimensions” on page 4 for more information. The console must be installed and operate in an environment that is not exposed to moisture, high humidity or direct sunlight.

CONNECTING POWER

If applicable, connect monitor(s) before connecting power.
To connect the power supply:

- Step 1. Make sure unit's power switch is set to “Off”
- Step 2. Connect AC input cable to AC Input connection on console (refer to Figure 1 on page 2).
- Step 3. Connect AC input cable to AC supply source.
- Step 4. Turn on console at Console On / Off Switch.
- Note: You must connect the console to the lighting system before it is capable of providing control. Refer to “Connections” on page 2 for connection information.

READY TO USE

Once console is connected to power and lighting control system, it is ready for use.

- Power on the console.
- Once the software boots, you are ready to program.
- Channels can be adjusted by selecting the channels and applying a value. [1 THRU 10 FULL].
- A Cue can be recorded for timed playback. [RECORD CUE 1 ENTER] or a Submaster can be recorded for fader playback. [RECORD SUB 1 ENTER].

For more information, refer to the on-line manual for console operation, operational features, and programming.

CONSOLE LAYOUT

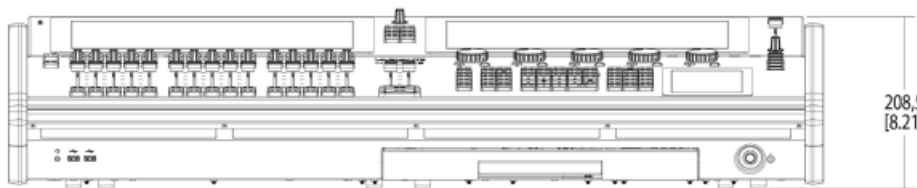
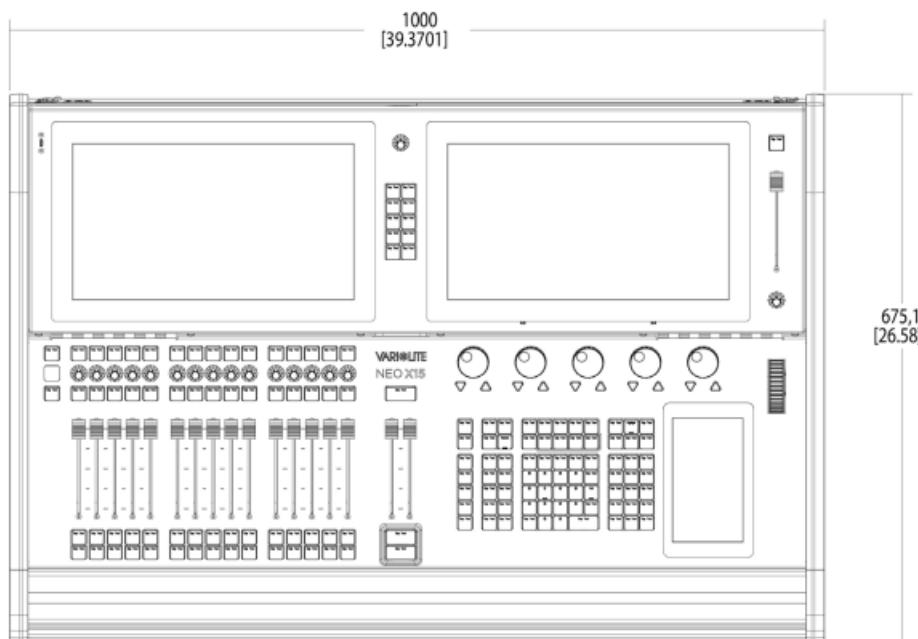
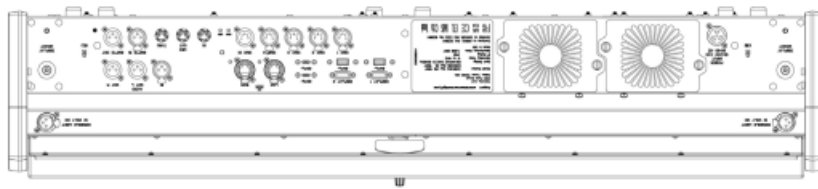

WARNING: It is the responsibility of the user to adequately protect supply source with a correct size and type circuit breaker and not overload circuits.

WARNING: This unit has a battery. Replace only with the correct type of battery. Failure to use the correct battery could cause serious damage to the fixture. Dispose of used batteries appropriately.

SAFETY WARNINGS AND NOTICES

Read this user manual in full before attempting to install, operate or maintain the Console to which it relates. This user manual is intended to provide general guidance to such suitably qualified personnel. Installation and operation of the Console are to be performed by qualified personnel only.

When using electrical equipment, basic safety precautions should always be followed including the following:

READ AND FOLLOW ALL SAFETY INSTRUCTIONS

- Equipment should be mounted in locations and at heights where it will not be readily subjected to tampering by unauthorized personnel.
- Not for residential use. Do not use this equipment for other than intended use.
- This equipment is not suitable for use in locations where children are likely to be present.
- Note distance requirement(s) from combustible materials or illuminated objects. Do not mount near gas or

electric heaters.

- Install only in locations with adequate ventilation. Ensure sure that ventilation slots are not blocked.
- Ensure that the voltage and frequency of the power supply match the power requirements of the Console.
- The Console must be earthed/grounded to the appropriate conductor.
- Do not operate Console outside the specified ambient temperature range.
- The use of accessory equipment not recommended by the manufacturer may cause an unsafe condition and void warranty.
- Refer service to qualified personnel. This Console contains no user serviceable parts.
- Prior to first use, carefully inspect Console to ensure no damage has occurred during shipping.
- Materials used in the manufacturing process can cause strong odors when the product is new. These odors dissipate over time.
- Prior to each use, carefully inspect power cables and replace any damaged cables.
- Continuous use of the Console may shorten the lifespan. Power down the Console when not in use.
- Do not cycle power on and off repeatedly. Disconnect mains power if the Console is not used for an extended period.
- Clean Consoles regularly, particularly when working in a dusty environment.
- Never touch power cables or wires while the Console is powered on.
- Avoid entangling power wires with other cables.
- In the event of a serious operating problem, immediately discontinue using the Console.
- This is a Class A product. In a domestic environment this product may cause radio interference, in which case, the user may be required to take adequate measures.

SAVE THESE INSTRUCTIONS

WARNING: Refer to National Electrical Code® and local codes for cable specifications. Failure to use proper cable can result in damage to equipment or danger to personnel.

COMPLIANCE NOTICE

FCC DECLARATION OF CONFORMITY

This equipment has been tested and found to comply with the limits for a Class A digital device pursuant to Part 15 of FCC Rules. These limits are designed to provide reasonable protection against harmful interference when this equipment is operated in a commercial environment. This equipment generates, uses, and can radiate radio frequency energy and, if not installed and used in accordance with Vari-Lite system, service, and safety guidelines, may cause harmful interference to radio communications.

As tested under this standard:

FCC 47CFR Part 15 Subpart B

ICES-003

Operation of this equipment in a residential area is likely to cause harmful interference, in which case the user will be required to correct the interference at his/her own expense.

EU DECLARATION OF CONFORMITY

We, Vari-Lite LLC., 10911 Petal Street, Dallas, Texas 75238, declare under our responsibility for the products contained herein are in conformity with the essential requirements of the following European Directives and harmonized standards:

Low Voltage Directive (LVD), 2014/35/EU

EN 62368-1

Electromagnetic Compatibility Directive (EMC), 2014/30/EU

EN 55032, EN 55035

All trademarks are owned by Signify Holding or their respective owners. The information provided herein is subject to change, without notice. Signify does not give any representation or warranty as to the accuracy or completeness of the information included herein and shall not be li-able for any action in reliance thereon. The information presented in this document is not intended as any commercial off er and does not form part of any quotation or contract, unless otherwise agreed by Signify. Data subject to change.

CUSTOMER SERVICE

If you have any questions regarding this product, please con-tact Customer Service by phone at +1 214-647-7880 or by email at entertainment.service@signify.com.

NEO X15 QUICK START GUIDE PART NUMBER: 443581628025
VERSION: REV A

Documents / Resources

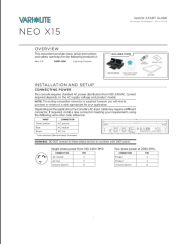
	Vari-Lite NEO X15 Launches X-Series Console Designed for Both Theatrical [pdf] User Guide NEO X15 Launches X-Series Console Designed for Both Theatrical, NEO X15, Launches X-Series Console Designed for Both Theatrical, Designed for Both Theatrical, Designed for Both Theatrical
---	--

References

- [* Home | Vari-Lite](#)