

## Vantron IQ Hubv1.1 User Manual

[Home](#) » [Vantron](#) » Vantron IQ Hubv1.1 User Manual 

### Contents

- 1 Vantron IQ Hub v1.1
- 2 Foreword
  - 2.1 Copyright Notice
  - 2.2 Statement
  - 2.3 Disclaimer Vantron assumes no legal liability of accidents resulting from failure of conforming to the safety instructions.
  - 2.4 Limitation of Liability / Non-Warranty
  - 2.5 Safety Instructions
  - 2.6 Precautions
  - 2.7 Safety Instructions for Power Cables and Accessories
  - 2.8 Warnings, Cautions and Notes
- 3 Overview
  - 3.1 Introduction
  - 3.2 Ordering Information
- 4 IQ Hub Hardware Instructions
  - 4.1 Product Appearance
  - 4.2 Specifications
  - 4.3 Interface Instructions
  - 4.4 Dimension
  - 4.5 Power/Sleep/Wake Button
  - 4.6 Interface Description
  - 4.7 Packing List
- 5 Software Instructions
  - 5.1 Brief Introduction
- 6 Safety Instruction
  - 6.1 Safety Precautions per IEC704-1
  - 6.2 Safety Precautions – Static Electricity
  - 6.3 Comply with the Following Safety Tips
- 7 Documents / Resources
- 8 Related Posts

# Vantron

## Vantron IQ Hub v1.1



## Foreword

### Copyright Notice

While all information contained herein have been carefully checked to assure its accuracy in technical details and printing, Vantron assumes no responsibility resulting from any error or features of this manual, or from improper uses of this manual or the software. Please contact our technical department for relevant operation solutions if there is any problem that cannot be solved according to this manual.

Vantron reserves all rights of this manual, including the right to change the content, form, product features, and specifications contained herein at any time without prior notice. The latest version of this manual is at [www.vantrontech.com.cn](http://www.vantrontech.com.cn). Please contact Vantron for further information:

Vantron Technology (Vantron) Email: [sales@vantrontech.com](mailto:sales@vantrontech.com)

The trademarks and registered trademarks in this manual are properties of their respective owners. No part of this manual may be copied, reproduced, translated or sold. No changes or other purposes are permitted without the prior written consent of Vantron.

Vantron reserves the right of all publicly-released copies of this manual.

### Notes

Applicable notes are listed in the following table:

Notice Type	Description
Notice	Important information and regulations
Caution	Caution for latent damage to system or harm to personnel

### Statement

It is recommended to read and comply with this manual before operating IQ Hub which provides important guidance and helps decreasing the danger of injury, electric shock, fire, or any damage to the device.

#### **Disclaimer**

**Vantron assumes no legal liability of accidents resulting from failure of conforming to the safety instructions.**

#### **Limitation of Liability / Non-Warranty**

For direct or indirect damage to this device or other devices of Vantron caused by failure of conforming to this manual or the safety instructions on device label, Vantron assumes neither warranty nor legal liability even if the device is still under warranty.

#### **Safety Instructions**

Keep and comply with all operation instructions, warnings, and information. Pay attention to warnings on this device. Please read the following precautions so as to decrease the danger of injury, electric shock, fire, or any damage to the device.

#### **Precautions**

Pay attention to the product labels/safety instructions printed on silk screens. Do not try repairing this product unless declared in this manual. Keep away from heat source, such as heater, heat dissipater, or engine casing. Do not insert other items into the slot (if any) of this device. Keep the ventilation slot ventilated for cooling. System fault may arise if other items are inserted into this device. Installation: ensure correct installation according to instructions from the manufacturer with recommended installation tools.

Ensure ventilation and smoothness according to relevant ventilation standard.

#### **Safety Instructions for Power Cables and Accessories**

##### **Proper power source only.**

Start only with power source that satisfies voltage label and the voltage necessary according to this manual. Please contact technical support personnel of Vantron for any uncertainty about the requirements of necessary power source.

##### **Power adapter Spec.**

- Model:SW-120100
- INPUT:100-240V~50/60Hz 0.68A Max
- OUTPUT:DC 12.0V,1000mA
- MADE IN CHINA BY SURE-POWER

#### **CAUTION**

RISK OF EXPLOSION IF BATTERY IS REPLACED BY AN INCORRECT TYPE DISPOSE OF USED BATTERIES ACCORDING TO THE INSTRUCTIONS MAKE SURE THE MECHINE IS POWER-OFF BEFORE TAKE OUT BATTERIES

Place cables properly:

Do not place cables at any place with extrusion danger.

#### **Cleaning Instructions**

- Please power off before cleaning the device.

- Do not use spray detergent.
- Clean with a damp cloth.
- Do not try cleaning exposed electronic components unless with a dust collector.

Support for special fault: Power off and contact technical support personnel of Vantron in case of the following faults:

- The device is damaged.
- The temperature is excessively high.
- Fault is still not solved after the operation according to the manual.

### **Warnings, Cautions and Notes**

- **Warning!** Warnings indicate conditions, which if not observed, can cause personal injury!
- **Caution!** Cautions are included to help you avoid damaging hardware or losing data. e.g. There is a danger of a new battery exploding if it is incorrectly installed. Do not attempt to recharge, force open, or heat the battery. Replace the battery only with the same or equivalent type recommended by the manufacturer. Discard used batteries according to the manufacturer's instructions.
- **Note!** Notes provide optional additional information.

## **Overview**

### **Introduction**

It is our commitment to provide our valued customers with the embedded devices equipped with the state-of-the-art technology and the best product services.

Tablet enables the interaction between operators/users and applications, connecting industrial control products such as wireless, transducer, battery inside, storage, etc. Tablet adopts a display for displaying and input units such as touch screen, keyboard, audio, kind of sensors etc. for writing working parameters or inputting operation commands. As a digital device for realizing information interaction between human and machine, Tablet is composed of hardware and software. Based on its ample function interfaces and powerful user operational interface, it is very suitable for control units such as medical device, intelligent transportation, industrial field, etc. Vantron's VT-Tablet products are based on the most advanced ARM, Rockchip processors and have low-power consumption and high integration. The products are designed for applications such as industrials, medicals, and transportations etc.

### **Ordering Information**

CPA-G1A-UNA4	<ul style="list-style-type: none"><li>• TFT LCD</li><li>• 1024*600</li><li>• RK-3368H, Octa-core 1.5GHz</li><li>• Speaker and MIC</li><li>• 3.7V/2600mAh battery</li><li>• WIFI/BT</li><li>• Z-wave</li><li>• LTE-1</li><li>• SRF</li></ul>
--------------	---

**Note:** LTE modules cannot transmit with other wireless Function at the same time.

**IQ Hub Hardware Instructions**

**Product Appearance**





Specifications

CPU	Processor	RK-3368H, ARM Octa-core Cortex-A53, Quad Core CPU,1.5GHz
Memory	RAM	2GB LPDDR3
	Flash	16GB EMMC Flash
Display	LCD	7" TFT LCD
	Resolution	1024*600 24bit Color
	Display Colors	16.7M
	Brightness	300cd/m2
	View Angle	85U/85D, 85L/85R
	Touch Screen	Cap-touch, multi-point

Supported Format	Audio	MP3, 3GPP, WAV
	Video	MP4, 3GPP
	Picture	BMP, GIF, JPEG, PNG
Interface	Wireless	<ul style="list-style-type: none"> <li>• 1x W-iFi 802.11a/b/g/n/ac, 1x Bluetooth4.2</li> <li>• 1x Z-wave</li> <li>• 1x LTE</li> <li>• 1x SRF</li> </ul>
	Internal Audio	Internal Speaker, Buzzer
		Internal MIC
	RTC	Supported
	10-85% RH (Non-Condensation), operating and storage	Supported
	LED	Bi-color LED (Green and Red)
Software	OS	Android 7.1+
Power	Battery	3.7V, 2600mAh
	DC Power Supply	12V,1.0A
Mechanical	Dimensions	196.4x155x25.6mm
	Weight	0.65 Kg
	Temperature	Operating Temperature: 0°C ~ +40°C

<b>Environment Condition</b>		Storage: -30℃ ~ +70℃
	Humidity	10-85% RH (Non-Condensation), operating and storage

## Interface Instructions

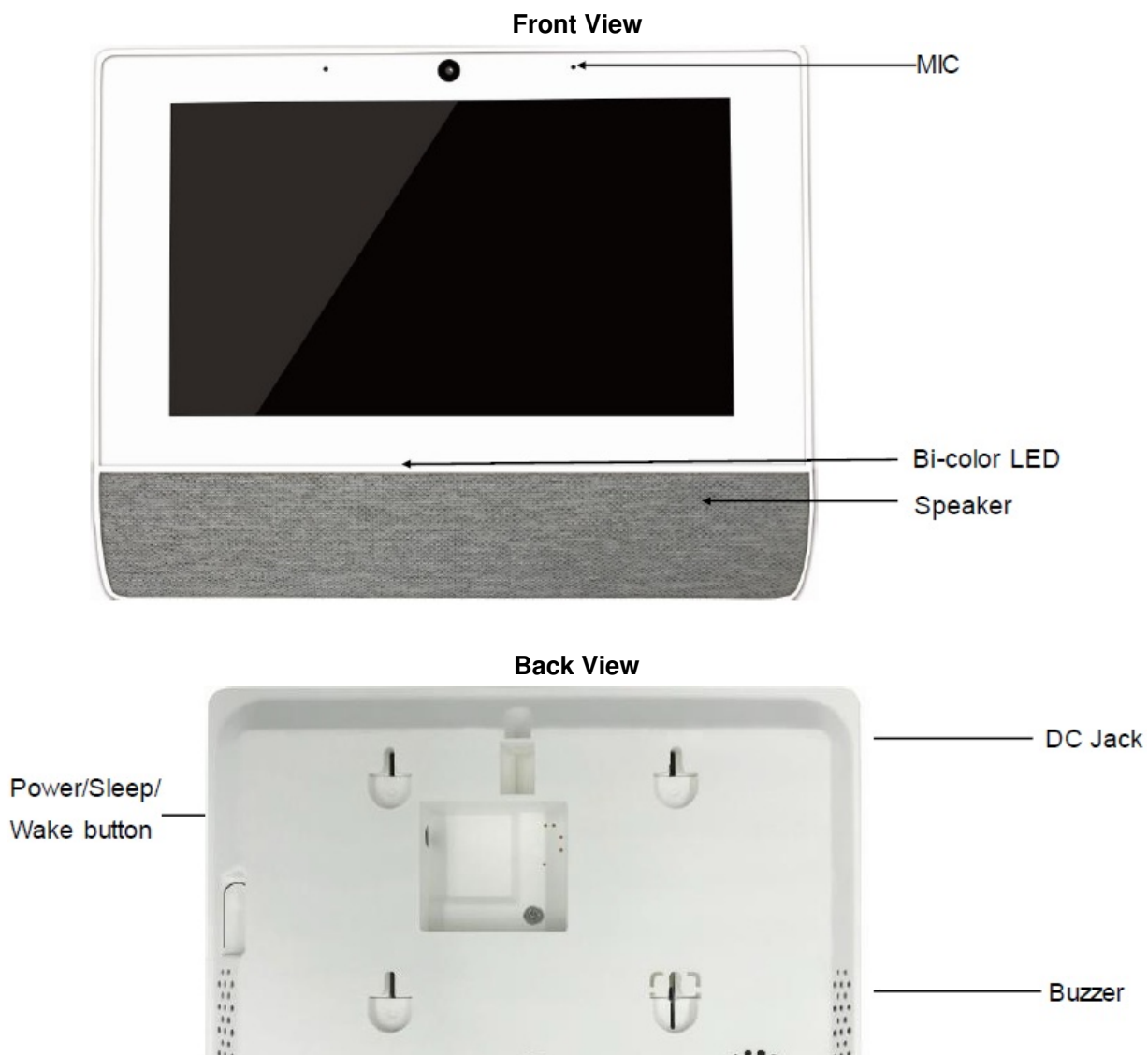

## Dimension

- Whole Device Size: 196.4 x 155 x 25.6 mm

## Power/Sleep/Wake Button

### • Power/Sleep/Wake Button

When you are not using the panel, you can turn off the display by press button

### • Lock Tablet

Press the Power/Sleep/Wake button

### • Unlock Tablet



Press the Power/Sleep/Wake button to wake from sleep, then drag the slider.

- **Turn Tablet on From Power-off**

Press and hold the Power/Sleep/Wake button until logo appears.

Never apply excessive pressure to a button, because this may cause unexpected damage that is not covered under the warranty.

Tablet cannot be turned off by pressing the button

## **Interface Description**

- **MIC**

Internal MIC with outstanding sensitivity and high SNR makes it very suitable for recording while suppressing the environment noise.

- **WIFI and BT**

The tablet supports 802.11 a/b/g/n/ac Wi-Fi and BT 4.2. With a good performance internal antenna, both WIFI and BT can achieve better connectivity.

- **Z-wave**

The tablet has the function of Z-wave connectivity so we can use it in a lot of aspects such as access control, appliance control, AV control, building automation, energy management, lighting, security, and sensor networks for the “Internet of Things”.

- **LTE**

The tablet supports LTE Cat 1 function, delivering M2M-optimized speeds of 10Mbps downlink and 5Mbps uplink. And it features ultra-low power consumption which can extend the battery lifecycle without DC adapter plugging in. (Report reference FCC ID:XMR201909EG91NAX)

- **Z-wave and SRF**

RF Card, 908MHz – 916MHz,319.5MHz(Report reference FCC ID:2AAJXQS-SRF319)

- **Speaker**

The tablet has an internal 1 watt speaker

- **Buzzer**

There is a high SPL buzzer in tablet. It features high sound when turned on

- **Gas Gauge**

A gas gauge is used to monitor the capacity of the li-polymer battery so we can figure out the status of it precisely and immediately

- **Front Camera**

The tablet has the ability to take beautiful photo and record the high resolution video.

- **RTC**

The tablet has internal RTC so the system time can keep a long time if we didn't turn it on.

## **Packing List**

No	Part Description	Quantity	Remark
1	CPA-G1A-UNA4	1 PCS	<ul style="list-style-type: none"> <li>• Power adapter</li> <li>• Table stand</li> <li>• Wall mount bracket</li> </ul>

## Software Instructions

### Brief Introduction

IQ Hub has been pre-loaded with Android image, so that the system can run Android tool to flash the system image.

### Safety Instruction

This section provides warnings that precede potentially dangerous procedures throughout this manual. Instructions contained in the warnings must be followed during all phases of operation, service, and repair of this equipment. You should also employ all other safety precautions necessary for the operation of the equipment in your operating environment. If you are not sure about the precautions applicable to your operating environment, please contact your company's safety administrator. For basic information you may also refer to the safety precautions per IEC704-1 listed below although Vantron disclaims all responsibility for the accuracy of any statements contained therein and its applicability for your specific environment. Failure to comply with these precautions or with specific warnings elsewhere in this manual could result in personal injury or damage to the equipment.

Vantron intends to provide all necessary information to install and handle the IQ Hub in this manual. Because of the complexity of this product and its various uses, we do not guarantee that the given information is complete. If you need additional information, contact your Vantron representative.

The product has been designed to meet the standard industrial safety requirements. It must not be used except in its specific area as specified in product specification.

Only personnel trained by Vantron or persons qualified in electronics or electrical engineering is authorized to install service or maintain the product. The information given in this manual is meant to complete the knowledge of a specialist and must not be used as replacement for qualified personnel. Operating personnel must not remove equipment covers. Only factory authorized service personnel or other qualified service personnel may remove equipment covers for internal subassembly or component replacement or any internal adjustment.

Do not install substitute parts or perform any unauthorized modification of the equipment or the warranty may be voided. Contact your local Vantron representative for service and repair to make sure that all safety features are maintained.

### Safety Precautions per IEC704-1

1. Read these safety instructions carefully.
2. Keep this User Manual for later reference.
3. Disconnect this equipment from any AC outlet before cleaning. Use a damp cloth. Do not use liquid or spray detergents for cleaning.
4. For plug-in equipment, the power outlet socket must be located near the equipment and must be easily accessible.
5. Keep this equipment away from humidity.
6. Put this equipment on a reliable surface during installation. Dropping it or letting it fall may cause damage.
7. The openings on the enclosure are for air convection. Protect the equipment from overheating. DO NOT COVER THE OPENINGS.

8. Make sure the voltage of the power source is correct before connecting the equipment to the power outlet.
9. Position the power cord so that people cannot step on it. Do not place anything over the power cord.
10. All cautions and warnings on the equipment should be noted.
11. If the equipment is not used for a long time, disconnect it from the power source to avoid damage by transient overvoltage.
12. Never pour any liquid into an opening. This may cause fire or electrical shock.
13. Never open the equipment. For safety reasons, the equipment should be opened only by qualified service personnel.
14. If one of the following situations arises, get the equipment checked by service personnel:
  - The power cord or plug is damaged.
  - Liquid has penetrated into the equipment.
  - The equipment has been exposed to moisture.
  - The equipment does not work well, or you cannot get it to work according to the user's manual.
  - The equipment has been dropped and damaged.
  - The equipment has obvious signs of breakage.
15. DO NOT LEAVE THIS EQUIPMENT IN AN ENVIRONMENT WHERE THE STORAGE TEMPERATURE MAY GO BELOW -20° C (-4° F) OR ABOVE 60° C (140° F). THIS COULD DAMAGE THE EQUIPMENT. THE EQUIPMENT SHOULD BE IN A CONTROLLED ENVIRONMENT.
16. CAUTION: DANGER OF EXPLOSION IF BATTERY IS INCORRECTLY REPLACED. REPLACE ONLY WITH THE SAME OR EQUIVALENT TYPE RECOMMENDED BY THE MANUFACTURER, DISCARD USED BATTERIES ACCORDING TO THE MANUFACTURER'S INSTRUCTIONS.

The sound pressure level at the operator's position according to IEC 704-1:1982 is no more than 70 dB (A).

**DISCLAIMER:** This set of instructions is given according to IEC 704-1. Advantech disclaims all responsibility for the accuracy of any statements contained herein.

### **Safety Precautions – Static Electricity**

Follow instructions below to protect yourself from harm and the products from damage:

1. Being sure you are at an ESD workstation, or grounded with an ESD strap before opening the top cover or installing/removing any unit accessible from the outside. Doing so will discharge any static electricity that might have built up in your body.
2. Don't touch any components inside the system while the system is on.
3. Disconnect power before making any configuration changes. The sudden rush of power as you connect a jumper or install a card may damage sensitive electronic components.
4. When unpacking a static-sensitive component from its shipping carton, do not remove the component's antistatic packing material until you are ready to install the component in the unit.
5. When transporting any electrical component, first place it in an antistatic container or packaging.

### **Waste Disposal**

It is recommended to disassemble the device before abandoning it in conformity with local regulations. Please ensure that the abandoned batteries are disposed according to local regulations on waste disposal. Do not throw batteries into fire (explosive) or put in common waste canister. Products or product packages with the sign of "explosive" should not be disposed like household waste but delivered to specialized electrical & electronic waste

recycling/disposal center. Proper disposal of this sort of waste helps avoiding harm and adverse effect upon surroundings and people's health. Please contact local organizations or recycling/disposal center for more recycling/disposal methods of related products.

### **Comply with the Following Safety Tips**

#### **Do not use in combustible and explosive environment.**

Keep away from combustible and explosive environment for fear of danger.

#### **Keep away from all energized circuits.**

Operators should not remove enclosure from the device. Only the group or person with factory certification is permitted to open the enclosure to adjust and replace the structure and components of the device. Do not change components unless the power cord is removed. In some cases, the device may still have residual voltage even if the power cord is removed. Therefore, it is a must to remove and fully discharge the device before contact so as to avoid injury.

#### **Unauthorized changes to this product or its components are prohibited.**

In the aim of avoiding accidents as far as possible, it is not allowed to replace the system or change components unless with permission and certification. Please contact the technical department of Vantron or local branches for help.

#### **Pay attention to caution signs.**

Caution signs in this manual remind of possible danger. Please comply with relevant safety tips below each sign. Meanwhile, you should strictly conform to all safety tips for operation environment.

#### **Notice**

Considering that reasonable efforts have been made to assure accuracy of this manual, Vantron assumes no responsibility of possible missing contents and information, errors in contents, citations, examples, and source programs.

Vantron reserves the right to make necessary changes to this manual without prior notice. No part of this manual may be reprinted or publicly released in forms of photocopy, tape, broadcast, e-document, etc.

#### **US Office: Vantron Technology, Inc.**

**Address:** 1292 Kifer Road #807, Sunnyvale, CA 94086

**Tel:** 510-304-7666

**Email:** [sales@vantrontech.com](mailto:sales@vantrontech.com)

#### **China Office: Chengdu Vantron Technology, Ltd.**

**Address:** 6th floor, 1st building, No.9, 3rd WuKe East Street, WuHou District, Chengdu, P.R. China 610045

**Tel:** 86-28-8512-3930/3931, 8515-7572/6320

**Email:** [sales@vantrontech.com.cn](mailto:sales@vantrontech.com.cn)

Changes or modifications not expressly approved by the party responsible for compliance could void the user's authority to operate the equipment.

This device complies with Part 15 of the FCC Rules. Operation is subject to the following two conditions:

1. This device may not cause harmful interference, and
2. This device must accept any interference received, including interference that may cause undesired operation.

The device has been evaluated to meet general RF exposure requirement, the device can be used in portable exposure condition without restriction.

**Note:** This equipment has been tested and found to comply with the limits for a Class B digital device, pursuant to Part 15 of the FCC Rules. These limits are designed to provide reasonable protection against harmful interference in a residential installation. This equipment generates, uses, and can radiate radio frequency energy, and if not

installed and used in accordance with the instructions, may cause harmful interference to radio communications. However, there is no guarantee that interference will not occur in a particular installation. If this equipment does cause harmful interference to radio or television reception, which can be determined by turning the equipment off and on, the user is encouraged to try to correct the interference by one or more of the following measures:

- Reorient or relocate the receiving antenna.
- Increase the separation between the equipment and receiver.
- Connect the equipment into an outlet on a circuit different from that to which the receiver is connected.
- Consult the dealer or an experienced radio/TV technician for help.

## Documents / Resources

	<p><a href="#">Vantron IQ Hubv1.1</a> [pdf] User Manual QS-IQHUB, QSIQHUB, 2AAJXQS-IQHUB, 2AAJXQSIQHUB, IQ Hubv1.1</p>
---	--