



## VANKYO Noise Cancelling Headset C751 User Manual

[Home](#) » [VANKYO](#) » VANKYO Noise Cancelling Headset C751 User Manual



NOISE-CANCELING HEADSET



**User Manual**

Please read the user manual thoroughly before use and keep it for future reference.

V1.02

## IMPORTANT

For the detailed Pairing Steps, please see page 6-10.

If you need any further assistance, please directly contact us at [support@ivankyo.com](mailto:support@ivankyo.com).

## CAUTIONS

1. Do not attempt to disassemble or repair the product yourself, please directly contact VANKYO for more help.
2. Do not use the product at high temperature, and near heat source or fire due to the built-in battery.
3. Please use the Type-C Cable we provided to charge the
4. Long time exposure to loud volume may cause hearing damage. It's advised you adjust the volume to a proper lever for use.
5. For your safety, it's not recommended to wear the headset when driving as it may result in distractions.
6. Please pay attention to the surroundings when you use the headset in case of potential risks.
7. Please recycle or dispose of the product according to your local environmental laws and regulations.

### Contents [ [hide](#)

- [1 PACKING LIST](#)
- [2 PRODUCT OVERVIEW](#)
- [3 CHARGE](#)
- [4 CONNECT WITH A MOBILE DEVICE](#)
- [5 FUNCTION OVERVIEW](#)
- [6 RESET](#)
- [7 SPECIFICATIONS](#)
- [8 Documents / Resources](#)
- [9 Related Posts](#)

## PACKING LIST



C751 Headset



Carrying Bag



3.5mm Audio Cable



Type-C Cable

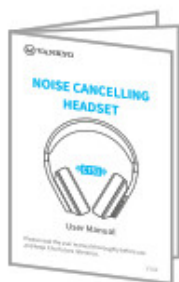

User Manual



Airline Adapter for  
C751 Headset

## PRODUCT OVERVIEW

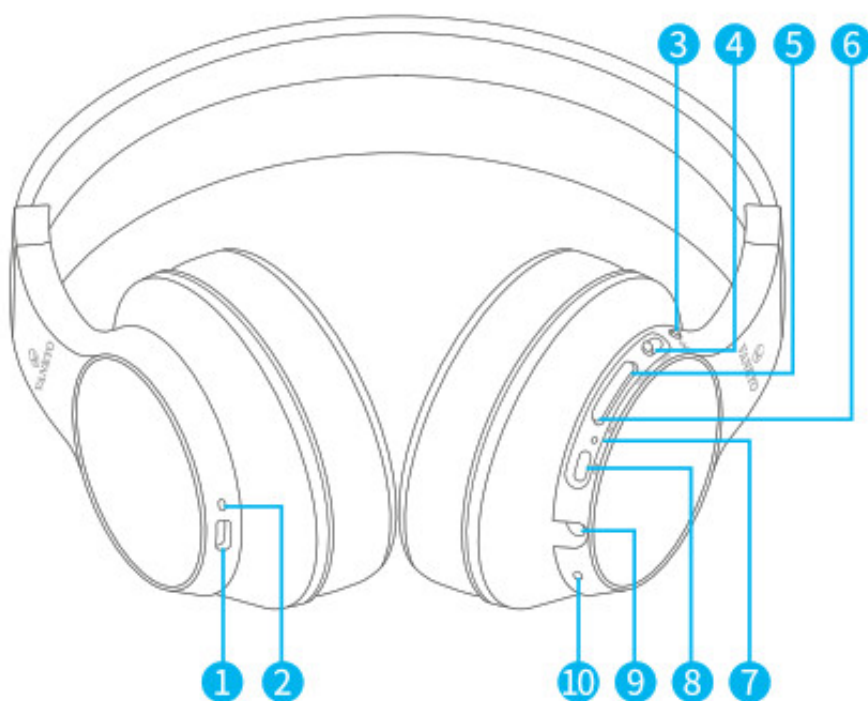

- |  |  |
|--|--|
| <ol style="list-style-type: none"><li>1. Type-C Connector</li><li>2. Charging Indicator</li><li>3. Power On/Off</li><li>4. ANC On/Off</li><li>5. Volume +(long press)/ Previous(short press)</li></ol> | <ol style="list-style-type: none"><li>6. Volume -(long press)/</li><li>7. Next(short press)</li><li>8. Pairing Indicator</li><li>9. Multi-function Button</li><li>10. 3.5mm Audio Jack ED Microphone</li></ol> |
|--|--|



## CHARGE

Please charge the headset at your first use.

Step 1: Connect one end of the Type-C Cable to the Type-C Connector on the headset.

Step 2: Connect the other end of the Type-C Cable to a compatible adapter, then plug the adapter into a socket.

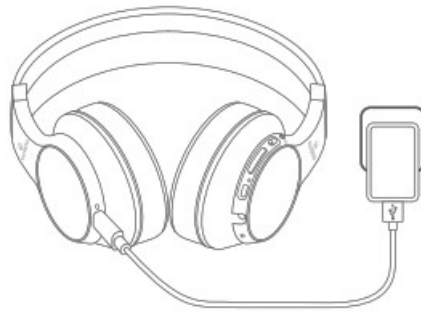

### Charging Indicator

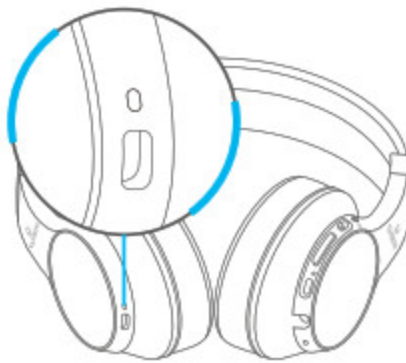

Charging: Solid White  
Fully Charged: Off Low  
Battery: Flash Red



#### Tips:

1. It takes about 3 hours to reach a full charge.
2. It's recommended to charge the headset in the power-off state.
3. When the battery of the headset gets low, the Charging Indicator will flash red and you will hear "Low Battery" from it.

## POWER ON/OFF

### Power On

Push the Power On/Off button upward to power on the headset, and you will hear "Power On. Pairing" from it.

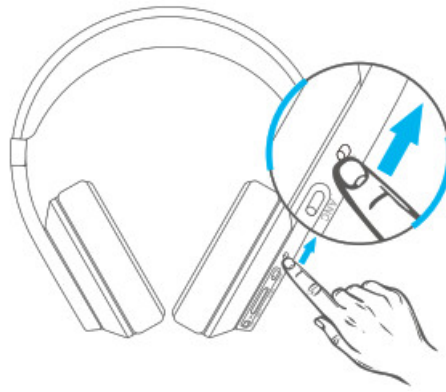

## Power Off

To power the headset off, push the Power On/Off button downward; or it will automatically power off when it's not connected with any Bluetooth device within 5 minutes.



## CONNECT WITH A MOBILE DEVICE

### Wireless Connection Connect

**Step 1:** After you power on the headset, the Pairing Indicator will quickly flash red and blue alternately, which means the headset is ready to be paired with your mobile device.



**Step 2:** Turn on the Bluetooth of your mobile device, then connect to Vankyo C751 from the searching list.



**Step 3:** After connection, you will hear “Connected” from the headset and the Pairing Indicator will always flash blue.



**Tips:**

1. Please connect the headset with your mobile device within 5 minutes.
2. If you power off the headset, it will automatically connect with the last mobile device when you power on again.

**Disconnect**

Go to the Bluetooth interface of your mobile device, select Vankyo C751, and Disconnect/Unpair to disconnect the headset. You will hear a voice prompt of “Disconnected. Pairing”.

Simultaneously connect to two mobile devices

This headset is able to connect to two mobile devices with Bluetooth. With this function, you will not miss the call on one mobile device when you are listening to music on another mobile device with the headset.

Step 1: Connect the headset with the first mobile device via Bluetooth.

Step 2: Disconnect the headset with the first mobile device.

Step 3: Connect the headset with the second mobile device via Bluetooth.

Step 4: Disconnect the headset with the second mobile device.

Step 5: Go to the Bluetooth list of both mobile devices to search Vankyo C751, then connect it on both mobile devices.

When you are using the headset to listen to the music from the first mobile device, if there is a call from the second mobile device, you can hear the ringtone from the headset and answer that call.



**Tip:**

If both devices are connected to this headset before, you can directly go to the Bluetooth list of both mobile devices to connect with it.

**Wired Connection**

Step 1: Plug one end of the 3.5mm Audio Cable into the headset.

Step 2: Plug the other end of the 3.5mm Audio Cable into the Audio Jack of your mobile device.

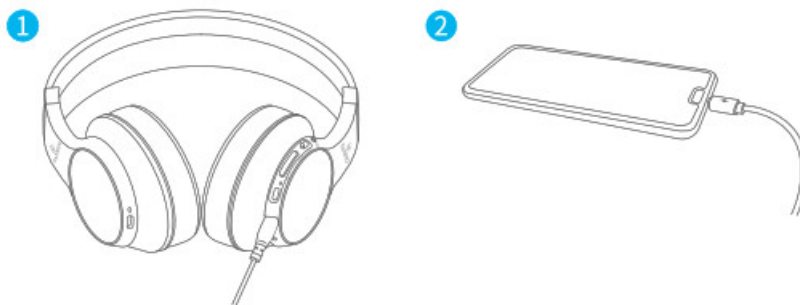

**Tip:**

The Airline Adapter for Headset will be needed when you are in an airplane.

## FUNCTION OVERVIEW

### Music

	* Press once to play the music; press it again to pause the music.
	* Press once to play the previous song. * Long press to turn up the volume.
	* Press once to play the next song. * Long press to turn down the volume.
	* Double press to change the band of EQ(Equalization), which are Pop (Default), Bass Boost, Treble Boost, Rock, and Jazz.



Tip: When you use the 3.5mm Audio Cable to connect the headset with the mobile device, all the functions of Music can only be realized by operating on your mobile device.

### Calls

	* Press once to answer the incoming call; Press it again to end the current call.
	* Long press to decline the incoming call.
	* Double press to call back the last call you dialed out.

### Wake up Voice Assistant

	* Long press to wake up the voice assistant on your mobile device.
--	--

### Active Noise Control

If you are in a relatively noisy environment, please push the ANC On/Off button upward to enable the noise canceling function for a better listening experience.



## RESET

To reset the headset, press and hold the Volume+/- button for around 8 seconds when it's not connected to any Bluetooth device after powering on. When you hear two beeps from the headset, it means that all Bluetooth devices are cleared.

## SPECIFICATIONS

BT Version	V5.0
Effective Distance	10m
Frequency Range	20Hz-20KHz
Impedance	32Ω
Power Input	DC 5V =180MA
Speakers	40mm Driver
Charging Time	Around 3 Hours
Charging Connector	Type-C
Battery Capacity	600mAh

### FCC Caution

Any changes or modifications not expressly approved by the party responsible for compliance could void the user's authority to operate the equipment. This device complies with part 15 of the FCC Rules. Operation is subject to the following two conditions:

- (1) This device may not cause harmful interference, and
- (2) this device must accept any interference received, including interference that may cause undesired operation.

**NOTE:** This equipment has been tested and found to comply with the limits for a Class B digital device, pursuant to part 15 of the FCC Rules. These limits are designed to provide reasonable protection against harmful interference in a residential installation. This equipment generates, uses, and can radiate radio frequency energy and, if not installed and used in accordance with the instructions, may cause harmful interference to radio communications. However, there is no guarantee that interference will not occur in a particular installation. If this equipment does cause harmful interference to radio or television reception, which can be determined by turning the equipment off and on, the user is encouraged to try to correct the interference by one or more of the following measures: —Reorient or relocate the receiving antenna. —Increase the separation between the equipment and receiver. —Connect the equipment into an outlet on a circuit different from that to which the receiver is connected. —Consult the dealer or an experienced radio/TV technician for help. This equipment complies with FCC radiation



exposure limits set forth for an uncontrolled environment. This transmitter must not be co-located or operating in conjunction with any other antenna or transmitter. ISED Warning This device complies with Industry Canada licence-exempt RSS standard(s). Operation is subject to the following two conditions: (1) this device may not cause interference, and (2) this device must accept any interference, including interference that may cause undesired operation of the device.

### CAUTION

RISK OF EXPLOSION IF BATTERY IS REPLACED BY AN INCORRECT TYPE.

DISPOSE OF USED BATTERIES ACCORDING TO THE INSTRUCTIONS =

--- The symbol indicates DC voltage



RECYCLING

This product bears the selective sorting symbol for waste electrical and electronic equipment (WEEE). This means that this product must be handled pursuant to European directive 2012/19/EU in order to be recycled or dismantled to minimize its impact on the environment. Manufacturer Shenzhen Qing YangXin Technology Co., Ltd.

Address 2-3F, Xinyibao Packing Building, Jiuwei Village, Hangcheng District, Baoan District, Shenzhen

### EC I REP

BellaCocool GmbH  
PettenkoferstraRe 18,10247,  
Berlin, Germany  
[info@bellacocool.de](mailto:info@bellacocool.de)

### CUSTOMER SUPPORT

North America: [support@ivankyo.com](mailto:support@ivankyo.com)

United Kingdom: [support.uk@ivankyo.com](mailto:support.uk@ivankyo.com)

 <a href="http://www.ivankyo.com">www.ivankyo.com</a>	 @VankyoOfficial	 VANKYO
<a href="https://qrs.ly/fc7wkt2">https://qrs.ly/fc7wkt2</a>	<a href="https://qrs.ly/awad7ea">https://qrs.ly/awad7ea</a>	<a href="https://qrs.ly/diad7dp">https://qrs.ly/diad7dp</a>

### Documents / Resources



[VANKYO Noise Cancelling Headset C751](#) [pdf] User Manual  
Noise, Cancelling, Headset, C751, VANKYO