



VALBERG CS 315 C X742C Refrigerator Freezer Instruction Manual

[Home](#) » [VALBERG](#) » VALBERG CS 315 C X742C Refrigerator Freezer Instruction Manual 

VALBERG
 **ELECTRO DEPOT**
CS 315 C X742C Refrigerator Freezer
Instruction Manual



Refrigerator Freezer
978547 – CS 315 C X742C

Contents

- 1 CS 315 C X742C Refrigerator Freezer
- 2 Product overview
- 3 Product usage
- 4 Installation
- 5 Cleaning and maintenance
- 6 Troubleshooting
- 7 WARRANTY CONDITIONS
- 8 Documents / Resources
 - 8.1 References

CS 315 C X742C Refrigerator Freezer

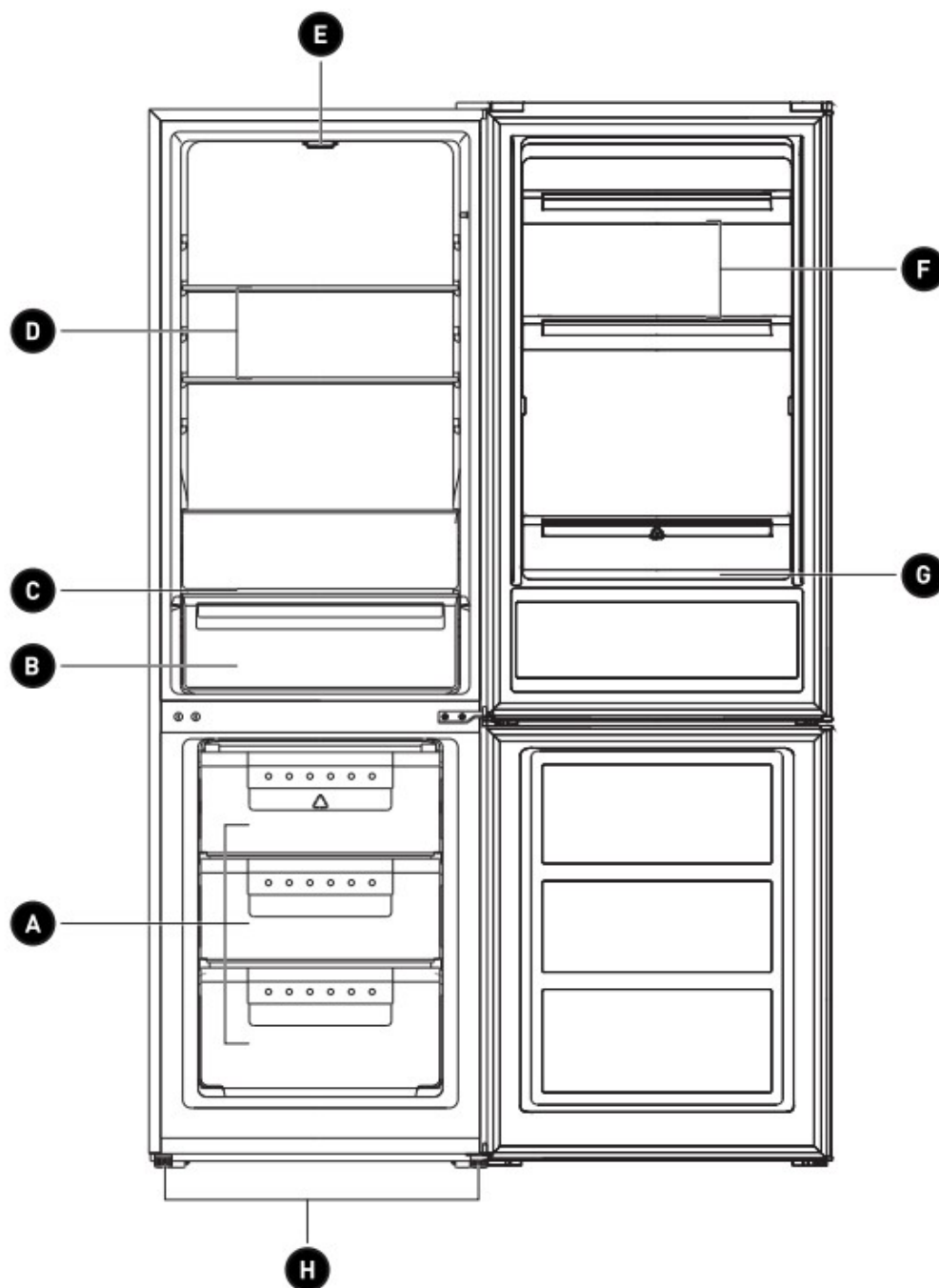

Thank you!

Thank you for choosing this VALBERG product. VALBERG products are chosen, tested, and recommended by ELECTRO DEPOT, so you can be sure you are getting a top-quality, easy-to-use product that won't let you down. We're confident your new device will be a pleasure to use every day! Welcome to ELECTRO DEPOT.

Product overview

Parts

- A Freezer drawers
- B Crisper
- C Crisper cover
- D Glass shelves
- E Thermostat and light
- F Upper balconies
- G Bottom balconies
- H Leveling feet

**Note:**

This illustration is only for hinting, the detail please check your appliance.

Product usage**Reverse Door**

Tool required: Philips screwdriver, Flat bladed screwdriver, Hexagonal spanner.

- Ensure the unit is unplugged and empty.
- To take the door off, it is necessary to tilt the unit backwards. You should rest the unit on something solid so that it will not slip during the door reversing process.
- All parts removed must be saved to do the reinstallation of the door.
- Do not lay the unit flat as this may damage the coolant system.
- It's better that 2 people handle the unit during assembly.

1. Unscrew and remove the hinge cover.

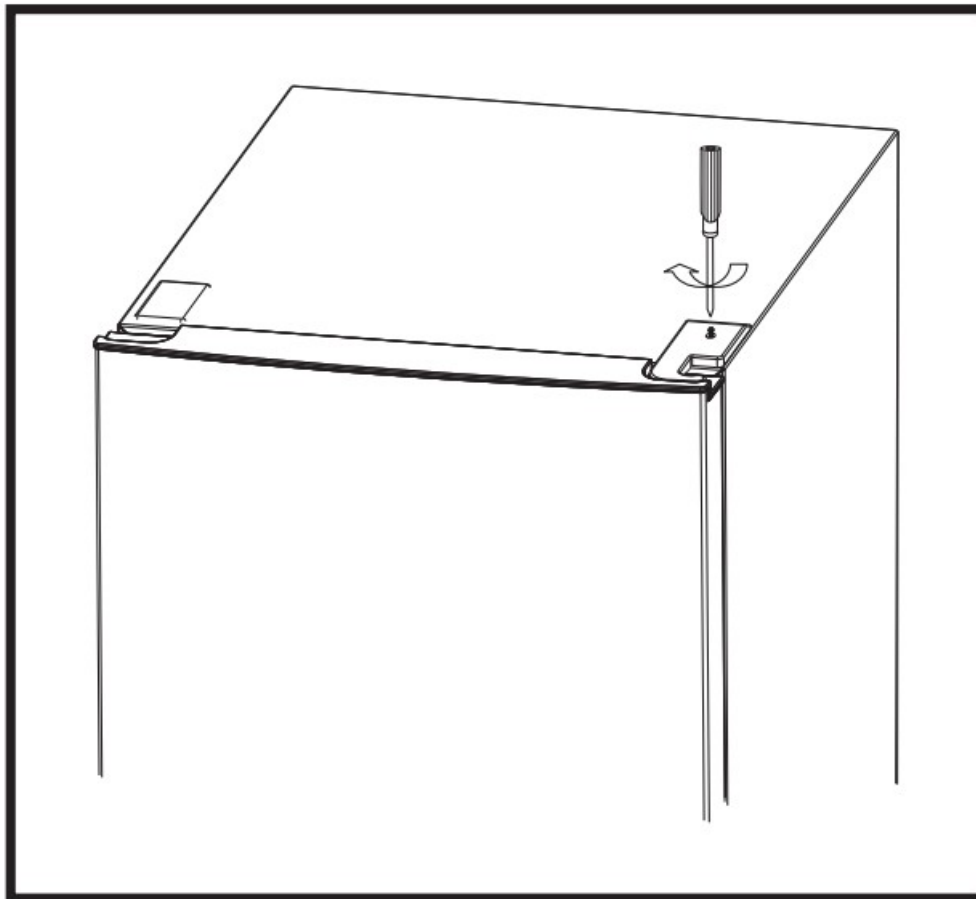

2. Unscrew and remove the hinge.

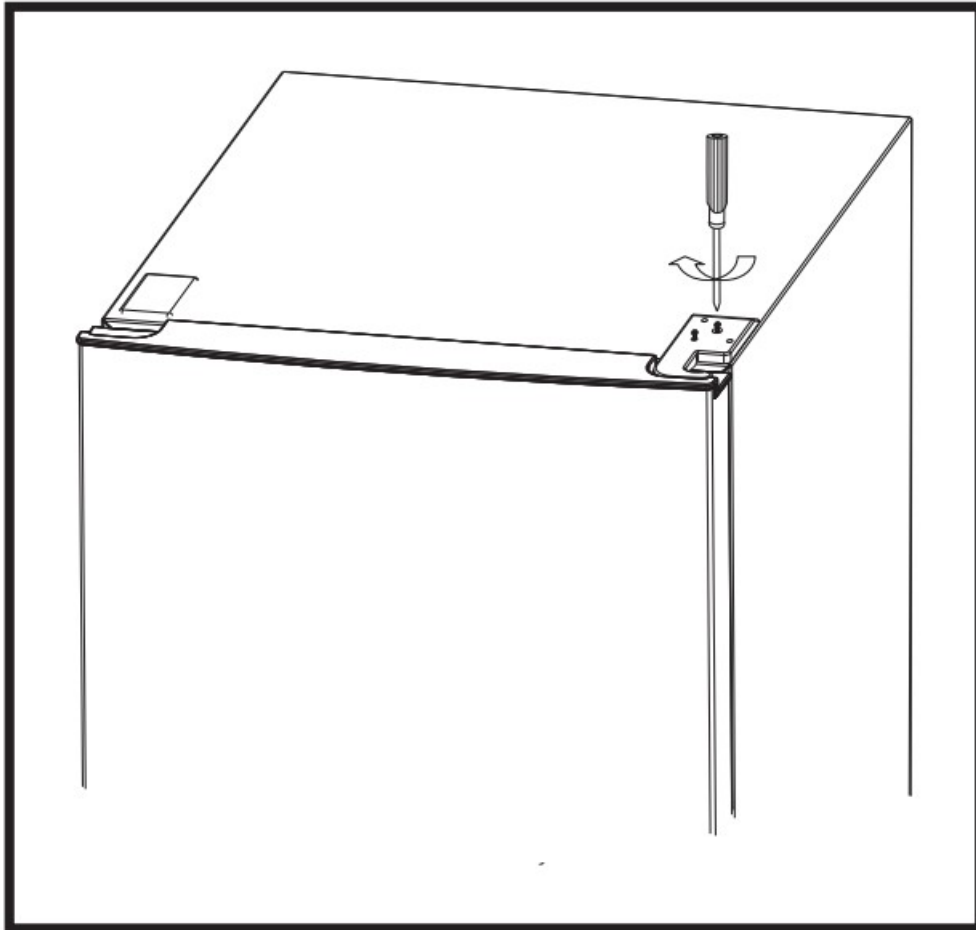

3. Unscrew middle hinge. Then lift lower door and place it on a soft pad to avoid scratch.

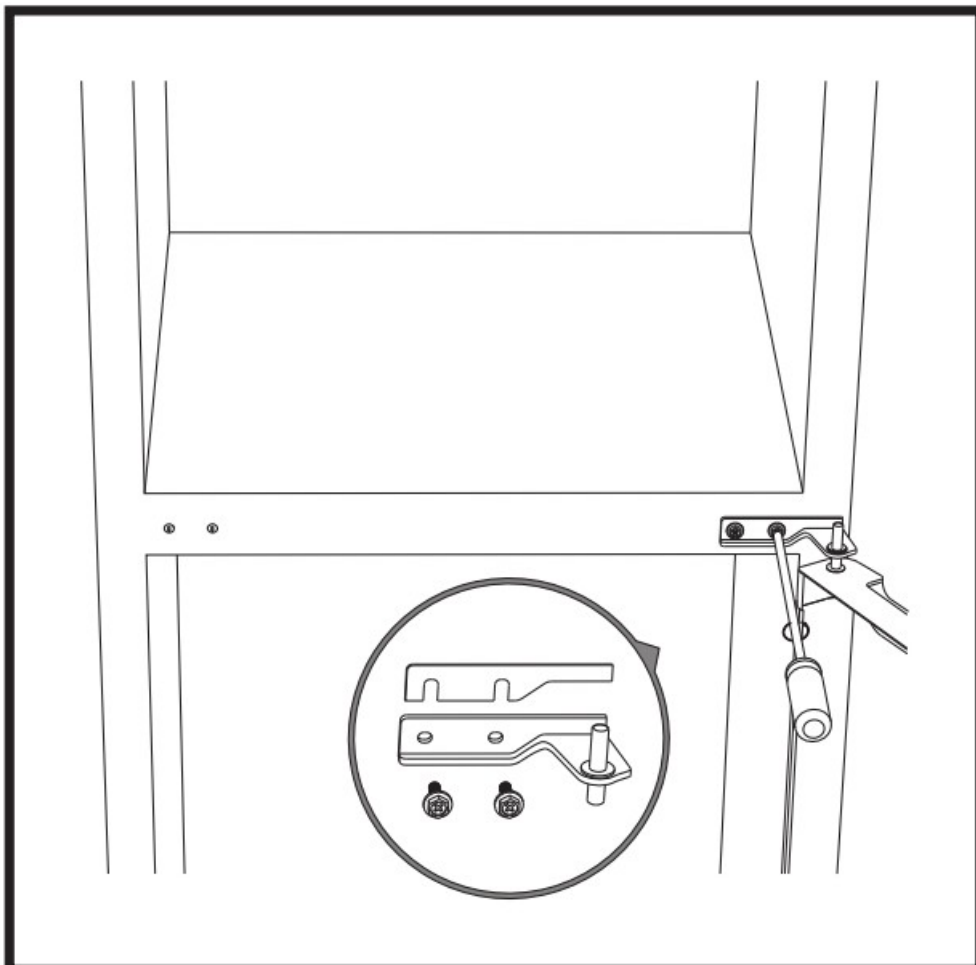

4. Move the hinge hole covers from left side to right side.

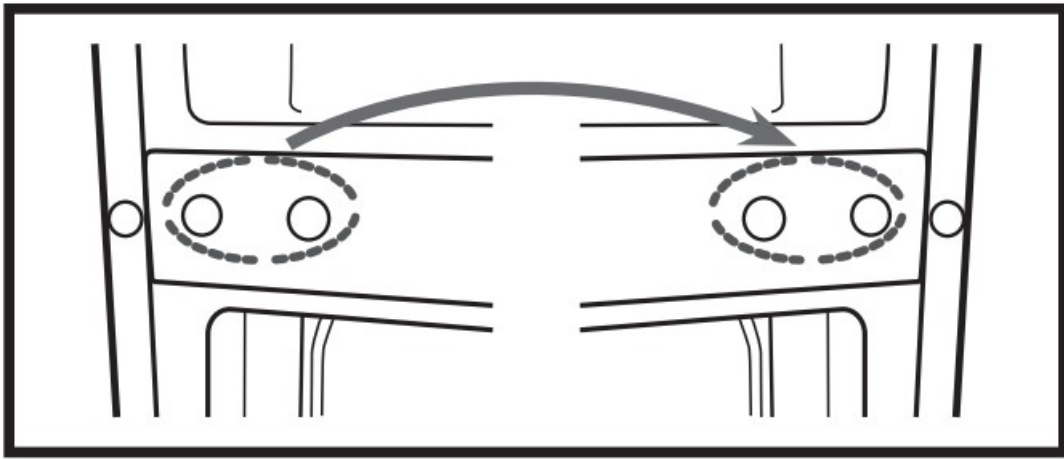

5. Unscrew bottom hinge. Then remove the adjustable feet from both side.

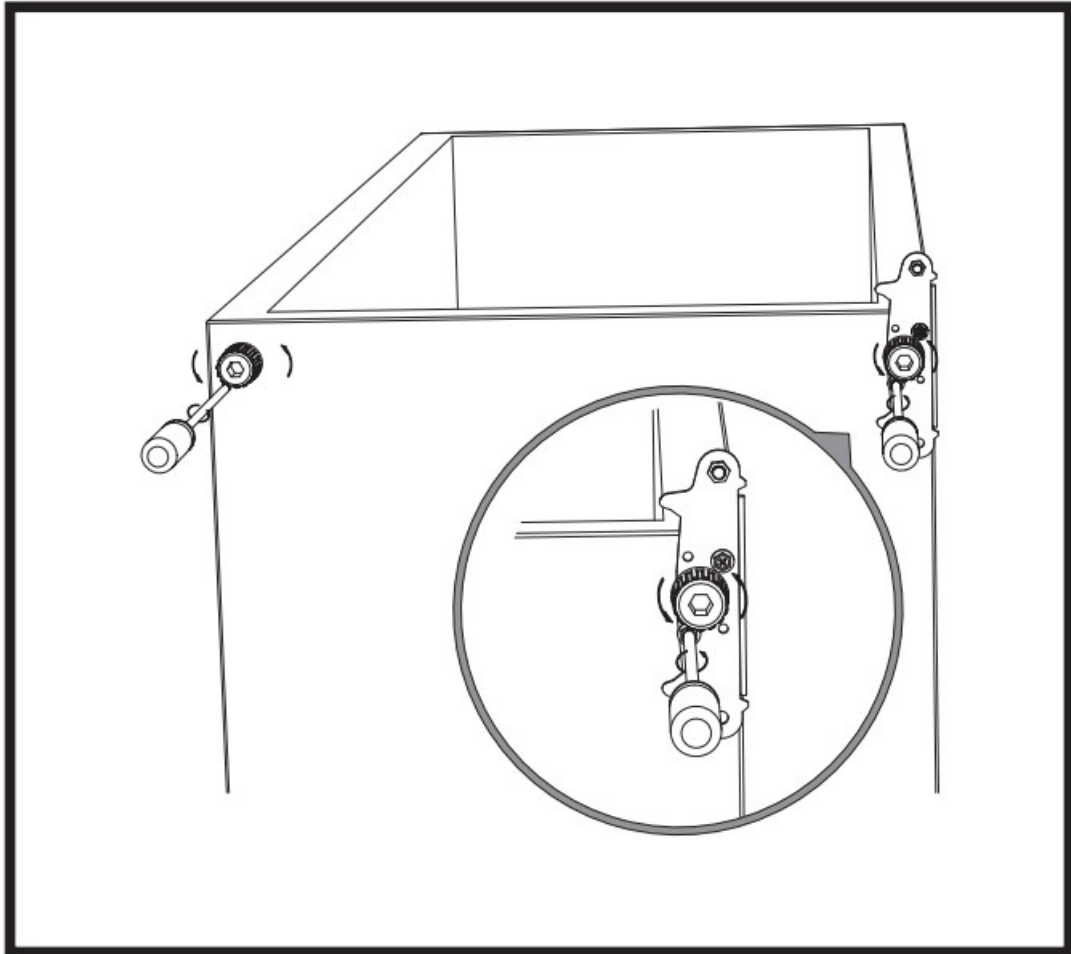

6. Unscrew and remove the bottom hinge pin, turn the bracket over and replace it.

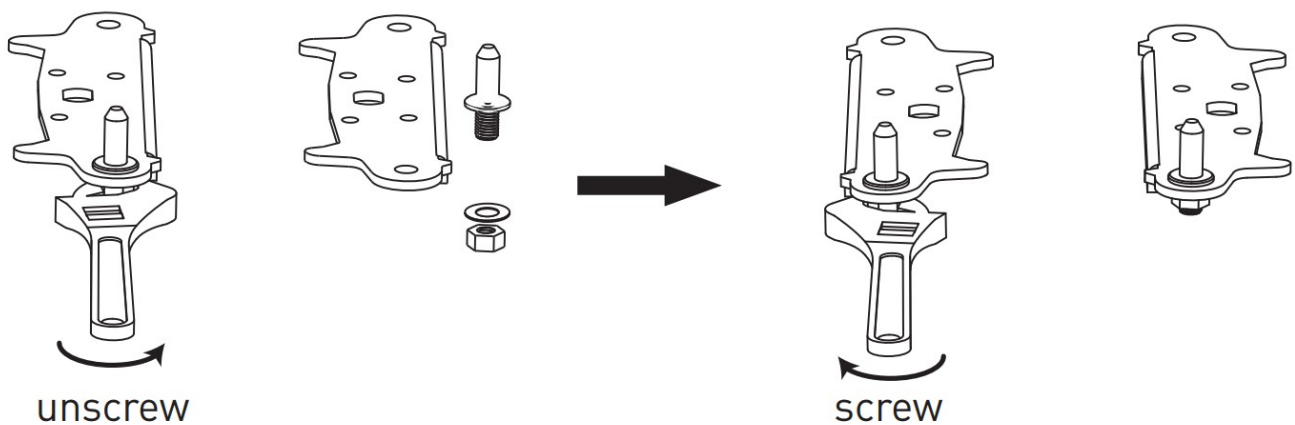

7. Refit the bracket fitting the bottom hinge pin. Replace both adjustable feet. Transfer the lower door to the property position.

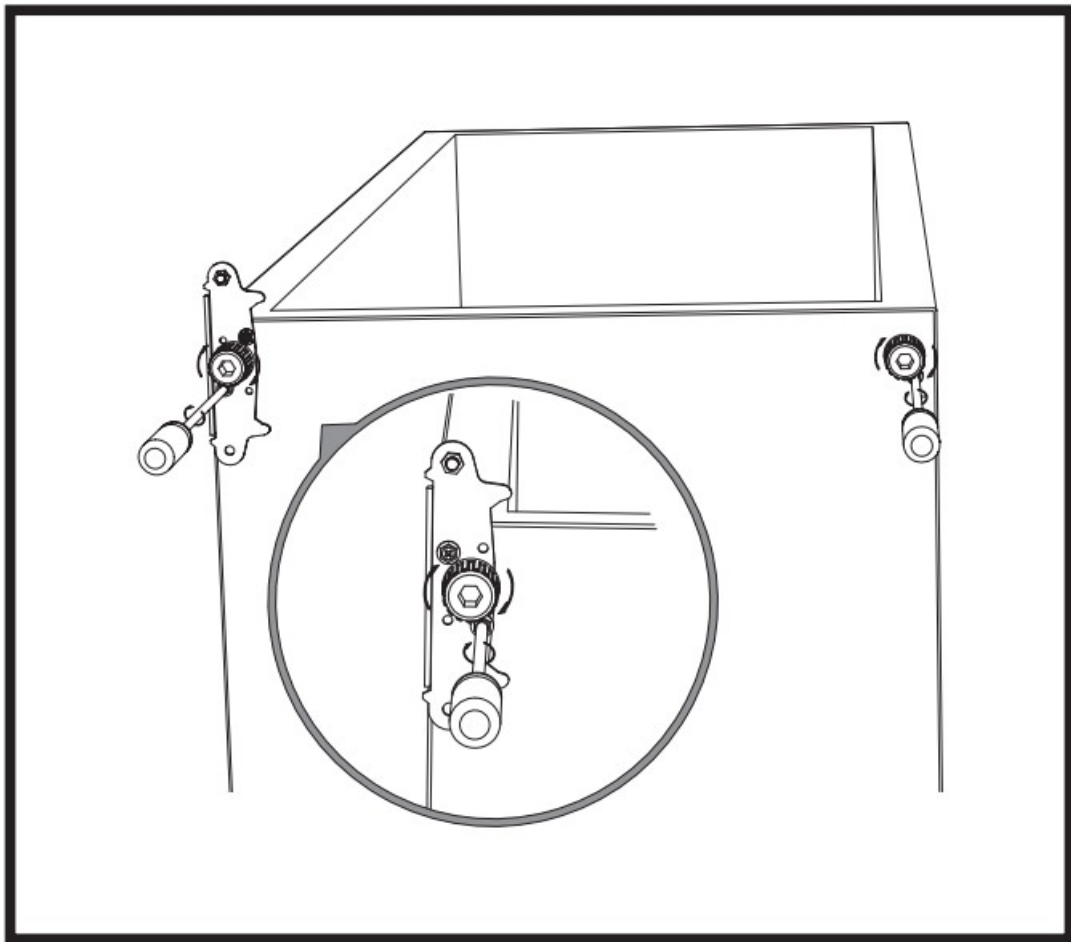

8. Detach the Fridge and the Freezer door gaskets and then attach them after rotating.

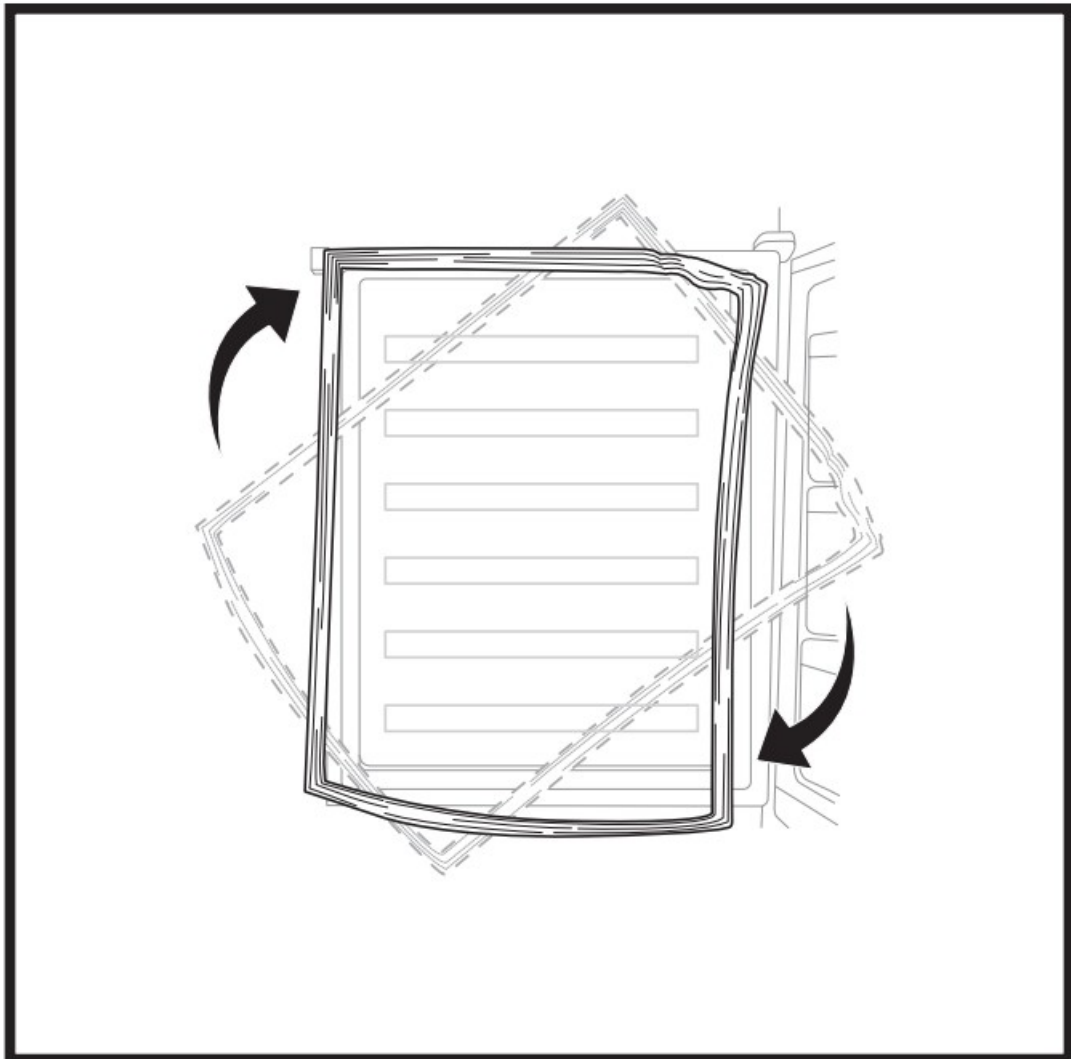

9. Make the middle hinge reverse the direction 180°, then transfer it to the left property position. Make the middle hinge pin in the upper hole of the lower door, then tight the bolts.

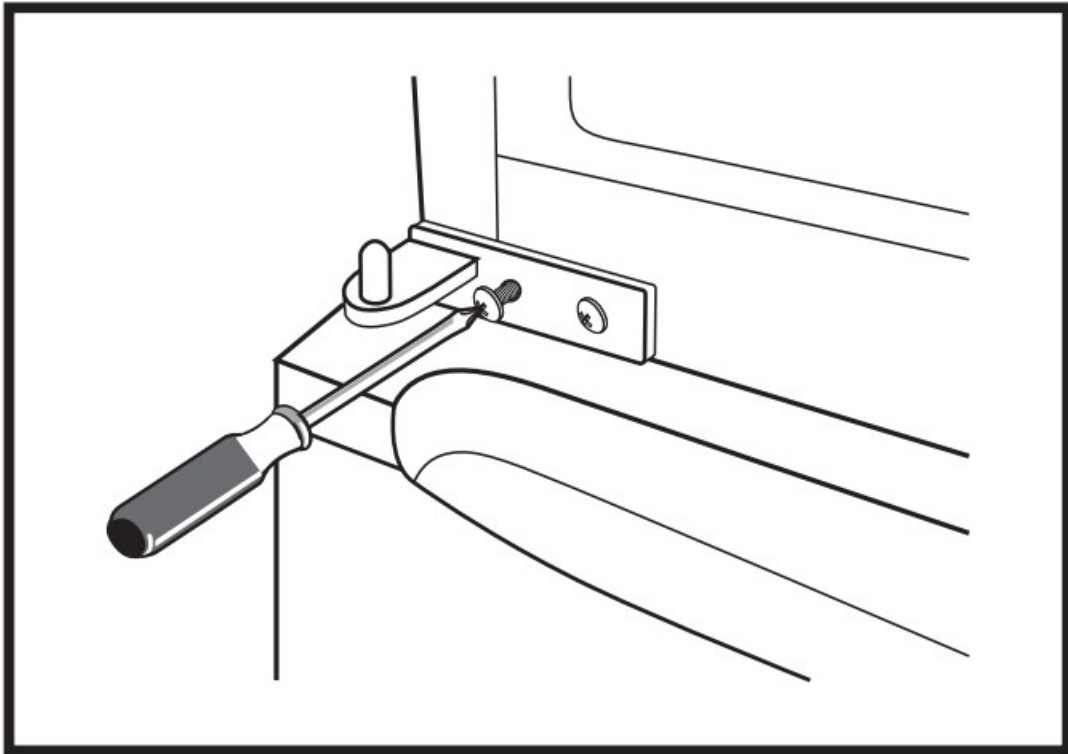

10. Place the upper door back on. Ensure the door is aligned horizontally and vertically so that the seal are closed on all sides before finally tightening the top hinge. Then inert the hinge and screw it to the front of the unit.

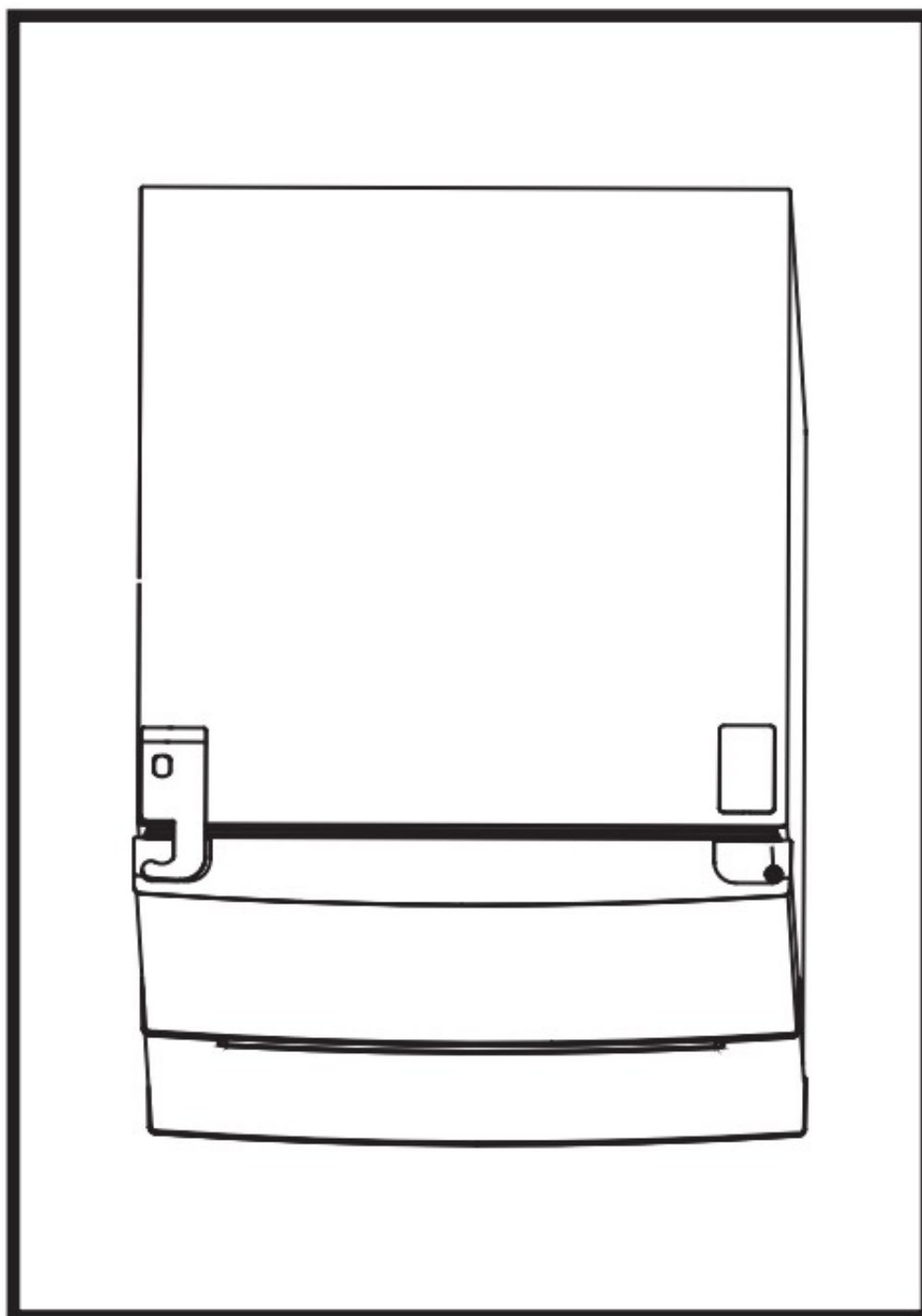

11. Unscrew the hinge pin and reverse the hinge, then reinstall the hinge pin.

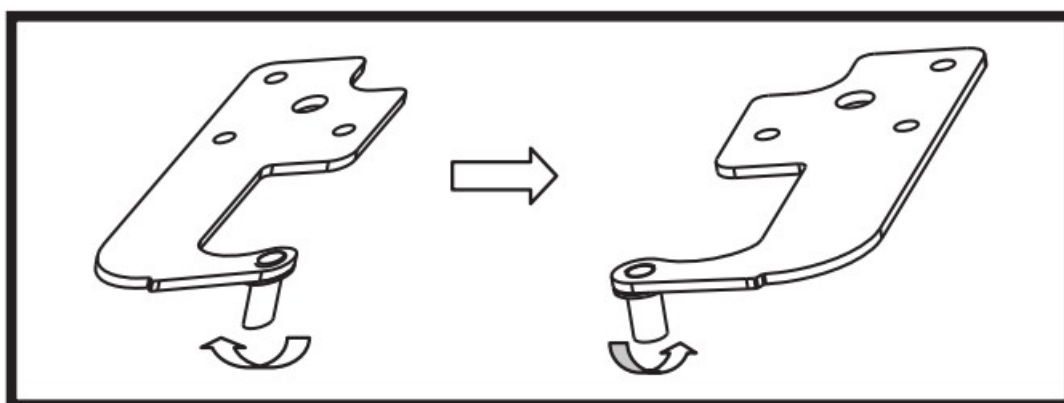

12. Prise the hinge hole cover.

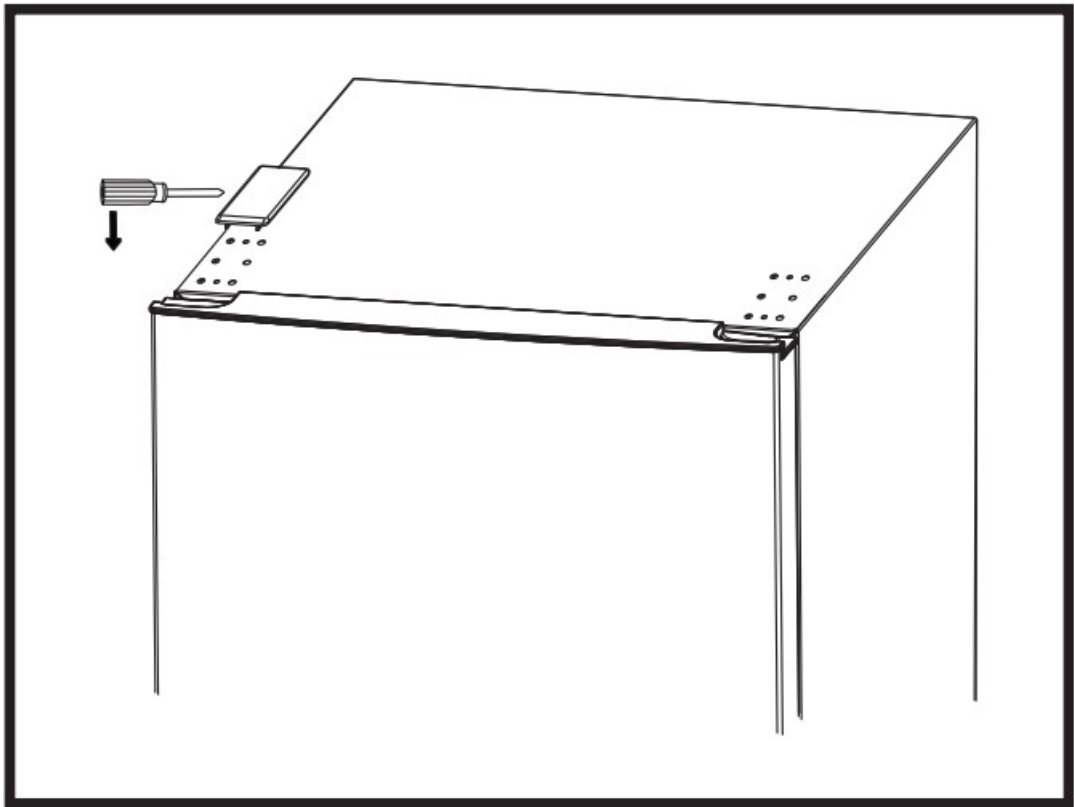

13. Fix the hinge on the left.

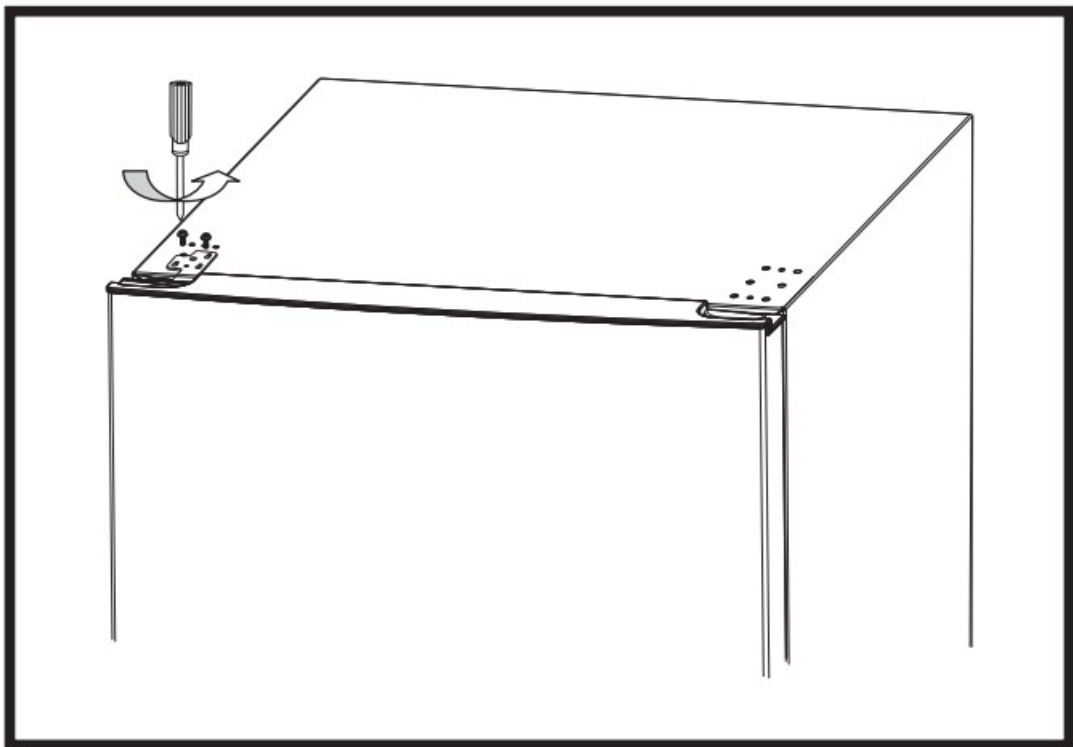

14. Fix the hinge cover on the left and the hinge hole cover on the right.

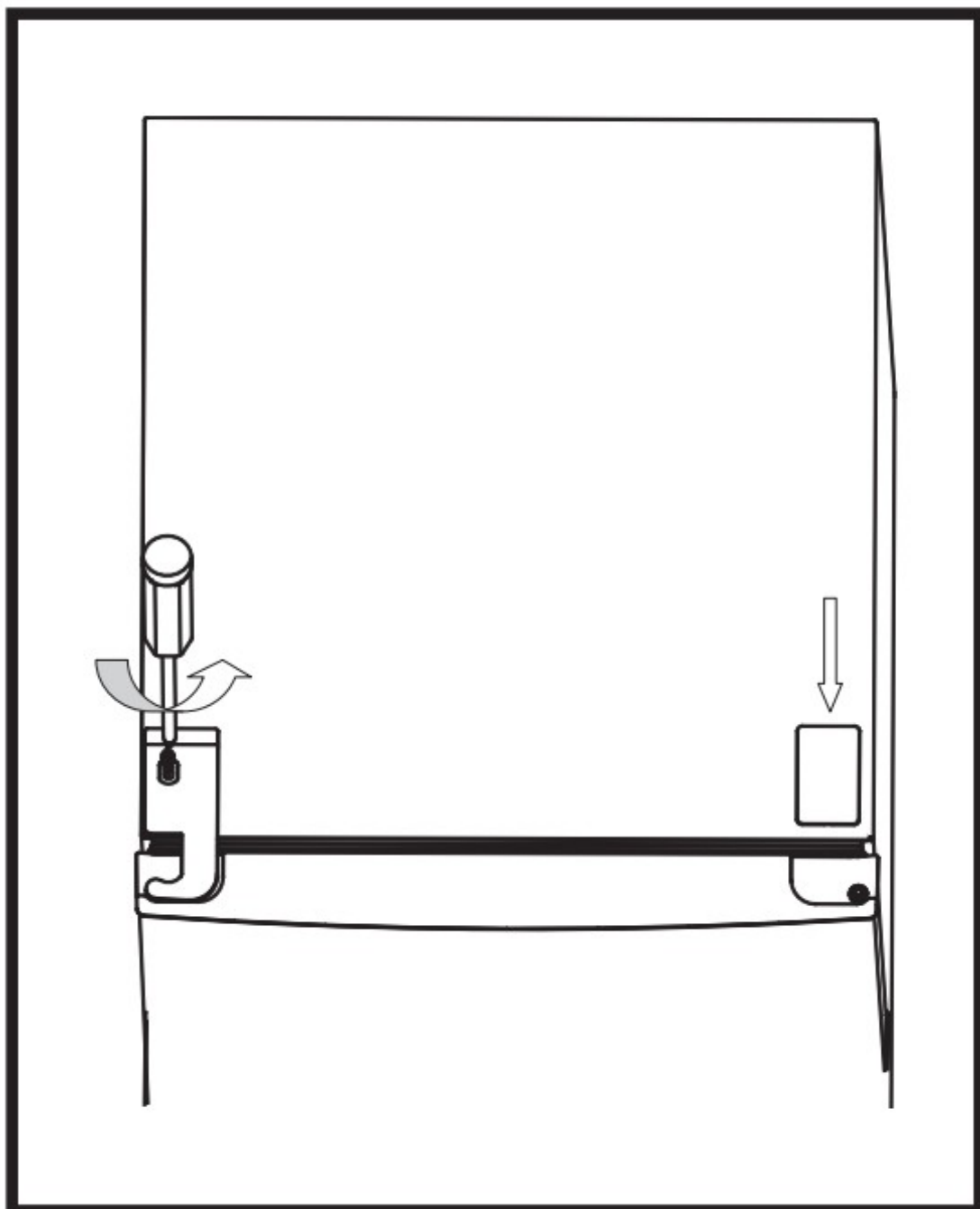

Installation

Space Requirement

- Keep enough space of door open.
- Keep at least 50mm gap at two sides and back.

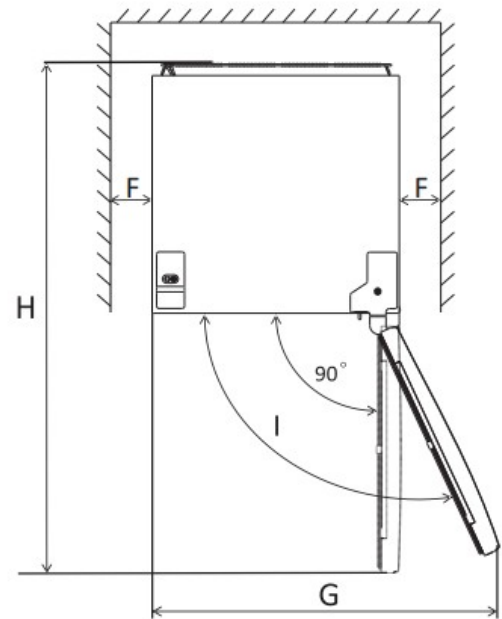
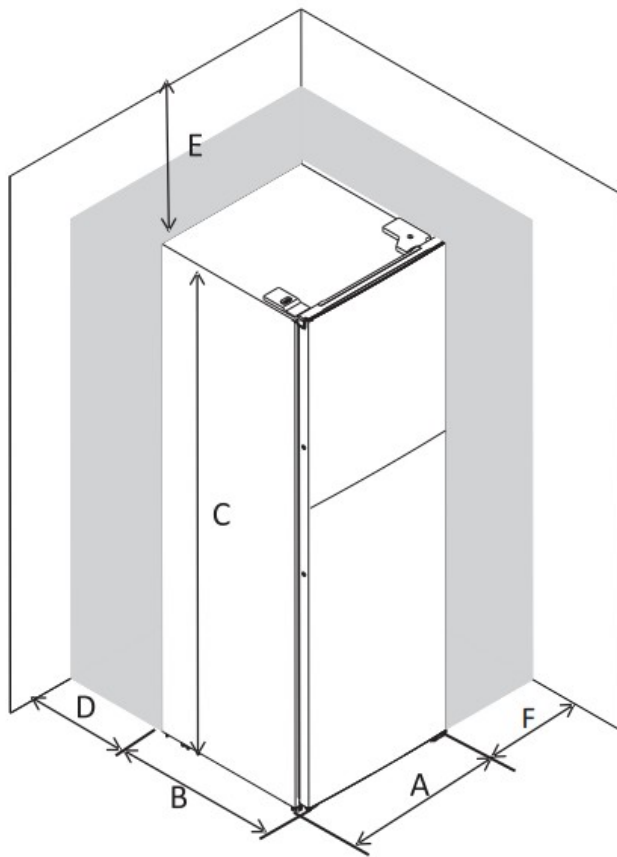

A:	600
B:	605
C:	1858
D:	min=50
E:	min=50
F:	min=50
G:	1200
H:	1205
I:	135°

Levelling the unit

To do this adjust the two levelling feet at front of the unit.

If the unit is not level, the doors and magnetic seal alignments will not be covered properly.

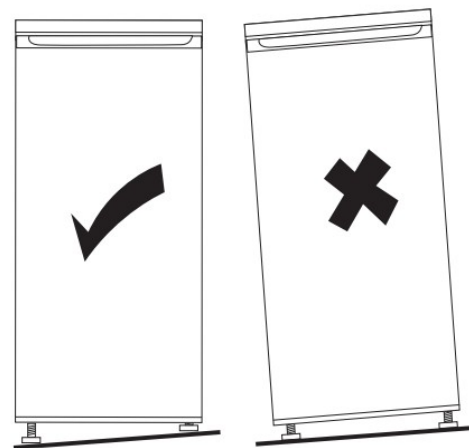
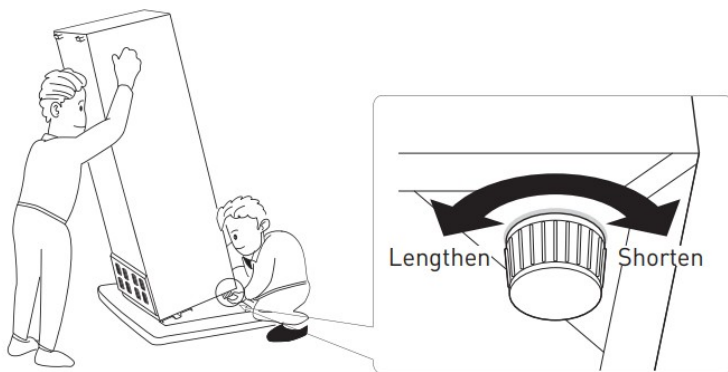

Positioning

Install this appliance at a location where the ambient temperature corresponds to the climate class indicated on the rating plate of the appliance:

For refrigerating appliances with climate class:

- extended temperate: this refrigerating appliance is intended to be used at ambient temperatures ranging from 10 °C to 32 °C; (SN)
- temperate: this refrigerating appliance is intended to be used at ambient temperatures ranging from 16 °C to 32 °C; (N)
- subtropical: this refrigerating appliance is intended to be used at ambient temperatures ranging from 16 °C to 38 °C; (ST)
- tropical: this refrigerating appliance is intended to be used at ambient temperatures ranging from 16 °C to 43 °C; (T)

Location

The appliance should be installed well away from sources of heat such as radiators, boilers, direct sunlight etc. Ensure that air can circulate freely around the back of the cabinet. To ensure best performance, if the appliance is positioned below an overhanging wall unit, the minimum distance between the top of the cabinet and the wall unit must be at least 50 mm. Ideally, however, the appliance should not be positioned below overhanging wall units. Accurate leveling is ensured by one or more adjustable feet at the base of the cabinet. This refrigerating appliance is not intended to be used as a built-in appliance;

Warning! It must be possible to disconnect the appliance from the mains power supply; the plug must therefore be easily accessible after installation.



Electrical connection

Before plugging in, ensure that the voltage and frequency shown on the rating plate correspond to your domestic power supply. The appliance must be earthed. The power supply cable plug is provided with a contact for this purpose. If the domestic power supply socket is not earthed, connect the appliance to a separate earth in compliance with current regulations, consulting a qualified electrician.

The manufacturer declines all responsibility if the above safety precautions are not observed.

This appliance complies with the E.E.C. Directives.

Daily Use

First use

Cleaning the interior

Before using the appliance for the first time, wash the interior and all internal accessories with lukewarm water and some neutral soap so as to remove the typical smell of a brand new product, then dry thoroughly.



Important! Do not use detergents or abrasive powders, as these will damage the finish.

Temperature Setting

- Plug on your appliance. The internal temperature is controlled by a thermostat. There are 8 settings. 1 is warmest setting and 7 is coldest, when set is 0, the appliance is switched off. When set is max, compressor will not stop.
- The appliance may not operate at the correct temperature if it is in a particularly hot or if you open the door often.

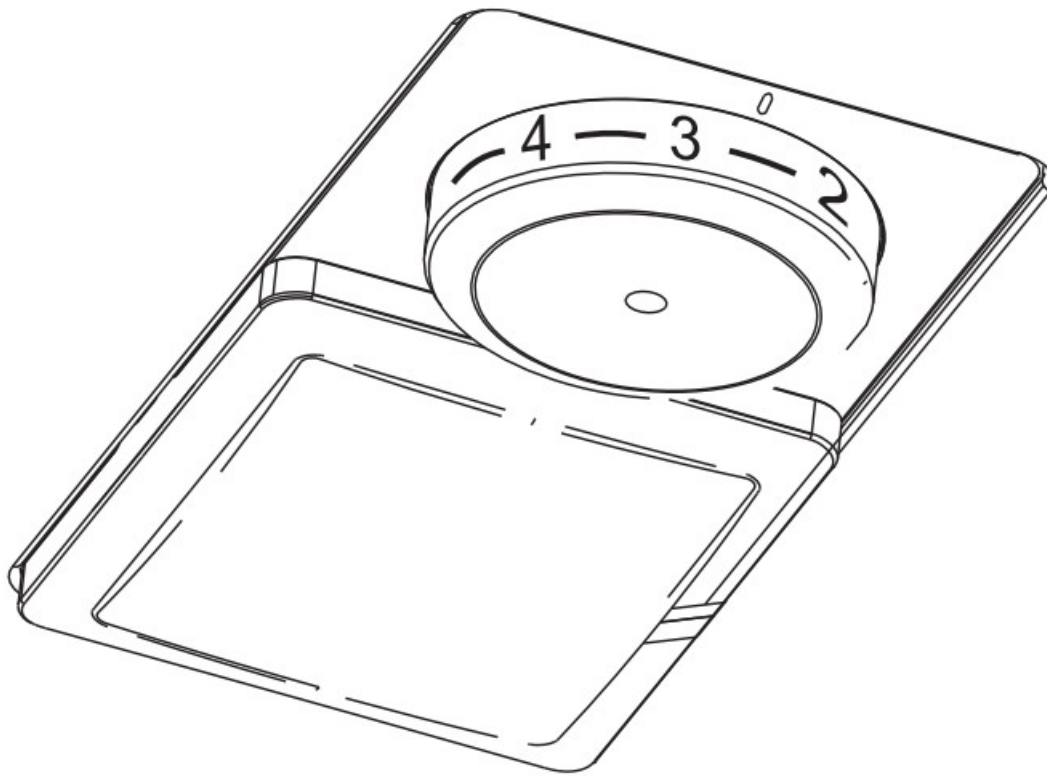

Daily use

Position different food in different compartments according to be below table:

Refrigerator compartments	Type of food
Door or balconies of fridge compartment	<ul style="list-style-type: none"> • Foods with natural preservatives, such as jams, juices, drinks, condiments. • Do not store perishable foods.
Crisper drawer (salad drawer)	<ul style="list-style-type: none"> • Fruits, herbs and vegetables should be placed separately in the crisper bin. • Do not store bananas, onions, potatoes, garlic in the refrigerator.
Fridge shelf – middle	<ul style="list-style-type: none"> • Dairy products, eggs
Fridge shelf – top	<ul style="list-style-type: none"> • Foods that do not need cooking, such as ready-to-eat foods, deli meats, leftovers.
Freezer drawers(s) / tray	<ul style="list-style-type: none"> • Foods for long-term storage. • Bottom drawer for raw meat, poultry, fish. • Middle drawer for frozen vegetables, chips. • Top tray for ice cream, frozen fruit, frozen backed goods.

Temperature setting recommendation

Temperature setting recommendation

Environment temperature	Freezer compartment	Fric
Thermostat setting for ambient T°C: NORMAL $\approx +24^{\circ}\text{C}$ ($\pm 4^{\circ}\text{C}$)	/	
Thermostat setting for ambient T°C: COLD $\approx +16^{\circ}\text{C}$ ($\pm 4^{\circ}\text{C}$)	/	
Thermostat setting for ambient T°C: HOT $\approx +32^{\circ}\text{C}$ ($\pm 4^{\circ}\text{C}$)	/	

- Information above give users recommendation of temperature setting.

Impact on Food Storage

- Under Recommended setting, the best storage time of fridge is no more than 3 days.
- Under Recommended setting, the best storage time of freezer is no more than 1 month.
- The best storage time may reduce under other settings.

Freezing fresh food

- The freezer compartment is suitable for freezing fresh food and storing frozen and deepfrozen food for a long time.
- Place the fresh food to be frozen in the freezer compartment.
- The maximum amount of food that can be frozen in 24 hours is specified on the rating plate.
- The freezing process lasts 24 hours: during this period do not add other food to be frozen.

Storing frozen food

When first starting-up or after a period out of use, before putting the product in the compartment let the appliance run at least 2 hours on the higher settings.



Important! In the event of accidental defrosting, for example the power has been off for longer than the value shown in the technical characteristics chart under “rising time”, the defrosted food must be consumed quickly or cooked immediately and then re-frozen (after cooked).

Thawing

Deep-frozen or frozen food, prior to be used, can be thawed in the fridge compartment or at room temperature, depending on the time available for this operation.

Small pieces may even be cooked still frozen, directly from the freezer. In this case, cooking will take longer.

Accessories

Movable shelves

The walls of the refrigerator are equipped with a series of runners so that the shelves can be positioned as desired.

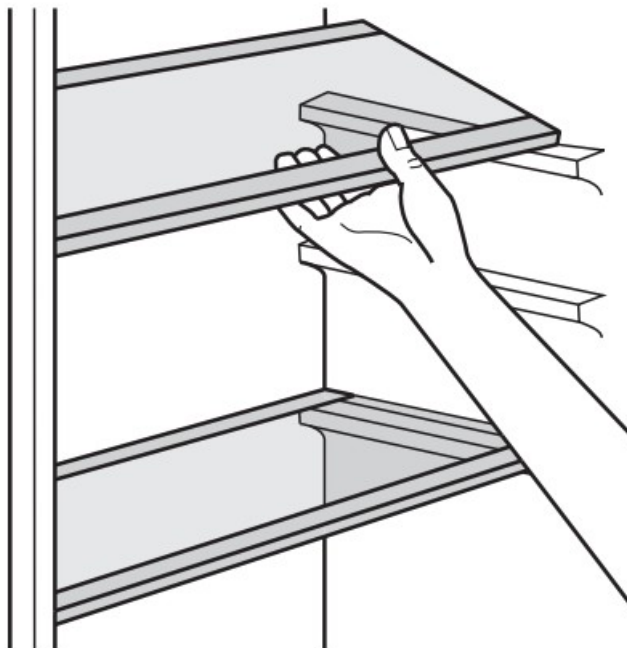

Positioning the door balconies

To permit storage of food packages of various sizes, the door balconies can be placed at different heights. To make these adjustments proceed as follows: gradually pull the balcony in the direction of the arrows until it comes free, then reposition as required.

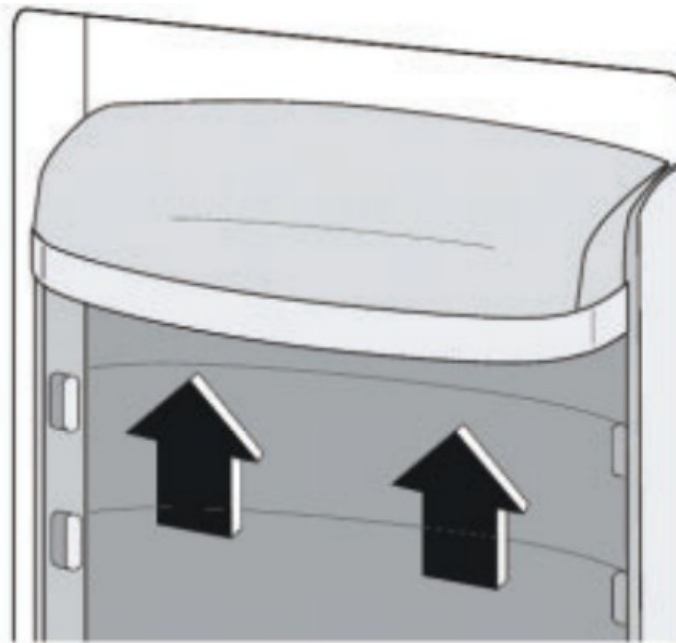

Helpful hints and tips

To help you make the most of the freezing process, here are some important hints:

- the maximum quantity of food which can be frozen in 24 hrs. is shown on the rating plate;
- the freezing process takes 24 hours. No further food to be frozen should be added during this period;
- only freeze top quality, fresh and thoroughly cleaned, foodstuffs;
- prepare food in small portions to enable it to be rapidly and completely frozen and to make it possible subsequently to thaw only the quantity required;
- wrap up the food in aluminium foil or polythene and make sure that the packages are airtight;
- do not allow fresh, unfrozen food to touch food which is already frozen, thus avoiding a rise in temperature of the latter;
- lean foods store better and longer than fatty ones; salt reduces the storage life of food;
- water ices, if consumed immediately after removal from the freezer compartment, can possibly cause the skin to be freeze burnt;
- when you remove the pack from freezer compartment, please take care not to cause the skin freeze burnt;
- it is advisable to show the freezing in date on each individual pack to enable you to keep tab of the storage time.

Hints for storage of frozen food

To obtain the best performance from this appliance, you should:

- make sure that the commercially frozen foodstuffs were adequately stored by the retailer;
- be sure that frozen foodstuffs are transferred from the food store to the freezer in the shortest possible time;
- not open the door frequently or leave it open longer than absolutely necessary.
- Once defrosted, food deteriorates rapidly and cannot be refrozen.
- Do not exceed the storage period indicated by the food manufacture.

Hints for fresh food refrigeration

To obtain the best performance:

- Do not store warm food or evaporating liquids in the refrigerator.
- Do cover or wrap the food, particularly if it has a strong flavour.
- Wrap food in polythene bags and place on the glass shelves above the vegetable drawer.
- For safety, store in this way only one or two days at the most.
- Cooked foods, cold dishes, etc...: these should be covered and may be placed on any shelf.
- Fruit and vegetables: these should be thoroughly cleaned and placed in the special drawer(s) provided.
- butter and cheese: these should be placed in special airtight containers or wrapped in aluminum foil or polythene bags to exclude as much air as possible.
- Milk bottle: these should have a cap and should be stored in the balconies on the door.
- Bananas, potatoes, onions and garlic, if not packed, must not be kept in the fridge.

Cleaning and maintenance

Cleaning

For hygienic reasons the appliance interior, including interior accessories, should be cleaned regularly.

**Caution!**

The appliance may not be connected to the mains during cleaning. Danger of electrical shock! Before cleaning switch the appliance off and remove the plug from the mains, or switch off or turn out the circuit breaker or fuse. Never clean the appliance with a steam cleaner. Moisture could accumulate in electrical components, danger of electrical shock! Hot vapors can lead to the damage of plastic parts. The appliance must be dry before it is placed back into service.



Important! Ethereal oils and organic solvents can attack plastic parts, e.g. lemon juice or the juice from orange peel, butyric acid, cleanser that contain acetic acid.

Clean drain hole

To avoid defrost water overflowing into the fridge, periodically clean the drain hole at back of fridge compartment. Use a cleaner to clean the hole as showed in right picture.

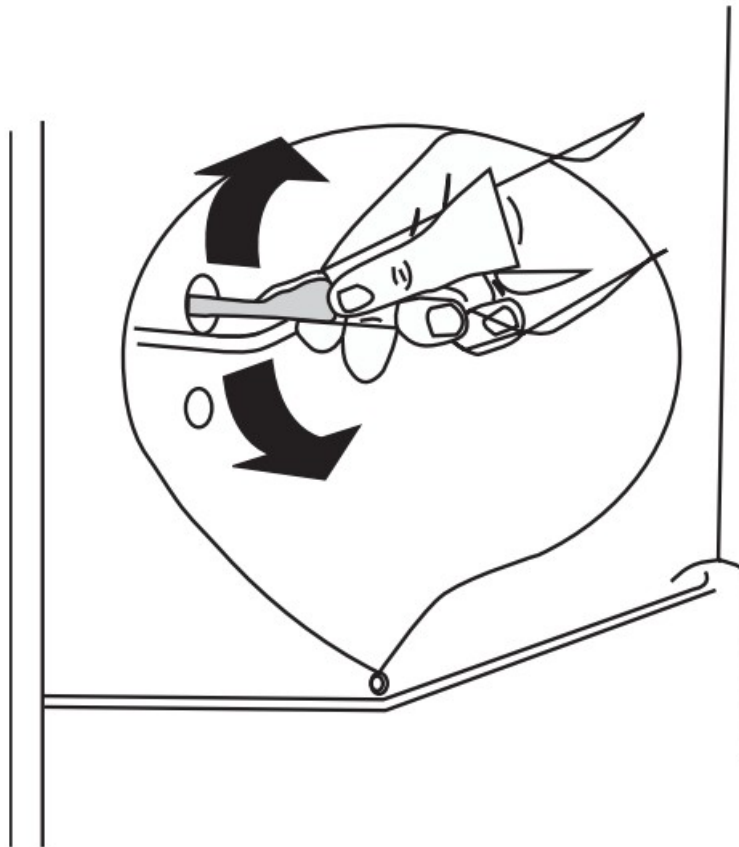

- Do not allow such substances to come into contact the appliance parts.
- Do not use any abrasive cleaners.
- Remove the food from the freezer. Store them in a cool place, well covered.
- Switch the appliance off and remove the plug from the mains, or switch off or turn out the circuit breaker of fuse.
- Clean the appliance and the interior accessories with a cloth and lukewarm water. After cleaning wipe with fresh water and rub dry.
- After everything is dry place appliance back into service.

Defrosting of the freezer

The freezer compartment, however, will become progressively covered with frost. This should be removed. Never use sharp metal tools to scrape off frost from the evaporator as you could damage it.

However, when the ice becomes very thick on the inner liner, complete defrosting should be carried out as follows:

- pull out the plug from the socket;
- remove all stored food, wrap it in several layers of newspaper and put it in a cool place;
- keep the door open, and placing a basin underneath of the appliance to collect the defrost water;

- when defrosting is completed, dry the interior thoroughly;
- replace the plug in the power socket to run the appliance again.

Replace the lamp

- The internal light is a LED type. To replace the lamp, please contact qualified technician.

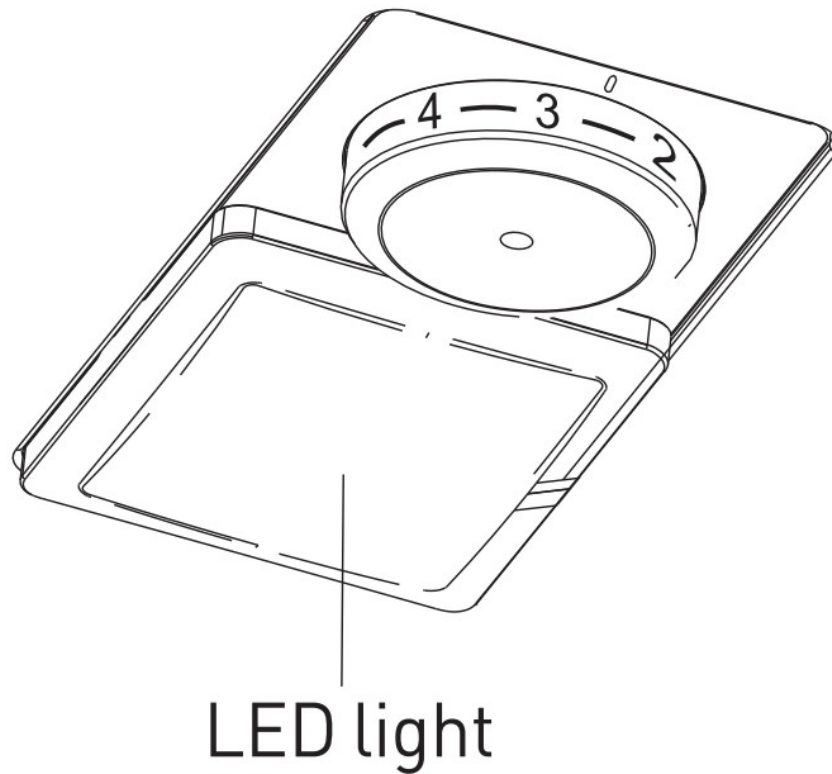

Troubleshooting



Caution! Before troubleshooting, disconnect the power supply. Only a qualified electrician of competent person must do the troubleshooting that is not in this manual.



Important! There are some sounds during normal use (compressor, refrigerant circulation).

Problem	Possible cause	Solution
Appliance does not work	<ul style="list-style-type: none"> • Temperature regulation knob is set at number "0". • Mains plug is not plugged in or is loose. • Fuse has blown or is defective. • Socket is defective. 	<ul style="list-style-type: none"> • Set the knob at other number to switch on the appliance. • Insert mains plug. • Check fuse, replace if necessary. • Mains malfunctions are to be corrected by an electrician.
The food is too warm	<ul style="list-style-type: none"> • Temperature is not properly adjusted. • Door was open for an extended period. • A large quantity of warm food was placed in the appliance within the last 24 hours. • The appliance is near a heat source. 	<ul style="list-style-type: none"> • Please look in the initial Temperature Setting section. • Open the door only as long as necessary. • Turn the temperature regulation to a colder setting temporarily. • Please look in the installation location section.
Appliance cools too much	<ul style="list-style-type: none"> • Temperature is set too cold. 	<ul style="list-style-type: none"> • Turn the temperature regulation knob to a warmer setting temporarily.
Unusual noises	<ul style="list-style-type: none"> • Appliance is not level. • The appliance is touching the wall or other objects. • A component, e.g. a pipe, on the rear of the appliance is touching another part of the appliance or the wall. 	<ul style="list-style-type: none"> • Re-adjust the feet. • Move the appliance slightly. • If necessary, carefully bend the component out of the way.
Water on the floor	<ul style="list-style-type: none"> • Water drain hole is blocked. 	<ul style="list-style-type: none"> • See the Cleaning section.
Side panel is hot	<ul style="list-style-type: none"> • Condenser is inside the panel. 	<ul style="list-style-type: none"> • It's normal.

If the malfunction shows again, contact the Service Center.

WARRANTY CONDITIONS



This product is guaranteed against faults caused by defects in manufacturing or the materials used for a period of two years, starting from the date of purchase.* This warranty does not cover defects or damage caused by failure to install the device correctly, incorrect use of the product, or excessive wear and tear. *proof of purchase required.



Documents / Resources

	<p>VALBERG CS 315 C X742C Refrigerator Freezer [pdf] Instruction Manual CS 315 C X742C, 978547, CS 315 C X742C, CS 315 C X742C Refrigerator Freezer, Refrigerat or Freezer, Refrigerator, Freezer</p>
--	--

References

-  [Electrodom sticos y electr nica del hogar | ELECTRO DEPOT](#)
-  [ lectrodom sticos pas cher, image son multim dia - Electro D p t](#)
-  [Avis certifi s - Electro D p t](#)