

UWANT

UWANT  
B200  
Multiple  
Spot  
Cleaner



# UWANT B200 Multiple Spot Cleaner Instruction Manual

[Home](#) » [UWANT](#) » UWANT B200 Multiple Spot Cleaner Instruction Manual 

## Contents

- [1 UWANT B200 Multiple Spot Cleaner](#)
- [2 Components](#)
- [3 Installation and Use](#)
- [4 Cleaning and Maintenance](#)
- [5 Troubleshooting](#)
- [6 Schematic Circuit Diagram](#)
- [7 Specifications](#)
- [8 Documents / Resources](#)
  - [8.1 References](#)
- [9 Related Posts](#)

UWANT

**UWANT B200 Multiple Spot Cleaner**



## Multiple Spot Cleaner 8200

Please read this manual carefully prior to use and retain it properly.

Dear user,

We appreciate your use of the Multiple Spot Cleaner. This Manual is intended for the 8200 model and the contents described herein are for your reference only for use and maintenance purposes. Please contact our Customer Service Department for further information.

Please read all safety precautions before using this product. Install the appliance in accordance with the procedures in this Manual. Any failure to follow the instructions may result in damage to the product or serious personal injury. The product is intended for normal domestic use only and is not intended for industrial or outdoor use. The basic precautions to be followed when using electrical equipment should include the followings:

- The product is not intended for use by persons with physical, sensory or mental impairments or persons lacking experience and/or knowledge of use (including children) unless they are supervised or instructed by a person responsible for their safety;
- Never immerse the product in water or liquids;
- Never use the product by dumping it;
- Do not touch the plug or any electrically insulated part of the product with wet fingers to avoid the risk of electric shock;
- Stop using if any plug or wire is found to be damaged, and call our professional maintenance personnel to make immediate replacement to avoid harm;
- Keep the long hair, loose clothing, fingers and other parts of the body away from the airflow channels and moving parts of the product. Never aim the suction nozzle and the accessory brush head at the eyes, ears or put them in the mouth;
- Never insert metal particles, pins, iron wires, etc. into the gaps of the product to prevent electric shock and injury;

- The product should only be disassembled, repaired, or modified by the professional and technical personnel;
- Unplug the product when it is not in use to avoid leakage, fire, and malfunction;
- In case of any product abnormalities found during use, cut off the power immediately and call us for after-sales treatment;
- Be sure to clean the sewage bucket in time after use to keep the ventilation path unobstructed, as it will result in reduced suction and motor heating, which will affect the product service life;
- Please keep the appliance in a dry place after use and do not fill the water tank with water as this may affect the service life of the appliance;
- The product is designed for partial cleaning of fabric household products, i.e. sofas, mattresses, carpets, etc. It may be less effective for others;
- The cleaning agent supplied or specified by us may be required to be added to the product during use. Add it in a specified proportion so as to prevent producing much foam, which may penetrate into the motor and reduce the service life;
- Add cleaning agent to the designated injection port; do not add cleaning agent directly to the clean water as this may affect the service life of the boiler;
- Never shake the machine when it is running to prevent sewage from entering the motor;
- A small amount of water will be left in the machine, which is normal for testing;
- Never point the brush head at a person when using steam mode as this may cause burns;
- This appliance is not intended for use by persons (including children) with reduced physical, sensory or mental capabilities, or lack of experience and knowledge, unless they have been given supervision or instruction concerning use of the appliance by a person responsible for their safety. Children should be supervised to ensure that they do not play with the appliance.(For non-EU market)
- This appliance can be used by children aged from 8 years and above and persons with reduced physical, sensory or mental capabilities or lack of experience and knowledge if they have been given supervision or instruction concerning use of the appliance in a safe way and understand the hazards involved. Children shall not play with the appliance. Cleaning and user maintenance shall not be made by children without supervision. (For EU market)
- If the supply cord is damaged, it must be replaced by the manufacturer, its service agent or similarly qualified persons in order to avoid a hazard.  
The instructions shall state that the liquid or steam must not be directed towards equipment containing electrical components, such as the interior of ovens.
- The instructions shall state that the appliance has to be unplugged after use and before carrying out user maintenance on the appliance.
- The instructions shall state the substance of the following: care should be taken when using the appliance due to the emission of steam; unplug the appliance during filling and cleaning.
- The technology and data covered in this manual are acquired by our company or a designated third-party testing agency. We reserve the final interpretation right.

## Components

The pictures in the manual are for reference only. Please refer to the physical product.

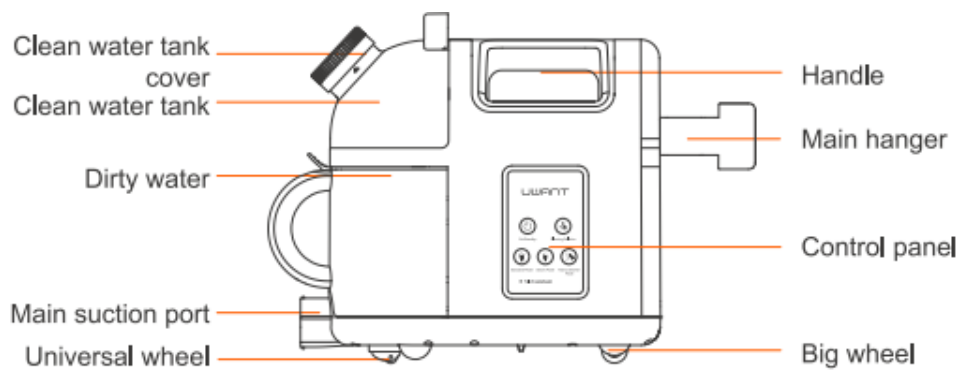

① Main Unit

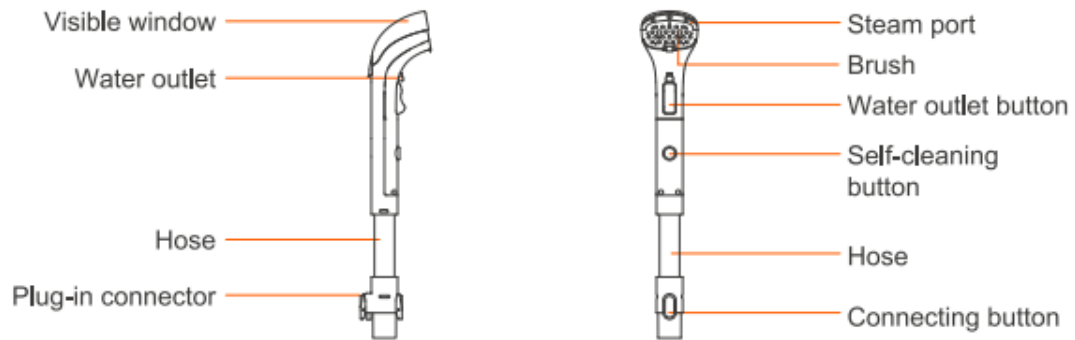

② Fabric Brush



③ Hanger

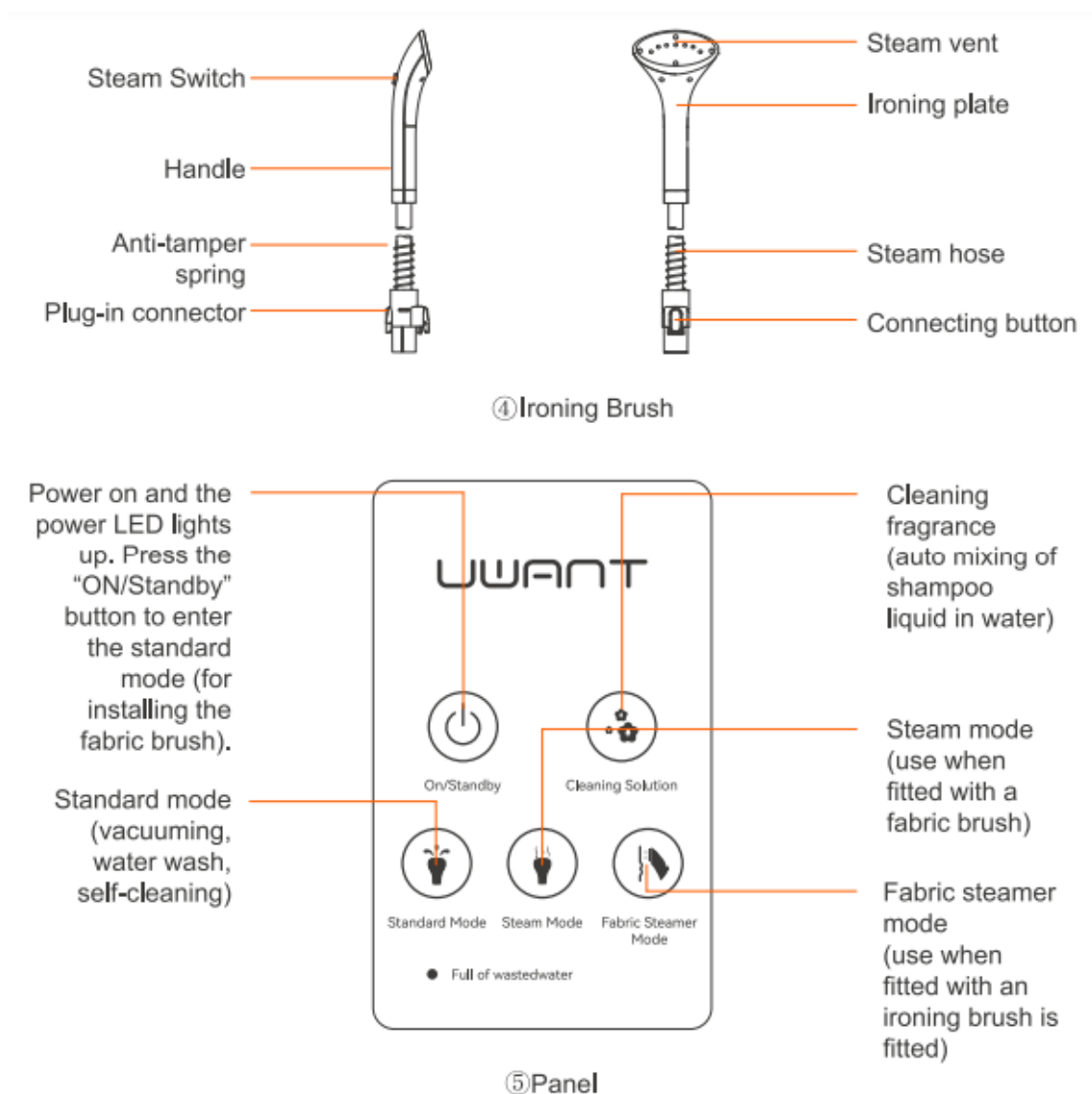

## Notes

- It is recommended to clean local stains on mattresses, sofas and the like with fabric brush head;
- It is recommended to iron the clothes, curtains, bed linen and the like with the ironing brush;
- Do not use the steam or hanging mode on wool and silk carpets, leather sofas, and leather coats, which cannot withstand high temperatures;
- Wear anti-scalding gloves before using the steam and ironing modes;
- Never pull out the plug-in connector during use;
- If you need to dismantle the plug-in connector, press the water outlet button or the self-cleaning button to release the pressure in the internal water circuit, then press the connector button to pull out the plug-in connector;
- The MODE indicator lights up to indicate that it is working in this mode.

## Installation and Use

- Install the brush head

1. First connect the plug-in connector to the main suction port as shown in the diagram, and drag it in the reverse direction without tripping after a click sound is made;

- 



Replace the brush plate

1. Toggle the brush plate as per the diagram, remove the brush plate and replace it with a leather brush plate.

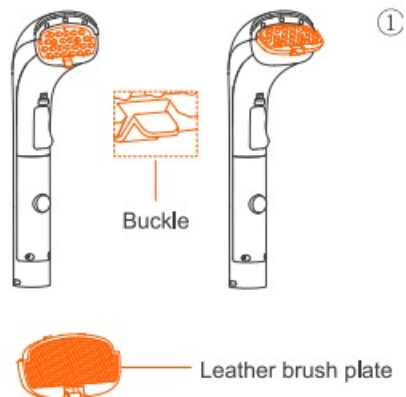

{Leather brush plate is primarily used for cleaning leather objects such as sofas, leather coats, etc.}

- Install the hose rack



1. Insert the hose hanger into the machine as shown in the diagram, and drag it in the reverse direction without tripping after a click sound is made;



- Install the main hanger

1. Insert the main hanger into the machine as shown in the diagram, and drag it in the reverse direction without tripping after a click sound is made;

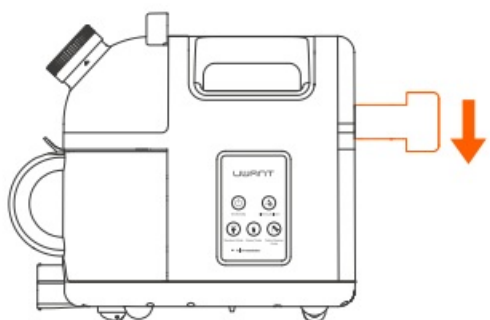
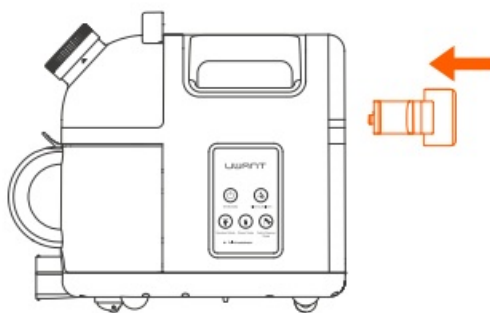

- Install the clean water tank

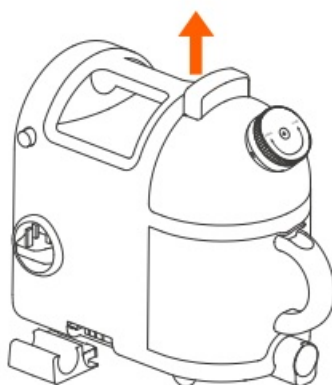

Fill clean water here

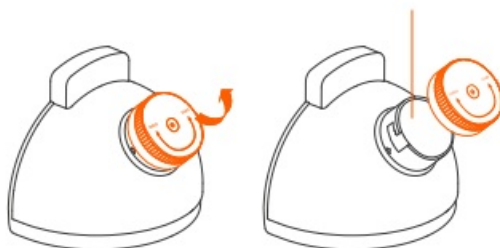

1. Take out the water tank by holding the handle as shown in the figure;
2. Open the cover of the clean water tank according to the diagram and fill with clean water (below 50° C) to the water level, put the cover back and make sure that no water leaks; Note: It is forbidden to pour cleaning solution into the water tank as this may affect the service life of the boiler; to prolong the service life of the steam boiler,

it is recommended to use pure water.

3. Remove the cleaning solution plug as shown and fill with 180 ml of cleaning solution; keep the plug tight to ensure that no cleaning solution leaks;

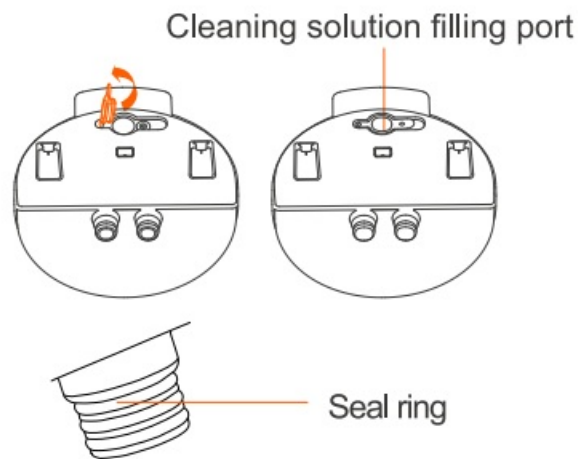

Note: Observe and make sure that there is no dislodging or curling of the sealing ring.

4. Install the water tank to the machine as shown in the figure; the water tank will be installed in place when you hear a click.



Note: Press down properly on the top of the water tank.

### Start up the machine

1. CD Make sure that the clean water and recovery tank are in place, that the clean water tank has water, and that the plug-in connector is correctly connected to the main suction port;
2. Pull out the power cord, insert the plug into your socket, and the "ON/Standby" button flashes;



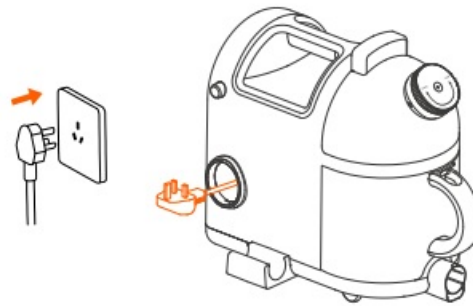
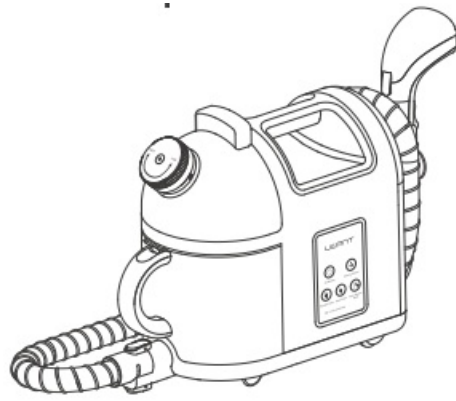

3. When the machine is powered on, press the ON/Standby button and you will hear the sound of the motor running, the machine will start in standard mode by default; if you need to switch modes, click on Steam mode to switch; if you need to use cleaning solution, click on Cleaning Solution and then press the Water Outlet button on the brush head or the Self-cleaning button;
4. To use the brush head, place the brush head close to the object to be cleaned as shown, press and hold the Water Outlet button to wet the area to be cleaned and repeat the cleaning process. When the spray is not required, release the Water Outlet button;

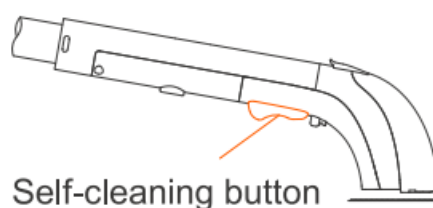

## Cleaning and Maintenance

- Self-cleaning

1. There must be some clean water in the clean water tank. Press the self-cleaning button as shown in the figure for at least 30S to clean the brush head and hose;
2. Push hard in the direction indicated by the arrow to remove the visible window of the brush head;
3. For any stains remaining in the visible window, remove the window and clean it under the faucet;

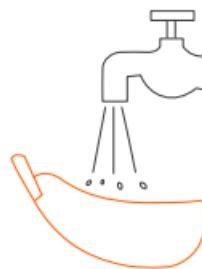
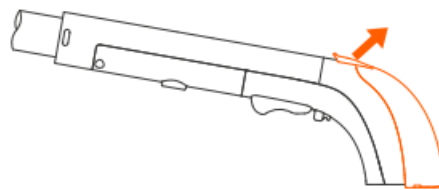
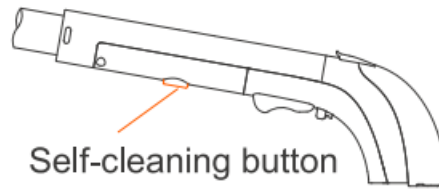

4. Dry the visible window after cleaning, and put it into the brush.

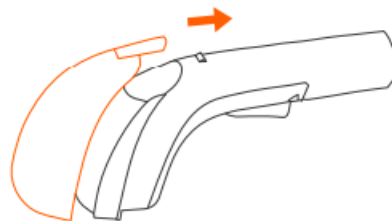

### Cleaning of recovery tank

Note: Before cleaning the recovery tank, unplug the power cord and stop the machine. Do not press the cover button when removing the tank as this may damage the tank cover.

1. After using, pull the hand clasp of the recovery tank and take it out, as shown in the figure. Try to keep it as horizontal as possible to prevent the sewage from spilling out;



Note: Do not press the cover button while removing the recovery tank.

2. Put the recovery tank into the sink, and remove the tank cover by toggling the flap catch;
3. Pressing the cover button to empty the sewage;
4. If the tank is dirty, clean it first, remove the tank cover as shown, take out the water stopper and then the float and flush it with running water;

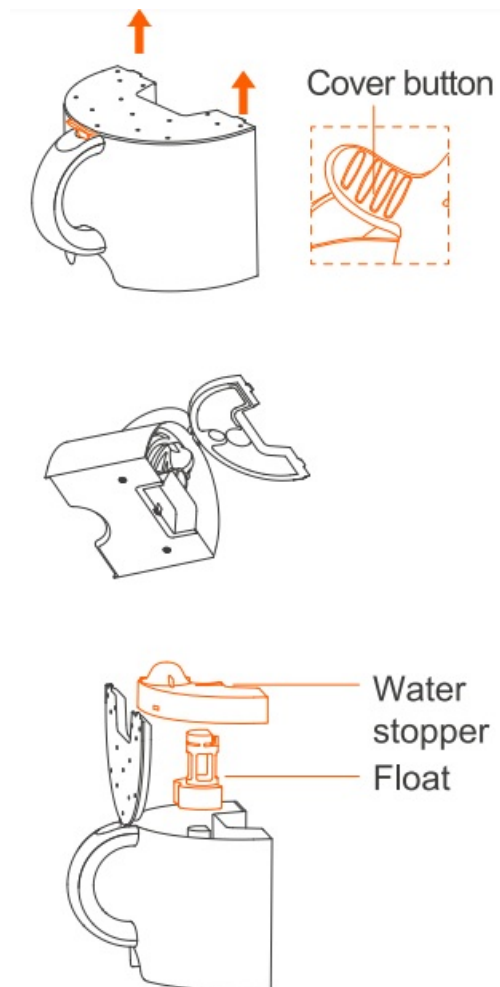

5. If the balance plate is dirty, clean it first, then disassemble the balance plate as shown and flush it with running water;
6. After rinsing and drying, put in the float, water stopper and balance plate in order, which should not be omitted (omission will lead to over-absorption and leakage of water and inability to start the machine);
7. Put the tank cover back and install the main unit as shown in the diagram; when you hear a click, the tank is installed in place.

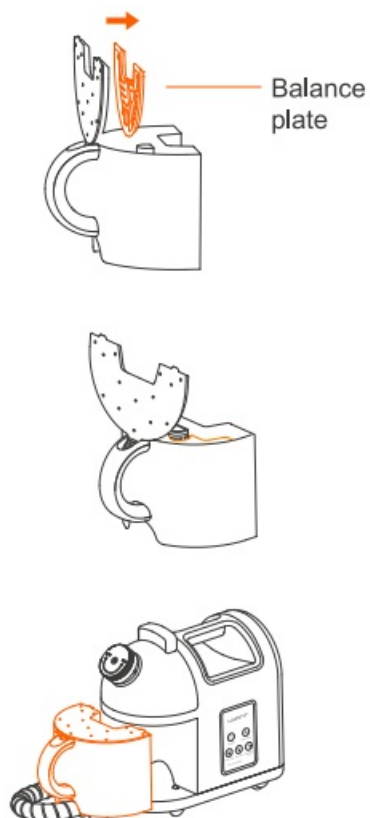

## Storage

Note: It is recommended to disassemble the accessories, put them into the accessory bag and store in a ventilated and dry place if the machine will not be used for a long time.

1. After use, press the One-key Take-up button after use to allow the storage of the power cord, as shown in figure;
2. Wrap the hose, put the brush head in the position as shown in the figure, and store it in a ventilated and dry place;

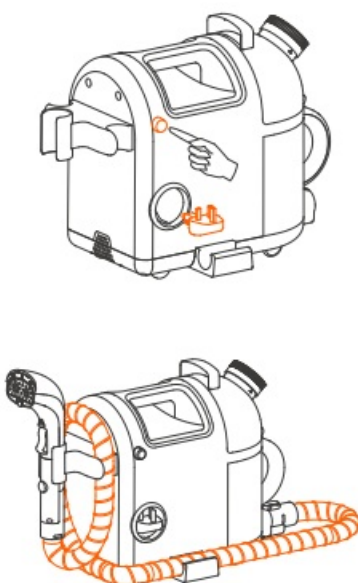

3. If not in use for a long period of time, remove the hose rack and main hanger as shown, put them in an accessory bag and store in a ventilated and dry place;
4. Move the main hanger upwards first as shown;
5. Then move the main hanger backwards to remove it and store it in the accessory bag in a ventilated and dry

place.

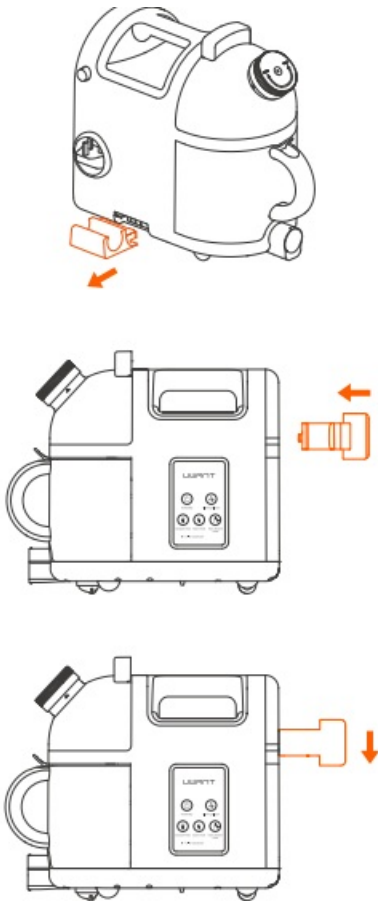

### Troubleshooting

Fault	Possible cause	Solution
Weakened suction or spray of water from the brush head	Recovery tank is full	Dump the sewage in the tank
	Clogged pipe orifice	Check the pipe orifice and clean it
	Longer time use of the machine	Fill with water
No water from the nozzle	Water shortage in tank	Check the pipe orifice and clean it
	Clean water tank not in place	Press down on the top of the clean water tank to fit it in place (see Installation and Disassembly of the Clean Water Tank for details)
	Clogged inlet	Please send it for maintenance
	No outlet button is pressed	Press the Outlet button
Water leakage at pipe orifice	Lack of water seal	Please send it for maintenance
Leakage of tank	Lack of water seal	Please send it for maintenance
	Clean water tank seal not fitted properly or twisted	Press down on the top of the clean water tank to fit it in place (see Installation and Disassembly of the Clean Water Tank for details)
Other problem	No outlet button is pressed	Please send it for maintenance

Schematic Circuit Diagram

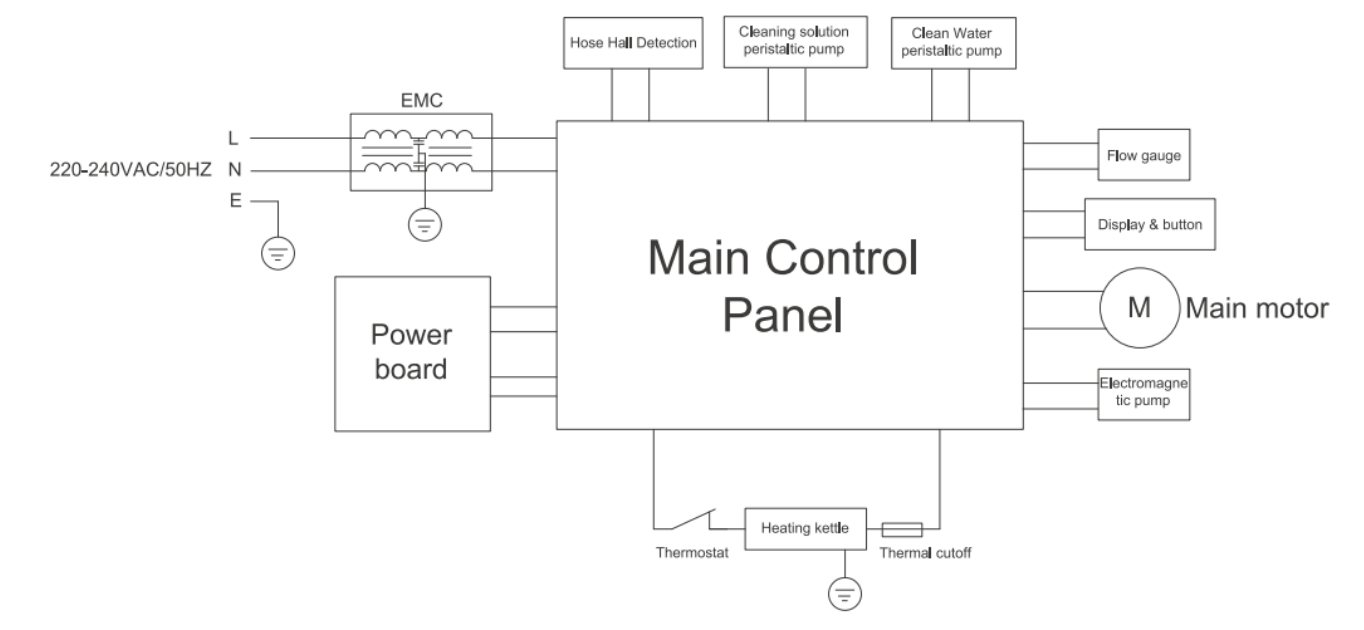

Specifications

Model	Mode	Rated Power	Rated Frequency	Clean Water Tank Capacity	Recovery Tank Capacity	Fragrance Volume
B200	Standard Mode	AC220-240V 50/60Hz	500W	1.5L	1.5L	200ml
	Steam Mode		1900W	1.5L	/	/
	Fabric Steamer Mode		1400W	1.5L	/	/

Since we are constantly improving our products, any changes to the technical specifications will be made without notice.

Names and Contents of Hazardous Substances

Component	Hazardous Substance					
	(Pb)	(Hg)	(Cd)	(Cr (VI))	(PBB)	(PBDE)
Plastic components	○	○	○	○	○	○
Hardware components	○	○	○	○	○	○
Motor components	X	○	○	○	○	○
Water pump group	X	○	○	○	○	○
PCB components	○	○	○	○	○	○
Power cord	X	○	○	○	○	○

This table has been prepared in accordance with the SJ/11364.

0: The content of hazardous substances in all homogeneous materials of the component is below the limit specified in GB/T26572.

X: The content of the hazardous substance in at least one of the homogeneous materials of the component exceeds the limit specified in GB/T26572.

Note: Some of the components marked with an “X” contain excessive amounts of hazardous substances due to the limited technology in the industry at present, which makes it impossible to achieve substitution or reduction for the time being.

### Restricted use of harmful substance

Environment friendly use period of 10 years: Indicates the period that the harmful substances contained in this product will not leak or mutate, and no serious pollution to the environment or serious damage to personal and property will be caused when the user uses this product normally under the conditions described in the product manual;

Arrow recycling symbol: Indicates that this product can be recycled. If it exceeds the service period or fails to work properly after maintenance, it should not be discarded at will. Please hand it over to a formal recycling channel and an enterprise qualified for the disposal of waste electrical and electronic products.

Suzhou Jiandan Youwei Technology Co., Ltd.

Place of Origin: Suzhou, Jiangsu Province

Address: Room 1518, Building B, Kai ping Business Center, No. 11666, East Taihu Avenue, East Taihu Ecological Tourism Resort (Taihu New Town), Wujiang District, Suzhou, China

### Documents / Resources

 <p>The image shows the cover of the instruction manual for the UWANT B200 Multiple Spot Cleaner. It features the UWANT logo at the top, followed by the product name 'Multiple Spot Cleaner B200' and 'Instruction Manual'. A line drawing of the device is in the center. At the bottom, it says 'Please read this manual carefully prior to use and store it properly.'</p>	<p><a href="#">UWANT B200 Multiple Spot Cleaner</a> [pdf] Instruction Manual</p> <p>B200, B200 Multiple Spot Cleaner, Multiple Spot Cleaner, Spot Cleaner, Cleaner</p>
---	--

References

- [User Manual](#)

Manuals+, Privacy Policy

This website is an independent publication and is neither affiliated with nor endorsed by any of the trademark owners. The "Bluetooth®" word mark and logos are registered trademarks owned by Bluetooth SIG, Inc. The "Wi-Fi®" word mark and logos are registered trademarks owned by the Wi-Fi Alliance. Any use of these marks on this website does not imply any affiliation with or endorsement.