

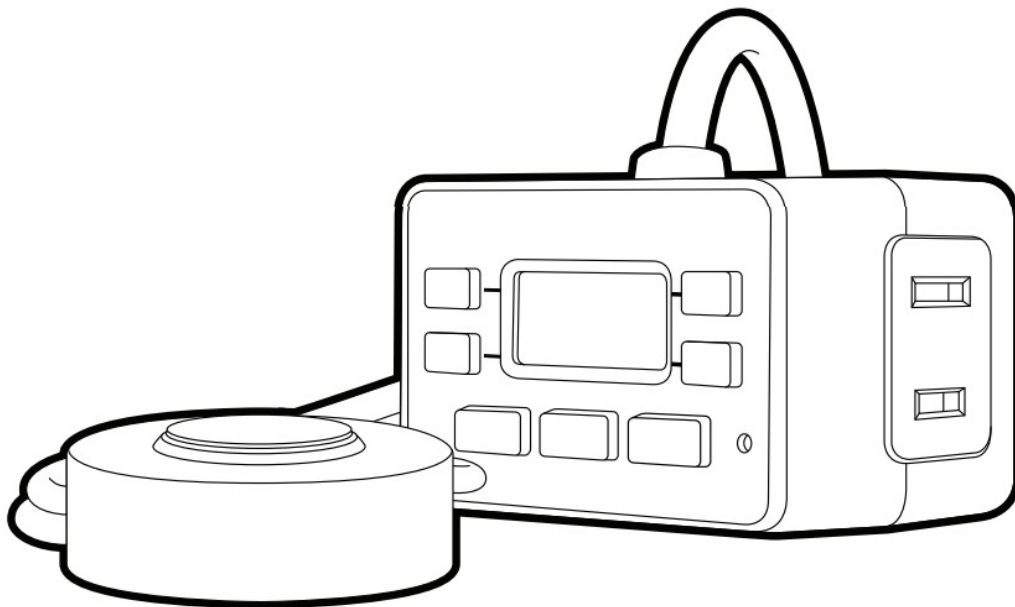

UltraPro 50021 Plug In Dual Outlet Digital Timer with Tethered Button User Guide

[Home](#) » [UltraPro](#) » UltraPro 50021 Plug In Dual Outlet Digital Timer with Tethered Button User Guide 

UltraPro™





Read instructions or watch the easy-to-follow videos.

Scan QR code or visit <https://byjasco.com/50021i>

50021

PLUG-IN DUAL-OUTLET DIGITAL TIMER WITH TETHERED BUTTON

Contents

- 1 SETUP
- 2 PROGRAMMING OPTIONS
- 3 CUSTOMIZED TIMER
- 4 OVERRIDE OPTIONS
- 5 FCC/IC
- 6 SPECIFICATIONS
- 7 WARNING
- 8 Documents / Resources
 - 8.1 References
- 9 Related Posts

SETUP

1. If no numbers are visible on-screen, plug the timer into an outlet and charge for 1 hour. Once charged, press the reset (**R**) button in the lower-right corner using a toothpick or pencil.
2. Use up (**^**) and down (**v**) arrows to set the time — note AM or PM.

Note: After the timer is charged, it can be removed from the outlet for easy programming. Return to the outlet when finished.

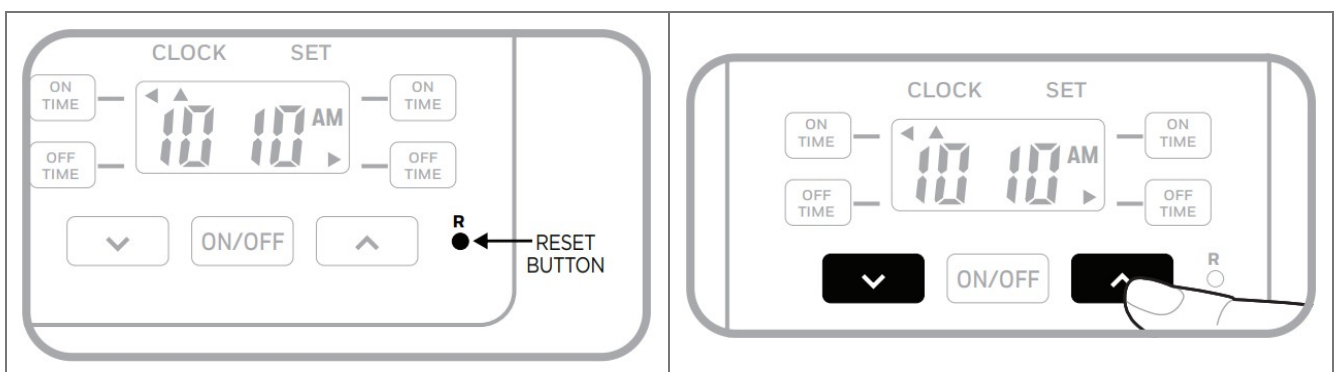

PROGRAMMING OPTIONS

DEFAULT TIMER

Two ON/OFF programs feature default settings. To activate the default times, press the **ON TIME** or **OFF TIME** button. Indicator arrows appear on the display to show which programs are set. To deactivate a setting, press the desired button again.

Note: Outlets operate simultaneously for any schedules.

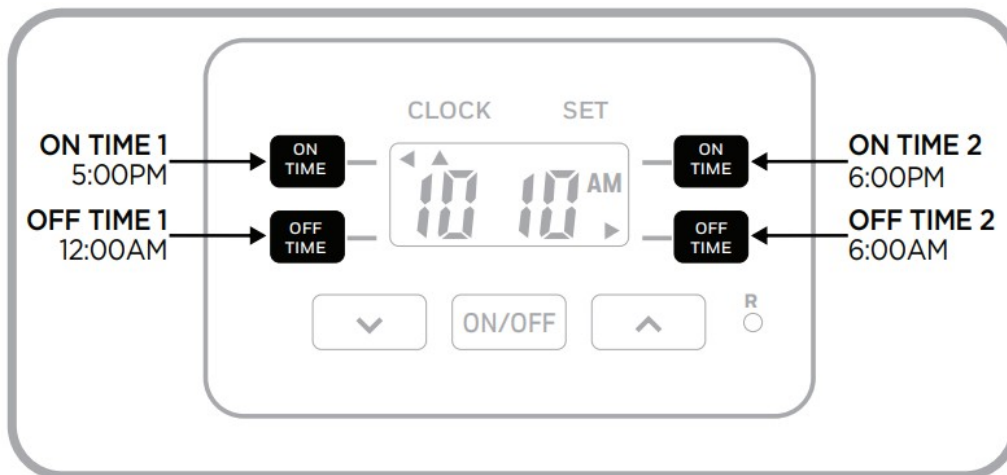

CUSTOMIZED TIMER

Press either **ON TIME** button, then use up (^) and down (v) arrows to set on time. Press the **ON TIME** button again or wait five seconds to store the program and return to the clock display.

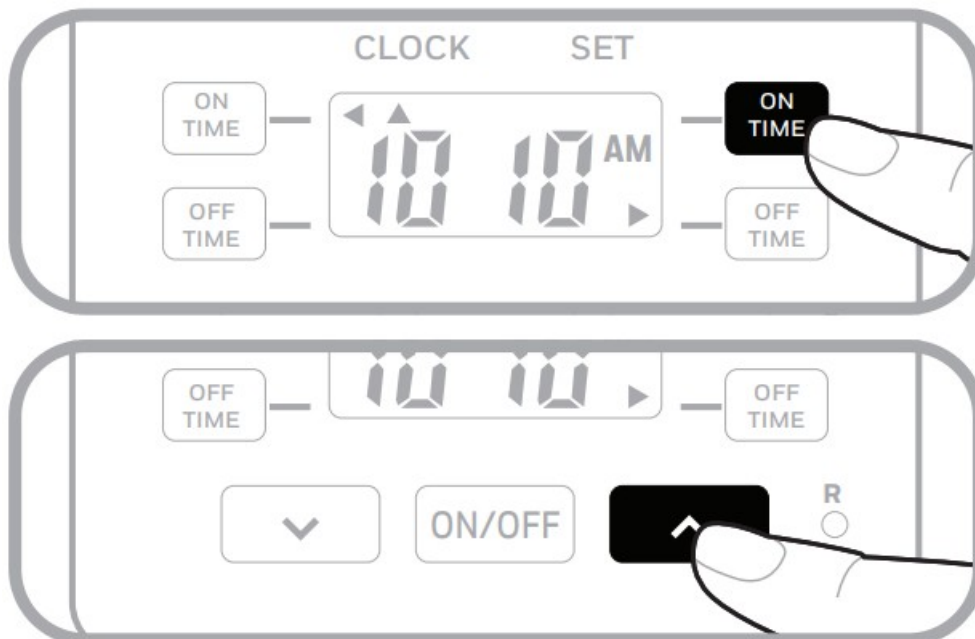

Press either **OFF TIME** button, then use up (^) and down (v) arrows to set off time. Press the **OFF TIME** button again or wait five seconds to store the program and return to the clock display.

Note: An indicator arrow (◀ or ▶) appears on-screen to show which settings are active.

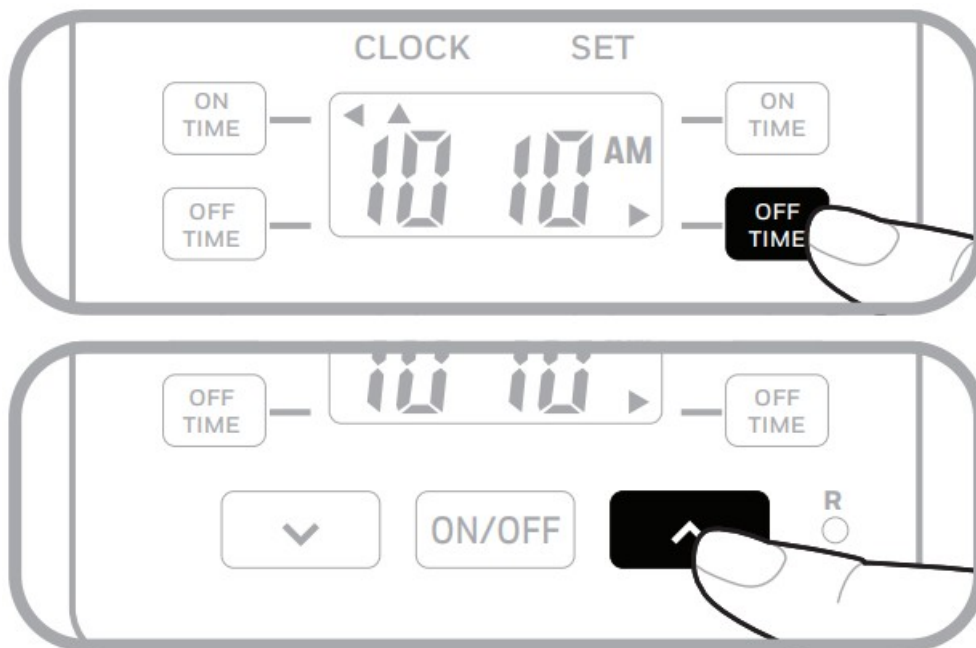

OVERRIDE OPTIONS

Override scheduled programs and manually operate the connected device(s) using the tethered button or ON/OFF button below the display screen. If a scheduled program is running and the device is on, press either button to turn off the device. The device remains off until the next scheduled program begins, or the button is pressed again. If a scheduled program is running and the device is off, press either button to turn on the device. It remains on until the next scheduled program ends, or the button is pressed again. When no programs are active, press either button to turn ON/OFF the device manually.

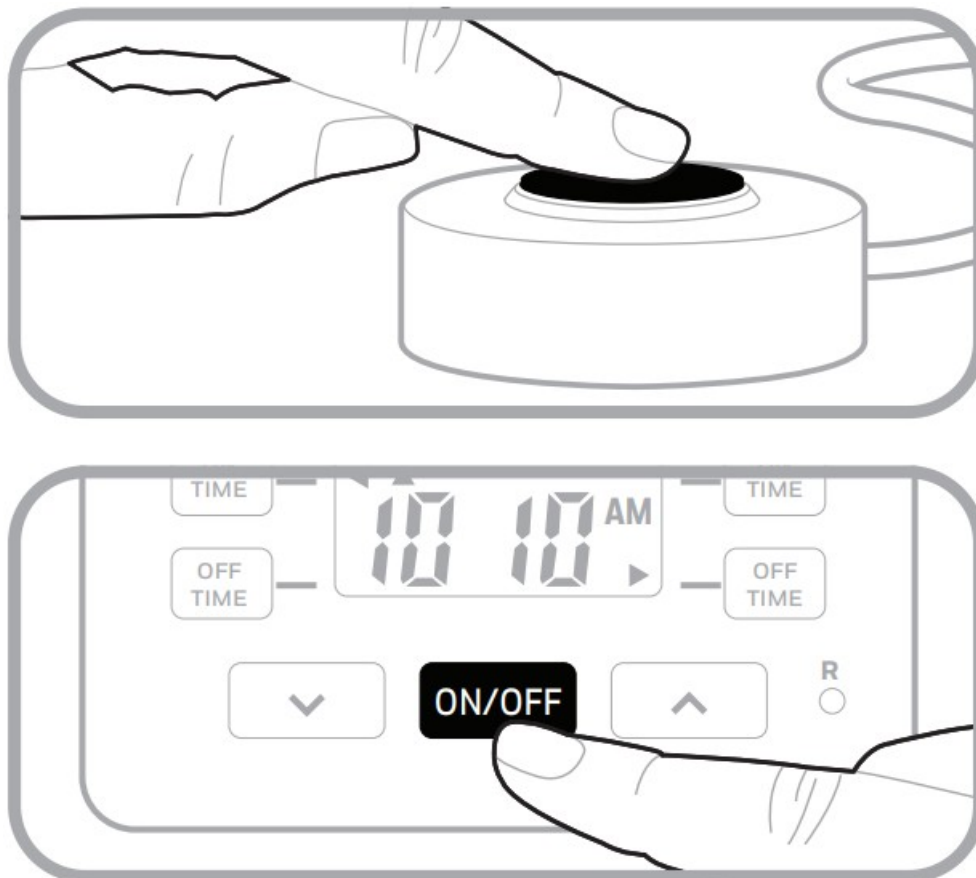

FCC/IC

Supplier Declaration of Conformity
Model #: 50021

Jasco Products Co., 10 E.
Memorial Rd., Oklahoma City, OK 73114, www.byjasco.com

This device complies with Part 15 of the FCC and Industry Canada license-exempt RSS standards. Operation is subject to the following two conditions: (1) this device may not cause harmful interference, and (2) this device must accept any interference received, including interference that may cause undesired operation.

FCC NOTE: The manufacturer is not responsible for any radio or TV interference caused by unauthorized modifications to this equipment. Such modifications could void the user's authority to operate the equipment.

NOTE: This equipment has been tested and found to comply with the limits for a Class B digital device, pursuant to Part 15 of the FCC Rules. These limits are designed to provide reasonable protection against harmful interference in a residential installation. This equipment generates, uses, and can radiate radio frequency energy, and if not installed and used in accordance with the instructions, may cause harmful interference to radio communications. However, there is no guarantee interference will not occur in a particular installation. If this equipment does cause harmful interference to radio or television reception, which can be determined by turning the equipment off and on, the user is encouraged to try to correct the interference by one or more of the following measures:

- Reorient or relocate the receiving antenna.
- Increase the separation between the equipment and receiver.
- Connect the equipment into an outlet on a circuit different from which the receiver is connected.
- Consult the dealer or an experienced radio/TV technician for help.

CAN ICES-3(B)/NMB-3(B)

SPECIFICATIONS

Total ratings for both outlets:
125VAC, 60Hz
15A 1875W general/resistive
5A 625W tungsten
1/2HP motor
Works with all LED and CFL bulbs

WARNING

RISK OF ELECTRICAL SHOCK	RISK OF FIRE
<ul style="list-style-type: none">• PLUG DIRECTLY INTO AN ELECTRICAL OUTLET• DO NOT USE IN WET LOCATIONS• USE INDOORS ONLY• UNPLUG TIMER BEFORE CLEANING	<ul style="list-style-type: none">• DO NOT USE TO CONTROL APPLIANCES THAT CONTAIN HEATING ELEMENTS (COOKING APPLIANCES, HEATERS, IRONS, ETC.)• DO NOT EXCEED ELECTRICAL RATINGS• DO NOT USE WITH EXTENSION CORDS



MADE IN CHINA/HECHO EN CHINA

Distributed by Jasco Products Company LLC, 10 E. Memorial Rd., Oklahoma City, OK 73114.
This Jasco product comes with a 2-year limited warranty. Visit www.byjasco.com for warranty details.
Questions? Contact our U.S.-based Consumer Care at 1-800-654-8483 between 7 AM-8 PM, M-F, Central Time.
©JASCO 2020 | 50021 | 09/21/20 v1

Documents / Resources

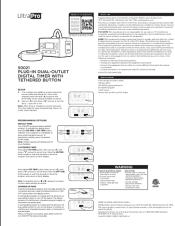
	UltraPro 50021 Plug In Dual Outlet Digital Timer with Tethered Button [pdf] User Guide 50021 Plug In Dual Outlet Digital Timer with Tethered Button
---	--

References

- [J Jasco](#)
- [50021 52086: UltraPro Plug-in Digital Timer with Tethered Button Operation - YouTube](#)