



UTILITECH SFDC-1500FB 60-IN High-Velocity Belt-Drive Drum Fan Instruction Manual

[Home](#) » [UtiliTech](#) » UTILITECH SFDC-1500FB 60-IN High-Velocity Belt-Drive Drum Fan Instruction Manual 

Contents

- [1 UTILITECH SFDC-1500FB 60-IN High-Velocity Belt-Drive Drum Fan Instruction](#)
- [2 PACKAGE CONTENTS](#)
- [3 SAFETY INFORMATION](#)
- [4 PREPARATION](#)
- [5 OPERATING INSTRUCTION](#)
- [6 CARE AND MAINTENANCE](#)
- [7 TROUBLESHOOTING](#)
- [8 WARRANTY](#)
- [9 Documents / Resources](#)
 - [9.1 References](#)
- [10 Related Posts](#)



UTILITECH SFDC-1500FB 60-IN High-Velocity Belt-Drive Drum Fan Instruction



PACKAGE CONTENTS

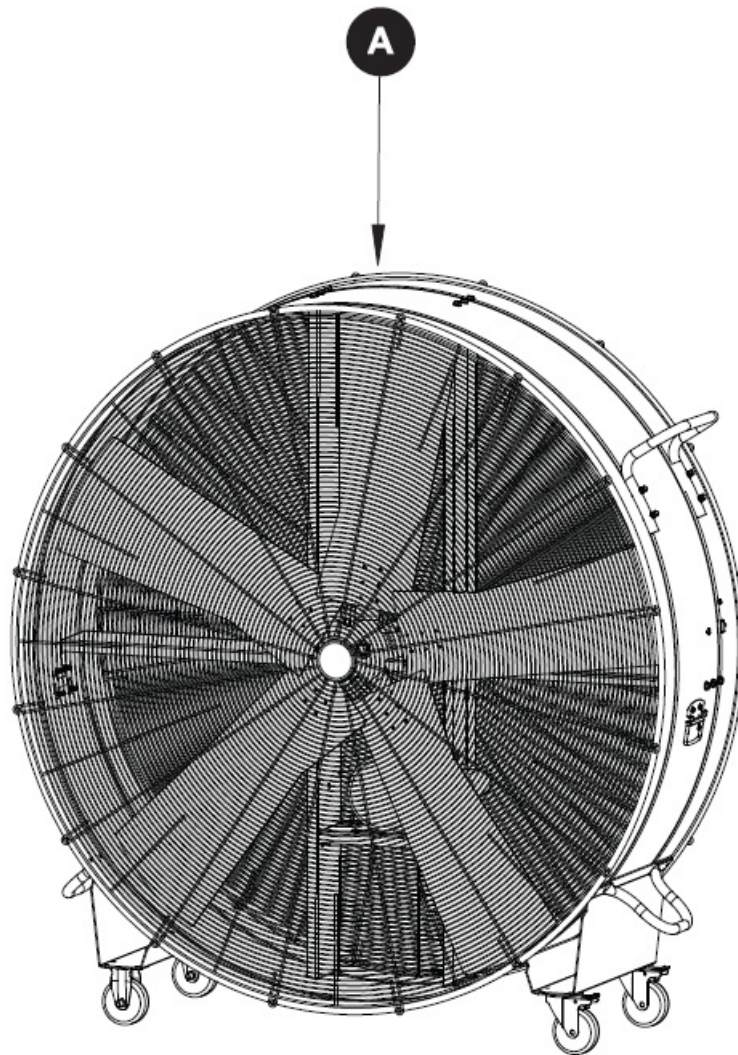

SAFETY INFORMATION

READ AND SAVE THESE INSTRUCTIONS Please read and understand this entire manual before attempting to assemble, operate or install the product.

WARNING

1. Please unplug the fan before moving it or performing maintenance. Don't touch the fan when your hands are wet.
2. Those who are not qualified electricians should not disassemble, repair or rebuild the fan.
3. Please unplug the fan when it is not in use.
4. Please don't unplug the fan by holding the cable cord. Unplug by holding the plug.
5. Please don't use the fan when there is damage to the cable cord or plug.
6. Please don't use the fan with extension cord.
7. Please don't use the fan close to fires.
8. Please don't insert your hand or other objects into the guard or the movable parts.
9. To reduce the risk of fire or electric shock, do not use this fan with any solid-state speed control device.
10. If the supply cord is damaged, it has to be replaced by the manufacturer, its service agent or similarly qualified persons in order to avoid hazard.

CAUTION

1. Please unplug the fan from the socket and clean it with a soft cloth.
2. Do not immerse the fan.
3. Please fit the guard onto fan before starting up the fan.
4. This fan is not intended for use by people (including children) with reduced physical, sensory or mental capabilities or lack of experience and knowledge unless they have been given supervision or instruction concerning use of the fan by a person responsible for their safety. Supervise children to ensure they do not play with the fan.

PREPARATION

Before beginning assembly of product, make sure all parts are present. Compare parts with package contents list and hardware contents list. If any part is missing or damaged, do not attempt to assemble the product.

Estimated Assembly Time: minutes

Tools Required for Assembly (not included):Wrench

OPERATING INSTRUCTION

- BRAKE OFF STATUS

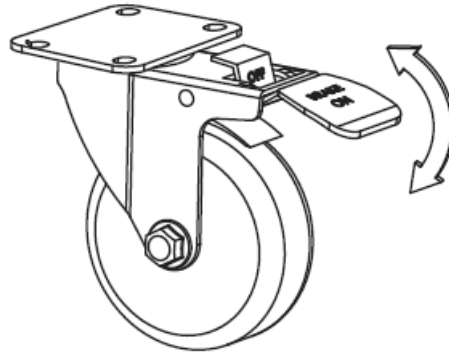

- BRAKE ON STATUS

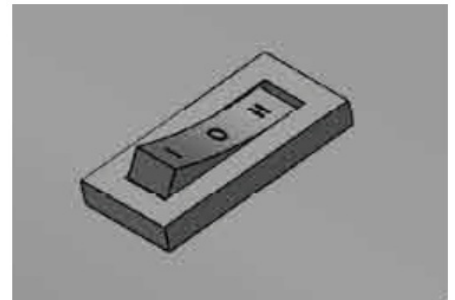
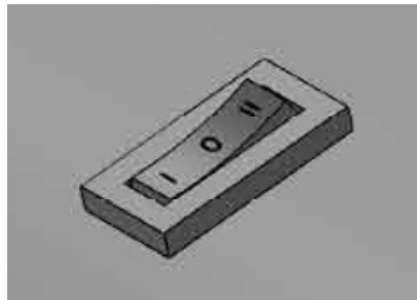
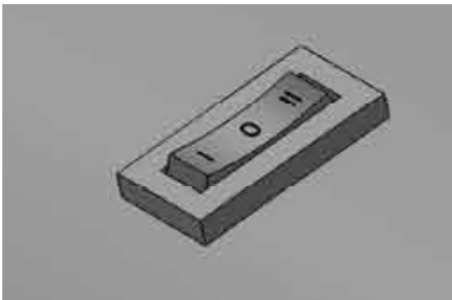
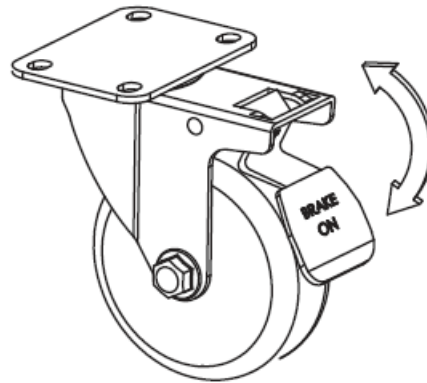

0-STOP I-LOW II-HIGH

CARE AND MAINTENANCE

Unplug the appliance before cleaning. Don't use any water for cleaning metal surfaces. In order to remove the dust from the protective screen, use a vacuum cleaner or remove the front protective screen by removing the securing screw on the top with a screwdriver. After cleaning, remount the safety screen. After doing this, fasten the securing screw on the edge of the protective screen.

TROUBLESHOOTING

PROBLEM POSSIBLE CAUSE CORRECTIVE ACTION

The fan fails to operate.

1. Fan may not be plugged in.
2. There may be some obstructions in the fan.
3. Make sure the fan is plugged in and electrical outlet is working properly.

4. Check for any obstruction. If you find an obstruction, turn the fan "OFF". Unplug the fan and carefully remove the obstruction. Plug the fan in and turn it on again, referring to the OPERATING INSTRUCTIONS.

WARRANTY

TWO-YEAR LIMITED WARRANTY. The manufacturer warrants this product to be free from manufacturing defects in material and workmanship. This warranty does not cover transit damages. This warranty does not apply to damages from accident, misuse, alteration of any kind to the fan or where the connected voltage is more than the nameplate voltage. This warranty does not apply to the finish on any portion of the product. Servicing performed by unauthorized persons shall render the warranty invalid. For warranty service, contact Customer Service at 1-866-994-4148, 8 a.m. – 8 p.m., EST, Monday-Sunday. Some states do not allow the limitation or exclusion of certain damages. Therefore, these limitations and exclusions may not apply to you. This warranty gives the consumer specific legal rights. You may have other rights that vary from state to state.

REPLACEMENT PARTS LIST

For replacement parts, call our customer service department at 1-866-994-4148, 8 a.m. – 8 p.m., EST, Monday – Sunday. You could also contact us at partsplus@lowes.com or visit www.lowespartsplus.com.

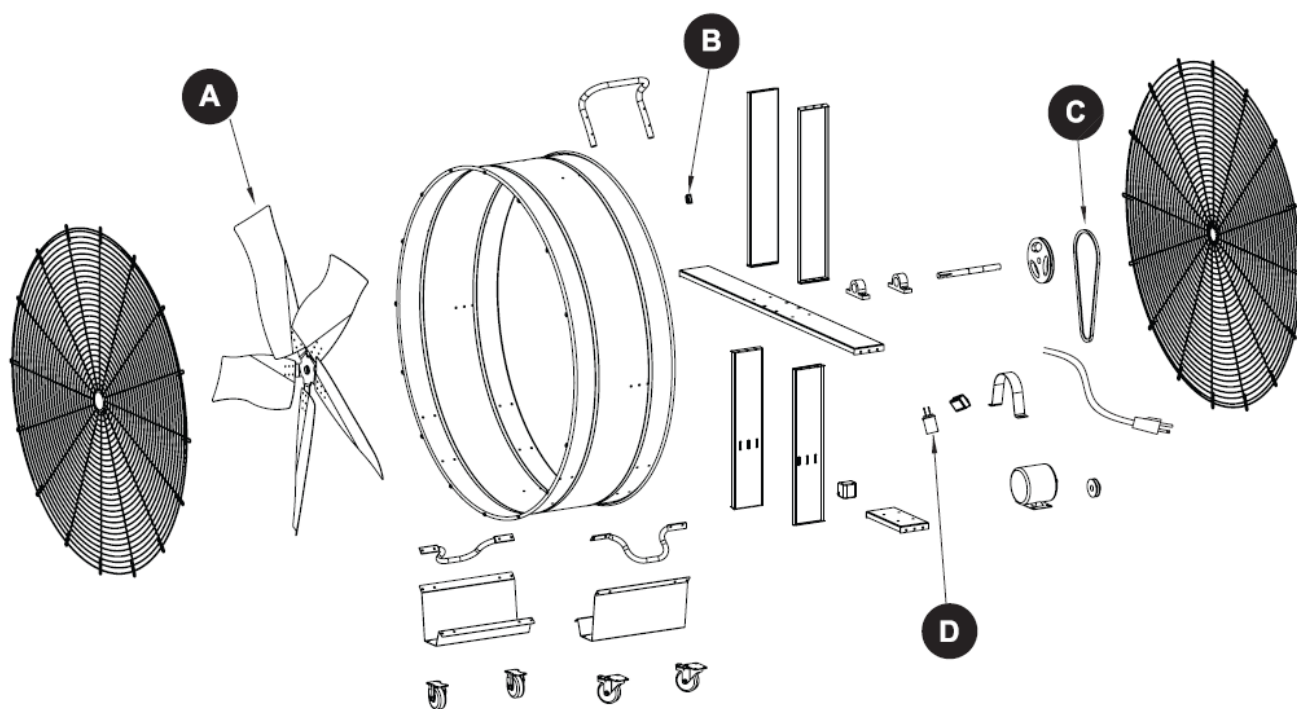

PART DESCRIPTION PART#

PART	DESCRIPTION	PART #
A	Blade	SFDC-1500FB-01
B	Switch	SFDC-1500FB-02
C	Belt	SFDC-1500FB-03
D	Capacitor	SFDC-1500FB-04

Questions, problems, missing parts? Before returning to your retailer, call our customer service department at 1-866-994-4148, 8 a.m. – 8 p.m., EST, Monday-Sunday. You could

also contact us at partsplus@lowes.com or visit www.lowespartsplus.com.

Documents / Resources

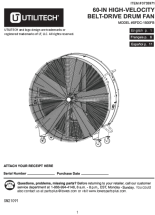
	<p>UTILITECH SFDC-1500FB 60-IN High-Velocity Belt-Drive Drum Fan [pdf] Instruction Manual SFDC-1500FB 60-IN High-Velocity Belt-Drive Drum Fan, SFDC-1500FB, 60-IN High-Velocity Belt-Drive Drum Fan, Velocity Belt-Drive Drum Fan, Belt-Drive Drum Fan, Drive Drum Fan</p>
---	--

References

- [Lowe's Parts Plus](#)

Manuals+.