



UTILITECH SFD3-450BI 18 Inch Internal Orbit Oscillating Fan Instruction Manual

[Home](#) » [UtiliTech](#) » UTILITECH SFD3-450BI 18 Inch Internal Orbit Oscillating Fan Instruction Manual 

Contents

- [1 UTILITECH SFD3-450BI 18 Inch Internal Orbit Oscillating Fan](#)
- [2 PACKAGE CONTENTS](#)
- [3 HARDWARE CONTENTS \(shown actual size\)](#)
- [4 SAFETY INFORMATION](#)
- [5 PREPARATION](#)
- [6 INSTALLATION INSTRUCTIONS](#)
- [7 HARDWARE USED](#)
- [8 OPERATING INSTRUCTIONS](#)
- [9 CARE AND MAINTENANCE](#)
- [10 TROUBLESHOOTING](#)
- [11 WARRANTY](#)
- [12 REPLACEMENT PARTS LIST](#)
- [13 Documents / Resources](#)
- [14 Related Posts](#)



UTILITECH SFD3-450BI 18 Inch Internal Orbit Oscillating Fan



PACKAGE CONTENTS

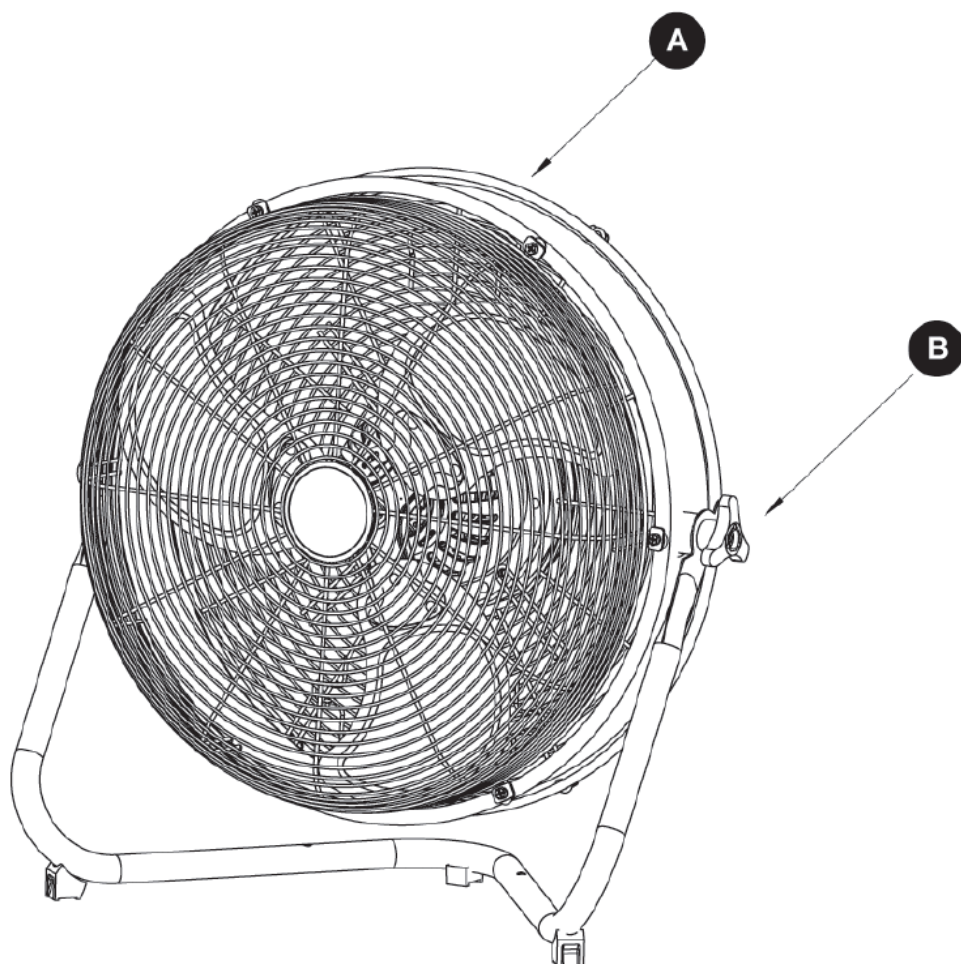

PART	DESCRIPTION	QUANTITY
A	Fan Body	1
B	Adjustable Knob	2

HARDWARE CONTENTS (shown actual size)



SAFETY INFORMATION

READ AND SAVE THESE INSTRUCTIONS

Please read and understand this entire manual before attempting to assemble, operate or install the product.

WARNING

1. Please unplug the fan before moving it or performing maintenance. Dont touch the fan when your hands are wet.
2. Those who are not qualified electricians should not disassemble, repair or rebuild the fan.
3. Please unplug the fan when it is not in use.
4. Please don't unplug the fan by holding the cable cord. Unplug by holding the plug.
5. Please don t use the fan when there is damage to the cable cord or plug.
6. Please don't use the fan with an extension cord.
7. Please don't use the fan close to fires.
8. Please don't insert your hand or other objects into the guard or near the movable parts.
9. To reduce the risk of fire or electric shock, do not use this fan with any solid-state speed control device.
10. if the supply cord is damaged, it has to be replaced by the manufacturer, its service agent or similarly qualified persons in order to avoid hazard.

CAUTION

1. Please unplug the fan from the socket and clean it with a soft cloth.
2. Do not immerse the fan.
3. Please fit the guard onto fan before starting up the fan.
4. This fan is not intended for use by people (including children) with reduced physical, sensory or mental capabilities or lack of experience and knowledge unless they have been given supervision or instruction concerning use of the fan by a person responsible for their safety.
Supervise children to ensure they do not play with the fan.

5. Do not operate any fan with a damaged cord or plug. Discard fan or return to an authorized service facility for examination and/or repair
6. Do not run cord under carpeting. Do not cover cord with throw rugs, runners, or similar coverings.
Do not route cord under furniture or appliances. Arrange cord away from traffic area and where it will not be tripped over

PREPARATION

Before beginning assembly of product, make sure all parts are present. Compare parts with package contents list. If any part is missing or damaged, do not attempt to assemble the product.

Estimated Assembly Time: 45 minute

Tools Required for Assembly: Phillips Screwdriver (not included)

1/8 in. Drill Bit (not included)

INSTALLATION INSTRUCTIONS

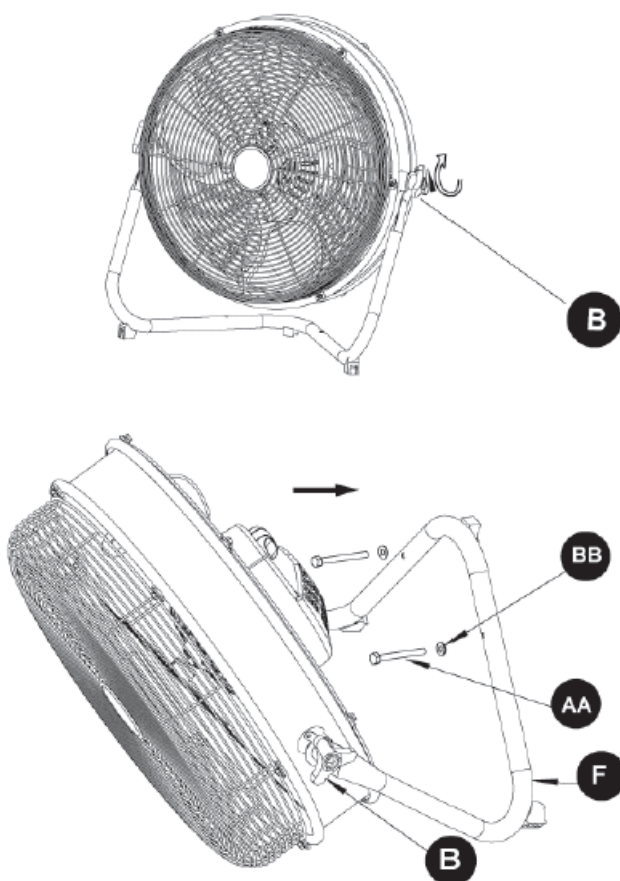

- **TO USE AS A FLOOR FAN**

The fan comes fully assembled

TO ADJUST AIRFLOW UP AND DOWN

1. Tilt the fan to the desired angle
2. Tighten the Adjustable knobs (B) on both sides to secure the fan head.

- **TO INSTALL AS A WALL FAN**

Feed the screws (AA) through the washers (BB) and the two holes on the fan bracket (F) to secure the fan to the wal.

WARNING

1. Mount fan on a wooden wall only.
 2. To reduce the risk of electric shock and personal injury, ensure the location for mounting is able to support this fan.
 3. Total weight of fan is 13.2LBS.
 4. It is recommended a qualified electrician mount this fan.
- TO ADJUST AIRFLOW UP AND DOWN
 1. Tilt the fan to the desired angle.
 2. Tighten the Adjustable knob (B) on both sides to secure the fan head.

HARDWARE USED



Screw



x2



Washer



x2

OPERATING INSTRUCTIONS

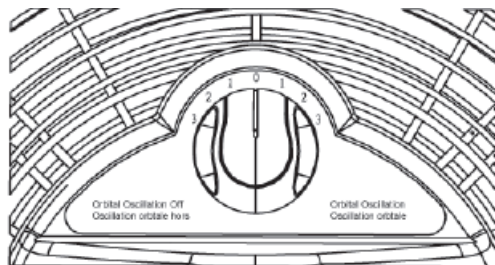

1. ADJUSTING AIR SPEED

Adjust the desired speed by rotating the switch knob

0 Stop 1 Low 2 Medium 3 High

2. ADJUSTING INTERNAL ORBITAL OSCILLATION FEATURE

The internal orbital oscillation feature can be turned on by rotating the switch knob to the side sticked “Orbital Oscillation”.

To disengage the oscillation feature, turn the switch knob to the side sticked “Orbital Oscillation Off”

CARE AND MAINTENANCE

Unplug the appliance before cleaning. Don't use any water for cleaning metal surfaces.

In order to remove the dust from the protective screen, use a vacuum cleaner or remove the front protective screen by removing the securing screw on the edge of the screen with a screwdriver. After cleaning, remount the safety screen. After doing this, fasten the securing screw on the edge of the protective screen.

TROUBLESHOOTING

PROBLE		
The fan fails to operate.	<ol style="list-style-type: none">1. Fan may not be plugged in.2. There may some be obstructions in the fan.	<ol style="list-style-type: none">1. Make sure the fan is plugged in and electrical outlet is working properly.2. Check for any obstruction. If you find an obstruction, turn the fan to "0". Unplug the fan and carefully remove the obstruction. Plug the fan in and turn it on again, referring to the OPERATING INSTRUCTIONS.
Orbital oscillation feature not working.	<ol style="list-style-type: none">3. Orbital oscillating feature is not turned on.	<ol style="list-style-type: none">3. Make sure that orbital oscillation switch is turned on.

WARRANTY

TWO-YEAR LIMITED WARRANTY. The manufacturer warrants this product to be free from manufacturing defects in material and workmanship. This warranty does not cover transit damages.

This warranty does not apply to damages from accident, misuse, alteration of any kind to the fan or where the connected voltage is more than the nameplate voltage. This warranty does not apply to the finish on any portion of the product. Servicing performed by unauthorized persons shall render the warranty invalid. For warranty service, contact Customer Service at 1-866-994-4148, 8 a.m. – 8 p.m., EST, Monday – Sunday.

Some states do not allow the limitation or exclusion of certain damages. Therefore, these limitations and exclusions may not apply to you. This warranty gives the consumer specific legal rights. You may have other rights that vary from state to state.

REPLACEMENT PARTS LIST

For replacement parts, call our customer service department at 1-866-994-4 148, 8 a.m. – 8 p.m., EST, Monday - Sunday.

PIEZA	DESCRIPCIÓN	PART #
A	Blade	SFD3-450BI-A
B	Adjustable Knob	SFD3-450BI-B
C	Capacitor	SFD3-450BI-C
D	Switch	SFD3-450BI-D
E	Knob	SFD3-450BI-E

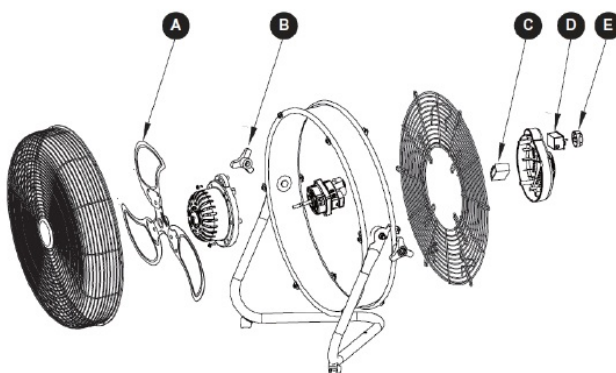

Documents / Resources



[UTILITECH SFD3-450BI 18 Inch Internal Orbit Oscillating Fan](#) [pdf] Instruction Manual
SFD3-450BI 18 Inch Internal Orbit Oscillating Fan, SFD3-450BI, SFD3-450BI Internal Orbit Oscillating Fan, 18 Inch Internal Orbit Oscillating Fan, Internal Orbit Oscillating Fan, Orbit Oscillating Fan, Oscillating Fan, Fan, 0625628