



UNV IPC21xx Series Network Bullet Cameras Installation Guide

[Home](#) » [UNV](#) » UNV IPC21xx Series Network Bullet Cameras Installation Guide 



IPC21xx Series Network Bullet Cameras Installation Guide



Contents

- [1 IPC21xx Series Network Bullet Cameras](#)
- [2 Camera appearance](#)
- [3 Camera installation](#)
- [4 Resistance requirements](#)
- [5 Package Contents](#)
- [6 Safety Instructions](#)
- [7 Involvement](#)
- [8 Camera access](#)
- [9 Compliance](#)
- [10 Documents / Resources](#)
 - [10.1 References](#)
- [11 Related Posts](#)

IPC21xx Series Network Bullet Cameras

Picture instructions

Camera appearance

1.1 Dimensions

The following illustration shows the dimensions of the device. Appearance and dimensions may vary depending on the device model.

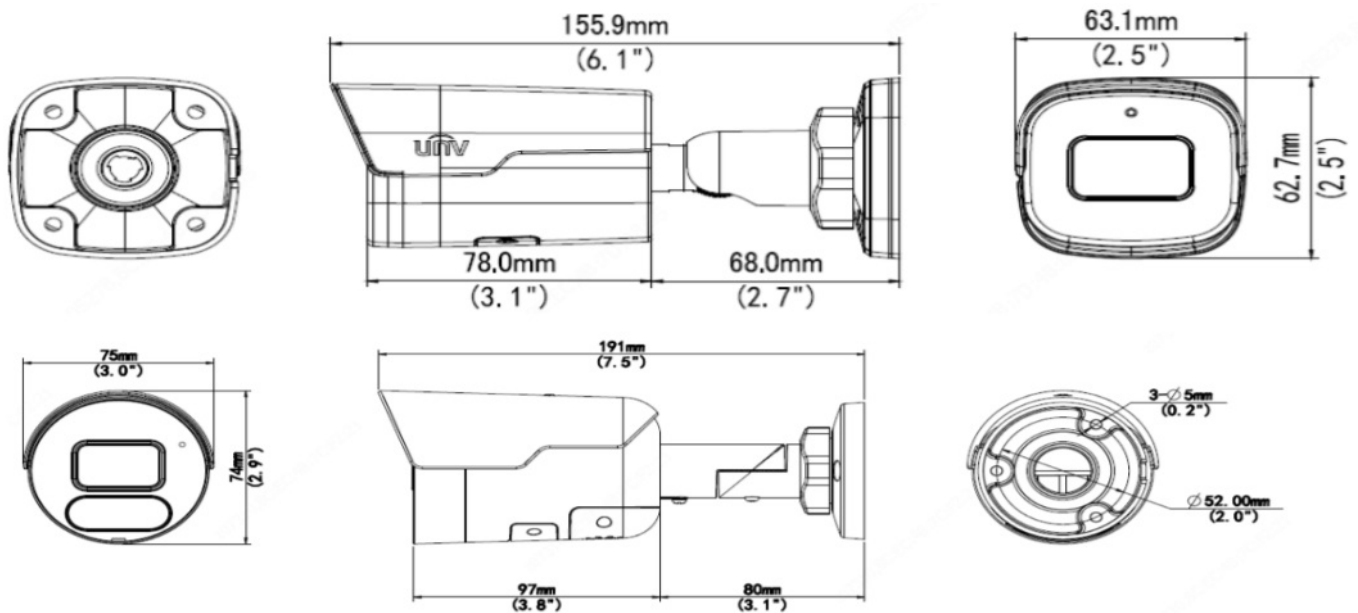

1.2 Cabling,

Appearance and tail cable may vary by device model.

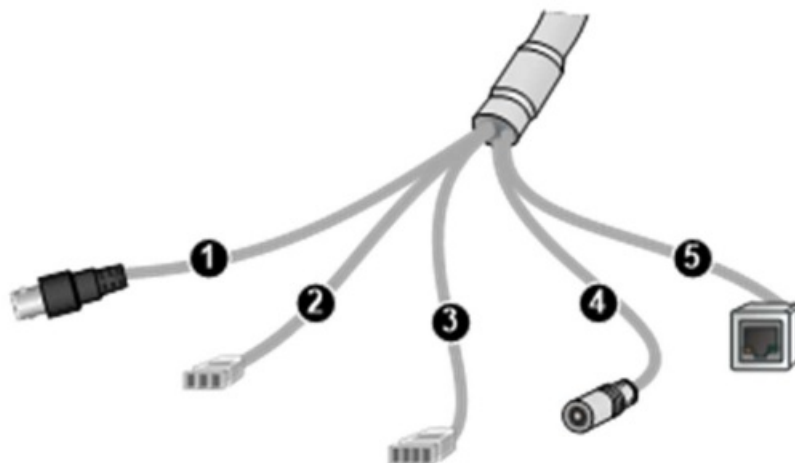

1. Video output(BNC interface)
2. Alarm input (IN,GND)/ Alarm output (N,P)
3. Ethernet interface
4. Audio input/Audio output/GND
5. Power interface

Camera installation

2.1 (Optional) Insert Micro SD card

Handle the SD card only on a disconnected camera, otherwise the camera or SD card may be damaged. Use a Phillips screwdriver (not included) to loosen the screws of the bottom cover of the camera, and insert the Micro SD card.

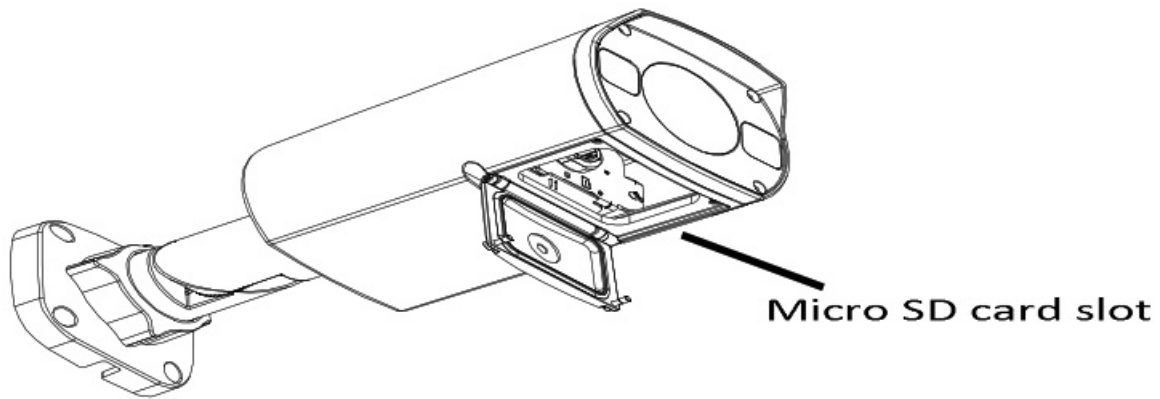

2.2 Wall installation

Attach the drilling template, draw the holes, drill with a 6 mm drill bit, and insert the plastic dowels..

1. Paste the installation positioning sticker on the wall and align the cross center to the hole on the wall. Use a 06-6.5 mm drill bit to drill 30 mm-depth guide holes according to the positions marked by the sticker. Knock the plastic anchors into the guide holes and ensure that they are tightened up.

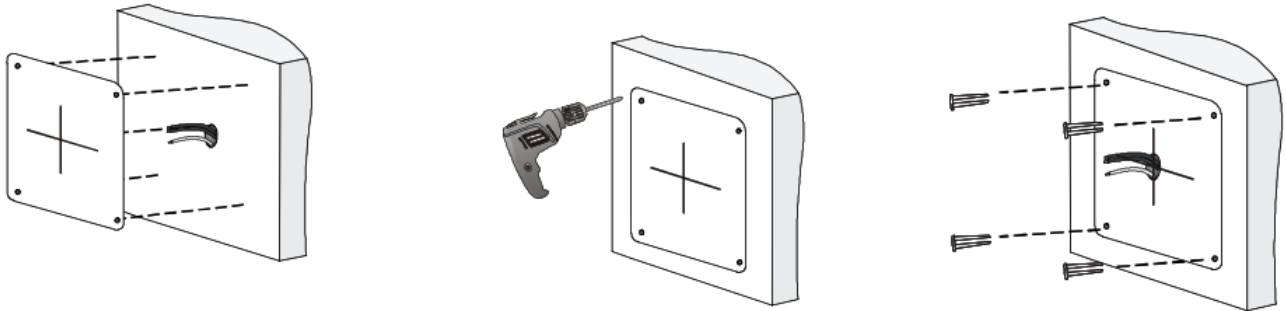

2. Lead the cables across the hole on the wall.

Loosen the hinge or cover screws with the supplied “L” wrench, connect the cables, screw the camera, point the camera, tighten the hinge / camera cover.

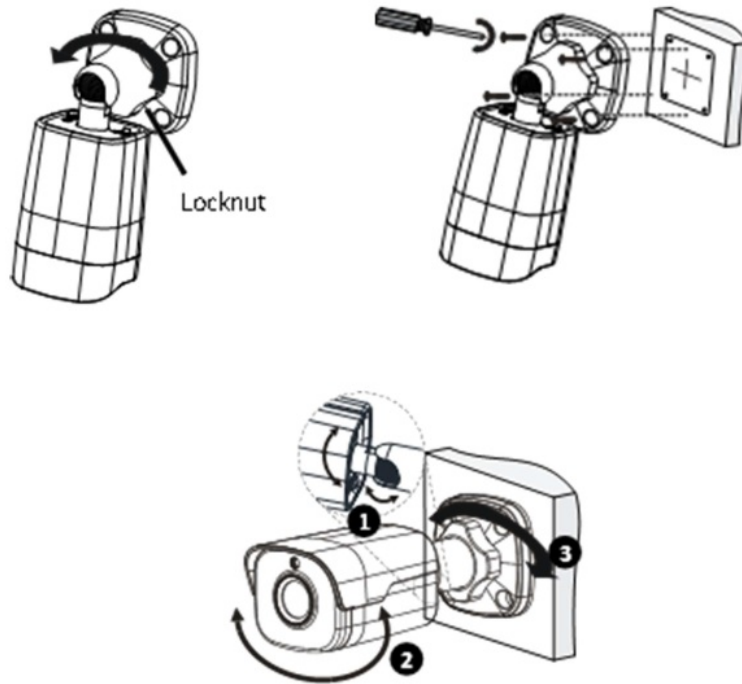

Resistance requirements

Install waterproof cables in accordance with the following instructions. The user assumes all responsibility for damage to the equipment caused by water as a result of improper installation.



NOTE!

- Before you begin, connect all the necessary cables and insulate the copper wires that you do not use.
- Use self-adhesive waterproof tape (not included) to protect the cables.
- Use waterproof components to protect the Ethernet cable.

1. Insulating tape (not included) to insulate the connection part of each cable.

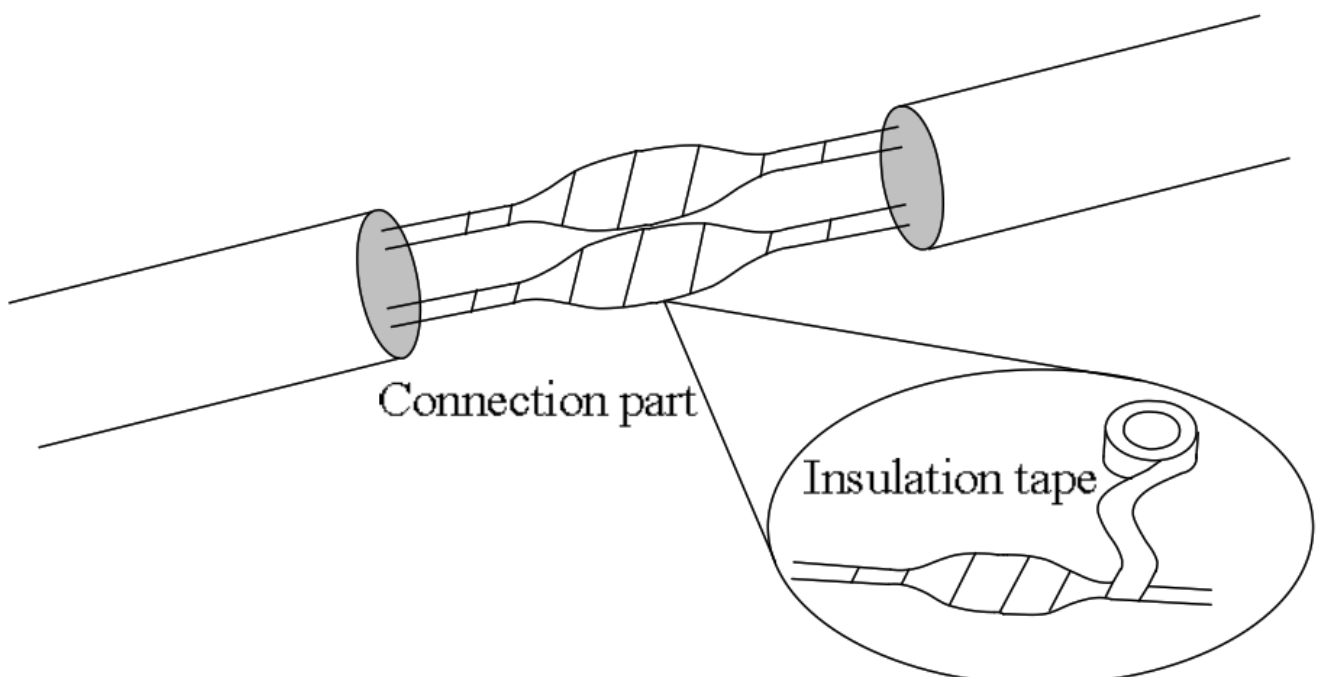

2. Waterproof cables with self-adhesive waterproof tape.
 1. Fully stretch the waterproof tape at both ends.

2. Insulate joints and cables tightly with waterproof tape.
3. Tighten the tape at both ends to prevent water from entering.



Wrap the used cables separately

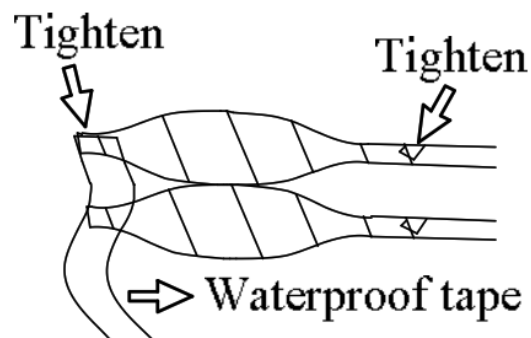

Wrap the unused cables together into a bundle

3. Install the supplied waterproof components on the network cable.

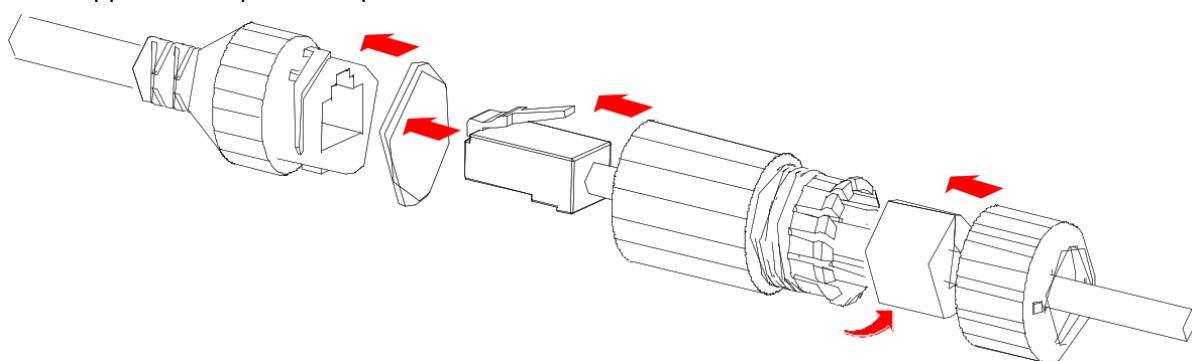

Notification!

Before stretching the cable through the coupling, insert a rubber sealing ring.

4. If the camera is equipped with a DC power connector and you will not use it, insert a blanking plug into the connector (When powering the camera using PoE).

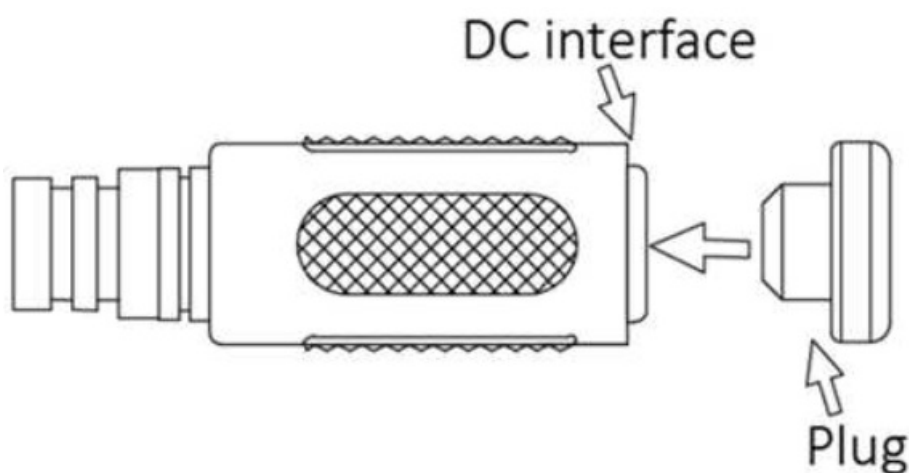

5. (Optional) When the waterproof treatment is complete, insert the cables into the waterproof junction box (purchased separately).



WARNING!

- Connectors must be kept away from water.
- Insert the power adapter into a waterproof distribution box or install it indoors.

Package Contents

Item	Quantity
Camera	1
Drill template	1
Bag with installation accessories	1

Safety Instructions

Installation and disassembly of the camera and its accessories must be carried out by a qualified person. Before installation and operation, study the safety instructions.

4.1 Installation and Shipping Notice

- Use the recommended power adapter or IEEE802.3af PoE device. Otherwise, the device may be damaged.
- Make sure that the length of the DC power cord between the power adapter and the camera is not too long, otherwise the voltage of the camera is reduced. The camera may not work properly.
- If it is necessary to extend the power cord, extend the cable between the power adapter and the 230V network.
- During installation, do not bend and break the cables too much, otherwise poor cable contact may cause a malfunction.
- When connecting to an external interface, use the connection terminal and make sure that the cable terminal (or ethernet connector latch) is in good condition and properly clicked. Make sure that the cable is not overly tensioned during assembly to avoid bad contact with the port or loosening caused by shock or shock.
- During transportation, special care should be taken to protect the transparent dome cover/camera visor from friction, scratches, chemical splashes, etc. Do not remove the protective film from the camera dome/visor until installation is complete.
- Contact the experts for maintenance information. Do not try to dismantle the device yourself. We assume no liability for problems caused by unauthorized repair or maintenance.

4.2 Maintenance

- Remove dust and small debris from the camera using lower pressure compressed air (blower) or a fine brush to avoid scratching the camera dome/visor.
- If there is grease or dust stain on the glass surface, gently clean the glass surface from the centre outwards using antistatic gloves or an optic cloth. If grease or stain still remains, use antistatic gloves or an optic cloth soaked in detergent and gently clean the surface of the glass until clean.
- Do not use organic solvents (such as benzene and alcohol) to clean the transparent dome cover.

Involvement

- Power supply: After installing the camera, connect the power adapter (not included unless otherwise stated) and the ethernet cable to your router, or when powering with IEEE802.3af PoE to your PoE switch / NVR Uniview (connection option without power adapter, the camera must support PoE).

- Alarm input / output: If the camera is equipped with a digital input and output, and unless otherwise stated, the digital input is activated by connecting to GND, the digital output is a MAX dry contact. 30, VDC, 1A or 50 VAC, 0.3A.
- Audio: if the camera is equipped with an Audio IN / OUT audio interface, the parameters are as follows (unless otherwise stated): Input-impedance 35kΩ; amplitude 2V [p-p], Impedance output 600Ω; amplitude 2V [p-p].

Camera access

1. Open the IE web browser, type the IP address of the camera in the address bar and press Enter. The default IP address is 192.168.1.13 (the subnet mask is 255.255.255.0).
2. On the login page, enter the default username and password (admin/123456) and click Log In. After logging in, you will see a live preview of the camera.



Camera reset (optional): disconnect the camera, press and hold the reset button and turn on the camera at the same time. Hold down the reset button for 15 seconds.



NOTE!

- By default, dhcp is enabled for the camera. If a DHCP server is used on your network, your camera may be assigned a different IP address by your router and you must use the assigned IP address to log in. The best way to find out the IP address is to use the Uniview Eztools desktop application.
- Možná will have to install a plug-in in the IE browser the first time you log in. Follow the on-screen instructions to complete the installation, and then reopen the browser to sign in.
- The default password is only for your first login. For security, change your password after the first login. We strongly recommend that you set a strong password of at least nine characters, including all three elements: numbers, letters, and special characters.
- If your password has been changed, sign in with your new password.

Copyright Notice

©2020 Zhejiang Uniview Technologies Co. All rights reserved.

No part of this manual may be copied, reproduced, translated or distributed in any form by any means without prior written content from Zhejiang Uniview Technologies Co., Ltd (hereinafter referred to as Uniview or we).

The product described in this guide may contain proprietary software owned by Uniview and its licensors, if any. Except as permitted by Uniview and its licensors, no one may copy, distribute, modify, abstract, decompile, disassemble, decrypt, reverse engineer, lease, transfer or sublicense the Software in any form by any means.

Trademark certificates



are trademarks or registered trademarks of Uniview.

All other trademarks, products, services and companies in this manual or the product described in this manual are the property of their respective owners.

Export Declaration of Conformity

Uniview complies with applicable export control laws and regulations worldwide, including those of the People's Republic of China and the United States, and complies with applicable export, re-export, and transfer regulations for hardware, software, and technology. With respect to the product described in this guide, Uniview asks you to fully understand and strictly comply with applicable laws and regulations regarding exports worldwide.

Privacy reminder

Uniview complies with applicable privacy laws and is committed to protecting users' privacy. You may want to read our full privacy policy on our website and learn how we process your personal data. Please note that the use

of the product described in this guide may involve the collection of personal data such as face, fingerprint, license plate number, email, phone number, GPS. Please comply with local laws and regulations when using the product.

About this guide

- This manual is intended for multiple product models and the photos, illustrations, descriptions, etc. in this manual may differ from the actual appearance, functions, characteristics, etc. of the product.
- This guide is intended for multiple versions of the software, and the illustrations and descriptions in this guide may differ from the actual graphical user interface and features of the software.
- Despite our best efforts, there may be technical or typographical errors in this guide. Uniview is not responsible for any such errors and reserves the right to change the manual without prior notice.
- Users are fully responsible for damages and losses that arise as a result of improper operation.
- Uniview reserves the right to change any information in this manual without prior notice or indication. For reasons such as product version upgrades or regulatory requirements of applicable regions, this guide will be updated regularly.

Disclaimer

- To the extent permitted by applicable law, in no event shall Uniview be liable for any special, incidental, indirect, consequential damages or loss of profits, data and documents.
- The product described in this manual is provided “as is”. Unless required by applicable law, this guide is for informational purposes only and all statements, information and recommendations in this manual are presented without warranty of any kind, express or implied, including, but not limited to, merchantability, quality satisfaction, fitness for a particular purpose and noninfringement.
- Users must assume full responsibility and all risks associated with connecting the Product to the Internet, including but not limited to network attacks, hacking and viruses. Uniview strongly recommends that users take all necessary measures to increase the protection of the network, devices, data and personal data. Uniview disclaims any liability associated with this, but will gladly provide the necessary security-related support.
- To the extent not prohibited by applicable law, in no event shall Uniview and its employees, licensors, subsidiaries, affiliates be liable for the results resulting from the use or inability to use the product or service, including but not limited to lost profits and any other business damages or losses, loss of data, purchase of replacement goods or services; damage to property, personal injury, business interruption, loss of business information or any special, direct, indirect, incidental, consequential, pecuniary, cover, exemplary, incidental loss, however caused and under any theory of liability, whether in contract, strict liability or tort (including negligence or otherwise) in any way outside of the use of the Product, even if Uniview has been advised of the possibility of such damages (other than as may be the case) required by applicable law in cases involving personal injury, incidental or incidental damage).
- To the extent permitted by applicable law, In no event shall Uniview’s total liability to you for any damages caused by the Product described in this Manual (except as required by applicable law in cases involving personal injury) in no event exceed the amount of money you paid for the Product.

Network security

Please take all necessary measures to increase the network security for your device.

Below are the necessary measures to secure your device’s network:

- Change your default password and set a strong password: We strongly recommend that you change your

default password after you sign in for the first time and set a strong password of at least nine characters, including all three elements: numbers, letters, and special characters.

- Keep your firmware up to date: It is recommended that your device is always updated to the latest version for the latest features and better security. Visit the official Uniview website or contact your local dealer for the latest firmware. The following are recommendations for increasing the security of your device's network:
- Change your password regularly: Change your device password regularly and keep your password safe. Make sure that only an authorized user can sign in to the device.
- Enable HTTPS/SSL: Use an SSL certificate to encrypt HTTP traffic and ensure data security.
- Allow IP address filtering: Allow access only from specified IP addresses.
- Minimum port mapping: Configure your router or firewall to open a minimum set of ports to the WAN and preserve only the necessary port mappings. Never set up a device as a DMZ host or configure full NAT.
- Disable the automatic logon and password saving features If multiple users have access to your computer, we recommend that you disable these features to prevent unauthorized access.
- Choose your username and password discreetly: Avoid using your social media username and password, bank, email account, etc. as your device's username and password in case your social media information, bank, and email account is leaked.
- Restrict user permissions: If more than one user needs access to your system, make sure that each user is granted only the necessary permissions.
- Disable UPnP: When UPnP is enabled, the router automatically maps internal ports and the system automatically forwards port data, leading to a risk of data leakage, so it is recommended that you disable UPnP if the HTTP and TCP port mapping on the router has been manually enabled.
- SNMP: Disable SNMP if you are not using it. If you are using it, SNMPv3 is recommended.
- Multicast: Multicast is designed to transfer video to multiple devices. If you do not use this feature, we recommend that you disable multicasting on your network.
- Review logs: Periodically review device logs for unauthorized access or abnormal operations.
- Physical protection: Keep your device in a locked room or closet to prevent unauthorized physical access.
- Isolate video surveillance network: Isolating the video surveillance network from other service networks helps prevent unauthorized access to devices in your security system from other service networks.

Other safety information:

You can also get security information from the Security Response Center on Uniview's official website.

Safety Warning

The equipment must be installed, serviced and maintained by a trained professional with the necessary safety knowledge and skills. Before you start using the device, read this manual carefully and make sure that all relevant requirements are met to avoid danger and loss of property.

Storage, transport and use

- Store or use equipment in the right environment that meets environmental requirements, including but not limited to temperature, humidity, dust, corrosive gases, electromagnetic radiation, etc.
- Make sure that the device is securely installed on a flat surface, and properly tightened screws to prevent the device from falling. Improper installation can result in damage to the health of people, animals, and property.
- Unless otherwise stated, do not stack the device on top of each other. Mechanical damage or overheating may occur.
- Provide good ventilation in the operating environment. Do not cover the ventilation holes on the device. Leave enough space for ventilation.

- Protect the plant from liquid of any kind.
- Make sure that the power supply provides a stable voltage that meets the power requirements of the device. Make sure that the output power of the power supply exceeds the total maximum power of all connected devices. Use only the power supplies recommended by the manufacturer.
- Before connecting to the power supply, verify that the device is installed correctly.
- Do not remove seals from the body of the device without first consulting Uniview. Do not attempt to service the product yourself. Contact a trained maintenance professional.
- Always disconnect the device from power before trying to move the device.
- Before using the device outdoors, take the correct waterproof measures in accordance with the requirements.

Power requirements

- Installation and use of the equipment must be in strict compliance with local electrical safety regulations.
- If you're using an adapter, use an LPS-certified power supply.
- Use the recommended cable (power cord) in accordance with the specified nominal values.
- Use only the power adapter that came with the device, or recommended by the manufacturer or supplier.
- For power, use a secured power socket with a protective grounding.
- If it is recommended to ground the device, ground it properly.

Battery warning

- When using the battery, avoid:
 - High or low extreme temperatures during use, storage and transportation;
 - Extremely low air pressure or air pressure at high altitude.
- Use the battery correctly. Improper use of the battery can cause a fire or chemical leakage from the batt
 - Always replace batteries with the same type;
 - Do not throw used batteries into a fire or hot oven or do not mechanically damage them. Do not try to disassemble the
- Dispose of a used battery according to local regulations or the battery manufacturer's instructions.

Compliance

FCC Statement

This device complies with Part 15 of the FCC Rules. Operation is subject to the following two conditions: (1) the device must not cause harmful interference, and (2) it must accept any interference from the outside, including interference that could adversely affect its functions.

The declaration of conformity information shall cover:
http://en.uniview.com/Support/Download_Center/Product_Installation/Declaration/

Please note: The user is notified that changes or modifications that are not expressly approved by the party responsible for compliance could revoke the user's authorization to operate the device.

NOTE: This device has been tested and found to meet the limits for a Class A digital device under Part 15 of the FCC Rules. These limits are designed to provide adequate protection against harmful interference when operating equipment in a commercial environment. This equipment generates, uses and can emit radio frequency energy and, if not installed and used in accordance with the instructions for use, may cause harmful interference to radio communications. The operation of this device in a residential area is likely to cause harmful interference, in which case the user will be obliged to correct the interference at his own expense.

 This product complies with the European Low Voltage Directive 2014/35/EU and EMC Directive 2014/30/EU.





The product referred to in this guide is covered by the Waste Electrical and Electronic Equipment (WEEE) Directive and must be disposed of responsibly.



The battery in the product complies with the European Battery Directive 2013/56/EC. For proper recycling, return the battery to the supplier or to a designated collection point.



Documents / Resources

<div><div><div>UNVIEW IPC21xx</div><div></div></div><div><ul style="list-style-type: none">• UNVIEW IPC21xx Series Network Bullet Cameras [pdf] Installation Guide• UNVIEW IPC21xx Series Network Bullet Cameras, IPC21xx Series, Network Bullet Cameras, Bullet Cameras</div></div>	<div><div><div>UNV IPC21xx Series Network Bullet Cameras [pdf] Installation Guide</div><div>IPC21xx Series Network Bullet Cameras, IPC21xx Series, Network Bullet Cameras, Bullet Cameras</div></div></div>
---	---

References

- [\[U\] Suppliers Declaration of Conformity - Uniview - Leader of AIoT Solution](#)