



unu Basics Scooter User Guide

[Home](#) » [unu](#) » unu Basics Scooter User Guide 

unu

Scooter basics
Quick Start Guide & Essentials



Contents

- 1 Unbox your scooter
- 2 Wake up & turn on/off
- 3 Mount your mirrors
- 4 First charge
- 5 Charge your battery
- 6 Park your scooter
- 7 Long-term Parking
- 8 Reboot your scooter
- 9 Documents / Resources
 - 9.1 References
- 10 Related Posts

Unbox your scooter

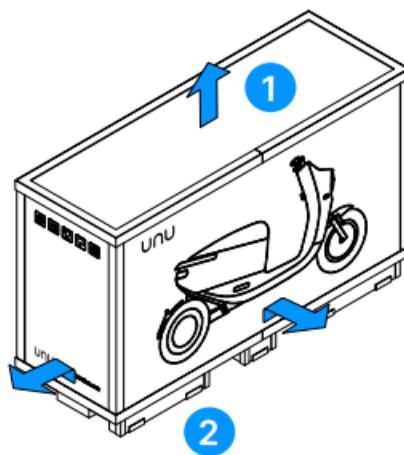

It's best to have a second person help unbox the scooter.

1. Remove the top lid of the box.
2. Remove the four side walls by sliding them upwards.

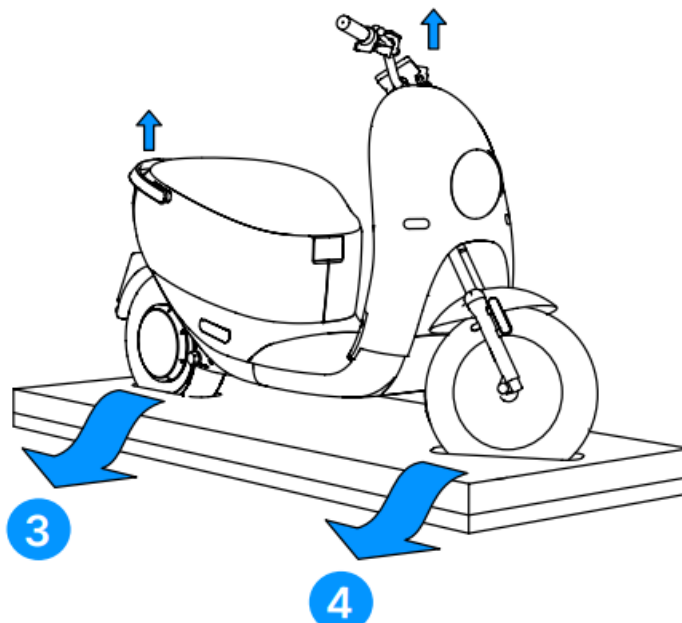

3. Lift the back wheel by the rear handle and move it off the platform.
4. Lift the front wheel off the package by the handlebar.

5. Unfold the kickstand to stabilize the scooter.

Wake up & turn on/off

To prevent the battery from discharging during transit, your scooter is delivered to you in a state of hibernation. Follow these steps to wake up your scooter:

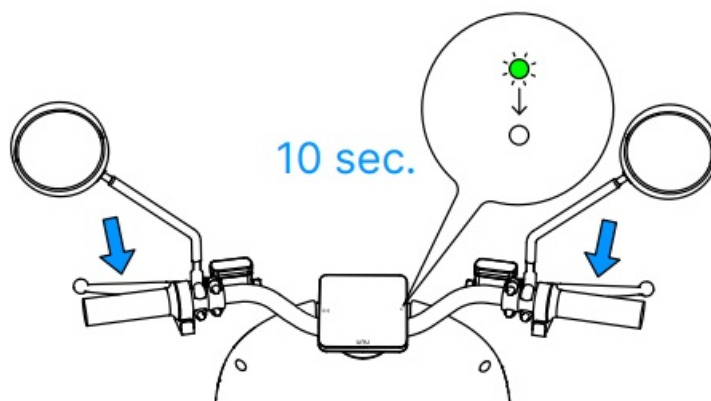

1. Press both brake levers for 10 seconds, until the LED turns green.
2. When the LED turns off, turn your scooter on by tapping your keycard.

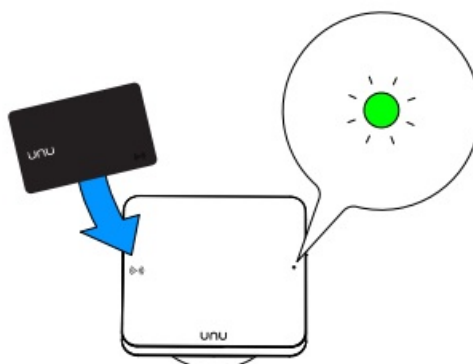

Turn on/off & lock

To turn your scooter on or off, place the provided keycard on the icon on the left of the display until the LED turns green. Fold up the kickstand to enter drive mode.

Your scooter comes with an integrated handlebar lock.

To activate it, turn the handlebar all the way to the left before turning off.

The scooter auto-turns off after 15 mins in Park mode.

Mount your mirrors

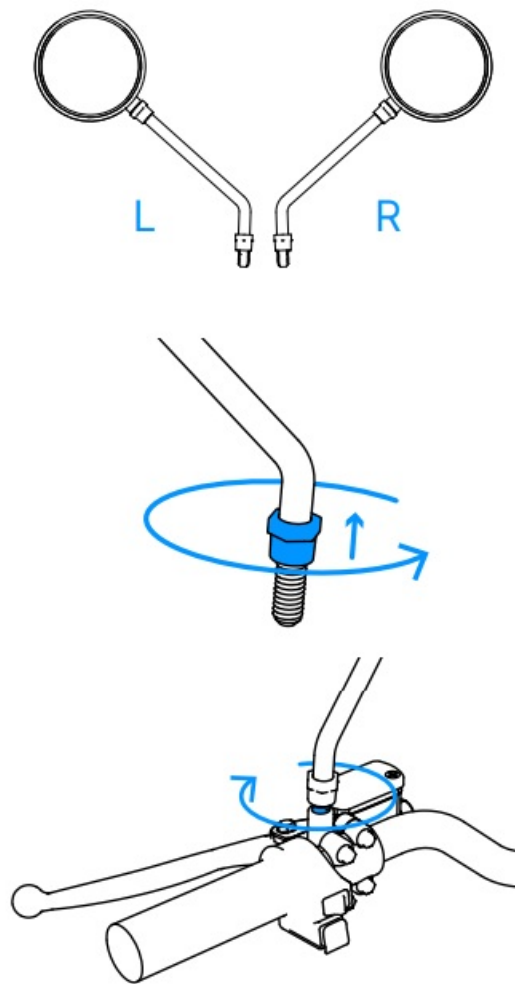

Your scooter should be in park mode and its handlebar unlocked.

These mirrors are compatible with both sides; if needed, you can reverse them by loosening the top bolt.

1. Place both mirrors on a flat surface so that they form a V shape.
2. Pick the left mirror and turn the bottom nut all the way up until you feel resistance.
3. Screw the bolt clockwise into the left side of the handlebar until you feel resistance. Do not use force!

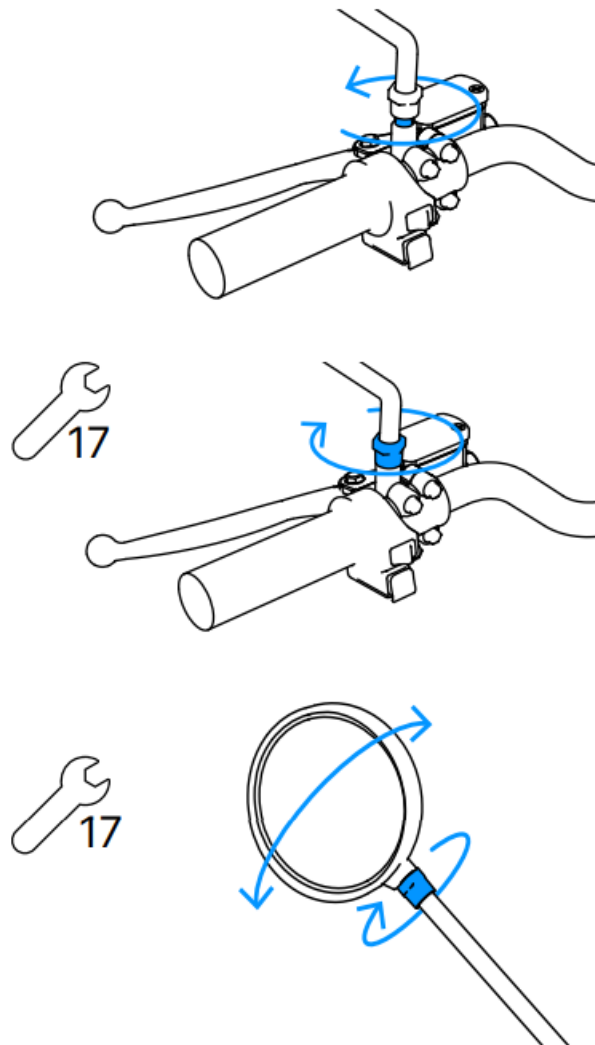

4. Now turn the mirror anticlockwise into a position, so that you can see what is behind you.
5. Tighten the nut with a wrench (17mm) until the mirror is fixed in one place.
6. You can loosen the nut at the top of the mirror arm to adjust the mirror's vertical orientation.
Make sure to tighten the nut again.
7. For fine tuning, press gently on the mirror glass to change its orientation.
8. Repeat with the right mirror.

First charge

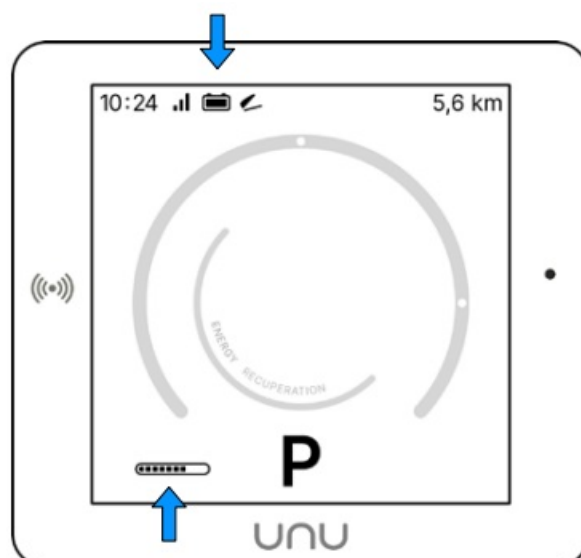

Check your batteries

Find the main battery state of charge (SOC) at the bottom left of the display.

Find the internal battery SOC at the top left of the display. The internal battery is used when no main battery is inserted.

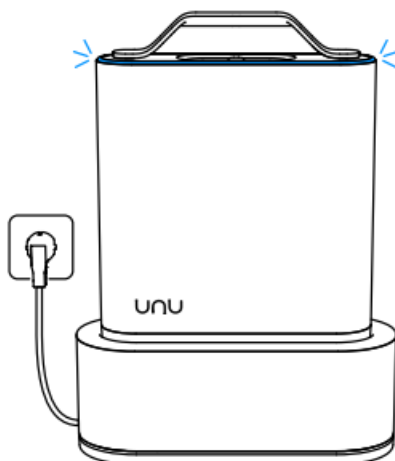

Charge your batteries

Open the seat box by pressing the button on the left of the handlebar.

Remove the main battery. Place the battery on the charger which is included in the starter kit. When you put the battery on the charger the battery LED ring should turn on indicating the current SOC.

Charge your battery



Main battery

- Charge the main battery at room temperature. Do not charge it when the battery is still cold from outside.
- Do not leave the battery in your scooter for several weeks at temperatures below 0°C.
- Take the battery off the charger, when it is fully charged.

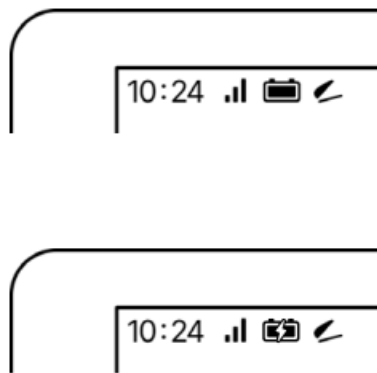

Internal battery

If there is no main battery in the scooter it runs on the internal battery. You can see the state of charge of the internal battery through the small battery icon on top left of the display.

If you want to charge the internal battery you need to put a charged main battery into the scooter. A small icon should appear indicating that the internal battery is charging.

Park your scooter

The unu Scooter is running in different power states to optimise for longer usage. This is an overview of how long you can leave your scooter unattended. If you're planning to park your scooter for a longer period, we recommend activating manual hibernation.

Time estimations are dependent on external factors such as temperature.

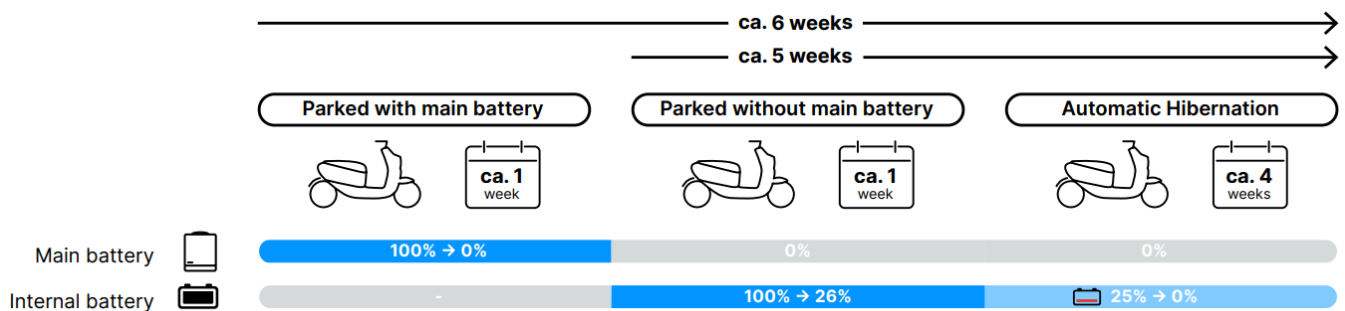

Long-term Parking

If you want to leave the scooter unattended for longer than 4 weeks, we recommend activating the hibernation mode manually to avoid the internal battery from getting drained. In this mode the scooter is running on the internal battery, so it makes no difference if a main battery is inserted or not. With a fully charged internal battery the scooter can last up to about 100 days.

Activate manual hibernation

1. In park mode, press both brake levers simultaneously for 15 seconds, until the display shows the hibernation screen.
2. Release the brake lever and tap your keycard. If you want to cancel, fold up the kickstand.

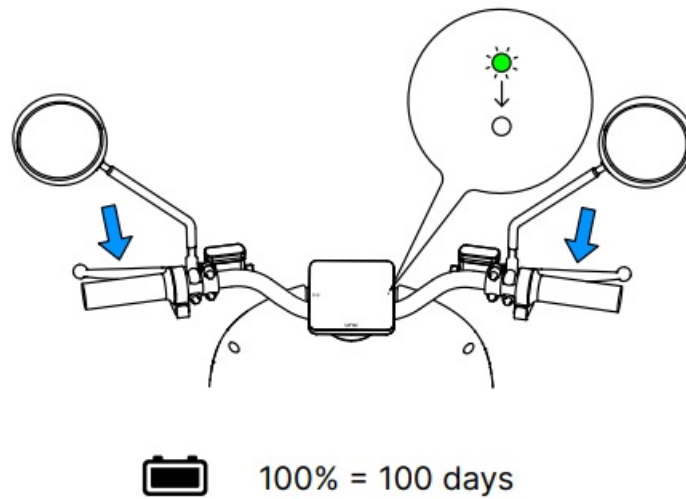

Wake up from hibernation

1. Press both brake levers for 5 seconds, until the LED turns green.
2. When the LED turns off, turn your scooter on by tapping your keycard.

Reboot your scooter

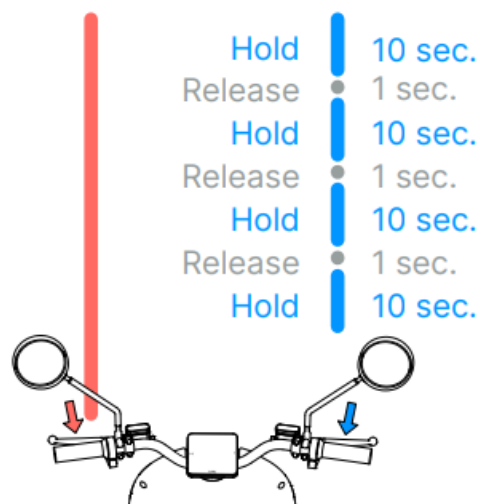

If your unu Scooter is not turning on nor waking up from hibernation, please try a reboot.
If the scooter is still not turning on, visit our help centre.

1. Put your kickstand down.
2. Open a timer on your phone but don't start it just yet.
3. Start the timer and press and hold both brake levers for 10 seconds.
4. When the timer shows 10 seconds, release the right brake lever for 1 second and then press and hold it down again.
5. Repeat the previous step 3 more times.
6. The LED on your display will turn green within 5-7 seconds. When the LED turns off you can tap your keycard and get started.

App

Download the unu App to enjoy smart features like battery and rides status.
We are continually updating the App and the scooter via over-the-air updates. So stay tuned!



Find the user manual

Are you Happy?

Having troubles?

<https://unumotors.com/en-de/manual>

Share your experience on social
and tag @unu

we are here to help, visit

unumotors.com/en-de/help-center/

Documents / Resources

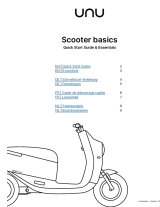
	unu Basics Scooter [pdf] User Guide Basics Scooter, Scooter
---	--

References

- [unu Maintenance, user manual and help for your unu e-scooter | unu](#)
- [unu Maintenance, user manual and help for your unu e-scooter | unu](#)
- [unu-unu-scooter-manual-de.pdf - Google Drive](#)
- [unu Maintenance, user manual and help for your unu e-scooter | unu](#)
- [unu-unu-scooter-manual-en.pdf - Google Drive](#)
- [unu-unu-scooter-manual-fr.pdf - Google Drive](#)
- [User Manual](#)

[Manuals+](#), [Privacy Policy](#)

This website is an independent publication and is neither affiliated with nor endorsed by any of the trademark owners. The "Bluetooth®" word mark and logos are registered trademarks owned by Bluetooth SIG, Inc. The "Wi-Fi®" word mark and logos are registered trademarks owned by the Wi-Fi Alliance. Any use of these marks on this website does not imply any affiliation with or endorsement.