



## unitech MS852DPMESD 2D Imager Barcode Scanner User Guide

[Home](#) » [unitech](#) » unitech MS852DPMESD 2D Imager Barcode Scanner User Guide 



Quick Start Guide  
609506G\_ V1.0



**MS852DPM ESD**  
**2D Imager Barcode Scanner**

## Contents

- 1 Connecting the Scanner
- 2 Test & Finish
- 3 Buzzer & LED Description
- 4 Enter/Exit Setup
- 5 USB Interface Mode
- 6 Illumination Level
- 7 Language Settings
- 8 Documents / Resources
- 8.1 References

## Connecting the Scanner

Connect USB cable to the USB port of a host computer.

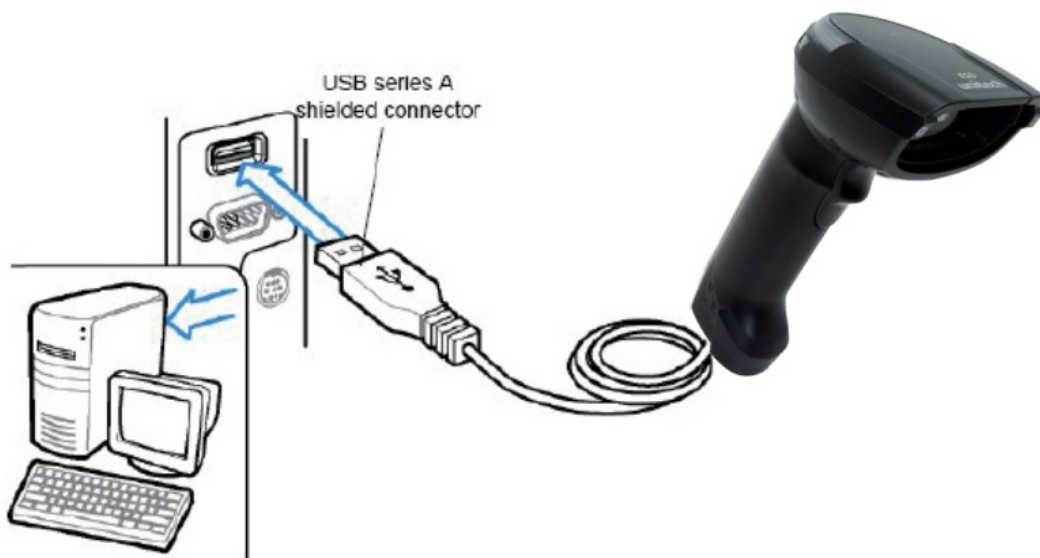

## Test & Finish

Open a word processing program such as Microsoft Word or Notepad and scan the following barcode:



Unitech

If the word “Unitech” appears on the screen, you have successfully installed your scanner.

## Buzzer & LED Description

- Three short beeps (low – medium – high): Power on/Exit Setting Mode (setting success)
- One short beep: Barcode Good Read
- Two long beeps: Entering setting mode
- One long beep: Good Read (during setting mode)

- Three short beeps (high – high – high): Setting Failed
- Green Light On: Barcode Good Read

### Default Setting



Set Factory Default

%++%

**Note:** The barcode with an Asterisk (\*) is the default setting.

### Enter/Exit Setup



Enter Setup

%+\$. \$



Exit Setup

%\$\$%

Scanning the Enter Setup barcode can enable the engine to enter the setup mode. Scan the Exit Setup barcode to exit the setup mode.

### USB Interface Mode



USB HID Keyboard\*

OP02



USB CDC  
OP03

## Scan Mode



Level Trigger Mode\*  
MD01



Sense Mode  
(Image Change)  
MD02

## Beeper Control



Low  
FRQ2



Medium\*  
FRQ3



High  
FRQ4

Good Read Beep



On\*  
SND1



Off  
SND0

Aiming



Always On  
AIM02



Off  
AIM00



Trigger\*  
AIM01

## HID Keyboard Case



No Case Conversion\*  
CCT0



Upper Case  
CCT1



Lower Case  
CCT2

## Illumination Level



Minimum brightness  
FL01



Intermediate brightness

FL02



Maximum brightness\*

FL03

Terminating Character



Set Terminating  
Character to CR (0x0D)\*

TC03



Set Terminating Character  
to CR LF (0x0D,0x0A)

TC02



Set Terminating  
Character to TAB (0x09)

TC04



None

TC01



<http://www.ute.com/services01.php?rbu=0>

## Language Settings



US (English)\*

KM00



UK (English)

KM02



Brazil

KM20



Belgium

KM01



Denmark

KM03



France



KM04

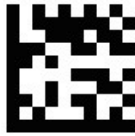

Germany

KM05



Hungary

KM13



Italy

KM06



Japan

KM12



Norway

KM07



Portugal

KM08



Poland

KM18



Russia

KM21



Spain

KM09



Switzerland

KM11



Sweden

KM10



Turkish Q

KM19

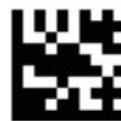

Turkish F

KM24



---

## Documents / Resources



[unitech MS852DPMESD 2D Imager Barcode Scanner](#) [pdf] User Guide

MS852DPMESD 2D Imager Barcode Scanner, MS852DPMESD, 2D Imager Barcode Scanner, Imager Barcode Scanner, Barcode Scanner, Scanner

## References

- [User Manual](#)