



Contents [[hide](#)]

- [1 UNISTYLE WG-01 Bluetooth Water Timer Gateway](#)
- [2 Introduction To The Feature](#)
- [3 Technical Parameters](#)
- [4 Install The Battery](#)
- [5 Installing The Timer](#)
- [6 Local Mode Settings](#)
- [7 Timer Settings in Smart Mode](#)
- [8 Cleaning Up Water Timer](#)
- [9 Troubleshooting](#)
- [10 FCC Statement](#)
- [11 FAQ](#)
- [12 Documents / Resources](#)
 - [12.1 References](#)

UNISTYLE

UNISTYLE WG-01 Bluetooth Water Timer Gateway



After Sales

Thank you for purchasing our Water Timer. We hope the product can bring you a good experience.

1. If you encounter any problems during use, please contact us at Unistyle2024@outlook.com
2. You can also scan the QR code on the product, through the QR code to reach the after-sales page, to provide you with 24-hour after-sales service, but also provides for you to get product maintenance and use in notes!



GET MORE (DE.ES.FR.IT)

Scan the QR code to get more language translations.

WARRANTY

Unistyle provides a one-year worry-free warranty. Please scan the R code to contact us, we will reply within 24 hours.

Warranty

Our products come with a one-year warranty, and if there is a quality problem within one year from the date of purchase.

Warning

1. Use in clean, cold water.
2. When the temperature drops below 37.4°F (3°C), the water timer should be removed and stored indoors. If the water inside the timer freezes, it may expand and damage the internal components, causing leaks and affecting normal operation.
3. The filter prevents dirt to extend the life of the product. Clean the filter regularly and replace it in time if there is any filter damage.
4. To ensure a longer service life, please use 2* AA alkaline batteries (not included). Do not mix old and new alkaline, carbon-zinc or rechargeable batteries.
5. Before first use or not used for a while, activate the irrigation timer.
6. In an open environment, the effective control distance of the water valve via Bluetooth on a smartphone is SOFT (ISM), and the effective range from the gateway to the water valve is 65FT (20M). Please note that if there are obstacles, it is recommended to shorten the connection distance to ensure a stable connection.

Introduction To The Feature

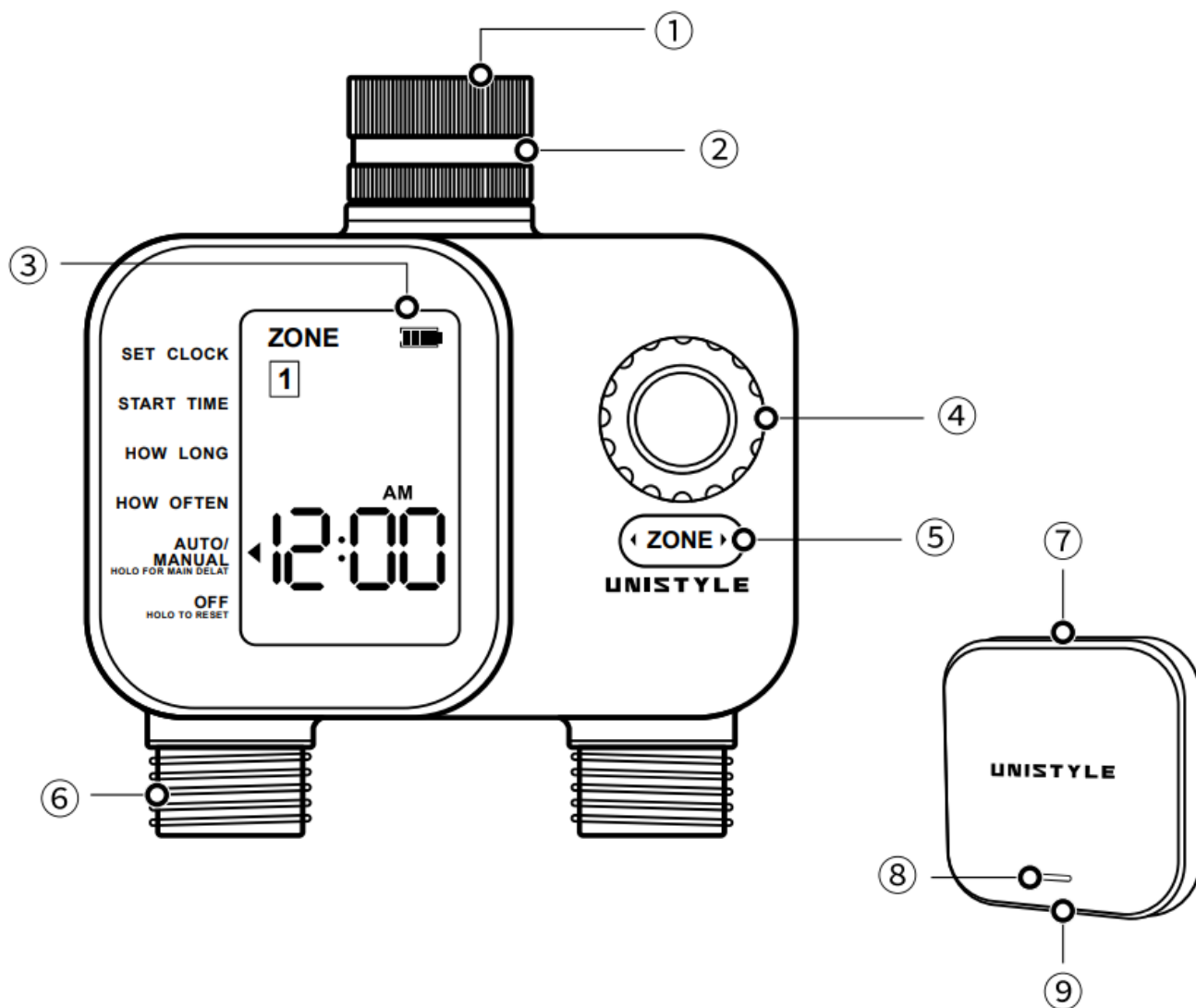

1. Filter
2. Inlet
3. LCD Screen
4. Knob
5. Zone
6. Outlet
7. Type-C
8. Indicator Light
9. Button

- Knob: Rotate the dial clockwise for "+" and counterclockwise for "-". Use the dial to customise your watering schedule.
- Confirm Button: Short press the knob to confirm the timer settings.
- Delay Watering: In AUTO mode, press and hold the "Confirm" button for 3 seconds to access the delay irrigation settings.

- Manual Irrigation: In AUTO mode, short-press the “Confirm” button to enter manual irrigation settings.

PANEL LOCATION	FUNCTION
SET CLOCK	Set the current time(12-hour format)
START TIME	Select what time you would like to start watering
HOW LONG	Determine how long to water(water duration)
HOW OFTEN	Choose how often you will water(water frequency)
AUTO	Timer runs according to your customised schedule
OFF	Turn off all watering

Technical Parameters

Water Timer

Water Pressure	7.25-116 PSI (0.5-8 BAR)
Maximum Flow Rate	35 L/min (9.25 Gal/min)
Waterproof Rating	IP55

Operating Temperature	3°C-S0°C {37.4°F-122°F)
Watering Frequency	1-7days
Automatic Watering Duration	1-360minutes (6hours)
Manual Watering Duration	1-480minutes (8hours)
Water Inlet	For 3/4" screw thread
Water Outlet	For 3/4" Standard tube

Battery	2*AA (1.5V) Alkaline batteries (not included)
---------	---

Gateway Specifications

Communication Distance Between WiFi Gateway and Timer	Up to 65FT (20M) in open areas without interference Input Voltage: DC 5V/1A, Type-C input
Input Voltage	DC 5V/1A, Type-C input
WiFi	2.4 GHz
Protocol	IEEE 802.11b/g/n
Operating Temperature Range	3°C-50°C (37.4°F-122°F)
Operating Humidity	10%-90% (non-condensing)
App	Smartlife

Install The Battery

1. Remove the battery compartment cover on the back of the timer.
2. Insert 2 new AA (1.5V) alkaline batteries (not included).
3. Put the battery compartment cover back on the timer and press firmly to make sure it is completely sealed for waterproofing.

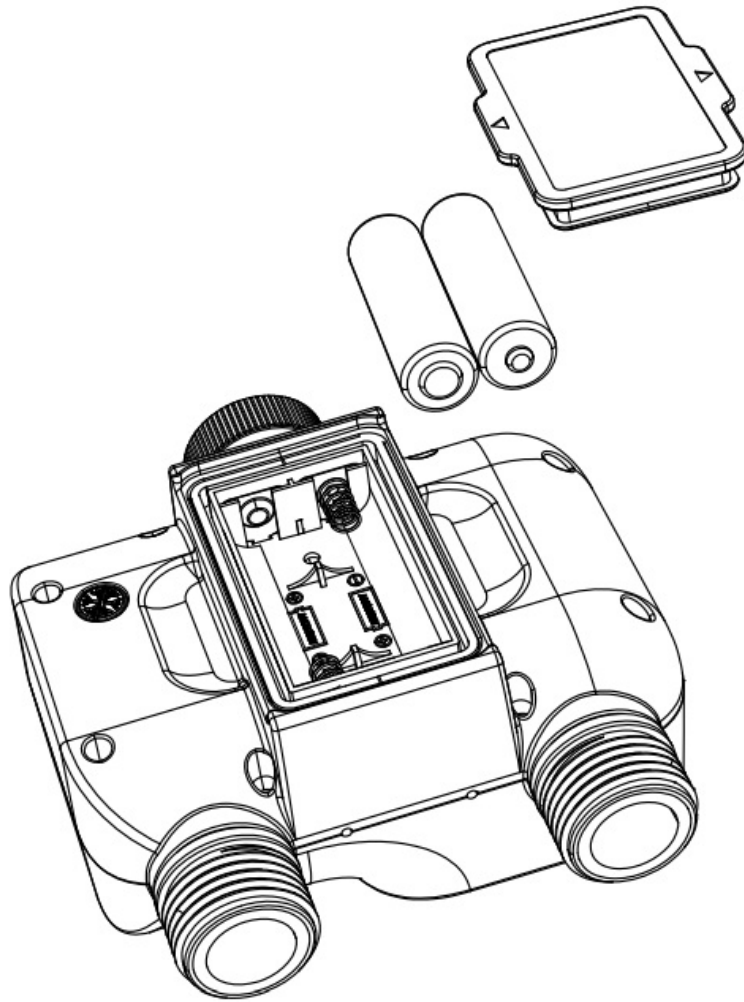

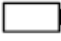
1. After the battery is installed, please install the battery tray cover firmly to ensure waterproofing.
2. When the timer is not used for a long time, remove the battery and dispose of it properly.
3. Replace batteries when the low battery indicator appears”  ” on display.
4. Do not put the battery in the fire. The battery may explode or leak.
5. For longer life, use 2 new AA alkaline batteries (not included). Do not mix old and new alkaline batteries, standard batteries (carbon-zinc batteries), or rechargeable batteries.

Installing The Timer

1. Turn off the faucet in the garden.
2. Wrap the PTFE tape around the faucet thread.
3. Screwing the timer to the garden faucet and keeping the display perpendicular to the ground prevents rainwater from accumulating and seeping inside.

4. Wrap the PTFE tape around the timer outlet.
5. Screw the garden hose onto the outlets of the timer.
6. After setting the program, turn on the faucet and timer.

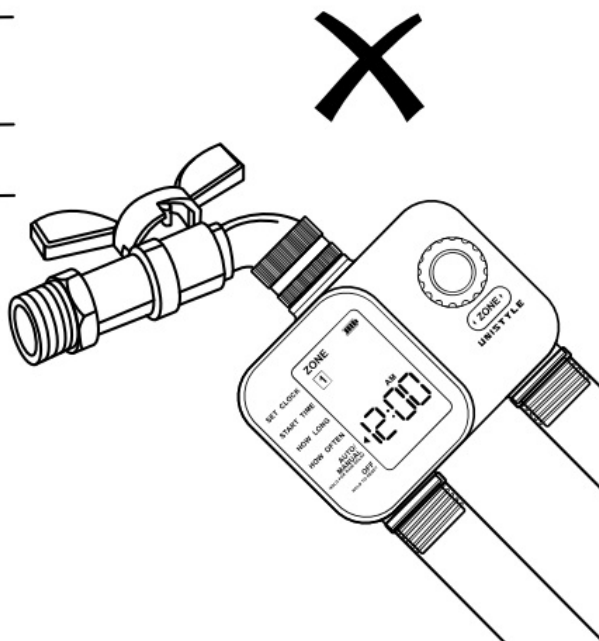
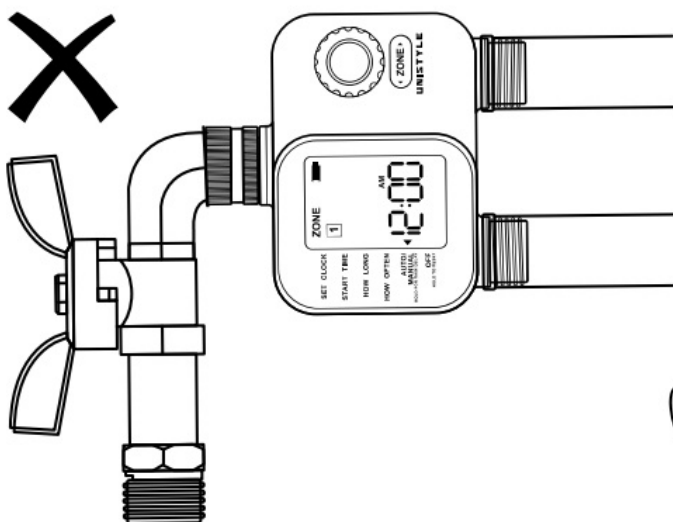
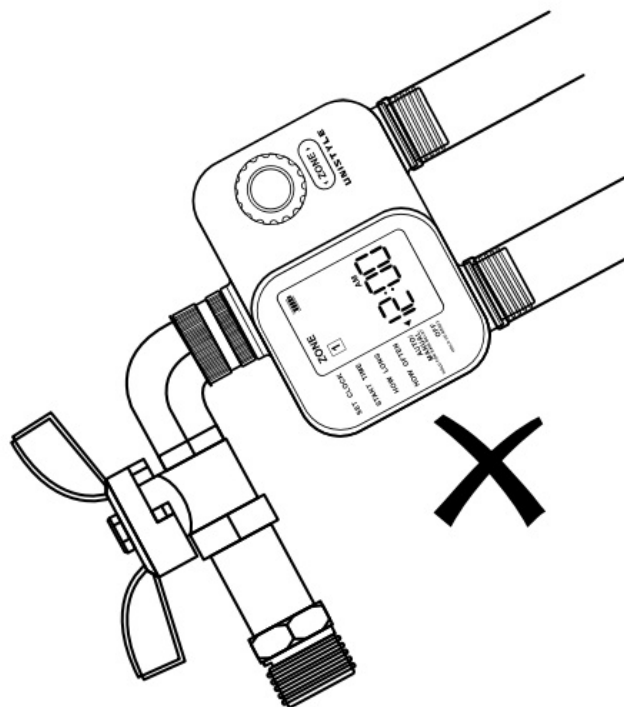
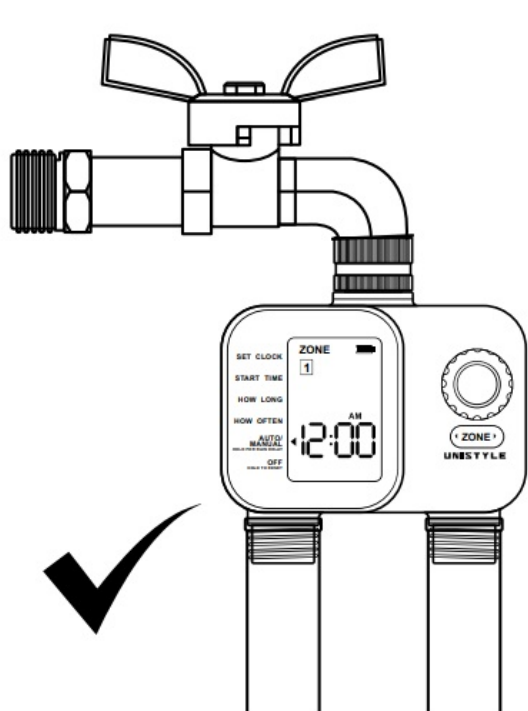

Note:

- When programming the timer, turn off the faucet so that it doesn't get wet.
- Do not use tools on timers. Tighten only with your hands.

- Batteries that run out or run out of power must be removed from the timer and disposed of properly.
- Under the environment temperature below 3°C. The timer should be removed to avoid freezing damage.
- To extend the life of the timer, keep the filter clean and in place when using the timer.

Local Mode Settings

Next are the operating instructions for Smart Mode. If you want to obtain local mode operation instructions, please scan the QR code for detailed guidelines.



Timer Settings in Smart Mode

Step 1

Install The “Smart Life” App

1. Search “smart Life” on the APP Store or Google Play. Or scan the QR code and download the free Android or ios APP, then install the APP.



2. Open the Smart Life APP, select “sign up” . Follow the prompts to register a Smart Life account with your email account or mobile number.If you have
3. If you have already installed the Smart Life App, go to step 2.



Step 2

Gateway Connection

1. Press and hold the button 2151 on the gateway until its LED indicator flashes (twice per\ second).
2. Turn on your phone’s Bluetooth and WiFi, then tap “Add Device” to automatically scan for the gateway.

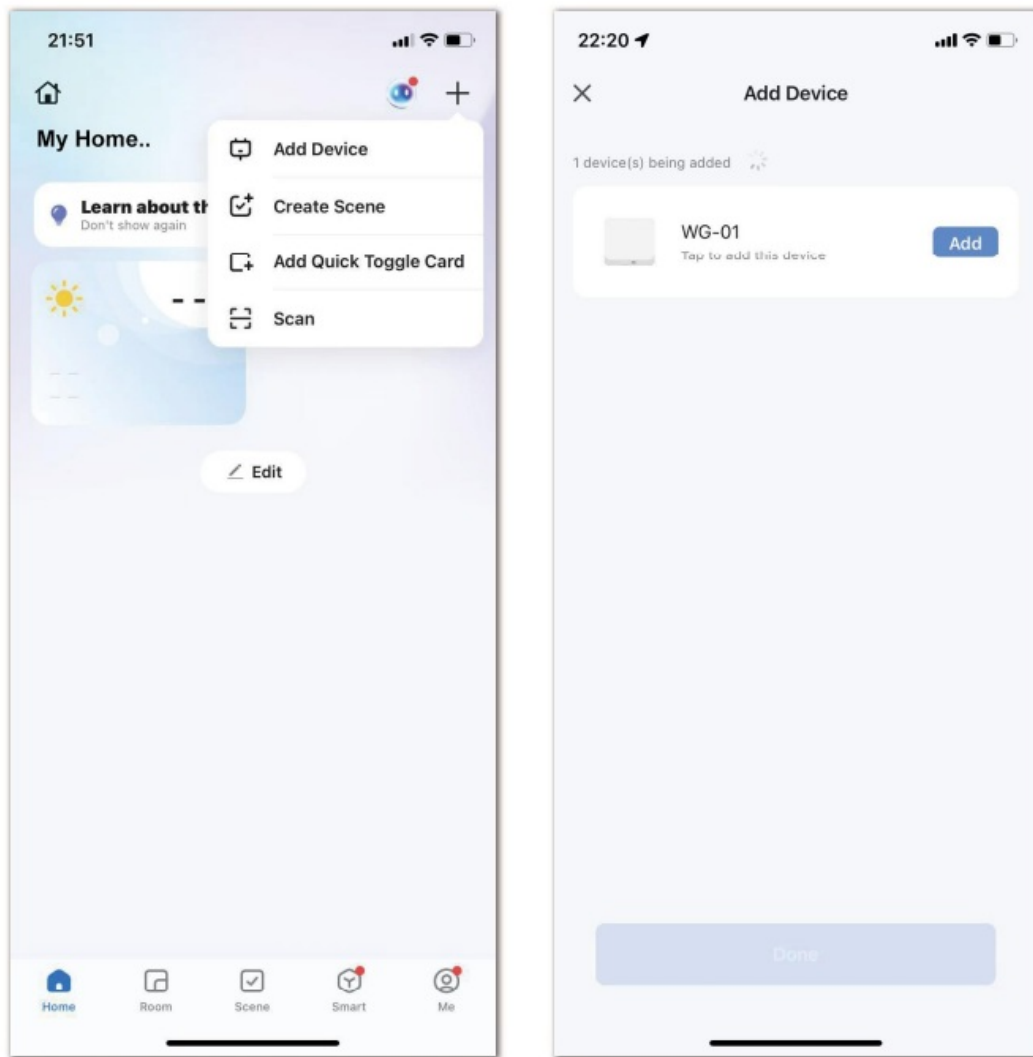

3. Tap the gateway icon, enter your Wi-Fi details (supports 2.4 GHz Wi-Fi only), wait for the connection to reach 100%, and verify the gateway is successfully added.

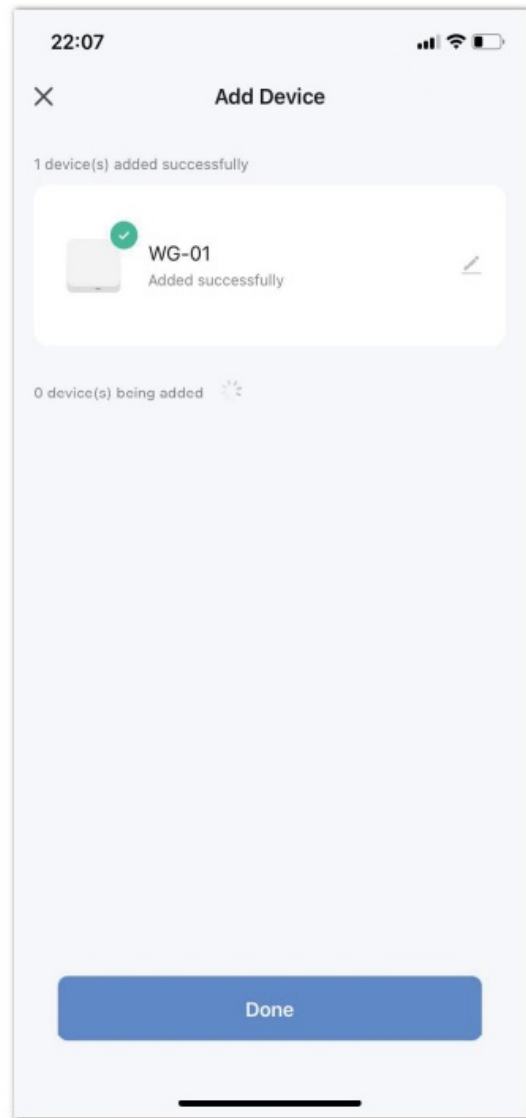
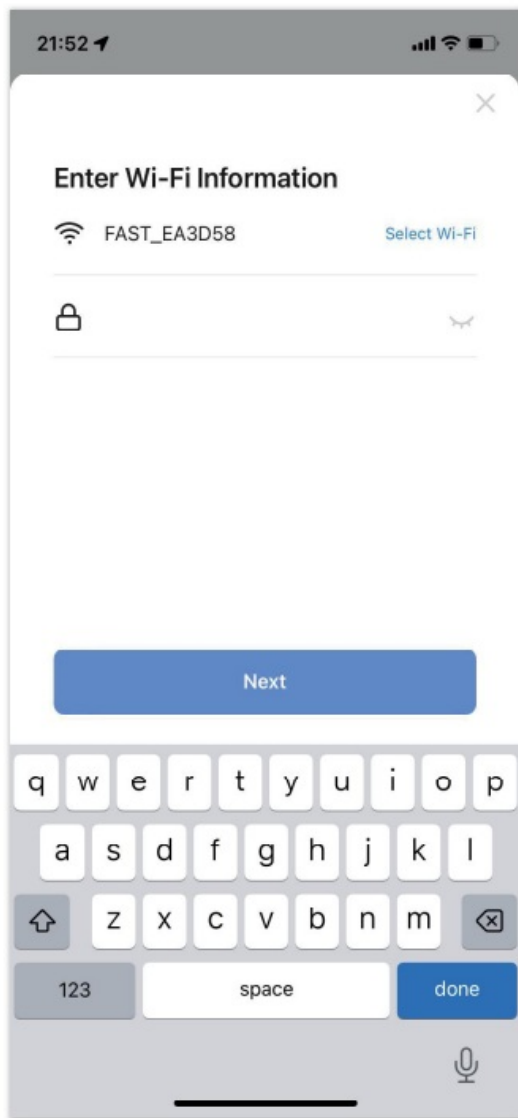

Note:

This setup only supports 2.4 GHz Wi-Fi. If your router is dual-band, enable the 2.4 GHz band separately and assign it a different name from the 5 GHz band.

Gateway LED Indicator Status:

1. Pairing Status: Green LED blinks slowly.
2. Wi-Fi Connected: Green LED is constantly on.
3. No Function: No light.

Step 3

Timer Connection

1. Rotate the knob to align the pointer with OFF, then press and hold the Confirm button for 3 seconds until the screen displays “BLE/LD” alternately.

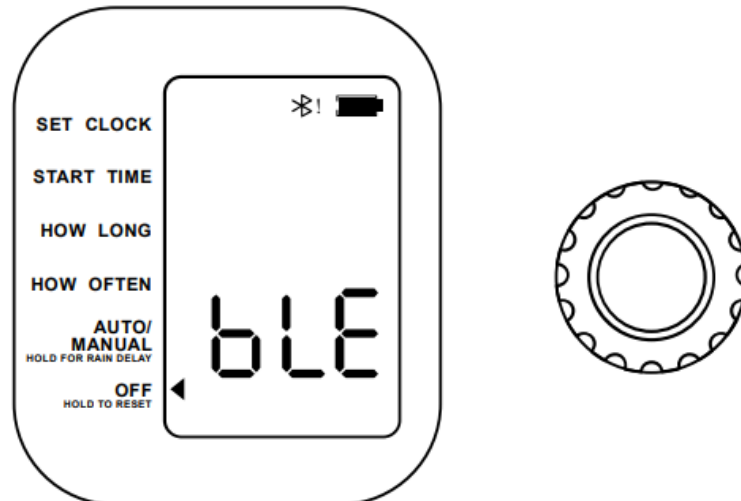

2. In this mode, use the knob to select between BLE/LD, then press the Confirm button briefly to confirm.
3. Select BLE with the knob, press the Confirm button briefly to confirm, then hold the Confirm button for 3 seconds to enter pairing mode (the Bluetooth icon will blink).



4. Return to the app's main\ interface and tap the gateway you just connected.
5. Once the Bluetooth icon blinks, pairing starts automatically. If already paired, the device will reconnect directly to the gateway without requiring re-pairing.

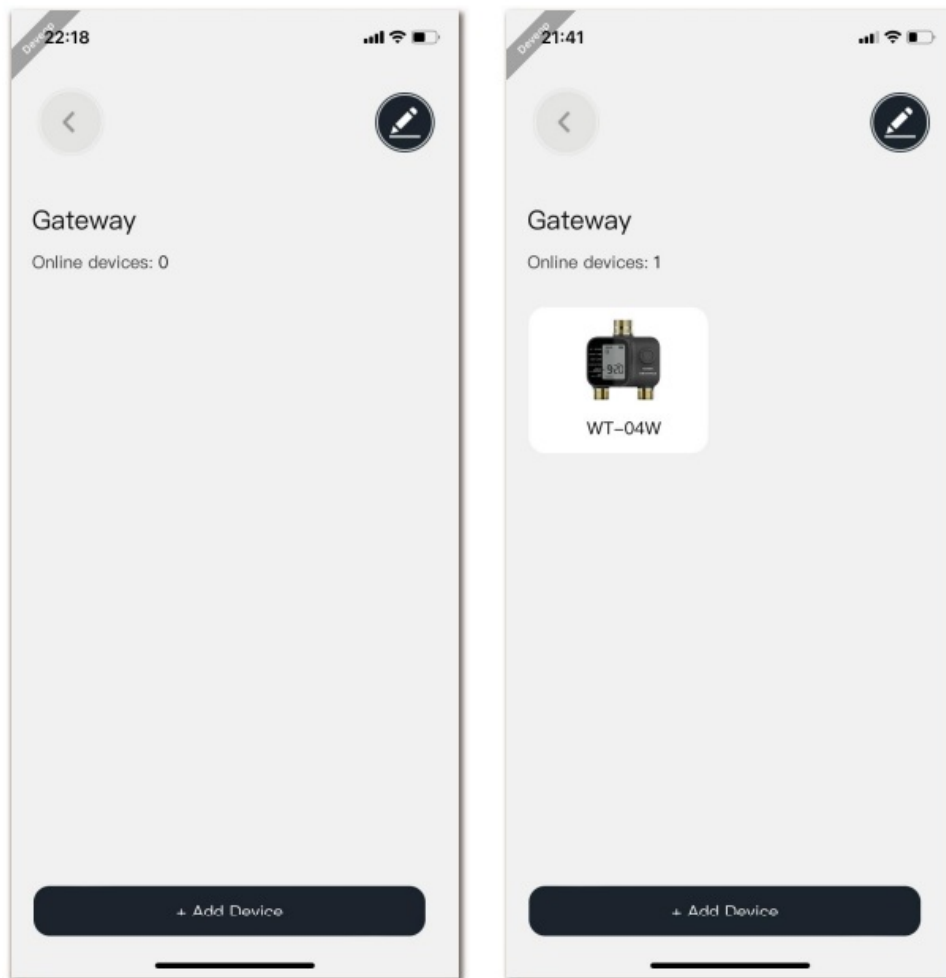

6. Once connected, the Bluetooth icon on the timer will light up. After a period of inactivity, Bluetooth will enter sleep mode, and an exclamation mark will appear on the icon. This doesn't indicate disconnection – the device will wake up and execute commands when operated.
7. If the timer is not detected within 1 minute, the pairing mode will exit automatically.



8. To reconnect, press and hold the Confirm button for 3 seconds until the Bluetooth icon blinks, then repeat the pairing steps.
9. If the gateway-timer connection drops mid-use, the timer's Bluetooth will attempt automatic reconnection.



10. To return to the local mode, turn OFF the Bluetooth mode, jump back to the BLE/LD icon through the “knob”, select the “LD” icon and press the “Confirm” button to return to the OFF state.

Note:

- SETCLOCK: Sync APP time
- HOW OFTEN: 1DAY

- STARTTIME: AM6:30
- HOWLONG: 10MINS
- AUTO/Manual:10M I NS

Step 4

Operating Instructions In App

Tap “RF Water Timer” on Home screen device list/ Sub-GHz Gateway screen, and enter into RF Water Timer screen

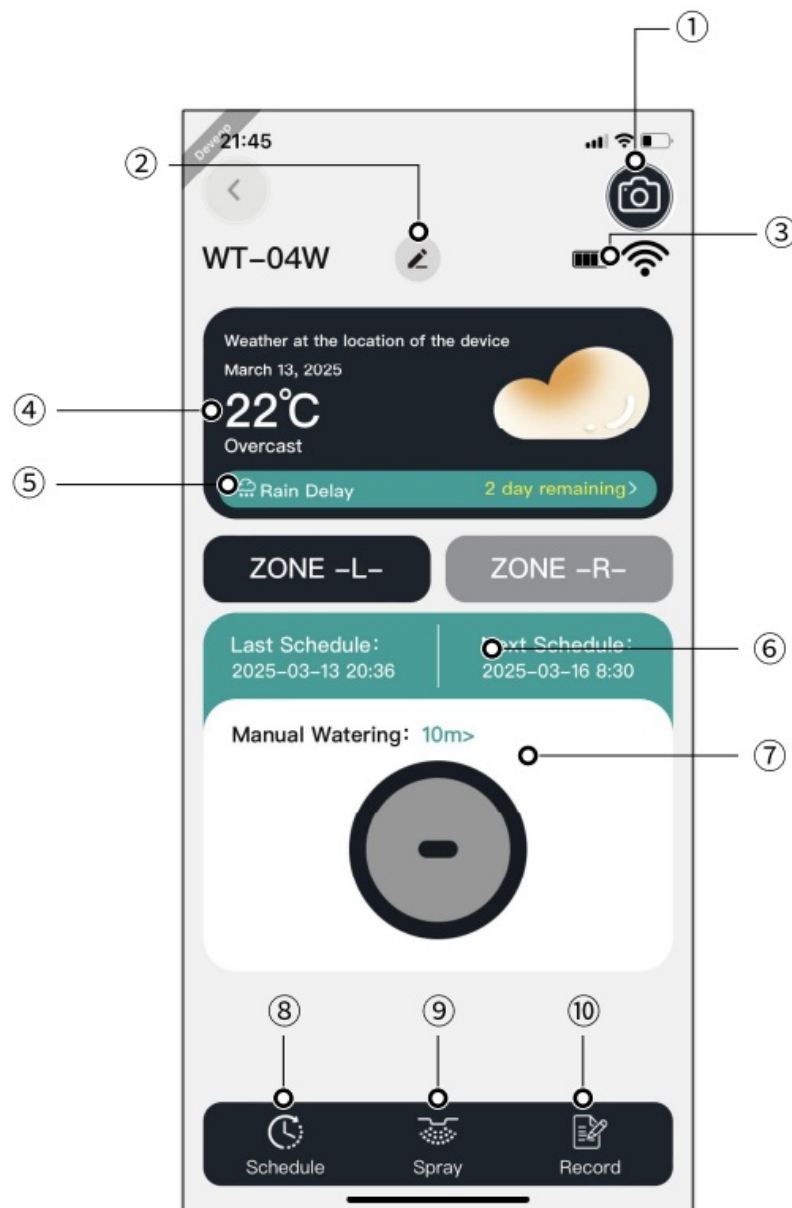

1. Photo Capture: Take a photo or select one from your phone's album to log the current location.
2. For additional information about the Water Timer, tap “icon”.

3. Battery power. If low, change with new alkaline batteries.
4. Tap to view the weather forecast for the upcoming week.
5. Weather Delay:
 1. Tap “Rain Delay” to the setting page.
 2. Set 1-7 delay, cancel or Smart Weather.
 3. Tap “⊗” on the top left corner.

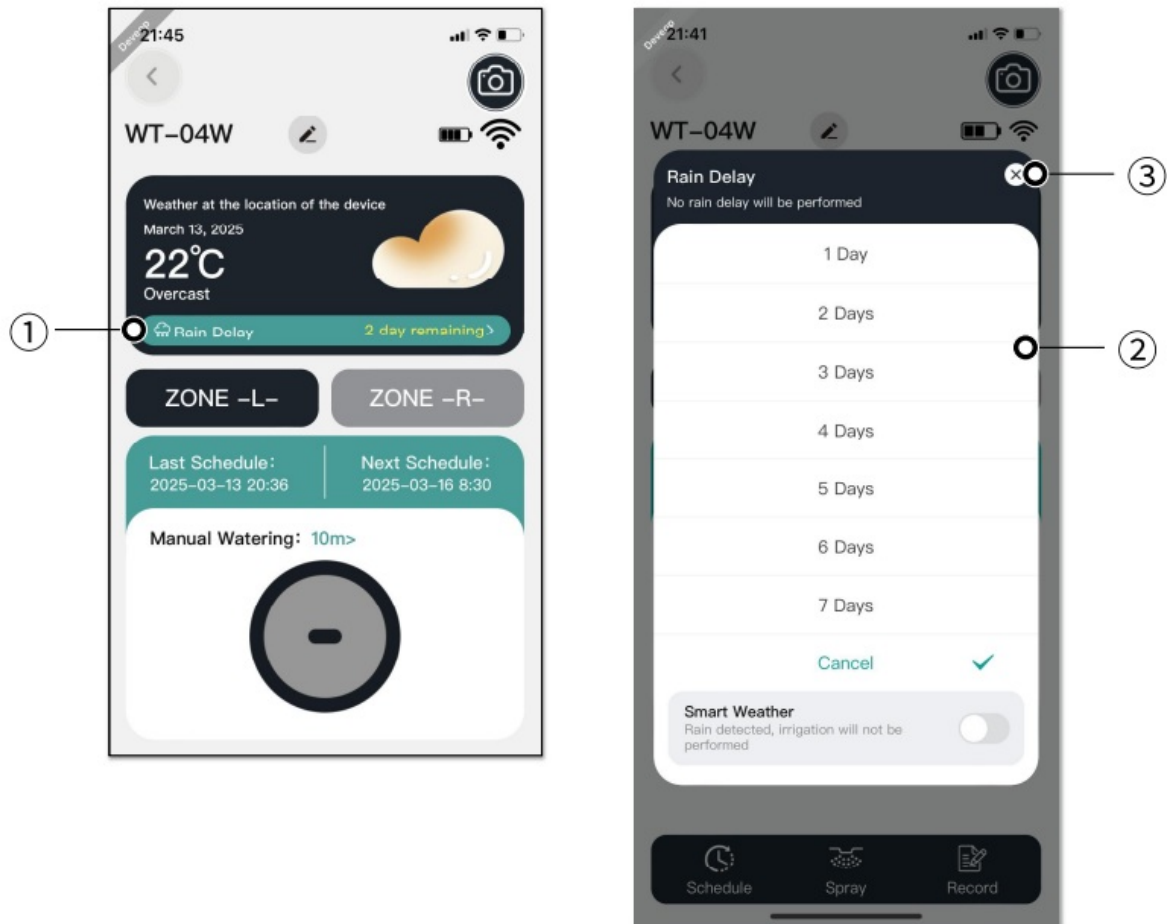

Manual watering:

1. Tap “Manual watering” to the setting page.
2. Use the wheels to set the desired hour, minute and second.
3. Tap “Save” to confirm your setting.
4. Go back by tapping “<” on the top left corner.
5. Tap “⊖” to start the Manual Watering.

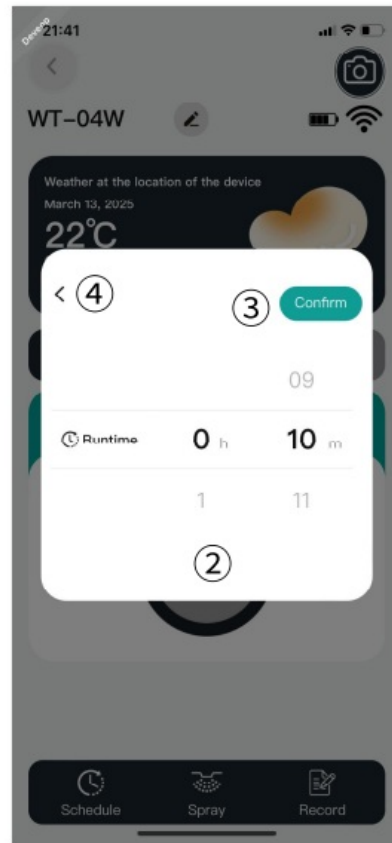
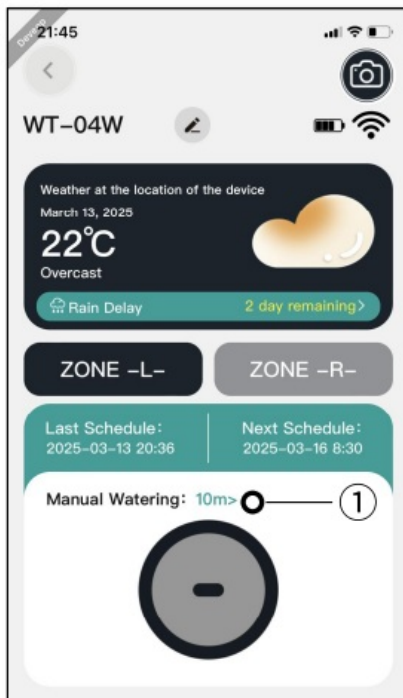

Schedule:

1. Tap "Schedule" and enter the "Add" page.
2. Tap "Add" to enter the content setting page.
3. Set start time, runtime and loop/ single time.
4. Tap "Save" on the top right conner.

Tap "icon" to go back to the "Add" page, the on-off button on the right side of the plan will be green, indicating it has been set successfully.

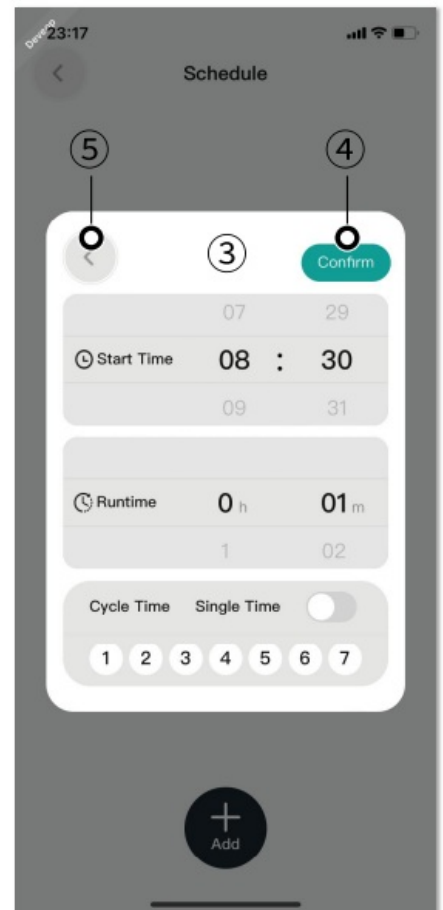
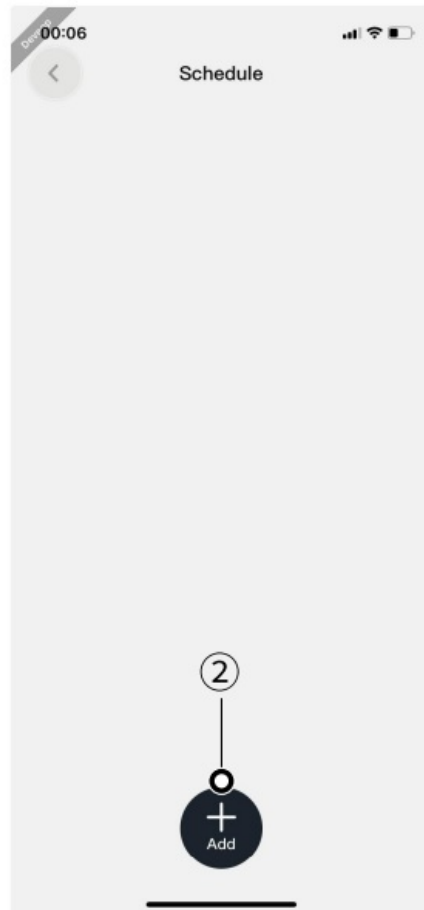
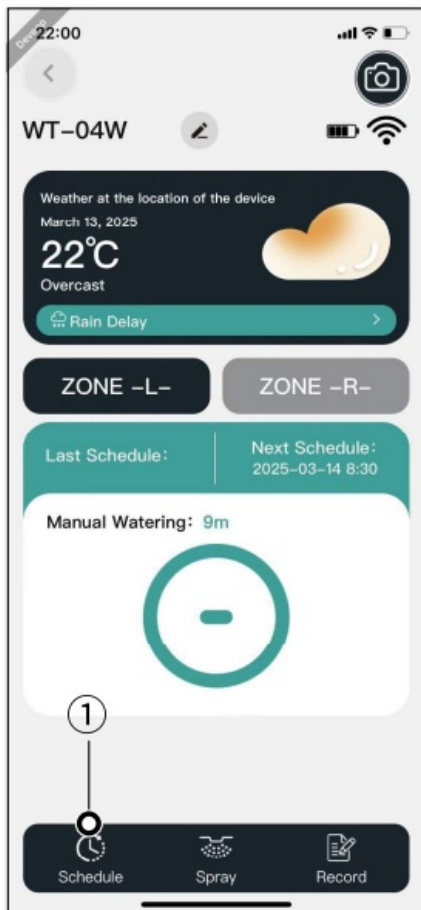

Spray:

1. Tap “Spray” and enter the content setting page.
2. Set start time, end time, spray duration, interval duration and loop/ single time.
3. Tap the “Enable” button to green.
4. Tap ” < ” on the top left corner.

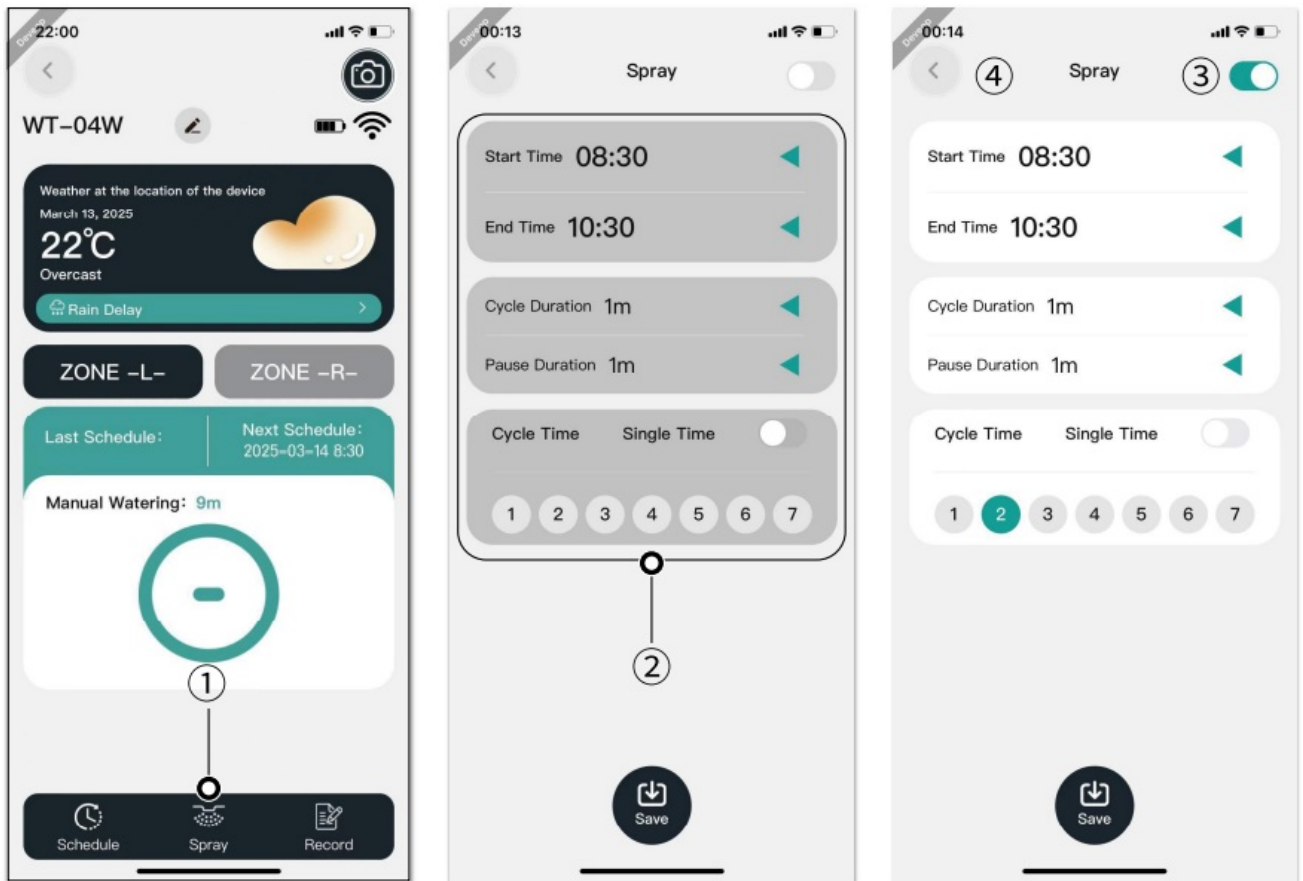

Record: You can view the watering records from the past days.

Cleaning Up Water Timer

After a period of use, impurities or dirt in the water may accumulate inside the timer. Therefore, the timer should be cleaned regularly to ensure its normal operation.

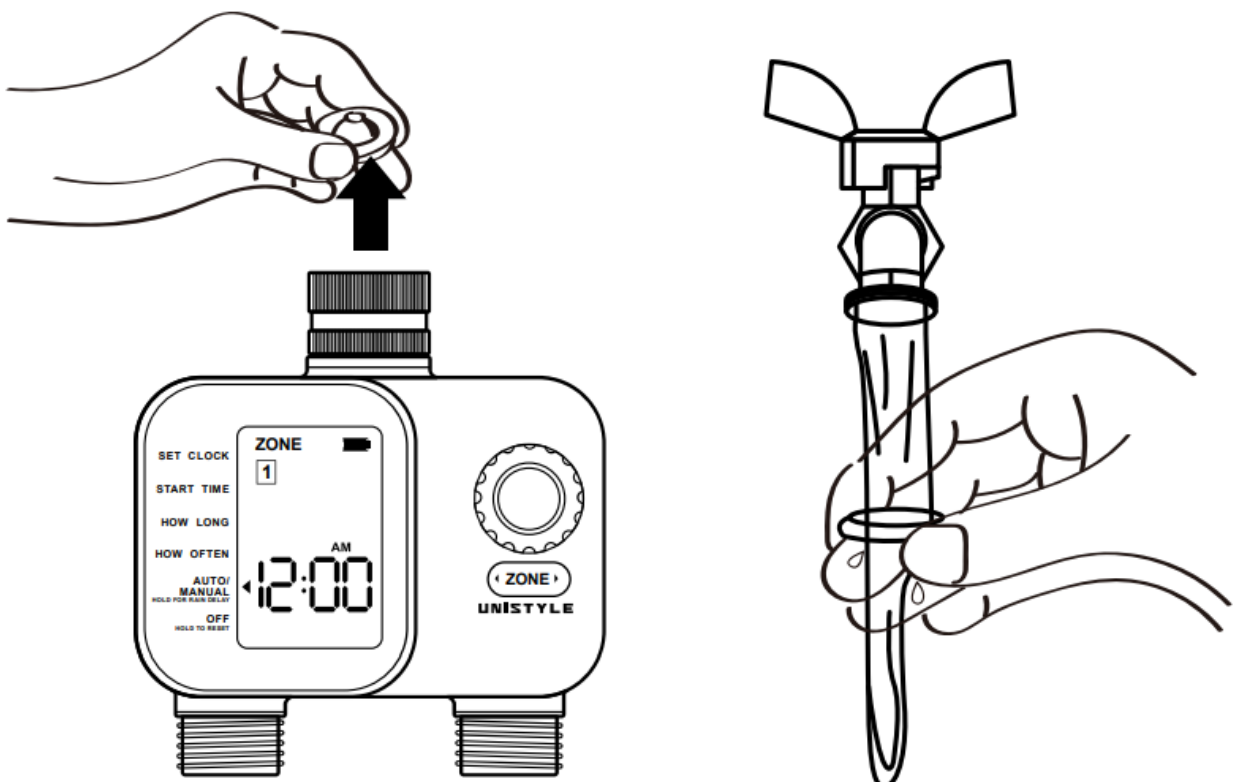

Follow the steps below to clean the timer:

1. Turn off the garden faucet and remove the timer. Check the timing water inlet filter for impurity accumulation.
2. If the filter element is dirty, remove it from the timer and rinse it with running water.
3. Turn on the manual watering mode of the timer, open the valve, and check whether the timer water pipe is blocked. If it is blocked, gently clean it with a small cleaning brush.

Troubleshooting

The timer is not watered according to the preset, and the inspection method is as follows:

- Whether the dial is in “AUTO” mode. Whether the faucet is on.
- Whether the time is set correctly.
- Whether the start watering time, watering duration, watering interval time is correct.
- Whether the delayed watering is turned on.

Check whether the water pipe connection is leaking as follows:

- Whether the timer filter and water pipes are installed correctly.
- Whether the faucet or hose is 3/4" NH threaded.
- Whether the faucet or hose is 3/4" BSP threaded.
- Whether the water pressure is 7.25-116 PSI {0.5-8 BAR}.

The timing valve cannot be opened/closed, and the reset valve is as follows:

- Install the timer to the faucet and turn the faucet to the maximum.
- Turn on the watering manually, at least 5 seconds, and let it turn off automatically; repeat 5 times until the water can pass normally.

FCC Statement

FCC Warning

This device complies with part 15 of the FCC Rules. Operation is subject to the following two conditions:

1. This device may not cause harmful interference, and
2. This device must accept any interference received, including interference that may cause undesired operation.

Any Changes or modifications not expressly approved by the party responsible for compliance could void the user's authority to operate the equipment.

Note: This equipment has been tested and found to comply with the limits for a Class B digital device, pursuant to part 15 of the FCC Rules. These limits are designed to provide reasonable protection against harmful interference in a residential installation. This equipment generates uses and can radiate radio frequency energy and, if not installed and used in accordance with the instructions, may cause harmful interference to radio communications. However, there is no guarantee that interference will not occur in a particular installation. If this equipment does cause harmful interference to radio or television reception, which can be determined by turning the equipment off and on, the user is encouraged to try to correct the interference by one or more of the following measures:

- Reorient or relocate the receiving antenna.
- Increase the separation between the equipment and receiver.
- Connect the equipment into an outlet on a circuit different from that to which the receiver is connected.
- Consult the dealer or an experienced radio/TV technician for help.

This equipment complies with FCC radiation exposure limits set forth for an uncontrolled environment. This equipment should be installed and operated with minimum distance 20cm between the radiator & your body.

FAQ

Question 1: After installing the battery, the LCD does not display anything.

Answer 1: The 2 batteries are loaded with new I.SV AA alkaline batteries, please make

sure the batteries are properly placed in the battery compartment.

Question 2: The water does not turn on at the pre-set time.

Answer 2: Check if.

1. The clock should be set to the correct time.
2. Set the start time to the desired time.
3. Delayed rain mode is on.
4. Turn on the shutdown mode.
5. The battery is insufficient.
6. The faucet is off.

Question 3: Hose faucet connection/water outlet leakage.

Answer 3: Check if.

1. The O-ring is connected correctly to the hose.
2. The connected water outlet or the water pipe is broken.
3. The thread of the faucet and the water pipe are not the same.
4. If necessary, use a suitable adapter or Teflon tape.

Documents / Resources

	UNISTYLE WG-01 Bluetooth Water Timer Gateway [pdf] Instruction Manual WG-01, WG-01 Bluetooth Water Timer Gateway, Bluetooth Water Timer Gateway, Water Timer Gateway, Gateway
---	--

References

- [User Manual](#)

Leave a comment

Your email address will not be published. Required fields are marked *

Comment *

Name

Email

Website

☐ Save my name, email, and website in this browser for the next time I comment.

Post Comment

Search:

e.g. whirlpool wrf535swhz

Search

[Manuals+](#) | [Upload](#) | [Deep Search](#) | [Privacy Policy](#) | [@manuals.plus](#) | [YouTube](#)

This website is an independent publication and is neither affiliated with nor endorsed by any of the trademark owners. The "Bluetooth®" word mark and logos are registered trademarks owned by Bluetooth SIG, Inc. The "Wi-Fi®" word mark and logos are registered trademarks owned by the Wi-Fi Alliance. Any use of these marks on this website does not imply any affiliation with or endorsement.