

UNISTATION Electrically Height Adjustable Desk Instruction Manual

[Home](#) » [UNISTATION](#) » UNISTATION Electrically Height Adjustable Desk Instruction Manual 

UNISTATION Electrically Height Adjustable Desk

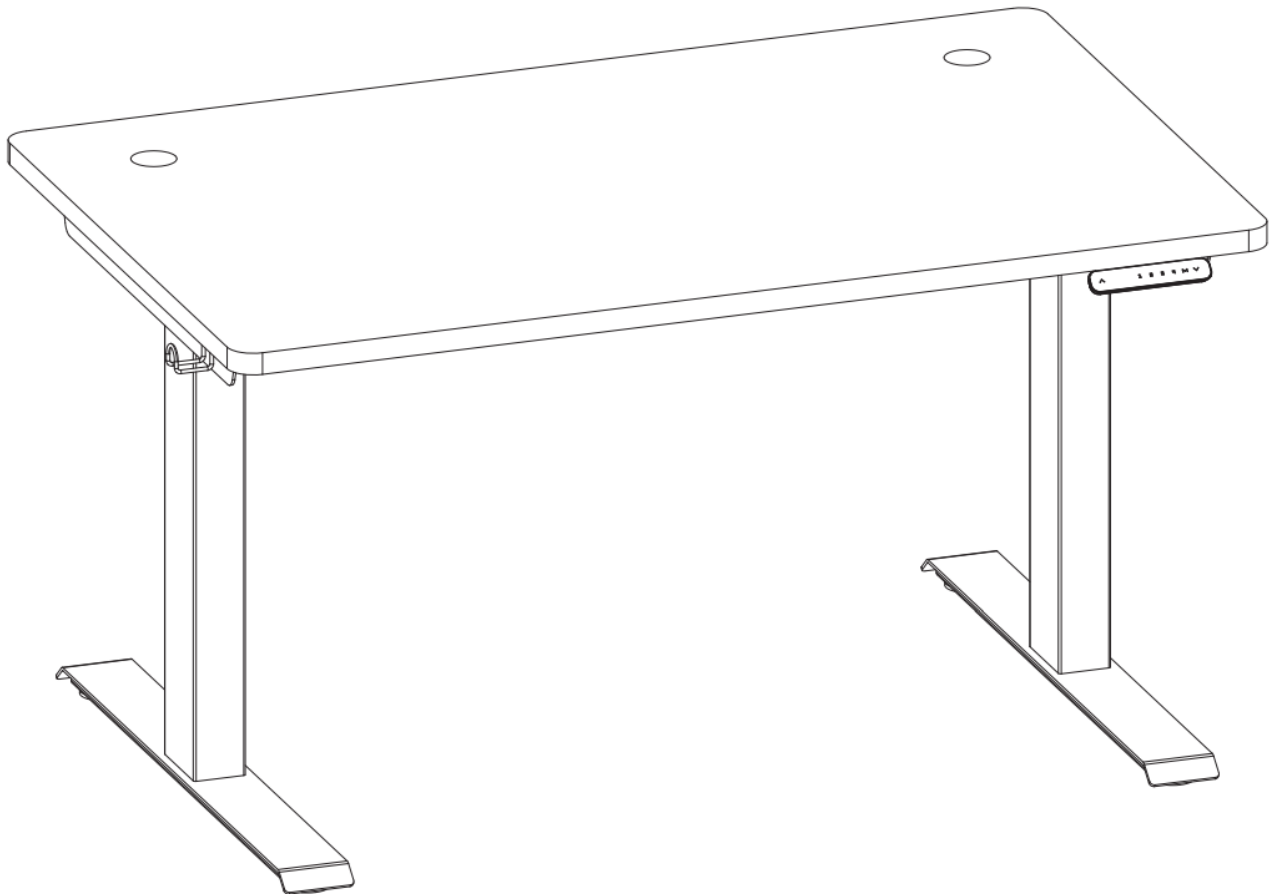

Contents

[1 Caution](#)

[2 Package Contents](#)

[3 Parts](#)

[4 Installation Instructions](#)

[5 Digital Handset Operate
Instruction](#)

[6 Documents / Resources](#)

[7 Related Posts](#)



Caution

- Keep children and animals away from the desk during use.
Ensure the desktop is not touching any walls.
- Remove obstacles taller than 20"/51 cm from underneath the desk.
- Operate only in a working environment temperature of 32°F-104°F/0°C-40°C.
- Keep product away from corrosive gases, liquids and dusty objects.
- Keep hands, feet and other body parts in a safe position during operation. Anti-collision is not automatically enabled during all resets.
- The company does not bear any warranty or liability for damage and human injury caused by any abnormal or un-intended operation of the equipment.
- It is necessary to perform a manual reset after the initial installation or power cycling the equipment.

Package Contents

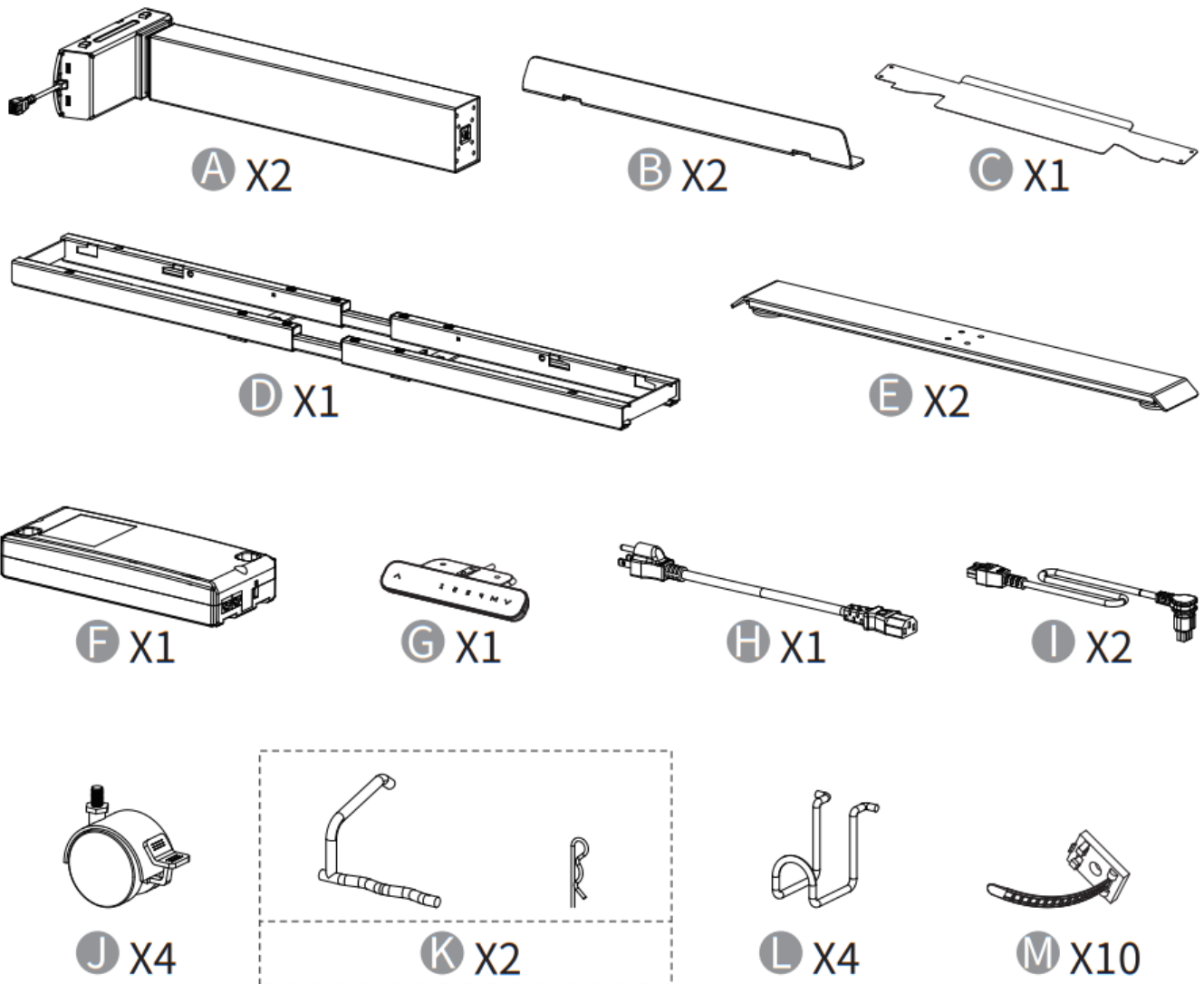

Parts

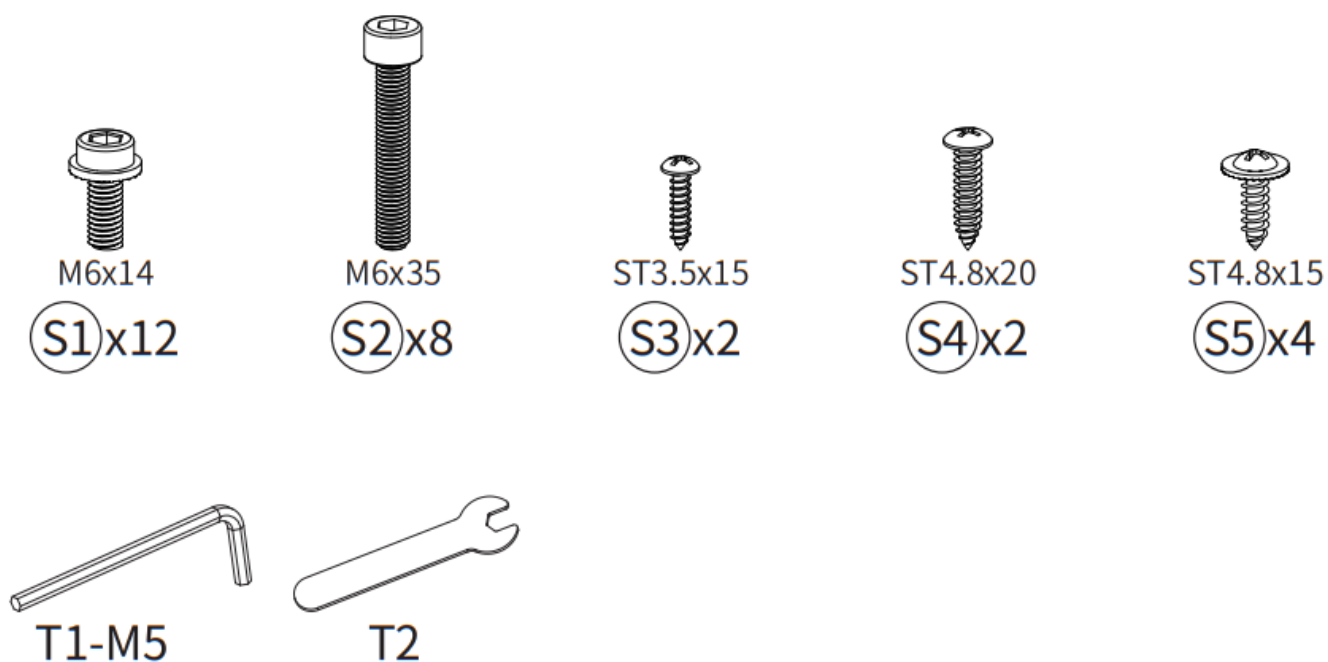

Installation Instructions

1

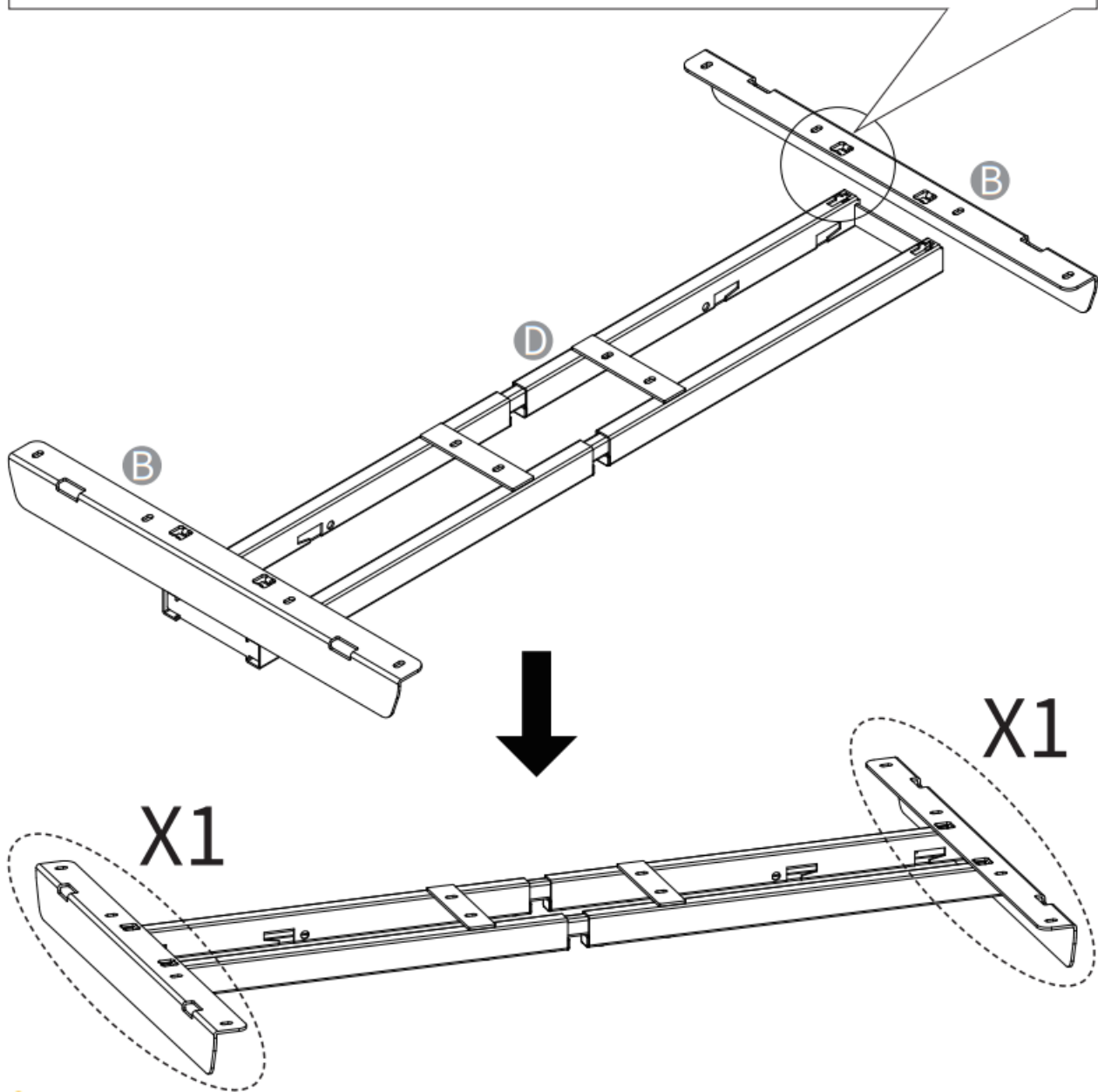
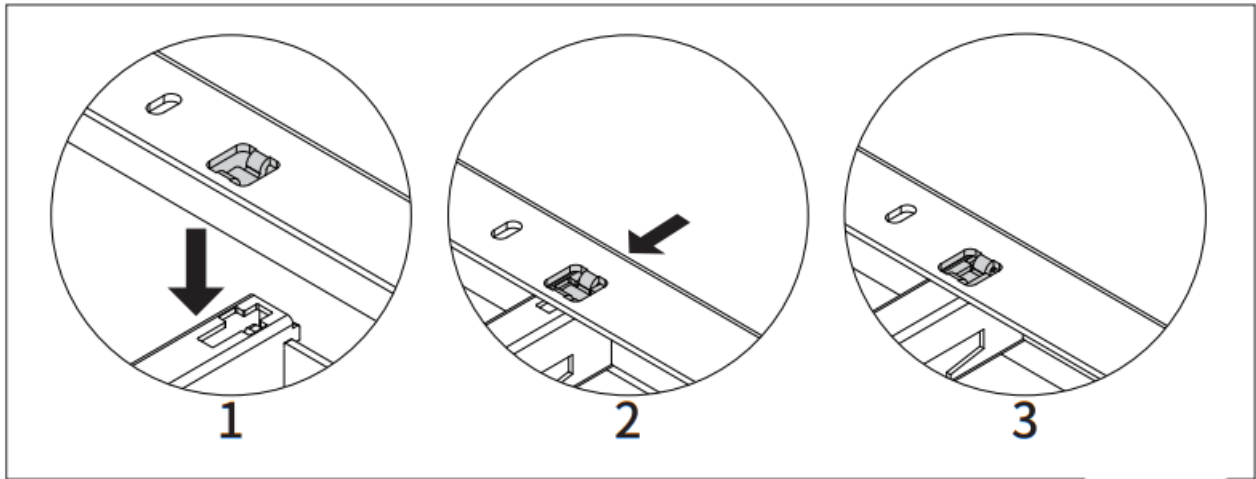

2

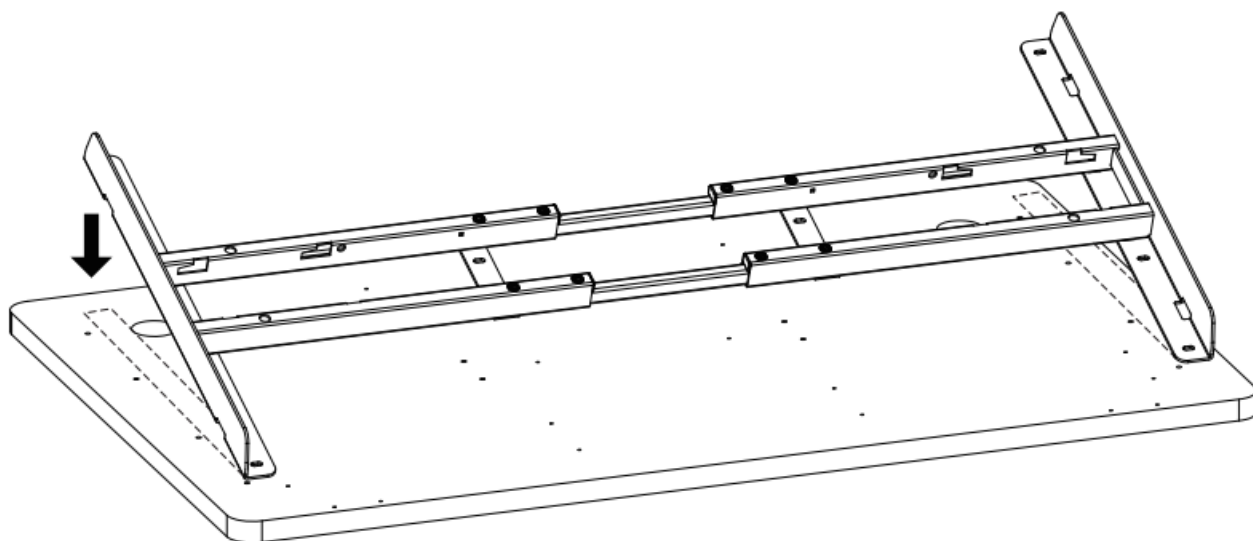

3

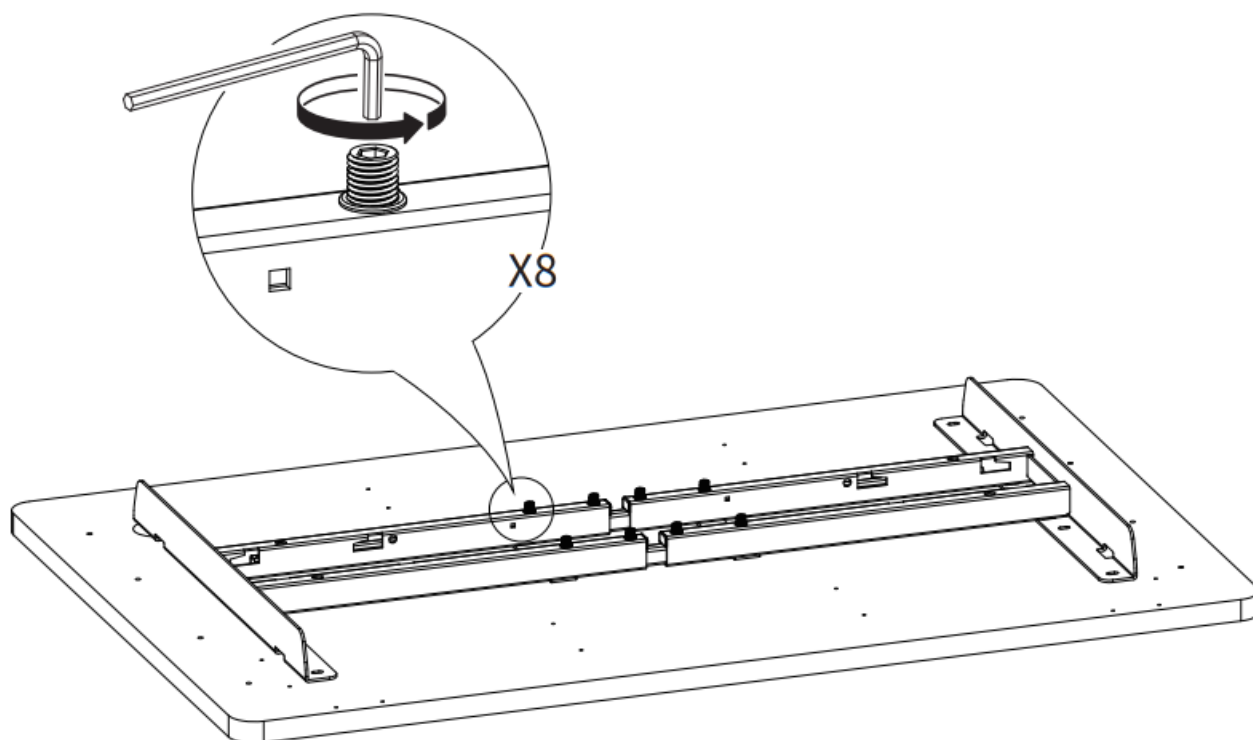

4

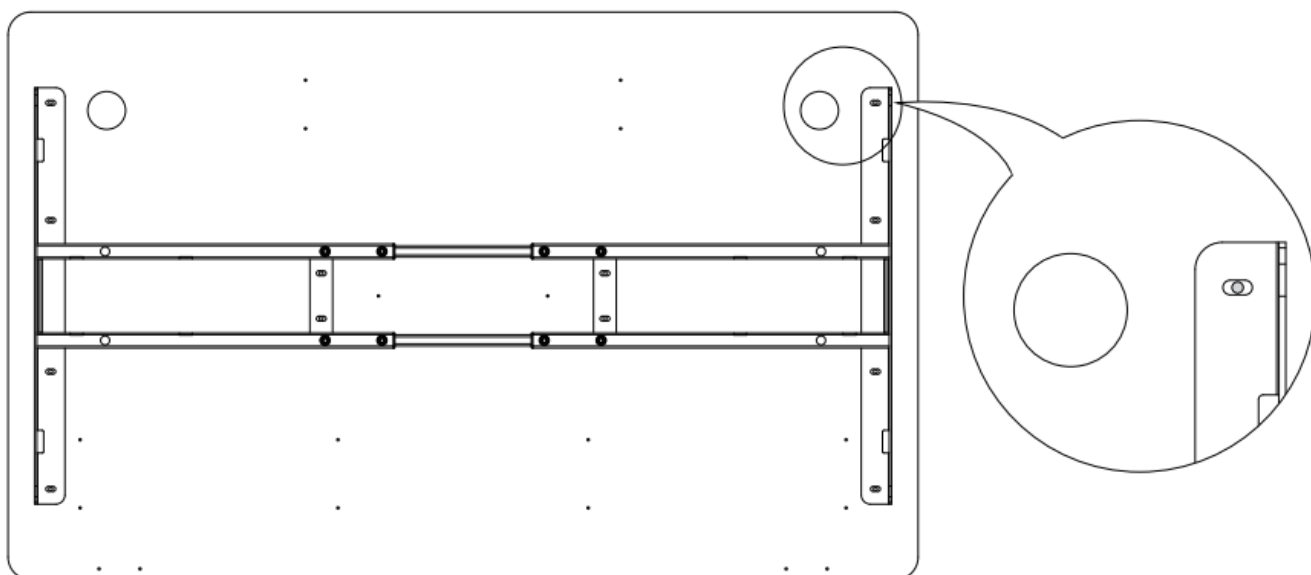
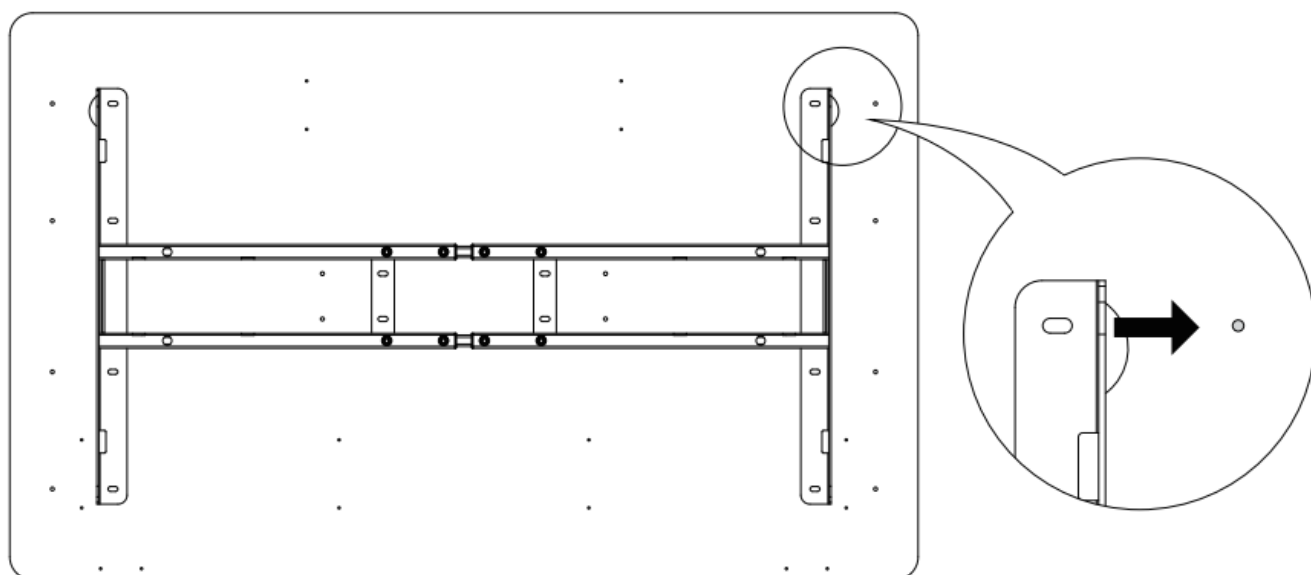

5

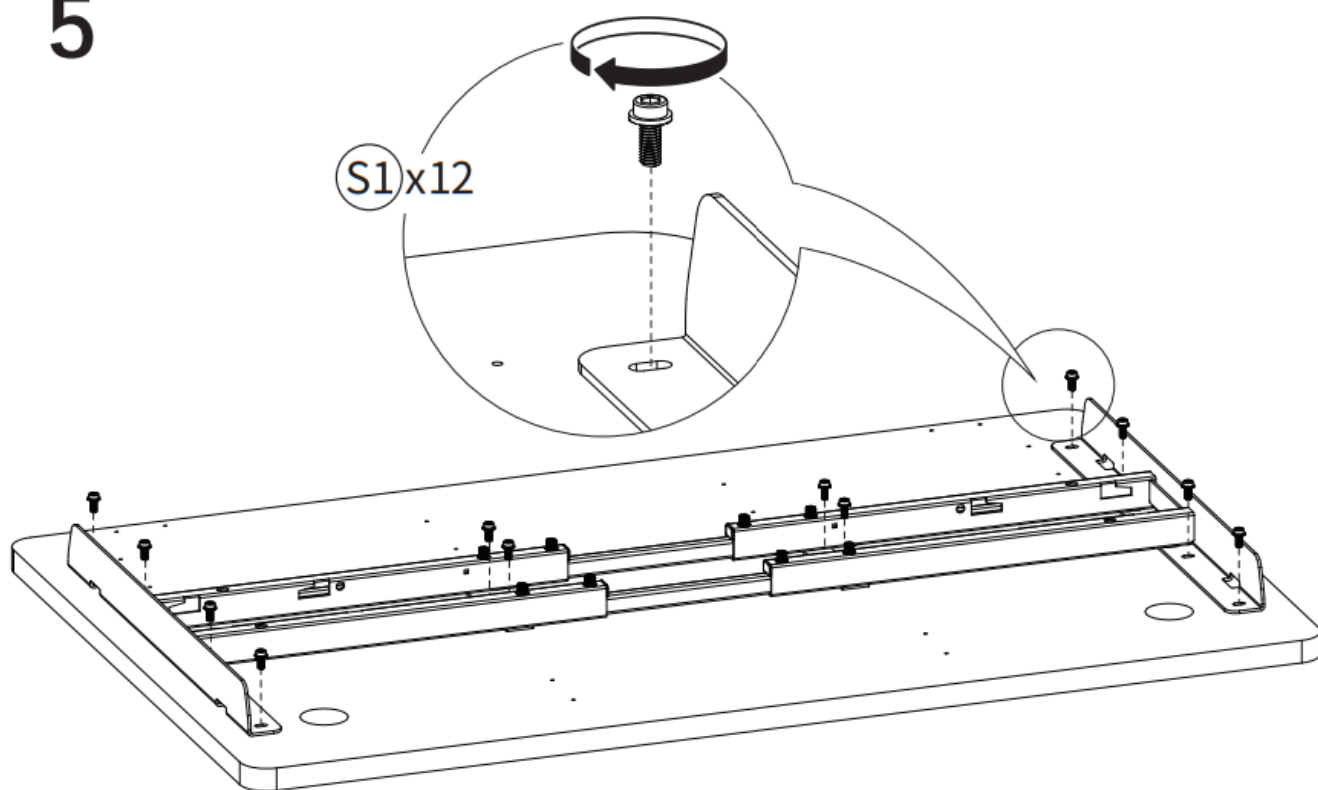

6

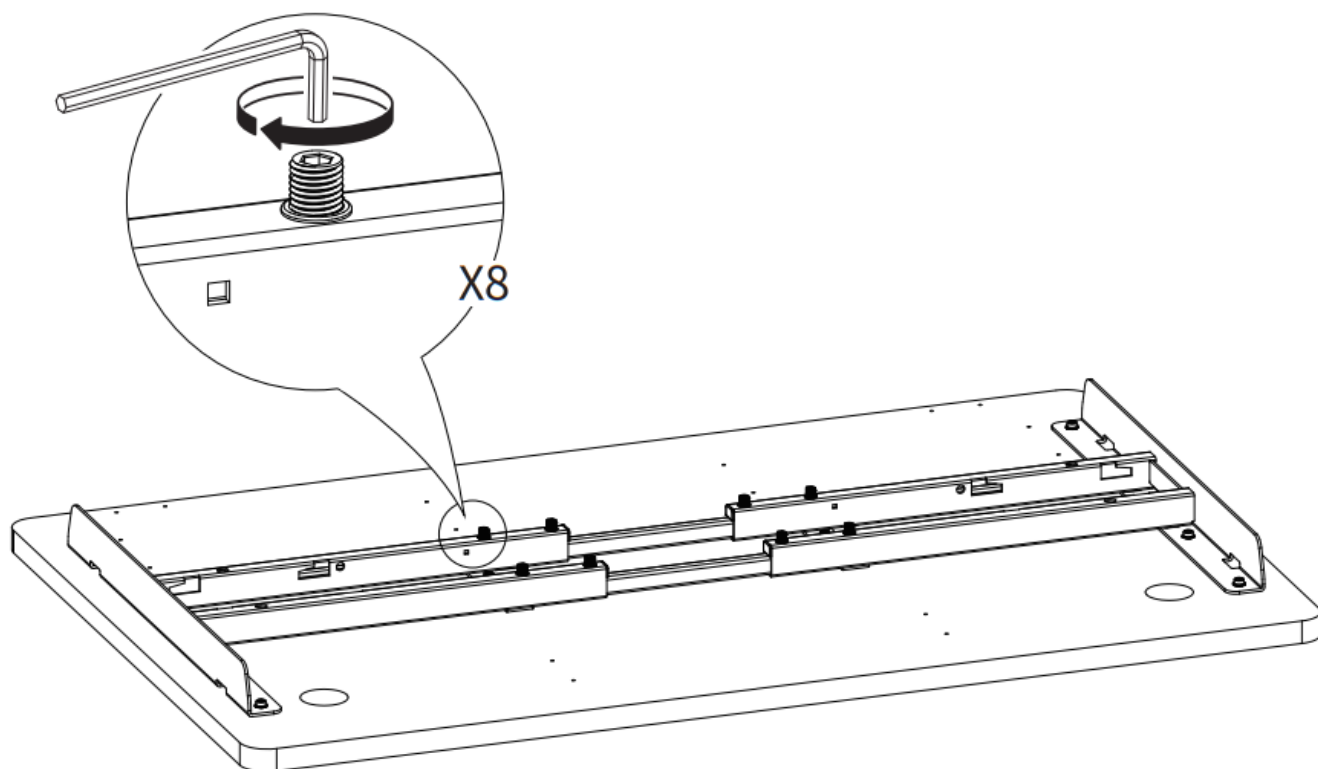

7

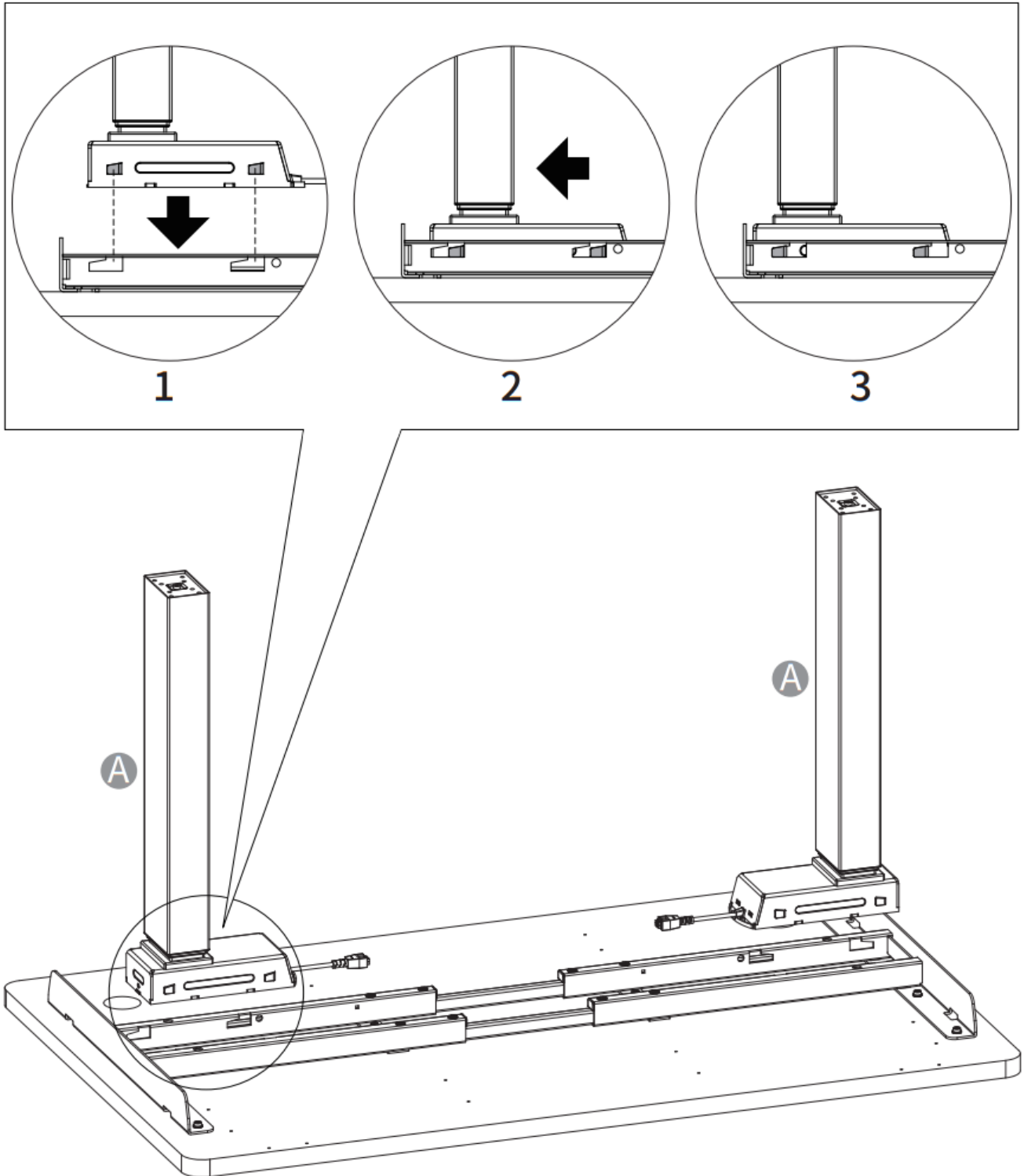

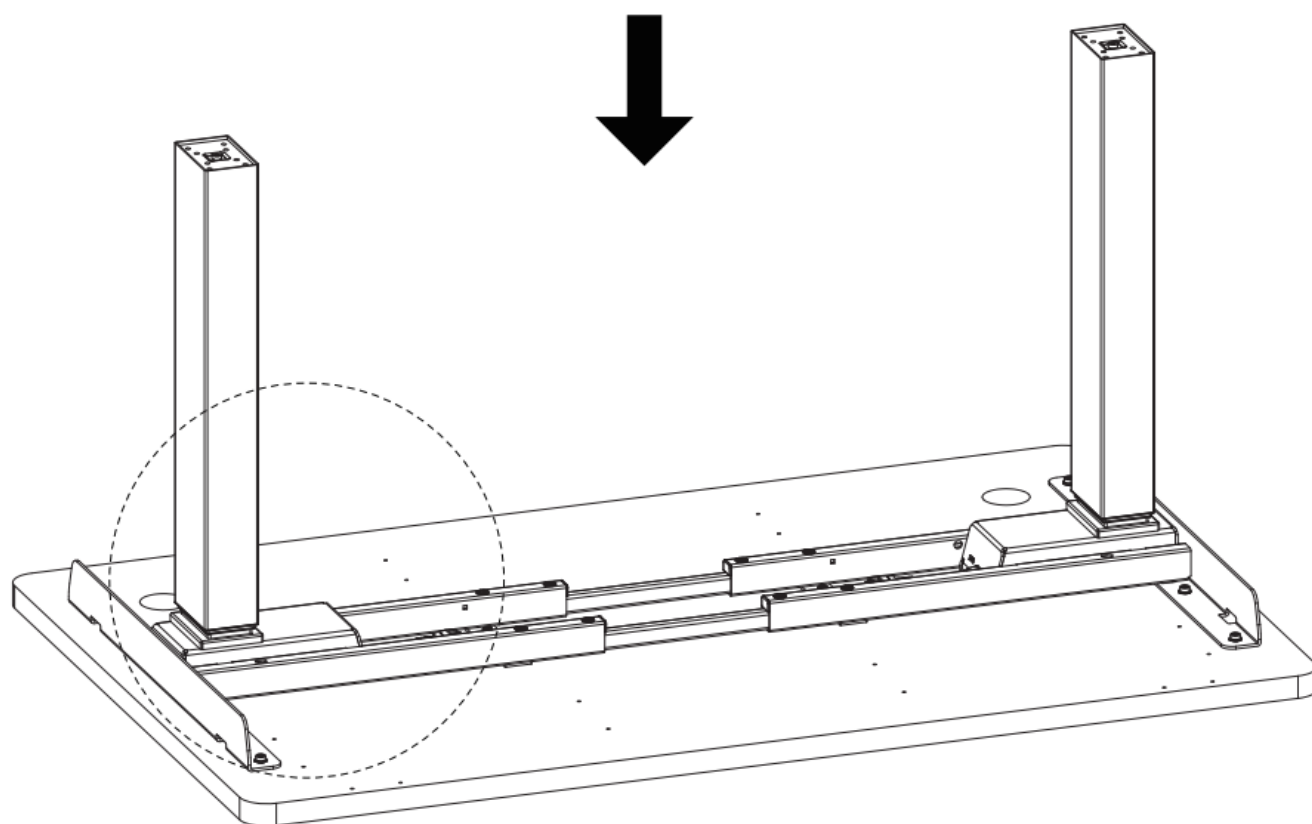
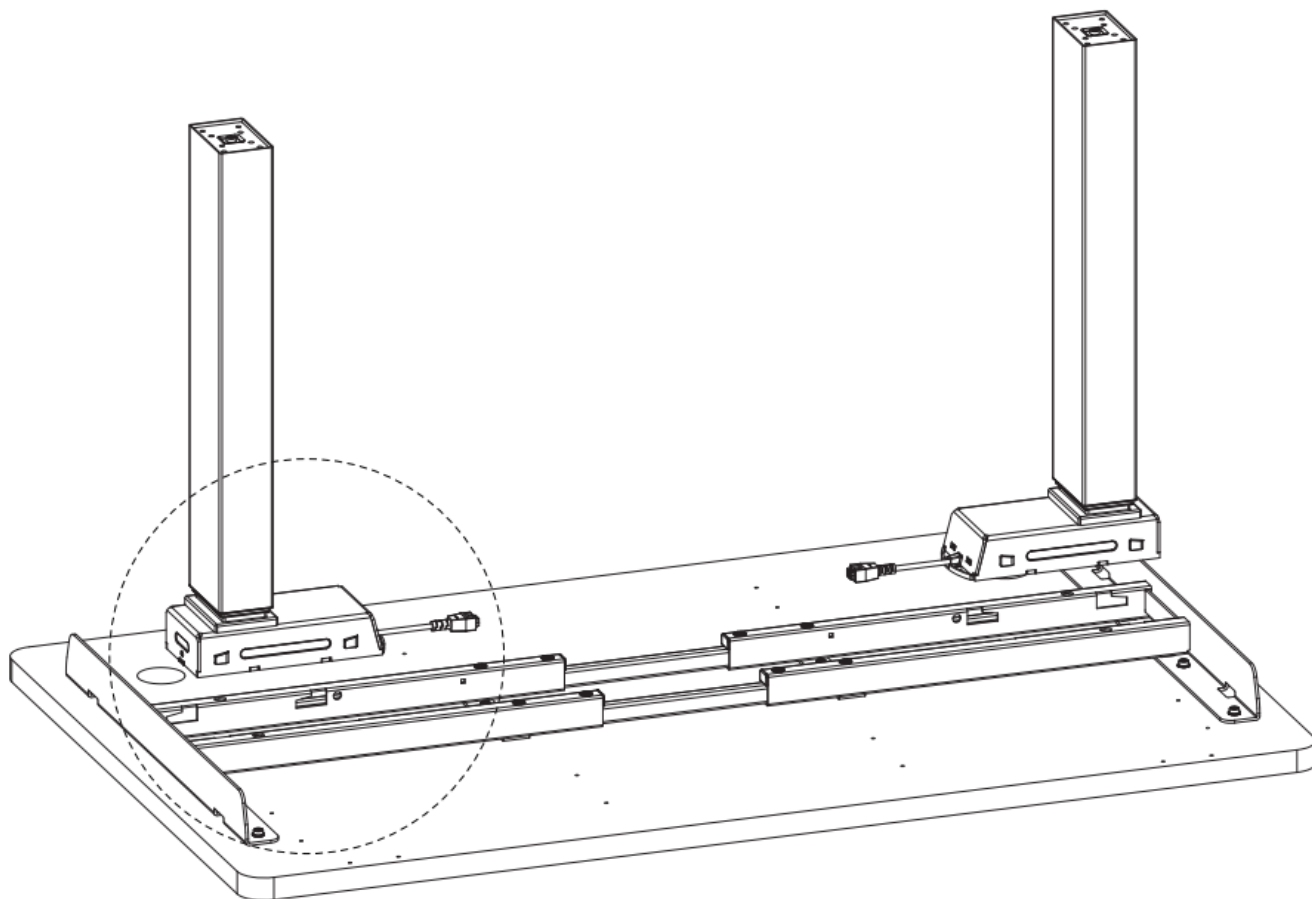

8



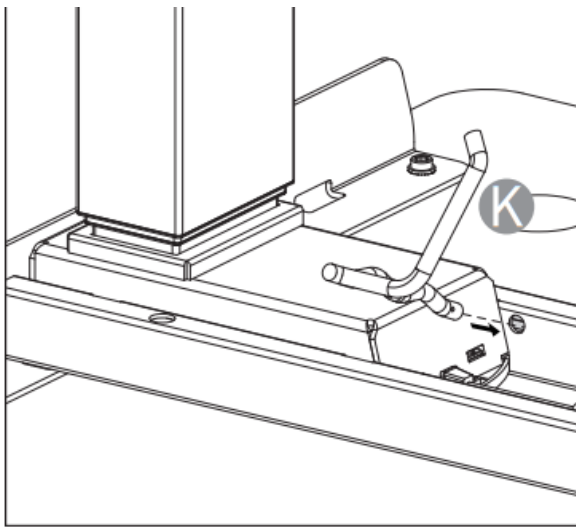

1

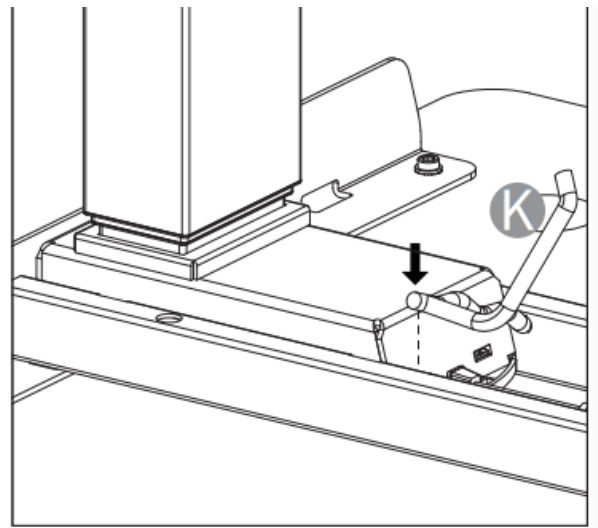

2

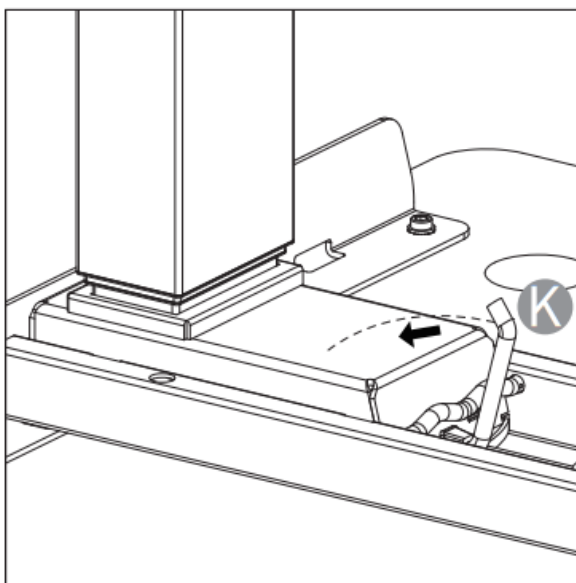

3

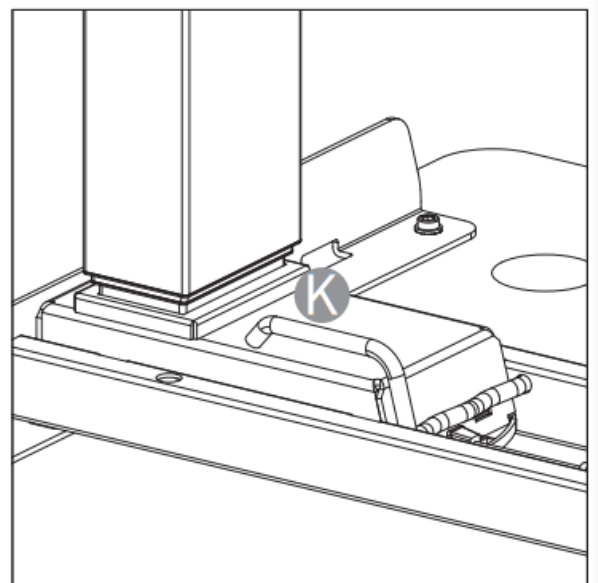

4

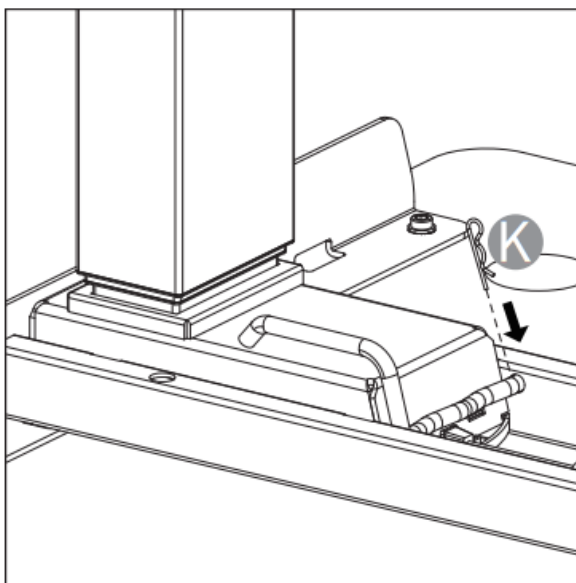

5

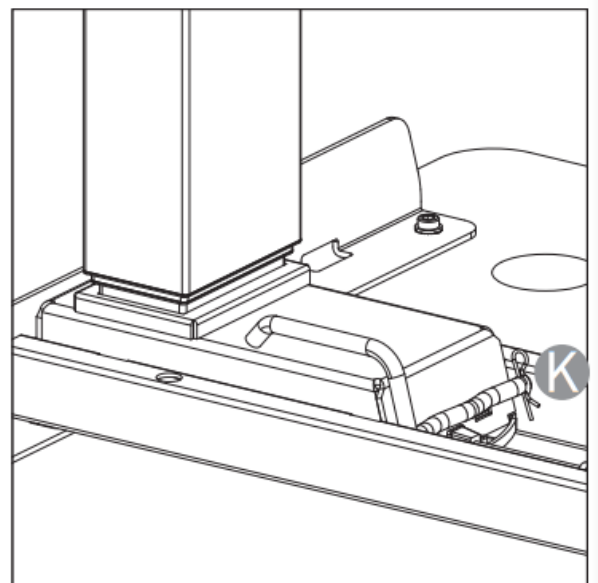

6

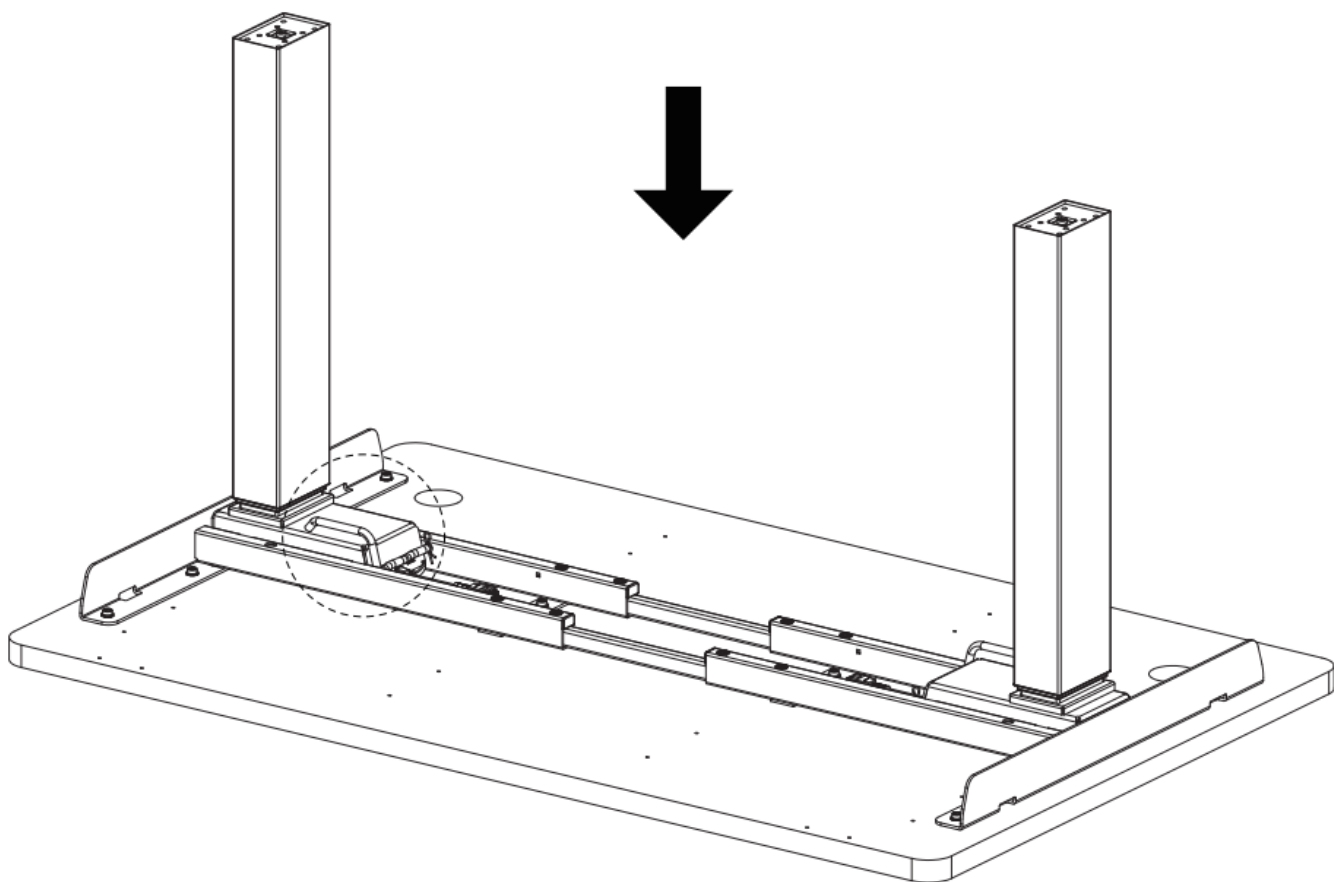
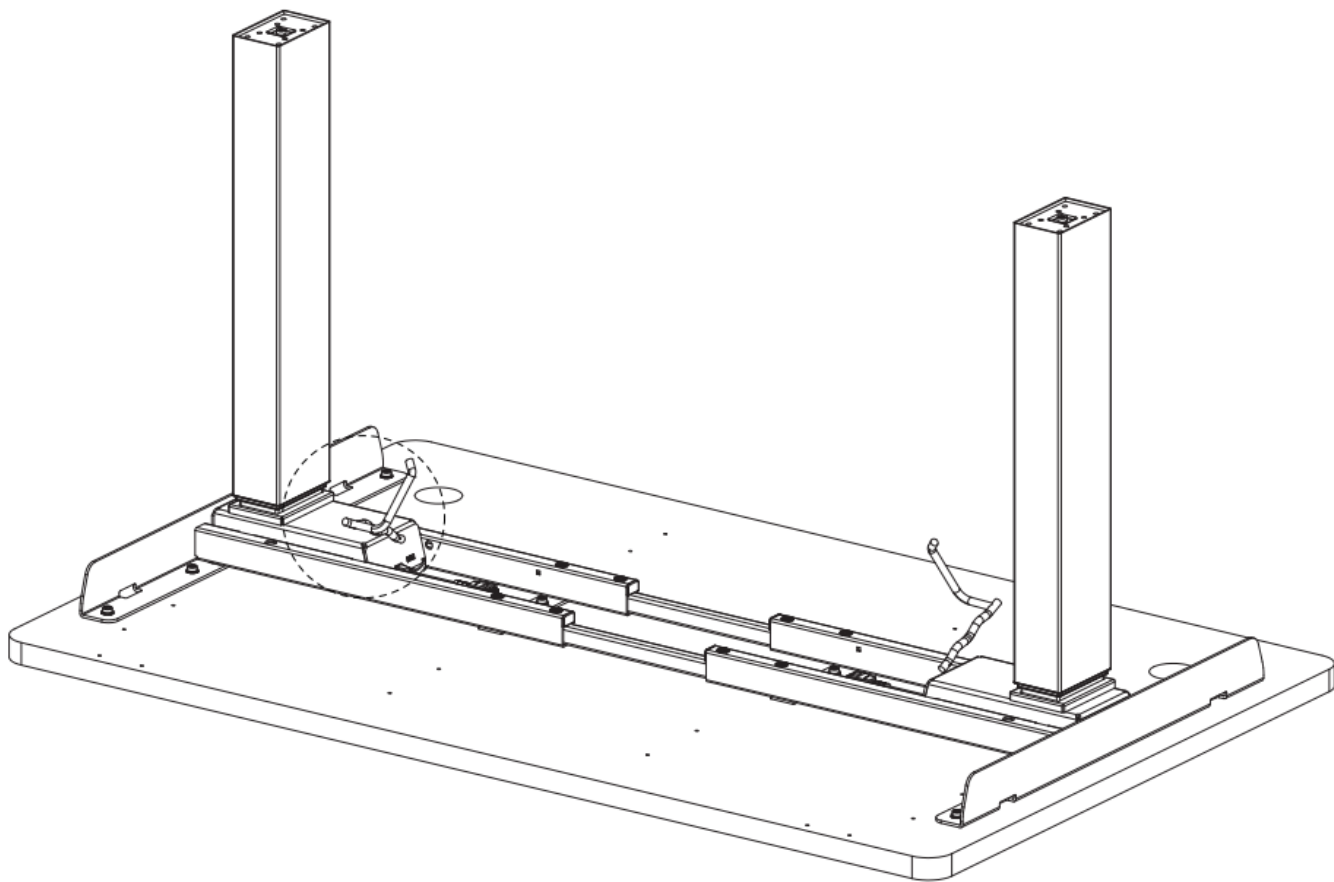

9

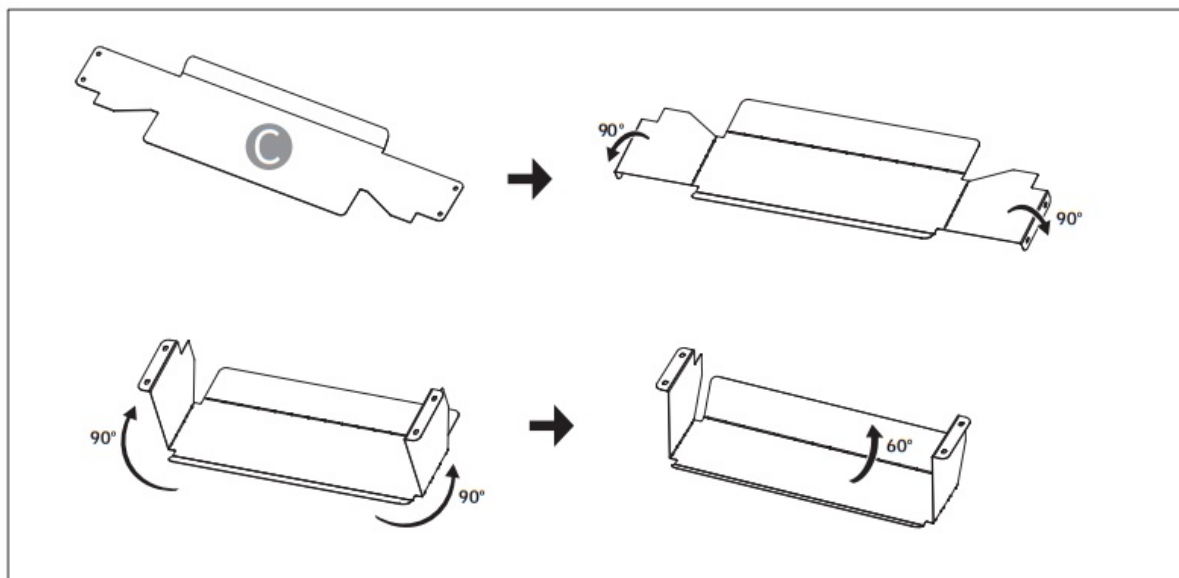

10

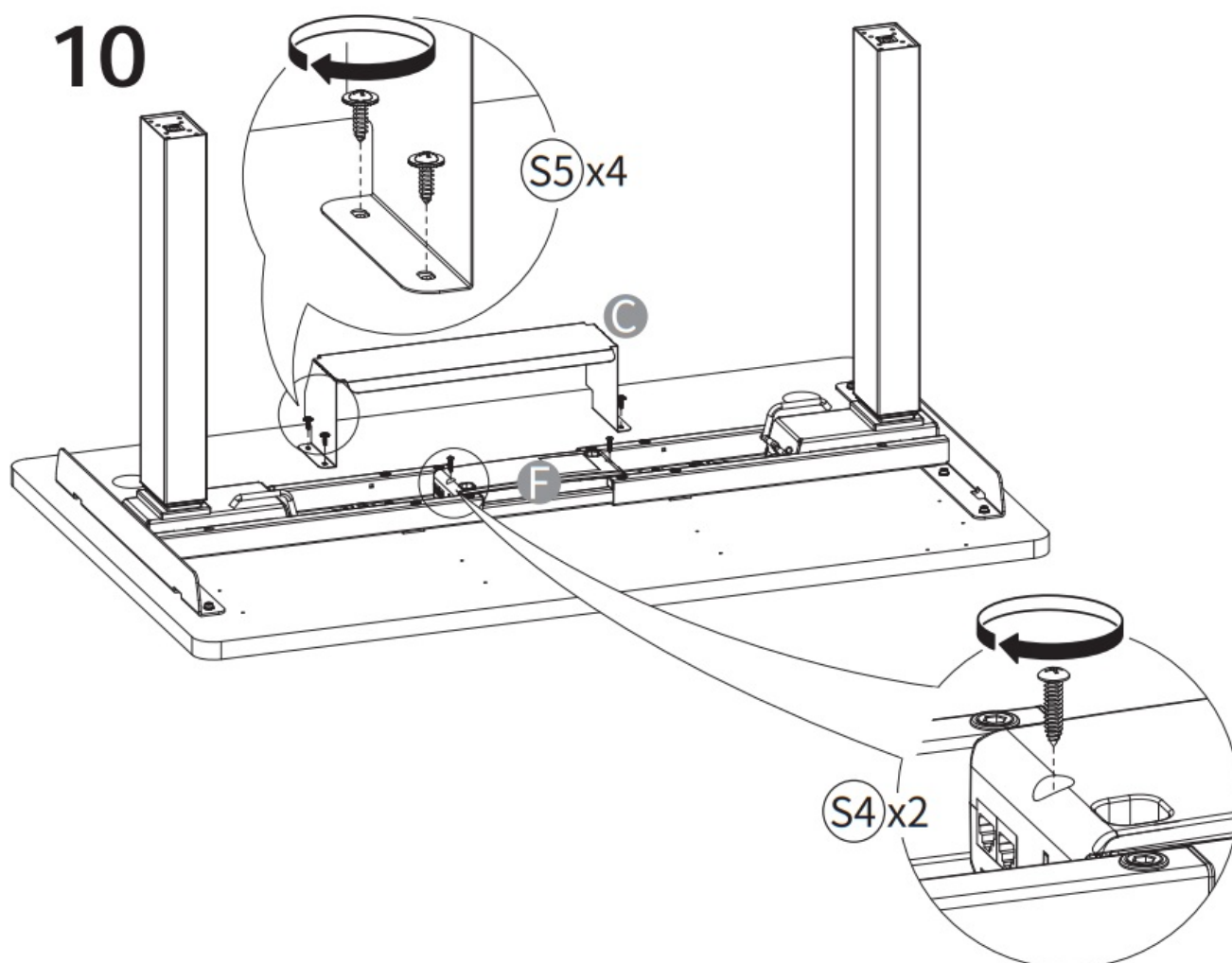

11

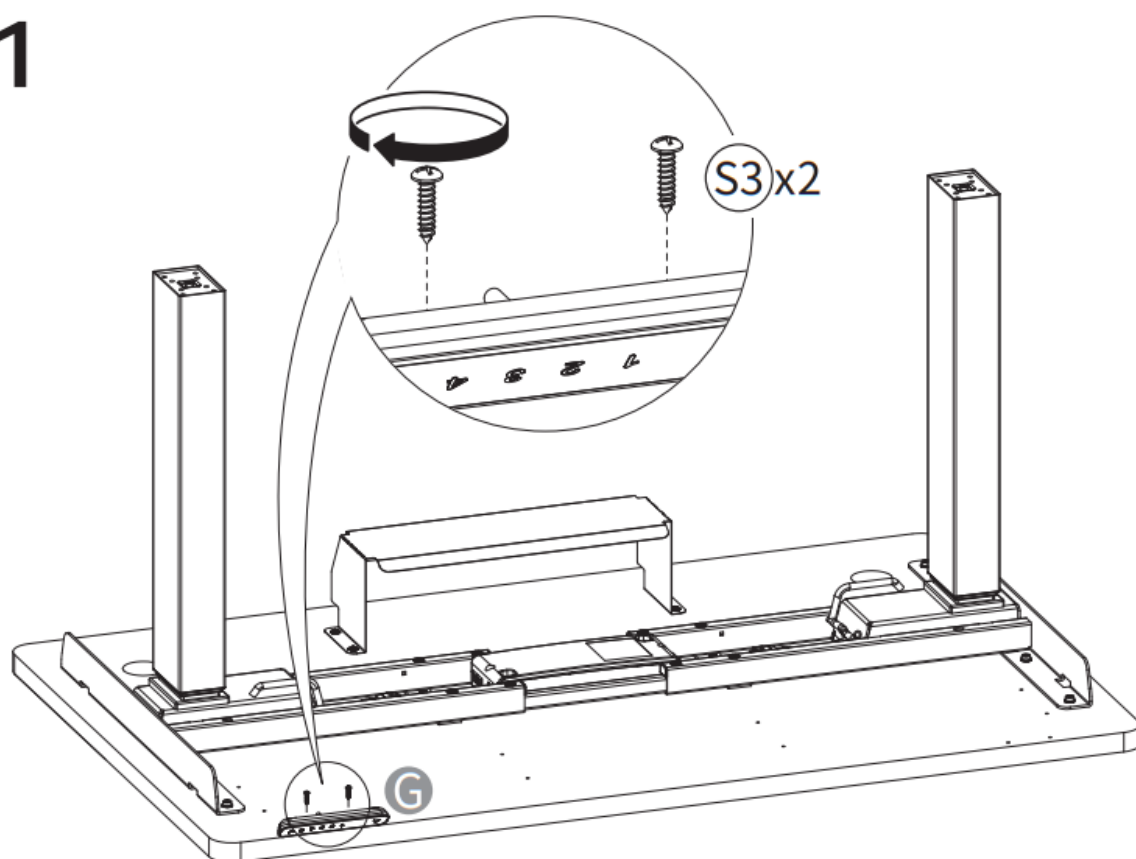

12

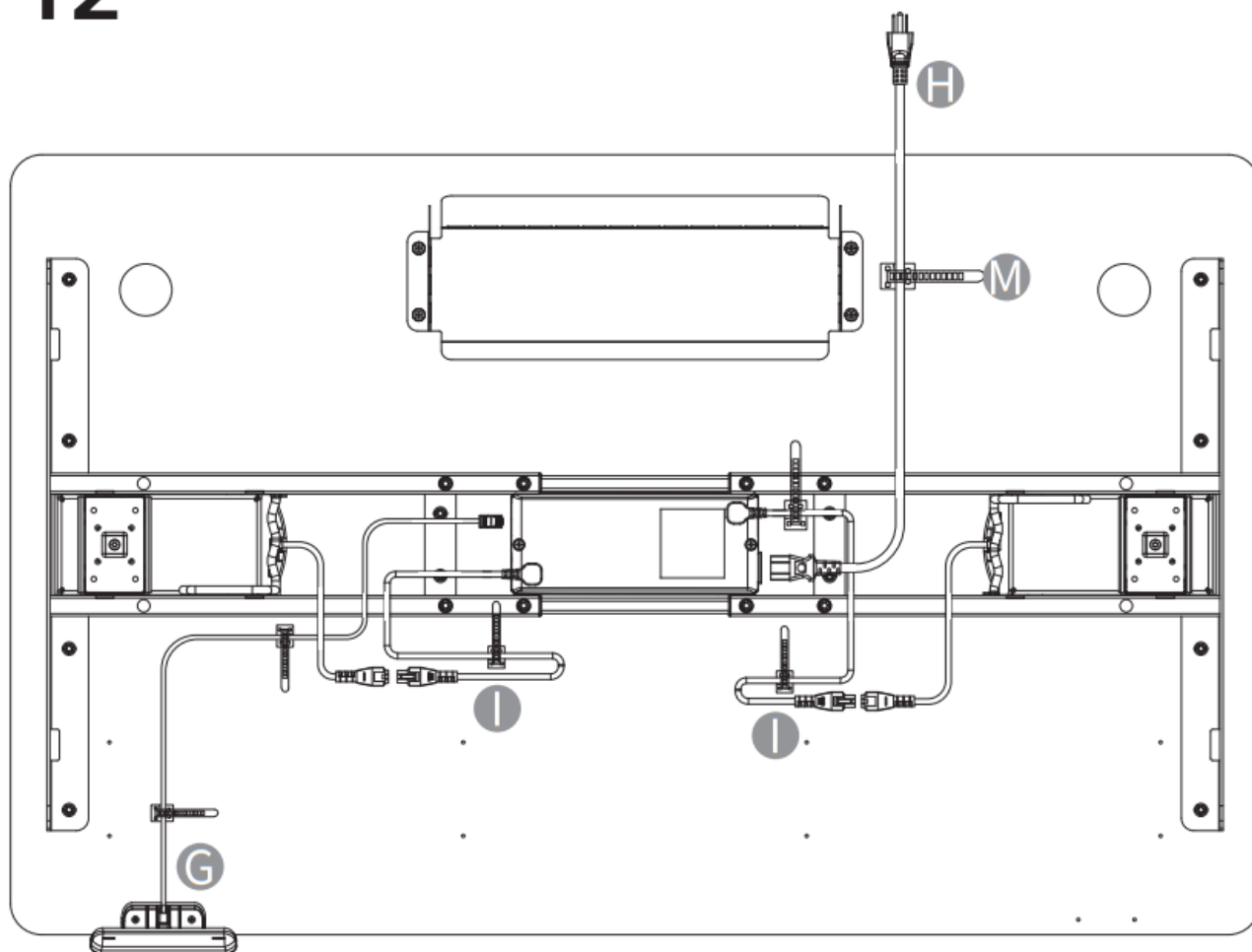

13

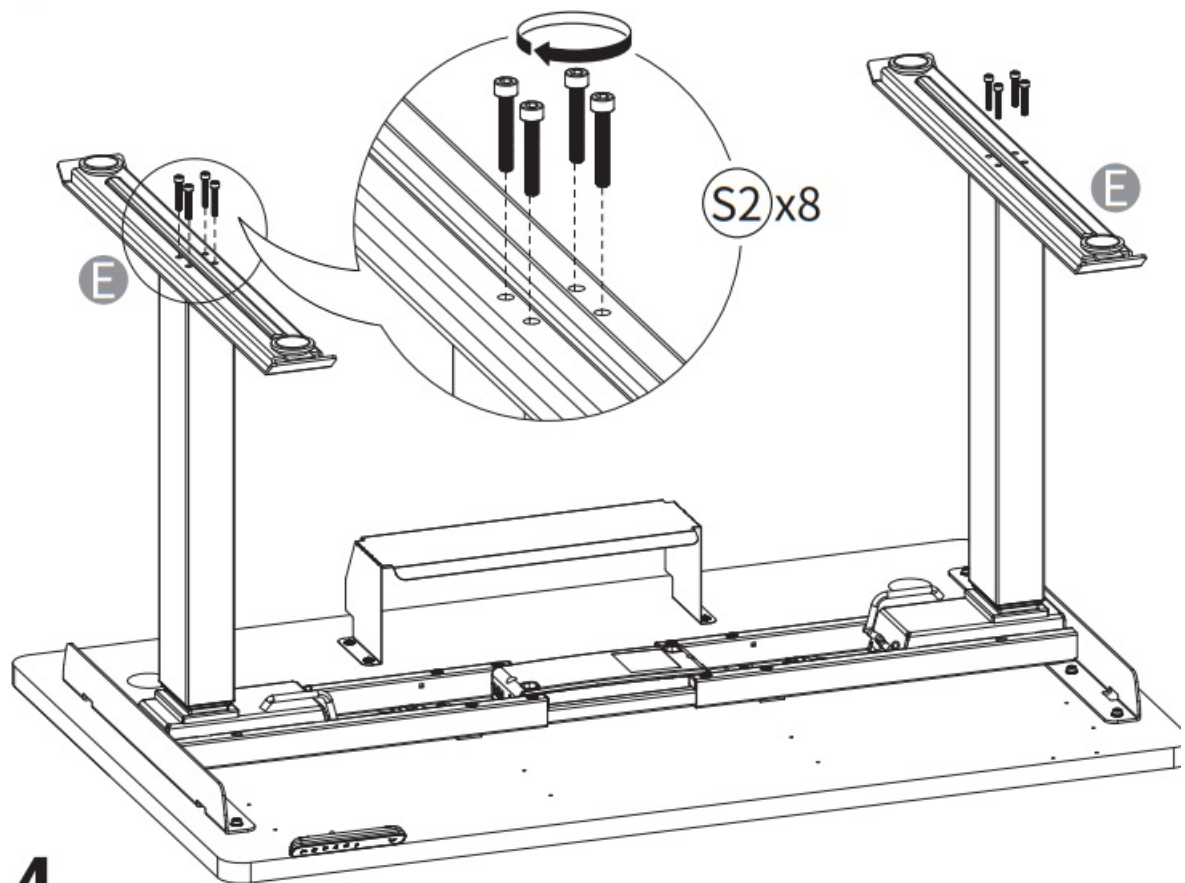

14

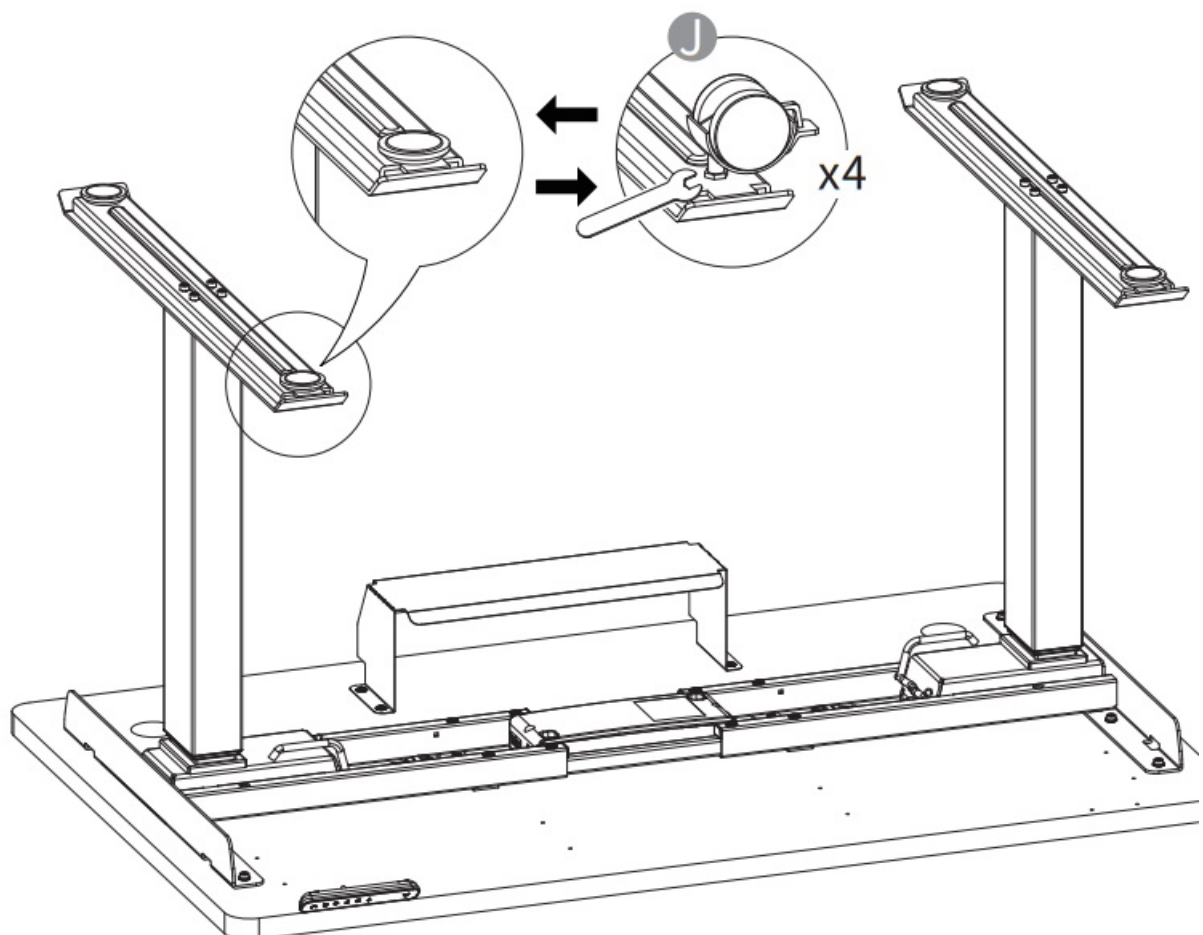

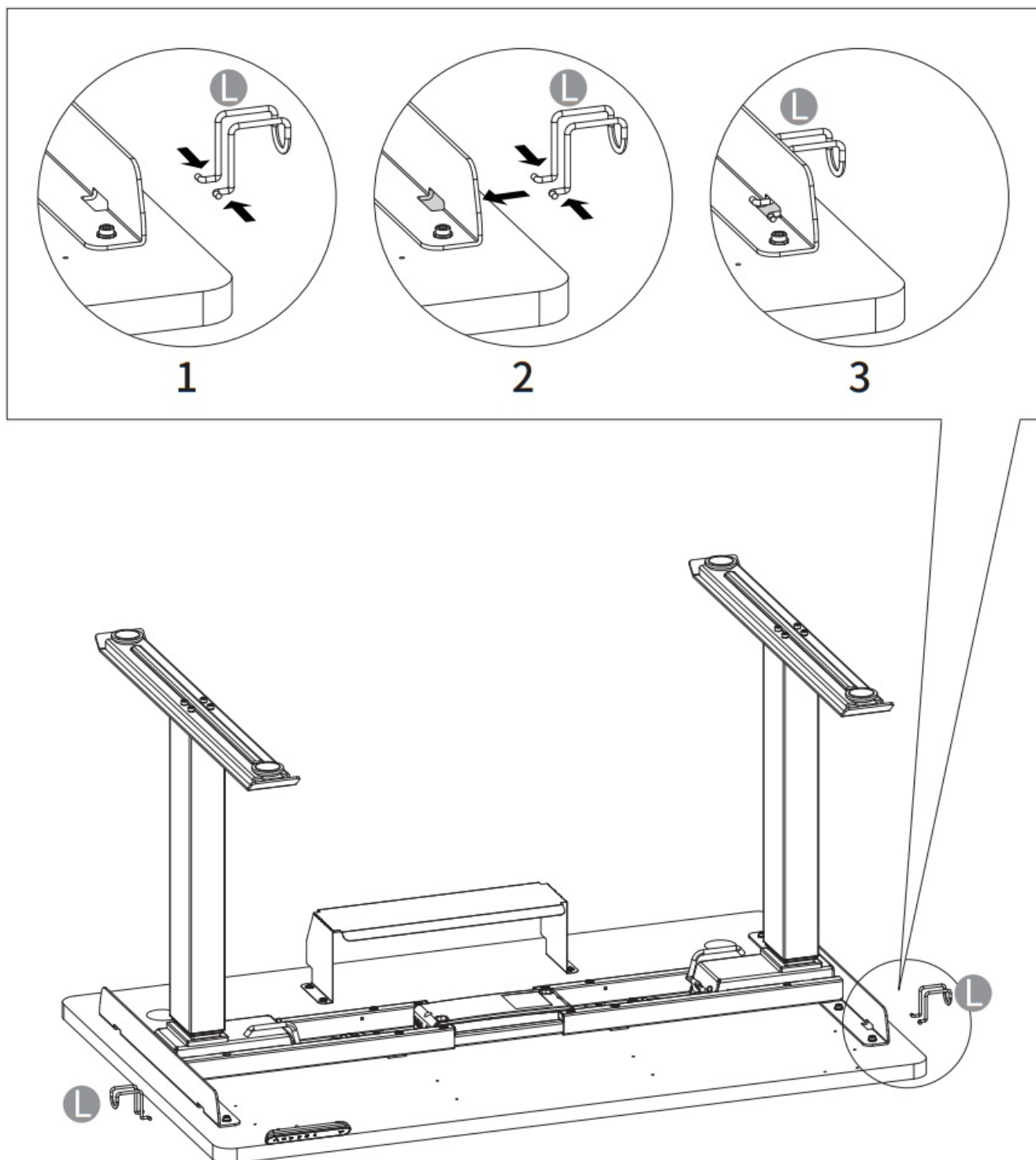

16

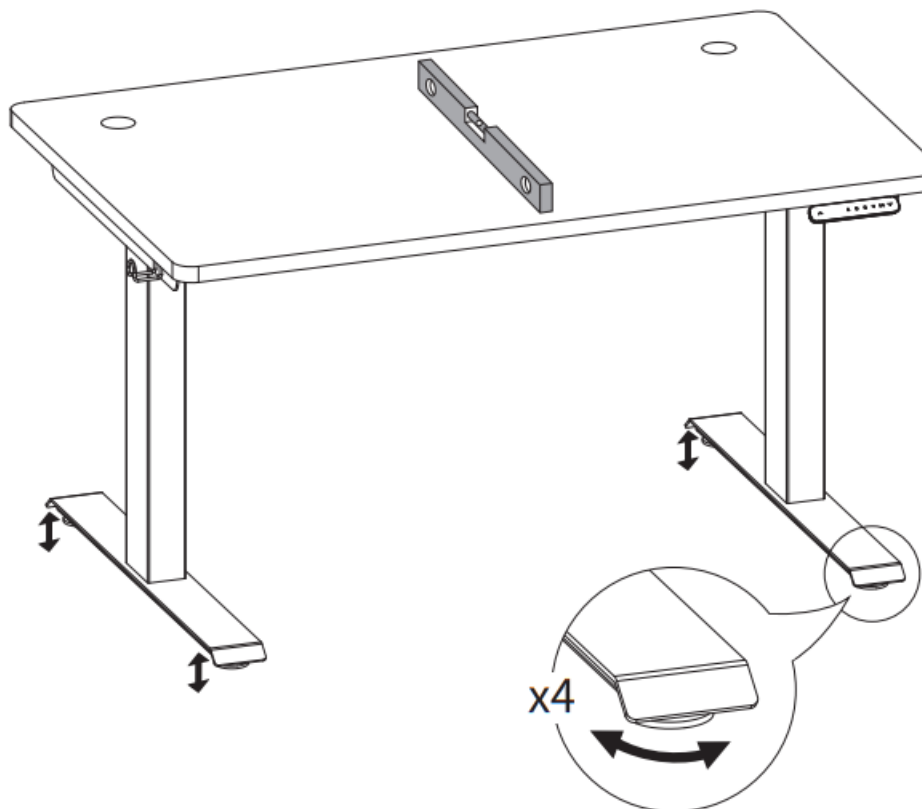
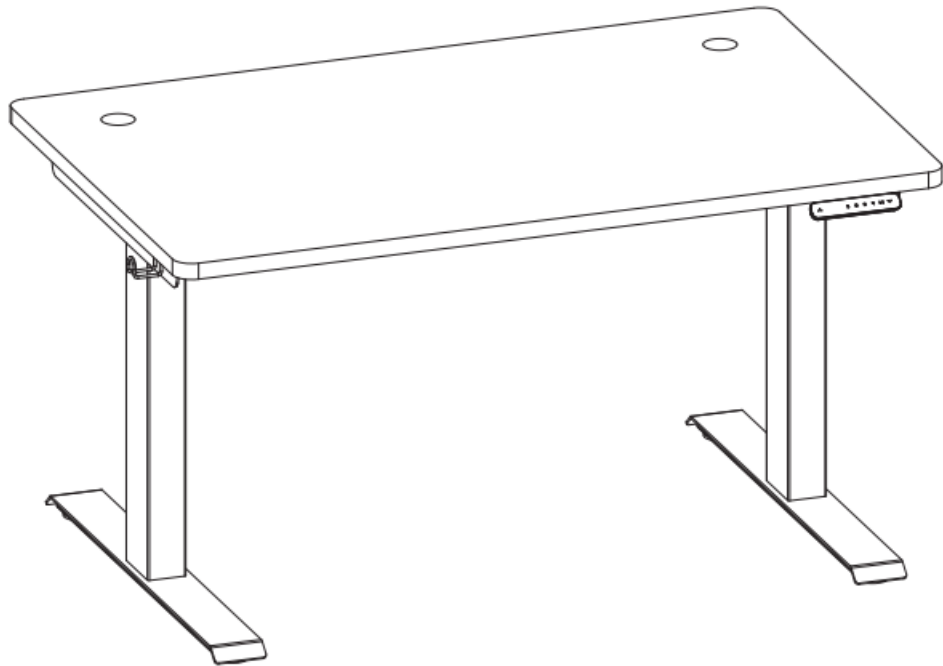



1. Initialization procedure

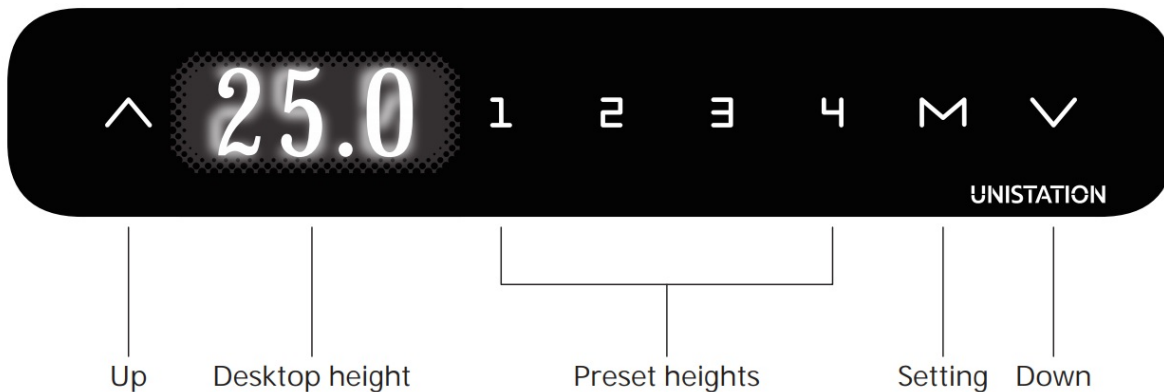

- Hold the button ^ & v together, the legs will begin to return to the lowest position. When the legs return to the lowest position, release the button ^ & v . Initialization is complete. Attention:

- Before using the desk for the first time, the initialization must be done.
- Once the desk parts have been replaced, the initialization must be done.
- When initialization has been interrupted, it must be reinitialized again.

2. Move up & down



- Hold the button ^ , legs move up. Release the button ^ , legs stop.
- Hold the button v , legs move down. Release the button v , legs stop.

3. Set the memory positions 1/2/3/4



- Hold the button \wedge or \vee until the desk height to the position you want, then release the button.
- Press the button M, the height number displayed on the handset will start flashing. Then press the button 1, 2, 3 or 4 within next 3 seconds.
- Press the button 1, 2, 3 or 4 when needed, the desk height will return to the corresponding position saved.

Attention:

- a. Memory position will be eliminated after initialization.
- b. Memory position can be covered.

4. Switch between centimeters and inches unit

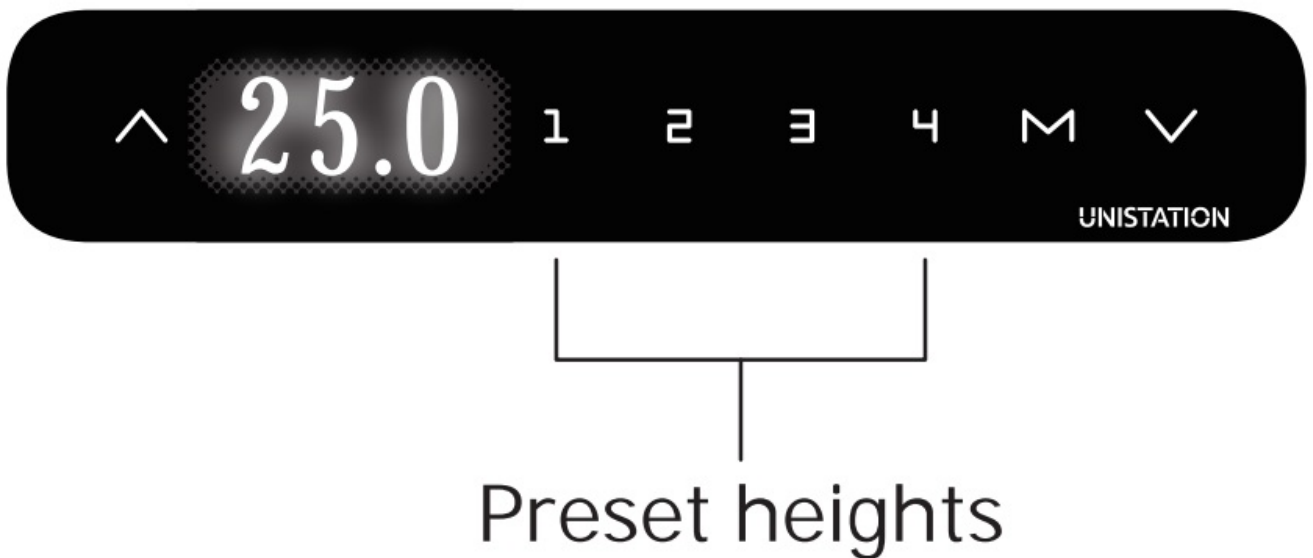

- Press the button M first, hold the button, then press the button \vee within 1 second, hold both buttons for 3 seconds, the desk height display unit will be switched between centimeters and inches.

5. Correct the desk height displayed on the handset

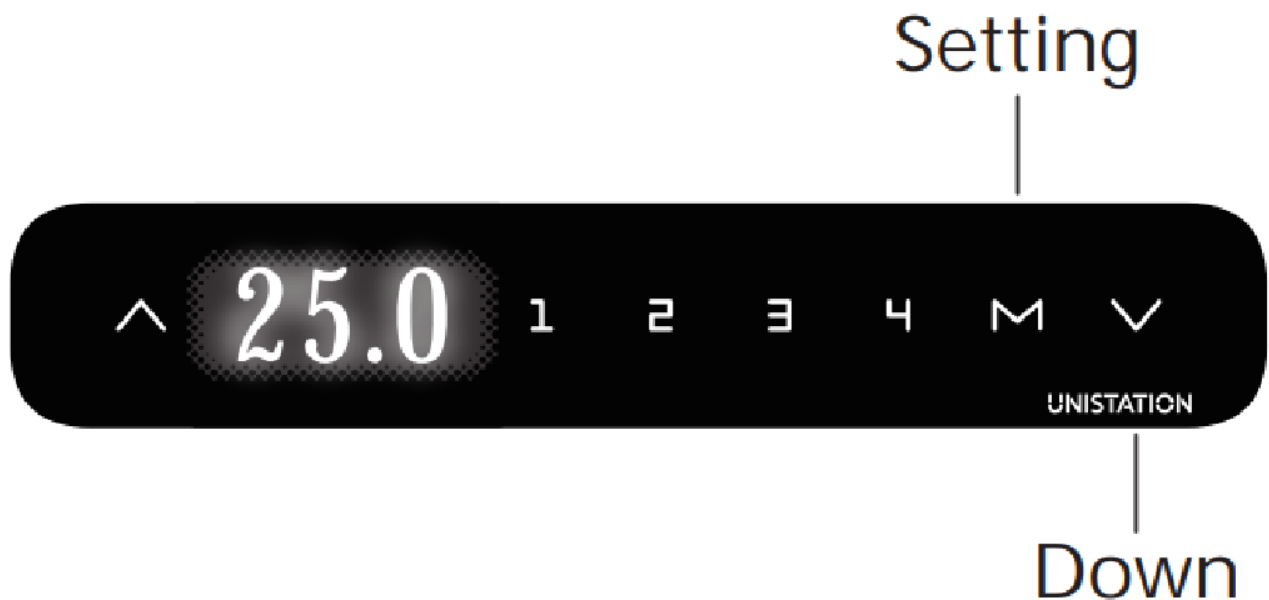

- If the actual height of the desk is inconsistent with the height displayed on the handset, you can take the following steps to correct it.
- Press the button M first, hold the button, then press the button \wedge within 1 second, hold both buttons for 3 seconds, the first digit of the desk height will start flashing. You can press the button \wedge or \vee to change the first digit.
- When the first digit is corrected, press the button M, the second digit of the desk height will start flashing. You can press the button \wedge or \vee to change the second digit.
- Repeat the above steps until all digits are corrected. Press the button M to end the height correct process.

6. Adjust the anti-clamping sensitivity



- Hold the button M for 6 seconds until the screen displays “— —”.
- Press and hold the button 3 for 3 seconds, the screen will display “G–N”. N represents the level of the anti-clamping sensitivity. N can be 0, 1, 2, 3, 4. “G–0” means no anti-clamping function, “G–4” means the highest anti-clamping sensitivity.
- You can press the button \wedge or \vee to change the N.

7. Error code

- E01: Leg malfunction. Check the cables between the legs and the control box first. If all the cables are connected, contact our customer service.
- E02: Frequent operations. Wait for 20 minutes to return to normal.
- E03: Overload. The objects placed on the desktop are too heavy.
- E04: Control box malfunction. Complete the initialization procedure first.
If initialization cannot solve the problem, contact our customer service.
- E06: Communication interruption. The connection between the handset and the control box is interrupted. Check the cable between the handset and the control box.
- E12: Gyroscope malfunction. The desk is tilted, place the desk flat or place the control box flat, then reconnect power.

UNISTATION

Documents / Resources

	<p> UNISTATION Electrically Height Adjustable Desk [pdf] Instruction Manual V1, Electrically Height Adjustable Desk, Height Adjustable Desk, Adjustable Desk, Desk </p>
---	--