



## Unger CLBK1 OmniClean Dual Bucket Kit Instruction Manual

[Home](#) » [Unger](#) » Unger CLBK1 OmniClean Dual Bucket Kit Instruction Manual 

**UNGER®**



**DUAL  
BUCKETKIT**



## Contents

1 [Quality Tools for Smart claning™](#)

2 [PART NO.: CLBK1/CLBK2 CASE QTY.:](#)

1

3 [HOW TO CLEAN WITH OMNICLEAN](#)

4 [ASSEMBLY](#)

5 [Documents / Resources](#)

6 [Related Posts](#)

**Quality Tools for Smart claning™**

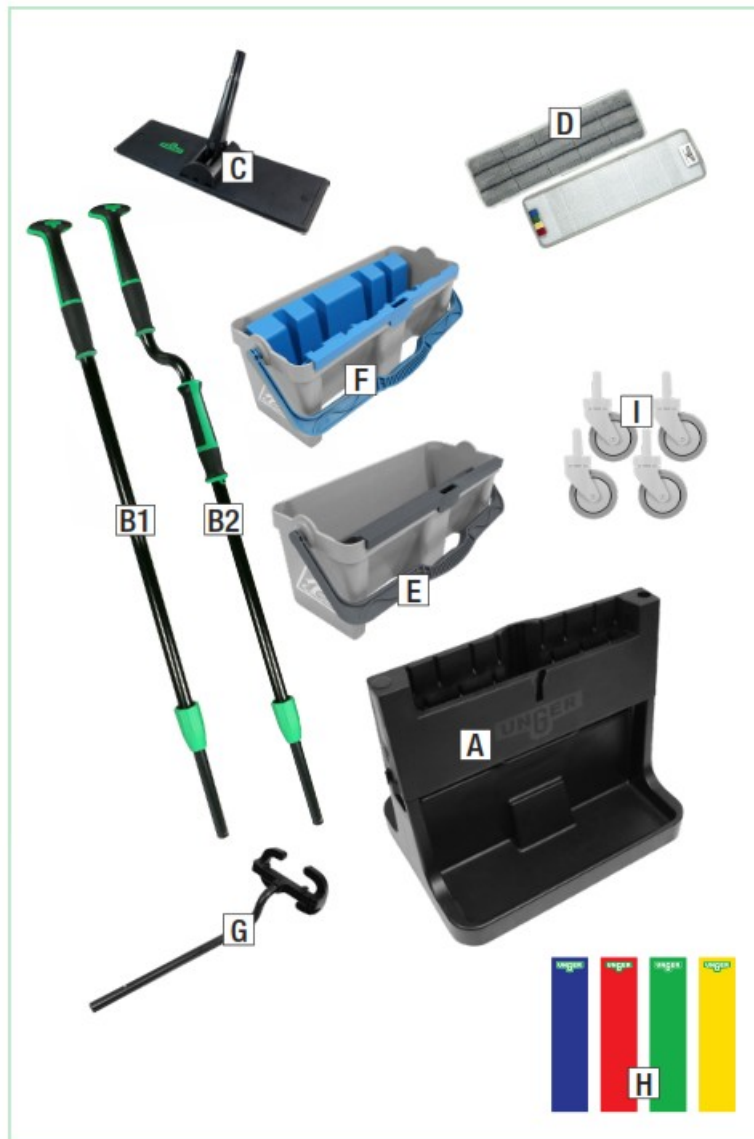

**PART NO.: CLBK1/CLBK2 CASE QTY.: 1**

- A. Carriage with Wringer
- B1. Straight Pole with Clip (CLBK1)
- B2. Offset Pole without Clip (CLBK2)
- C. Pad Holder
- D. Microfiber Pads (2)
- E. Gray Bucket with Scrub Board
- F. Blue StayClean Bucket with Guide
- G. Offset Carriage Handle
- H. SmartColor Rectangular Labels (2)
- I. Casters (4)

**HOW TO CLEAN WITH OMNICLEAN**

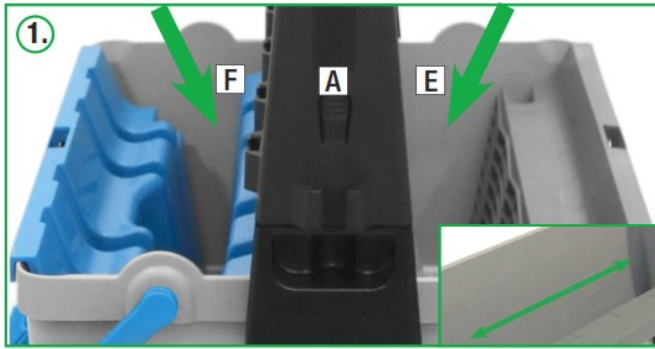

**(EN)** Fill StayClean bucket (F) with water and cleaning agent to fill line, place on carriage (A). Fill scrub board bucket (E) with water to the fill line then place on carriage (A).

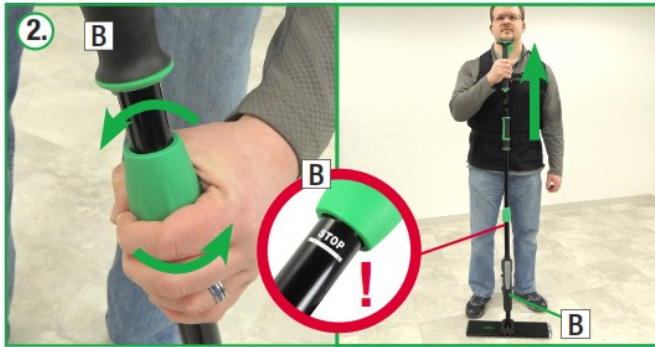

**(EN)** Adjust the height of the Unger Excella (B) pole by twisting counterclockwise (to the left) to chin height. To lock into place, tighten the locking collar by twisting clockwise (to the right). \*Unger Excella shape pole may vary

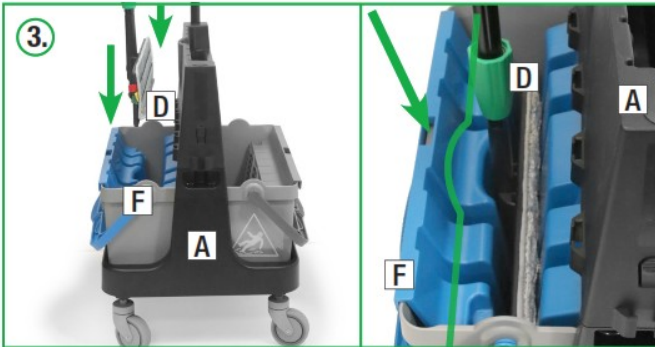

**(EN)** Insert mop into StayClean bucket (F) with mop pad (D) facing the carriage (A) to moisten the pad (D).

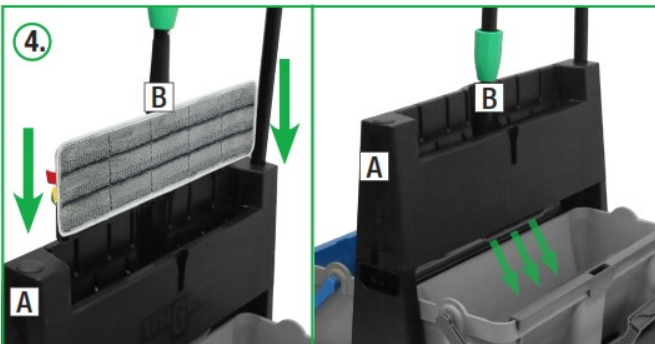

**(EN)** Insert mop (B) into wringer (A), wring mop 2x making sure to completely pull mop (B) out of wringer (A) each time. NOTE - Push/pull mop (B) vertically to insert and remove. DO NOT move it from side to side. This could damage the mop (B).

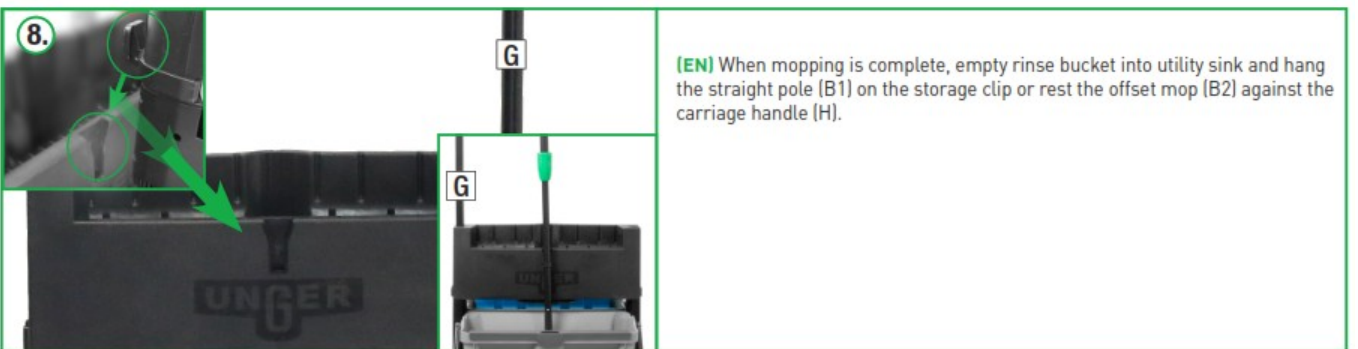
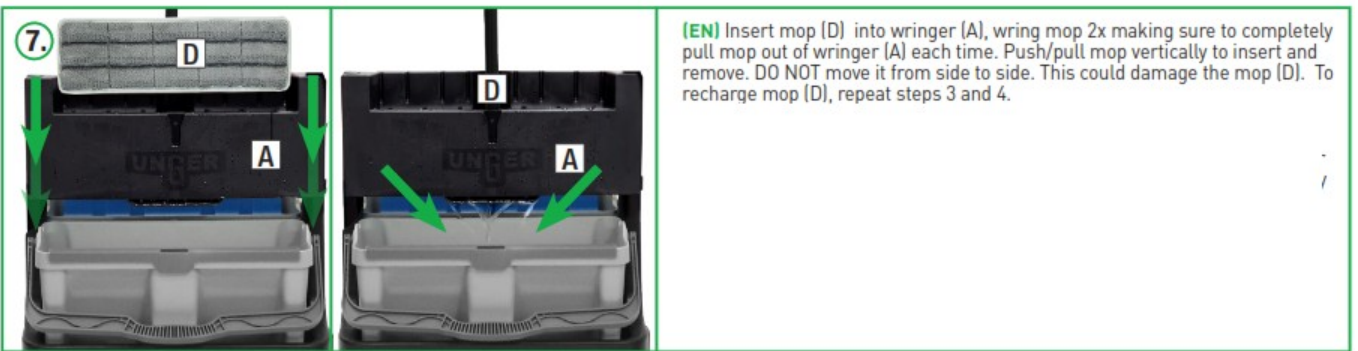
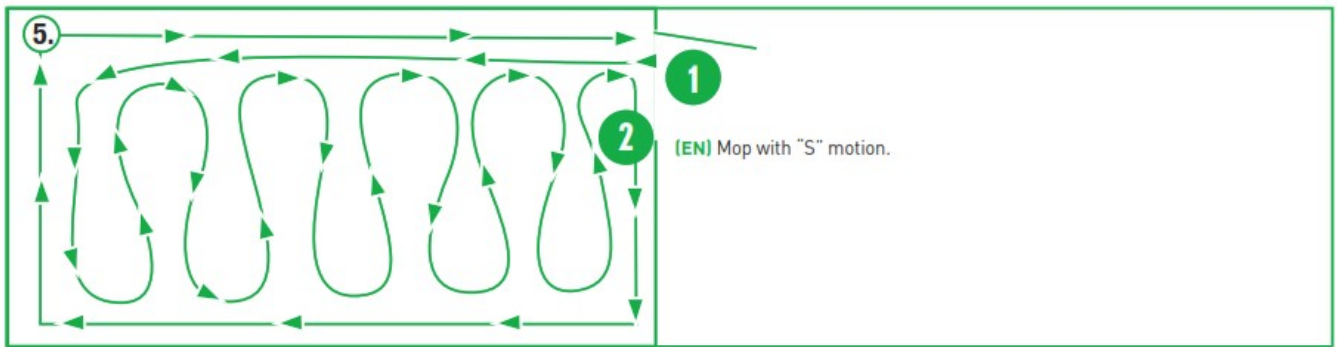

## ASSEMBLY



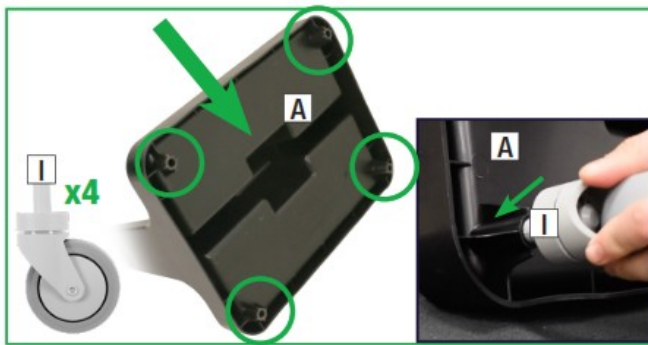

#### Caster Installation

(EN) Push casters (I) firmly into the base of the carriage (A).

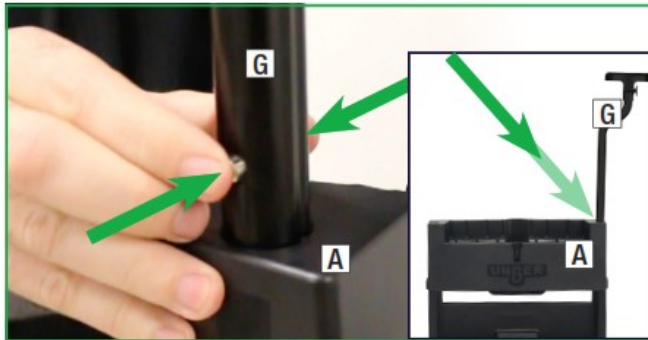

#### Handle Installation

(EN) On the handle (G), press metal pins and guide into the carriage base until you hear a click. The handle can be assembled to either side of the carriage (A).

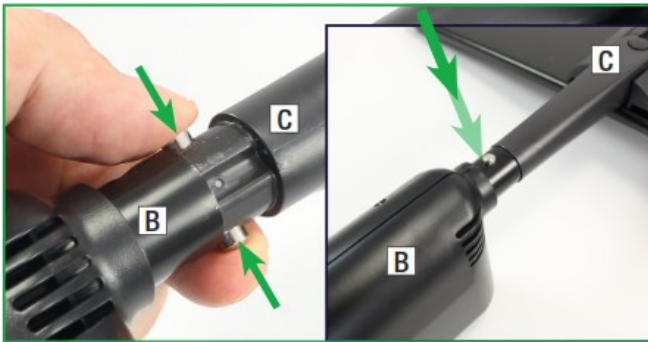

#### Mop Head Installation

(EN) Press metal pins on mop pad holder (C) into the base of the Unger Excella pole (B) until you hear a click.



#### Bucket Setup

(EN) Place scrub board bucket on Unger logo side and StayClean bucket on the opposite side. ((E) Grey = scrub board, (F) blue = StayClean)

Scan here for more information.



<https://www.youtube.com/watch?v=eLLU1ICnPE>  
[ungerglobal.com](http://ungerglobal.com)

Documents / Resources

	<p><a href="#">Unger CLBK1 OmniClean Dual Bucket Kit</a> [pdf] Instruction Manual CLBK1, CLBK2, CLBK1 OmniClean Dual Bucket Kit, OmniClean Dual Bucket Kit, Dual Bucket Kit, Bucket Kit</p>
---	---

[Manuals+](#)