



umbra EXHIBIT 5 Multi Photo Display Installation Guide

[Home](#) » [umbra](#) » umbra EXHIBIT 5 Multi Photo Display Installation Guide 

umbra EXHIBIT 5 Multi Photo Display Installation Guide



Contents

- [1 Parts List](#)
- [2 Hardware Tools](#)
- [3 Installation Instruction](#)
- [4 Documents / Resources](#)
 - [4.1 References](#)
- [5 Related Posts](#)

Parts List

- A, x2



- **B.** x2

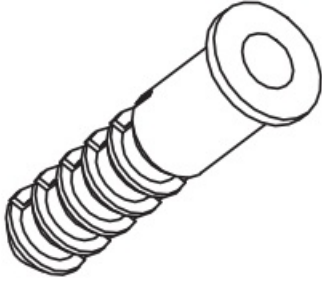

- **C.** x2



- **D.** x1

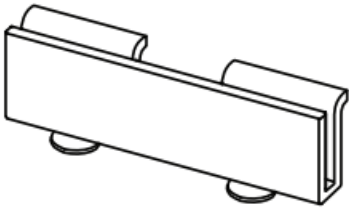

- **E.** x2

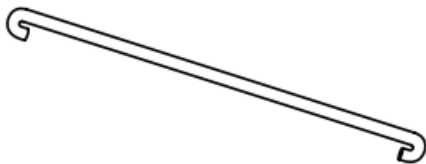

- **F.** x3

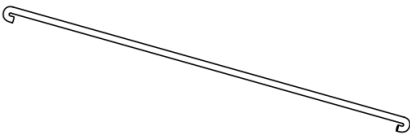

- **G.** x1



- **H.** x1

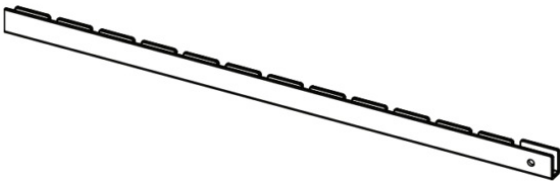

- I. x3

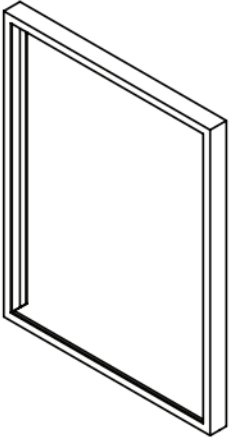

- J. x2

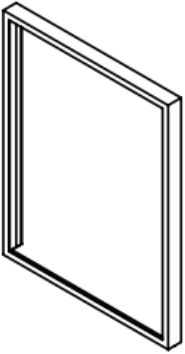

Hardware Tools

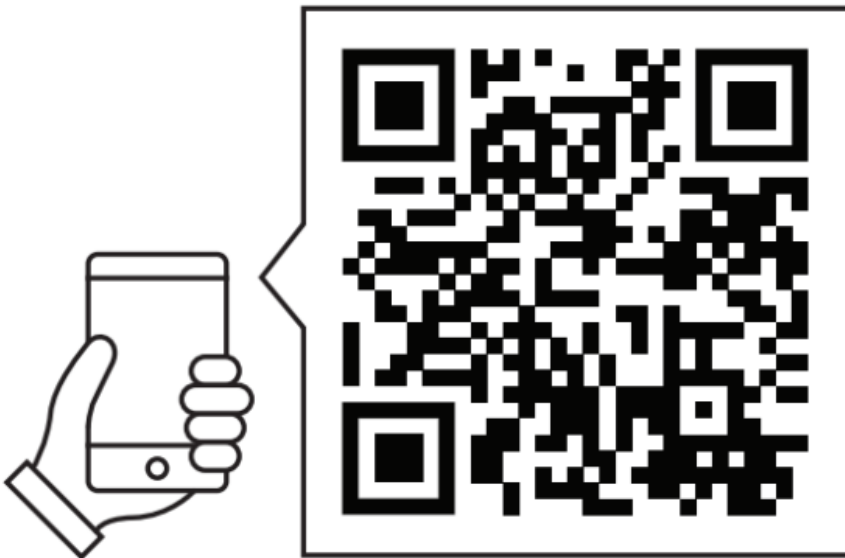

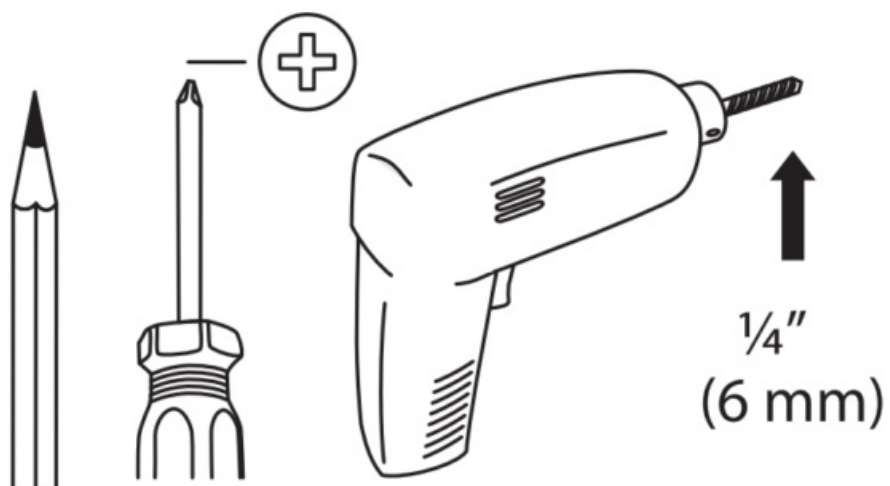

Installation Instruction

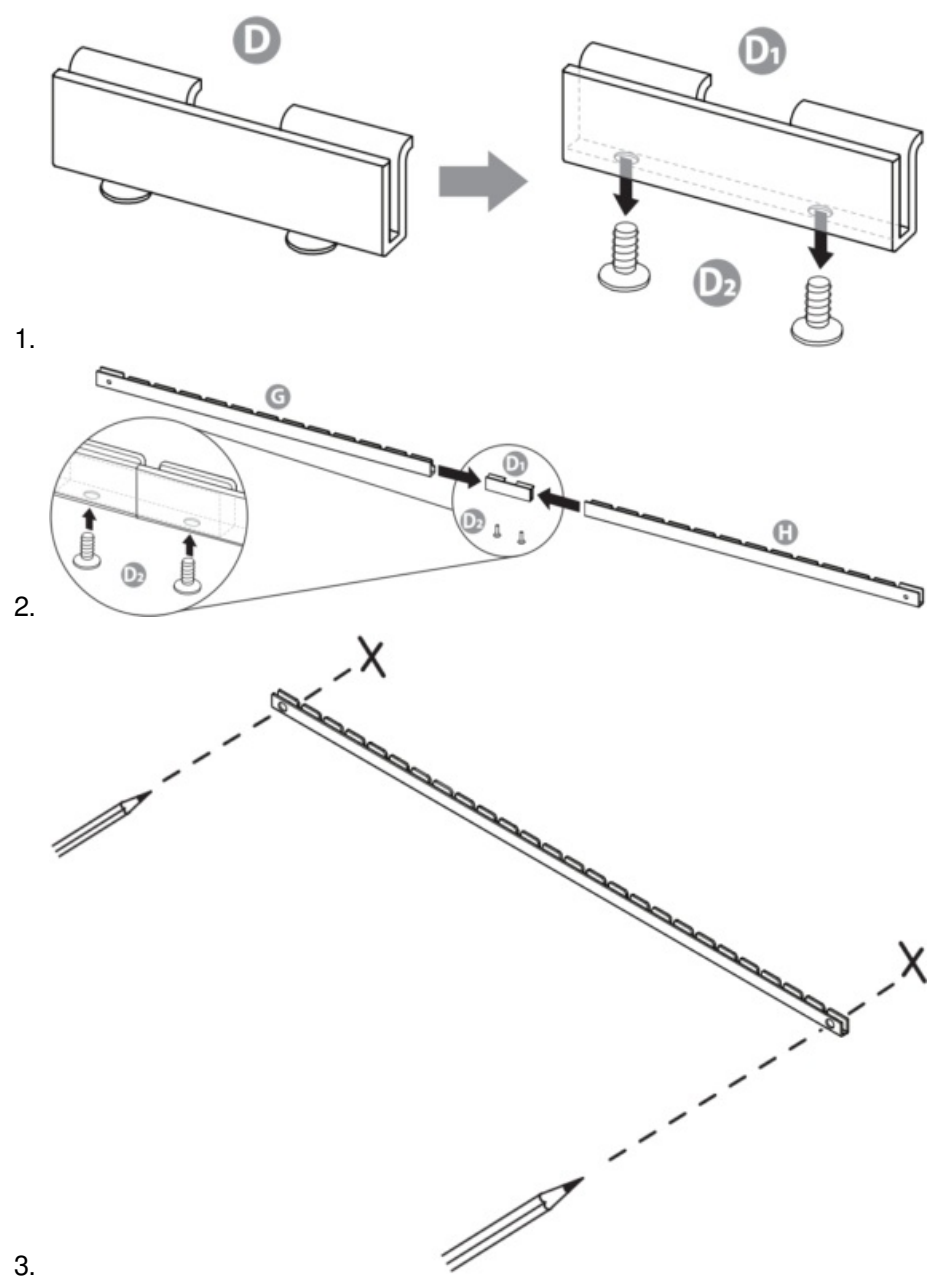

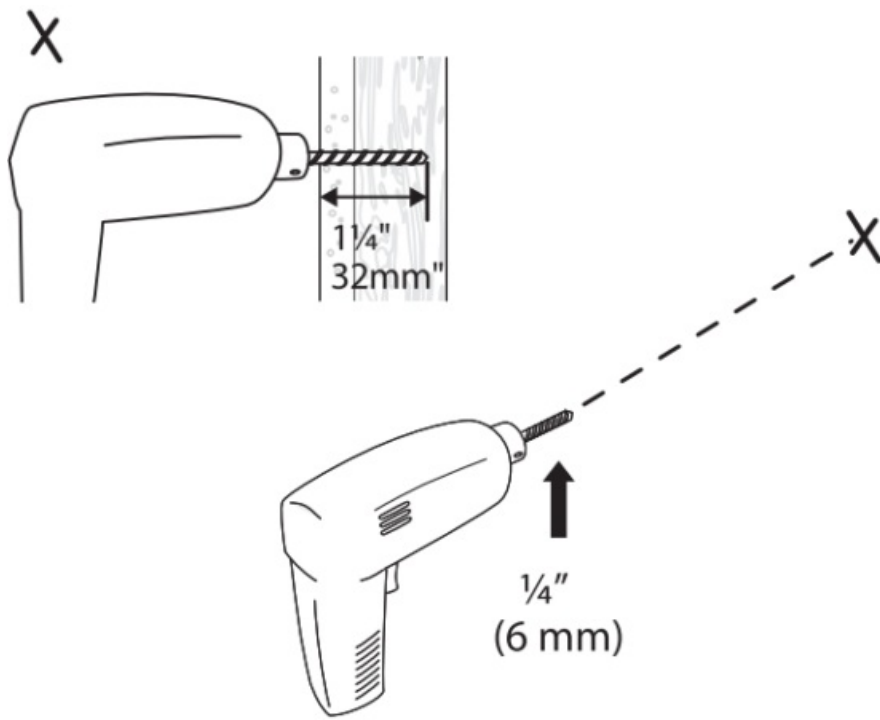

4.

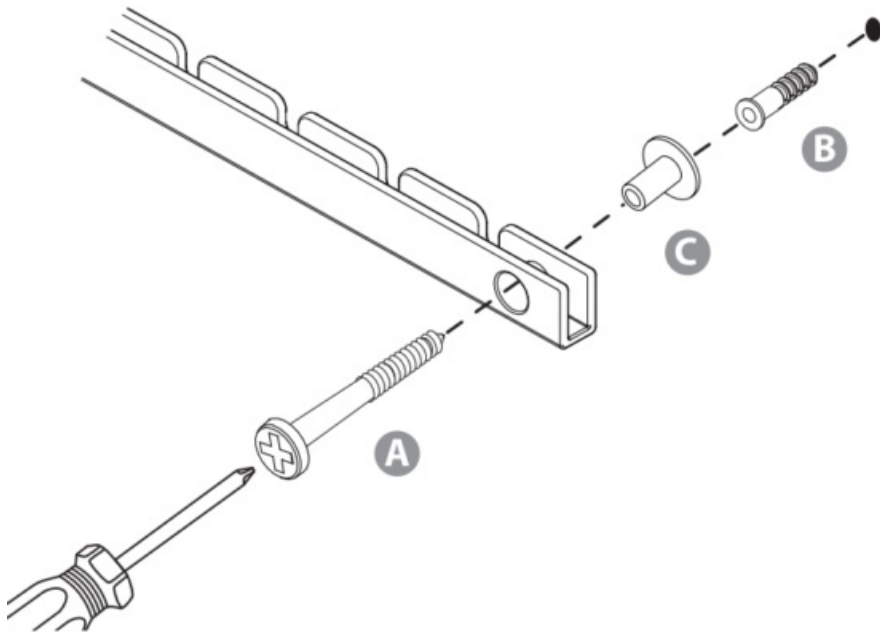

5.

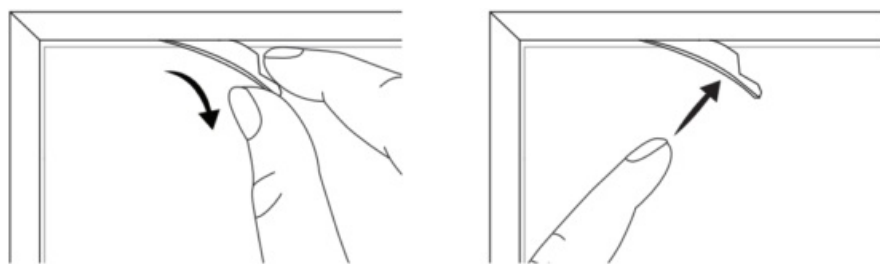

Pull out rubber strips to remove glass back and insert photo. Reinsert rubber strips after assembly.

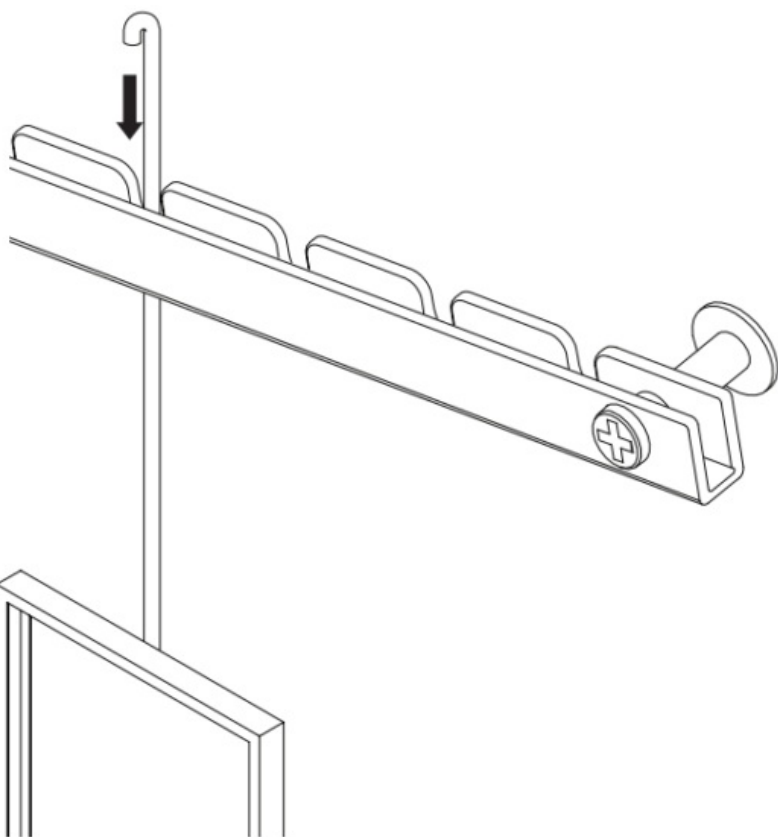
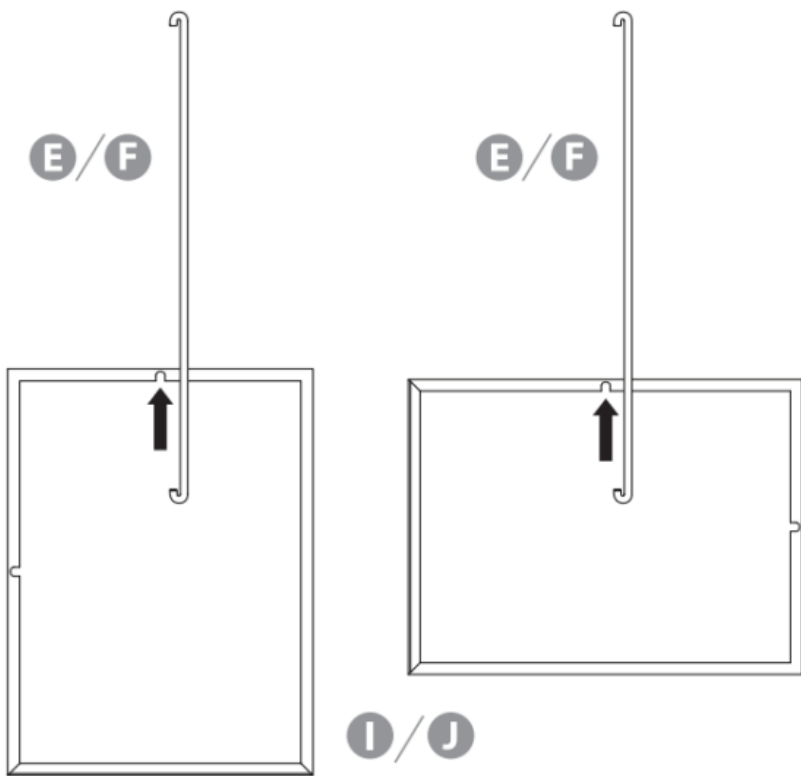

7.

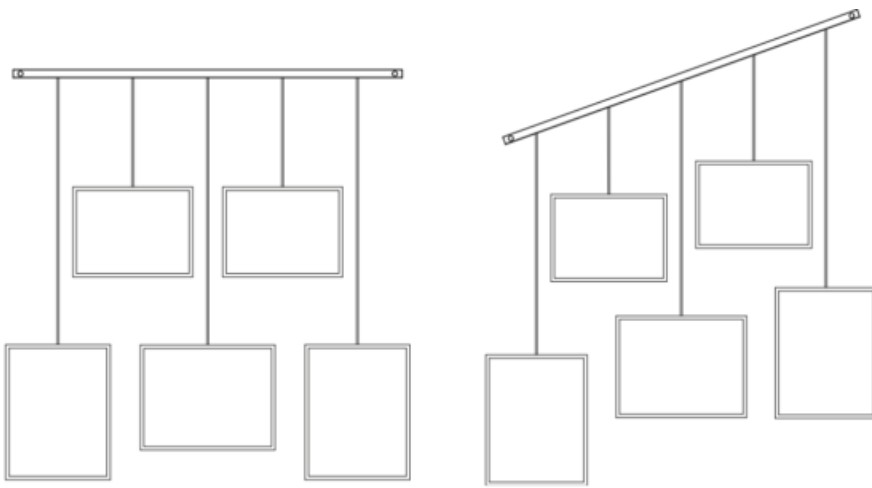

EXHIBIT 5

Multi Photo Display
Cadre photo multi-vues
Marco multi-Fotomat
Multi photo display
Perpetrator
Espositore multifoto

umbra.com



Documents / Resources

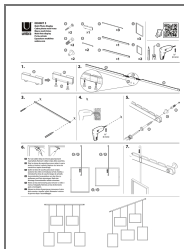

[umbra EXHIBIT 5 Multi Photo Display](#) [pdf] Installation Guide

EXHIBIT 5 Multi Photo Display, EXHIBIT 5, Multi Photo Display, Photo Display, Display

References

- [User Manual](#)

[Manuals+](#), [Privacy Policy](#)

This website is an independent publication and is neither affiliated with nor endorsed by any of the trademark owners. The "Bluetooth®" word mark and logos are registered trademarks owned by Bluetooth SIG, Inc. The "Wi-Fi®" word mark and logos are registered trademarks owned by the Wi-Fi Alliance. Any use of these marks on this website does not imply any affiliation with or endorsement.