



# umay Remote Control for Treadmill Instructions

[Home](#) » [umay](#) 

## umay Remote Control for Treadmill Instructions



Contents

1 Remote control interface

2 Documents / Resources

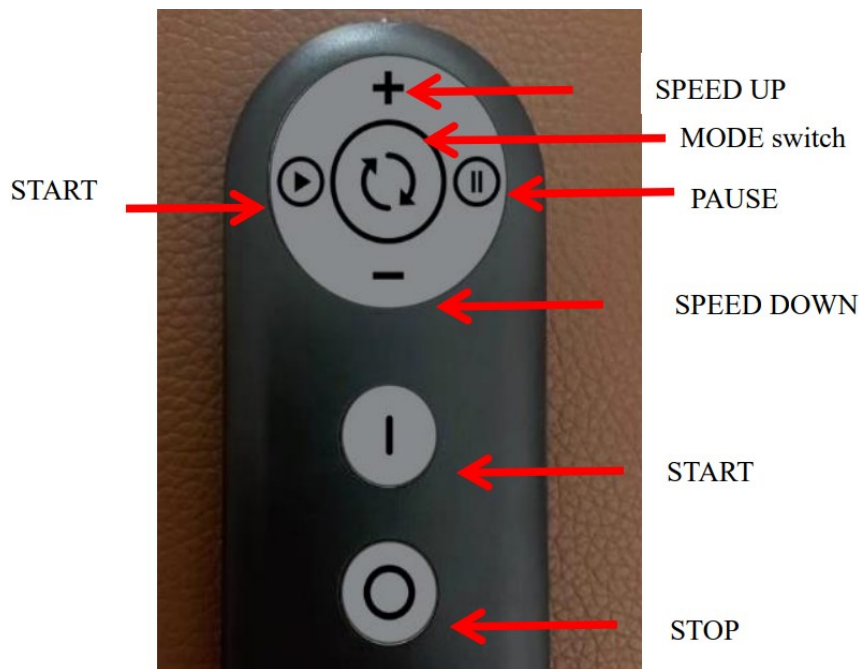

1. **START:** Press the button in standby or pause mode Start running the treadmill.
2. **STOP:** Press the button while the treadmill is running Stop the treadmill.
3. **MODE switch**
  - A. Rest is displayed in standby mode, Press the key to switch  
**cycle:** redy mode→time counter mode→range reversal mode→Calorimeter mode→Standby mode.
  - B. In working condition ,Press the key to switch cycle:0.00→ time  
T:00:00→ distance D:0.00→ calorie C:0000→ speed S:0.00
4. **SPEED UP and SPEED DOWN :**
  - A. Rest is displayed in standby mode, Press the key to adjust the parameter settings, Long press to adjust quickly
  - B. In working condition, short press key to adjust the speed change, Long press to adjust quickly
5. **PAUSE:** In working condition, Press the key to pause runnning, speed go to zero, interface display PAUSE

Please take attention that changes or modification not expressly approved by the party responsible for compliance could void the user's authority to operate the equipment.

This device complies with Part 15 of the FCC Rules. Operation is subject to the following two conditions:

1. This device may not cause harmful interference, and
2. This device must accept any interference received, including interference that may cause undesired operation.

This equipment complies with FCC radiation exposure limits set forth for an uncontrolled environment. This equipment should be installed and operated with minimum distance 20cm between the radiator & your body.

## Documents / Resources

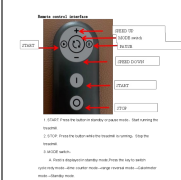

[umay Remote Control for Treadmill](#) [pdf] Instructions  
2A6QS-REMOTE, 2A6QSREMOTE, Remote Control for Treadmill, Remote Control, Treadmill R  
emote Control