

ULTIMEA

ULTIMEA Apollo  
S60 Detachable  
Sound Bar



# ULTIMEA Apollo S60 Detachable Sound Bar User Manual

[Home](#) » [ULTIMEA](#) » ULTIMEA Apollo S60 Detachable Sound Bar User Manual 

## Contents

- 1 [ULTIMEA Apollo S60 Detachable Sound Bar](#)
- 2 [ACCESSORIES LIST](#)
- 3 [SOUNDBAR CONTROLS](#)
- 4 [SOUNDBAR INSTALLATION](#)
- 5 [CONNECT TO SUBWOOFER](#)
- 6 [CONNECT TO TV VIA HDMI OUT eARC / ARC](#)
- 7 [CONNECT TO TV VIA OPTICAL I AUX](#)
- 8 [CONNECT TO BLUETOOTH'](#)
- 9 [PLACEMENT OPTIONS](#)
- 10 [SPECIFICATIONS](#)
- 11 [PROPER DISPOSAL INSTRUCTIONS](#)
- 12 [FCC REGULATORY COMPLIANCE](#)
- 13 [Documents / Resources](#)
  - 13.1 [References](#)
- 14 [Related Posts](#)

# ULTIMEA

**ULTIMEA Apollo S60 Detachable Sound Bar**



## ACCESSORIES LIST



Soundbar



Subwoofer



Power Adaptor

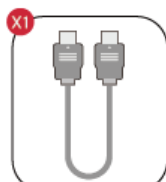

HDMI Cable

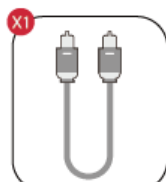

Digital Optical Cable

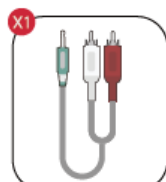

Stereo RCA to 3,5mm  
Audio Cable

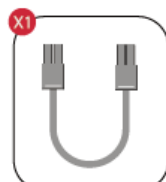

4-pin Cable for  
Soundbar  
Connection(100mm)

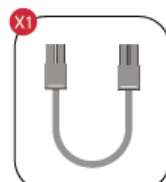

4-pin Cable for  
Soundbar  
Connection(2,5m)

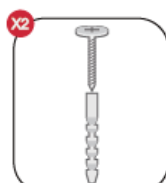

Wall Mounting Kit



Wall Bracket



Remote Control

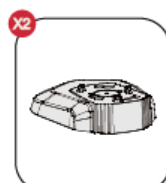

Base



User Manual

## SOUNDBAR CONTROLS

1. Control Panel
2. VOL+: Volume Up.
3. VOL-: Volume Down.
4. Power Button:

Press to power button to turn on / off

5. INPUT:

Press to switch channels: EARC-HDIN-OPT(OPTICAL)-BT-AUX-USB. Hold for 3 seconds to disconnect the current device and connect to a new device manually on your mobile phone / PC / TV (BT ID: Apollo S60)

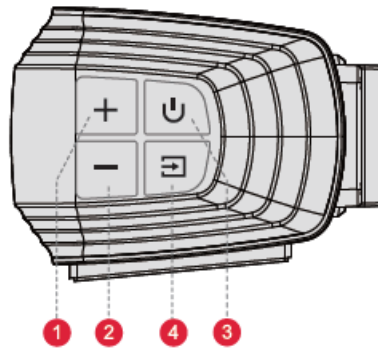

1. Power Button Press to power button to turn on / off.
2. RC Press to switch to HDMI eARC channel.
3. HDIN Press to switch to HDMI IN channel.
4. OPT Press to switch to OPTICAL channel.
5. AUX Press to switch to AUX channel. • “
6. BT Press to switch to Bluetooth channel and enter pairing mode. Hold for 3 seconds to disconnect current device and connect to a new device manually on your mobile phone / PC / TV (BT ID: Apollo S60).
7. USB Press to switch to USB channel
8. + Volume Up
9. - Volume Down 10
10. “<”: Previous For BT and USB mode only: Skip to previous track. “
11. > Next For BT and USB mode only: Skip to next track.
12. “DII” “DII”: Play / Pause For BT and USB mode only. USB mode: Hold for 3 seconds to switch between single loop playback and list loop playback.
13. **MOVIE** “: MOVIE Press to switch to MOVIE mode.
14. **GAME** “: GAME Press to switch to GAME mode.
15. **MUSIC** “: MUSIC Press to switch to MUSIC mode.
16. BASS MX “: BASSMAX Press to adjust bass level, the display will show: “b5-2”, “b5-1”, “b5 0”, “b5 1”, “b5 2”. “
17. Mute / Recover the volume.

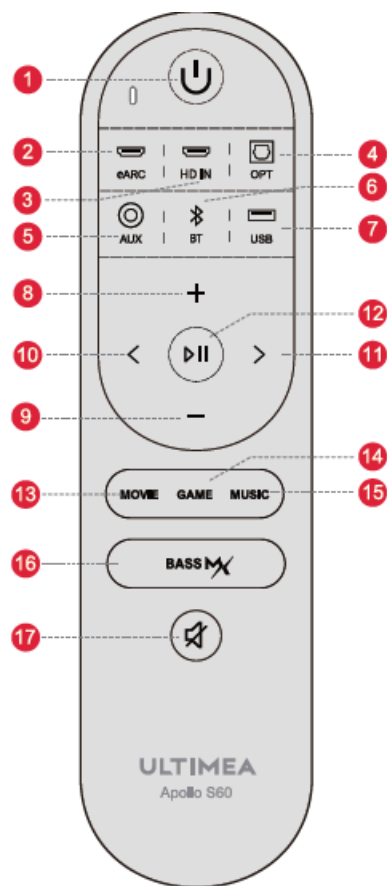

## SOUNDBAR INSTALLATION

### Assembly steps

1. Align the joints of the two parts.
2. Twist to connect.
3. Plug in the 4-pin Cable for Soundbar Connection.

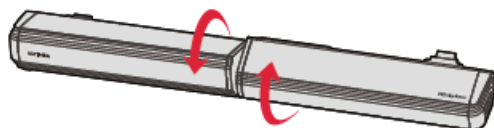
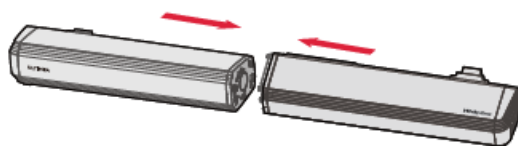

## Detached and stand on base

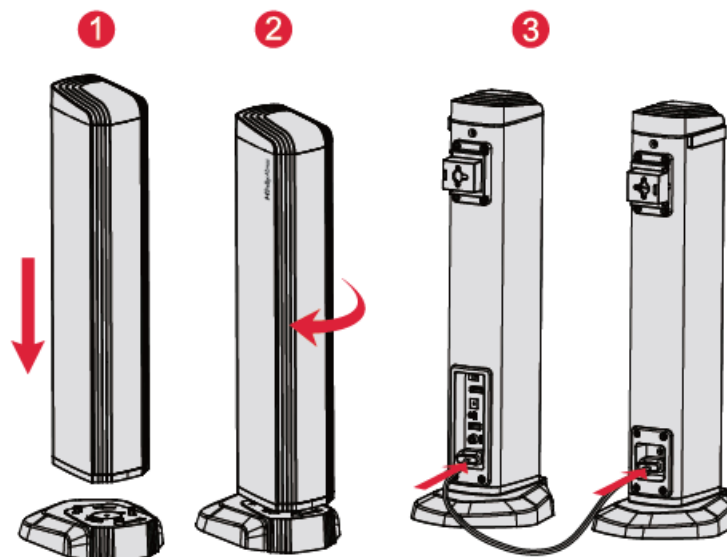

1. Set the soundbar on the base and align the joints
2. Twist to connect with the base.
3. Plug in the 4-pin Cable for Soundbar Connection.

## CONNECT TO SUBWOOFER

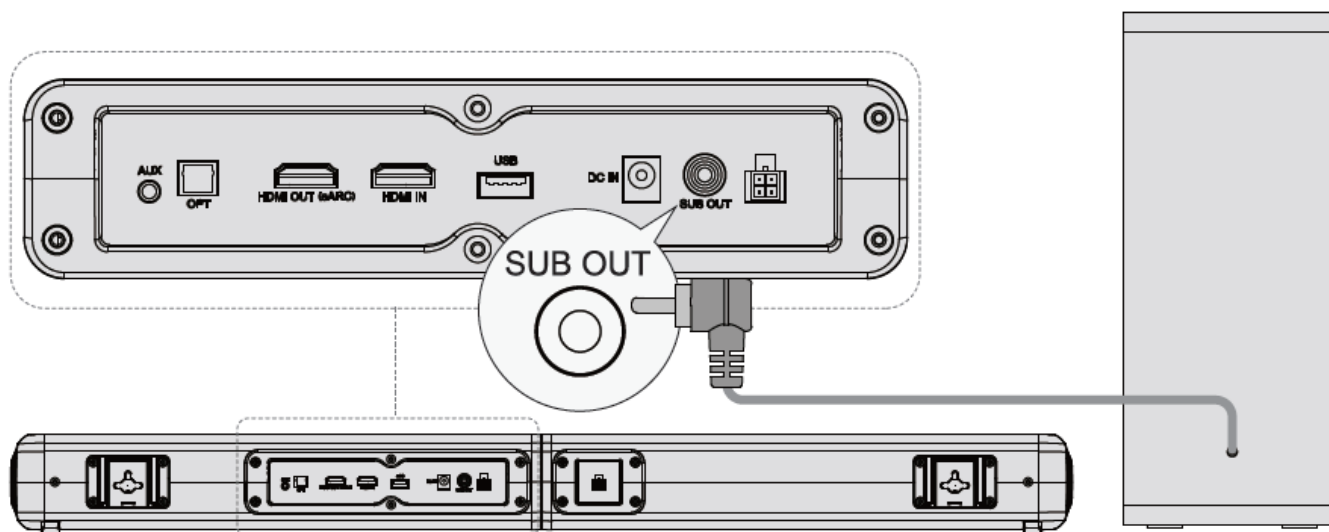

## CONNECT TO TV VIA HDMI OUT eARC / ARC

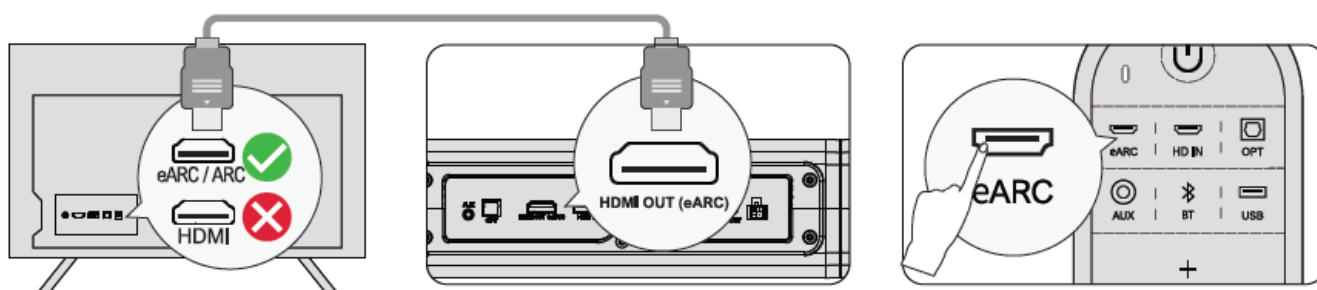

1. Step 1: Connect one end of the HDMI cable to the eARC / ARC port on the back of your TV.

2. Step 2: Then connect the other end into the HDMI OUT(eARC) port of the soundbar.
3. Step 3: Press the “eARC” button on the remote control to select “eARC” input.

## CONNECT TO OTHER DEVICE VIA HDMI IN

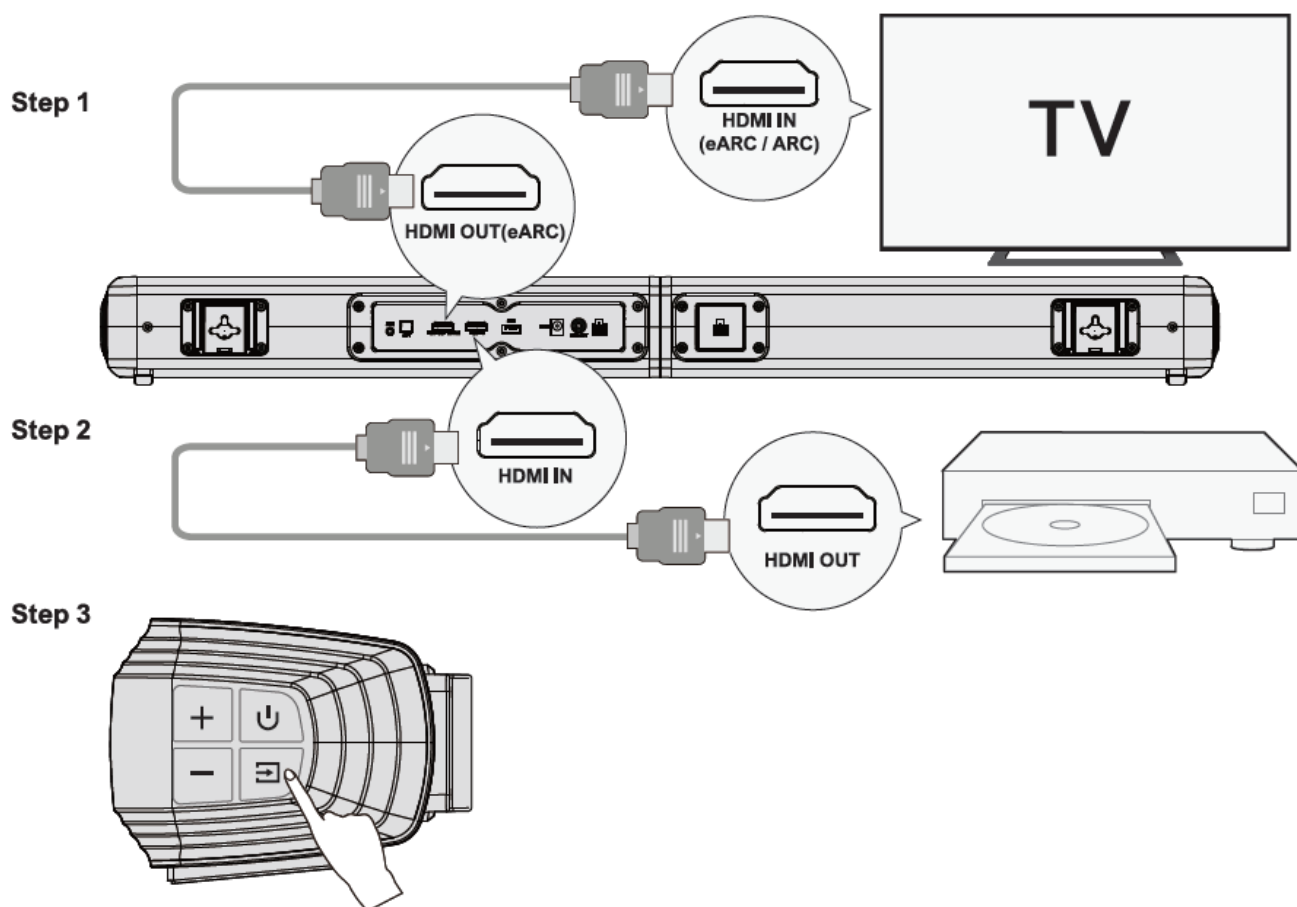

1. Step 1: Connect the HDMI Cable to the HDMI OUT (eARC) port on the Soundbar and the other end to the HDMI IN (eARC / ARC) port on the TV.
2. Step 2: Connect the HDMI cable to the HDMI OUT port on the other device (Such as DVD or game consol) and the other end to HDMI IN port on the Soundbar.
3. Step 3: Press  button on Soundbar or Remote Control to switch to HDMI IN channel. Note: Your TV HDMI needs to support eARC to transmit the Dolby Atmos audio format to your Soundbar.

## Note

- Make sure your TV HDMI supports eARC, otherwise the Dolby Atmos audio signal cannot be transmitted.
- Atmos: If you are watching movie in the Dolby Atmos format, please set the audio output on your IV to Pass Through: IV Settings > Home > Settings > Sound > Digital Audio Output > Pass Through
- DTS: If you are watching a movie in the DTS format, please set the audio output on your IV to PCM: IV Settings > Home > Settings > Sound > Digital Audio Output > PCM
- What's the difference between: HDMI IN, HDMI ARC, HDMI eARC?
- HDMI IN is a standard HDMI input that allows you to connect devices to your IV or audio system. It supports audio and video signals, but it does not support audio return channel (ARC) or enhanced audio return channel (eARC) functionality. HDMI ARC is a special HDMI port that supports two-way communication between your IV

and audio system. This means that audio can be sent from your IV to your audio system, and audio system can send audio back to your IV.

- HDMI eARC (Enhanced Audio Return Channel) is an updated version of HDMI ARC that supports higher quality audio formats such as Dolby Atmos and DTS:X.
- Note: Please turn on the “CEC” function on your TV.
- When eARC / ARC is connected, your IV remote control can control the soundbar and IV simultaneously:
- Turn on/ off 8Adjust the volume

## CONNECT TO TV VIA OPTICAL I AUX



### OPTION 1: OPTICAL



1. Make sure the TV's port is OPTICAL OUT, connect both sides of the cable to OPTICAL, for both the TV and the soundbar
2. Make sure the optical plug is inserted correctly as it shows in the picture. Do not insert the plug upside down and break the optical. Note: If audio is coming from the internal TV speakers, mute or minimize the TV volume

### OPTION 2: AUX

1. Connect the 3.5mm to RCA audio cable to connect to your TV's RCA AUDIO OUT port.
2. Make sure the color of the cables ends matches the color of the TV ports. Note: Please remember to unplug the AUX cable from TV and Soundbar when you want to switch other mode.

In Optical Mode: If there is no sound, try setting the TV audio output to PCM: TV Settings > Home > Settings > Sound > Digital Audio Output > PCM

## CONNECT TO BLUETOOTH'

1. Press the  button on the soundbar or press the “” button on the remote control to enter Bluetooth pairing mode.
2. Go to the Bluetooth setting on your phone, find and select “Apollo S60” to connect the soundbar. Note: If it's

already in the Bluetooth mode and connected, press and hold “” button for 3 seconds to disconnect current device and choose to connect to a new device manually on your mobile phone / PC / TV.

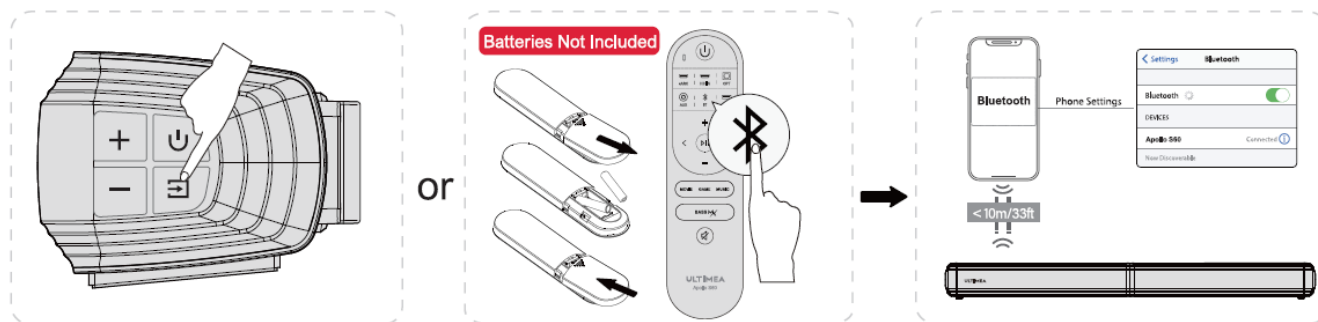

## PLACEMENT OPTIONS

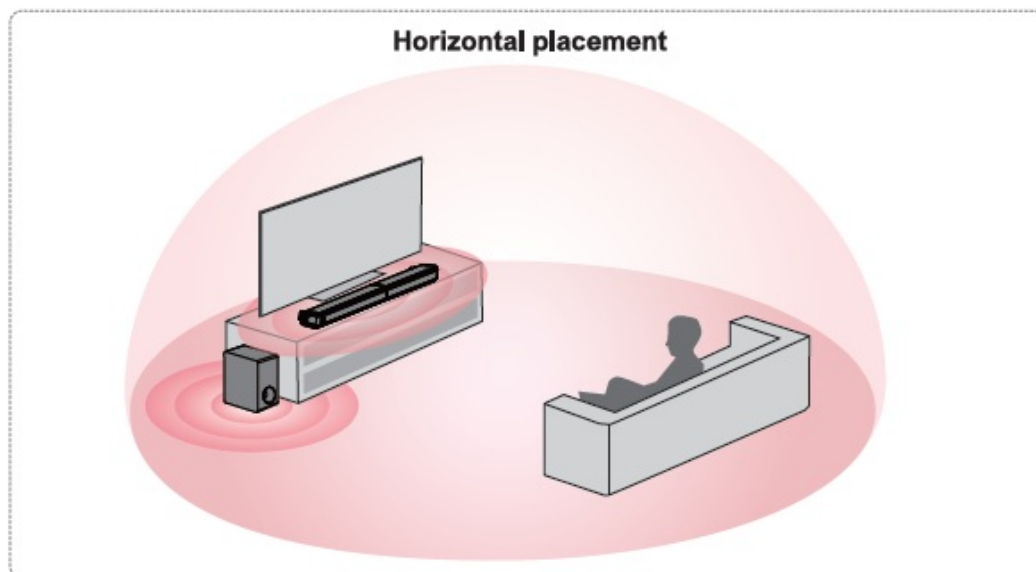
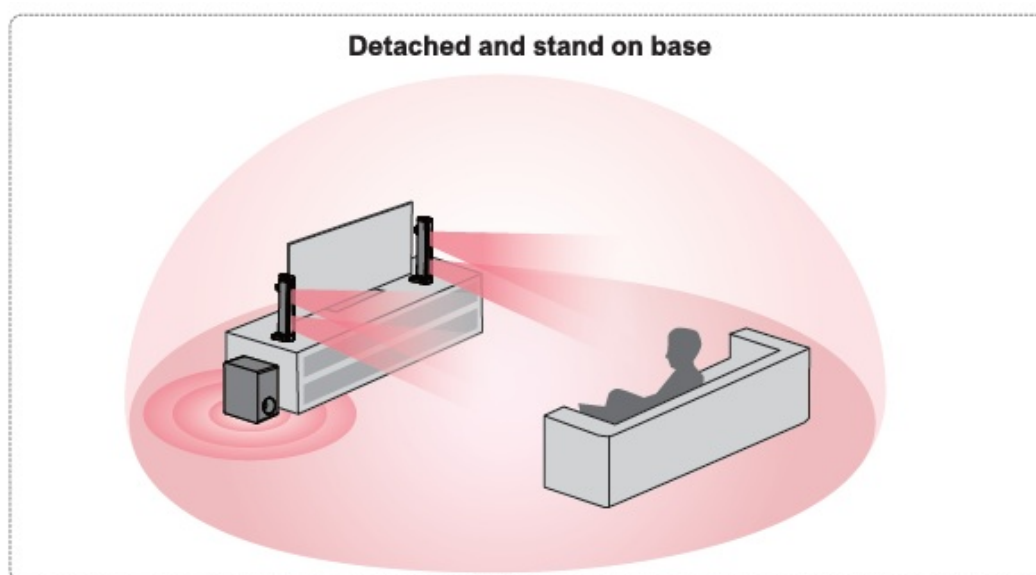

**Note:** The soundbar should be placed at or near ear level.

## WALL MOUNT INSTALLATION



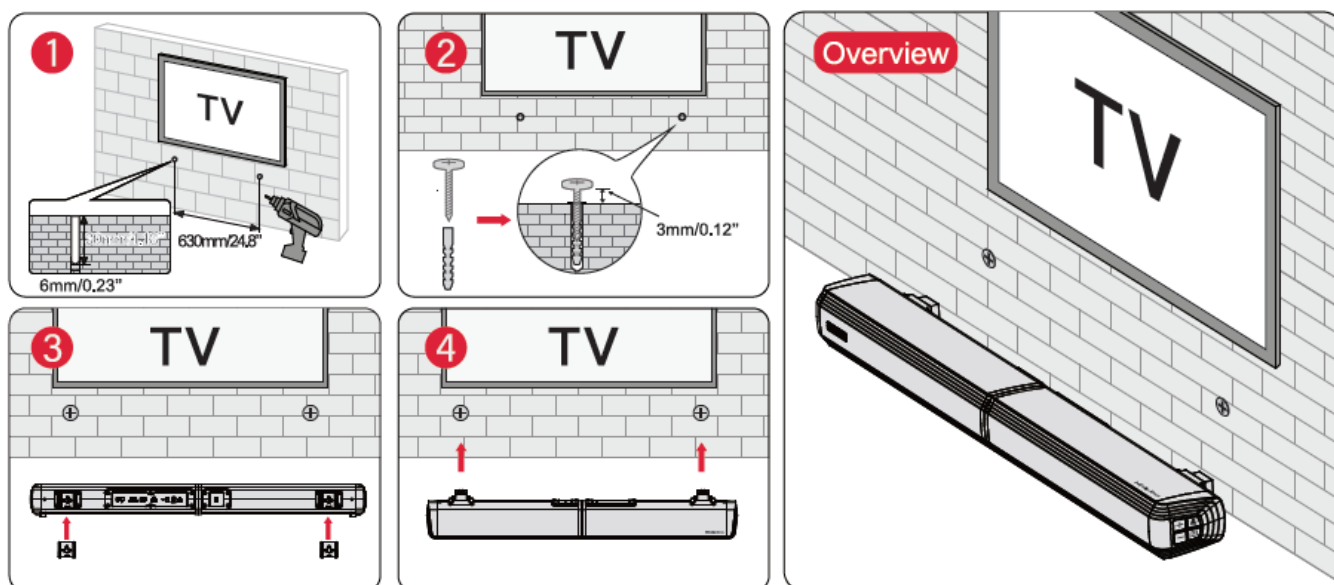

## SPECIFICATIONS

<b>Model Number</b>	U3620
<b>Power Supply</b>	AC 100-240V, -50/60Hz
<b>Soundbar Drivers</b>	2.25"x 4(Soundbar) + 5.25"(Subwoofer)
<b>Frequency Response</b>	45Hz- 18kHz
<b>Standby Power</b>	<0.5W
<b>Operating Temperature</b>	0°C – 45°C/32°F – 113°F
<b>Bluetooth Vision</b>	5.3

Dimensions and Weight		
<b>Soundbar</b>	811(W) x 98(0) x 70(H)	31.9" X 3.9" X 2.8"
<b>Subwoofer</b>	270(W) x 115(0) x 270(H)	10.6" X 4.5" X 10.6"
<b>Packaging</b>	436(W) x 306(0) x 236(H)	17.2" X 12.15" X 9.3"
<b>Net Weight</b>	4.6kg / 10.141bs	
<b>Gross Weight</b>	6.7kg / 14.771bs	

## SAFETY INSTRUCTIONS

Please read this user manual carefully and save it for future reference.

Do not make unauthorized alterations to the product, doing so may compromise safety, regulatory compliance, system performance, and may void the warranty.

- Avoid dropping.
- Do not disassemble.
- Do not submerge in water
- Avoid extreme temperatures.

- Do not use the device outdoors during thunderstorms.
- Use original or certified cables.
- Do not place dangerous items on top of this device (e.g. liquid filled objects, lit candles).
- Clean with a dry, soft lint-free cloth. Do not use any corrosive cleaner or oil.
- To avoid hearing damage, do not listen for extended periods at high volume.
- Do not expose the batteries to extreme heat sources such as direct sunlight or open flames.
- The ideal operating temperature for this product and its accessories is between 41 °F/5°C and 95°F/35°C.
- The adapter should be installed near the device and should be easily accessible.
- Do not use this product in environments of extreme heat or cold. Never expose this device to strong sunshine or wet environments.

## PROPER DISPOSAL INSTRUCTIONS

This mark shown on the product or its packaging, indicates that this product should not be disposed of with other household waste at the end of its working life.

To prevent possible harm to the environment or human health from uncontrolled waste disposal, please separate this from other types of wastes and recycle it responsibly to promote the sustainable reuse of material resources.



### Waste Electrical & Electronic Equipment

Household user should contact either the retailer where they purchased this product, or their local government office, for details of where and how they can take this item for environmentally safe recycling.

Business users should contact their suppliers and check the terms and conditions of the purchase contract. This product should not be mixed with other commercial wastes for disposal.

## FCC REGULATORY COMPLIANCE

Any changes or modifications not expressly approved by the party responsible for compliance could void the user's authority to operate the equipment. This device complies with Part 15 of the FCC Rules. Operation is subject to the following two conditions:

1. This device may not cause harmful interference.
2. This device must accept any interference received, including interference that may cause undesired operation

**NOTE:** This equipment has been tested and found to comply with the limits for a Class B digital device, pursuant to part 15 of the FCC Rules. These limits are designed to provide reasonable protection against harmful interference in a residential installation. This equipment generates, uses, and can radiate radio frequency energy, and if not installed and used in accordance with the instructions, may cause harmful interference to radio communications. However, there is no guarantee that interference will not occur in a particular installation. If this equipment does cause harmful interference to radio or television reception, which can be determined by turning the equipment off and on, the user is encouraged to try to correct the interference by one or more of the following measures:

- Reorient or relocate the receiving antenna
- Increase the separation between the equipment and the receiver.

- Connect the equipment to an outlet on a circuit different from that to which the receiver is connected
- Consult the dealer or an experienced radio / TV technician for help.

This equipment complies with FCC radiation exposure limits set forth for an uncontrolled environment. This equipment should be installed and operated with a minimum distance of 20cm between the radiator & your body. This transmitter must not be co-located or operating in conjunction with any other antenna or transmitter.

## **ISED WARNINGS**

This device contains licence-exempt transmitter (s) / receiver (s) that comply with Innovation, Science and Economic Development Canada's licence-exempt RSS (s). Operation is subject to the following two conditions:

1. This device may not cause interference.
2. This device must accept any interference, including interference that may cause undesired operation of the device.

The device meets the exemption from the routine evaluation limits in section 2.5 of RSS 102 and compliance with RSS-102 RF exposure, users can obtain Canadian information on RF exposure and compliance.

This transmitter must not be co-located or operating in conjunction with any other antenna or transmitter. This equipment should be installed and operated with a minimum distance of 20 centimeters between the radiator and your body.

## **Declaration of Conformity**

- We (Manufacturer is responsible for this declaration)
- Dynanic (Shenzhen) Technology Limited (Company name)
- 20th Floor, Building 4, Tianan Cloud Park, Bantian St.,
- Longgang District Shenzhen, China 518000 (Company address)
- Declare under our sole responsibility that the product
- Trade Mark: UL TIMEA
- Product Name: Apollo S60 4.1 Channel Dolby Atmos
- Detachable Soundbar
- Model No.: U3620
- To which this declaration relates is in conformity with the essential requirement set out in the Council Directive on the Approximation of the laws of the Member States relating to RED Directive (2014/53/EU) & RoHS (2011/65/EU) product is responsible to affix CE marking, the following standards were applied:

## **Trade Marks**

- 141 Dolby Atmos
- EN 55032:2015/A11:2020
- EN 55035:2017/A11:2020
- ENIEC 61000-3-2:2021
- EN 61000-3-3:2013/A 1 :2021
- ETSIEN 301 489-1 V2.2.3(2019-11)
- ETSIEN 301 489-17 V3.2.4(2020-09)
- EN 300 328 V2.2.2(2019-07)
- EN 50663:2017

- ENIEC 62368-1:2020+A11:2020
- IEC62321-3-1 :2013
- IEC 62321-4:2013+A1:2017
- IEC 62321-5:2013
- IEC 62321-6:2015
- IEC 62321-7-1:2015
- IEC 62321-7-2:2017
- IEC 62321-8:2017
- Full Name: Yoyo.Yu
- Position: Approbation Manager
- Signature: .,,-,- ;,-,-
- Place/Date: Shenzhen, China / Dec. 25-2023
- Dolby, Dolby Atmos, and the double-D symbol are registered trademarks of Dolby Laboratories Licensing Corporation. Manufactured under license from Dolby Laboratories. Confidential unpublished works.

Dolby, Dolby Atmos, and the double-D symbol are registered trademarks of Dolby Laboratories Licensing Corporation. Manufactured under license from Dolby Laboratories. Confidential unpublished works. Copyright© 2012-2021 Dolby Laboratories. All rights reserved.

The Bluetooth® word mark and logos are registered trademarks owned by Bluetooth SIG, Inc. and any use of such marks by Soundlab Technology Co.,Ltd. is under license. Other trademarks and trade names are those of their respective owners.

The Adopted Trademarks HDMI, HDMI High-Definition Multimedia Interface, HDMI trade dress and the HDMI Logos are trademarks or registered trademarks of HDMI Licensing Administrator, Inc. in the United States and other.

- Apollo S60 4.1 Channel Dolby Atmos Detachable Soundbar
- Model No.: U3620
- I EC I REPI Dynanic GmbH
- Buchenring 57, 22359 Hamburg, Germany
- I UK I REPI UK Crossborder limited
- 7 Bell Yard London WC2A 2JR, UK United Kingdom

## **Made in China**

- Manufacturer: Dynanic (Shenzhen) Technology Limited
- Address: 20th Floor, Building 4, Tianan Cloud Park, Bantian St.,
- Longgang District, Shenzhen, China 518000



If you need our support, kindly reach out to our service team. We are always glad to help.

+1 [888-598-8875](tel:888-598-8875) (US) Mon-Fri 9am-5pm (PST)

+49 89-628-25828 (EU)

Mon-Fri 9am-5pm (CET)

[support@ultimea.com](mailto:support@ultimea.com)  
[support@ultimea.de](mailto:support@ultimea.de)  
[support.ultimea.com](mailto:support.ultimea.com)  
[support.ultimea.de](mailto:support.ultimea.de)



Documents / Resources

	<p><a href="#">ULTIMEA Apollo S60 Detachable Sound Bar</a> [pdf] User Manual</p> <p>Apollo S60 Detachable Sound Bar, Apollo S60, Detachable Sound Bar, Sound Bar</p>
---	--

References

- [User Manual](#)

[Manuals+.](#) [Privacy Policy](#)

This website is an independent publication and is neither affiliated with nor endorsed by any of the trademark owners. The "Bluetooth®" word mark and logos are registered trademarks owned by Bluetooth SIG, Inc. The "Wi-Fi®" word mark and logos are registered trademarks owned by the Wi-Fi Alliance. Any use of these marks on this website does not imply any affiliation with or endorsement.