

[Skip to content](#)

Manuals+

User Manuals Simplified.



ULSee AI Monitor iOS Apps User Guide

[Home](#) » [ULsee](#) » **ULSee AI Monitor iOS Apps User
Guide**



**AI Monitor iOS Apps
User Guide
Download and Install the AI Monitor iOS
App**

AI Infrared Monitor System All-In-One ULTI-A100

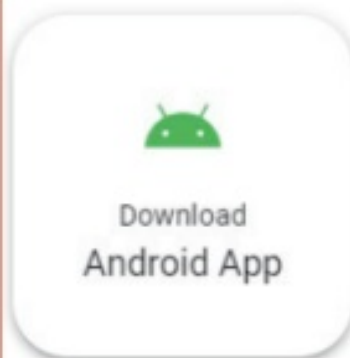
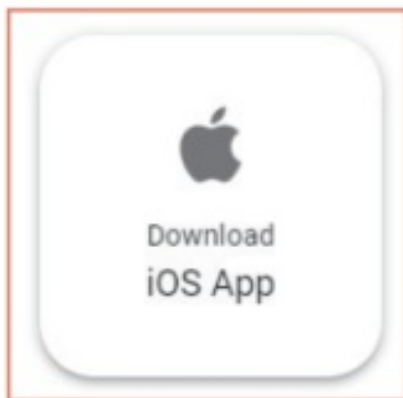
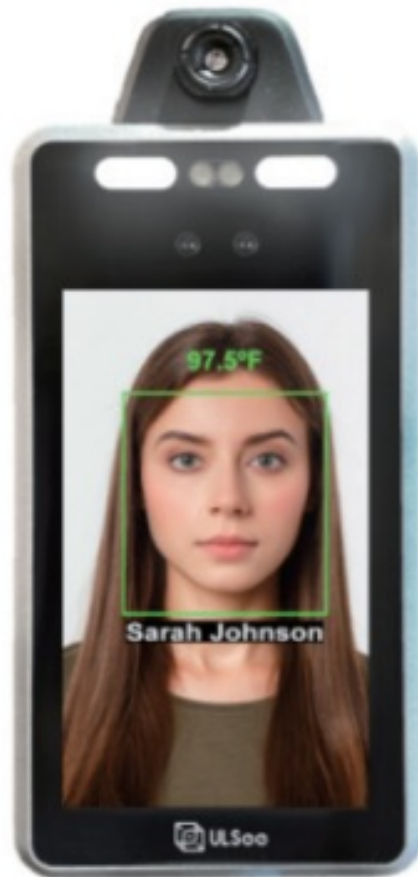

Tap on Download iOS App

Contents [hide](#)

[1 Software Configuration \(iOS\)](#)

[2 Log in with Admin Credentials](#)

[3 Revealing the Function Menu](#)

[4 Hiding the Function Menu](#)

[5 Logging out of the Admin Account](#)

[6 Download and Install the AI Monitor Android App](#)

[7 Revealing the Function Menu](#)

[8 Hiding the Function Menu](#)

[9 Logging out of the Admin Account](#)

[10 Documents / Resources](#)

[10.1 References](#)

[11 Related Posts](#)

Software Configuration (iOS)

Connect to ULTI-A100 using the ULTI-

The screenshot shows a mobile application interface for the "AI Infrared Monitor System". At the top, the status bar displays "No SIM", signal strength, the time "11:06 AM", and a battery level of "11%". Below the status bar is a header with the title "AI Infrared Monitor System". The main content area features a label "IP Address:" followed by a text input field containing the IP address "192.168.11.122". Below the input field is a blue button labeled "Connect".

A100's IP Address

- a) Enter the ULTI-A100's IP address in the IP Address field. If there is a port number, add it at the end of the URL with a prefix.
- b) Tap on the Connect button

Log in with Admin Credentials

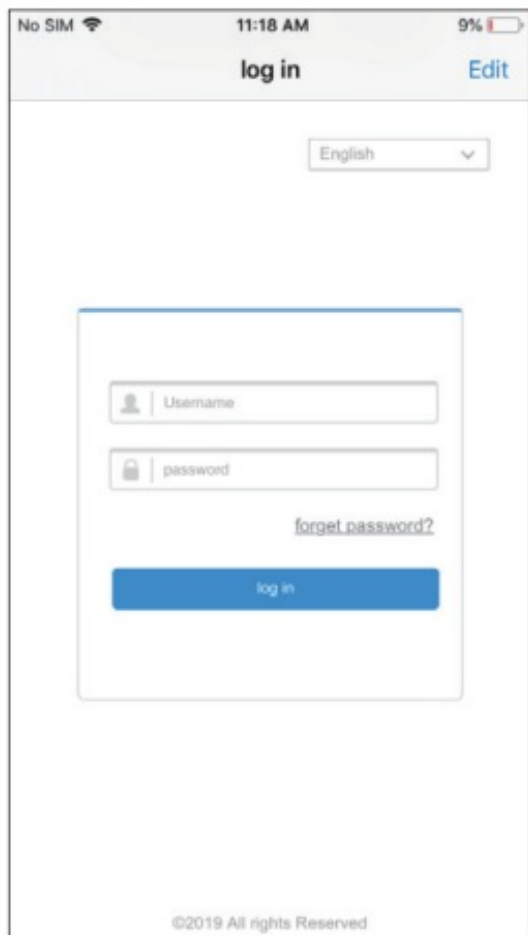

Mobile app login screen (English). The screen shows a language dropdown menu set to "English". Below it is a login form with fields for "Username" and "password", a "forget password?" link, and a "log in" button. The status bar at the top shows "No SIM", signal strength, time "11:18 AM", and battery level "9%". The footer says "©2019 All rights Reserved".

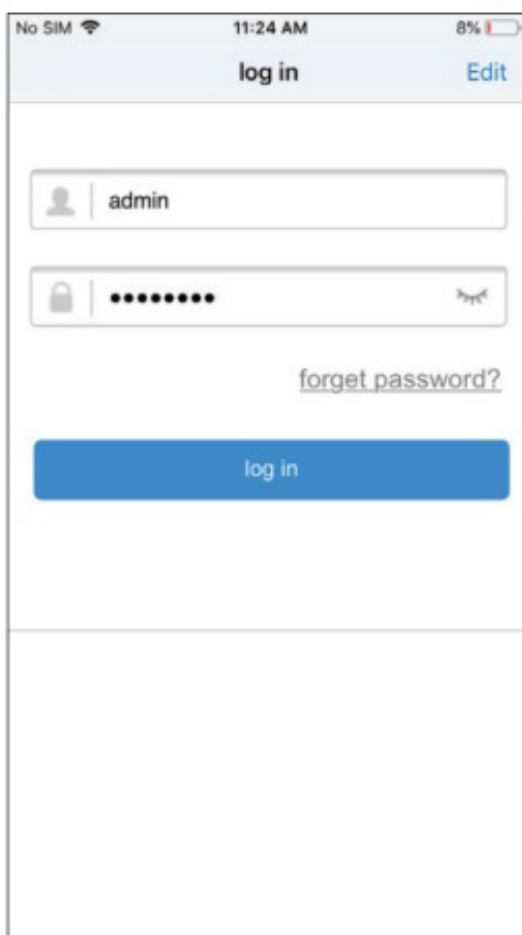

Mobile app login screen (Admin). The screen shows a login form with fields for "admin" (username) and "admin123" (password), a "forget password?" link, and a "log in" button. The status bar at the top shows "No SIM", signal strength, time "11:24 AM", and battery level "8%". The footer says "©2019 All rights Reserved".

Type in username admin, password admin123 and click on log in.

Viewing the Live Video Stream of an AI Infrared Monitor ULTI-A100 Unit

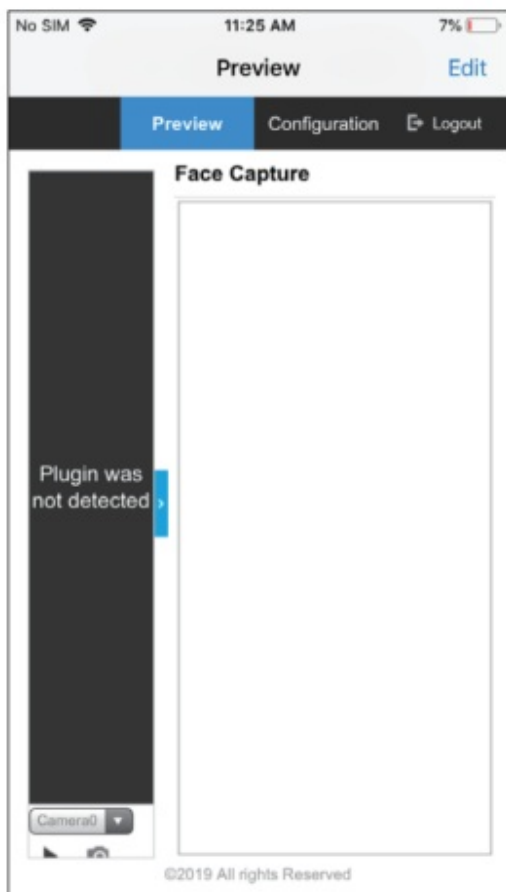

Mobile app preview screen. The screen shows a "Face Capture" section with a video stream. A message "Plugin was not detected" is displayed on the left. The status bar at the top shows "No SIM", signal strength, time "11:25 AM", and battery level "7%". The footer says "©2019 All rights Reserved".

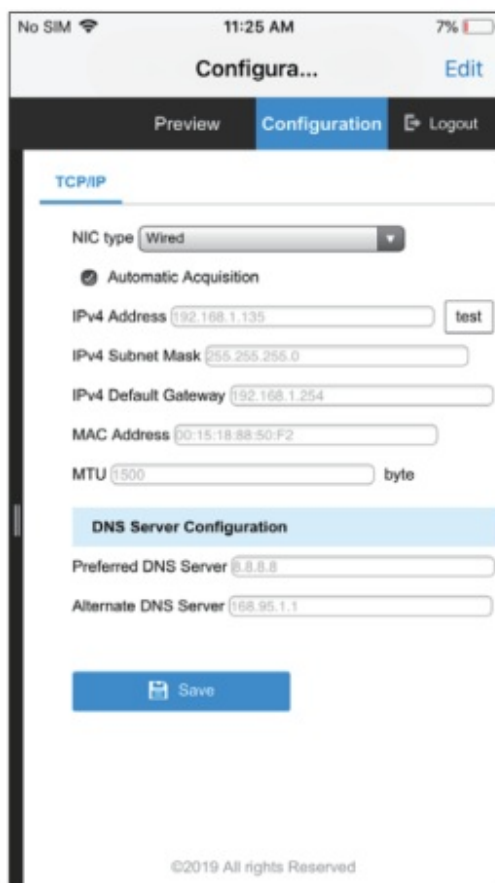

Mobile app configuration screen. The screen shows a "Configuration" section with fields for "NIC type" (Wired), "Automatic Acquisition" (checked), "IPv4 Address" (192.168.1.135), "IPv4 Subnet Mask" (255.255.255.0), "IPv4 Default Gateway" (192.168.1.254), "MAC Address" (00:15:18:88:50:F2), and "MTU" (1500). Below these are "DNS Server Configuration" fields for "Preferred DNS Server" (8.8.8.8) and "Alternate DNS Server" (168.95.1.1). A "Save" button is at the bottom. The status bar at the top shows "No SIM", signal strength, time "11:25 AM", and battery level "7%". The footer says "©2019 All rights Reserved".

- Tap on Preview to view the live video stream from an AI Infrared Monitor ULTI-A100 units camera, choose the camera from the drop-down menu from the bottom-left set of controls, and tap on the button.
- Tap on Confi guration to switch from the Preview screen to the Confi guration screen

Revealing the Function Menu

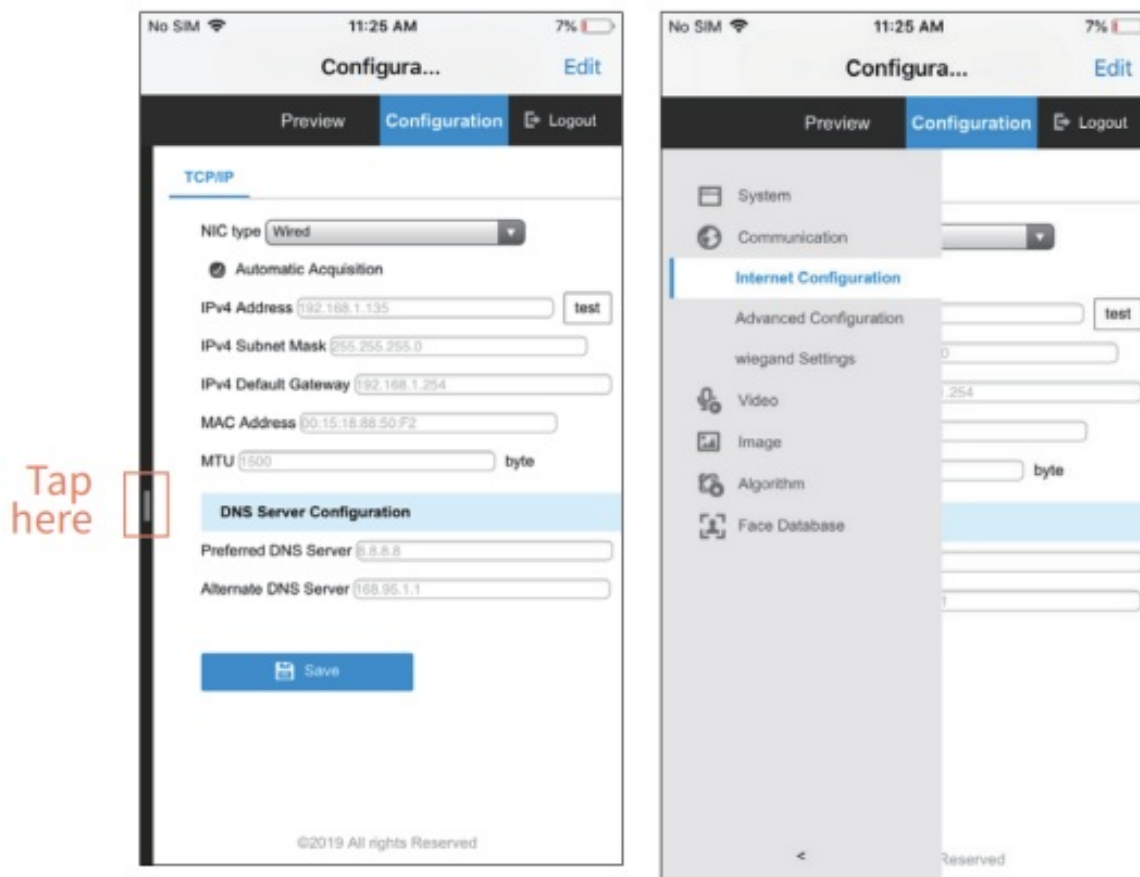

Tap on to reveal the function menu, because the function menu is Tap on to reveal the function menu, because the function menu is hidden by default

Hiding the Function Menu

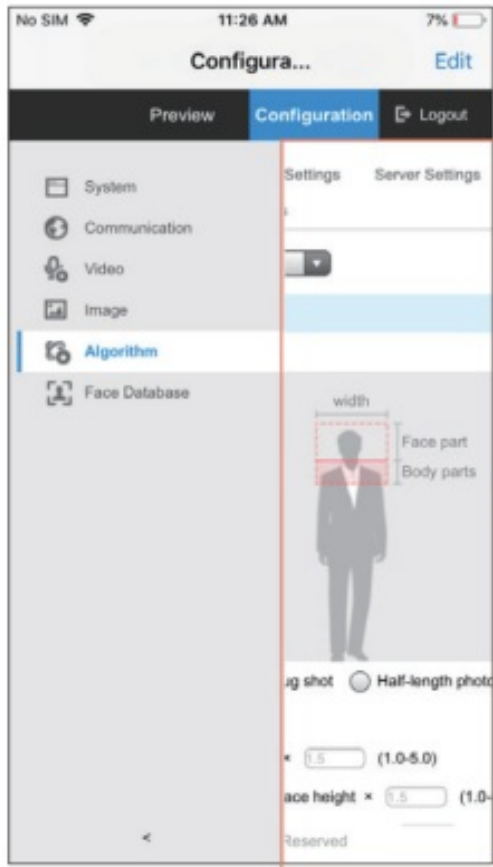

Tap on
this
region

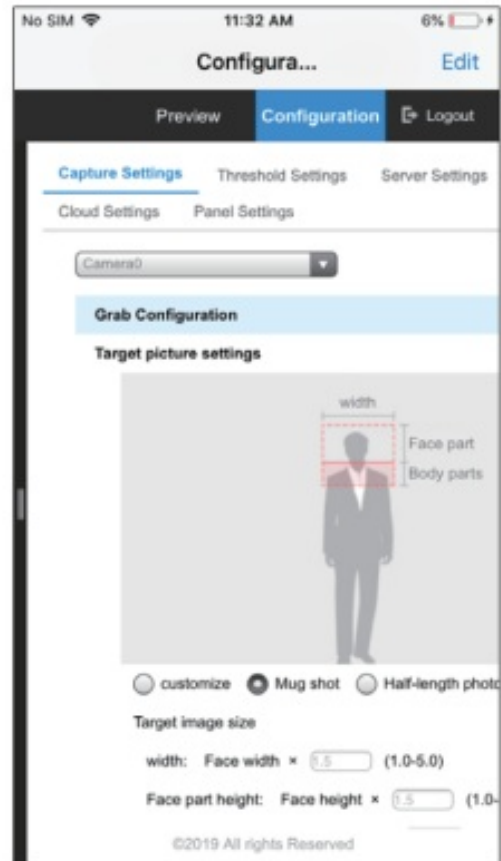

Tap on the right pane to hide the function menu

Logging out of the Admin Account

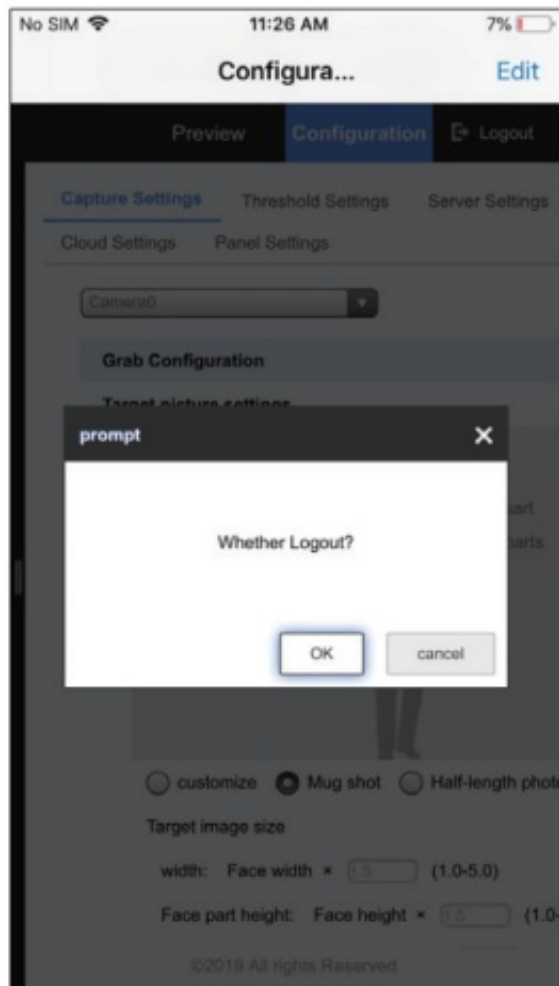
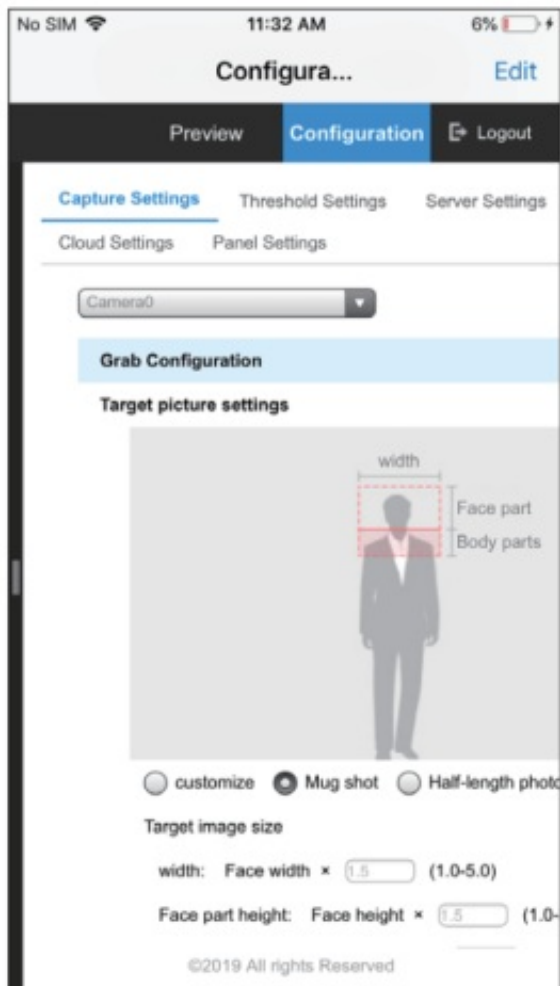

Tap on Logout on the upper-right corner to log out of the admin account

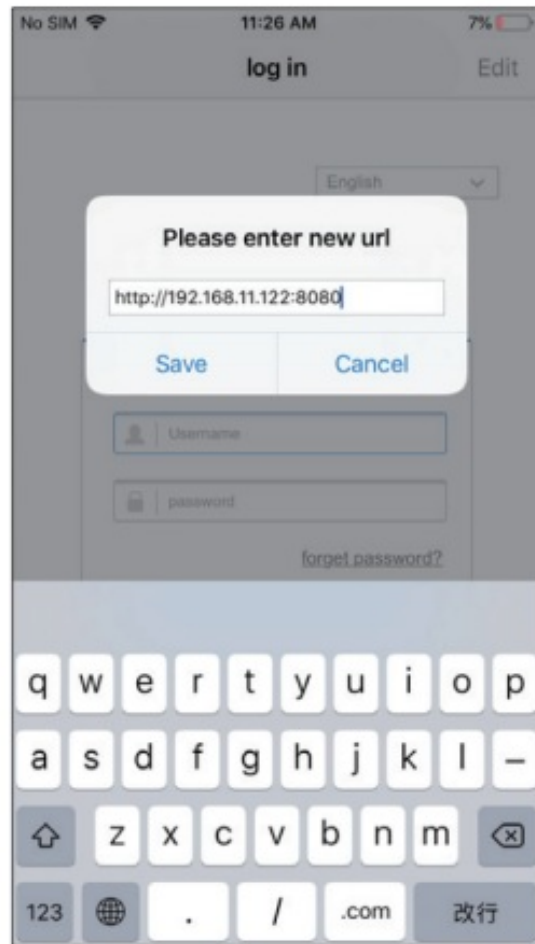
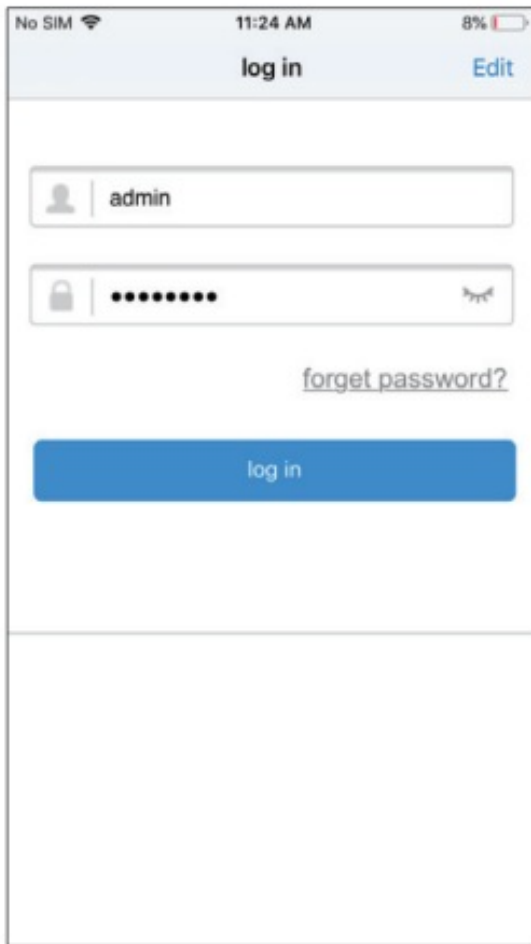

Tap on Edit in the upper-right corner to change the IP address needed to connect to the ULTI-A100, if required. If there is a port number, add it at the end of the URL with a prefix.

Software Configuration (Android)



Open the All-in-One ULTI-A100 Product Page

Enter URL <https://tinyurl.com/y6nu4x9w> into a Web browsers Address field or scan the QR code above, to quickly access the AI Monitor Product Page

Download and Install the AI Monitor Android App

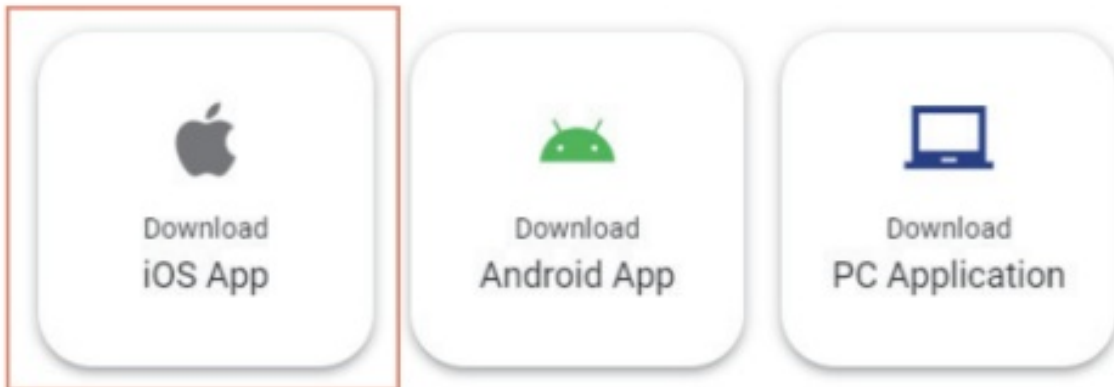
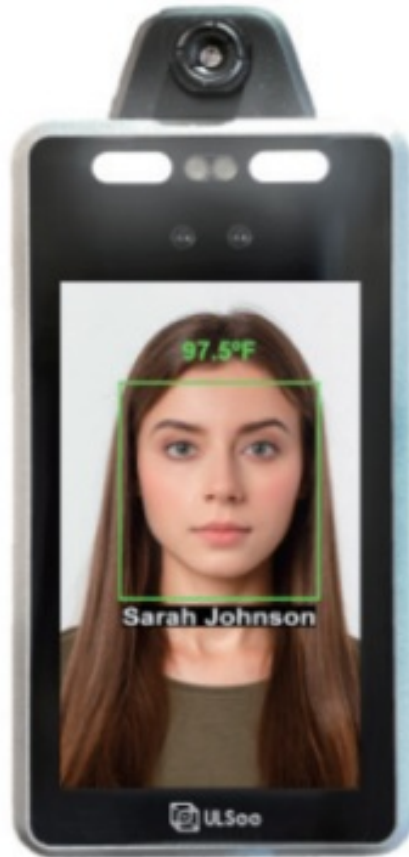

Tap on Download Android App

Connect to ULTI-A100 using the ULTI A100s IP Address

11:47

58%

AI Infrared Monitor System

IP Address

192.168.11.122

CONNECT

a) Enter the ULTI-A100s IP address in the IP Address field. If there is a port number, add it at the end of the URL with a prefix.

b) Tap on the Connect button

Log in with Admin Credentials

11:50 57%

AI Infrared Monitor System

EDIT

English

Username

password

[forget password?](#)

log in

©2019 All rights Reserved

11:52 56%

AI Infrared Monitor System

EDIT

English

admin

[forget password?](#)

log in

©2019 All rights Reserved

Type in username admin, password admin123 and click on log in.

Viewing the Live Video Stream of an AI Infrared Monitor ULTI-A100 Unit

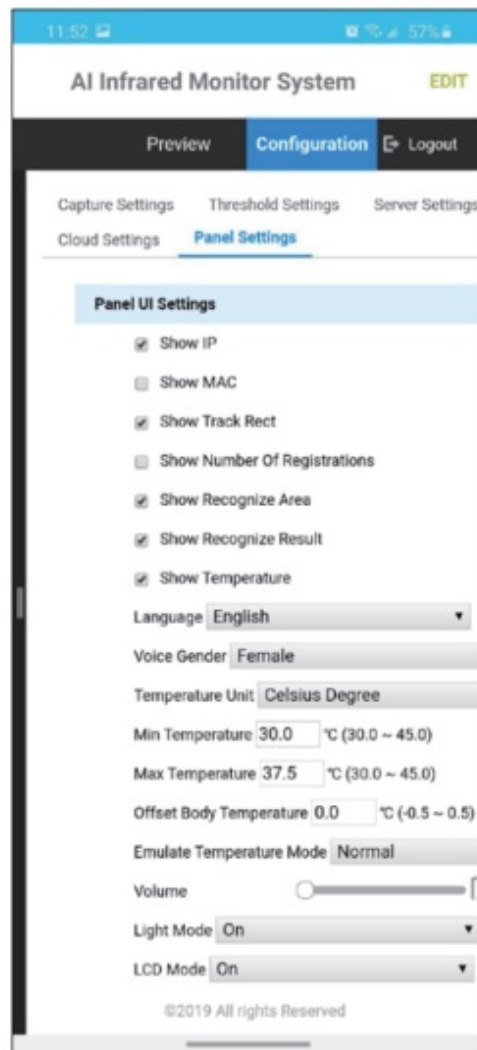
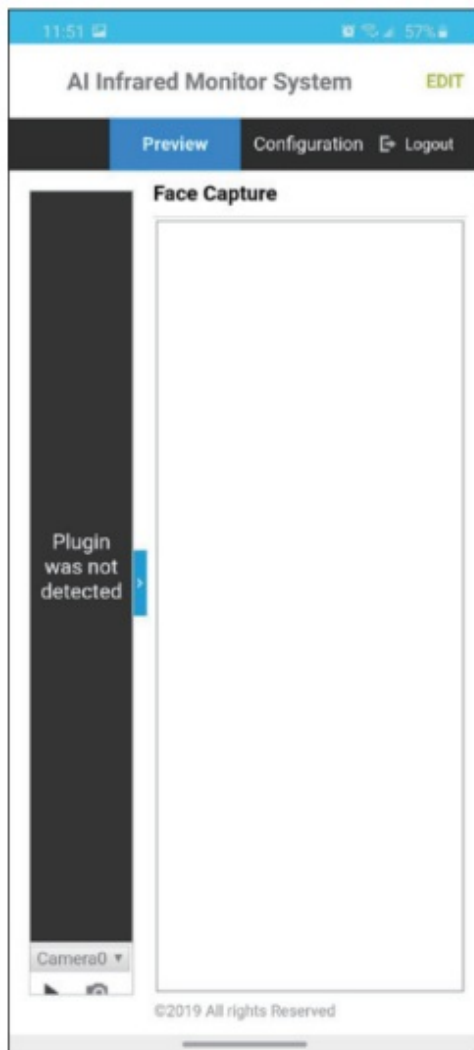

- a) Tap on Preview to view the live video stream from an AI Infrared Monitor ULTI-A100 units camera, choose the camera from the drop-down menu from the bottom-left set of controls and tap on the button.
- b) Tap on Configuration to switch from the Preview screen to the Configuration screen

Revealing the Function Menu

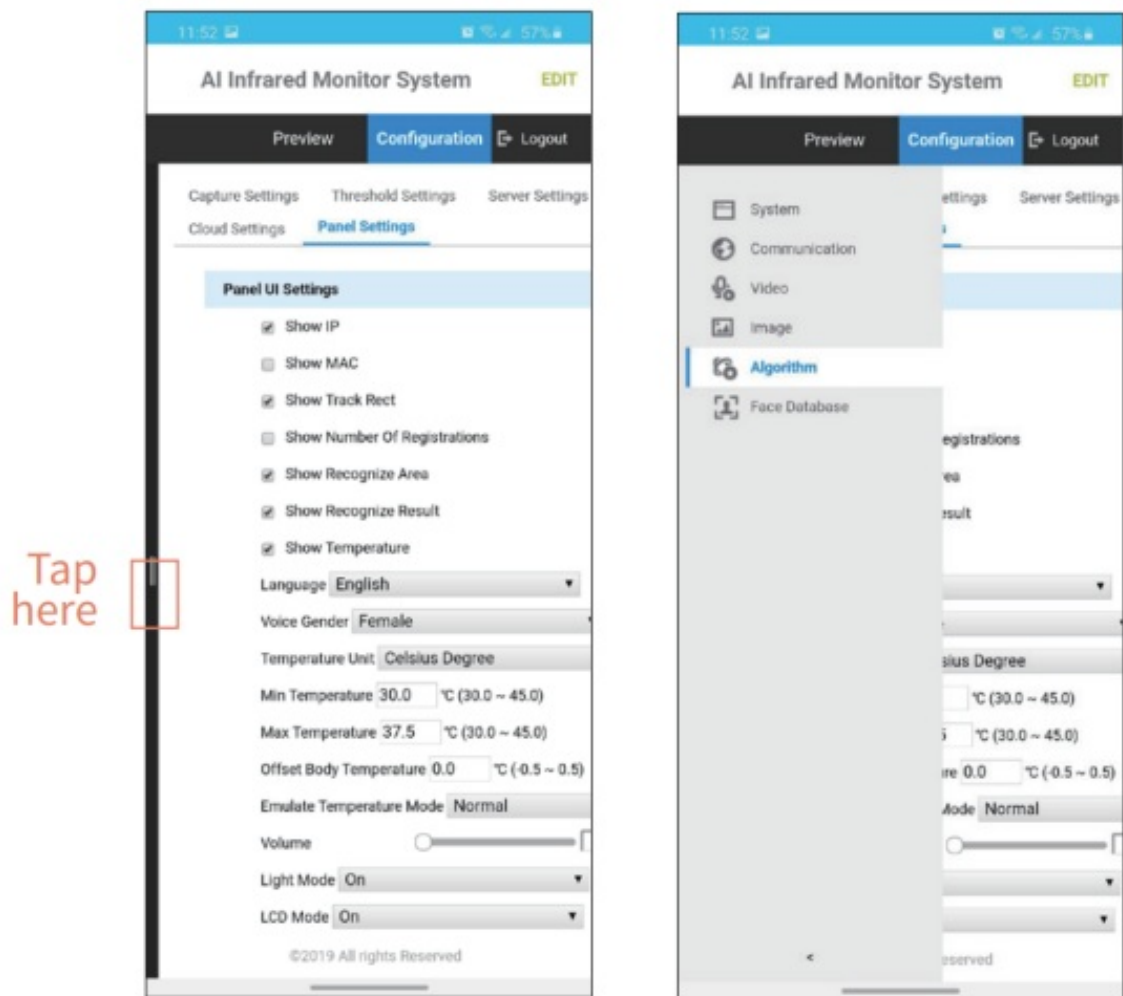

Tap on to reveal the function menu, because the function menu is hidden by default

Hiding the Function Menu

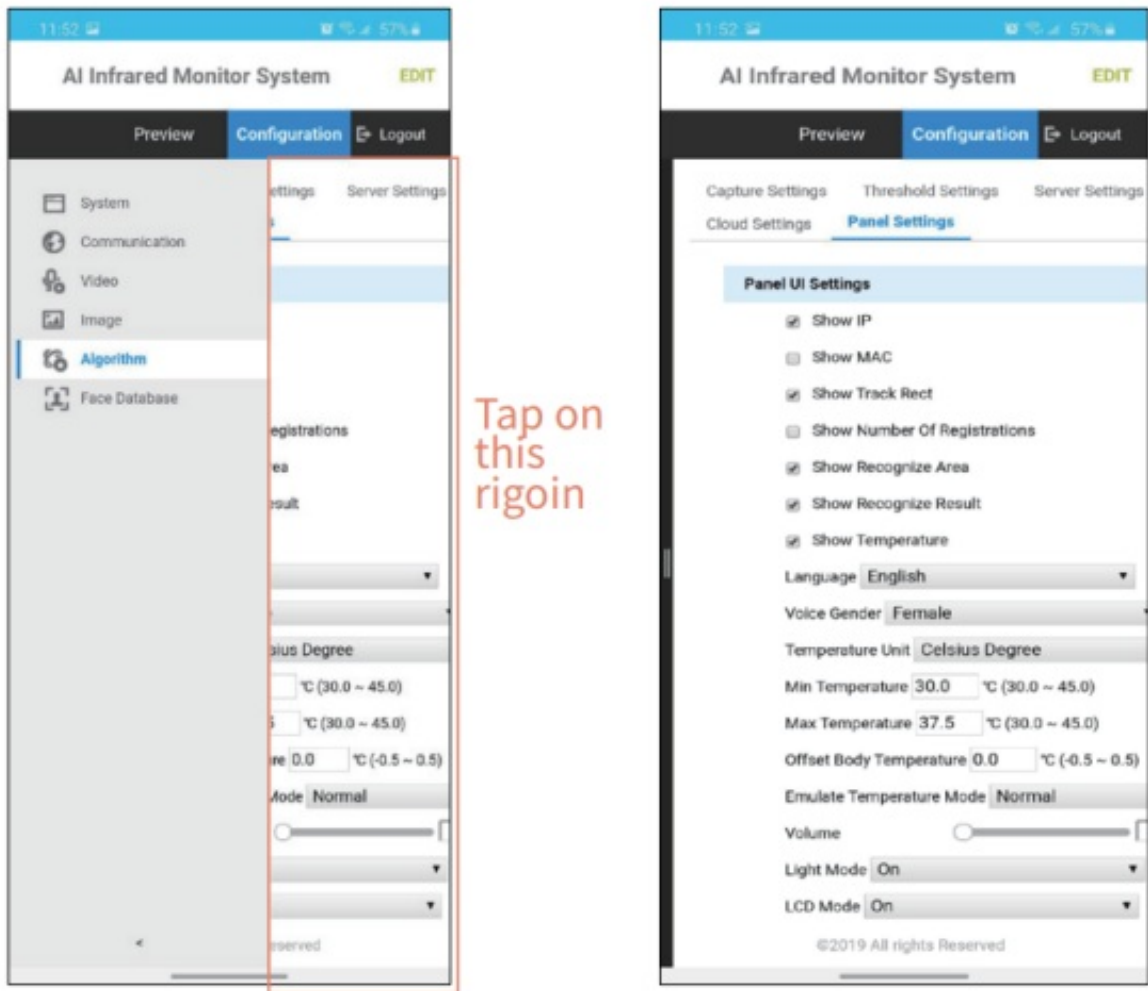

Tap on the right pane to hide the function menu

Logging out of the Admin Account

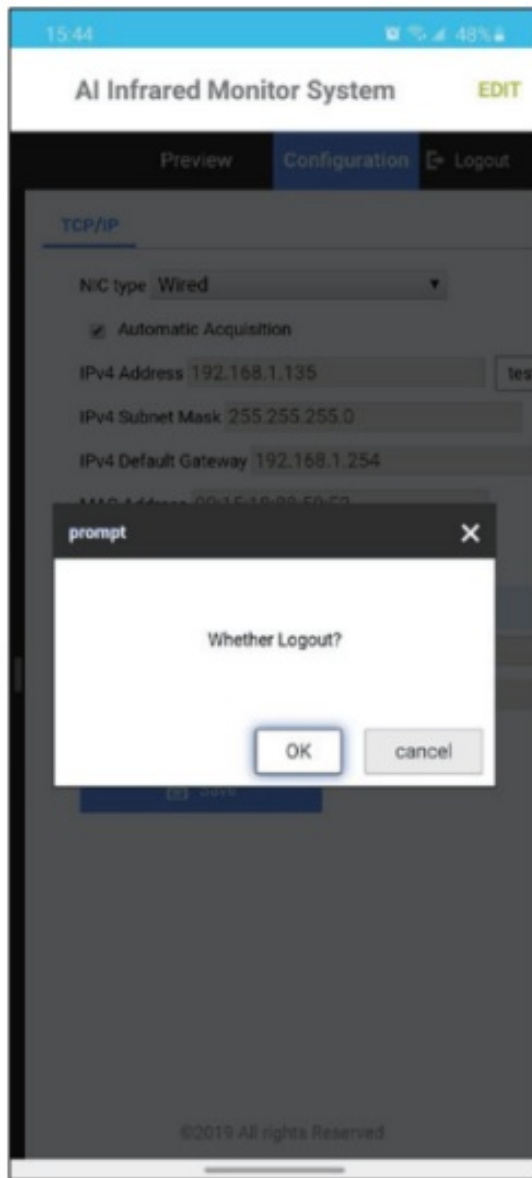
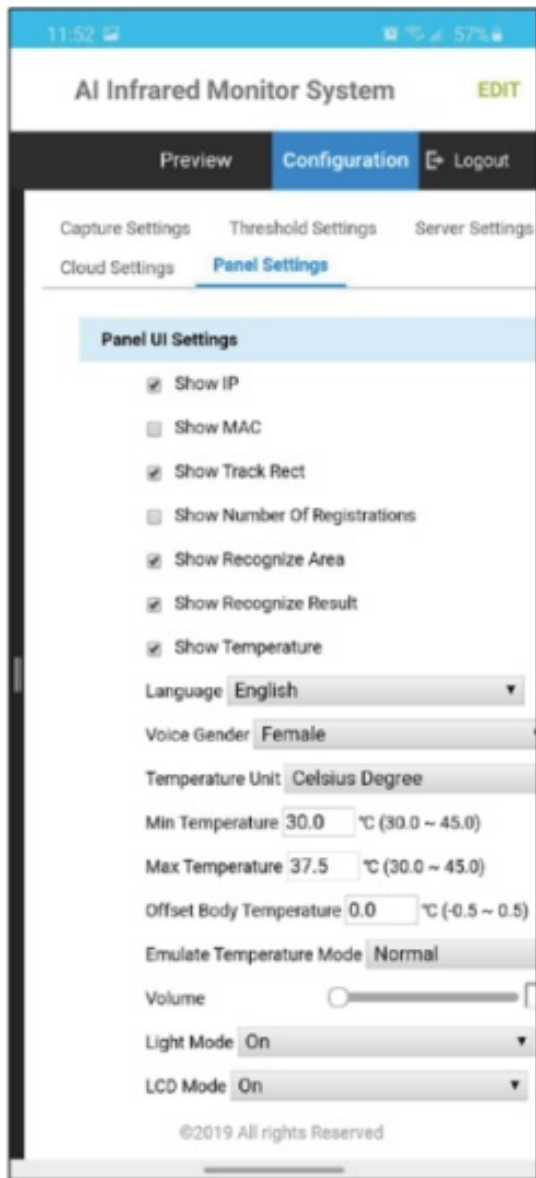

Tap on Logout in the upper-right corner to log out of the admin account

Optional

Changing the IP Address Needed to Connect to ULTI-A100

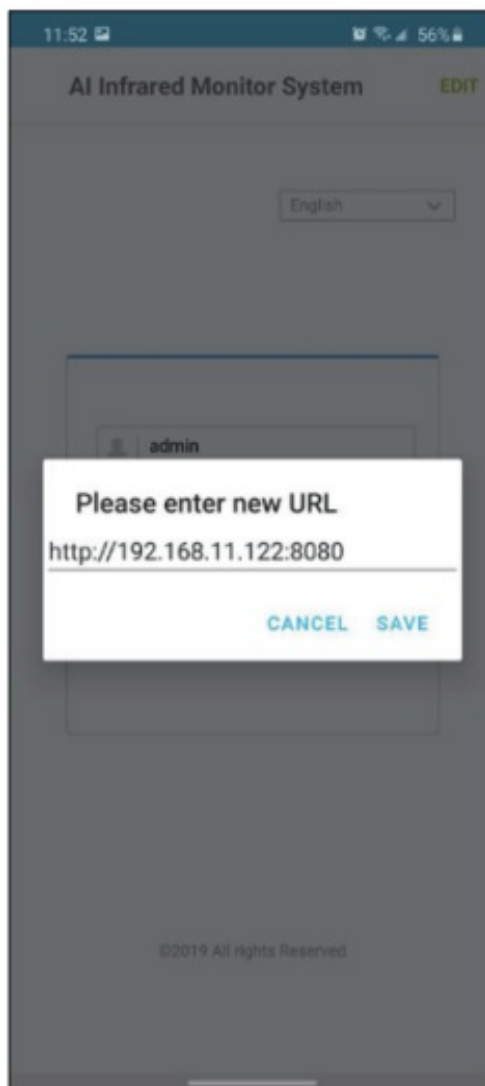
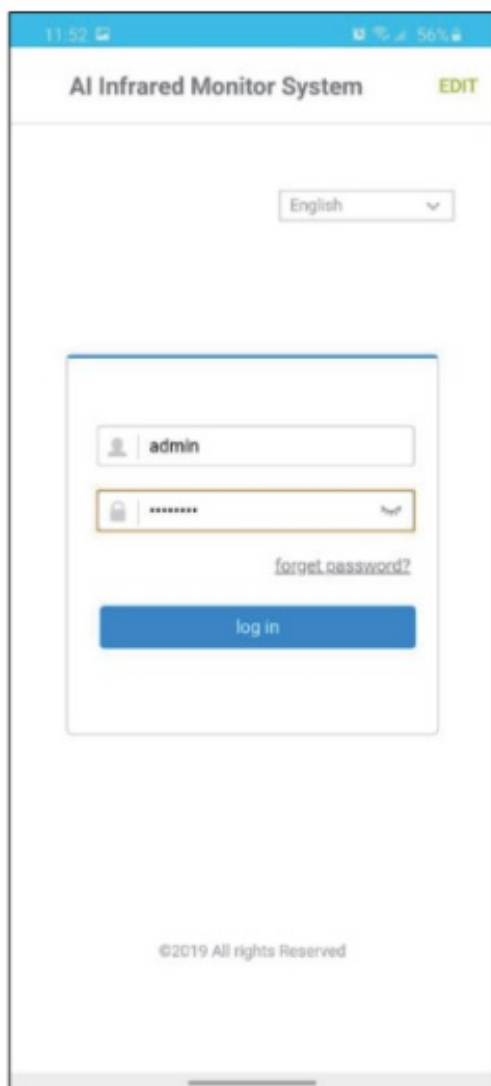

Tap on Edit on the upper-right corner to change the IP address needed to connect to the ULTI-A100, if required. If there is a port number, add it at the end of the URL with a prefix.

The AI Infrared Monitor ULTI-A100 unit is now set up and ready for use Notification

This device complies with Part 15 of the FCC Rules. Operation is subject to the following two conditions :

1. this device may not cause harmful interference, and
2. this device must accept any interference received, including interference that may cause undesired operation.

The distance between user and device should be no less than 20cm. This equipment has been tested and found to comply with the limits for a Class B digital device, pursuant to Part 15 of the FCC Rules. These limits are designed to provide reasonable protection against harmful interference in a residential installation. This equipment generates uses and can radiate radio frequency energy and, if not installed and used in accordance with the instructions, may cause harmful interference to radio communications. However, there is no guarantee that interference will not occur in a particular installation. If this equipment does cause harmful interference to radio or television reception, which can be determined by turning the equipment off and on, the user is encouraged to try to correct the interference by one or more of the following measures:

- Reorient or relocate the receiving antenna.
- Increase the separation between the equipment and receiver.
- Connect the equipment into an outlet on a circuit different from that to which the receiver is connected.
- Consult the dealer or an experienced radio/TV technician for help.

Changes or modifications not expressly approved by the party responsible for compliance could void the user's authority to operate the equipment.

ULSee Inc.

Address

9F, No.97, June 1st Road, Zhongshan District,

Telephone +886-2-8502-2798

Website <https://ulsee.com/#/>

E-mail service@ulsee.com



Documents / Resources

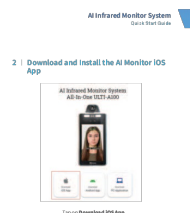

[ULSee AI Monitor iOS Apps](#) [pdf] User Guide

UA100, 2AWAO-UA100, 2AWAOUA100, AI Monitor iOS Apps, AI Monitor iOS, Apps

References

- [AI Infrared Monitor AIO](#)
- [ULSee – ULSee](#)

[Manuals+](#),

- [home](#)
- [privacy](#)