

ULINE Window Folding Security Gate User Guide

[Home](#) » [ULINE](#) » ULINE Window Folding Security Gate User Guide 



H-6937

WINDOW FOLDING SECURITY GATE

1-800-295-5510

ulink.com

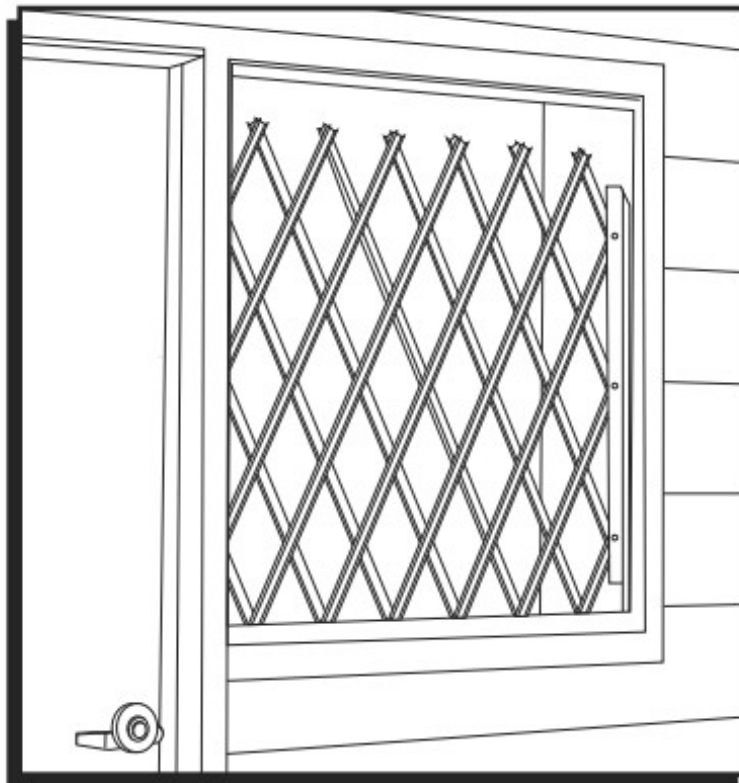

TOOLS NEEDED



Electric
Drill



1/4" Masonry or
Wood Drill Bit



1/2" Socket
Bit

PART INCLUDED

Contents

- 1 [INSTALLATION](#)
- 2 [Documents / Resources](#)
- 3 [Related Posts](#)



Locking Bar

INSTALLATION

Security gates can be installed either inside or outside the frame. It can be mounted on the left or right. Turn the gate upside down to mount on the opposite side.



CAUTION! Pinch Point: Keep hands and fingers out of collapsing gate when handling.

1. Stand gate against the frame where the user intends to mount it. Mark the mounting surface through the holes in the hinge bar with a pencil. Drill mounting holes into the mounting surface. (See Figure 1)

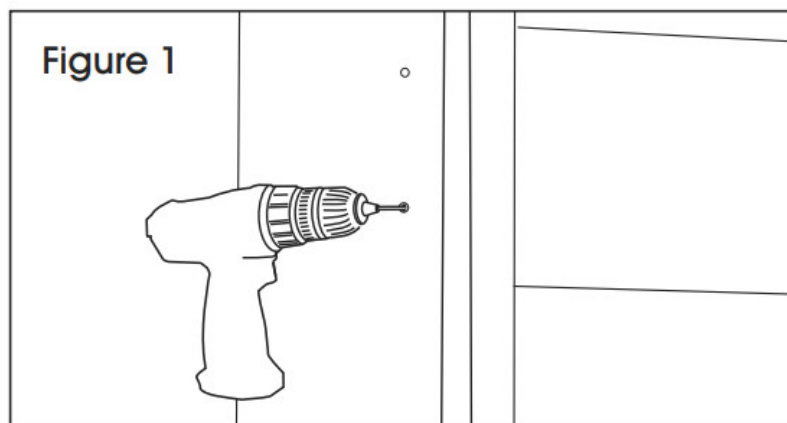

- Wood door frames or walls: 5/16 x 2" lag bolts
 - Steel door frames or walls: Drill and tap for 5/16 x 1" lag bolts
 - Brick or concrete frames or walls: 5/16 x 2" lag bolts set into 3/8" holes with lead anchors
2. Mount the gate by inserting bolts through the hinge bar set into the mounting surface. (See Figure 2)

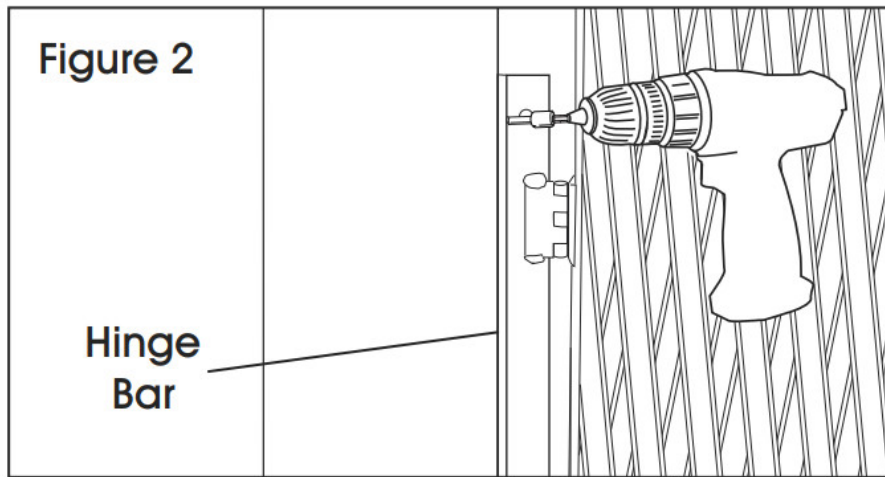

3. Stretch gate across the opening. Place locking bar onto the mounting surface, align padlock holes and mark mounting surface through the holes in the locking bar with a pencil. Drill mounting holes and secure with bolts. (See Figure 3)

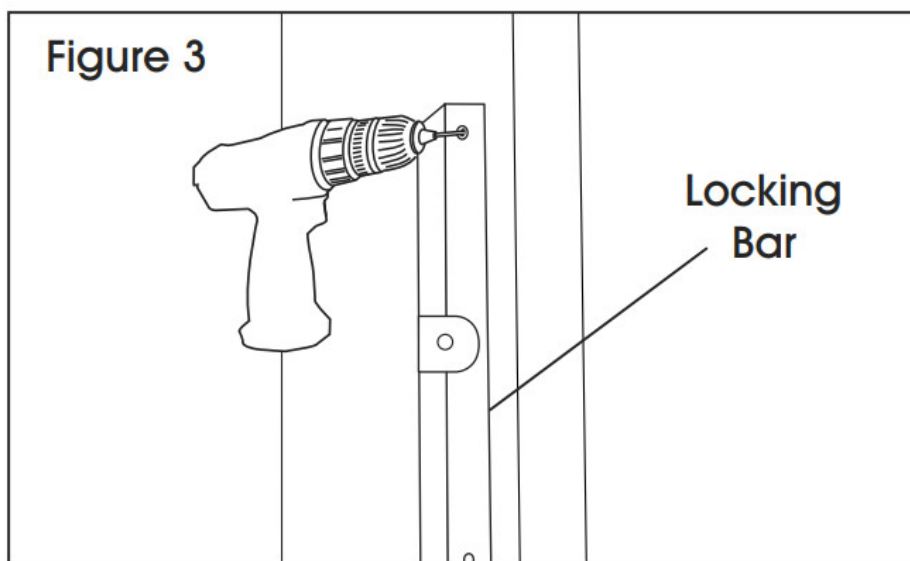

4. Stretch gate across opening into locking bar, and insert into the padlock. (See Figure 4)

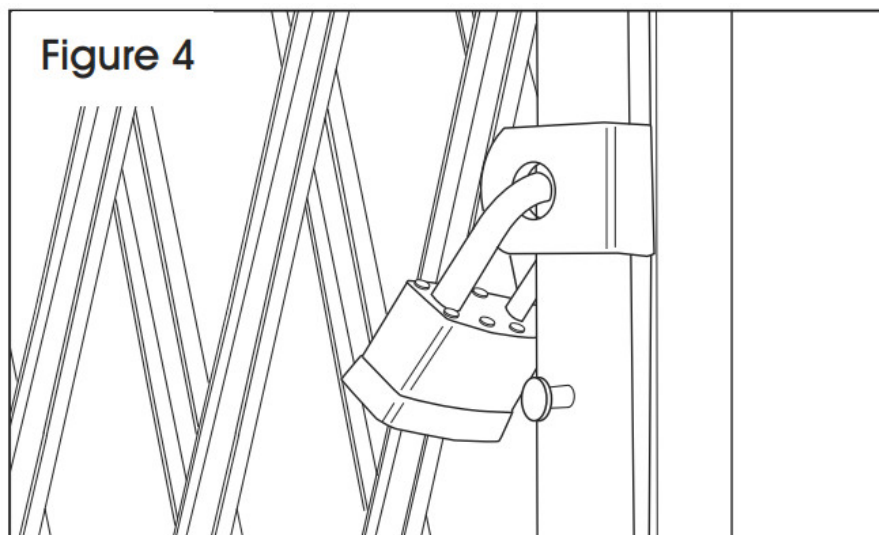

NOTE: Retainer straps hold security gates in the retracted position. (See Figure 5)

Figure 5

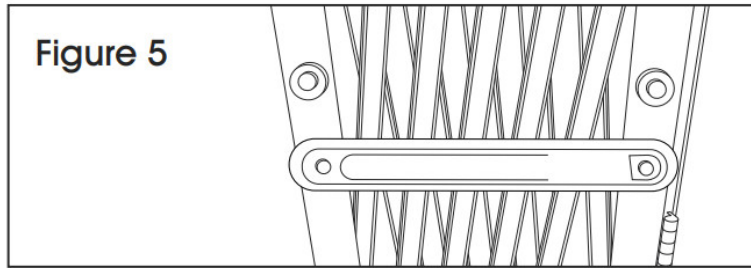

ULINE

1-800-295-5510

ulink.com

Documents / Resources

| | |
|---|---|
|  | <p>ULINE Window Folding Security Gate [pdf] User Guide Window Folding Security Gate, H-6937, H-6938</p> |
|---|---|

[Manuals+](#)