



UISP Router Pro User Manual

[Home](#) » [UISP](#) » UISP Router Pro User Manual 

Contents

- 1 [UISP Router Pro](#)
- 2 [WHAT'S INCLUDE](#)
- 3 [CONNECTION](#)
- 4 [INSTALLATION](#)
- 5 [POWER](#)
- 6 [Federal Communications Commission Statement](#)
- 7 [Documents / Resources](#)
- 8 [Related Posts](#)



UISP Router Pro



WHAT'S INCLUDE

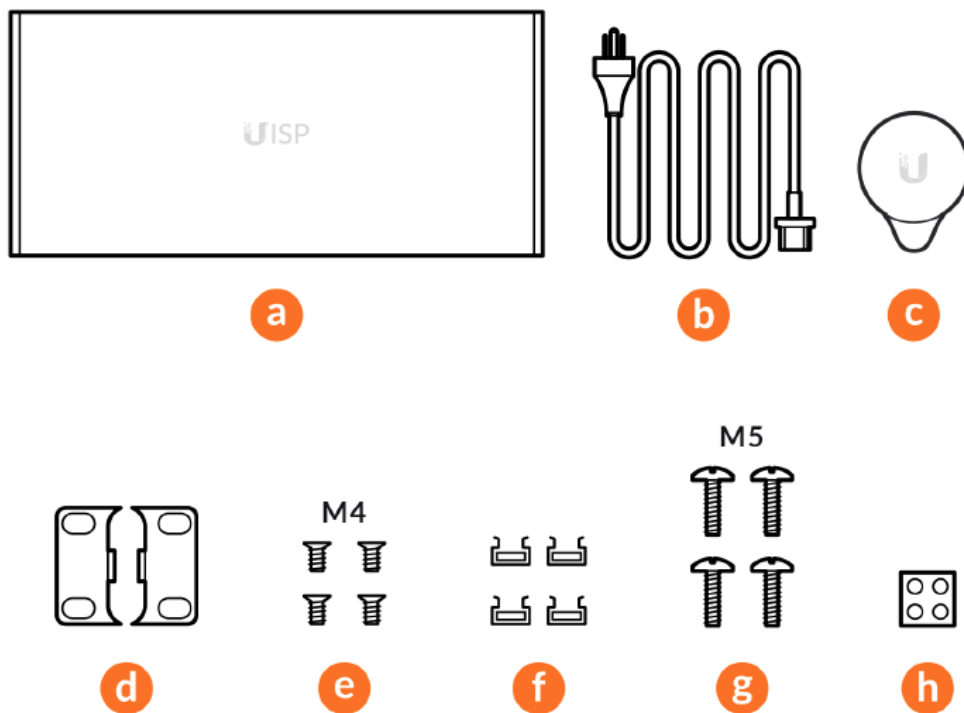

CONNECTION

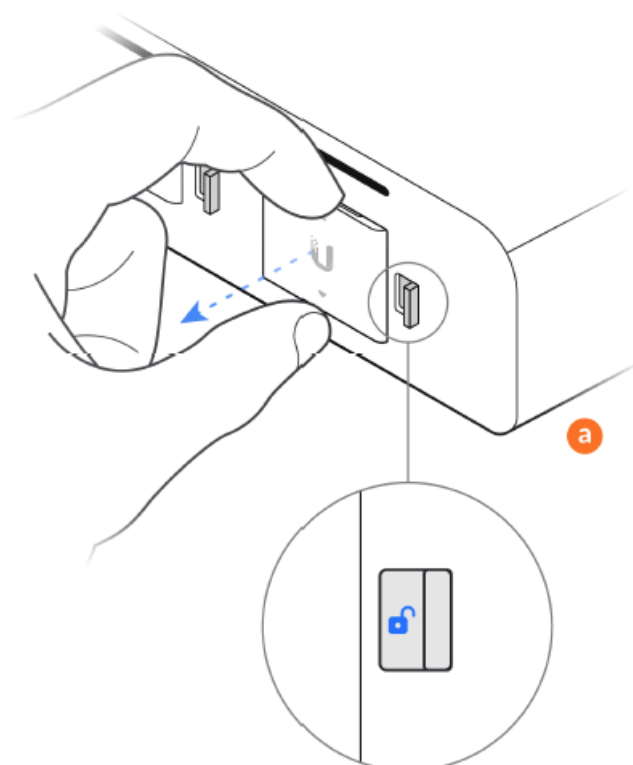

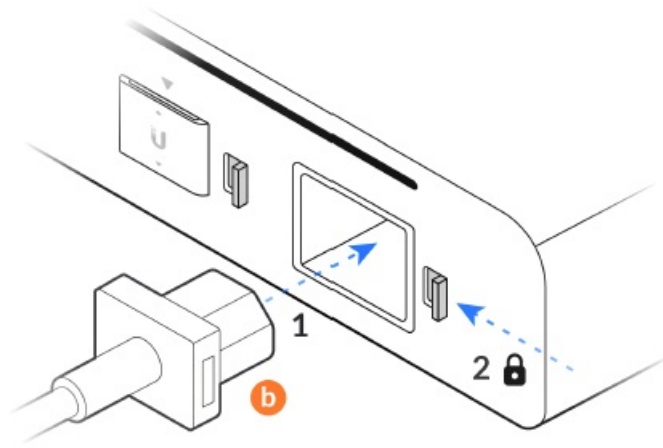

INSTALLATION

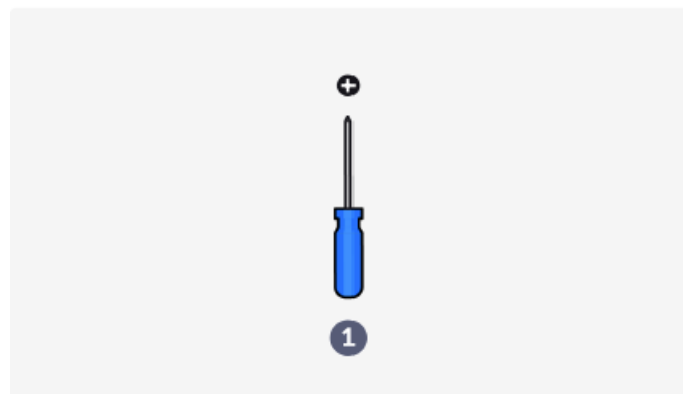
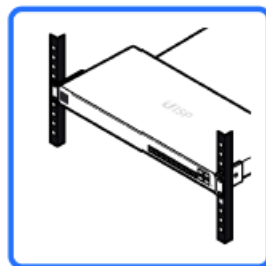

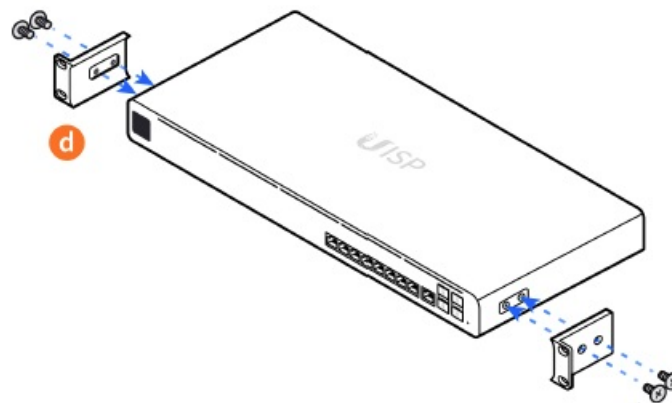

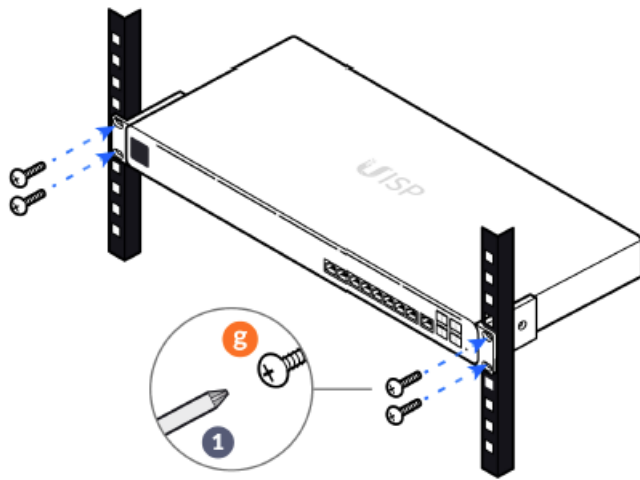
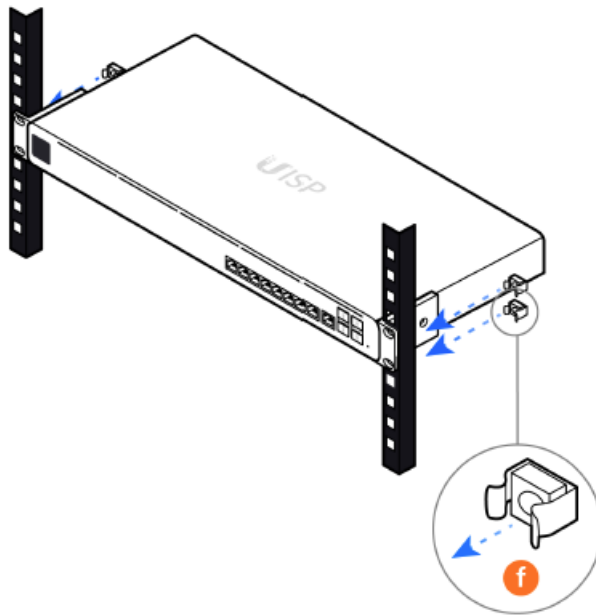

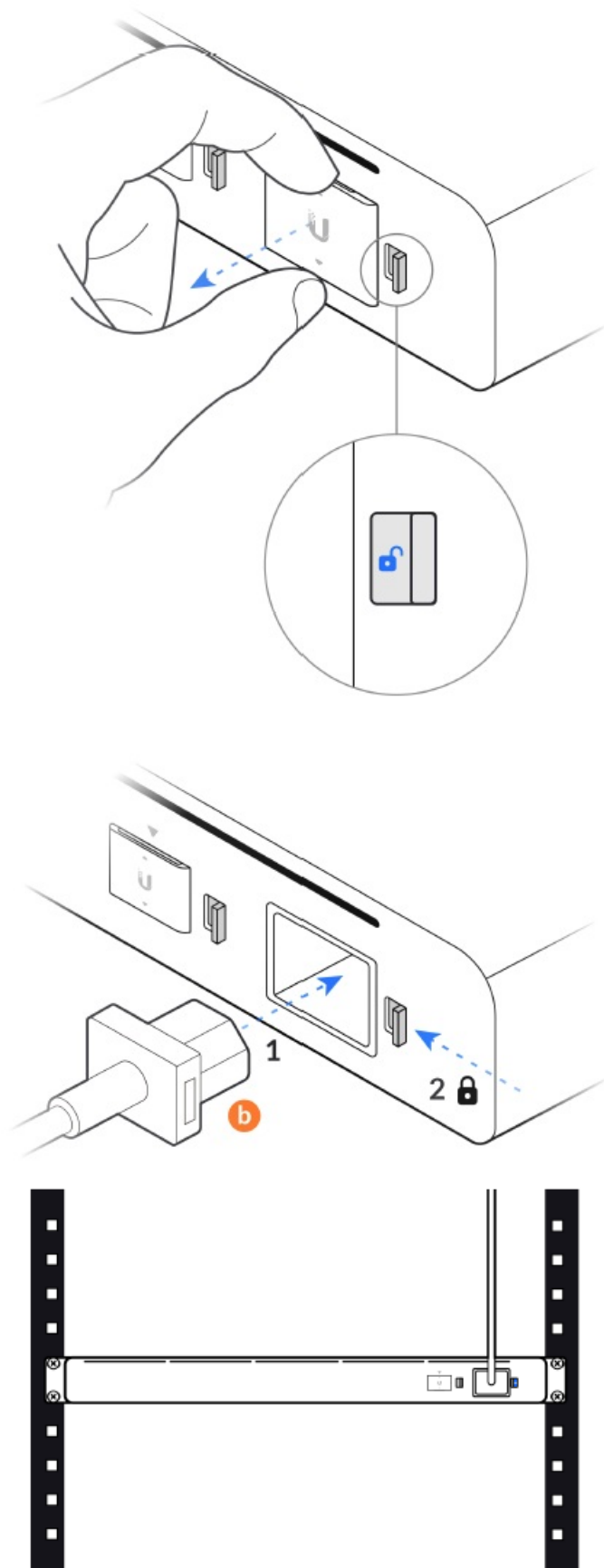

POWER

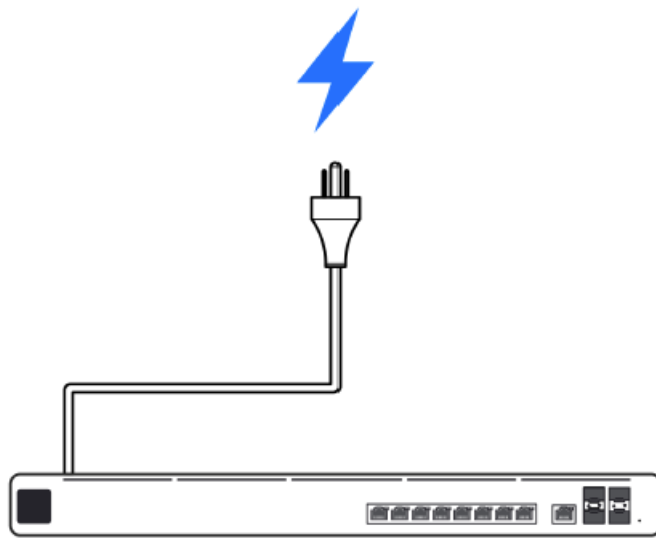

INTERNET SPEED

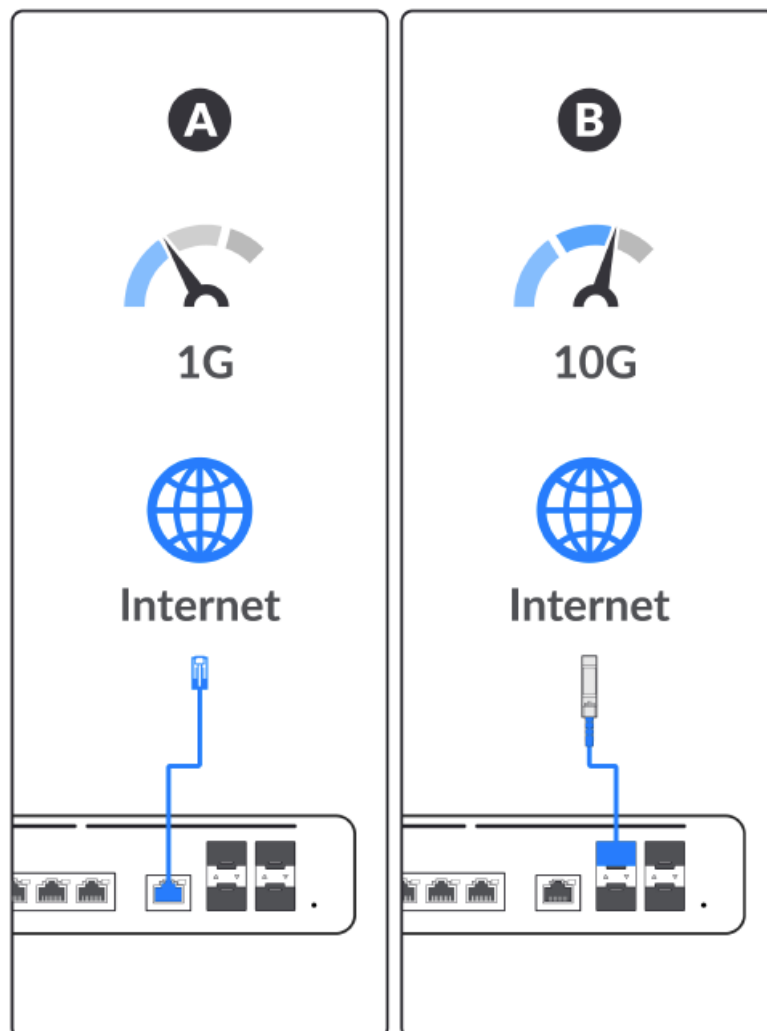

INFO



Federal Communications Commission Statement

This device complies with FCC Rules Part 15. Operation is subject to the following two conditions: This device may not cause harmful interference. This device must accept any interference received, including interference that may cause undesired operation.

This equipment has been tested and found to comply with the limits for a class B digital device, pursuant to Part 15 of the Federal Communications Commission (FCC) rules. These limits are designed to provide reasonable protection against harmful interference in a residential installation. This equipment generates, uses, and can radiate radio frequency energy and, if not installed and used in accordance with the instructions, may cause harmful interference to radio communications. However, there is no guarantee that interference will not occur in a particular installation. If this equipment causes harmful interference to radio or television reception, which can be determined by turning the equipment off and on, the user is encouraged to try to correct the interference by doing one or more of the following measures:

- Reorient or relocate the receiving antenna.
- Increase the separation between the equipment and receiver.
- Connect the equipment into an outlet on a circuit different from that to which the receiver is connected.
- Consult the dealer or an experienced radio/TV technician for help.

FCC Caution

Any changes or modifications not expressly approved by the party responsible for compliance could void the user's authority to operate the equipment. The antenna(s) used for this transmitter must not be co-located or operating in conjunction with any other antenna or transmitter.

Radiation Exposure Statement:

This equipment must be installed and operated in accordance with provided instructions and the antenna(s) used for this transmitter must be installed to provide a separation distance of at least 20 cm from all persons and must not be co-located or operating in conjunction with any other antenna or transmitter.

Documents / Resources

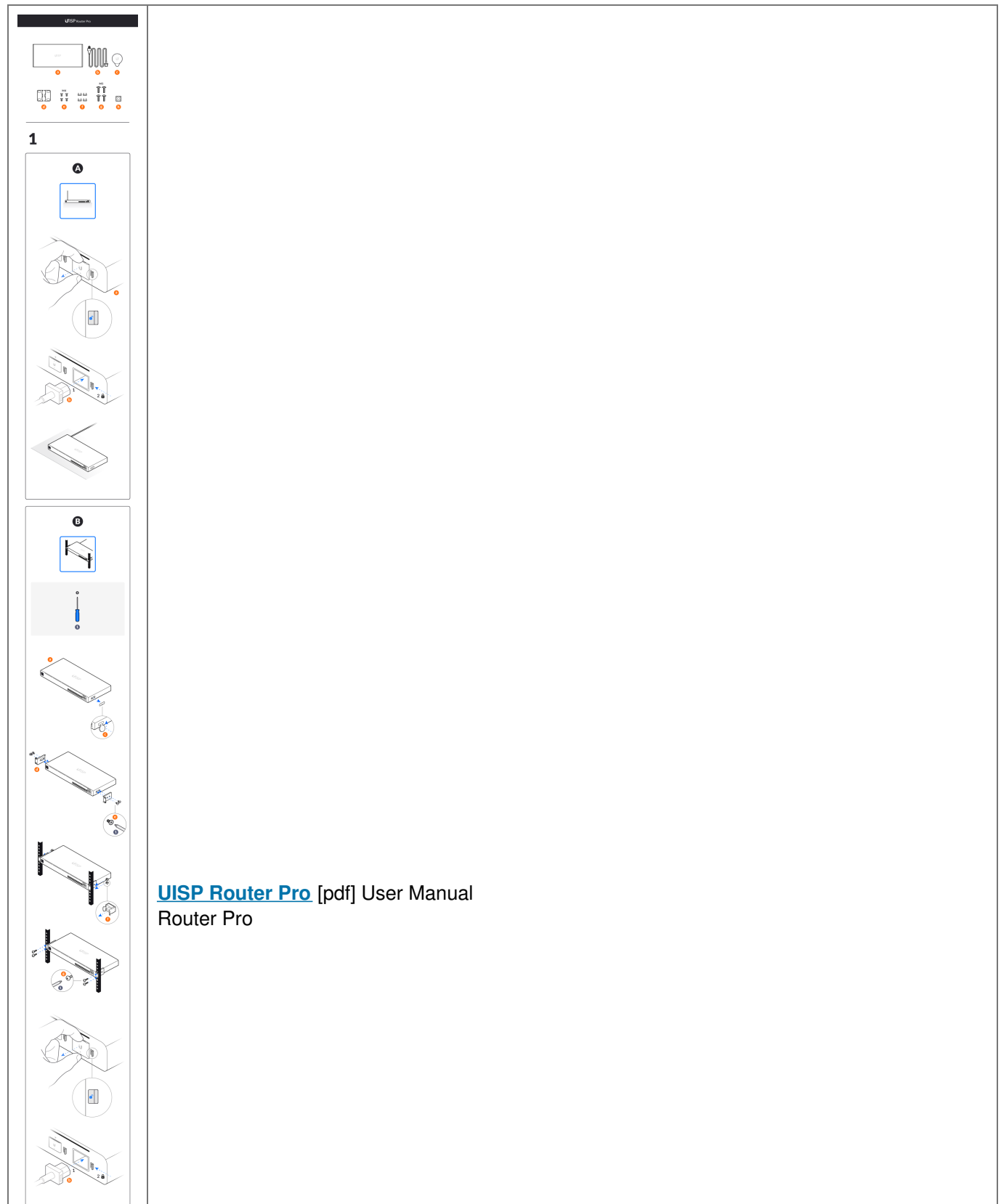

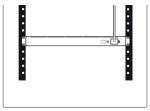

2

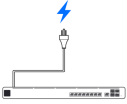

3

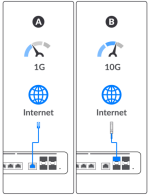

4

