

UISP AX55 Router Professional



UISP AX55 Router Professional Instruction Manual

[Home](#) » [UISP](#) » UISP AX55 Router Professional Instruction Manual 

Contents

- 1 UISP AX55 Router Professional
- 2 Product Usage Instructions
- 3 WHAT IN THE BOX
- 4 HOW TO USE
- 5 CONNECTIONS
- 6 Documents / Resources
 - 6.1 References



UISP AX55 Router Professional



Specifications

- **Brand:** UISP
- **Model:** Router Professional
- **Features:** High-speed routing, advanced security features, multiple LAN ports
- **Dimensions:** 8.5 x 6.2 x 1.5 inches
- **Weight:** 1.2 lbs

Product Usage Instructions

Initial Setup

Before using the UISP Router Professional, ensure you have a stable internet connection and power supply. Connect the router to your modem using an Ethernet cable.

Configuration

Access the router's configuration settings by entering the default IP address in your web browser. Follow the on-screen instructions to set up your network preferences, including SSID, password, and security settings.

Connecting Devices

Connect your devices to the router using either Ethernet cables or the Wi-Fi network created during the configuration process. Ensure all connected devices are within the router's range for optimal performance.

Advanced Features

Explore the advanced features of the UISP Router Professional, such as port forwarding, VPN setup, and parental controls, to customize your network according to your needs.

FAQ

- **Q: How do I reset the router to factory settings?**

- **A:** To reset the UISP Router Professional to factory settings, locate the reset button on the device and hold it down for 10 seconds while the router is powered on.

- **Q: Can I update the firmware of the router?**

- **A:** Yes, you can update the router's firmware by accessing the administration panel and checking for any available updates. Follow the on-screen instructions to complete the firmware update process.

WHAT IN THE BOX

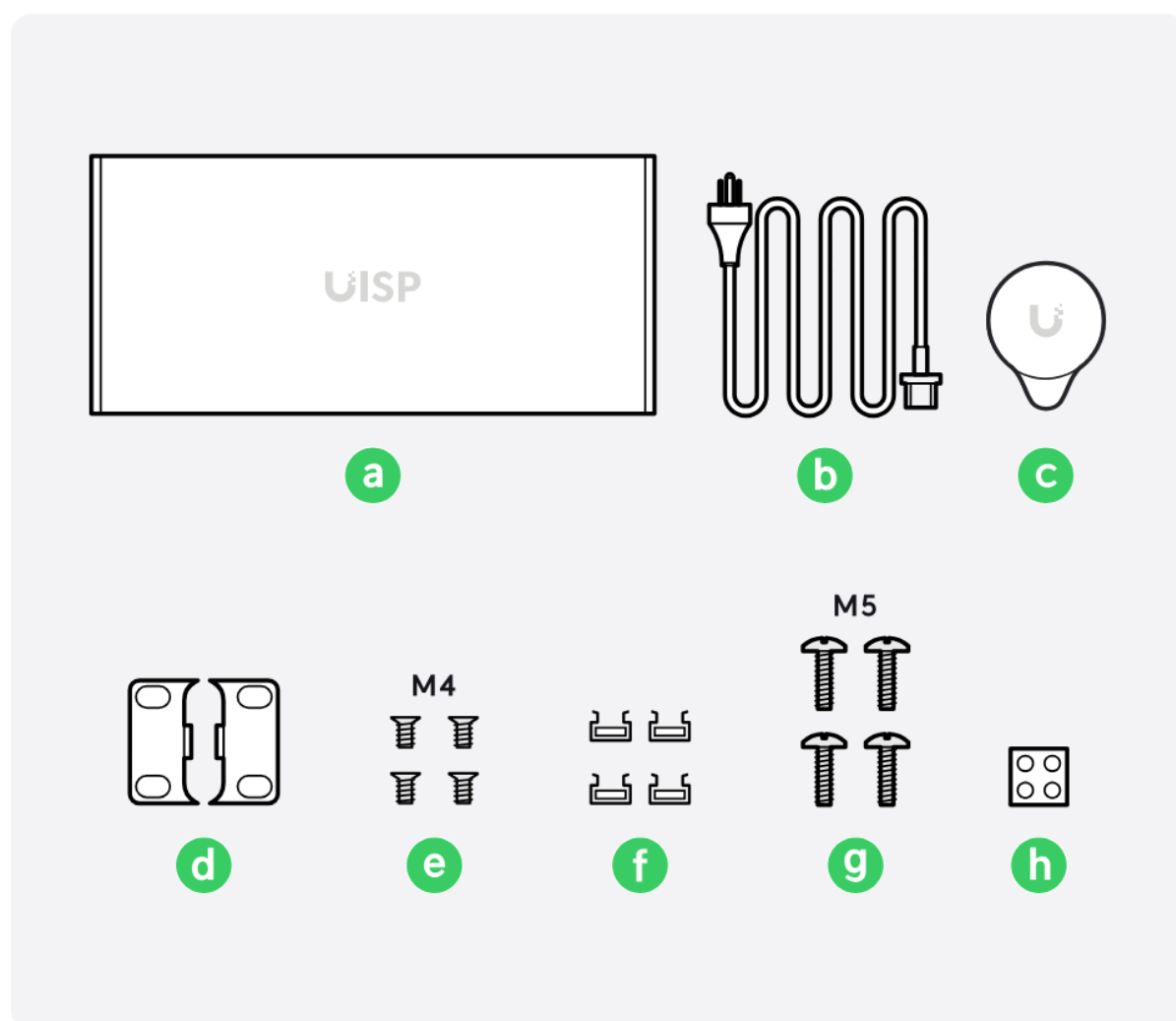

HOW TO USE

1

A

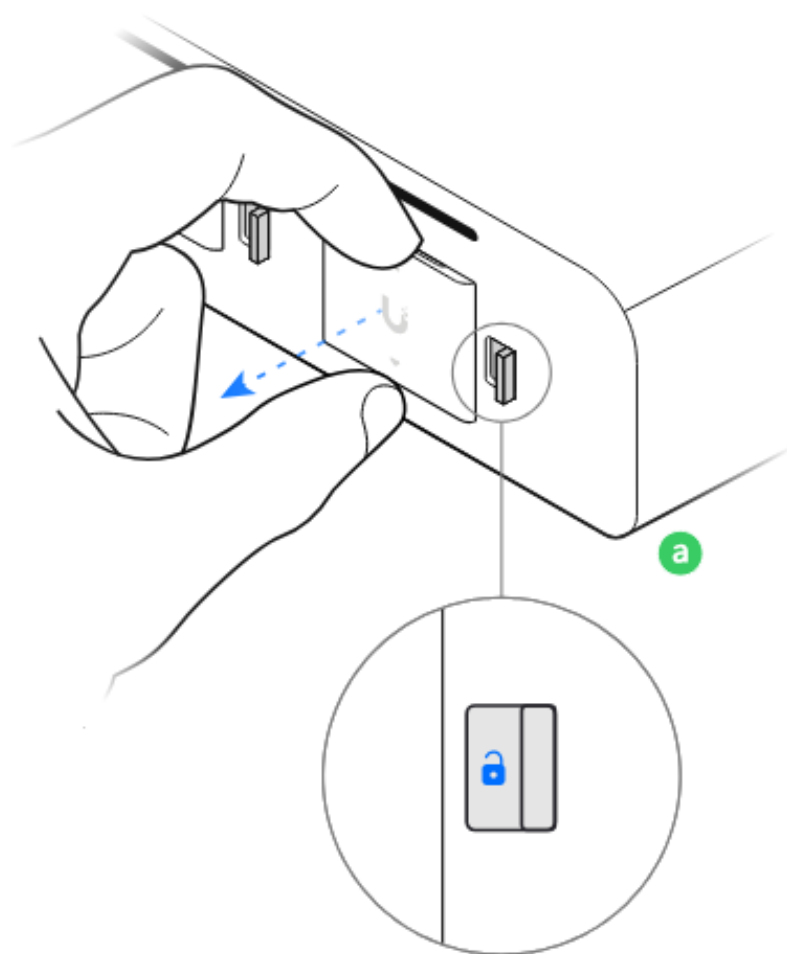

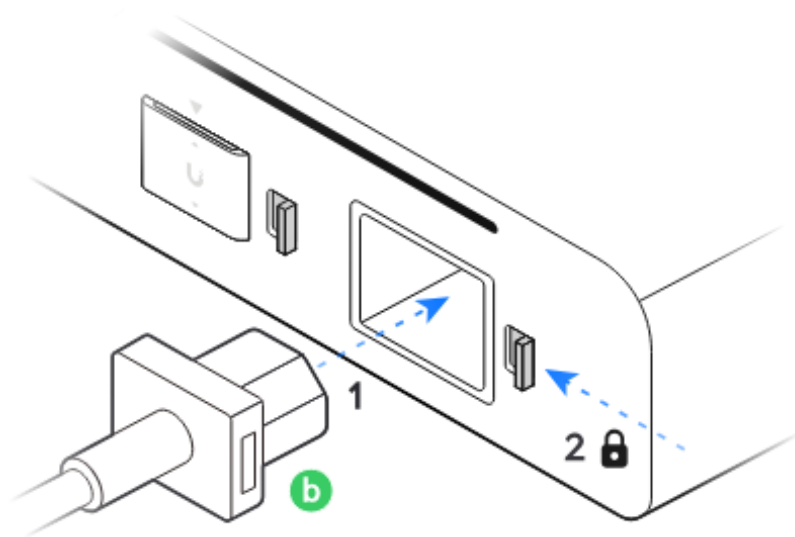

B



+



1

a



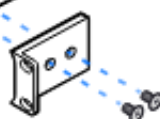
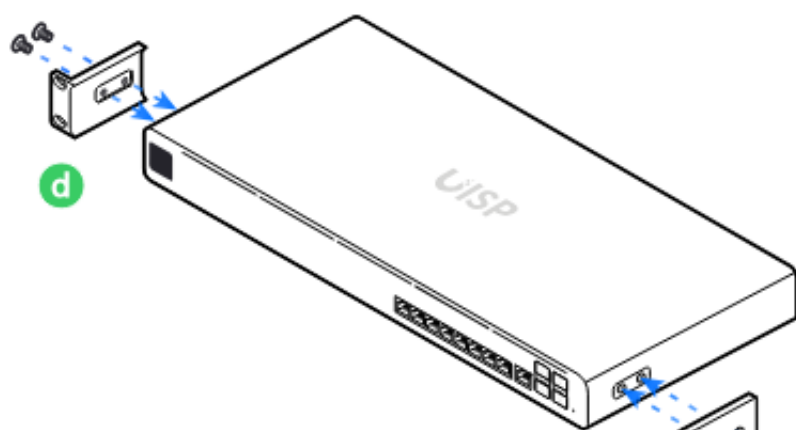
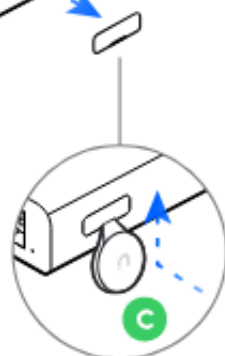

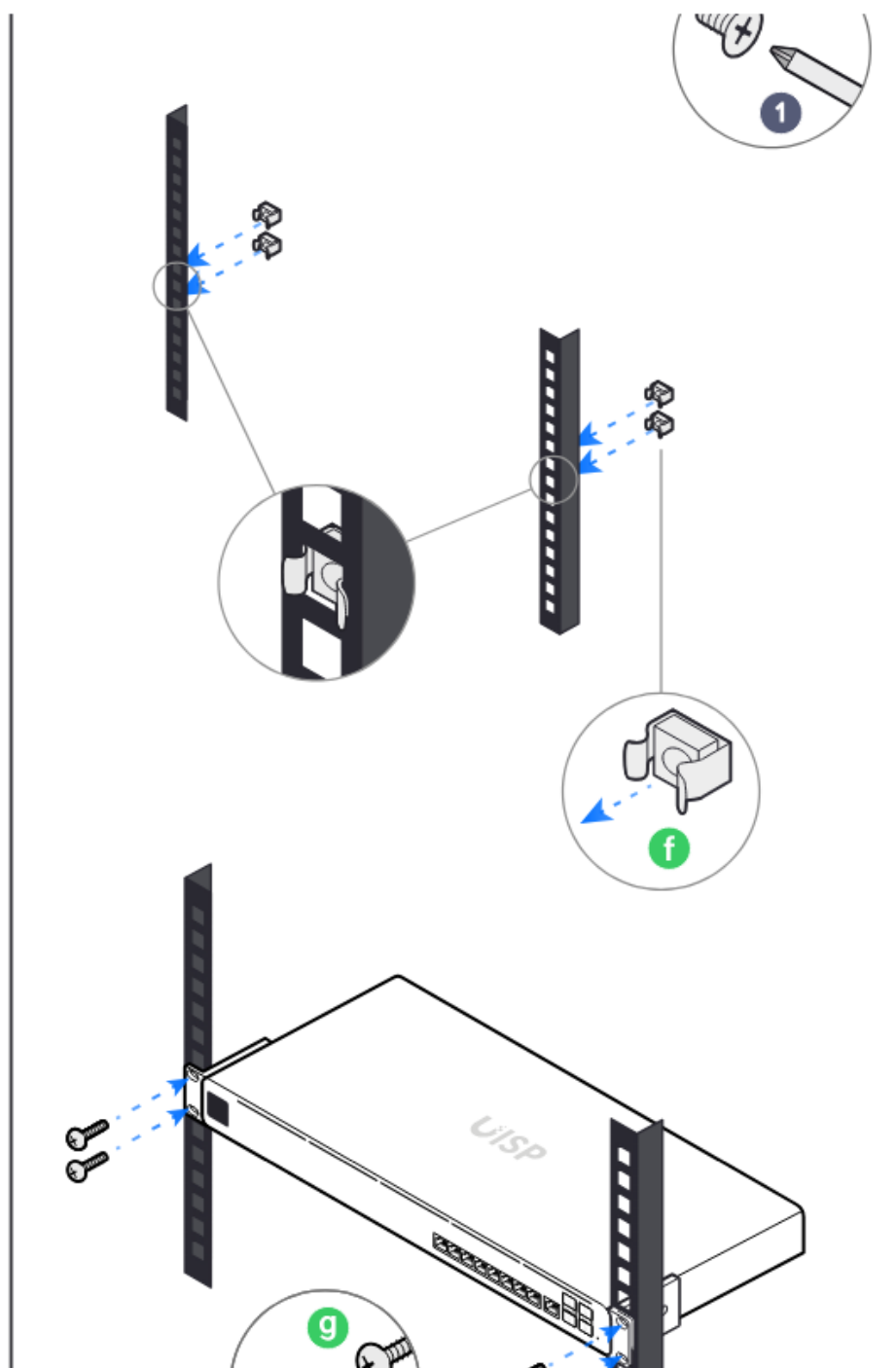

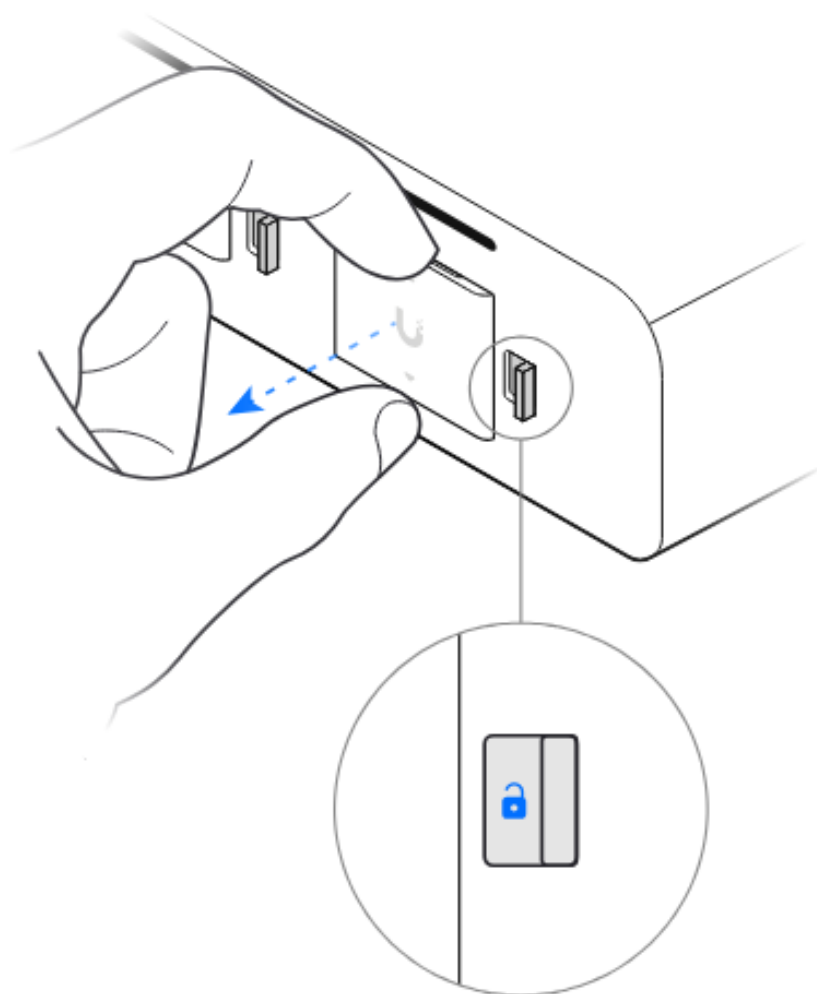
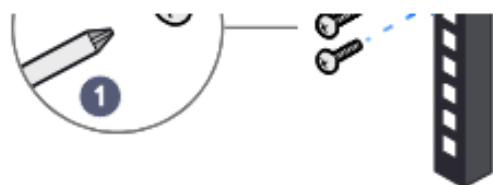

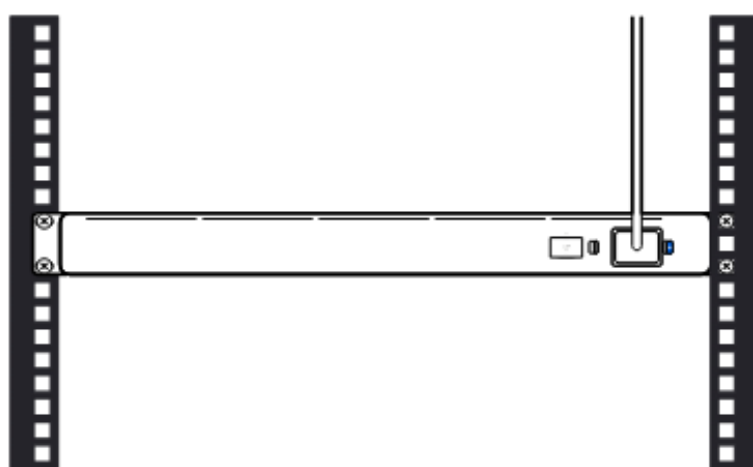
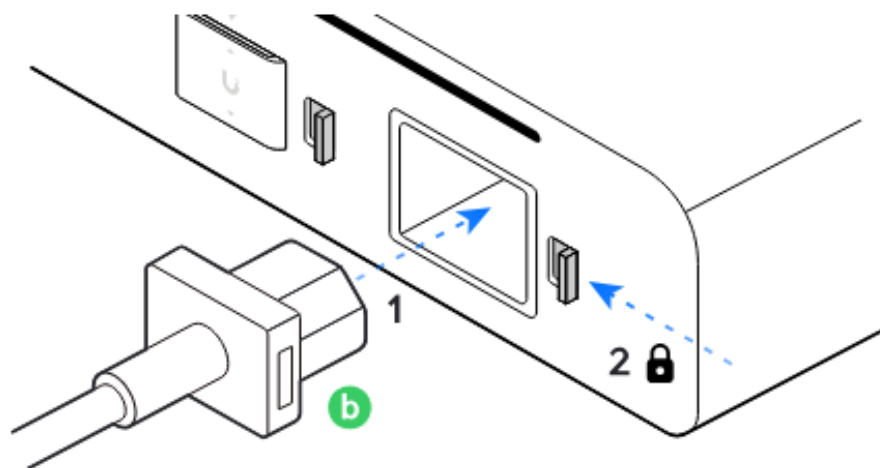

CONNECTIONS

2

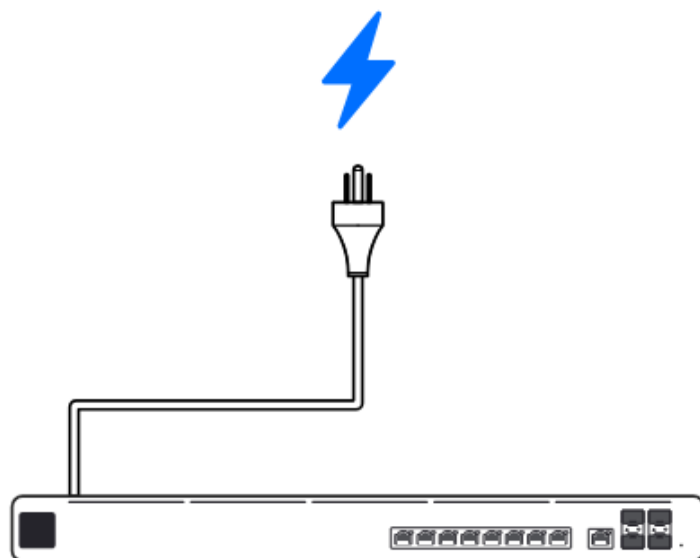

3



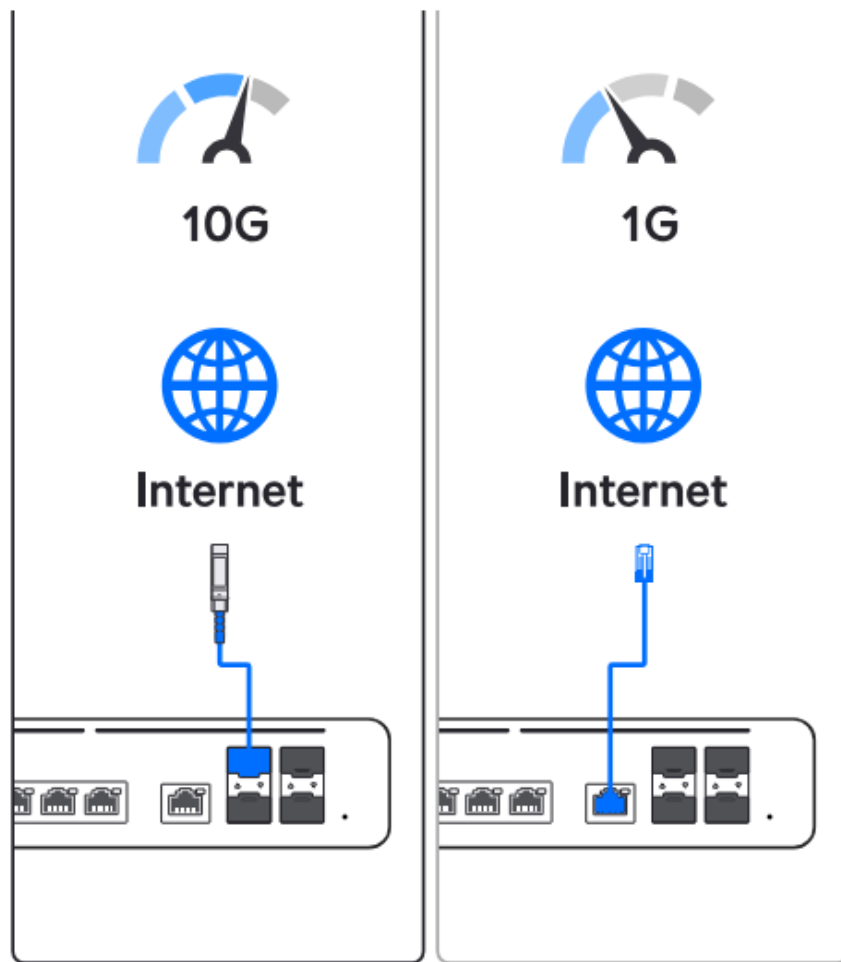

4



If you need further assistance, visit our [Help Center](#) or contact [Ubiquiti Support](#).

©2023 Ubiquiti Inc. All rights reserved. Ubiquiti, Ubiquiti Networks, the Ubiquiti U logo, and UISP are trademarks or registered trademarks of Ubiquiti Inc. in the United States and in other countries. App Store and the Apple logo are trademarks of Apple Inc., registered in the U.S. and other countries. Google Play and the Google Play logo are trademarks of Google LLC. All other trademarks are the property of their respective owners.

Documents / Resources

 <small>UISP Router Professional</small>	UISP AX55 Router Professional [pdf] Instruction Manual AX55 Router Professional, AX55, Router Professional, Professional
--	---

References

- [!\[\]\(2dc8cdc0c918df88cde61039ecf68682_img.jpg\) Ubiquiti Account](#)
- [User Manual](#)

[Manuals+](#), [Privacy Policy](#)

This website is an independent publication and is neither affiliated with nor endorsed by any of the trademark owners. The "Bluetooth®" word mark and logos are registered trademarks owned by Bluetooth SIG, Inc. The "Wi-Fi®" word mark and logos are registered trademarks owned by the Wi-Fi Alliance. Any use of these marks on this website does not imply any affiliation with or endorsement.