



ugoho me LYT-10 2k Wireless Security Camera User Guide

[Home](#) » [ugoho me](#) » ugoho me LYT-10 2k Wireless Security Camera User Guide 

Contents

- [1 ugoho me LYT-10 2k Wireless Security Camera](#)
- [2 Product Usage Instructions](#)
- [3 IN THE BOX](#)
- [4 PRODUCT OVERVIEW](#)
- [5 CAMERA SETUP](#)
- [6 CAMERA INSTALLATION](#)
- [7 Warranty](#)
- [8 Documents / Resources](#)



ugoho me LYT-10 2k Wireless Security Camera



Product Information:

The product is a versatile handheld device designed to provide various functionalities to its users. It is equipped with advanced technology to deliver high performance and convenience. The device is lightweight and compact, making it easy to carry and use in different settings.

Key Features:

- Multiple modes for different applications
- Intuitive touchscreen interface
- Long-lasting battery life
- Wireless connectivity options
- High-resolution display
- Expandable storage capacity

Product Usage Instructions

To use the product effectively, please follow these instructions:

1. **Power On/Off:** Press and hold the power button until the device turns on or off.
2. **Navigation:** Use the touchscreen to navigate through different menus and options. Swipe, tap, or pinch gestures can be used for scrolling, selecting, and zooming.
3. **Mode Selection:** Depending on your desired application, select the appropriate mode from the main menu. Use the mode switch located on the side of the device to switch between different modes.
4. **Battery Charging:** Connect the provided charger to the device's charging port. Plug the charger into a power outlet. The device will indicate the charging status on the screen. Once fully charged, disconnect the charger.
5. **Wireless Connectivity:** Enable Wi-Fi or Bluetooth by accessing the settings menu. Follow the on-screen instructions to connect to available networks or devices.
6. **Storage Expansion:** To expand the storage capacity, insert a compatible memory card into the designated slot. Ensure that the card is properly inserted and recognized by the device.
7. **Maintenance:** Keep the device clean and free from dust or debris. Use a soft cloth to wipe the screen and body. Avoid using harsh chemicals or abrasive materials.

For further information or troubleshooting, refer to the detailed user manual provided with the product.

This Quick Start Guide already contains minimalist instructions for different users (Vietnamese, Japanese, German, Italian, French, and Spanish). We avoid printing these large manuals in an effort to limit our impact on the environment.

Scan the code below for a more detailed installation guide on how to operate your camera.

IN THE BOX

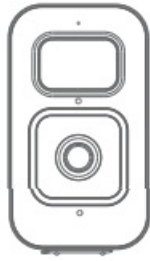

WiFi
Camera*1



1/4" Screw
Universal Base*1

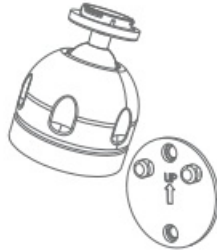

Mounting
Bracket*1



screws plastic
anchors

Screw
Set*1

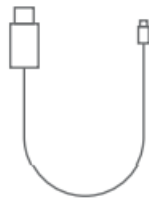

USB
Cable*1



USB
Adapter*1



Quick Start
Guide*1

PRODUCT OVERVIEW

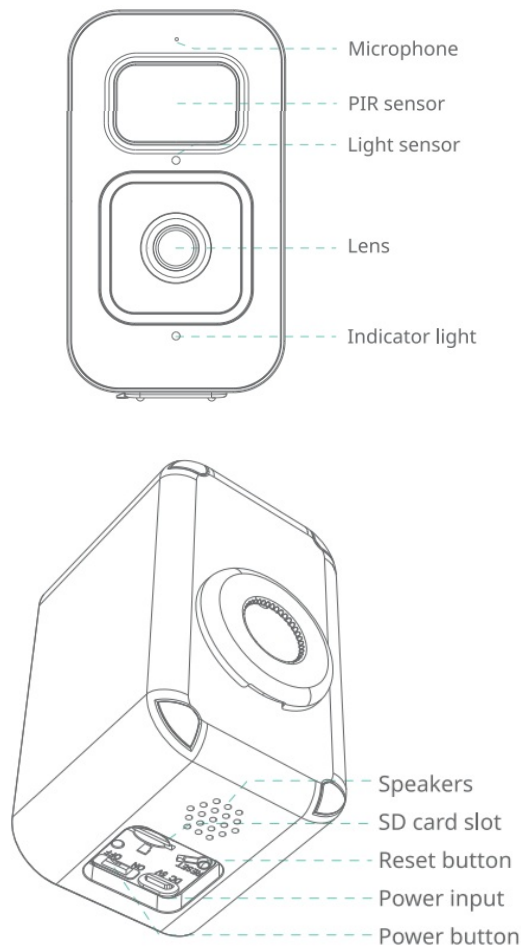

CAMERA SETUP

1. Download the ugo.me APP and create a new account.



2. Switch the power button on to wake up the camera.
3. Press the Reset button for about 5 seconds until you hear a 'Du' sound with the red light flashing.
4. Follow the on-screen instructions to complete the setup.

Note: Camera setup only support 2.4GHz WIFI

CAMERA INSTALLATION

The camera can be used in a variety of locations and is available in two mounting options. The installation process ensures that the camera has a wide field of view and is not obstructed by walls, windows or other nearby objects, which will help avoid the reflection of infrared light, which can adversely affect night vision. To mount this indoor camera on a ceiling or on a wall, follow the steps below:

1. Separate the mounting bracket by swiping down the base plate. Then, use the plate as a template to mark points on the ceiling or wall to assist with the drilling process.

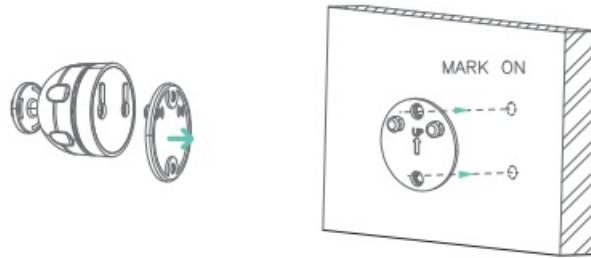

2. Drill holes with a 1/4 inch drill bit.

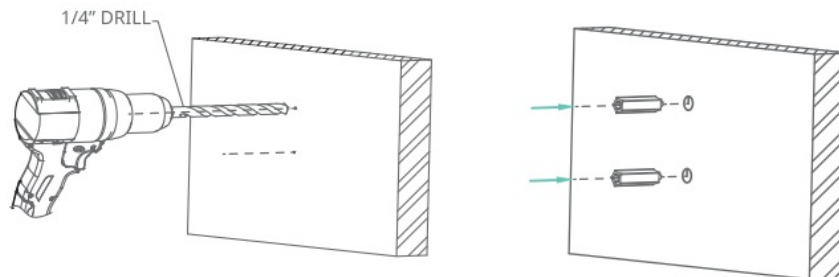

3. Align the holes on the mounting plate with those in the ceiling. Insert the anchors into the holes (anchors are necessary for walls that are made out of hard materials such as concrete, brick, or stucco.) Fix the screws with a screwdriver to fasten the mounting bracket to the ceiling or wall.

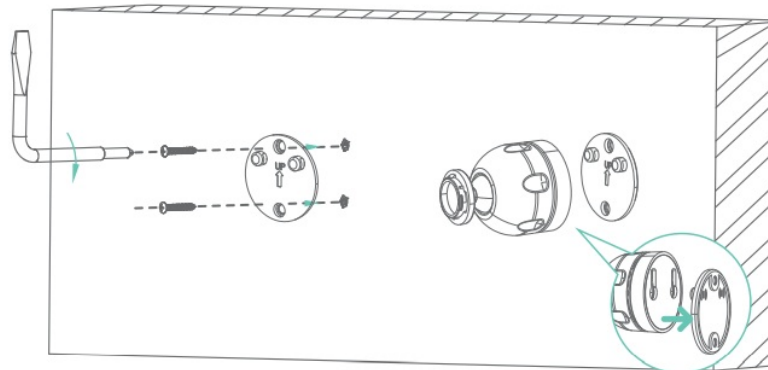

4. Swipe the mounting bracket onto the plate until it is secured, then attach the camera to the bracket by clicking it on.

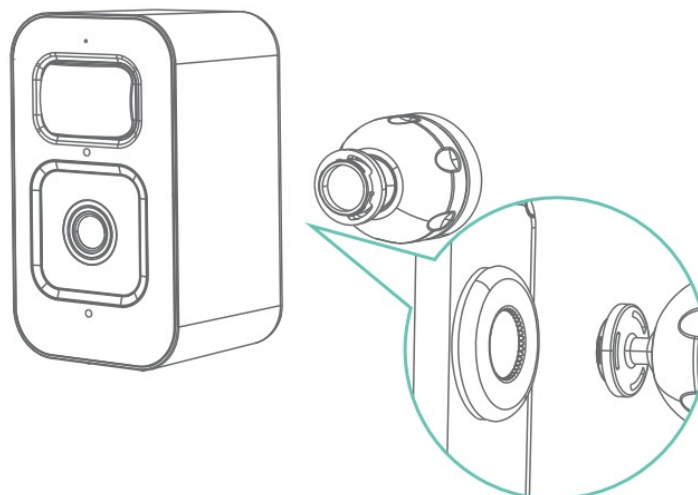

The 1/4" screw universal base is included for your convenience. For instance, if you have previously installed other cameras on your ceiling or wall, you can now reuse the same bracket by simply attaching our universal base to the old bracket from the other cameras. Note: This item does not include 1/4" screw universal bracket.

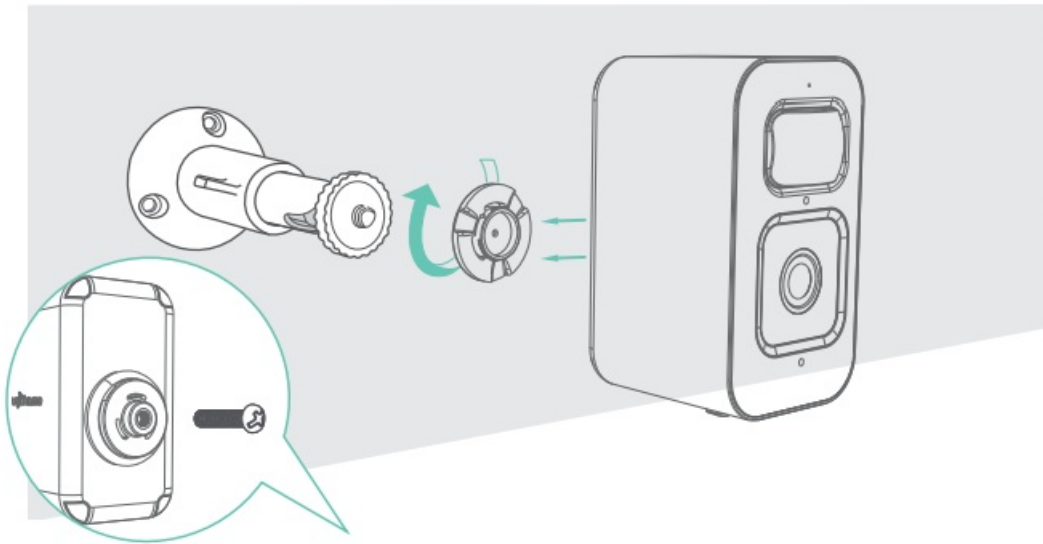

Tips: To remove the Screw Universal Base, you can use a screw key for assistance. Simply Insert the key into the base then pull it out.

NOTICE

FCC Statement This device complies with Part 15 of the FCC Rules. Operation is subject to the following two conditions: (1) this device may not cause harmful Interference, and (2) this device must accept any Interference received, Including Interference that may cause undesired operation.

Warning Changes or modifications not expressly approved by the party responsible for compliance could void the user's authority to operate the equipment.

FCC Radio Frequency Exposure Statement

The device has been evaluated to meet general RF exposure requirements. The device can be used in fixed/mobile exposure condition. The min separation distance is 20cm.

Notice: Shielded cables All connections to other computing devices must be made using shielded cables to maintain compliance with FCC regulations.

CUSTOMER SERVICE

Warranty

Puwell Technology Inc. warrants this product to be free of defects in materials or workmanship for one year. This warranty does not include damage resulting from accidents or misuse. Damage from unauthorized service or modification of the product or of any furnished component will void this warranty in its entirety. This warranty is expressly in lieu of all other warranties, expressed or implied, including any warranty, representation, or condition of merchantability or that the products are fit for any particular purpose or use, and specifically In lieu of all special, Indirect, incidental, or consequential damages. To obtain service/ replacement, please contact support@ugoho.me.

Please allow up to seven (7) business days for your replacement to be processed.

NOTE: This equipment has been tested and found to comply with the limits for a Class B digital device, pursuant to Part 15 of the FCC Rules. These limits are designed to provide reasonable protection against harmful interference in a residential installation. This equipment generates, uses and can radiate radio frequency energy and, if not installed and used in accordance with the instructions, may cause harmful interference to radio

communications. However, there is no guarantee that interference will not occur in a particular installation. If this equipment does cause harmful interference to radio or television reception, which can be determined by turning the equipment off and on, the user is encouraged to try to correct the interference by one or more of the following measures:

- Reorient or relocate the receiving antenna.
- Increase the separation between the equipment and receiver.
- Connect the equipment into an outlet on a circuit different from that to which the receiver is connected.
- Consult the dealer or an experienced radio/TV technician for help.

Contact Us

support@ugoho.me

0 @UGOHOME

D @UGOHOME

Documents / Resources

	ugoho me LZT-10 2k Wireless Security Camera [pdf] User Guide 2K 2BARM-LZT-10, 2BARMLZT10, LZT-10, LZT-10 2k Wireless Security Camera, 2k Wireless Security Camera, Wireless Security Camera, Security Camera, Camera
---	---