

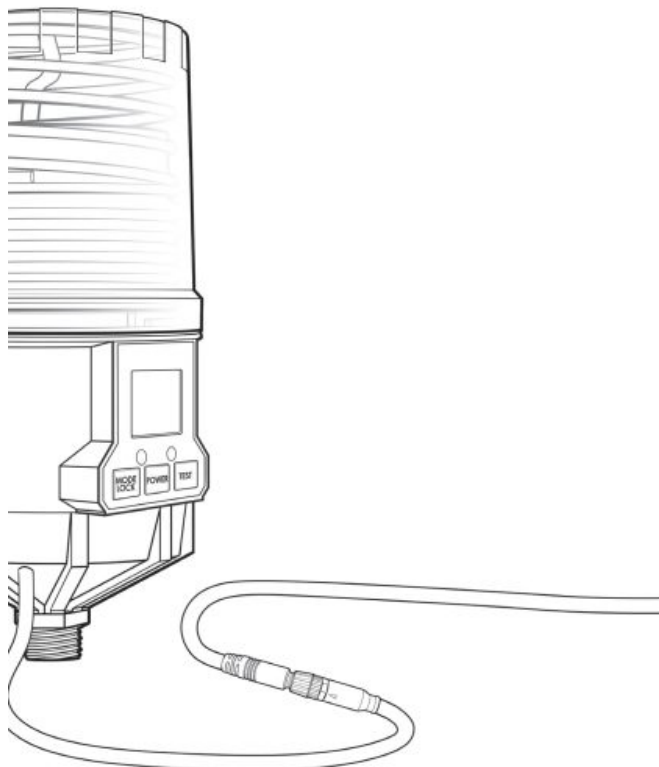

ue SYSTEMS M-UE Series Single Point Lubricator User Manual

[Home](#) » [ue SYSTEMS](#) » ue SYSTEMS M-UE Series Single Point Lubricator User Manual 



Copyright

© 2021 by UE Systems. All rights reserved.

No part of this publication may be reproduced, transmitted, transcribed, stored in a retrieval system, or translated into any language in any form by any means without the written permission of UE Systems.

Disclaimer

This manual is provided for informational purposes. UE Systems MAKES NO WARRANTY OF ANY KIND WITH REGARD TO THIS MATERIAL, INCLUDING, BUT NOT LIMITED TO, THE IMPLIED WARRANTIES OF MERCHANTABILITY AND FITNESS FOR A PARTICULAR PURPOSE.

UE Systems shall not be liable for errors, omissions, or inconsistencies that may be contained herein or for incidental or consequential damages in connection with the furnishing, performance, or use of this material. Information in this document is subject to change without notice and does not represent a commitment on the part of UE Systems. The information in this manual is not all-inclusive and cannot cover all unique situations.

Patents

The product(s) described in this manual may be covered under existing and pending patents.

Contents

- 1 IMPORTANT SAFETY INFORMATION**
- 2 Product Overview**
- 3 Product Specifications**
- 4 Product Dimensions**
- 5 Product Operation**
- 6 Button Control**
- 7 LCD Display**
- 8 M-UE Maintenance**
- 9 M-UE Installation**
 - 9.1 Guidelines**
- 10 Mounting Options**
 - 10.1 Direct Mount**
- 11 Remote Mounting (Optional)**
- 12 Troubleshooting Tips**
- 13 Customer Support**
- 14 Contact Us**
- 15 Documents / Resources**
 - 15.1 References**
- 16 Related Posts**

IMPORTANT SAFETY INFORMATION

READ ALL INSTRUCTIONS BEFORE USE

For your safety, the information in this manual must be followed to minimize the risk of fire, explosion, electric shock, and to prevent property damage, personal injury, or death.



Use the lithium battery pack for specific applications such as extremely cold temperatures and single point remote

installation over 10ft. for a 500ml unit.

Refer to the product safety data sheet for the selected grease type for safe temperature storage.

The shelf life of a service pack is 1 year from the date of manufacturing.

When replacing service packs, ensure the battery is always changed at the same time as the replaceable grease cartridge.

Precautions for safe handling:

Avoid contact with skin and eyes. Avoid inhalation of vapor or mist and avoid the formation of dust and aerosols. Eating, drinking, and smoking should be prohibited in areas where this material is handled, stored, and processed.

Conditions for safe storage:

Store in a cool place. Keep the container tightly closed in a dry and well-ventilated place.

Store in accordance with local regulations.

Product Overview

About The M-UE Single-Point Lubricator

The M-UE electromechanical automatic grease lubricator is primarily designed to ensure reliable lubrication and at the same time reduce lubrication expenses with cost-saving Service Packs. It also offers superior advantages in cost competitiveness and user-friendliness.

The M-UE consists of a positive displacement pump for improved accuracy, a microprocessor control system, and a large LCD display. Regardless of backpressure, the electro-mechanically driven lubricator works to dispense a steady dose of lubricant and alerts users if a clog ever occurs. This product is ideal for applications where: considerable back pressure in the lube line exists, precise lubrication is required, or a disposable gas type lubricator is not economical.

Why invest in the M-UE?

Cost Savings – Substantial savings from the use of replaceable grease pouches and battery packs.

Remote Installation – High output pressure (870 psi) allows for remote installation up to 20 ft.

Simple Operation – Easy to program with built-in LCD and simple to use button controls.

Convenient Maintenance – Transparent protective cover allows for quick visual inspection of grease type verification and remaining volume.

Additional Features

- Various dispensing settings & grease pouch volumes to suit a wide range of industrial applications.
- Auto Lock-Out mode to prevent unintentional mode changes.
- Easy installation in confined areas.

Product Specifications

Sensor Parameter	Parameter Description
Grease Pouch Capacity	60ml/250ml/500ml (replaceable)
Power Supply	DC 4.5V Battery Pack (replaceable)
Operating Pressure	30~60bar (435~870psi)
Operating Temperature	Standard Alkaline Battery: -15°C~60°C (5 °F~140°F) Optional Lithium Battery: -40°C~60°C (-40 °F~140°F)
Remote Installation	10 ft with O.D. Ø6 tube 20 ft with O.D. Ø6 tube
IP Code	IP54
Certifications	CE

*Note: Specifications are subject to change without notice.

Product Dimensions

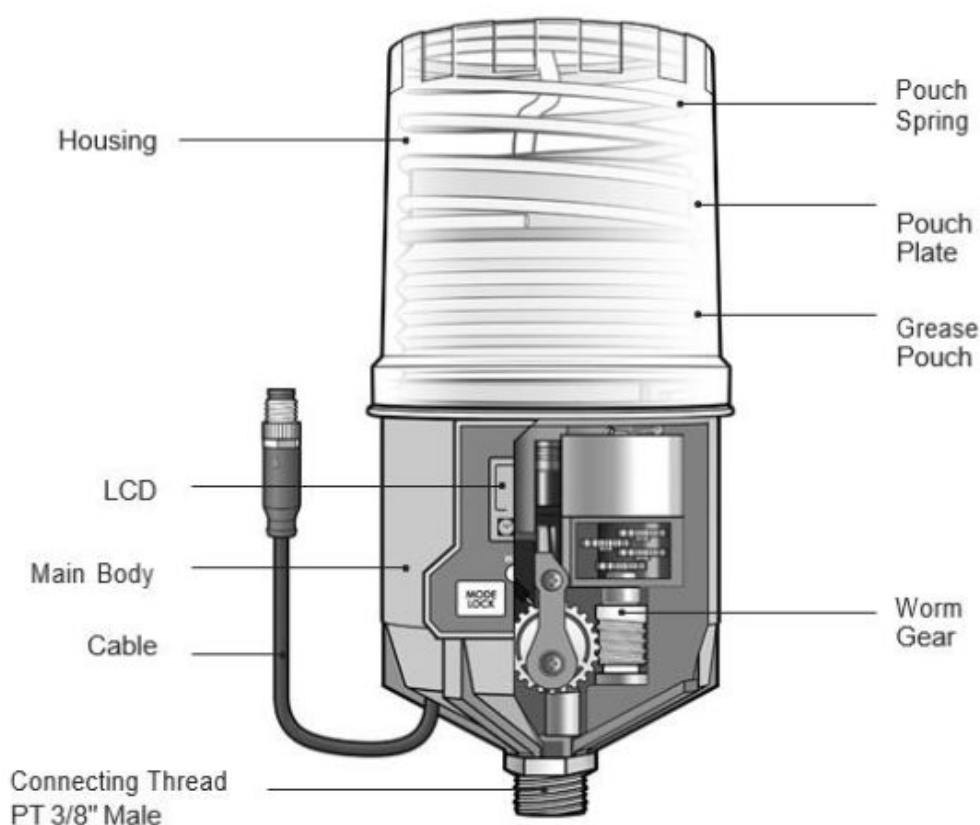

M-UE Series (cartridge size)	Product Width (inches)	Product Height (inches)
60 ml	3.6	7.15
250 ml	3.6	8.25
500 ml	3.6	10.25

Product Operation

Dispensing Volume

Mode Setting	60 ml M-UE	250 ml M-UE	500 ml M-UE
Mode 1	0.34 ml	0.34 ml	0.34 ml
Mode 2	0.68 ml	0.68 ml	0.68 ml
Mode 3	1.02 ml	1.02 ml	1.02 ml
Mode 4	1.36 ml	1.36 ml	1.36 ml
Mode 5	1.70 ml	1.70 ml	1.70 ml
Mode 6	2.04 ml	2.04 ml	2.04 ml
Total Dispense Cycles	180	720	1440

Button Control

Mode Settings
Mode 1, 2, 3, 4, 5, 6

MODE LOCK

Automatic Lock Out Mode
Press for 2 seconds to unlock (🔒)

POWER

Power **ON/OFF**
Press to Power unit On or Off

PURGE Mode
ON : Press for 2 seconds
OFF : Short press of button
(will stop after completion of ongoing cycle)







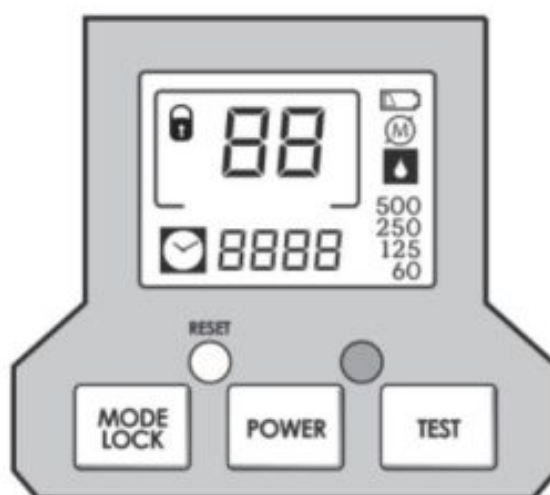

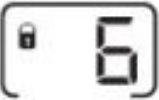

TEST

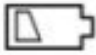
RESET

Reset to default setting when
the unit malfunctions and/or after
changing the Service Pack

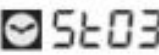
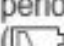

LCD Display

	Dispensing mode		Number of days operation has been on hold due to excessive backpressure
	Remaining dispensing cycles		Low battery power
	Automatic Lock Out mode		Operation on hold due to excessive backpressure
60/250/ 500	Grease pouch capacity		Dispensing period has completed
	PURGE mode		LED blinks when battery is low, excessive backpressure exists, or dispensing period has completed
	Number of days since dispensing period has completed ( and  will also display)		LED blinks during normal operation

M-UE Maintenance

Through the use of interchangeable service packs, the M-UE single-point lubricators are designed to last several dispense cycles. As a result, one of the most important advantages of M-UE is the significant cost savings when compared to manual lubrication while also ensuring the precision of providing the required lubrication quantity. M-UE service packs are designed for easy replacement for users to exchange the used grease pouches and battery packs. Refer to section 2.1, steps 3 – 7 for instructions on service pack replacement. If you are changing the size of the grease cartridge included in the service pack, a new base unit will need to be ordered with the same cartridge size capability.

Service Pack Contents:

A grease pouch of selectable lubricant types in various volume sizes.

An OEM battery pack: DC 4.5V Alkaline battery pack (standard) or DC 4.5V Lithium battery pack for operation

A disposable dust cover to protect your M-UE in harsh conditions.

A peelable sticker for noting the installation date and grease type to further avoid the risk of lubricant cross-contamination.



Notes:

Service packs must be stored in a well-ventilated storage unit with the container tightly closed.

Refer to the product safety data sheet for the selected grease type for safe temperature storage.
The shelf life of a service pack is 1 year from the date of manufacturing.

M-UE Installation

Guidelines

Remove contaminants around the lube point using a damp cloth.

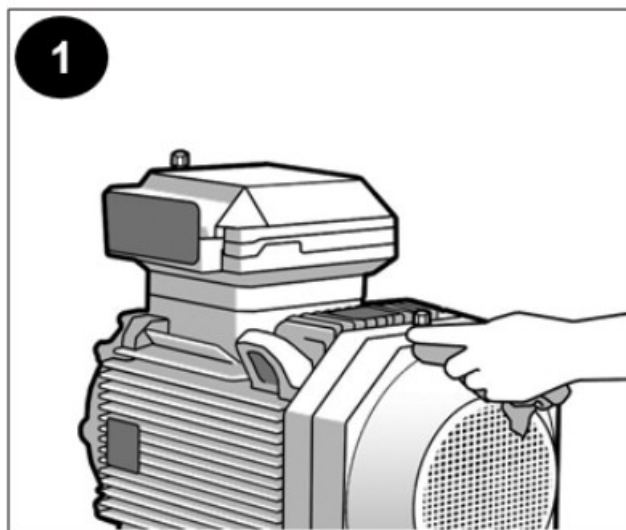

Ensure a clear passage using a manual grease gun. Remove any hardened grease by purging the lube point with a grease gun.

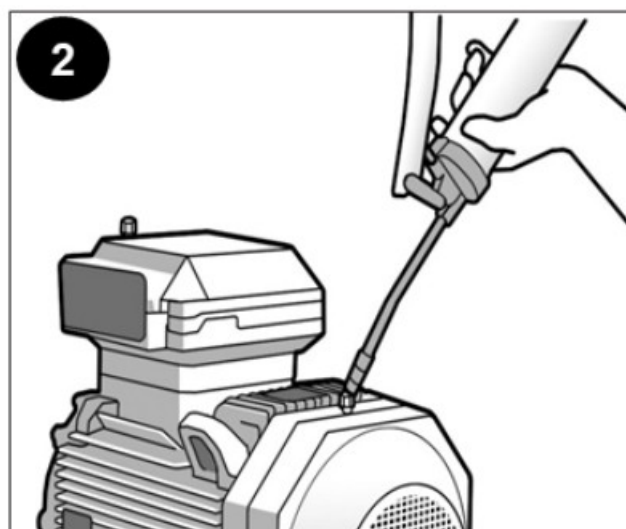

Confirm the grease pouch capacity matches the M-UE size and the service pack items are included (battery pack, grease pouch & dust cover).



Insert battery pack and grease cartridge inside the M-UE. Prime the cartridge by lightly squeezing it until a quarter-inch of grease is visible out of the tip.

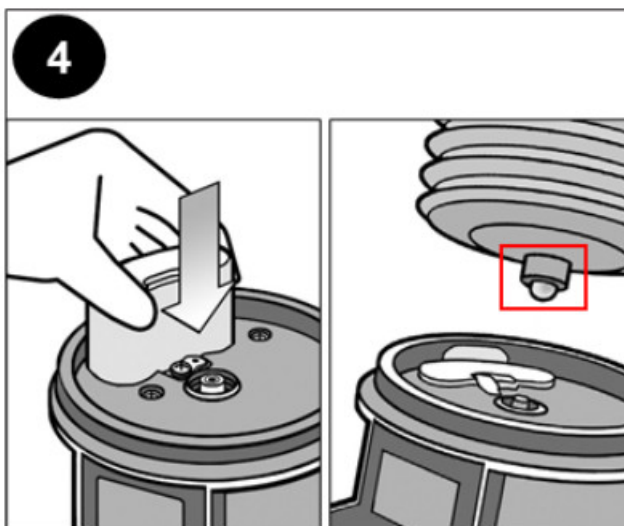

Carefully screw the grease pouch in by turning clockwise. Do not overtighten.

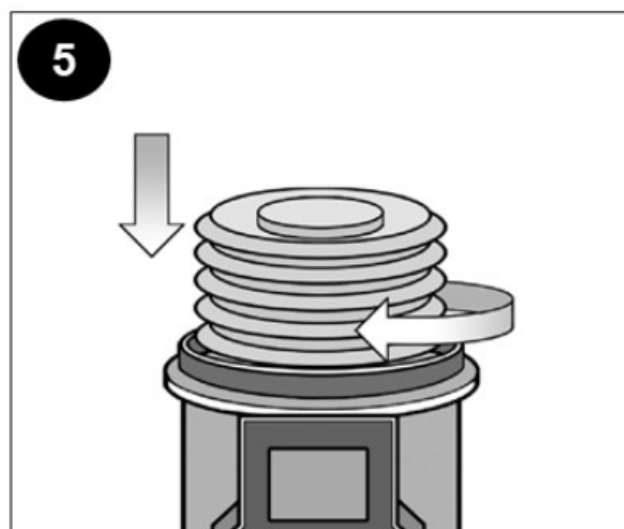

Refit the top housing on the unit and turn clockwise until it clicks.

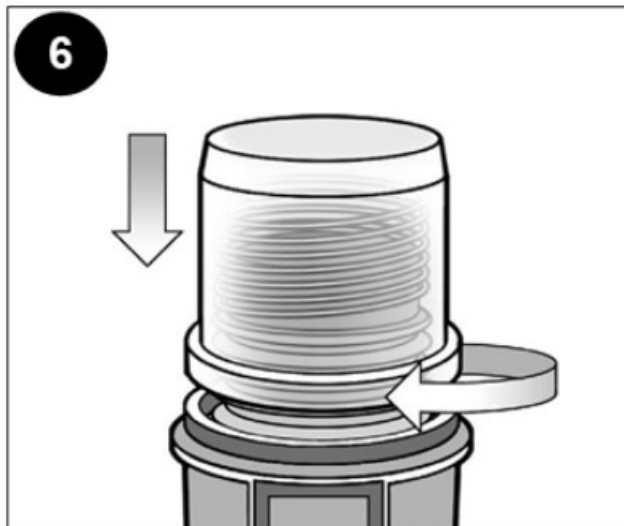

Hold the power button for 2 seconds to power it on.

Hold the mode lock button for 2 seconds to unlock the display and cycle through dispensing modes.

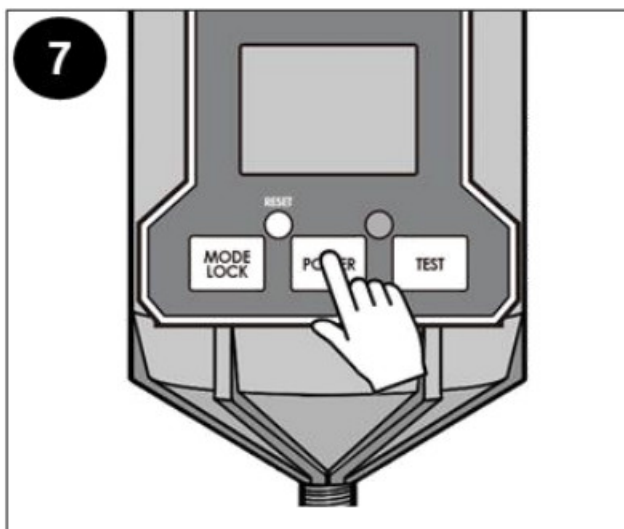

Hold the test button for 2 seconds to run a test cycle of 6 dispenses.

Check for proper operation of the unit and keep using the test mode until the M-UE generic pre-lube has been replaced with the lubricant in the grease pouch.

Note: If there is an issue with this step, refer to the troubleshooting tips section on page 13.

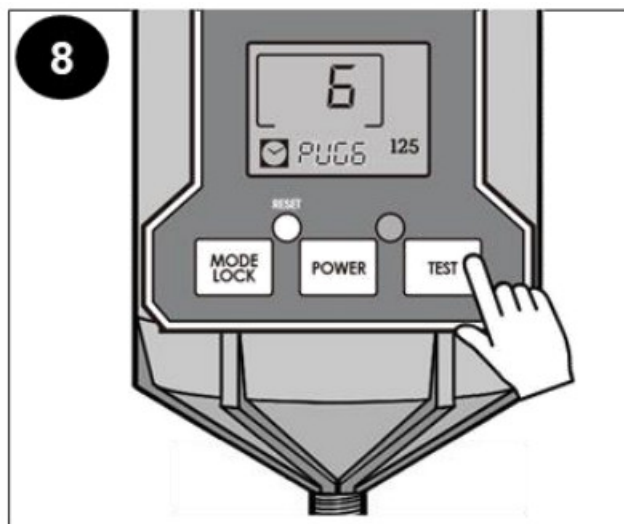

Note the installation date and grease type using the label provided in the service pack for maintenance purposes.

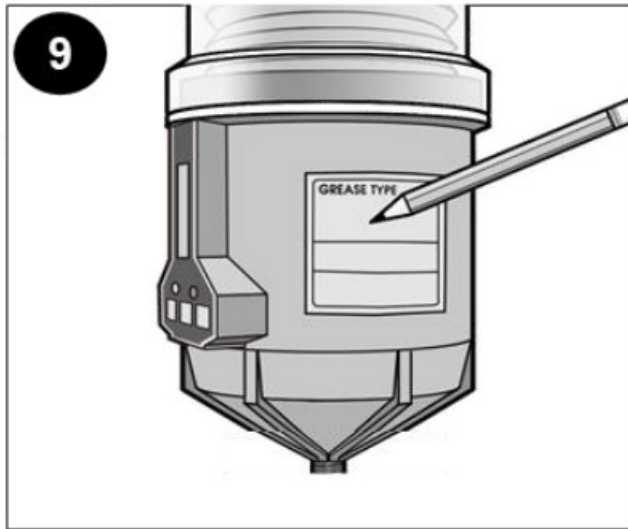

Install the lubricator on the lube point and follow steps 3 – 7 when replacing service packs.

Note: Before replacing, swap out the battery for a new battery and clean the lube point with a damp cloth.

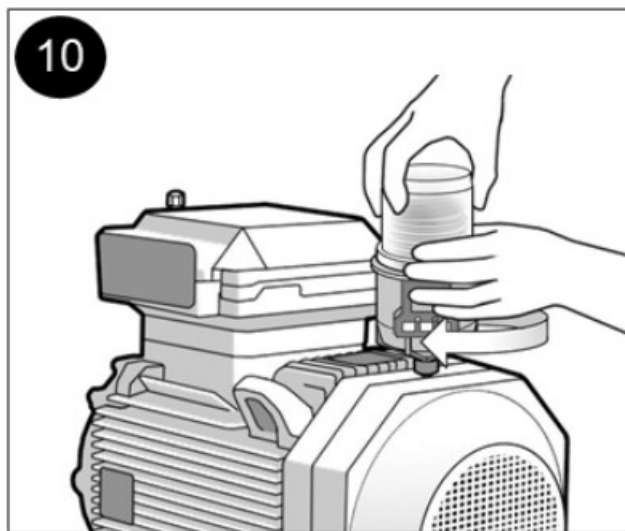

Run the M-UE cable to the OnTrak controller and terminate the wires in 1 of the 16 available channels. For more information, refer to the OnTrak user manual.

1. Black Wire, GND – Terminal # 10
2. White Wire, Signal – Terminal # 9

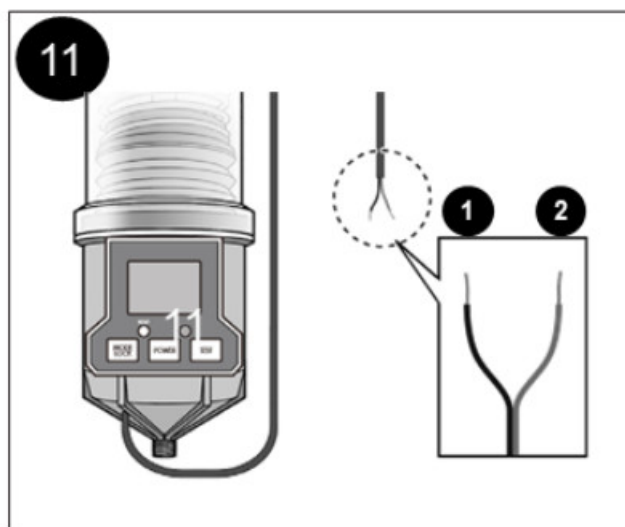

Optional: Install the dust cover over the lubricator for added protection in a messy environment.

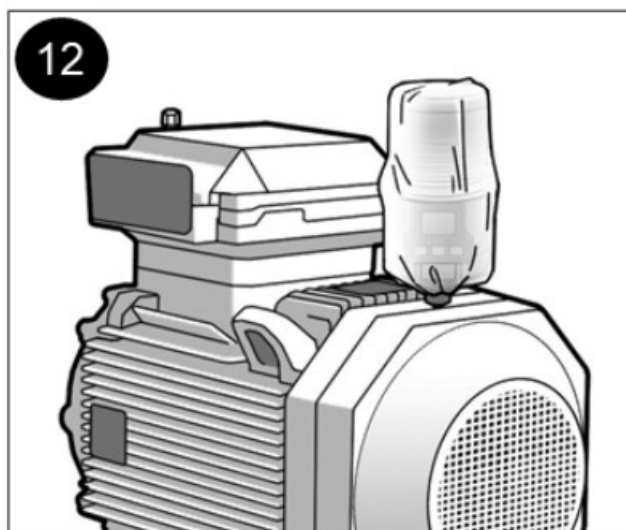

Mounting Options

Direct Mount

The dispense port on the M-UE is 3/8". First, check the size required on the lube point and use an appropriate 3/8" Female to lube point thread size Male brass reducer.



Remote Mounting (Optional)

For applications where heat, space, and vibration are of concern, remote mounting is highly recommended in either 10 ft or 20 ft options.

AL-1250RC-1: M-UE High-Pressure Single Point Remote Installation Kit with 10 ft. Nylon, Prefilled Distribution

Tubing, O.D. 1/4" (6mm).





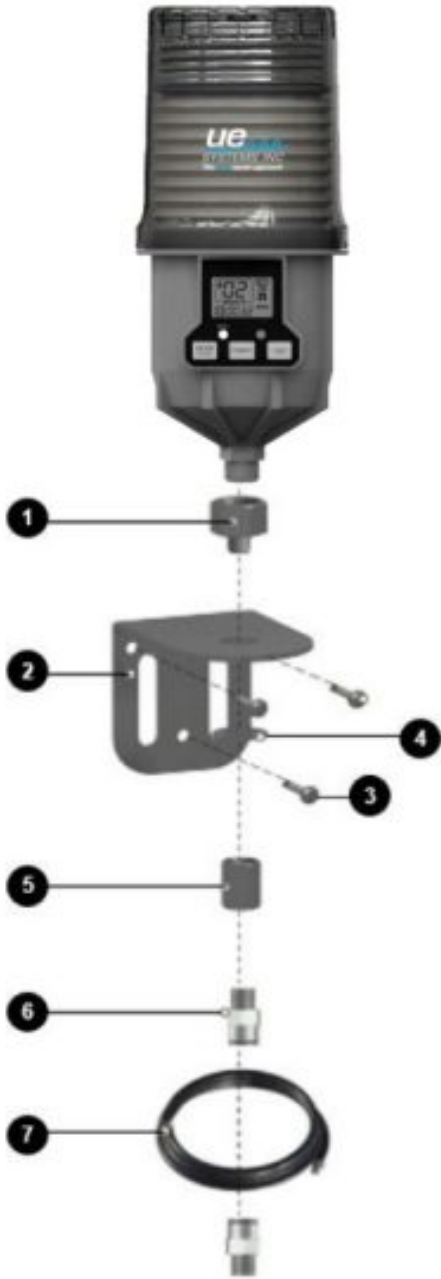

AL-A214-2: M-UE High-Pressure Single Point Remote Installation Kit with 20 ft. Nylon, Prefilled Distribution Tubing, O.D. 1/4" (6mm).

For remote installation ensure the tube that's been ordered is using the same grease type as contained in the M-UE cartridge and is compatible with the machine.



Number	Description	QTY
1	Reducer, 3/8"F x 1/8"M Adaptor (Brass)	1
2	Mounting Bracket "L" Shape	1
3	Self Drilling Screw, #8 x 20	3
4	Washer	3
5	Socket, 1/8"F x 1/8"F Adaptor (Brass)	1
6	Tube Fitting, Push-In Type, PC6-PT1/8"M	2
7	Distribution Tubing, 10ft or 20 ft Pre-filled with (Grease Type)	1

Troubleshooting Tips

<p>Symptom: Operation on hold due to non-detection of the motor st?</p> <p>Possible Cause: Sensor may break when dropped.</p> <p>Solution: Contact us for troubleshooting support.</p>	
<p>Symptom: Excessive back-pressure indication.</p> <p>Possible Cause: Hardened grease obstructing the lube point or the lube one has been bent over time.</p> <p>Solution: Purge grease into the lube point using a manual grease gun to eliminate the hardened grease that may be causing an obstruction. This alleviates excessive backpressure.</p>	
<p>Symptom: Motor not resporidtig.</p> <p>Possible Cause: Electric motor may not be able to be activated due to the possible electrical e nvironment.</p> <p>Solution: Contact us for troubleshooting support.</p>	
<p>Symptom: Operation continues on hold without dispense activation.</p> <p>Possible Cause: Low battery cannot support the operation</p> <p>Solution: Replace the battery with a new service pack.</p>	
<p>Symptom: Blank LCD screen</p> <p>Possible Cause: CPU electrical malfunction or battery issue.</p> <p>Solution: Replace the battery pack and press the reset button to restart the lubricator. Contact us if the problem persists.</p>	
<p>Symptom: Light flashes green indicating a successful cycle but no grease is dispensed.</p> <p>Possible Cause: Improper cartridge storage.</p> <p>Solution: Squeeze the cartridge while in test mode and ensure the service pack was stored at t he right temperature.</p>	

Customer Support

Have a question or need assistance with your single-point lubricator?
 Want more information regarding products or training?

Contact Us

UE Systems Inc.

Toll-Free – **800.223.1325**

Phone – **914.592.1220**

Fax – **914.347.2181**

Email – info@uesystems.com

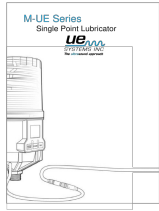

OR Visit – www.uesystems.com

Documents / Resources



[ue SYSTEMS M-UE Series Single Point Lubricator](#) [pdf] User Manual
M-UE Series, Single Point Lubricator

References

-  info@uesystems.com
-  [Ultrasonic Predictive Maintenance and Condition Monitoring – UE Systems](#)
-  [Ultrasonic Predictive Maintenance and Condition Monitoring – UE Systems](#)

Manuals+.