

**UdiRC<sup>®</sup>**  
**UCX24 Wireless**  
**Radio System**



# UdiRC UCX24 Wireless Radio System Instruction Manual

[Home](#) » [UdiRC](#) » UdiRC UCX24 Wireless Radio System Instruction Manual 

## Contents

- [1 UdiRC UCX24 Wireless Radio System](#)
- [2 Product Usage Instructions](#)
- [3 TRANSMITTER DATA](#)
- [4 TRANSMITTER CONTROLS/FUNCTIONS](#)
- [5 FAQ](#)
- [6 Documents / Resources](#)
  - [6.1 References](#)

**UdiRC<sup>®</sup>**

**UdiRC UCX24 Wireless Radio System**



### Specifications:

- **Model:** UCX24-E007
- **Frequency Band:** 2.4GHz
- **Channels:** 4

### Product Usage Instructions

Before installing and operating your new radio system, please take a few minutes to familiarize yourself with the various features of the system by reading this instruction manual thoroughly.

#### Safety Precautions

This product is a sophisticated hobby product and not a toy. It must be operated with caution and common sense and requires some basic mechanical ability. Failure to operate this product in a safe and responsible manner could result in injury or damage to the product or property. This product is not intended to be used by children without direct adult supervision. It is essential to read and follow all instructions and warnings found in this manual prior to installation, set up, and use, in order for the product to operate properly and to avoid damage or injury.

### TRANSMITTER DATA

- **Model:** UCX24-E007
- **Input Power:** AAAx4
- **Size:** 175x133x79mm
- **Frequency Band:** 2.4GHz
- **Channels:** 4

#### Transmitter Controls/Functions

Open battery cover at the bottom of transmitter. Install batteries. Follow the direction of batteries designated in the inside of the battery box.

- **Battery Cover:** Open the cover at the bottom, install batteries following the designated direction.

- **Regulatory Interface:** M1, M2, M3, M4
- Front Sub-trim, Rear Sub-trim, Reverse for CH2, F.ST.TRIM, ST.D/R, R.ST.TRIM, TH.TRIM, MODE, TH.REV, ST.REV
- **Mode Status Light:** Indicates weak signal or low power.
- Throttle Sub-trim, Reverse for CH1, Mode Selection Button
- **Transmitter Indicator:** Flashing indicates weak signal or low power.
- **Power Switch:** ON/OFF, ensure throttle trigger and steering wheel are normal before startup.
- **CH1 Steering Wheel:** Left, Neutral, Right. Emergency flashers and high lights activation.
- **CH2 Throttle Trigger:** Forward/Speed up, Backward/Speed down, Neutral.
- **CH3:** Headlights and fog lights control, frequency pairing.
- **CH4 Throttle Speed Limit Switch:** Low speed, Neutral, High speed.

## Usage Guidelines

1. Ensure proper battery installation following designated direction.
2. Check mode status light for signal strength and power level indications.
3. Handle weak signal or low power situations promptly to avoid accidents.
4. Follow specific instructions for throttle trigger and steering wheel operation.
5. Activate emergency flashers and high lights as needed.
6. Keep throttle trigger in neutral position for electric vehicles.
7. Properly pair frequencies for smooth operation.

Before installing and operating your new radio system, please take a few minutes to familiarize yourself with the various features of the system by reading this instruction manual thoroughly.

## TRANSMITTER CONTROLS/FUNCTIONS

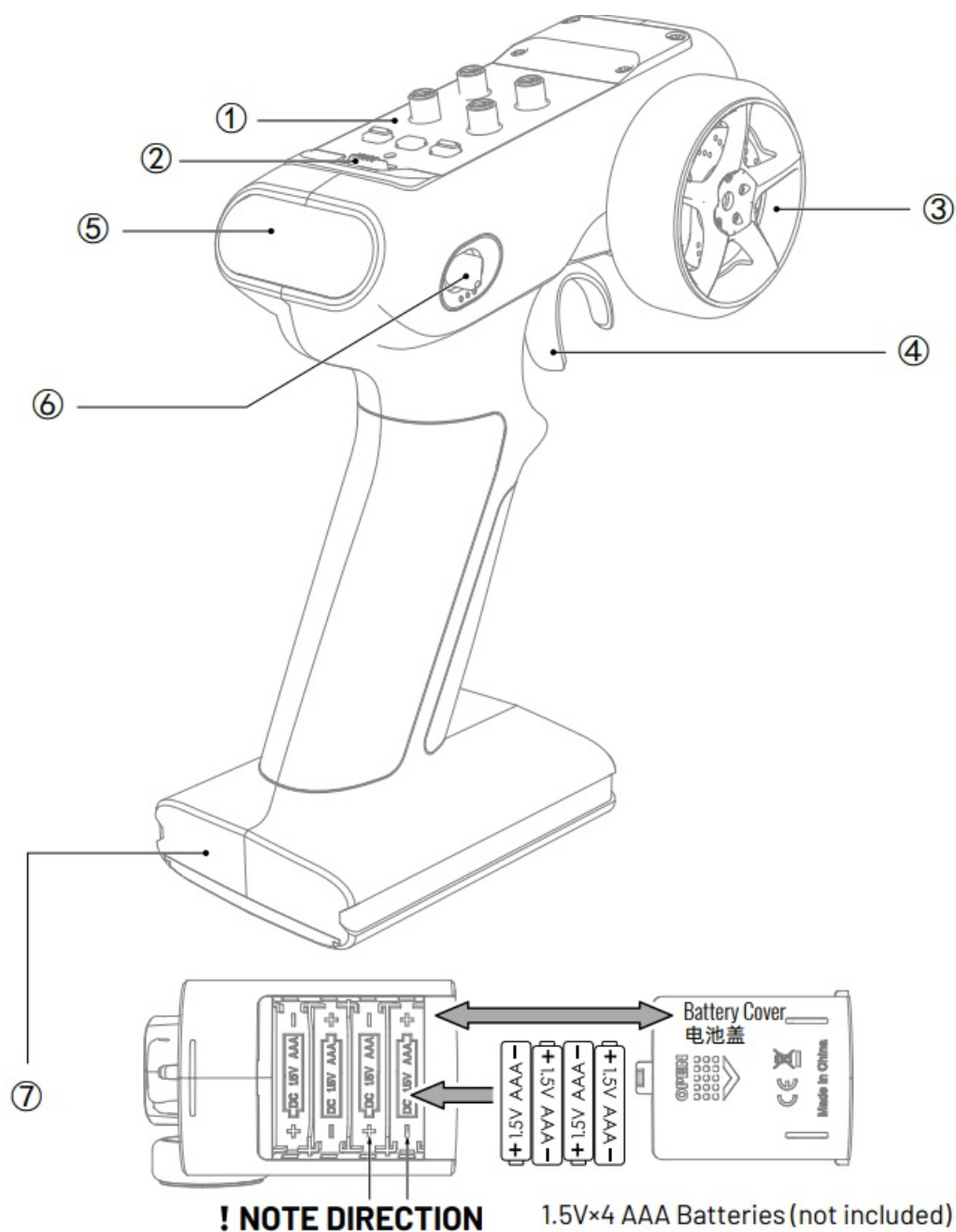

Open battery cover at the bottom of transmitter. Install batteries. Follow the direction of batteries designated in the inside of the battery box.

## 1. Regulatory interface

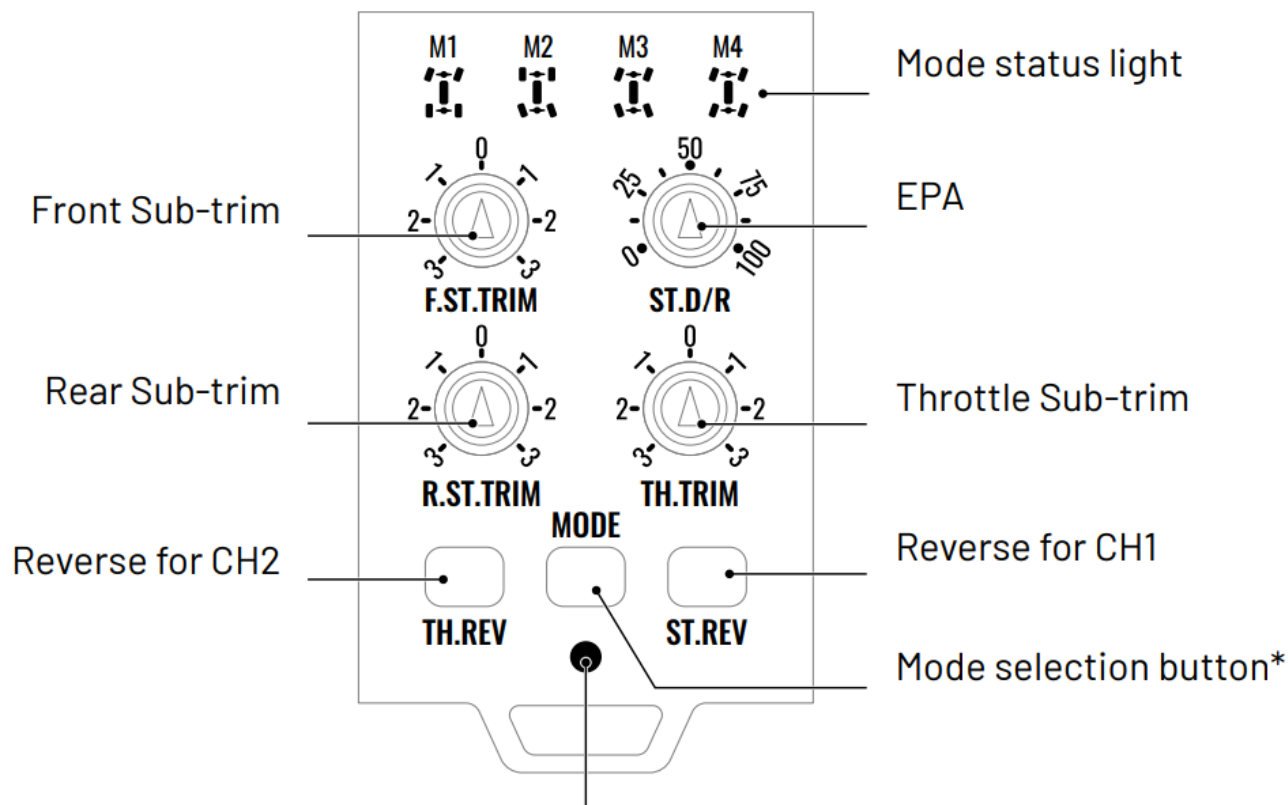

### Transmitter indicator

When the signal is weak or interrupted, the indicator will flash quickly. When the power of the transmitter is low, the indicator light will flash slowly. The above situation should be handled as soon as possible to avoid accidents.

**Note:** \*Default front wheel steering (M1), other modes available with purchase of rear wheel upgrade kit.

## 2. Power switch



- Please make sure the transmitter throttle trigger and Steering wheel to normal before starting up. Do not touch the throttle trigger when turning on the power of the transmitter.
- Power on the transmitter, will sound "di", and the indicator light flashes to enter the frequency state.

## 3. CH1, Steering wheel

- Turn on the emergency flashers by twisting it left to hold for a maximum of 3 seconds.

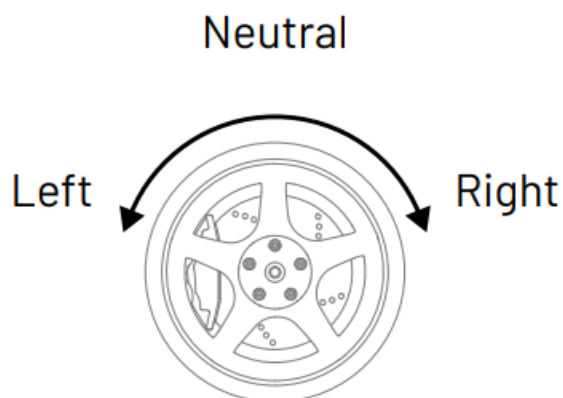

- Turn on the high lights by twisting it right to hold for a maximum of 3 seconds.



#### 4. CH2, Throttle trigger

**Note:** When using the transmitter in electric-powered vehicles, the throttle trigger should always remain in the neutral position. Otherwise the vehicle may experience erratic operation of the throttle trigger functions.

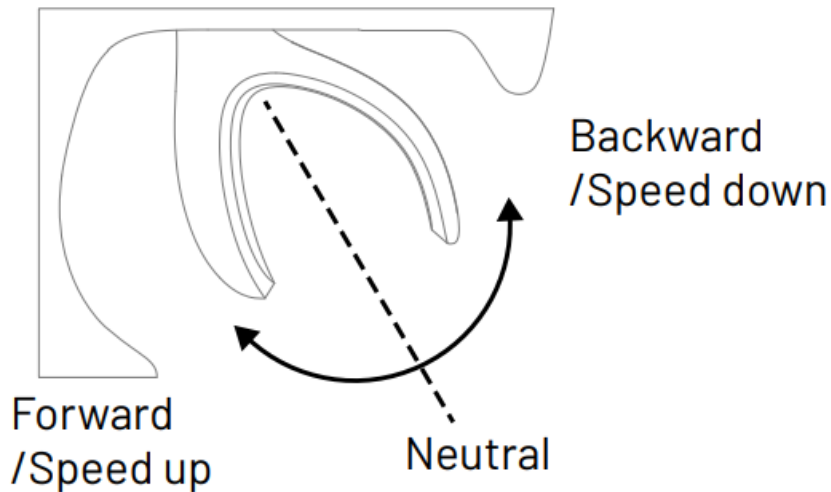

#### 5. CH3

- Short press to headlights switch.
- A long press for 3 seconds switches the fog lights.
- Frequency pairing.
- Automatic frequency failure, turn off all power sources. Turn on power of the vehicle again and the headlights flash, then press the remote control CH3 and turn on the power. When the indicator lights of the car lights and remote control keep bright for a long time, the frequency pairing is successful.

#### 6. CH4, Throttle speed limit switch



Low speed



Neutral



High speed

#### FAQ

##### **Q: What should I do if the transmitter indicator flashes quickly?**

A: The indicator flashing quickly indicates a weak or interrupted signal. Address the issue promptly to avoid any problems.

##### **Q: How do I pair frequencies for the transmitter?**

A: Turn off all power sources, then turn on the vehicle power. Press CH3 on the remote control and turn on the power. Successful pairing is indicated by bright indicator lights on both the car lights and remote control.

#### Documents / Resources



[UdiRC UCX24 Wireless Radio System](#) [pdf] Instruction Manual  
UCX24 Wireless Radio System, UCX24, Wireless Radio System, Radio System, System

References

- [User Manual](#)

[Manuals+.](#) [Privacy Policy](#)

This website is an independent publication and is neither affiliated with nor endorsed by any of the trademark owners. The "Bluetooth®" word mark and logos are registered trademarks owned by Bluetooth SIG, Inc. The "Wi-Fi®" word mark and logos are registered trademarks owned by the Wi-Fi Alliance. Any use of these marks on this website does not imply any affiliation with or endorsement.