

UCTRONICS U6236 AC to DC Power Source and Case Instruction Manual

[Home](#) » [UCTRONICS](#) » UCTRONICS U6236 AC to DC Power Source and Case Instruction Manual 

Contents

- [1 UCTRONICS U6236 AC to DC Power Source and Case](#)
- [2 Packing List](#)
- [3 Decomposition schematic](#)
- [4 Assembly Steps](#)
- [5 NOTE](#)
- [6 Documents / Resources](#)
- [7 Related Posts](#)

UCTRONICS

UCTRONICS U6236 AC to DC Power Source and Case

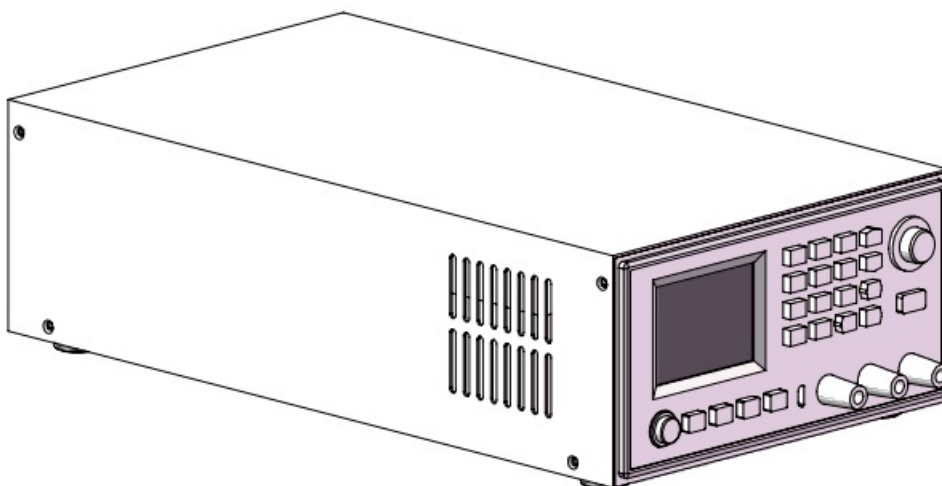

Packing List

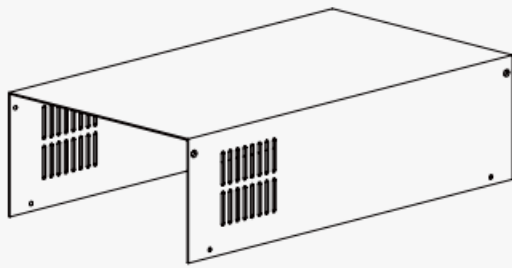

① The upper cover plate

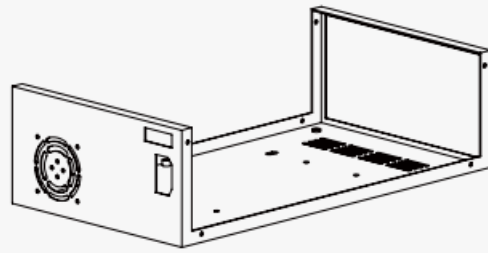

② The lower cover plate

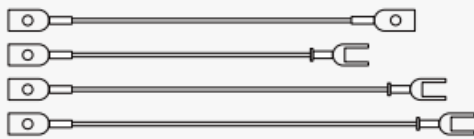

③ Wires for switching power supply, power switch and power socket

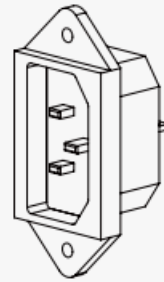

④ Power socket AC-03

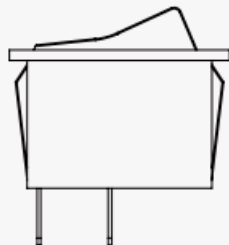

⑤ Power switch KCD3

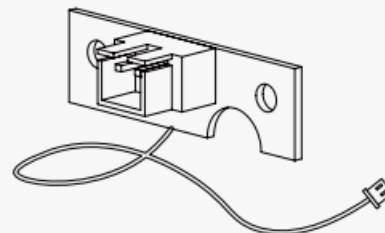

⑥ Temperature sensor extension cable

1. The upper cover plate
2. The lower cover plate
3. Wires for switching power supply, power switch and power socket
4. Power socket AC-03
5. Power switch KCD3
6. Temperature sensor extension cable

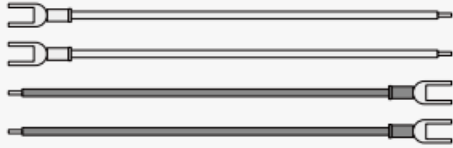

⑦ Wires for switching power supply and output controller



⑧ Screws for switching power supply, pads and temperature sensor extension

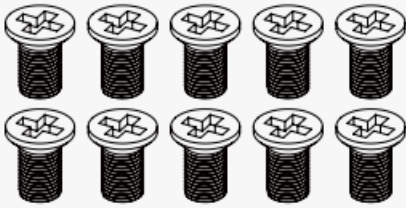

⑨ Screws for covers and Power socket

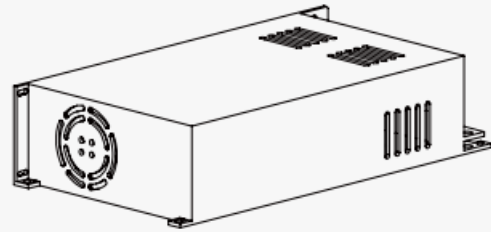

⑩ Switching power supply

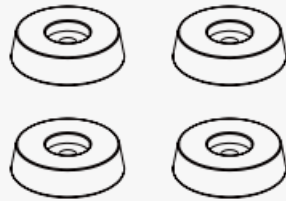

⑪ Pads

7. Wires for switching power supply and output controller
8. Screws for switching power supply, pads and temperature sensor extension
9. Screws for covers and Power socket
10. Switching power supply
11. Pads

Decomposition schematic

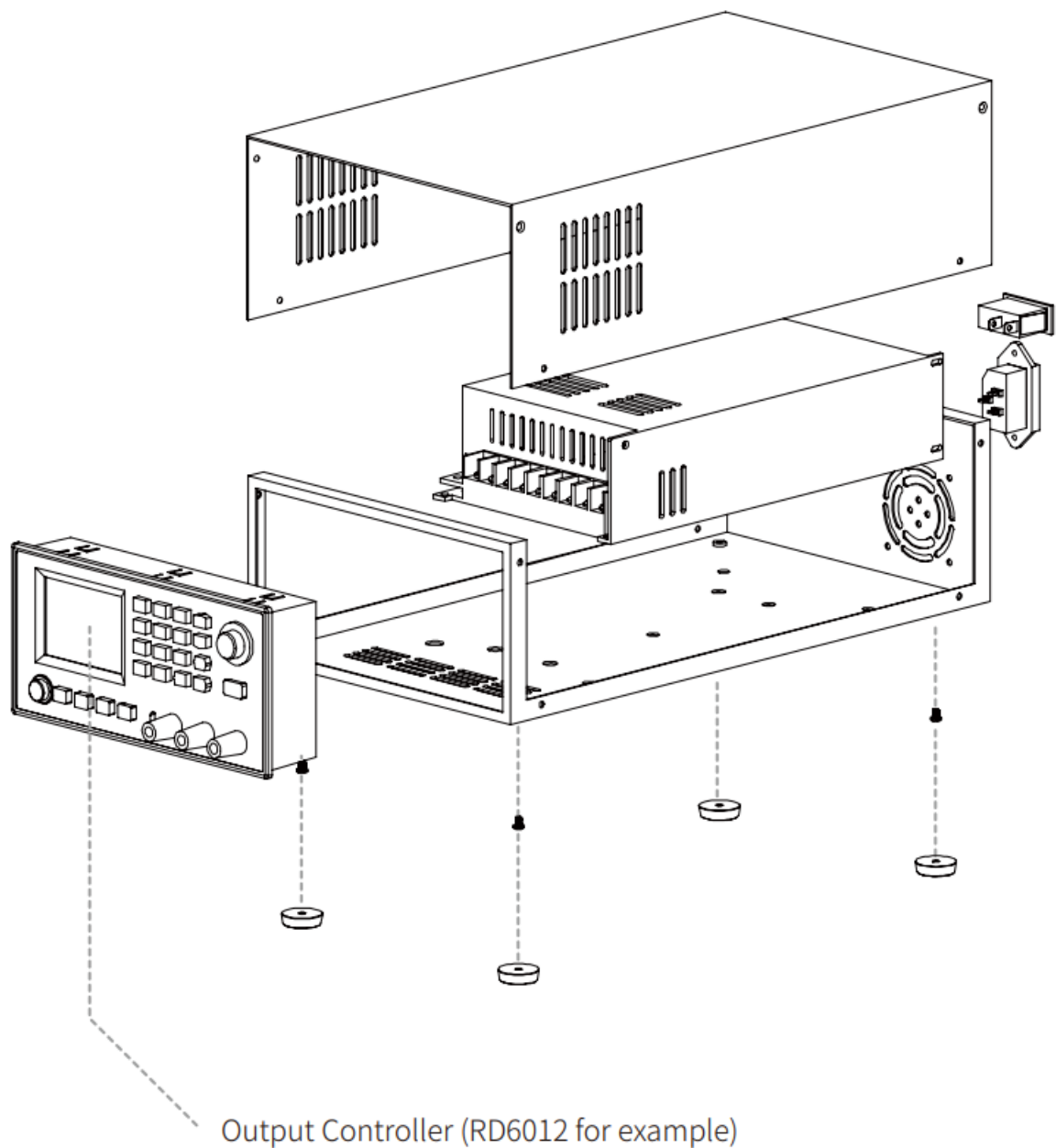

Output Controller (RD6012 for example)

Assembly Steps

- Insert the power switch KCD3 and keep clamped
Insert the power socket AC-03 and fix with the screws 9

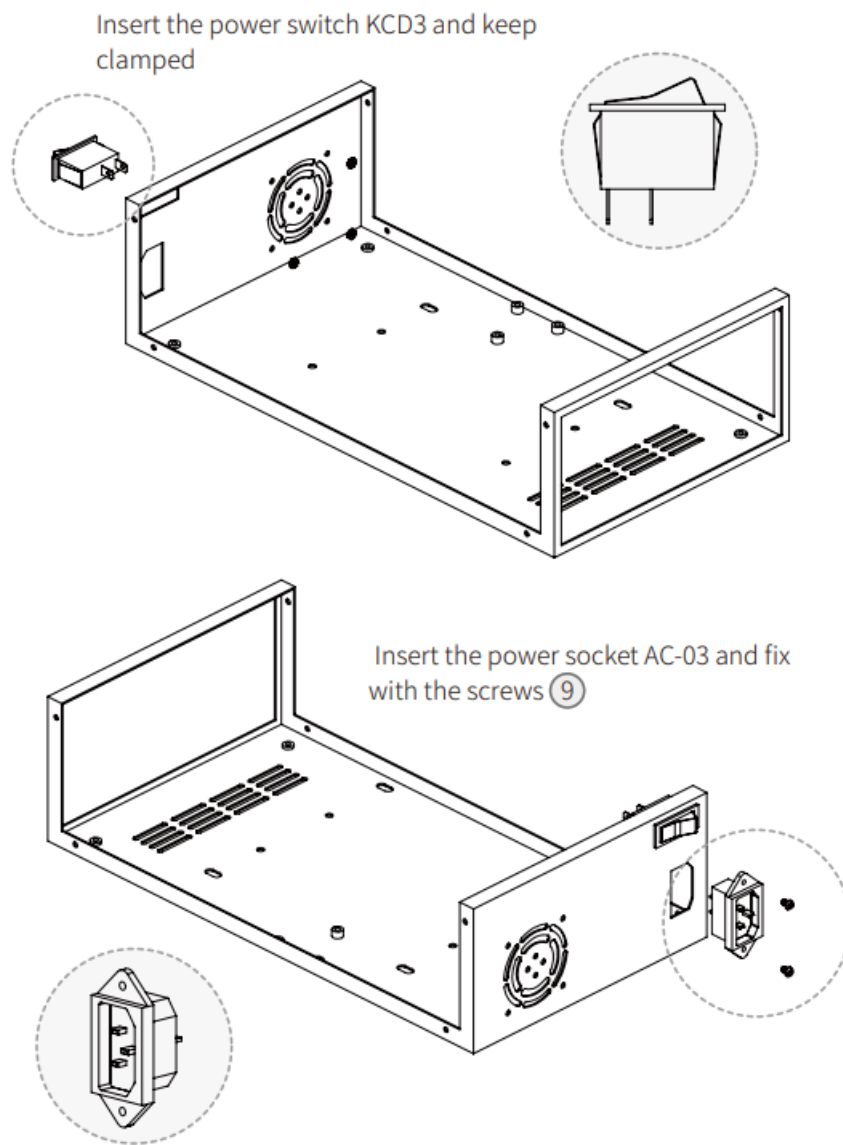

- Mount the temperature sensor extension and fix with screws 8
Mount the switching power supply with the screws 8

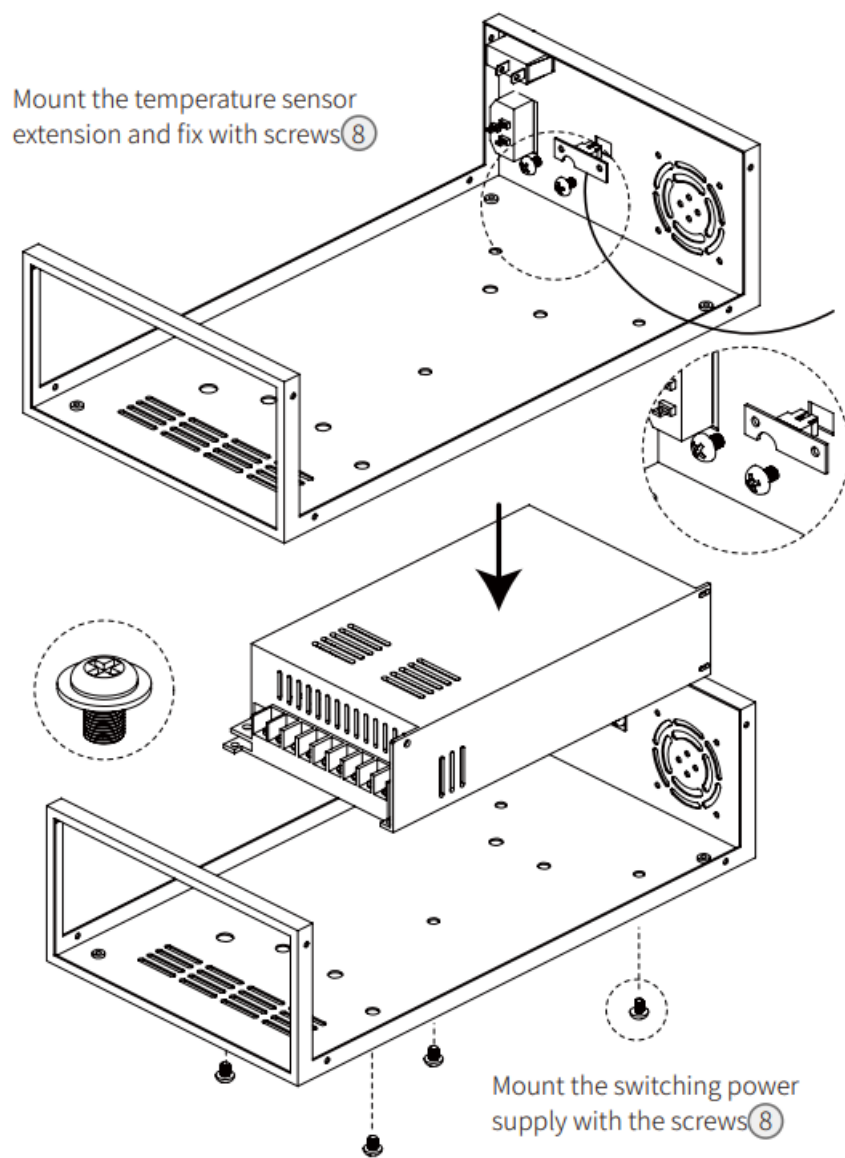

- Insert the blue wire into the Neutral wires(N) of switching power supply
- Insert the double color wire into the ground terminal () of the switching power supply
- Insert the brown wire into the FireWires(L) terminal of switching power supply

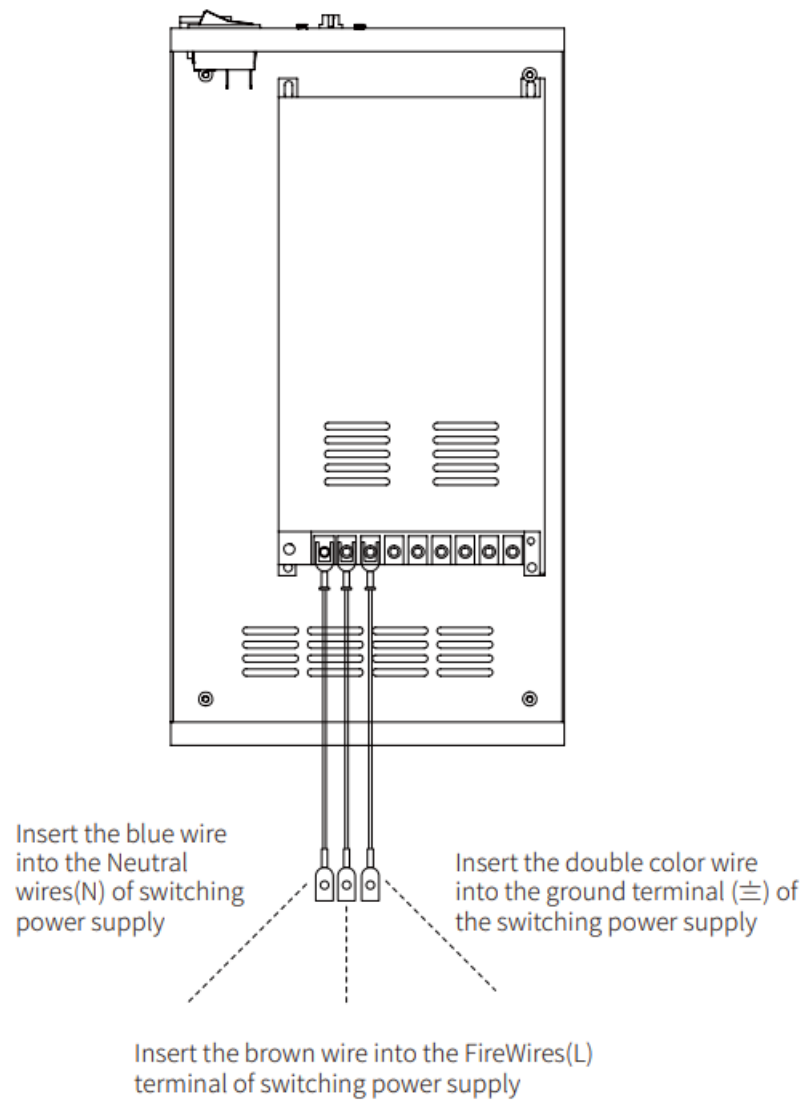

- **Unplug the input power terminal of output controller (RD6012 for example, not included)**

Unplug the input power terminal of
output controller (RD6012 for example,
not included)

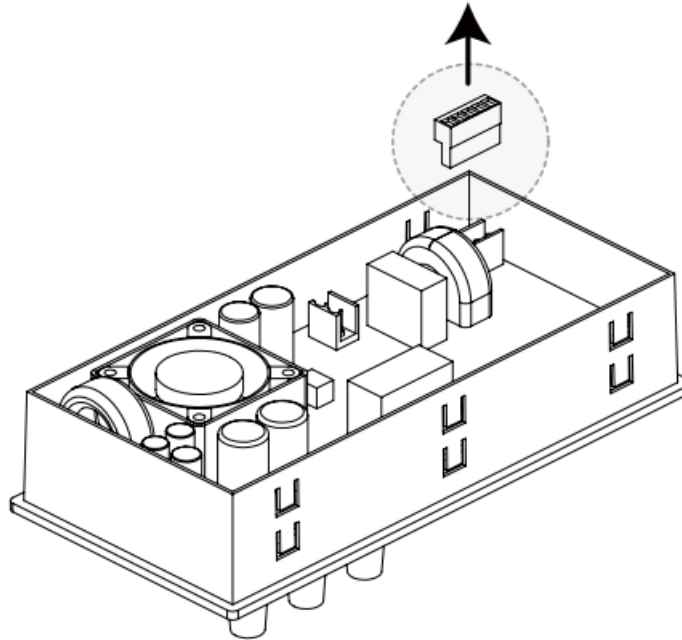
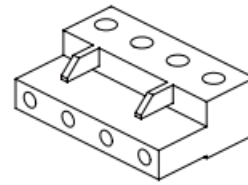

- **Insert the the red and black wires into the terminal and fix them**

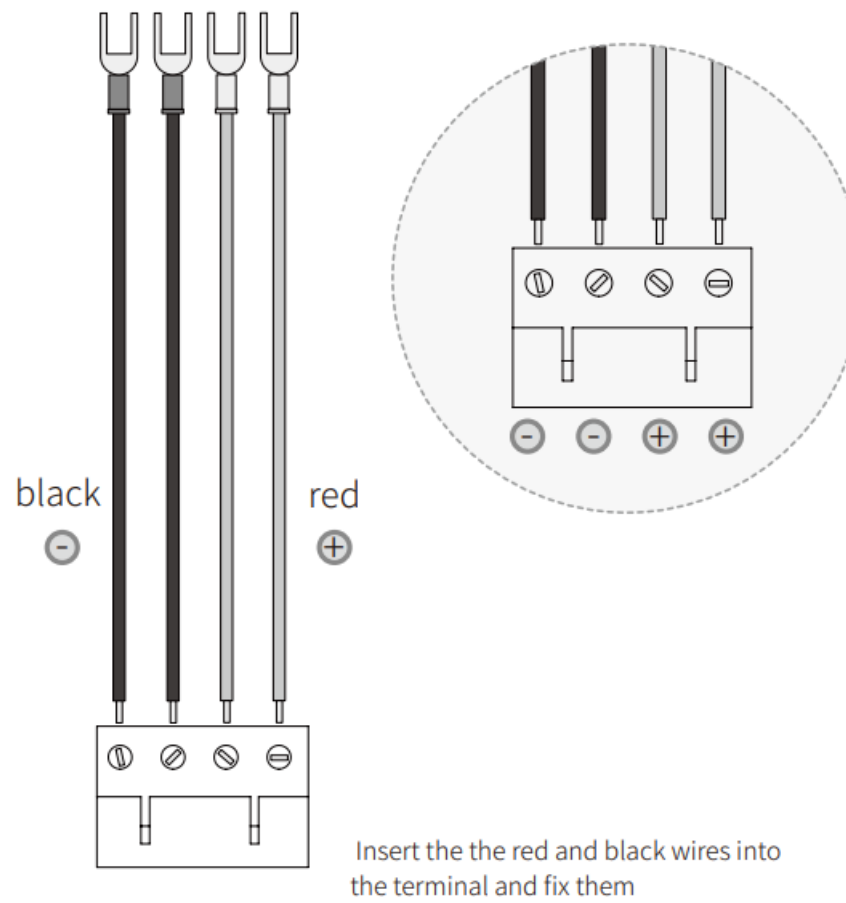

- **Connect the output terminal of the switching power supply to the input terminal of controller RD6012 with red and black wires**

Connect the output terminal of the switching power supply to the input terminal of controller RD6012 with red and black wires

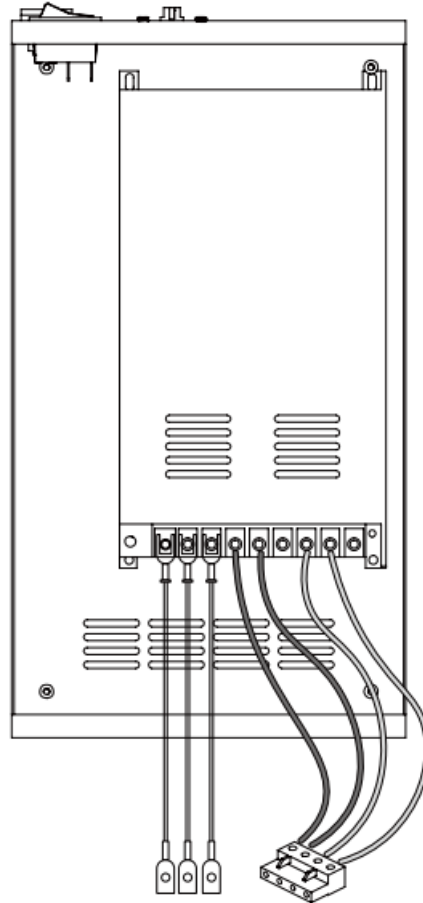

- **Connect the FireWires(L) of power switch and power socket with the short brown wire**
Connect the FireWires(L) of power switch and switching power supply with the brown wire
Connect the Ground wires of power socket (E) to the Ground wires of switching power supply () with the double color wire
Connect the Neutral wires(N) of switching power supply and power socket with the blue wire

Connect the FireWires(L) of power switch and power socket with the short brown wire



Connect the FireWires(L) of power switch and switching power supply with the brown wire

Connect the Ground wires of power socket (E) to the Ground wires of switching power supply (\equiv) with the double color wire

Connect the Neutral wires(N) of switching power supply and power socket with the blue wire

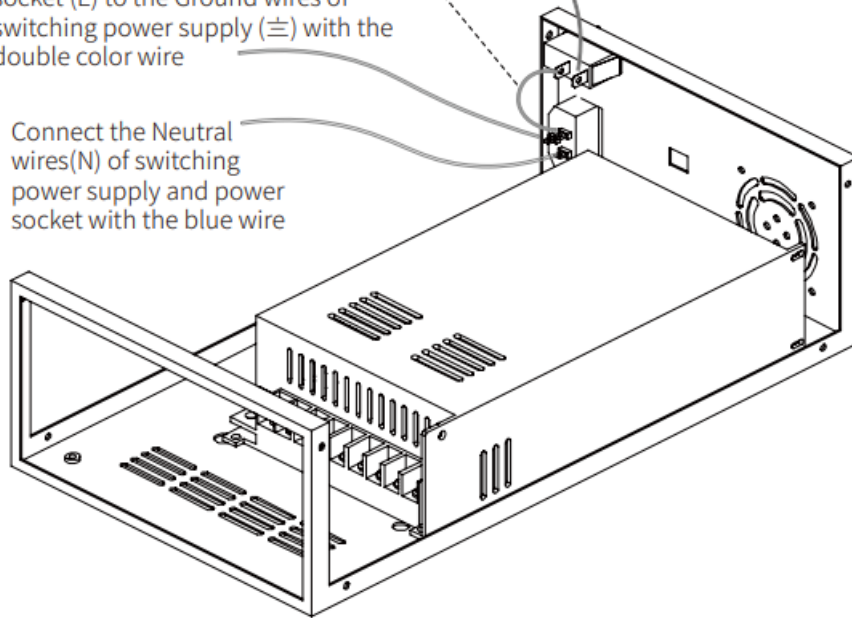

- Insert the output controller RD6012 into the frame

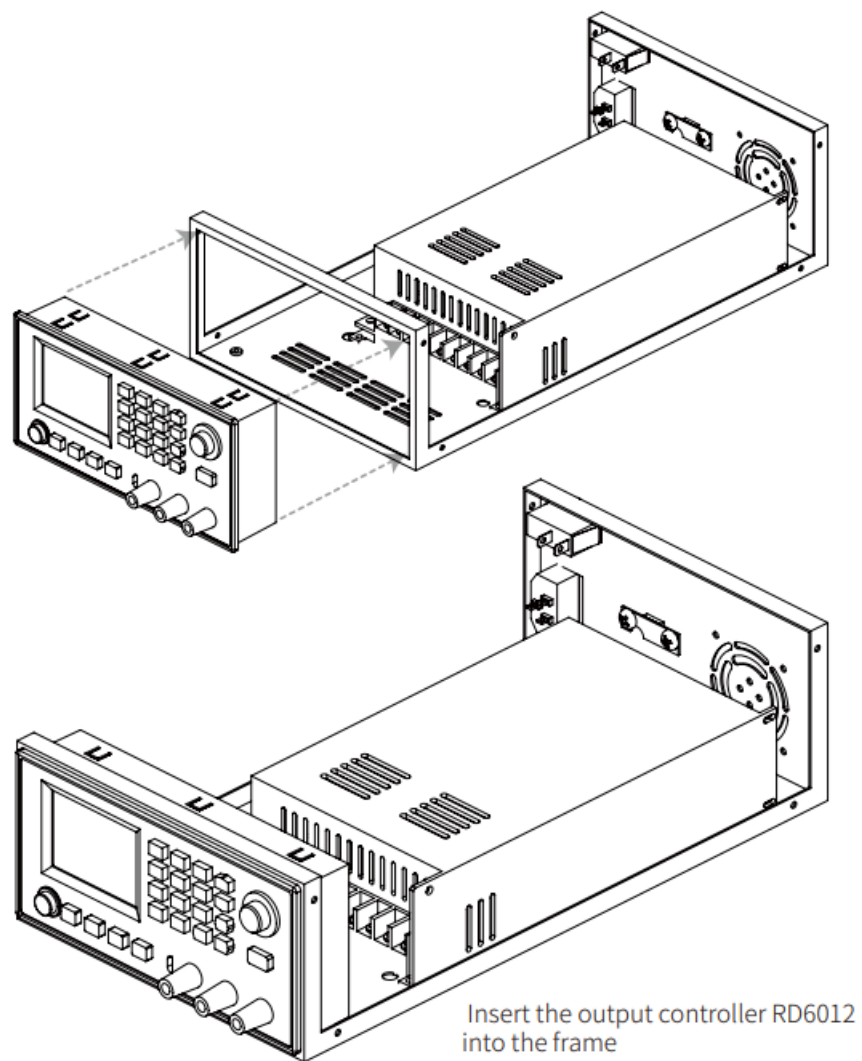

- Plug the input power terminal into the output controller RD6012
Plug the temperature sensor extension into the sort on RD6012

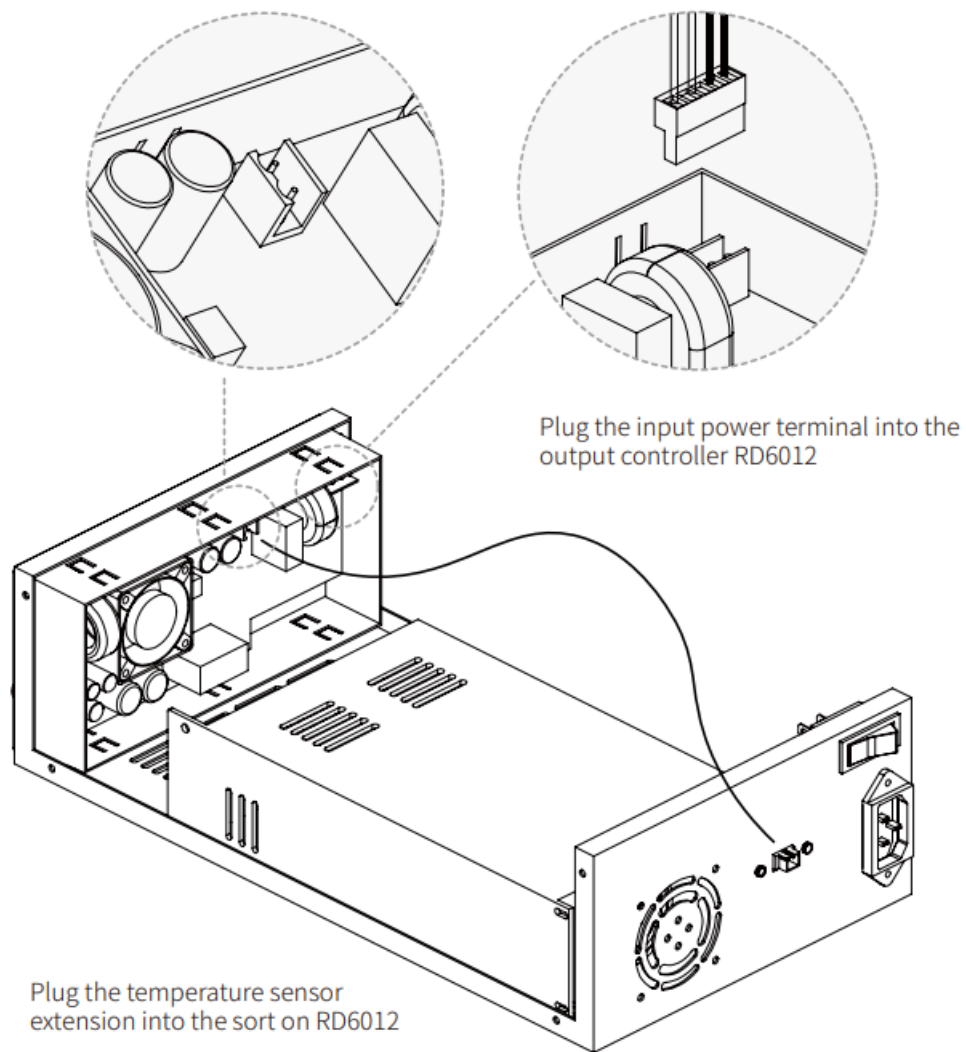

- Assemble the upper cover plate and fix with the screw 9

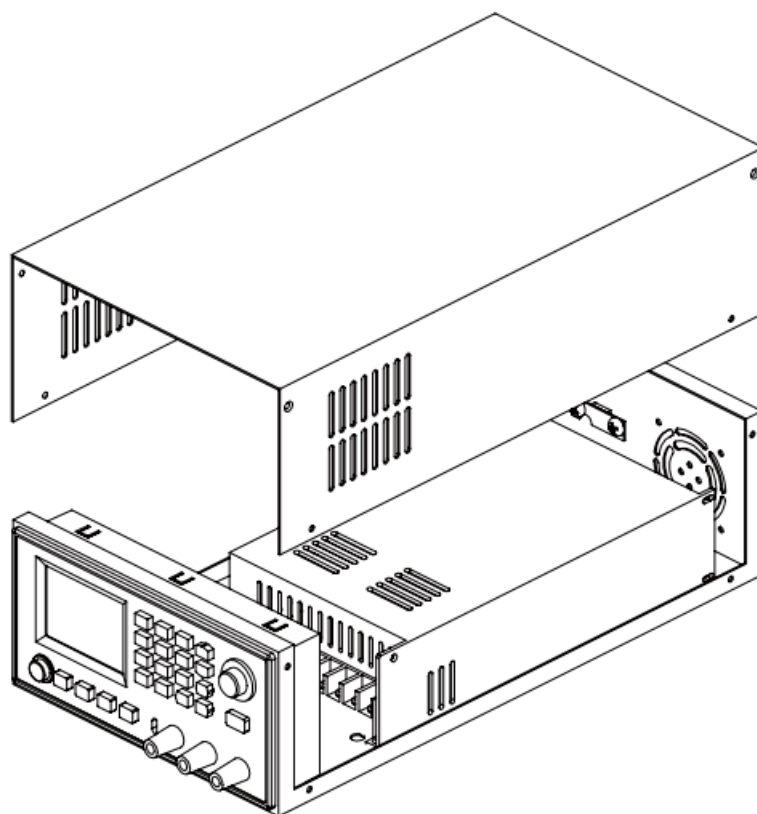

Assemble the upper cover plate and
fix with the screw ⑨

- Mount the pads with the screw 8

Mount the pads with the screw ⑧

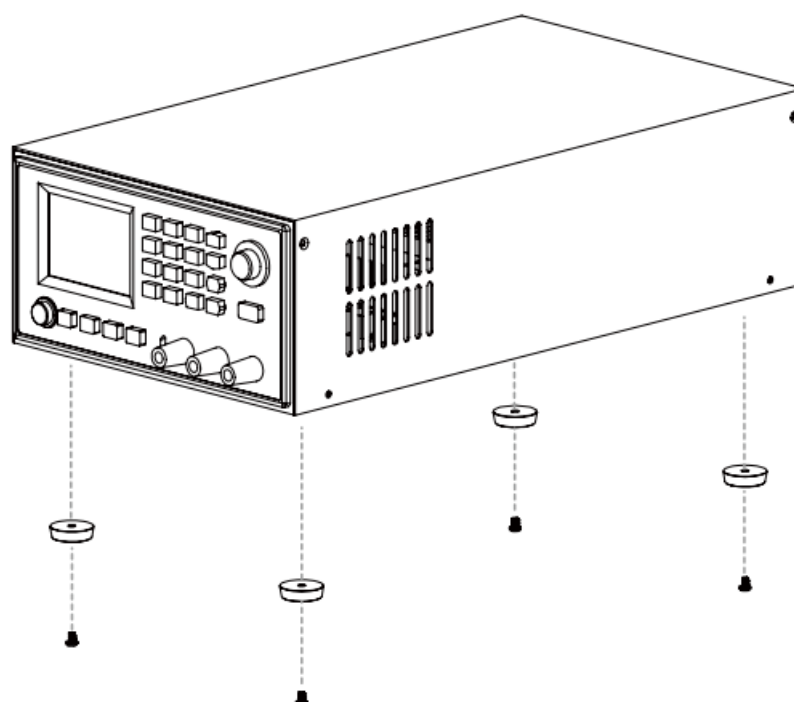

NOTE

- The wiring requests a high level of expertise, non-professionals must not operate, otherwise, there is a risk of fire and explosion.
- Please check and switch the input power 110V or 220V before power on to avoid damage

Any problem, please feel free to contact us. support@uctronics.com
www.uctronics.com

Documents / Resources

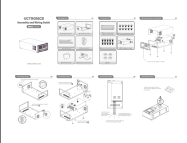
	<p>UCTRONICS U6236 AC to DC Power Source and Case [pdf] Instruction Manual U6236, U6236 AC to DC Power Source and Case, AC to DC Power Source and Case, Power S ource and Case, Source and Case, Case</p>
---	--

Manuals+.