

UBTECH UGOTERX UGOT Programmable Robot Builder Stock



# UBTECH UGOTERX UGOT Programmable Robot Builder Stock User Guide

[Home](#) » [UBTECH](#) » UBTECH UGOTERX UGOT Programmable Robot Builder Stock User Guide 

## Contents

- 1 UBTECH UGOTERX UGOT Programmable Robot Builder Stock
- 2 Product Information
- 3 Product Usage Instructions
- 4 Introduction of product modules
- 5 Model assemble, disassemble, connections and power on
- 6 Wireless connection
- 7 Download And Running
- 8 Specification
- 9 THIS DEVICE COMPLIES WITH PART 15 OF THE FCC RULES
- 10 Warranty Card
- 11 Documents / Resources
  - 11.1 References



UBTECH UGOTERX UGOT Programmable Robot Builder Stock



## Product Information

### Specifications

- **Main Controller:**
  - **Features:** Slot, Loudspeaker, Indicator bar, USB interface, Microphone, Power interface, Open-source hardware interface
- **Battery Box:**
  - **Features:** Battery clip, DC power input
- **Servo and Gear Motor:**
  - **Features:** Power indicator, Servo (orange colour), Gear motor (blue colour)
- **Gripper:**
  - **Features:** Clip slot
- **Sensors:**
  - **Features:** Camera module, TOF module
- **McNumm Wheel and Rubber Wheel**
- **Wire:** Gull-wing plug, Duck-bill plug
- **Components:** Expansion box, Bottom cover, Expansion supports, L-shaped connector, Bionic connectors, Mechanical leg, Rotated supports

## Product Usage Instructions

### Instruction of Servo and Gear Motor

1. Align the slots of the servo and gear motor components.
2. Ensure dimensions are aligned properly for correct assembly.
3. Seal any gaps in the assembly.

## Instruction of Sensors

1. Push the sensors into place.
2. Click to secure the installation of sensors.

## Instruction of Battery

1. Align the battery slots.
2. Lay down the battery in the designated area.
3. Press to secure the battery in place.
4. To remove the battery, pinch and lift it.

## Instruction of UBT Designed Wire

### Note:

Strictly prohibit loop connections to prevent damage to the main controller.

### Important:

Each port supports up to 4 heavy loads; the maximum number of heavy loads for the main controller is 12 (Heavy load memo: Servo and Gear motor).

## Frequently Asked Questions (FAQ)

### How do I establish a wireless connection?

To establish a wireless connection between your PC and UGOT main controller:

- Connect the PC and UGOT main controller to the same router.
- Select Wi-Fi mode or IP mode based on your preference.
- Follow the specific steps provided by the uCode software or website for a successful connection.

### What should I do if I encounter difficulties connecting via Wi-Fi?

If you encounter difficulties connecting via Wi-Fi:

- Set UGOT hotspots on with the provided SSID and password.
- Connect your PC to the UGOT hotspots for assistance.

## uCode



uCode is a software and hardware combination programming client developed by UBTECH for the field of programming education. Students can program by dragging and dropping blocks without using the keyboard.

uCode can not only create interesting games and animation works but can also program the hardware products of UBTECH. It can even realize the virtual reality effect of mutual control of software and hardware through the joint programming of software and hardware, and guide students in creation based on reality.

Download link: <https://ucode.ubtrobot.com/#/>

## Introduction of product modules

### 1. UGOT Main controller

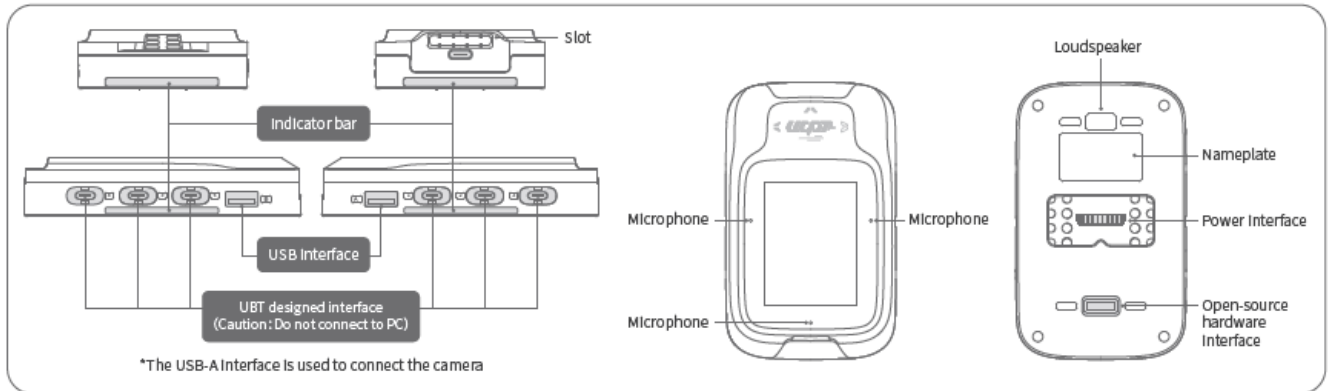

### 2. Battery box

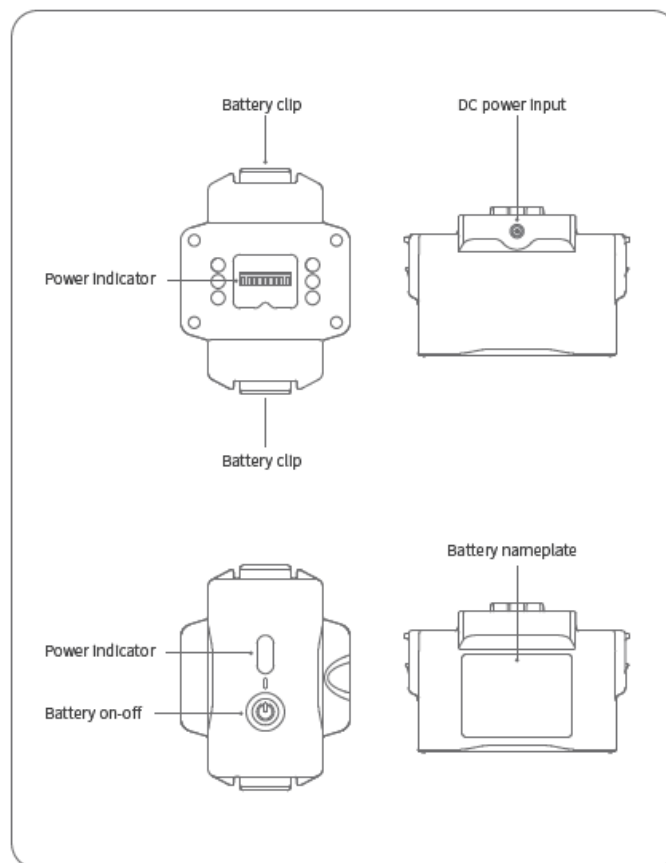

### 3. Servo and gear motor

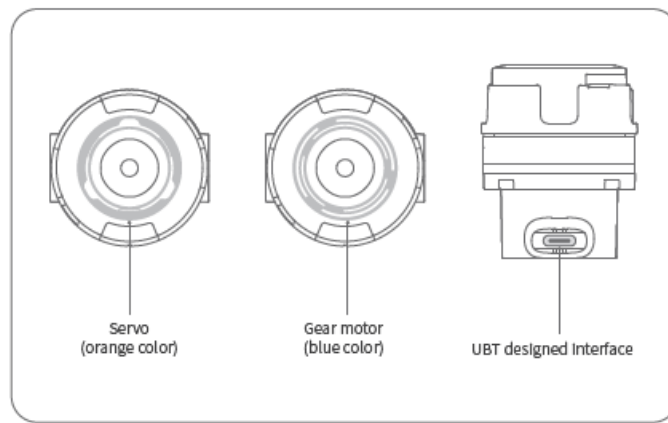

#### 4. Gripper

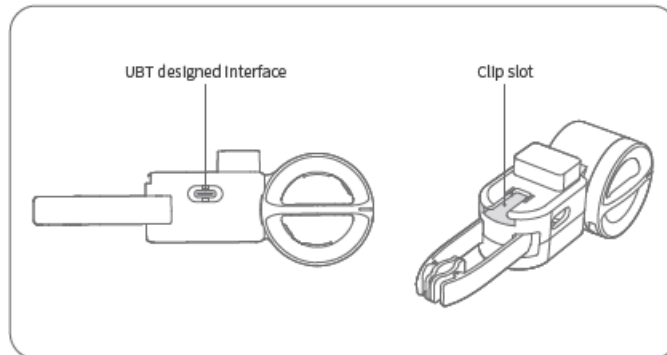

#### 5. Sensors



#### 6. McNumm wheel and rubber wheel

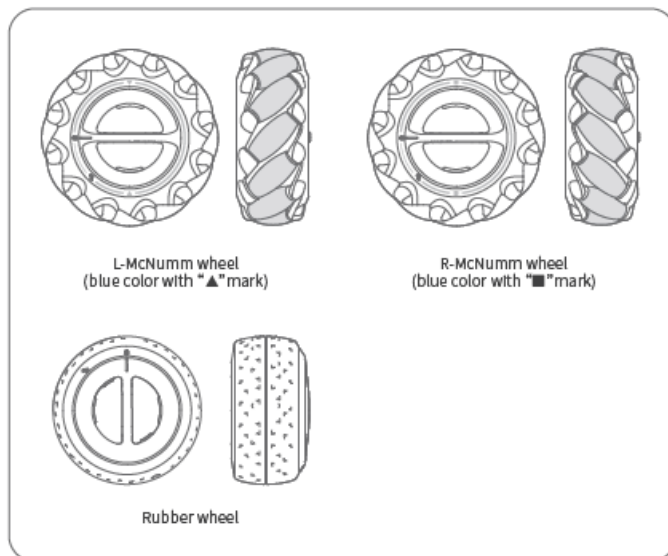

#### 7. Wire

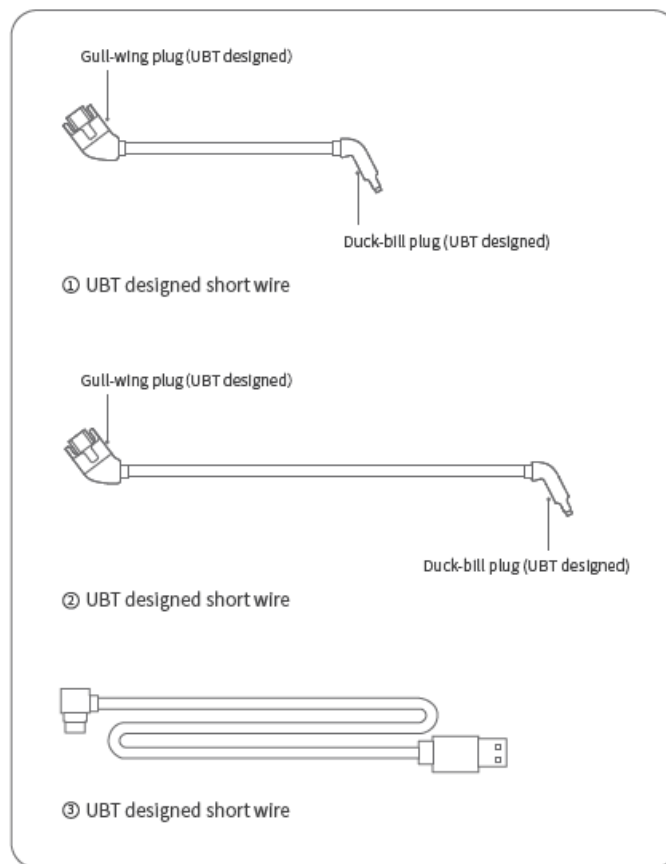

## 8. Components

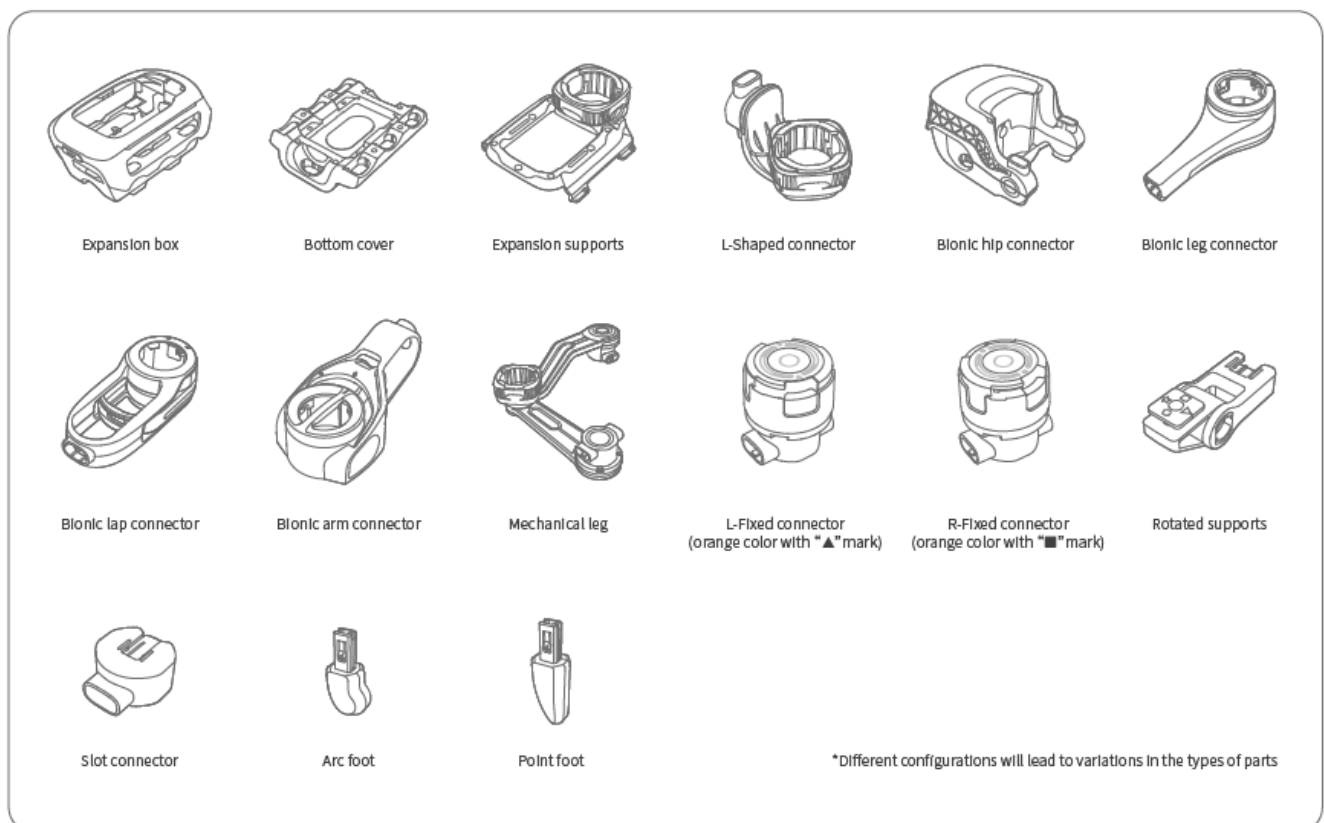

## Model assemble, disassemble, connections and power on

### 1. Instruction of servo and gear motor

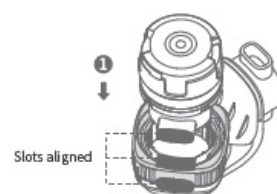
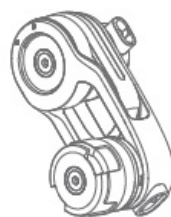
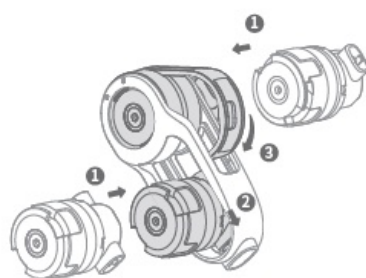
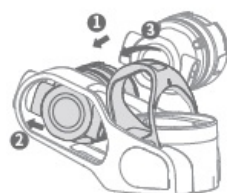
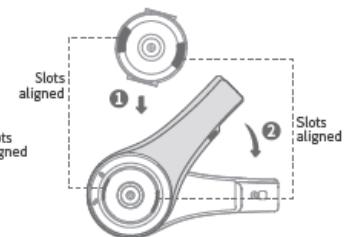
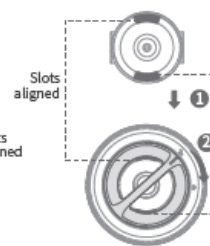
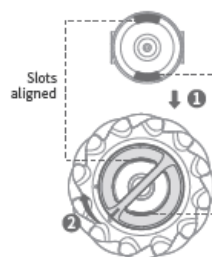
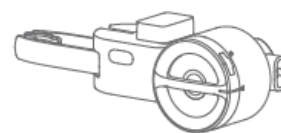
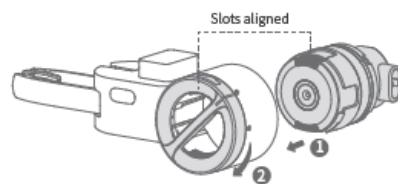
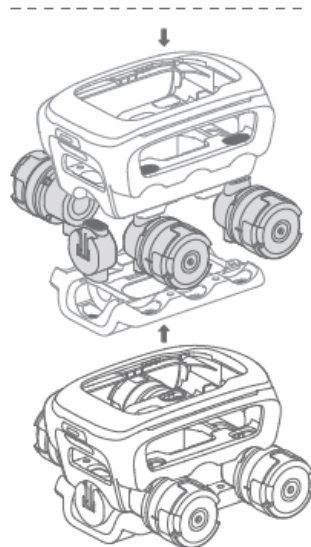
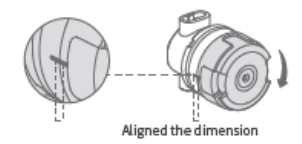

## 2. Instruction of sensors

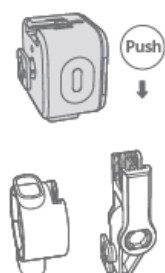

Click

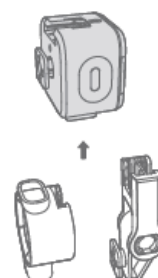
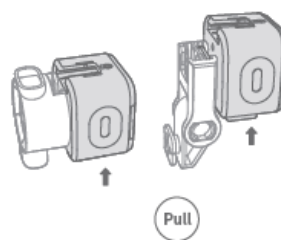
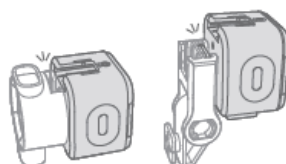

Installation of sensors

Sensors removal

### 3. Instruction of battery

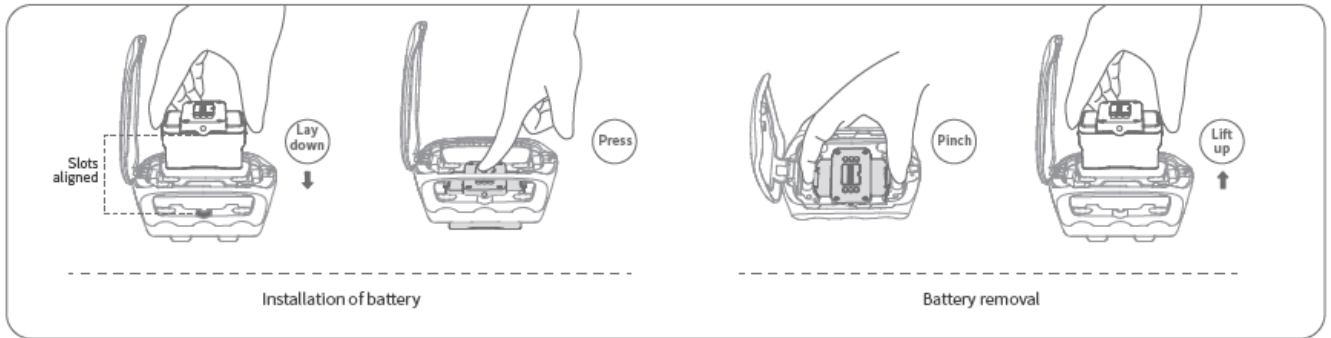

### 4. Instruction of UBT-designed wire

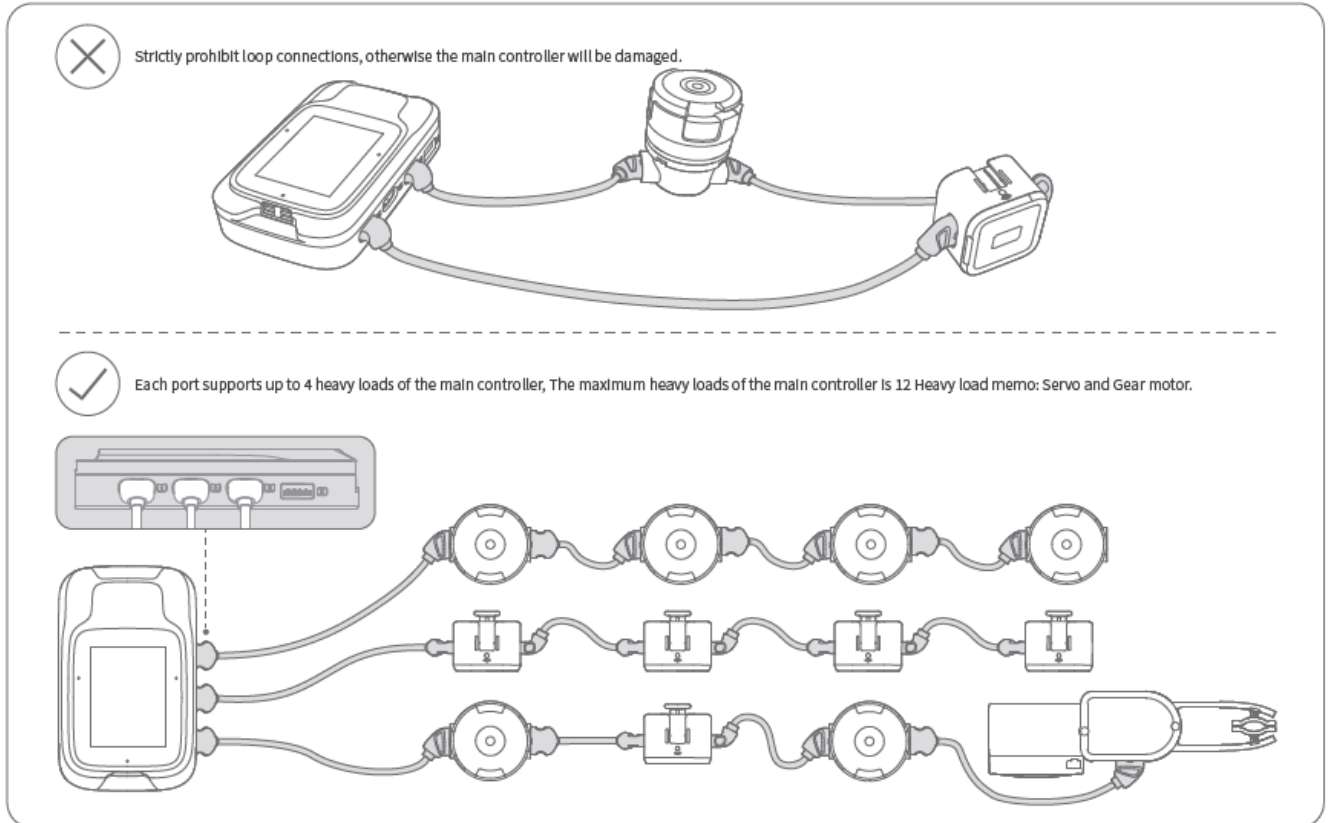



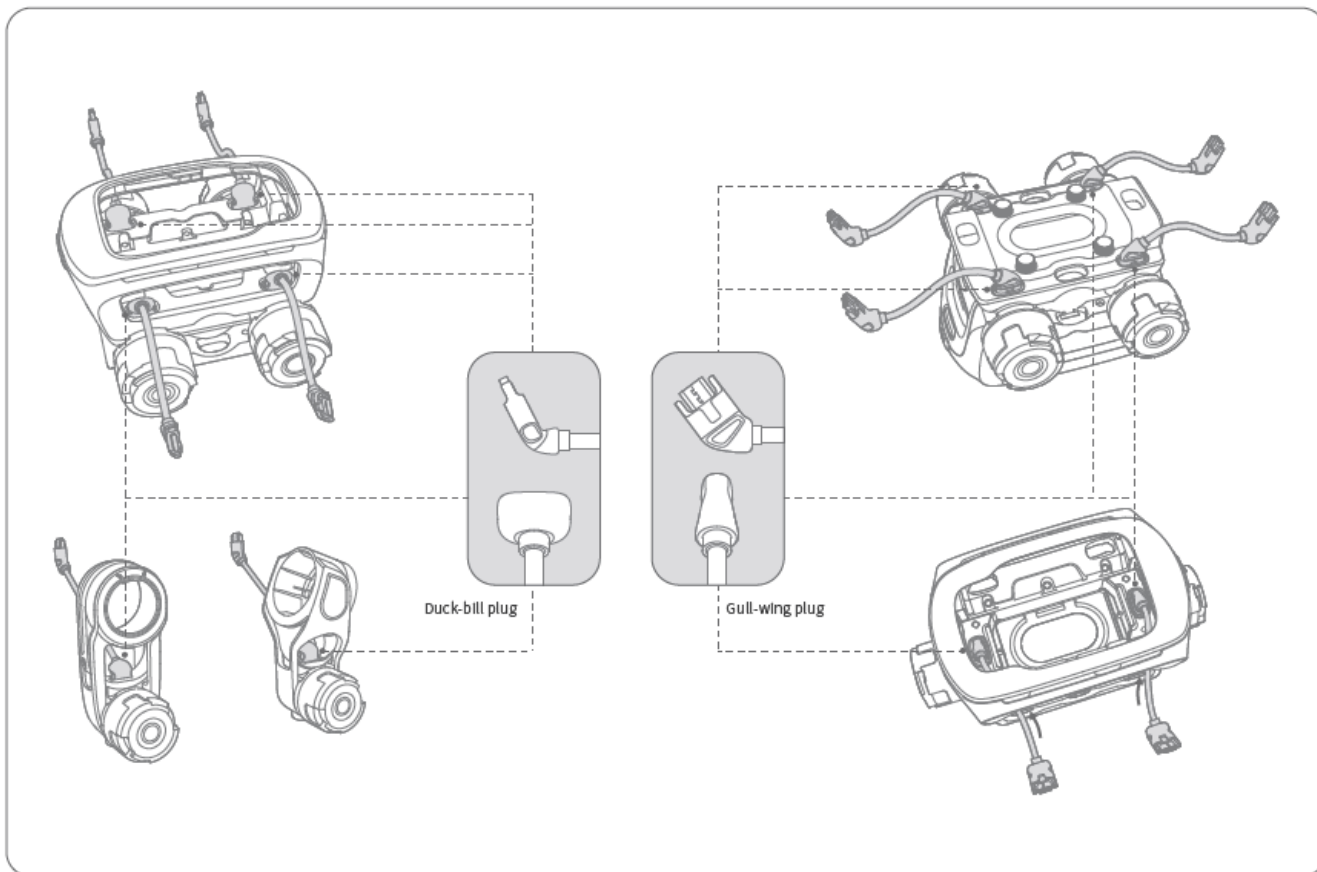



## Wireless connection

<p>Wi-Fi mode</p>	<p>Connected PC and UGOT main controller to the same router. Search UGOT main controller SSID: UGOT_XX XX, by uCode software been installed or uCode website has been opened. There will be some operation tips for you.</p>	<p>Connected PC and UGOT main controller to the same router.</p> <ol style="list-style-type: none"> <li>1 Connect the PC to the Wi-Fi SSID.</li> <li>2 Wipe down the screen of UGOT.</li> <li>3 press the Wi-Fi icon to get the settings list.</li> <li>4 Select the same Wi-Fi SSID as step1.</li> </ol> 
-------------------	--	--

IP mode	<p>Connected PC and UGOT main controller to the same router.</p> <p>Connected UGOT main controller IP address, by uCode software being installed or uCode website being opened. There will be some operation tips for you.</p>	<p>Connected PC and UGOT main controller to the same router.</p> <p>1 Connected the PC to the Wi-Fi SSID.</p> <p>2 Swipe the UGOT screen to the left to get the setting selected.</p> <p>3 Check the main controller IP address in the system information.</p> <p>4 Input the main controller IP address in the uCode dialogue box.</p> 
Hotspots mode	<p>Set UGOT hotspots on, SSID: UGOT_XXXX, Password 12345678. Connected PC to the hotspots. uCode will be some operation tips for you.</p>	<p>Set UGOT hotspots on, SSID: UGOT_XXXX, Password: 12345678.</p> <p>1 Swipe the UGOT screen to the left to get the setting selected.</p> <p>2 Check the hotspot icon to set on.</p> <p>3 Connected the PC to the main controller's hotspots.</p> 
Bluetooth	The details are specified on Bluetooth instruction.	

## Download And Running

### User's program edits and download

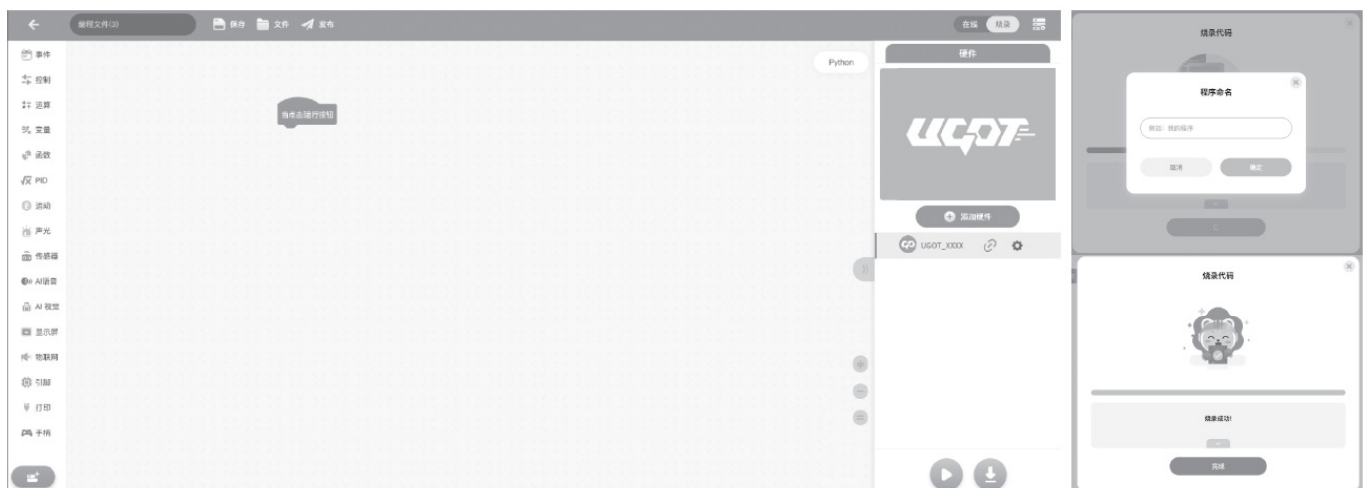

UGOT robot executes action automatically according to executable file download. Which is user edit and generate in uCode.

## Specification

Name	UGOT Robot	Model	ERX Series
DC power input	19V = 1A	Screen	2.4 inch
Nominal Capacity	2600mAh	Materials	PC+ABS
Bluetooth	Bluetooth 5.0	Camera	1M pixels, wide-angle lens
WLAN	2.4G (802.11 b/g/n) / 5G (802.11 a/n/ac)	Operating Temperature	0° to 35° C
Adapter	Input: AC 100-240 50/60Hz 0.6A Max; Output: DC 19.0V 1.0A 19.0 W		

## THIS DEVICE COMPLIES WITH PART 15 OF THE FCC RULES

Changes or modifications not expressly approved by the party responsible for compliance could void the user's authority to operate the equipment.

**This device complies with Part 15 of the FCC Rules. Operation is subject to the following two conditions:**

1. this device may not cause harmful interference, and
2. this device must accept any interference received, including interference that may cause undesired operation.

This equipment complies with FCC radiation exposure limits set forth for an uncontrolled environment. This equipment should be installed and operated with a minimum distance of 20cm between the radiator & your body. This transmitter must not be co-located or operated in conjunction with any other antenna or transmitter.

### Note:

This equipment has been tested and found to comply with the limits for a Class B digital device, under Part 15 of the FCC Rules. These limits are designed to provide reasonable protection against harmful interference in a residential installation. This equipment generates, uses, and can radiate radio frequency energy, and if not installed and used by the instructions, may cause harmful interference to radio communications. However, there is no guarantee that interference will not occur in a particular installation. If this equipment does cause harmful interference to radio or television reception, which can be determined by turning the equipment off and on, the user is encouraged to try to correct the interference by one or more of the following measures:

- Reorient or relocate the receiving antenna.
- Increase the separation between the equipment and the receiver.
- Connect the equipment to an outlet on a circuit different from that to which the receiver is connected.
- Consult the dealer or an experienced radio/TV technician for help.

## Cautions

- Do not connect the designed interface to the PC's USB-C, or the robot/PC will be damaged.
- Use the adapter that came with a robot, otherwise could damage the battery. Only data transmission is when

the Camera wire(USB-C) is connected PC and maincontroller.

- The robot could not act when it is charging.
- Pls charge in time when the robot is in low battery. Ensure charge once 2-3 months, if not used for a long time.
- Please connect to the WLAN in advance, when using the online voice function of the main controller.
- Each port supports up to 4 heavy loads of the main controller. The maximum heavy load of the main controller is 12. It depends on the actual power consumption.
- Windows 10 is recommended to use, or later.
- Please power off before removing the battery.

## **WARNING!**

- The packaging must be retained since it contains important information.
- The battery charger used with the product is to be regularly examined for damage to the cord, plug, enclosure and other parts, and in the event of such damage, they must not be used until the damage has been repaired.
- The product is not to be connected to more than one power supply.
- The product must be used with the recommended battery (Li-ion type rechargeable battery, rated DC 7.4V).
- The battery is to be mounted with the correct polarity.
- The supply terminals, battery terminals and connectors are not to be short-circuited.
- Never connect more than 12 servo motors in total at the same time. Do not operate the product during charging.
- Choking hazard – small parts inside. Not suitable for children under three years.
- The product must only be used with the recommended transformer (rated output DC 19V, 1A). The transformer is not a toy.
- The product must be disconnected from the transformer before cleaning.
- Transformers and power supplies for products are not intended to be used as toys, and the use of these products by children shall be under the full supervision of an adult.
- Risk of explosion if the battery is replaced by an incorrect type.
- Disposal of a battery into a fire or a hot oven, or mechanically crushing or cutting of a battery, that can result in an explosion.
- Leaving a battery in an extremely high temperature surrounding environment that can result in an explosion or the leakage of flammable liquid or gas.
- A battery subjected to extremely low air pressure may result in an explosion or the leakage of flammable liquid or gas.

Read the safety instructions carefully before using the device for the first time. Note the warnings on the device and in the operating instructions, use only power supplies listed in the user manual.

## **Warranty Card**

### **Customer Information:**

- Product Version:
- Product NO:
- Purchase Date:
- Name:

- Tel:

## Maintenance Record

Date of Maintenance	Problem & Solution	Date of Completion	Customer Signature

**After the purchase, please read this Warranty Card carefully and comply with the following clauses.**

1. Please keep the warranty card in a safe place.
2. This warranty card should be provided with your request for repair or maintenance.
3. Please make sure the information is true on this card, otherwise, it is invalid.
4. The warranty period of this product is one year after purchase. If there are any problems with this product within the warranty period, UBTECH will offer free maintenance, repairs or replacement of components. Consumables like servo motors, batteries and cables are excluded from this policy.

Warranty protections are in addition to rights provided under local consumer laws and may vary between countries.

**Product damage due to the following reasons is beyond the range of**

### Warranty Policy.

1. Improper use (not as specified in the User Manual) of the product.
2. Intended or accidental damage.
3. Damage resulted from unauthorized maintenance, conversion or unsealing of the product.
4. Aging, collision or scratching of the product shell.

**After the Warranty Period, UBTECH offers paid maintenance services.**

Official Customer Service Email: [aftersales@ubtrobot.com](mailto:aftersales@ubtrobot.com).

**Scan the QR code to get the electronic quick guide**



This guide does not constitute any form of commitment. Products (including but not limited to colour, size, quantity, etc.), related information and pictures are for reference only. Please refer to the actual product.



## UBTECH ROBOTICS CORP LTD

- **Add:** Room 2201, Building C1, Nanshan Smart Park, No.1001 Xueyuan Avenue, Changyuan Community, Taoyuan Street, Nanshan District, Shenzhen, P.R. China.
- **Web:** [www.ubtrobot.com](http://www.ubtrobot.com).

## Documents / Resources

	<a href="#">UBTECH UGOTERX UGOT Programmable Robot Builder Stock</a> [pdf] User Guide UGOTERX UGOT Programmable Robot Builder Stock, UGOTERX UGOT, Programmable Robot Builder Stock, Robot Builder Stock, Builder Stock, Stock
--	---

## References

- [Home Page-UBTECH](#)
- [uCodeçx³/4âœ°-K12äººâ·¥æ™ªèf¹/2â°â...¿ç¹/4-ç”](#)
- [User Manual](#)

[Manuals+](#), [Privacy Policy](#)

This website is an independent publication and is neither affiliated with nor endorsed by any of the trademark owners. The "Bluetooth®" word mark and logos are registered trademarks owned by Bluetooth SIG, Inc. The "Wi-Fi®" word mark and logos are registered trademarks owned by the Wi-Fi Alliance. Any use of these marks on this website does not imply any affiliation with or endorsement.