



Contents [[hide](#)]

- [1 U-PROX SE Mini Universal Reader](#)
- [2 Installation:](#)
- [3 Configuration:](#)
- [4 Usage:](#)
- [5 FCC](#)
- [6 IC STATEMENT](#)
- [7 TECHNICAL SPECIFICATIONS](#)
- [8 INSTALLATION](#)
- [9 CONNECTION](#)
- [10 FAQs](#)
- [11 Documents / Resources](#)
 - [11.1 References](#)

U-PROX

U-PROX SE Mini Universal Reader



Specifications:

- Brand: U-Prox
- Model: U-Prox SE mini
- Interfaces: Wiegand, RS-232, Mifare, OSDP, NFC, Mobile ID, Payment cards
- Compatibility: Works with the U-Prox Mobile ID application and U-Prox IDs
- Compliance: Radio Equipment Directive 2014/53/EU, Directive 2011/65/EU (RoHS), FCC Class B digital device

Installation:

1. Mount the U-Prox SE mini reader securely at the desired access point.
2. Connect the necessary interfaces such as Wiegand, RS-232, or NFC based on your system requirements.
3. Ensure proper power supply to the reader.

Configuration:

1. Access the U-Prox Mobile ID application and pair the U-Prox SE mini reader with your mobile credentials.
2. Adjust settings on the reader as needed for your access control requirements.

Usage:

1. Present your mobile credentials or proximity identifiers near the U-Prox SE mini reader.

2. The reader will authenticate the credentials and grant access if authorized.

UNIVERSAL MINIATURE READER U-PROX access control system declares, that the U-PROX SE mini complies with the Radio Equipment Directive 2014/53/EU and with the Directive 2011/65/EU (RoHS) The original Declaration of Conformity is available on the website www.u-prox.systems in the Certificates section.

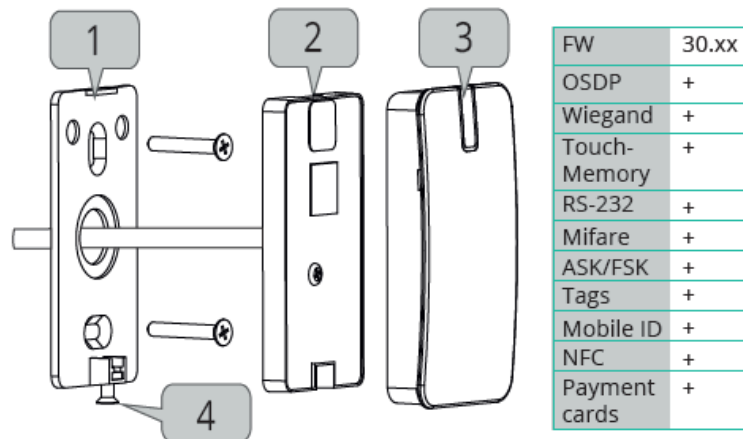

FCC

This equipment has been tested and found to comply with the limits for a Class B digital device, under Part 15 of the FCC Rules. These limits are designed to provide reasonable protection against harmful interference in a residential installation.

This equipment generates uses and can radiate radio frequency energy and, if not installed and used according to the instructions, may cause harmful interference to radio communications. However, there is no guarantee that interference will not occur in a particular installation.

If this equipment does cause harmful interference to radio or television reception, which can be determined by turning the equipment off and on, the user is encouraged to try to correct the interference by one or more of the following measures:

- Reorient or relocate the receiving antenna.
- Increase the separation between the equipment and receiver.
- Connect the equipment to an outlet on a circuit different from that to which the receiver is connected.

- Consult the dealer or an experienced radio/TV technician for help.

This device complies with part 15 of the FCC Rules. Operation is subject to the following two conditions:

1. This device may not cause harmful interference,
2. This device must accept any interference received, including interference that may cause undesired operation.

Changes or modifications not expressly approved by the party responsible for compliance could void the user's authority to operate the equipment.

IC STATEMENT

This device contains licence-exempt transmitter(s)/receiver(s) that comply with Innovation, Science and Economic Development Canada's licence-exempt RSS(s).

Operation is subject to the following two conditions:

1. This device may not cause interference.
2. This device must accept any interference, including interference that may cause undesired operation of the device.

RF warning for Portable device:

The device has been evaluated to meet the general RF exposure requirements. The device can be used in portable exposure conditions without restriction.

TECHNICAL SPECIFICATIONS

Reads (Supported formats depend on firmware)	Mifare®, 13.56 MHz, ISO14443A, 4, 7, 10 bytes UID: Mifare®Classic 1K/4K, Mifare®Standard, Mifare®Ultralight, Mifare®Hi-Memory, Mifare® Plus S 2K, Mifare® Plus S 4K, Mifare® Plus SE 1K, Mifare® Plus X 2K, Mifare®Plus X 4K, Mifare®Plus EV1 2K, Mifare® Plus EV1 4K, Mifare® DESfire, Mifare® DESfire EV1, Mifare® DESfire EV2 NFC, 13.56 MHz, ISO 14443/15693; Payment cards: PayPass, PayWave RFID, 125 kHz : ASK and FSK; 2.4 GHz mobile ID, U-PROX Tag / Auto Tag
Read range	NFC, Mifare and RFID 125 kHz - up to 5 cm, 2.4 GHz radio - adjustable 10 cm - 15 m
Interfaces	Wiegand Auto, 26, 32, 34, 37, 40, 42, 56, 58, 64, 80 bits, RS-232, TouchMemory, OSDP v 2.2
Ambient	IP65, -40°C to +60°C
Power	+9...+15 VDC, consumption < 80 mA
Dimensions & weight	45 x 80 x 12.5 mm & 70 gramms
Case material & colour	ABS+PC plastic & black, light gray
Wiring and distance	8 wire cable, TouchMemory - up to 30 m, Wiegand - up to 150 m, OSDP - up to 1000 m

PROGRAMMING



The reader is supplied without the engineering password

INSTALLATION

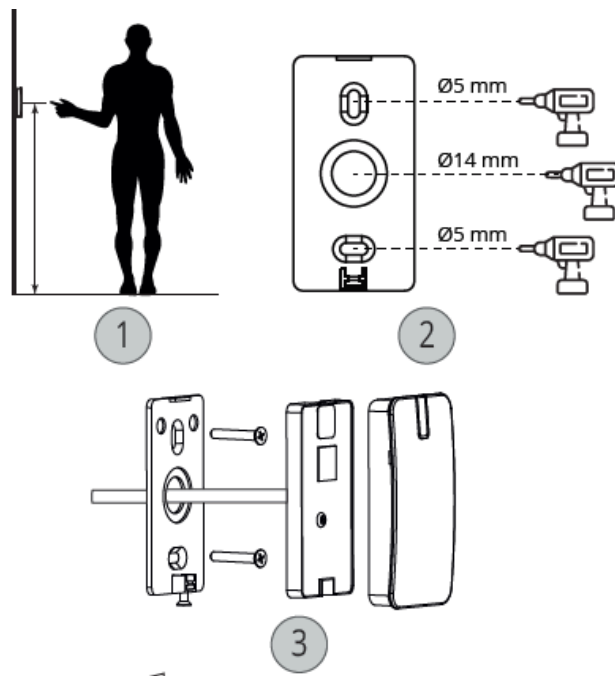

- Range decreases on metal
- Connect the yellow wire for synchronization.

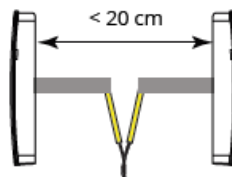
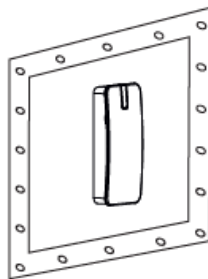

CONNECTION

Wiegand

+12V	EN red ES rojo	FR rouge PT vermelho	UA червоний PL czerwony
GND	EN black ES negro	FR noir PT preto	UA чорний PL czarny
Data0 (WD0)	EN green ES verde	FR vert PT verde	UA зелений PL zielony
Data1 (WD1)	EN white ES blanco	FR blanc PT branco	UA білий PL biały
Red LED (RD)	EN brown ES marrón	FR brun PT marrom	UA коричневий PL brązowy
Green LED (GN)	EN orange ES naranja	FR orange PT laranja	UA помаранчевий PL pomarańczowy
Beep	EN blue ES azul	FR bleu PT azul	UA синій PL niebieski
Hold or sync	EN yellow ES amarillo	FR jaune PT amarelo	UA жовтий PL żółty

Using twisted pair

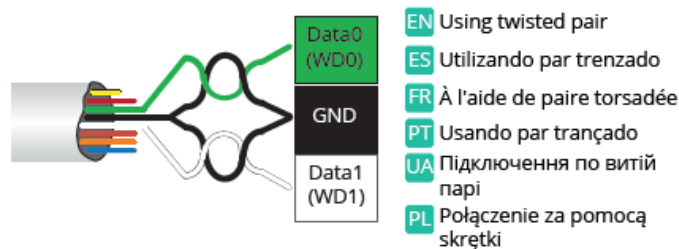

TouchMemory

+12V	EN red ES rojo	FR rouge PT vermelho	UA червоний PL czerwony
GND	EN black ES negro	FR noir PT preto	UA чорний PL czarny
Button	EN green ES verde	FR vert PT verde	UA зелений PL zielony
Red LED (RD)	EN brown ES marrón	FR brun PT marrom	UA коричневий PL brązowy
Green LED (GN)	EN orange ES naranja	FR orange PT laranja	UA помаранчевий PL pomarańczowy
Beep	EN blue ES azul	FR bleu PT azul	UA синій PL niebieski
Hold or sync	EN yellow ES amarillo	FR jaune PT amarelo	UA жовтий PL żółty

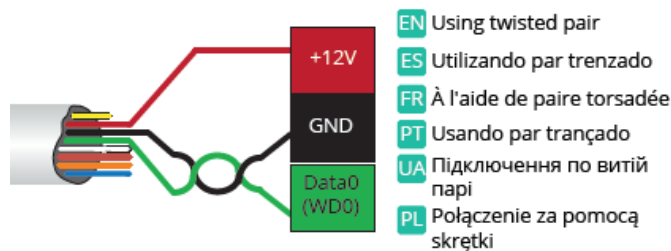

+12V	EN red ES rojo	FR rouge PT vermelho	UA червоний PL czerwony
GND	EN black ES negro	FR noir PT preto	UA чорний PL czarny
Rx	EN green ES verde	FR vert PT verde	UA зелений PL zielony
Tx	EN white ES blanco	FR blanc PT branco	UA білий PL biały

OSDP

+12V	EN red ES rojo	FR rouge PT vermelho	UA червоний PL czerwony
GND	EN black ES negro	FR noir PT preto	UA чорний PL czarny
A+	EN green ES verde	FR vert PT verde	UA зелений PL zielony
B-	EN white ES blanco	FR blanc PT branco	UA білий PL biały

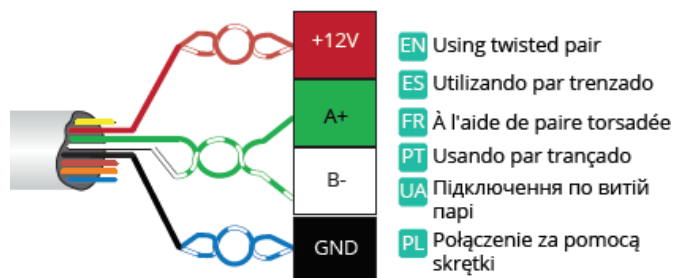

SET OR RESET ENGINEER PASSWORD

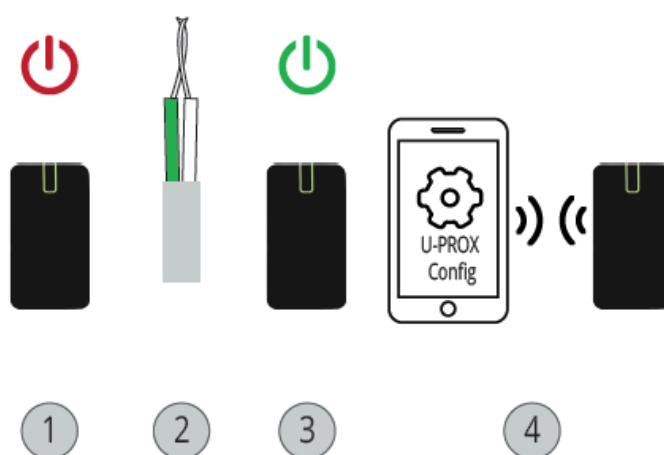

PROXIMITY-DOOR” MODE

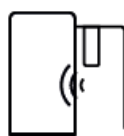

- The reader is activated by the presence sensor.
- Read range 5-10 cm

“DOOR” MODE

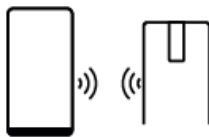

- The reader is always active.
- Read range 50-60 cm

“GATE/BARRIER” MODE

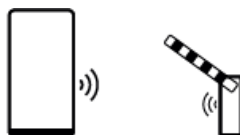

- The reader is always active.
- Read range 1 – 15 m

U-PROX MOBILE ID

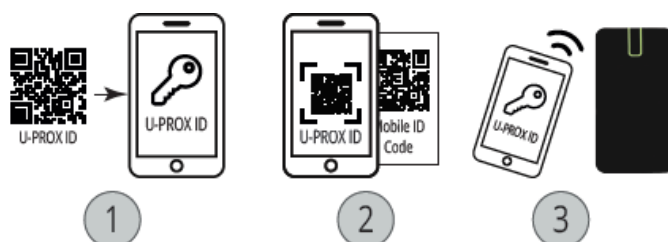

- www.u-prox.systems
- support@u-prox.systems
- www.u-prox.systems/doc_semini



FAQS

Q: What should I do if the device causes interference?

A: If interference occurs, try turning the device off and on. If the issue persists, follow the guidelines provided in the manual to address the interference.

Q: How can I ensure proper operation of the U-Prox SE mini?



A: Make sure to install and use the device according to the instructions provided. Keep the device updated with the latest firmware to maintain optimal performance.

Documents / Resources

	U-PROX SE Mini Universal Reader [pdf] Instruction Manual SE Mini Universal Reader, Mini Universal Reader, Universal Reader, Reader
--	---

References

- [User Manual](#)

 Mini Universal Reader, Reader, SE Mini Universal Reader, U-PROX, Universal
 U-PROX Reader

Leave a comment

Your email address will not be published. Required fields are marked *

Comment *

Name

Email

Website

☐ Save my name, email, and website in this browser for the next time I comment.

Post Comment

Search:

e.g. whirlpool wrf535swhz

Search

[Manuals+](#) | [Upload](#) | [Deep Search](#) | [Privacy Policy](#) | [@manuals.plus](#) | [YouTube](#)

This website is an independent publication and is neither affiliated with nor endorsed by any of the trademark owners. The "Bluetooth®" word mark and logos are registered trademarks owned by Bluetooth SIG, Inc. The "Wi-Fi®" word mark and logos are registered trademarks owned by the Wi-Fi Alliance. Any use of these marks on this website does not imply any affiliation with or endorsement.